

Plan traseu PC 0+00 + PC 4+00.

Sc1:500.

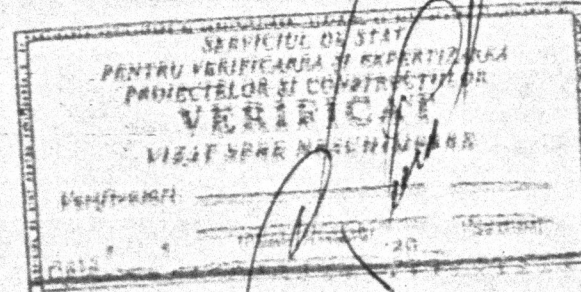

Actualizare:
 N. Untila

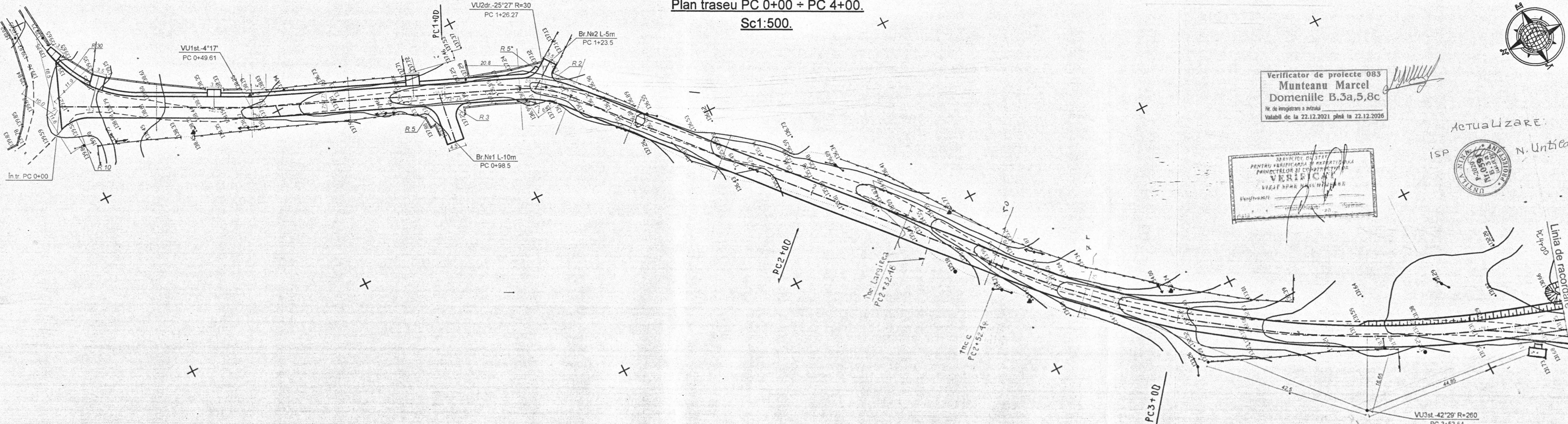
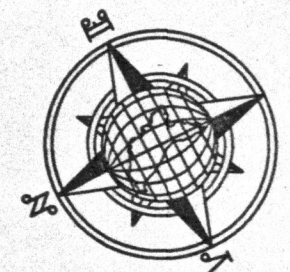

					Nr.15823 - DA				
					Amenajarea traseului ECO - Turistic "ZAMCA" in apropierea r.Prut, s.Pererita, r-ului Briceni				
					Drumuri pentru automobile.		Stadia PE	Desen 3	Nr. desen
					Plan traseu PC 0+00 + PC 4+00.		INCP"URBANPROIECT"		
ISP	Elaborat	Untila N.	Mironova T.						

Plan traseu PC 4+00 + PC 6+36.6

Sc1:500.

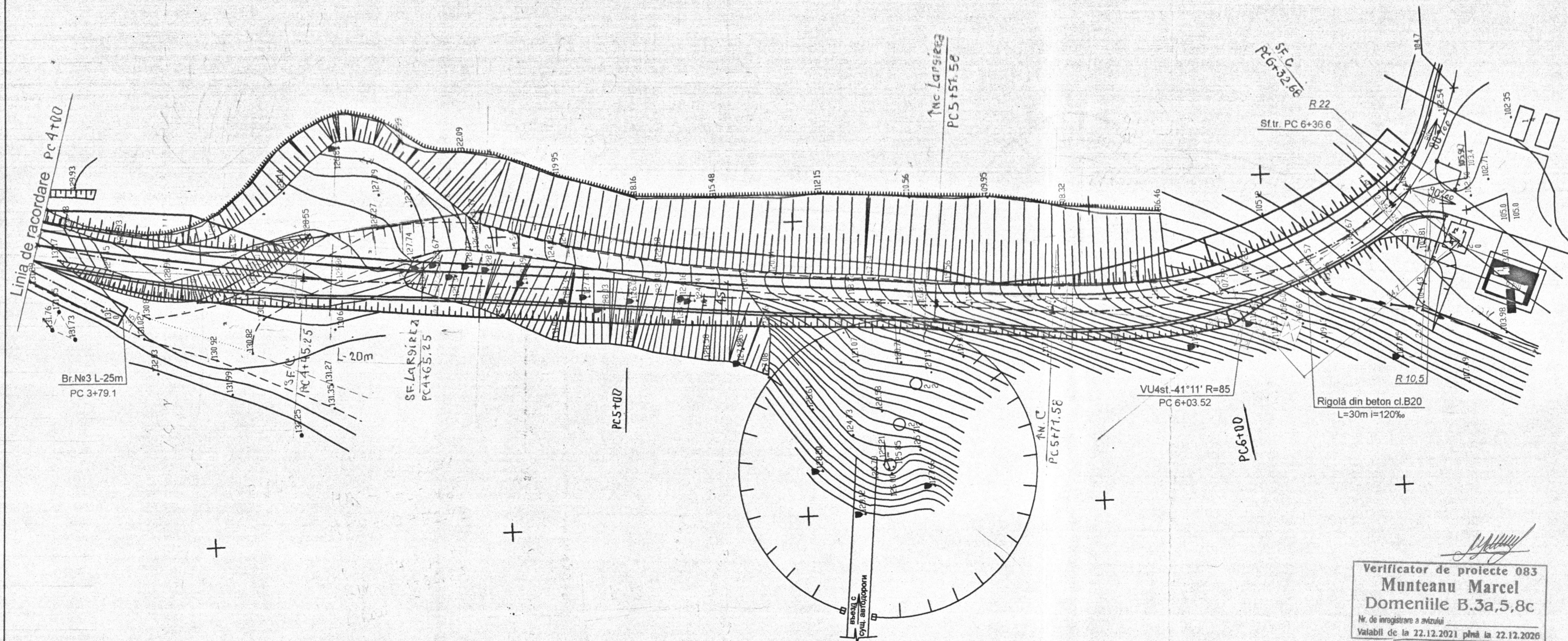
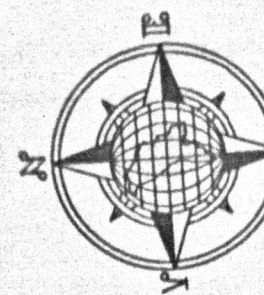

Elementele geometrice ale traseului.

No ungh-i	Unghiuri				Curbe													Aliniament		
	Pozitie vhf ungh-i		Mărime ungh-i		Elemente in metri								Început curbă IC		Sfârșit curbă SC		Distanța dintre VU S	Lungime aliniament P	Cart	
	km	PC	+	dreapta	stinga	Raza R	Lung. curbei progr. L	Tangenta T	Bisec-toarea B	Curbă C	D	Dilatate E	PC	+	PC	+				
1	2	3	4	5	6	7	8	9	10	11	12	13	14	15	16	17	18	19	20	
Inc. traseu	0	0	00	-	-	-	-	-	-	-	-	-	-	-	-	-	-	49.61	49.61	-
1	0	0	49.61	-	4°17'	-	-	-	-	-	-	-	-	-	-	-	-	76.66	69.88	-
2	0	1	26.27	25°27'	-	30	-	6.78	0.76	13.33	0.23	-	1	19.49	1	32.82	227.50	119.66	-	
3	0	3	53.54	-	42°29'	260	20	101.06	18.15	192.77	9.35	0.5	2	52.48	4	45.25	259.33	126.33	-	
4	0	6	03.52	-	41°11'	85	20	31.94	5.80	61.10	2.78	0.7	5	71.58	6	32.68	35.86	3.92	-	
St. traseu	0	6	36.60	-	-	-	-	-	-	-	-	-	-	-	-	-	ΣS=648.96	-	-	-
																	ΣP=369.40			
																	ΣC=267.20			
																	ΣD=12.36			
																	ΣT=139.78*2=279.56			
																	ΣT-ΣC=ΣD	279.56-267.20=12.36		
																	ΣS-ΣD=L	648.96-12.36=636.6		
																	ΣP+ΣC=L	369.4+267.2=636.6		

Actualizaze
ISP Untiea

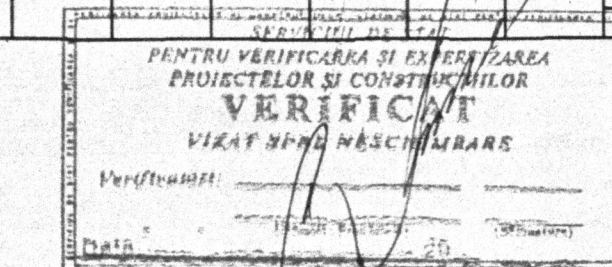

Verificator de proiecte 083
Munteanu Marcel
Domeniile B.3a,5,8c
Nr. de inregistrare a avizului
Valabil de la 22.12.2021 pînă la 22.12.2026

					Nr.15823 - DA		
					Amenajarea traseului ECO - Turistic "ZAMCA" in apropierea r.Prut, s.Perenta, r-ul Briceni		
					Drumuri pentru automobile.		
					Stadia	Desen	Nr. desen
					PE	4	
					Plan traseu PC 4+00 + PC 6+36.6.		
					INCP"URBANPROIECT"		