

Schita  
Impuls de întârziere Sticlă pachet

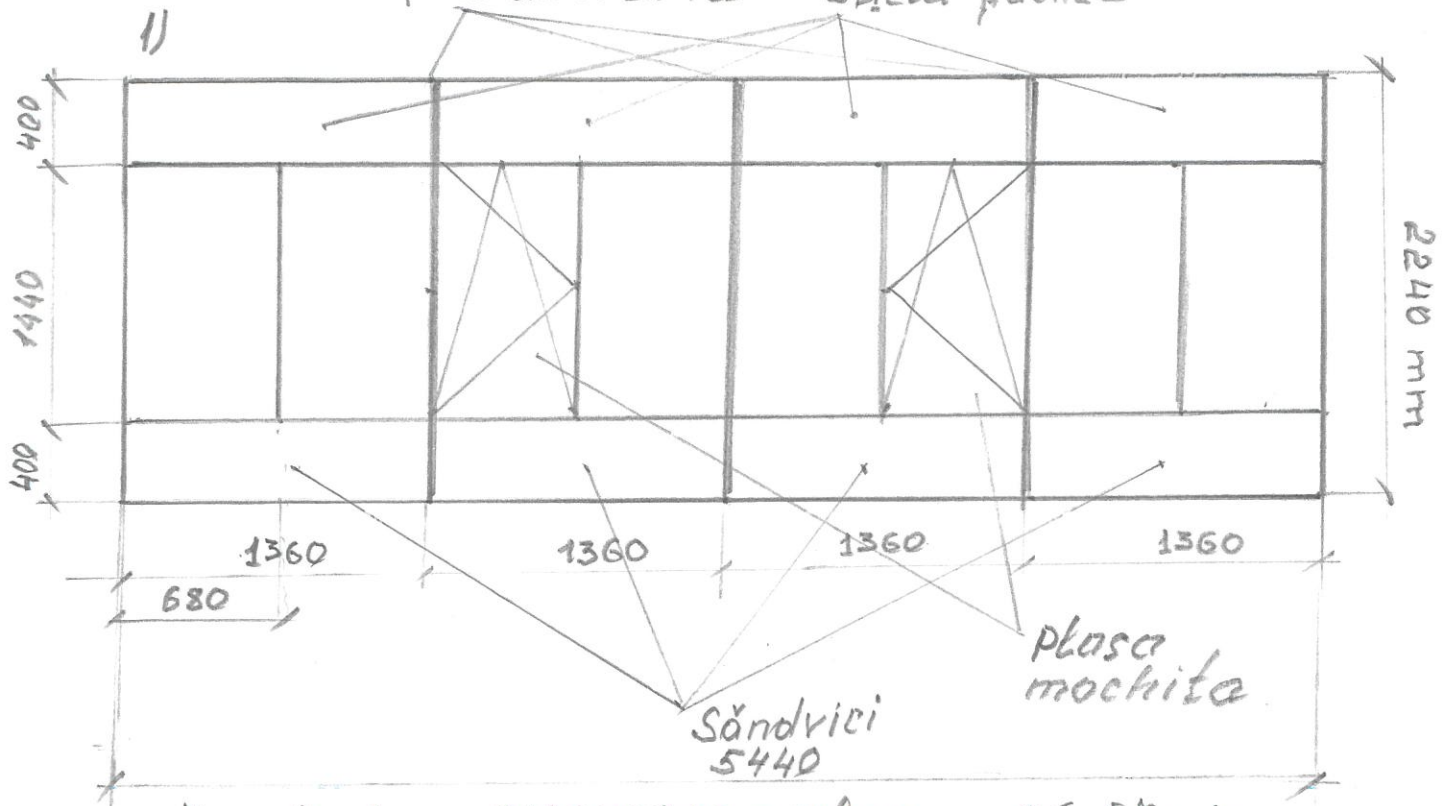

Impuls de întârziere  
2) 2240 x 5440 = 3 buc 36.57 m<sup>2</sup>  
Sticlă pachet

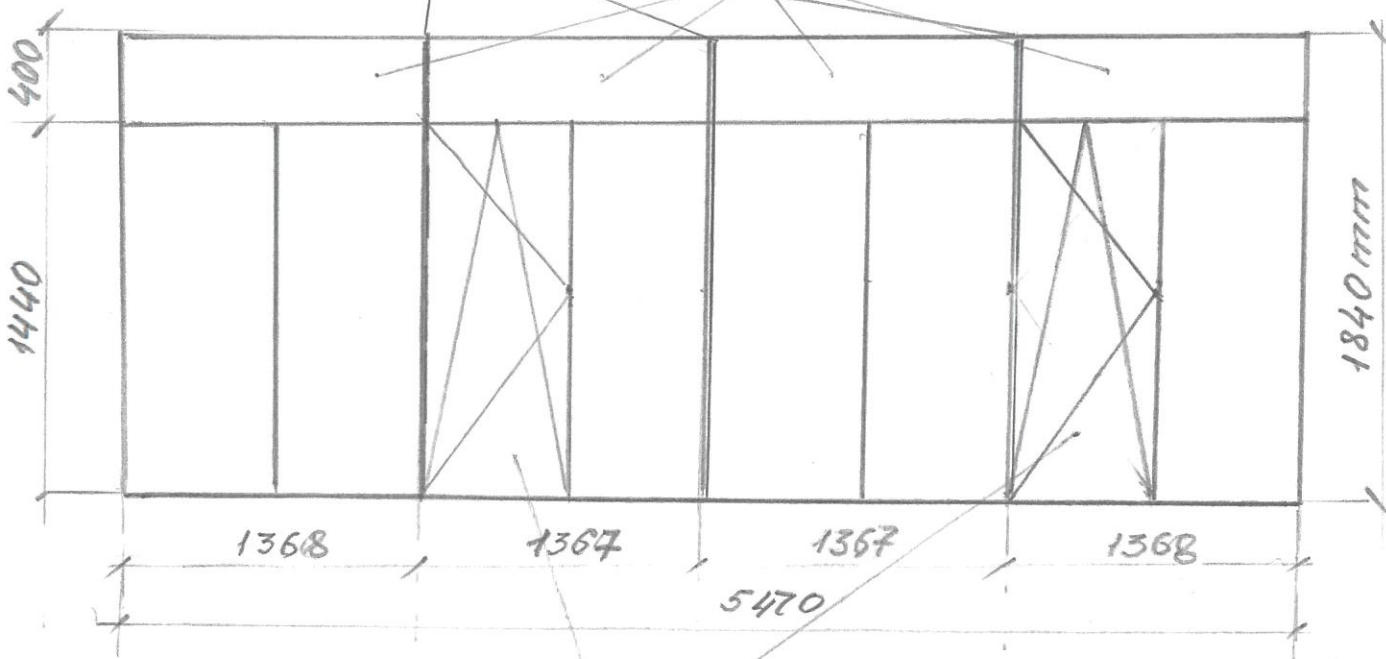

1840 x 5470 = 1 buc 10.07 m<sup>2</sup>

plasa mochetă

Inginer specialist principal  
Vladimir Bolgari

# Schita Uși din aluminiu

1) coridor

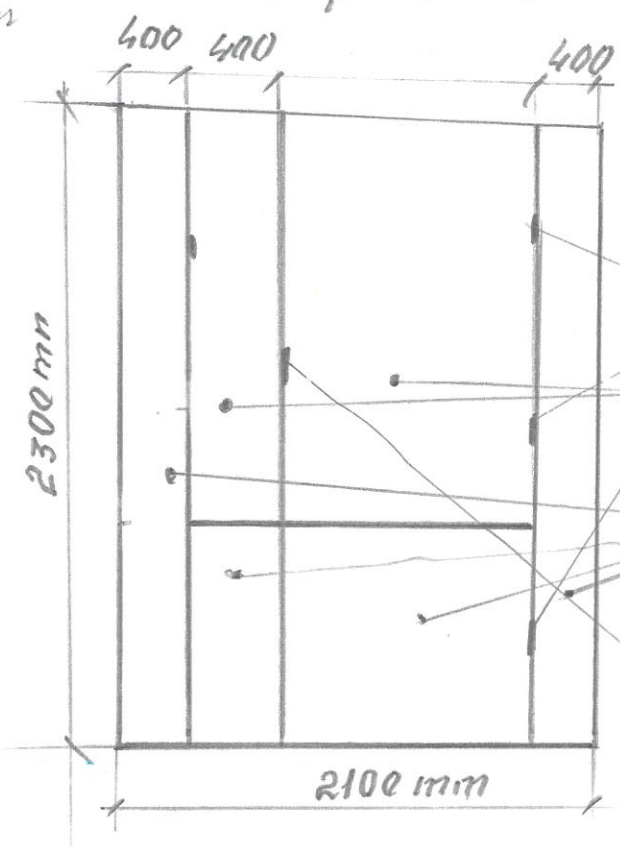

Deschidere stînga

$2300 \times 2100 \text{ mm} = 1 \text{ buc}$

$4,83 \text{ m}^2$

2) scara

Deschidere dreapta

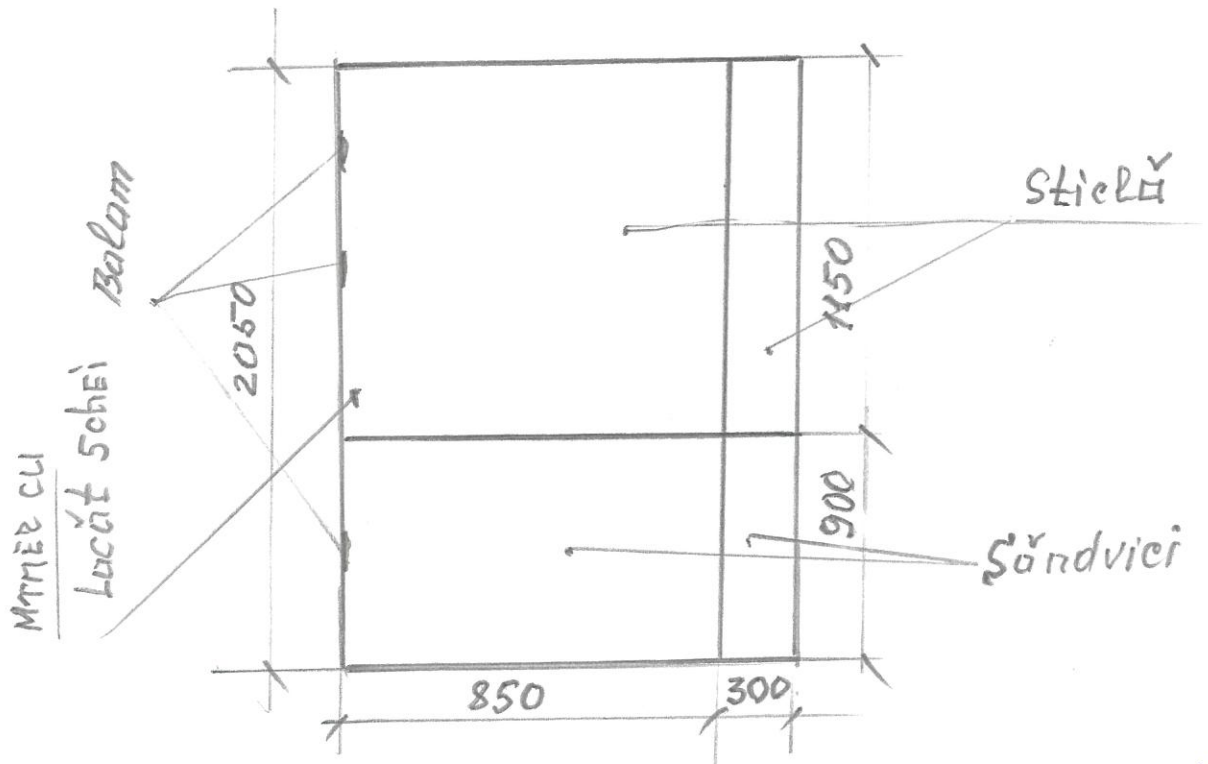

$2050 \times 1150 = 1 \text{ buc}$   
 $2,36$

Inginer specialist principal  
*Vladimir Belgor*

Ușă exterioară din aluminiu

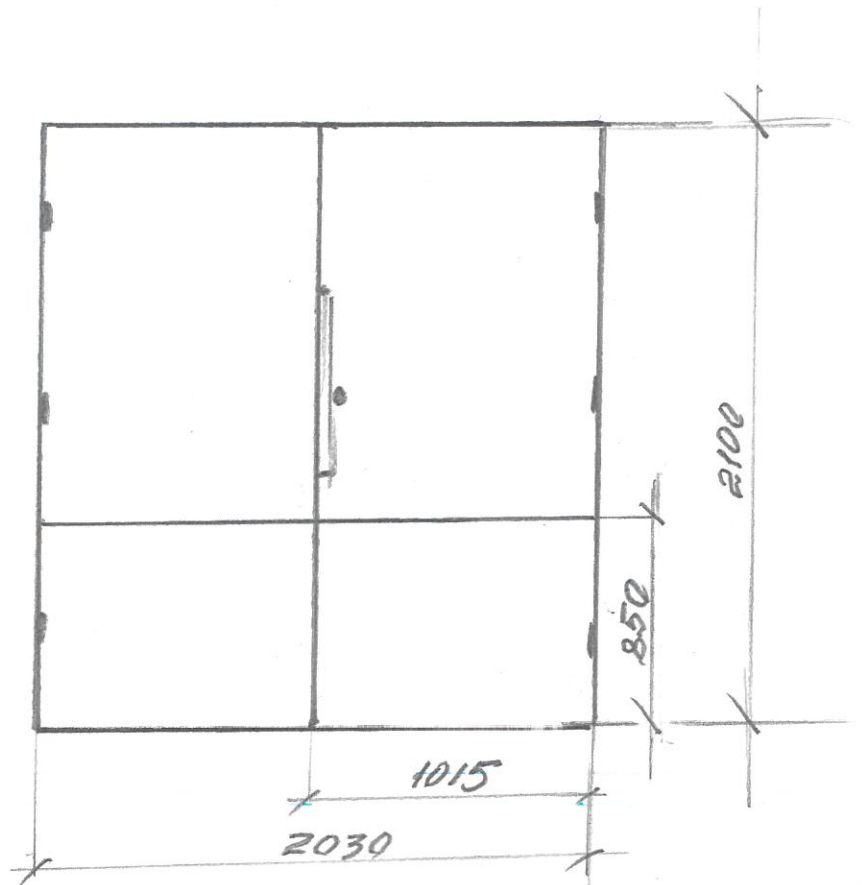

2100 x 2030 = 1 buc

Ușă metalică exterioară

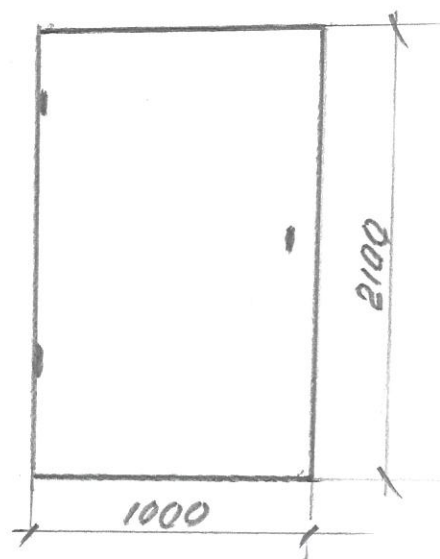

2100 x 1000 = 2 buc

Inginer specialist principal serviciul  
Logistica  V. Bolgari

Tambur

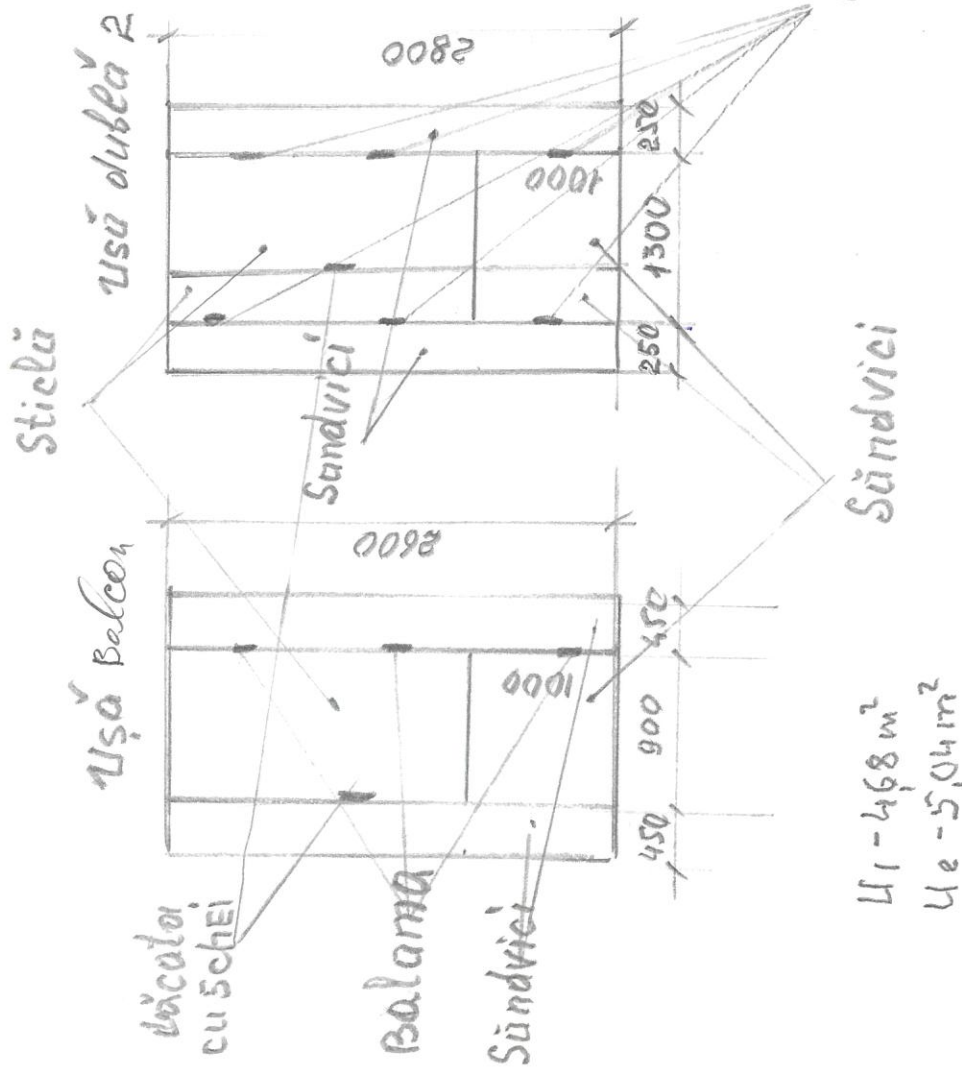
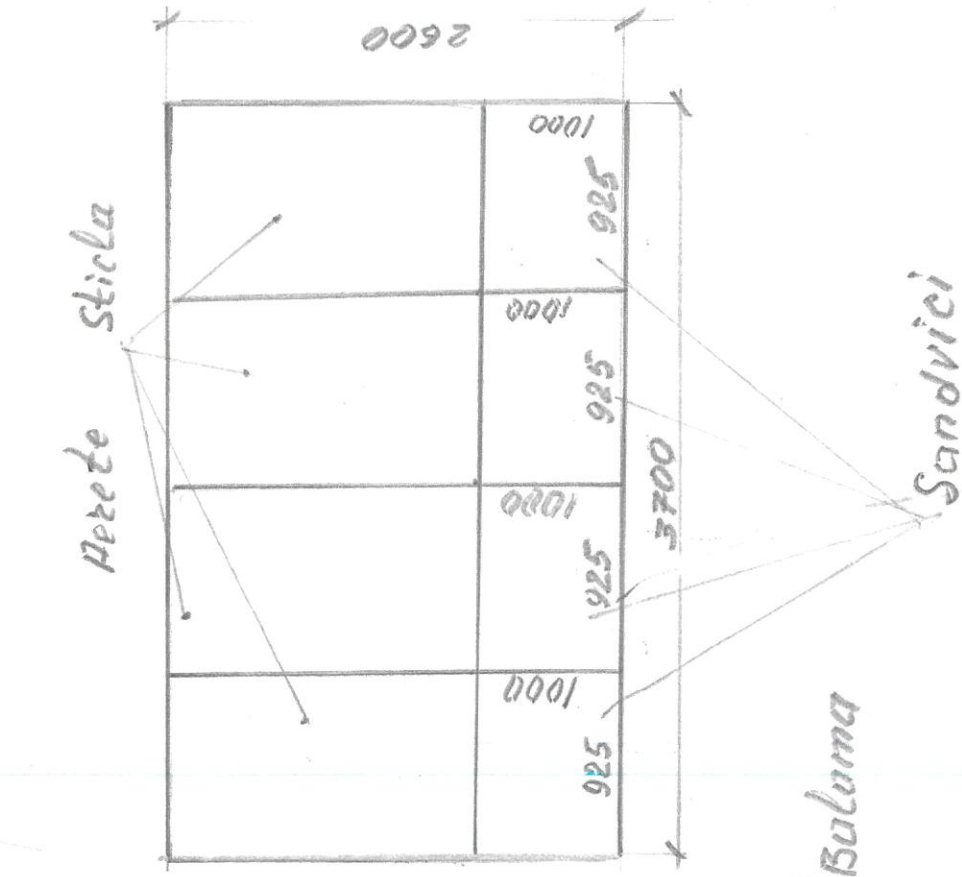

U1 - 468 m<sup>2</sup>  
 Ue - 5,04 m<sup>2</sup>  
 Perete - 9,62 m<sup>2</sup>  
 Total: 19,34 m<sup>2</sup>

Ingineer specialist principal

Vladimir Bobyari

FERESTRE  
cu persiță  
mobilitate

Et. 7

salon 7/08, 7/10, 7/11, 7/12

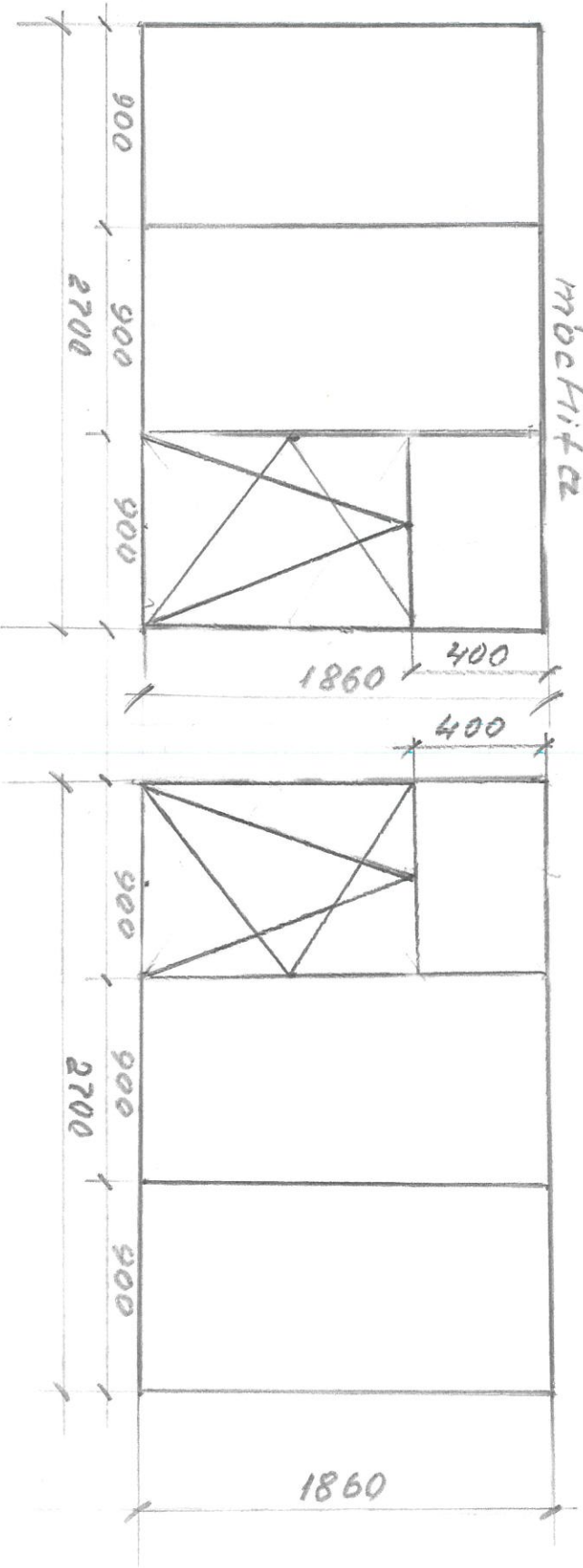

$$2700 \times 1860 = 2541c$$

$$2700 \times 1860 = 2541c$$

Pereche - 5600 mm

Pereche - 5600 mm

20. 12 m<sup>2</sup>

Inginer specialist principal

Vladimir Bologan



Ușă metalică  
cu disolizator mecanic

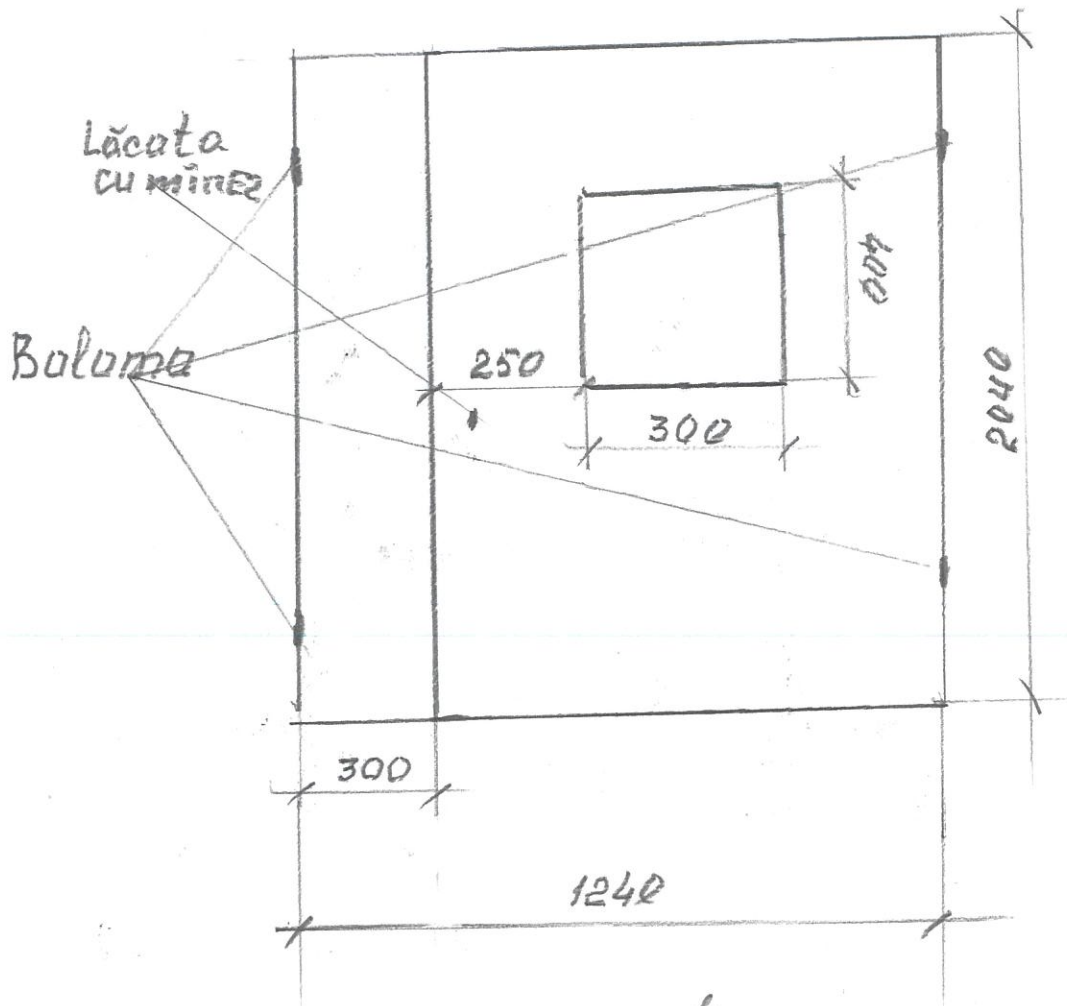

$$1240 \times 2040 = 1 \text{ buc}$$
$$S = 2,53 \text{ m}^2$$

Inginer specialist principal

Vladimir Bolgar