

Schema CONSTRUCTIVĂ
 a GALEREEI DE TRECERE
 P/U BOENAVI
 (secția de INTERNARE)

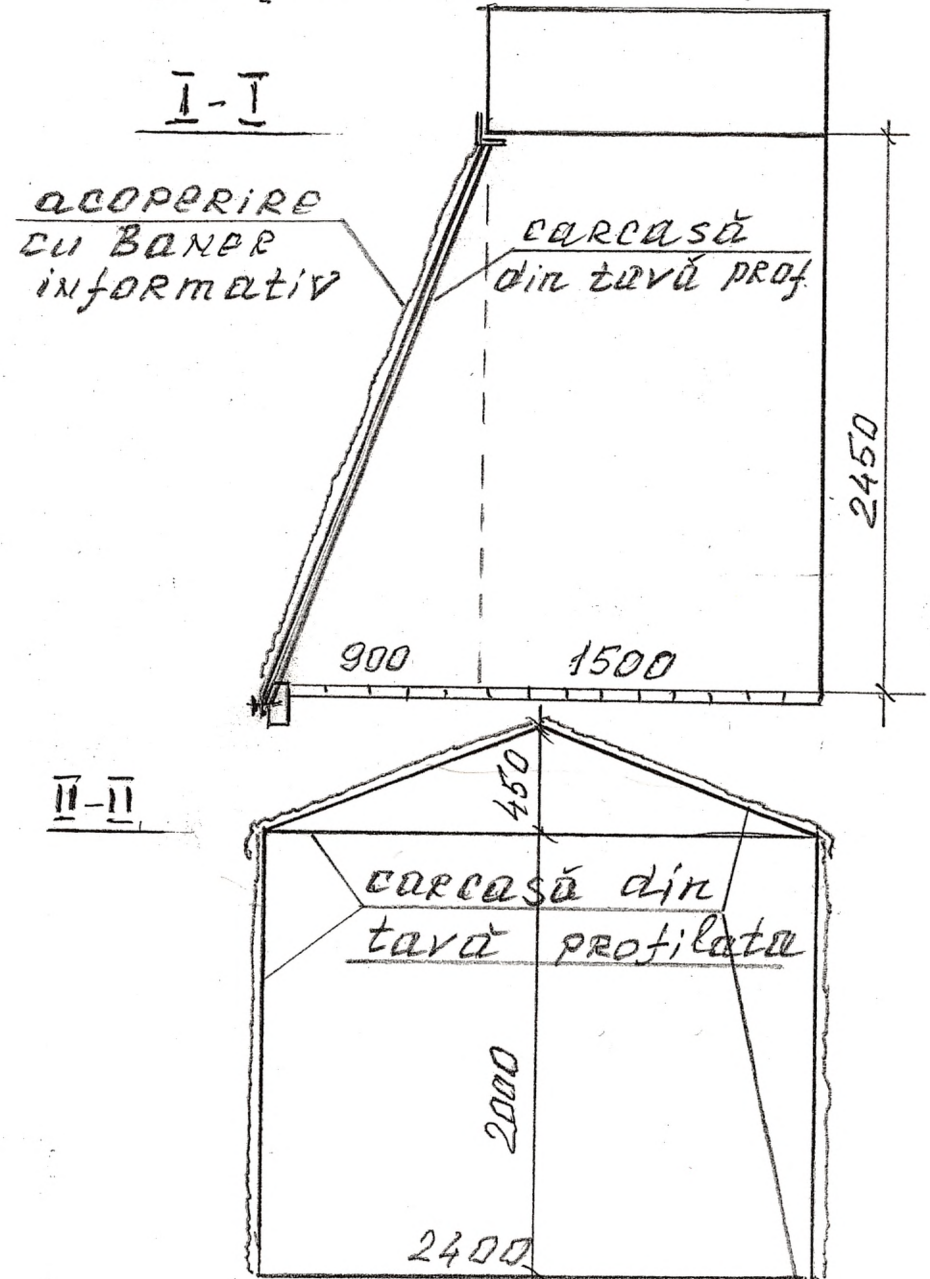

Schema constructivă
a galeriei de trecere
pentru bolnavi
(Bec chirurgicale)

Galerie existentă
Sticlă de vitraliu
se demonstrează

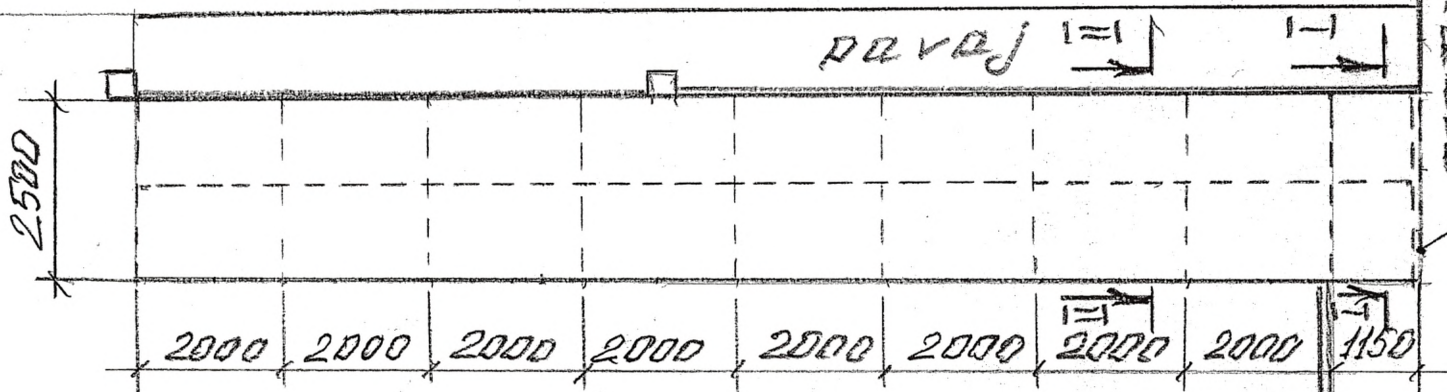

I-I

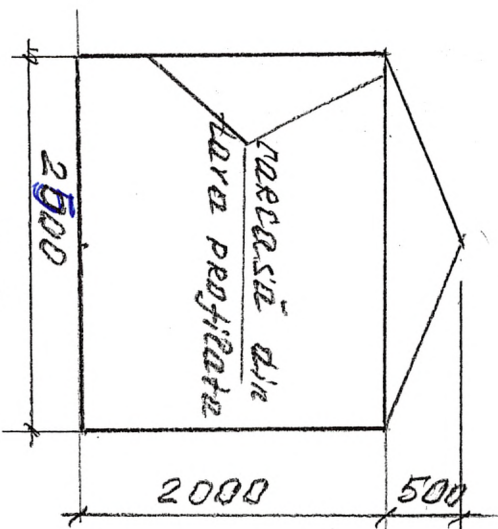

II-II

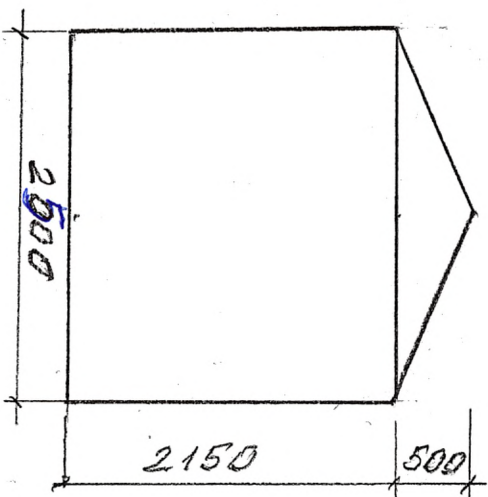

Novamod

Bordură

CONSTRUCTIE
METALICĂ

PRELATĂ
(TENT)

pavaj

SCR 16 ET.

Găberee

(SECȚIA DE INTERNARE)

Galerie
(Bloc chirurgical)

