

> 专业就是希望 品质保证一切 <



江苏康宝医疗器械有限公司

JIANGSU KANGBAO MEDICAL EQUIPMENT CO., LTD.

» YANGZHOU CHINA



公司概况

江苏康宝医疗器械有限公司创建于1986年6月,是集科研、制造、贸易于一体的医疗器械、器材和医用设备专业制造商。

公司主要生产一次性无菌医疗器械、医用敷料及卫生材料、医用设备。公司注册资本2250万元。公司占地面积60,000平方米,并按照GMP规范和美国FDA标准,建造10万级净化厂房18,000平方米。

公司已通过ISO13485质量体系认证和CE产品认证。公司采用科学的生产工艺,严密的质量管理体系,依靠雄厚的专业技术力量和先进的检测设备装置为客户提供优质的产品和服务。

公司产品目前覆盖全国20多个省市,并出口到欧美、东盟、南美和中东等数十个国家和地区。长期以来,“申宝”、“广顺”牌各种产品深受国内外客户的赞赏和信赖,得到了国内外客户的一致好评。

PRESENTATION

Jiangsu Kangbao Medical Equipment Co., Ltd (MedKB), as a professional manufacturer of disposable medical devices, is located in Yangzhou city, about 4 hours from Shanghai by car. Our company was founded in 1986, with the registered capital of RMB 22.50 million. We cover a land area of 60,000 sqm, including state-of-the-art facilities and 100,000 Level Clean Rooms covering 18,000 sqm, which was built according to GMP and FDA Standard. We are specialized in producing and distributing disposable devices, main including disposable sterile syringe, infusion sets, blood transfusion sets, Hypodermic needle, IV systems, scalp vein sets and medical dressing products.

There are more than 500 employees working in MedKB. We have established Quality Management System according to ISO 13485 and CE standards. The QA is applied to the full process of manufacturing. We have obtained CE and ISO13485 certificate as well. Our biochemical & physical laboratories were constructed strictly as per GMP standard, equipped with advanced testing apparatuses. We have EO sterilization devices, which are complying with European standards.

We believe that Price, Quality and Service form an equilateral triangle. We always try our best to offer the perfect triangle with the competitive price. High quality and Good service to our customers all over the world.





江苏康宝医疗器械有限公司
JIANGSU KANGBAO MEDICAL EQUIPMENT CO., LTD.



江苏康宝医疗器械有限公司
JIANGSU KANGBAO MEDICAL EQUIPMENT CO., LTD.



目录 Contents

01-02	Disposable Hypodermic Syringe
03	Disposable Syringe with safety needle
04	Various Syringe
05-06	Disposable Infusion Sets
07	Three way stopcock
08	Extension tube
09	Safety scalp vein set
10	Safety blood collection needle
11	Gravity blood administration sets
12	Voluntric I-V Burette
13	Oral Syringe
14	The connector
15	Drug preparation
16	Blood collection needle
17	Disposable needle
18	Sharps disposal solutions
19	Irrigation Syringe
20	I.V. Catheter/Cannula





质量方针

quality policy

保证质量是我们永远的承诺

Quality assurance is our eternal commitment

用户满意是我们不懈的追求

Customer satisfaction is our unremitting pursuit

企业精神

Enterprise spirit

诚信、创新、奋发、超越

Sincerity、innovate、Strenuous、Transcend



key facts of our production unit

40sets

Injection molding machines

16sets

Auto printing lines for syringes

8sets

Auto-assembling machines for syringes

8sets

Blister packing machines

8sets

Auto-loading packing machines for syringe

1set

Auto-assembling machine for infusion set

1set

Auto-assembling machine for scalp vein set

3sets

Auto-assembling machines for hypodermic needle

3sets

Modernization testing lab for Physical
Chemical and Biological

3sets

EO Sterilization chamber



Testing center ▶





▲ Disposable syringe workshop

▶ Hypodermic needle workshop



▼ Injection molding workshop





Disposable Syringe

Features:

- Luer slip nozzle/luer lock nozzle
- Smooth consistent plunger action
- Clear, legible and accurate graduation
- Minimal dead space
- Well rounded finger grips for safe handling
- Positive stop against inadvertent withdrawal of plunger
- Barrel PP Piston PE
- Sterile and pyrogen free
- Sterilized with Ethylene Oxide
- Gamma Ray resistant material are available
- Latex free pistons are available

SIZE

SPEC.

1cc	Luer slip
2cc	Luer slip or luer lock
3cc	Luer slip or luer lock
5cc	Luer slip or luer lock
10cc	Luer slip or luer lock
20cc	Luer slip or luer lock
30cc	Luer slip or luer lock
50cc	Luer slip or luer lock
60cc	Luer slip or luer lock
100cc	Luer slip

3-Parts Syringe





2-Parts Syringe



Syringe caps





Disposable Syringe with safety needle

Features:

- compatible with all standard hypodermic needles
- convenient to use, one hand activation, minimal training required.
- economic, reduce the cost of safety injection.
- triple safety mechanism to guarantee 100% safety.
- visual confirmation of safety activation
- click device guarantee no obstruction during injection
- both luer slip and luer lock nozzle are available.





Hard pack Syringe

we offer syringe for the pet care market

Features:

- hard pack design, convenient and safe cartridge pack, easily disposed of and transportable.
- heat sealed cap for assurance of sterility.



Code	Size
HS01	1cc
HS02	2cc
HS05	5cc
HS10	10cc



Code	Unit	Size
IS03	U-100	0.3cc
IS05	U-40/U-1000	0.5cc
IS10	U-40/U-100	1cc





Infusion set

Delivering solutions in IV therapy for improved patient care

Features:

- Sharp spike is easy to puncture
- The iso standard spike can fit with any infusion bottles and bags.
- Soft and transparent chamber is easy to press and adjust solution.
- Antibacterial air-inlet.



- Big chamber with air vent, filter, needleless Y site, Adelberg flow regulator, 1.8m tube, luer lock with cap.



IVS01

- Big amber-colored drip chamber with air vent, ABS Adelberg flow regulator, amber-colored tube 1.5m, luer lock with needle.



IVS02

- Small drip chamber with air vent, Y site, 1.5m tube, luer slip without needle.



IVS03

- Winged spike, medium drip chamber with air vent, filter, ABS Adelberg flow regulator, Y injection port, 1.8m tube, luer lock without needle.



IVS04

- Medium drip chamber without air vent, 60 drops, filter, Y injection port, 1.8m tube, luer slip without needle.



Infusion set



Spike with drip chambers



Flow regulators



Injection ports

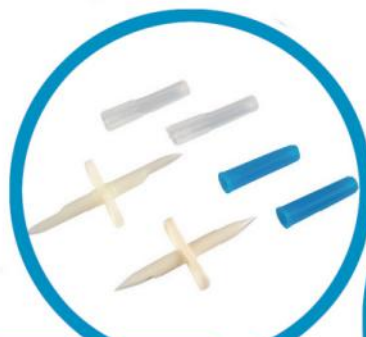

Transfer set



Y injection ports



Connectors

We offer a wide variety of IV accesssres to meet the needs of current practice:

- Small drip chamber 14.30*50mm.
Medium drip chamber 15.50*54mm.
Big drip chamber 17.20*61mm.
- With air vent, without air vent.
- Transfer set.
- 15drops 20drops, 60 drops/mL.
- With filter or without filter.
- Small flow regulator Medium flow regulator, ABS
Adelberg flow regulator.
- Accurate flow regulator rate of 5mL/hr to a maximum of
300mUhr.
- Latex straight tube, injection bulb, Y injection port.
- Latex free straight tube, injection bulb, Y injection port
- Needleless Y injection port, Needle free injection cap.
- Luer slip, luer lock connector.
- Red cap, blue cap, white cap.
- PVC tube length 1.3m to 2m or any required length.
- PVC tube DEHP FREE.
- Non-PVC tube.
- Customization mold construction for any kind of components.



Three way stopcock

Maximize fluid flow control and fluid and drug delivery efficiency.

Features:

- We can offer a full range of stopcocks to assist you in controlling fluid flow through IV delivery systems.
- Single packaged, as various options to meet all of your IV therapy needs
- All options are liquid resistant with a transparent housing for clear view of the fluid path.



TWB01



TWB04



TWB03



TWB02



TWB06



TWB07



Safety scalp vein set

It is used for injection of vein for medication infusion, the safety mechanism help to eliminate accidental needlestick injuries.

Features:

- The ergonomic design is ideal for clinician handling and patient comfort.
- Offering an easy grip.
- The design to minimize slips and touch contamination.



Safety scalp vein set



Safety scalp vein set



scalp vein set



Connectors

Code	Gauge	Size and length	
SSVS27/SVS27	27G*5/8"-3/4"	0.4x16-19mm	Grey
SSVS26/SVS26	26G*5/8"-3/4"	0.45x16-19mm	Brown
SSVS25/SVS25	25G*5/8"-4/5"	0.5x16-20mm	Orange
SSVS24/SVS24	24G*5/8"-4/5"	0.55x16-20mm	Purple
SSVS23/SVS23	23G*3/4"-1"	0.6*19-25mm	Blue
SSVS22/SVS22	22G*1"	0.7x25mm	Black
SSVS21/SVS21	21G*1-1/8"	0.8x 28mm	Green
SSVS20/SVS20	20G*1-1/8"	0.9x28mm	Yellow
SSVS19/SVS19	19G*1-1/8"	1.1 x28mm	Cream
SSVS18/SVS18	18G*1-1/8"	1.2x28mm	Pink



Extension tube

Features:

- Our extension sets are available in various lengths and dimensions to accommodate various applications,
- A range of lengths that provide flexibility in a variety of clinical settings.
- Available with various needleless connector options.
- A range of various flow clamber, components, connector options.
- To prevent dislodgment of IV catheter and offers ease of use during connection.
- Components are available for DEHP free or latex free.



ET10



ET09



ET08



TWB08



TWB09



TWB10

Description

Size

Needleless type, 1way, female luer lock, male rotating luer lock, slide clamp, OD 4mm
Needleless type, 2way, female luer lock, male rotating luer lock, slide clamp, OD 4mm
Needleless type, 3way, female luer lock, male rotating luer lock, slide clamp, OD 4mm
Needleless type, 4way, female luer lock, male rotating luer lock, slide clamp, OD 4mm
Male and female luer lock connector, male and female luer lock, slide clamp
3way stopcock, male rotating luer lock
Needleless type, 1way, female luer lock, male rotating luer lock, slide clamp, OD 2.35mm
Needleless type, 2way, female luer lock, male rotating luer lock, slide clamp, OD 2.35mm
Needleless type, 3way, female luer lock, male rotating luer lock, slide clamp, OD 2.35mm

ET01
ET02
ET03
ET04
ET05
ET06
ET07
ET08
ET09
ET10



Safety blood collection needle

It is used for aspiration of blood, the safety mechanism help to eliminate accidental needle stick injuries.

- Type 1 Scalp vein set type.
- Type 2 Safety needle type.
- Type3 Pen type.

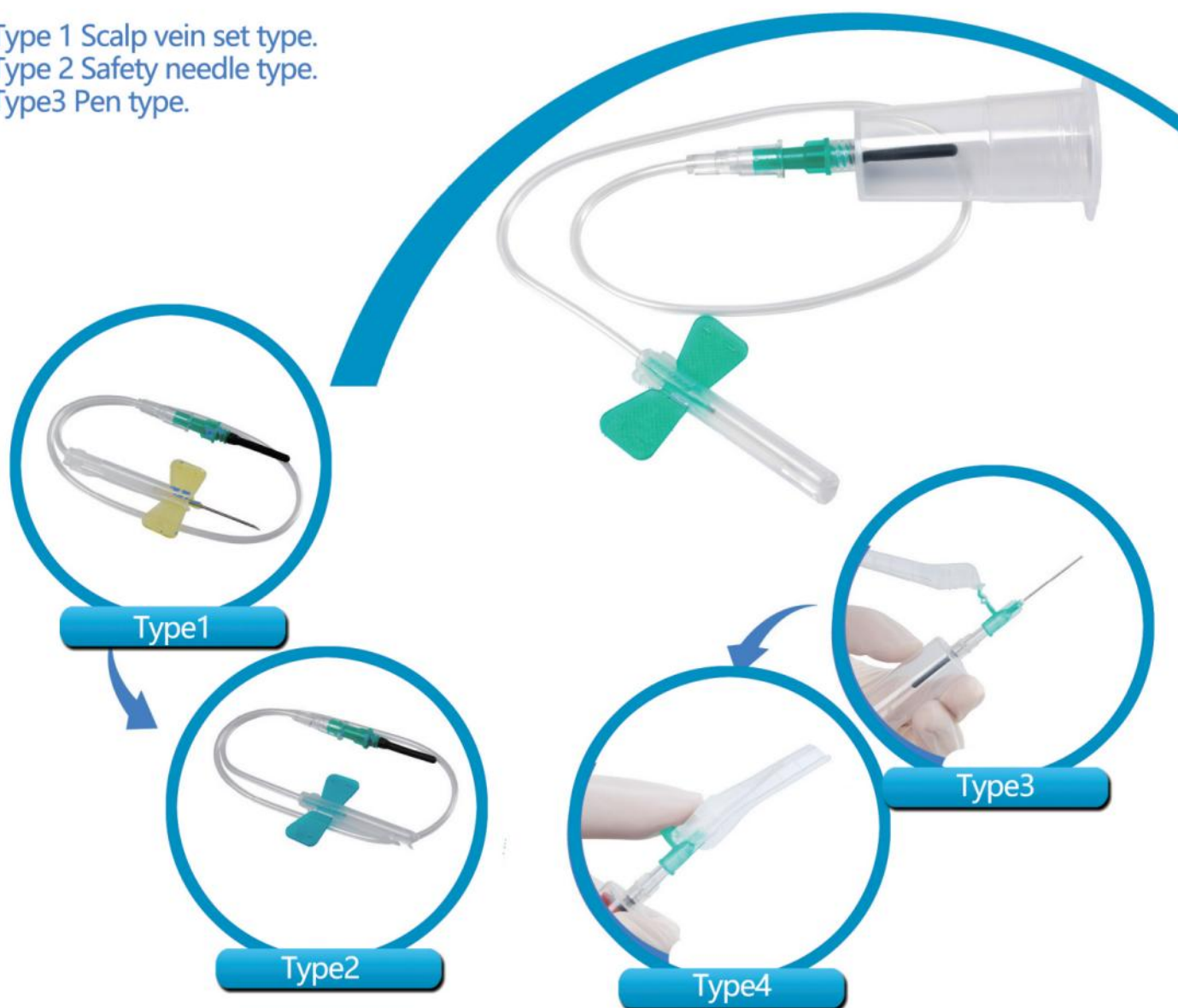

Size		Color	Code					
			Normal blood collection needle			Safety blood collection needle		
OD(mm)	Gauge	Color	Type1	Type2	Type3	Type1	Type2	Type3
0.40	27G	Grey	BCN27-1	BCN27-2	BCN27-3	SBCN27-1	SBCN27-2	SBCN27-3
0.45	26G	Brown	BCN26-1	BCN26-2	BCN26-3	SBCN26-1	SBCN26-2	SBCN26-3
0.50	25G	Orange	BCN25-1	BCN25-2	BCN25-3	SBCN25-1	SBCN25-2	SBCN25-3
0.55	24G	Purple	BCN24-1	BCN24-2	BCN24-3	SBCN24-1	SBCN24-2	SBCN24-3
0.60	23G	Blue	BCN23-1	BCN23-2	BCN23-3	SBCN23-1	SBCN23-2	SBCN23-3
0.70	22G	Black	BCN22-1	BCN22-2	BCN22-3	SBCN22-1	SBCN22-2	SBCN22-3
0.80	21G	Green	BCN21-1	BCN21-2	BCN21-3	SBCN21-1	SBCN21-2	SBCN21-3
0.90	20G	Yellow	BCN20-1	BCN20-2	BCN20-3	SBCN20-1	SBCN20-2	SBCN20-3
1.10	19G	Cream	BCN19-1	BCN19-2	BCN19-3	SBCN19-1	SBCN19-2	SBCN19-3
1.20	18G	Pink	BCN18-1	BCN18-2	BCN18-3	SBCN18-1	SBCN18-2	SBCN18-3

Remark: normal size in above table, we can also make special size as clients' request



Gravity blood administration sets

Filtration for various blood IV administration needs.

Features:

- Sharp spike is easy to puncture.
- Plastic spike/metal spike available.
- Vented with hydrophobic bacterial filter.
- The ISO standard spike can fit with any blood bags.
- Soft and transparent chamber.
- Extra soft & kink resistant tubes.
- Acute roller clamp.
- With 200 micron filtration.
- Latex free.
- Straight and Y type are available.
- DEHP free tube is available.



BTS001

Big chamber with air inlet



BTS002

Big chamber with air inlet



BTS003

Big chamber with air inlet



IV burette

Delivering solutions in IV therapy for improved patient care.



IVB150-2

Features:

- Soft and transparent chamber for easy to read graduated scale.
- Floating disk for easy fluid level indication and auto shut-off to resist the air bulb to the vein.
- Integral 15 micron air-guard filter to prevent air introduction.
- 60drops/ml.
- Gravity use.



IVB110-1



needle-free injection site



air cented spike

Description

Code

Soft chamber 100ml with air vent, latex tube, tube 1.5m, luer lock with needle.

IVB 100-1

Hard chamber 100ml with air vent, latex bulb, luer slip with needle

IVBH-100

Soft chamber 110ml, with air vent, with latex shut-off valve, Y injection port, tube 1.8m, luer lock with needle

IVB 110-1

Soft chamber 150ml with air vent, with latex shut-off valve, Diameter 5.6mm tube to comply with the infusion spike.

IVB150-1

Soft chamber 150ml with air vent, with latex free shut-off valve, needleless Y injection port, tube 2.2m, luer lock without needle.

IVB 150-2



Oral Syringe

With the further research on the structure and function of gastrointestinal tract, it has been gradually recognized that gastrointestinal tract is not only an organ of digestion and absorption, but also an important immune organ.

Enteral feeding refers to the delivery of a nutritionally complete feed, containing protein, carbohydrate, fat water, minerals and vitamins, can directly into the stomach, duodenum or jejunum.

Enteral nutrition is the nutritional support provided by the gastrointestinal tract to provide nutrients needed for metabolism and other nutrients. It depends on the length of time, mental state and gastrointestinal function.

There are three ways for enteral access:

- 1, Nasogastric feeding
- 2, Gastrostomy.
- 3, Jejunostomy.

We offer the various components for Enteral nutrition therapy.



Low dose

Features:

- The Enteral syringe tip is compliant to help reduce the risk of misconnections.
- Offer a full range and are the result of research aimed at creating a product with certified quality and safety features.
- DEHP Free.
- Latex free plungers, made of synthetic rubber which does not contain natural latex, in order to prevent any allergies.
- Low dose syringes have a male design feature within the female connector to prevent volume in the dead space.
- Tip caps available.



Spec.

Size

Code

Enfit and low dose	1ml	ES1
Enfit and low dose	3ml	ES3
Enfit and low dose	5ml	ES5
Enfit	10ml	ES10
Enfit	20ml	ES20
Enfit	30ml	ES30
Enfit	60ml	ES60
Bulb	60ml	BS60
Thumb control ring	60ml	TS60
Catheter tip	60ml	CT60



The connector

Features:

- The connector is compliant to help reduce the risk of misconnections.
- The connector make enteral feeding and medication administration easy, efficient and most importantly, comfortable for patients.
- Have a wide range of connector for enteral feeding which along with the syringes, complete a range of products which enable solutes and medication to be prepared and administered in complete safety.
- Customized different connectors according to requirements.



ENC1

ENC10



ENC2



ENC3



ENC4



ENC5



ENC6



ENC7

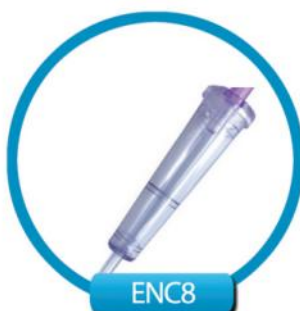

ENC8



ENC9



Drug preparation

Needle free system

Needle-free system offer a safe way to access IV lines without the use of a needle, which greatly reduces the risk of accidental needle stick injuries.



SafespikeF



Safespile

Safesite



Blunt needle with/without filter

Blunt needle is a sterile, single use device used for safety drug admixture.



Aspiration needle with safety shield



Blood collection needle

Blood collection system has advanced the science of specimen collection to help laboratory tests become the foundation for 70% of all medical decisions. Today the gold standard in sample collection is blood collection family, which most of the hospitals rely on to enhance their sample quality and protect their nurses, phlebotomists and other caregivers from costly accidental needle stick injuries. These products, backed by unrivaled customer support and training help hospitals every day enhance lab productivity and workflow by reducing retests, recollects and instrument downtime.

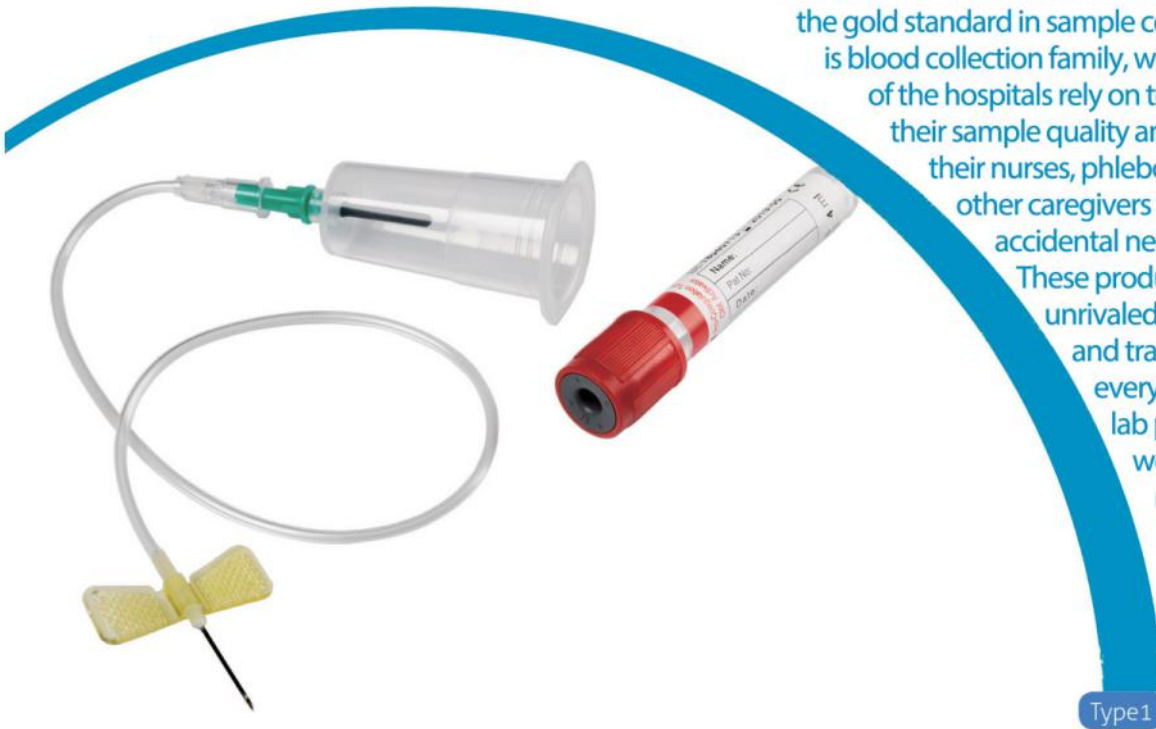

Type1

- Blood collection needle with scalp vein set, Latex free.
- Soft and transparent tube, can observe the vein blood flow clearly.
- Double wings make puncture more safe.
- Different color wings means different sizes.



Type2

- Pen type blood collection, latex free.
- Multi-sample needles permit several samples to be taken with a single puncture.
- Sharp 8 smooth edges make penetration painless, easy connection to rubber stoppers.



Type3

- Blood collection needle with hypodermic needle holder, latex free.



Hypodermic Needle



Dental needle



Code	Size	Length
DN25	25G	38/25/21mm
DN27	27G	38/25/21mm
DN30	30G	38/25/21/13mm

Irrigation needle

The migration needle are intended for irrigation purposes in dentistry and ophthalmology. or used for withdrawal of drugsolutions out ofvials



Code	Size and length	Color
IN 27	27Gx13.15mm	Grey
IN 25	2 SGX	Orange
IN 23	23G*13.15mm	Blue
IN 22	22Gx13. 15mm	Black
IN 21	21Gx13.1 5mm	Green
IN 20	20G*13.15mm	Yellow
IN 18	18Gx13. 1 5mm	Pink

Irrigation needle

Subdural, lower thorax and lumbar spinal puncture.

Features:

- Full sizes of anesthesia needles.
- Identified as spinal needle bevel quincke tip, pencil point tip and epidural needle.
- 304 stainless steel needle tubes and stylets.
- International colour coding.
- With mounted introducer needle.
- Luer lock hub.





Sharps disposal solutions

Ultimate sharps safety stations (needle counter)

It is used for needle or sutures counting in the operation room, dangerous sticks from uncounted needles. Can be safely avoided from the needle stick injury.



needle counter

Code	Counts	Spec.
NC10	10	Magnet/ foam block/
NC15	15	foam strips/adhesive
NC20	20	magnet strip/ clear lid
NC 30	30	are optional
NC40	40	
NC60	60	
NC80	80	
UNC20-1	20	Ultimate with safety
UNC20-2	20	needle, blade removal
UNC40-1	40	device, and safety
UNC40-2	40	lock device

Veterinary needle

Used for veterinary intradermal, subcutaneous, intramuscular and intra-articular injection, harvesting of biological material depending on chosen gauge.

Features:

- Luer fitting or record fitting are available.
- By copper base and strong enough.
- Full range for chosen.

Code	Size
VN14	14G
VN15	15G
VN16	16G
VN17	17G
VN18	18G
VN19	19G
VN20	20G
VN21	21G
VN22	22G
VN23	23G
VN24	24G
VN25	25G



Flow regulators



Irrigation syringe

Bulb syringe

Features:

- Flexible soft bulb promotes one handed administration.
- Designed to stand on the bulb end to help minimize contamination.
- Patient label provides convenient patient documentation.
- Sterile, Latex free, DEHP free, and BPA free.
- Includes syringe protector cap.

Thumb control ring syringe

Features:

- Thumb control ring top allows for maximum control and one handed administration.
- Precision crafted O-ring plunger ensures a positive seal
- Re-sealable pole bag designed for safe and convenient storage.
- Patient label provides convenient patient documentation.
- Sterile, Latex free, DEHP free, and BPA free.
- Includes syringe tip adapter and protector cap.

Flat top piston syringe

Features:

- Precision crafted O-ring plunger ensures a positive seal.
- Visible dosing marks designed for ease of use.
- Latex free, DEHP free, and BPA free.
- Includes syringe luer tip adapter and protector cap.

Size	Description	Code
60ml	Thumb control ring type	URTS60
60ml	Bulb type	URBS60
60ml	Flat top piston	URFS60
12ml	Curved tip	URCS12





IV cannula

Delivering solutions in IV therapy for a short term period.



Features:

- Color-coded casing cap allows for easier identification of catheter size.
- Translucent catheter hub and flashback chamber allows for easy detection of blood.
- Flash back at vein insertion.
- Teflon radio-opaque catheter.
- Precision finished pet or pu catheter assures stable flow and eliminates catheter tip kink.
- The sharp needle features a universal bevel geometry that llws a wider choice of isetion angles.
- Can be connected to syringe by removing filtercap to expose luer taper end.
- Use of hydrophobic membrane fiter eiminanen blood leakage.
- Close and smooth contact between catheter tip and inner needle enables safe and smooth.
- Vein puncture.

Features:



Code			Gauge	Size and length	Color
Pencil type	Wing type	Injection type			
IVCP14	IVCW14	IVCI14	14G	2"	Orange
IVCP16	IVCW16	IVCI16	16G	2", 2 1/2"	Grey
IVCP18	IVCW18	IVCI18	18G	1 1/4", 1 1/2", 2"	Green
IVCP20	IVCW20	IVCI20	20G	1 1/4", 2"	Pink
IVCP22	IVCW22	IVCI22	22G	1"	Blue
IVCP24	IVCW24	IVCI24	24G	3/4"	Yellow