



# Urimed® B'Bags

THE NEW AFFORDABLE URINE BAGS RANGE

Adult urine collection bags

# Urimed® B'Bags

B. Braun developed a specific range of urine bags with an affordable price.

With this new Urimed® B'Bags we provide a large portfolio of bags suitable for all types of use, both in hospitals and outside.

The range is made up of three types of bags, each with different configurations:

- Closed bags
- Drainable bags
- Leg bags



## Main features of the Urimed® B'Bags:

- Latex free material
- Graduated scale on all bags (approximate mL)
- Patient data to be filled in major languages
- A tube of 90 cm on 1,5L and 2L bags
- Universal connector

Look no further, you will find what you are looking for in the Urimed® B'Bags range!



# Closed bags

For urine collection and secretion

Large capacity: **2L** and **1,5L**

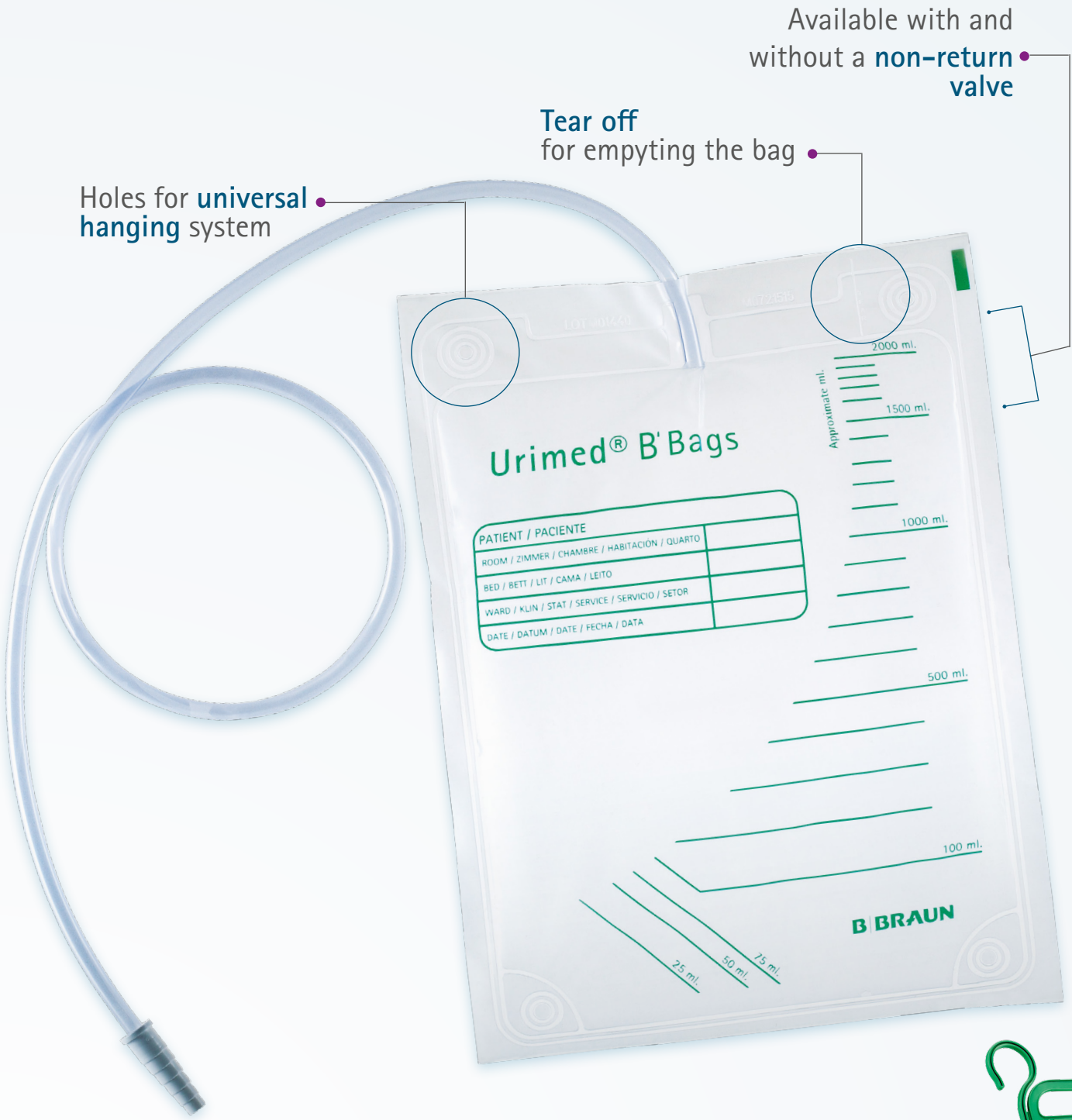

**Suspension accessory** available with the bags in some references

# Drainable bags

For urine collection

Large capacity: **2L** and **1,5L**

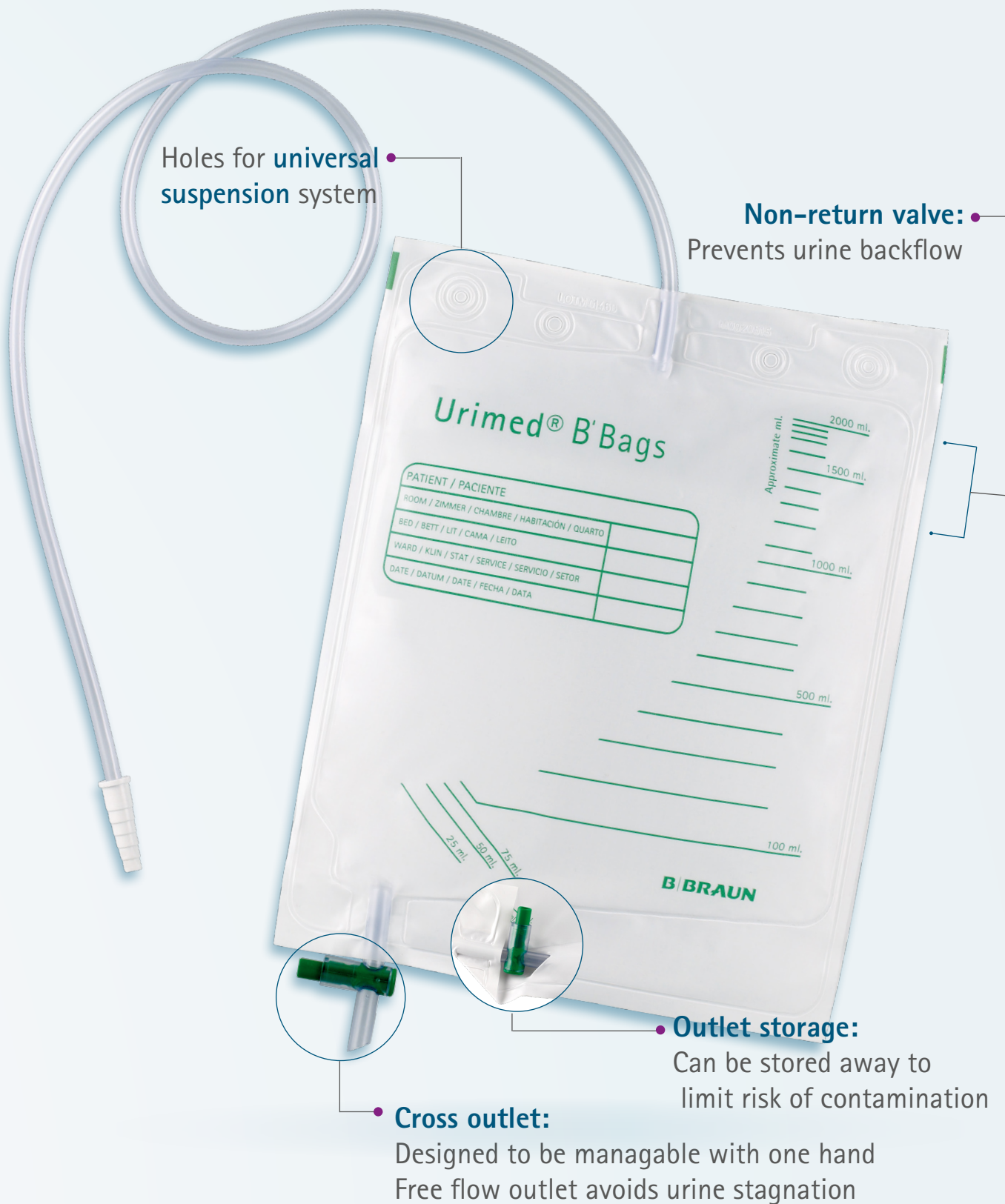

# Drainable leg bags

for urine collection

Slots for  
fixation straps



Non-return valve:  
Prevents urine backflow

Push / Pull tap outlet  
Designed to be discreet and simple.

## Closed bags

### For urine collection and secretion

|                  |           | Capacity | Tube length | Box                      | References |
|------------------|-----------|----------|-------------|--------------------------|------------|
| Sterile bags     | No NRV*   | 2L       | 90 cm       | 100                      | 29400      |
|                  |           | 1,5L     | 90 cm       | 100                      | 29420      |
| Non Sterile bags | No NRV*   | 2L       | 90 cm       | 250                      | 29415      |
|                  |           | 1,5L     | 90 cm       | 250                      | 29435      |
|                  | With NRV* | 2L       | 90 cm       | 250                      | 29410      |
|                  |           | 1,5L     | 90 cm       | 250                      | 29430      |
| Non Sterile bags | No NRV    | 2L       | 90 cm       | 30 + 1 hanging accessory | 29416      |
|                  | With NRV* | 2L       | 90 cm       | 30 + 1 hanging accessory | 29411      |

## Drainable bags

### For urine collection

|                  |           | Capacity | Tube length | Box                      | References |
|------------------|-----------|----------|-------------|--------------------------|------------|
| Sterile bags     | With NRV* | 2L       | 90 cm       | 100                      | 29440      |
| Non Sterile bags | With NRV* | 2L       | 90 cm       | 200                      | 29450      |
|                  |           | 1,5L     | 90 cm       | 200                      | 29455      |
| Non Sterile bags | With NRV* | 2L       | 90 cm       | 30 + 1 hanging accessory | 29451      |

## Drainable leg bags

### For urine collection

|                  |           | Capacity | Tube length | Box | References |
|------------------|-----------|----------|-------------|-----|------------|
| Non Sterile bags | With NRV* | 0,75L    | 12 cm       | 100 | 29510      |

\*NRV = Non-Return Valve

This document, its contents, including institutional data, information, trademarks and logos mentioned herein are the exclusive property of B. Braun. Any representation and / or reproduction, total or partial, of this document and its contents without the express prior consent of B. Braun, is strictly prohibited and constitutes an infringement of the intellectual property rights of B. Braun.  
Non binding documents and photographs.  
For healthcare professional use only.

#### Distributed by:

B. BRAUN MEDICAL | 26 rue Armengaud | 92210 Saint-Cloud - France  
Tél. 01 41 10 53 00 | Fax 01 41 10 53 99  
B. Braun Medical | SAS with a share capital of 31 000 000 € | RCS Nanterre 562050856  
www.bbraun.fr  
www.bbraun.com/continence-care-and-urology

#### Manufactured by :

TECNOCLINIC, S.A.  
Ctra. de Prats de Lluçanès, Km.2,300  
P.I. La Llanera  
08207 Sabadell (Barcelona) - Spain