



A 24.1-inch widescreen monitor with DICOM Part 14 calibration support, smooth color reproduction, and screen management for increased work efficiency.

- Optimal viewing of medical DICOM grayscale images
- Image accuracy and consistency over time with DICOM Part 14 calibration
- Low power consumption and long lifetime with LED backlight
- Increased work efficiency with widescreen
- Minimal color and contrast shift when viewed from an angle
- Consistent display with automatically stabilized brightness
- Stable images across the screen with brightness uniformity
- Smooth color gradation with over 1 billion colors displayed
- Ideal preset modes for CR, CT, MRI, and endoscope images
- Guaranteed usage time of 5 years or 15,000 hours at 180 cd/m²



RadiForce® MX242W

Make the Precise Diagnosis

EIZO carefully measures and sets each grayscale tone to create a monitor compliant with DICOM Part 14. This ensures the most consistent shading possible, allowing for the most accurate diagnosis.

Maintain the Precision

Perform a simplified calibration compliant with DICOM Part 14 using the bundled RadiCS LE quality control software. RadiCS LE corrects the brightness and grayscale tones of the monitor to maintain image accuracy and consistency over time.

Keep Your Monitor Lit Longer

The LED backlight offers a significantly longer service life over conventional CCFL backlights. In addition, you can maintain high brightness while simultaneously lowering power consumption. Since the LED backlight is mercury-free, it will also reduce any potential impact on the environment when disposed of.

View More with Widescreen

The widescreen 16:10 aspect ratio provides significantly more horizontal space than the aspect ratios of conventional square monitors so that you can keep tool palettes open without covering the window you are working on.

Comfortably View from Any Angle

The wide viewing angles of the IPS panel allow you to view the screen from the side with minimal color shift, also permitting more than one person to view the monitor comfortably at the same time.

View Accurate Images in Moments

The EIZO-patented drift correction function quickly stabilizes the brightness level of the monitor upon startup or wakeup from sleep mode, giving you the most accurate images quickly ready for viewing. In addition, a sensor measures the backlight brightness fluctuations caused by ambient temperature and aging for a consistently stable display.

Attain Steady Images Across the Screen

The Digital Uniformity Equalizer (DUE) function helps to even out fluctuations in brightness and chroma on different parts of the screen to provide smoother images.

Gain Smooth Color Reproduction

The monitor can support 10-bit input for each RGB color, displaying more than one billion colors simultaneously. This ensures accurate reproduction of color tones for 3D color rendering and image fusion.

Select the Ideal Mode for Modalities

The CAL Switch function allows you to choose various modes for different modalities such as CR, CT, MRI, and endoscopy and can be conveniently accessed using the monitor's front panel buttons.

Stay Confident with Stable Brightness

EIZO's confidence in its product quality extends to brightness stability. 5 years or 15,000 hours of usage time is guaranteed when used at the recommended brightness of 180 cd/m².

Specifications

Cabinet Color		Black
Panel	Type	Color TFT LCD Panel (IPS)
	Backlight	LED
	Size	61 cm / 24.1" (611 mm diagonal)
	Native Resolution	1920 x 1200 (16:10 aspect ratio)
	Viewable Image Size (H x V)	518.4 x 324.0 mm
	Pixel Pitch	0.270 x 0.270 mm
	Display Colors	10-bit colors (DisplayPort) : 1.07 billion (maximum) colors 8-bit colors: 16.77 million from a palette of 68 billion colors"
	Viewing Angles (H / V, typical)	178° / 178°
	Brightness (typical)	350 cd/m ²
	Contrast Ratio (typical)	1000:1
Response Time (typical)	12 ms (On/Off)	
Video Signals	Input Terminals	DVI-I x 1, DisplayPort x 1
	Digital Scanning Frequency (H / V)	31 - 76 kHz / 59 - 61 Hz
	Analog Scanning Frequency (H / V)	26 - 76 kHz / 49 - 71 Hz
	Sync Formats	Separate
USB	Function	1 upstream, 2 downstream
	Standard	Rev. 2.0
Power	Power Requirements	AC 100 - 240 V: 50 / 60 Hz
	Maximum Power Consumption	68 W
	Typical Power Consumption	31 W
	Power Save Mode	0.5 W or less
	Power Management	Digital: DVI DMPM, DisplayPort 1.1a Analog: VESA DPM
Sensor		Backlight Sensor
Features & Functions	Brightness Stabilization	Yes
	Digital Uniformity Equalizer	Yes
	Preset Modes	CAL Switch
	OSD Languages	English, German, French, Italian, Japanese, Simplified Chinese, Spanish, Swedish, Traditional Chinese
Physical Specifications	Net Weight	8.7 kg
	Net Weight (Without Stand)	6.0 kg
	Hole Spacing (VESA Standard)	100 x 100 mm
Certifications & Standards (Please contact the EIZO group company or distributor in your country for the latest information.)		CE (Medical Device Directive), EN60601-1, UL60601-1, CSA C22.2 No. 601-1, IEC60601-1, VCCI-B, FCC-B, Canadian ICES-003-B, RCM, RoHS, China RoHS, WEEE, CCC, GOST-R
FDA 510(k) Clearance		Yes (for General Radiography*)
Supplied Accessories		AC power cord, signal cable (DVI-D - DVI-D, DisplayPort - DisplayPort) , USB cable, Utility Disk (RadiCS LE, ScreenManager Pro for Medical, PDF instructions for use, PDF installation manual), instructions for use
Warranty		Five Years

*Display of mammography images for diagnosis is not supported.

Dimensions (Unit: mm)

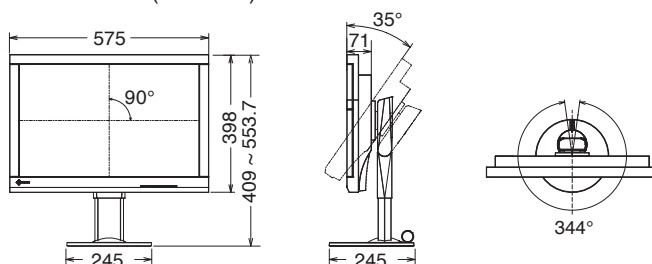

EIZO Corporation

153 Shimokashiwano, Hakusan, Ishikawa 924-8566 Japan

Phone +81-76-277-6792 Fax +81-76-277-6793

www.eizo.com

All product names are trademarks or registered trademarks of their respective companies. EIZO, RadiForce, RadiCS, and RadiNET are registered trademarks of EIZO Corporation. Specifications are subject to change without notice.

Copyright© 2018 EIZO Corporation. All rights reserved. (140907C)