

All materials specified in compliance with the requirements of the List of Prohibited Substances

**Note:**  
 the CAN cable should be routed properly through the compressor unit.  
 Drill holes through the inlet panel/cubicle & use cable glands  
 (e.g. 0698 5140 70 or 0698 5140 71).

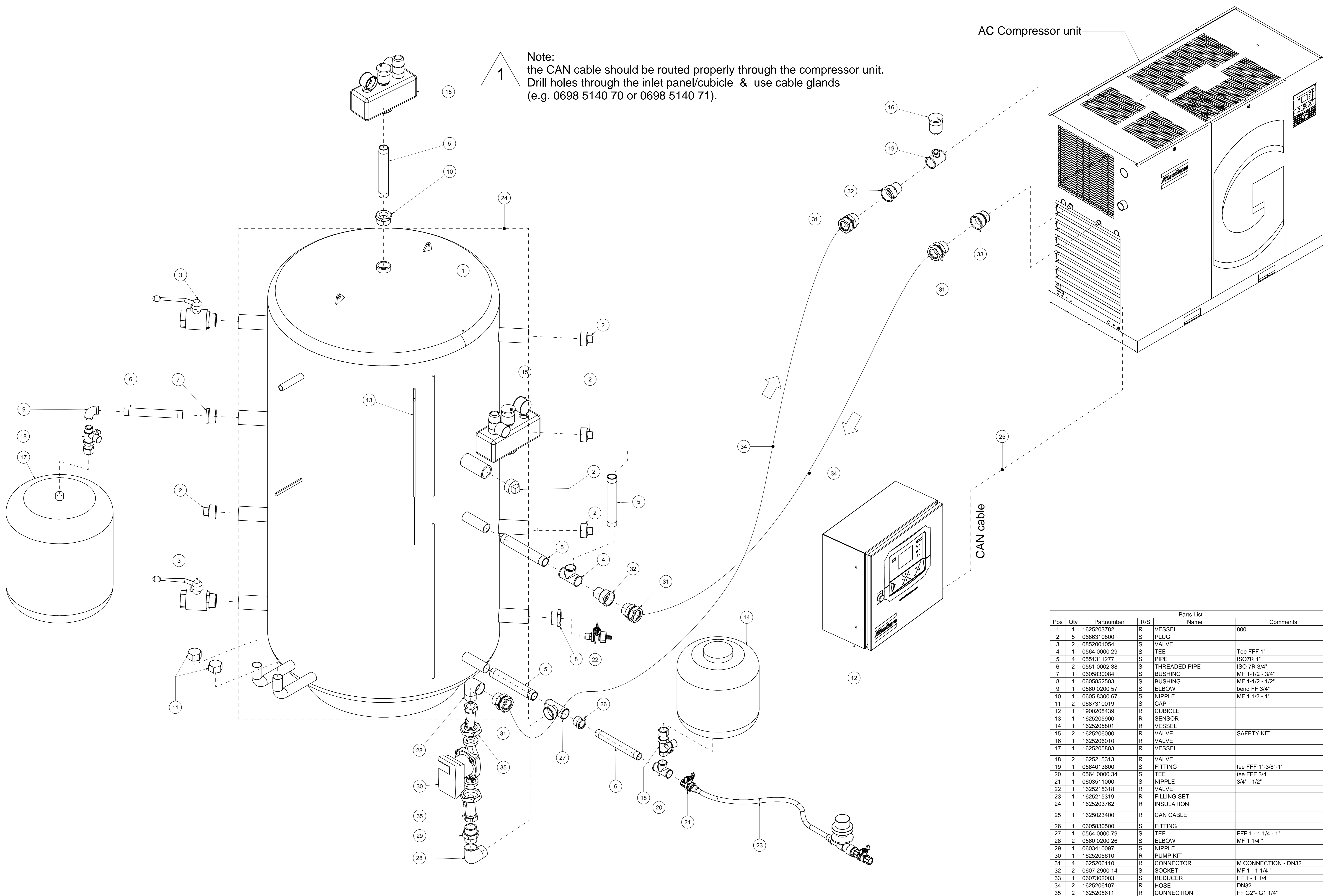

Pos	Qty	Partnumber	R/S	Name	Comments
1	1	1625203782	R	VESSEL	800L
2	5	0686310800	S	PLUG	
3	2	0852001054	S	VALVE	
4	1	0564 0000 29	S	TEE	Tee FFF 1"
5	4	0551311277	S	PIPE	ISO7R 1"
6	2	0551 0002 38	S	THREADED PIPE	ISO 7R 3/4"
7	1	0605830084	S	BUSHING	MF 1-1/2 - 3/4"
8	1	0605852503	S	BUSHING	MF 1-1/2 - 1/2"
9	1	0560 0200 57	S	ELBOW	bend FF 3/4"
10	1	0605 8300 67	S	NIPPLE	MF 1 1/2 - 1"
11	2	0687310019	S	CAP	
12	1	1900208439	R	CUBICLE	
13	1	1625205900	R	SENSOR	
14	1	1625205801	R	VESSEL	
15	2	1625206000	R	VALVE	SAFETY KIT
16	1	1625206010	R	VALVE	
17	1	1625205803	R	VESSEL	
18	2	1625215313	R	VALVE	
19	1	0564013600	S	FITTING	tee FFF 1"-3/8"-1"
20	1	0564 0000 34	S	TEE	tee FFF 3/4"
21	1	0603511000	S	NIPPLE	3/4" - 1/2"
22	1	1625215318	R	VALVE	
23	1	1625215319	R	FILLING SET	
24	1	1625203762	R	INSULATION	
25	1	1625023400	R	CAN CABLE	
26	1	0605830500	S	FITTING	
27	1	0564 0000 79	S	TEE	FFF 1 - 1 1/4 - 1"
28	2	0560 0200 26	S	ELBOW	MF 1 1/4 "
29	1	0603410097	S	NIPPLE	
30	1	1625205610	R	PUMP KIT	
31	4	1625206110	R	CONNECTOR	M CONNECTION - DN32
32	2	0607 2900 14	S	SOCKET	MF 1 - 1 1/4 "
33	1	0607302003	S	REDUCER	FF 1 - 1 1/4"
34	2	1625206107	R	HOSE	DN32
35	2	1625205611	R	CONNECTION	FF G2"- G1 1/4"

Tolerances, if not indicated, according to:  
 ATLAS COPCO STANDARD CLASS

Name: INSTR. ASSEMBLY HEATING KIT  
 Material: SEE DRAWING  
 Treatment: See Drawing

Scale: -  
 Drawn by: AIR15334  
 Blank nr.:  
 Date checked: 2014-09-25

Pos	note added	2015-01-05	Date	Int./Appd.
1				

CONFIDENTIAL