

SOFAR 15K~24KTLX-G3

15 / 17 / 20 / 22 / 24 kW

THREE-PHASE DUAL MPPT



Product advantages

- Maximum efficiency 98.6%
- Low start-up voltage, wide MPPT voltage
- Maximum DC input voltage 1100 V
- Smart string level monitoring
- Type II SPD for both DC and AC side
- Remote firmware upgrade
- 110% long-time overload ability



Datasheet	SOFAR 15KTLX-G3	SOFAR 17KTLX-G3	SOFAR 20KTLX-G3	SOFAR 22KTLX-G3	SOFAR 24KTLX-G3
Input (DC)					
Max. input voltage	1100V				
Rated input voltage	650V				
Start-up voltage	160V				
MPPT operating voltage range	140V-1000V				
Number of MPP trackers	2				
Number of DC inputs	2/2				
Max. input MPPT current	26A/26A	26A/26A	26A/26A	26A/26A	26A/26A
Max. input short circuit current	36A/36A	36A/36A	36A/36A	36A/36A	36A/36A
Output (AC)					
Rated output power	15000W	17000W	20000W	22000W	24000W
Max. apparent power	16500VA	18700VA	22000VA	24200VA	26400VA
Max. output current	23.9A	27.1A	31.9A	35.1A	38.3A
Rated output voltage	3/N/PE, 230V/400Vac				
Output voltage range	310Vac-480Vac				
Rated output frequency	50/60Hz				
Output frequency range	45Hz-55Hz/55Hz-65Hz				
Active power adjustable range	0-100%				
THDI	<3%				
Power factor	1 (adjustable +/-0.8)				
Efficiency					
Max. efficiency	98.6%	98.6%	98.6%	98.6%	98.6%
European efficiency	98.2%	98.2%	98.2%	98.2%	98.2%
Protection					
DC reverse polarity protection	Yes				
Anti-islanding protection	Yes				
Leakage current protection	Yes				
Ground fault monitoring	Yes				
PV-array string fault monitoring	Yes				
DC switch	Yes				
SPD	PV: type II, AC: type II				
General Data					
Ambient temperature range	-30 C--+60 C				
Self-consumption at night	<1W				
Topology	Transformerless				
Degree of protection	IP65				
Allowable relative humidity range	0-100%				
Max. operating altitude	4000m				
Cooling	Smart air cooling				
Dimension (W×H×D)	520×430×189mm				
Weight	20kg	22kg	22kg	23kg	23kg
Display	LCD & Bluetooth +APP				
Communication	RS485/WIFI				
Standard	IEC/EN 61000-6-1/3, IEC/EN 61000-3-11/12, IEC 62116, IEC 61727, IEC 61683, IEC 60068-1/2/14/30, IEC/EN 62109-1/2 G99, VDE-AR-N 4105, VDE V 0126-1-1, CEI0-21, EN 50549-1, NRS 097-2-1				

*All specifications are subject to change without notice.

03 / 2023—V2

Hi-MO 6

Explorer

LR5-72HTH 560~580M

- Suitable for Distribution Market
- Simple design embodies modern style
- Better energy generation performance
- High-quality module guarantees long-term reliability



15-year Warranty for
Materials and Processing



25-year Warranty for Extra
Linear Power Output

Complete System and Product Certifications

IEC 61215, IEC 61730, UL 61730

ISO9001:2015: ISO Quality Management System

ISO14001: 2015: ISO Environment Management System

ISO45001: 2018: Occupational Health and Safety

IEC62941: Guideline for module design qualification and type approval

LONGI



22.5%
MAX MODULE
EFFICIENCY

0~3%
POWER
TOLERANCE

<1.5%
FIRST YEAR
POWER DEGRADATION

0.40%
YEAR 2-25
POWER DEGRADATION

Additional Value

25-Year Power Warranty

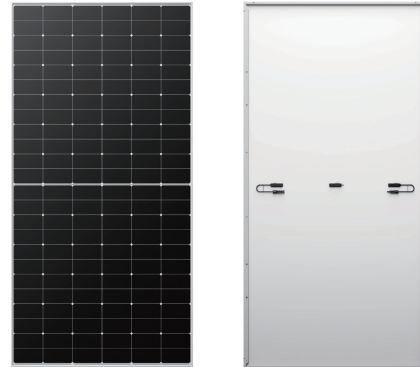
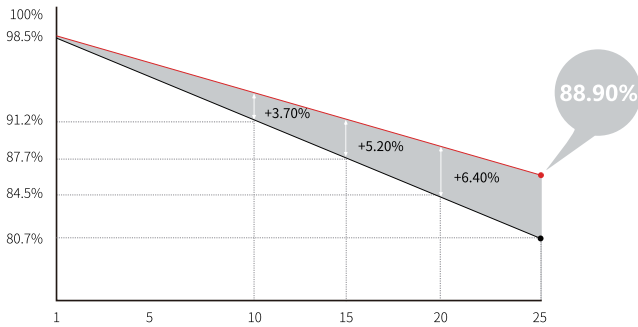

Mechanical Parameters

Cell Orientation	144 (6×24)
Junction Box	IP68, three diodes
Output Cable	4mm ² , +400, -200mm/±1400mm length can be customized
Glass	Single glass, 3.2mm coated tempered glass
Frame	Anodized aluminum alloy frame
Weight	27.5kg
Dimension	2278×1134×35mm
Packaging	31pcs per pallet / 155pcs per 20' GP / 620pcs per 40' HC

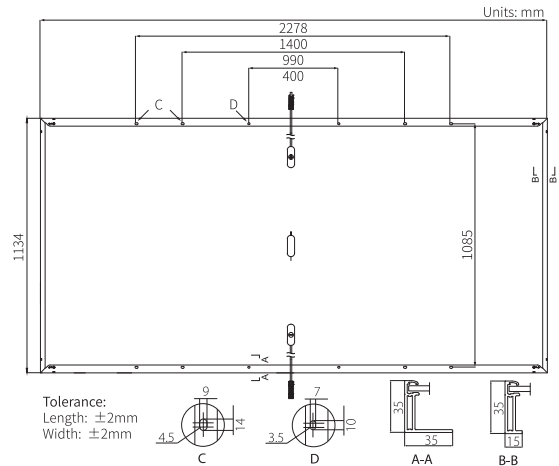

Electrical Characteristics

STC : AM1.5 1000W/m² 25°C

NOCT : AM1.5 800W/m² 20°C 1m/s

Test uncertainty for Pmax: ±3%

Module Type	LR5-72HTH-560M		LR5-72HTH-565M		LR5-72HTH-570M		LR5-72HTH-575M		LR5-72HTH-580M	
	STC	NOCT	STC	NOCT	STC	NOCT	STC	NOCT	STC	NOCT
Maximum Power (Pmax/W)	560	418	565	422	570	426	575	430	580	433
Open Circuit Voltage (Voc/V)	51.61	48.46	51.76	48.60	51.91	48.74	52.06	48.88	52.21	49.02
Short Circuit Current (Isc/A)	13.94	11.26	14.01	11.31	14.07	11.36	14.14	11.42	14.20	11.47
Voltage at Maximum Power (Vmp/V)	43.46	39.66	43.61	39.79	43.76	39.93	43.91	40.07	44.06	40.20
Current at Maximum Power (Imp/A)	12.89	10.55	12.96	10.61	13.03	10.67	13.10	10.72	13.17	10.78
Module Efficiency(%)	21.7		21.9		22.1		22.3		22.5	

Operating Parameters

Operational Temperature	-40°C ~ +85°C
Power Output Tolerance	0 ~ 3%
Voc and Isc Tolerance	±3%
Maximum System Voltage	DC1500V (IEC/UL)
Maximum Series Fuse Rating	25A
Nominal Operating Cell Temperature	45±2°C
Protection Class	Class II
Fire Rating	UL type 1 or 2 IEC Class C

Mechanical Loading

Front Side Maximum Static Loading	5400Pa
Rear Side Maximum Static Loading	2400Pa
Hailstone Test	25mm Hailstone at the speed of 23m/s

Temperature Ratings (STC)

Temperature Coefficient of Isc	+0.050%/°C
Temperature Coefficient of Voc	-0.230%/°C
Temperature Coefficient of Pmax	-0.290%/°C