



BPT 13A/G, Sterilmed, Turcia



BPT 13SG, Sterilmed, Turcia



Sechrist Water Trap, Sechrist, USA



Hepa filtru, Sterilmed, Turcia



Sechrist Mixer Filter Kit, Sechrist, USA

Pressure sensor 0-10 bar, Sterilmed, Turcia



Pressure sensor 0-4 bar, Sterilmed, Turcia



BSL STANDARD SINTERED BRONZE SILENCER

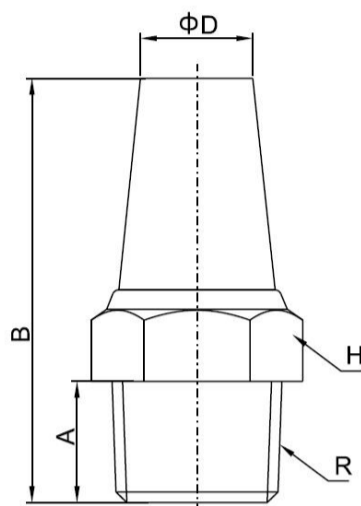

Body(noise absorbing material): Sintered bronze
Base(thread): Brass

Working Pressure: 0—1.0MPa | 0—150psi

Proof Pressure: 3.0Mpa | 435psi

Negative Pressure: -100Kpa | -29.5 In Hg

Working Temperature: -10~80°C | 14~176°F

PART NO.	Sound Pressure Level*	R	A(mm)	B(mm)	H(mm)
BSL 01	75	R1/8	5.8	23	12
BSL 02	80	R1/4	7	28	15
BSL 03	85	R3/8	9	36	18
BSL 04	90	R1/2	10	40	21
BSL 06	95	R3/4	10.5	48	27
BSL 08	100	R1	11.5	62	34
BSL 10	105	R1-1/4	18.5	83	46
BSL 12	105	R1-1/2	18.2	92	53
BSL 16	105	R2	19.5	108	64
BSL G01	75	G1/8	5.8	23	12
BSL G02	80	G1/4	7	28	15
BSL G03	85	G3/8	9	36	18
BSL G04	90	G1/2	10	40	21
BSL G06	95	G3/4	10.5	48	27
BSL G08	100	G1	11.5	62	34
BSL G10	105	G1-1/4	18.5	83	46
BSL G12	105	G1-1/2	18.2	92	53
BSL G16	105	G2	19.5	108	64
BSL U10	74	10-32UNF	4	19	8
BSL N01	75	1/8NPT	5.8	23	12
BSL N02	80	1/4NPT	7	28	15
BSL N03	85	3/8NPT	9	36	18
BSL N04	90	1/2NPT	10	40	21
BSL N06	95	3/4NPT	10.5	48	27
BSL N08	100	1NPT	11.5	62	34
BSL N10	105	1-1/4NPT	18.5	83	46
BSL N12	105	1-1/2NPT	18.2	92	53
BSL N16	105	2NPT	19.5	108	64
BSL M5 x 0.8	72	M5 x 0.8	4	19	8
BSL M6 x 1	72	M6 x 1	4.1	19	8
BSL M8 x 1	75	M8 x 1	5.8	23	12
BSL M8 x 1.25	75	M8 x 1.25	5.8	23	12
BSL M10 x 1	75	M10 x 1	5.8	23	12
BSL M10 x 1.25	75	M10 x 1.25	5.8	23	12
BSL M12 x 1.25	80	M12 x 1.25	7	28	15
BSL M14 x 1.5	80	M14 x 1.5	7	28	15
BSL M16 x 1.5	85	M16 x 1.5	9	36	18
BSL M20 x 1.5	90	M20 x 1.5	10	40	21

* Sound pressure level measured at 6 bar at 1 m distance.

** Information contained herein may be changed without prior notification.

PSE Porous Plastic Muffler

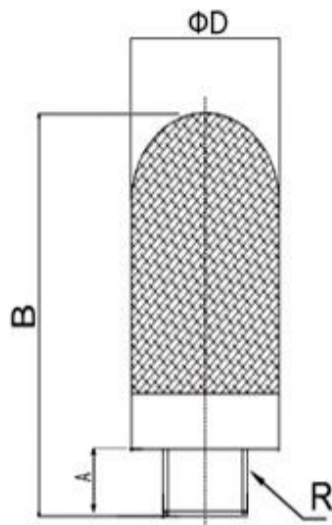

Body(noise absorbing material): Polyethylene
Base(thread): Polyethylene

Working Pressure: 0—1.0MPa | 0—150psi

Proof Pressure: 3.0Mpa | 435psi

Negative Pressure: -100Kpa | -29.5 In Hg

Working Temperature: -10°C~60°C | 14°F~140°F

PART NO.	Sound Pressure Level*	R	A(mm)	B(mm)	D(mm)
PSE M5	-	M5 x 0.8	6	32	7
PSE 01	78	R1/8	7	33	13
PSE 02	80	R1/4	8	41	17
PSE 03	85	R3/8	10	65	25
PSE 04	88	R1/2	13.5	74	25
PSE 06	90	R3/4	15	137	37
PSE 08	95	R1	18	155	48
PSE G01	78	G1/8	7	33	13
PSE G02	80	G1/4	8	41	17
PSE G03	85	G3/8	10	65	25
PSE G04	88	G1/2	13.5	74	25
PSE G06	90	G3/4	15	137	37
PSE G08	95	G1	18	155	48
PSE N01	78	1/8NPT	7	33	13
PSE N02	80	1/4NPT	8	41	17
PSE N03	85	3/8NPT	10	65	25
PSE N04	88	1/2NPT	13.5	74	25
PSE N06	90	3/4NPT	15	137	37
PSE N08	95	1NPT	18	155	48

* Sound pressure level measured at 6 bar at 1 m distance.

** Information contained herein may be changed without prior notification.

TRANSDUCER OPTIONS

Transducer name	Scan type	Freq. (MHz)	B-mode Freq. (MHz)			THI-mode Freq. (MHz)				D-THI Freq. (MHz)				2D mode			M mode	CDI mode
														Fund.	Pulse Subtract ON	Pulse Subtract OFF		
PST-25BT	Sector	2.5	4.2	3.0	1.8	4.0	3.0	2.0	-	-	-	-	○	○	○	○	○	
PST-30BT	Sector	3.0	4.8	3.4	2.0	4.4	3.6	2.8	-	-	-	-	○	○	○	○	○	
PST-50BT	Sector	5.0	6.0	4.2	3.0	6.2	5.4	4.4	-	-	-	-	○	○	○	○	○	
PVT-350BTP	Convex	3.5	6.0	4.0	1.9	6.0	5.0	4.0	3.0	-	5.0	-	○	○	○ ^{*3}	○	○	
PVT-375BT	Convex	3.5	6.0	4.0	1.9	6.0	5.0	4.0	3.0	-	5.0	-	○	○	○ ^{*3}	○	○	
PVT-375MV	Convex 4D	3.5	6.0	4.0	1.9	6.0	5.0	3.0	-	-	5.0	-	○	○	○ ^{*3}	○	○	
PVT-382BT	Convex	3.5	5.5	3.7	1.8	5.0	3.8	2.8	-	-	5.0	-	○	○	○ ^{*3}	○	○	
PVT-382MV	Convex 4D	3.5	5.5	3.7	1.8	5.0	3.8	2.8	-	-	5.0	-	○	○	○ ^{*3}	○	○	
PVT-661VT	Convex	6.0	8.8	7.3	4.7	8.0	7.2	6.0	-	-	7.0	6.0	○	○	○ ^{*3}	○	○	
PVT-674BT	Convex	6.0	9.2	6.0	3.6	8.0	7.0	6.0	-	8.0	6.0	5.0	○	○	○ ^{*3}	○	○	
PVT-675MV	Convex 4D	6.0	7.2	5.0	2.8	7.0	5.5	4.0	-	-	6.0	5.0	○	○	○ ^{*3}	○	○	
PVT-681MV	Convex 4D	6.0	8.8	7.3	4.7	8.0	7.2	6.0	-	-	7.0	6.0	○	○	○ ^{*3}	○	○	
PVT-712BT	Convex	7.0	10.2	7.5	4.2	10.0	8.0	6.0	-	11.0	9.0	8.0	○	○	○ ^{*3}	○	○	
PVT-745BTV	Convex	7.0	11.0	8.0	4.0	9.0	7.6	5.8	-	-	10.0	-	○	○	○ ^{*3}	○	○	
PLT-704SBT	Linear	7.5	11.0	8.6	4.8	8.4	7.2	6.2	-	-	9.0	8.0	○	○	○ ^{*3}	○	○	
PLT-805AT	Linear	8.0	12.0	10.0	6.2	9.0	7.6	6.6	-	-	9.0	8.0	○	○	○ ^{*3}	○	○	
PLT-1202S	Linear	12.0	14.0	12.0	7.0	14.0	12.0	8.0	-	-	-	-	○	○	x	○	○	
PLT-1204BT	Linear	12.0	14.0	12.0	7.2	14.0	12.0	8.0	-	18.0	14.0	13.0	○	○	○ ^{*3}	○	○	
PLT-1204MV	Linear	12.0	14.0	12.0	7.2	14.0	12.0	8.0	-	-	14.0	13.0	○	○	○ ^{*3}	○	○	
PET-510MA	Sector, TEE	5.0	6.5	5.0	3.0	6.6	5.6	4.4	-	-	-	-	○	○	○	○	○	
PET-510MB	Sector, TEE	5.0	6.5	5.0	3.0	6.6	5.6	4.4	-	-	-	-	○	○	○	○	○	
PET-511BTM	Sector, TEE	5.0	7.5	5.0	2.5	7.0	5.6	3.5	-	-	-	-	○	○	○	○	○	
PET-512MC	Sector, TEE	5.0	7.5	5.0	2.5	7.0	5.6	3.5	-	-	-	-	○	○	○	○	○	
PC-20M	Pencil	2.0	-	-	-	-	-	-	-	-	-	-	x	x	x	x	x	
PC-50M	Pencil	5.0	-	-	-	-	-	-	-	-	-	-	x	x	x	x	x	

*1 Optional software is required.

*2 Depends on the preset.

*3 Differential THI

*4 Not available in the USA.

Transducer name	POWER ANGIO mode	ADF mode	TDI mode	Elasto-graphy mode*1	PW mode	CW mode	CHI mode*1				ApliPure	Precision Imaging*1	Remarks
							2D	ADF	MFI	VRI			
PST-25BT	O/x ²	O/x ²	O	x	O	O	O	x	O	x	x	x	
PST-30BT	O/x ²	O/x ²	O	x	O	O	O	x	O	x	x	x	
PST-50BT	x	x	O	x	O	O	x	x	x	x	x	x	
PVT-350BTP	O	O	x	x	O	x	O ⁴	O ⁴	O ⁴	O ⁴	O	O	
PVT-375BT	O	O	O	x	O	x	O ⁴	O ⁴	O ⁴	O ⁴	O	O	
PVT-375MV	O	O	x	x	O	x	O ⁴	O ⁴	O ⁴	O ⁴	O	O	
PVT-382BT	O	O	x	x	O	x	O ⁴	O ⁴	O ⁴	O ⁴	O	O	
PVT-382MV	O	O	x	x	O	x	O ⁴	O ⁴	O ⁴	O ⁴	O	O	
PVT-661VT	O	O	O	x	O	x	O ⁴	O ⁴	O ⁴	O ⁴	O	O	
PVT-674BT	O	O	x	x	O	x	O ⁴	x	O ⁴	x	O	O	
PVT-675MV	O	O	x	x	O	x	x	x	x	x	O	O	
PVT-681MV	O	O	O	x	O	x	O ⁴	x	O ⁴	x	O	O	
PVT-712BT	O	O	x	x	O	x	x	x	x	x	O	O	
PVT-745BTV	O	O	x	x	O	x	x	x	x	x	O	O	
PLT-704SBT	O	O	x	x	O	x	O ⁴	O ⁴	O ⁴	x	O	O	
PLT-805AT	O	O	O	O	O	x	O ⁴	O ⁴	O ⁴	O ⁴	O	O	
PLT-1202S	O	O	O	O	O	x	O ⁴	x	O ⁴	x	O	O	
PLT-1204BT	O	O	O	O	O	x	O ⁴	x	O ⁴	x	O	O	
PLT-1204MV	O	O	x	x	O	x	O ⁴	x	O ⁴	x	O	O	
PET-510MA	x	x	O	x	O	O	x	x	x	x	x	x	
PET-510MB	x	x	O	x	O	O	x	x	x	x	x	x	
PET-511BTM	x	x	O	x	O	O	x	x	x	x	x	x	
PET-512MC	x	x	O	x	O	O	x	x	x	x	x	x	
PC-20M	x	x	x	x	x	O	x	x	x	x	x	x	
PC-50M	x	x	x	x	x	O	x	x	x	x	x	x	

O: Available
x: Not available

Respiratory Humidifier

VH-3000



Features

The product is able to control the temperatures of humidification chamber outlet and inhalation other than humidifying respiratory gas. That does not only reduce the humidity loss in breathing circuit during ventilation, but also prevent clog because of excessive water condensation. Therefore, this improves the humidification therapy and comfort of patients.

► Optional Accessories Please Refer to P.6, P.7, P.11

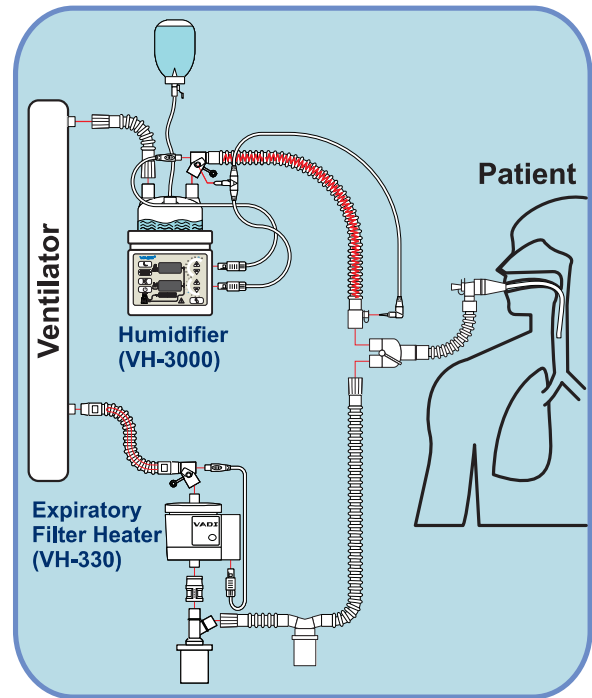
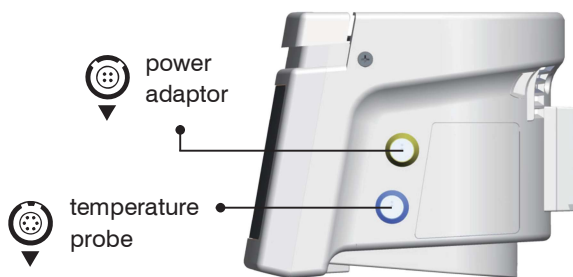

Part Number	Electrical Specification	Product Specification
800-VH3000-110	Input Voltage: 100~120 Vac Frequency: 50 / 60 Hz Max. Power: 350 VA Power Supply: 150 W Heated Wire Max. Power: 120 W	<u>Basic Specification</u> Dimension: 16 cm X 14.5 cm X 13.5 cm Weight: 1.48 kg <u>Performance Specification</u> Mode: (1) Standby (2) Heated Wire (3) Non-heated Wire
800-VH3000-220	Input Voltage: 200~240 Vac Frequency: 50/60 Hz Max. Power: 350 VA Power Supply: 150 W Heated Wire Max. Power: 120 W	Gas Flow: 2~60 LPM <u>Operation Environment</u> Temperature: 18~26°C Pressure: 700~1060 hPa

	Option				
	EU	US	Aus	UK	CN
Plug type:					