

Inspiring for Splendid Healthcare

ISO | ISO | CE
9001:2015 | 13485:2016

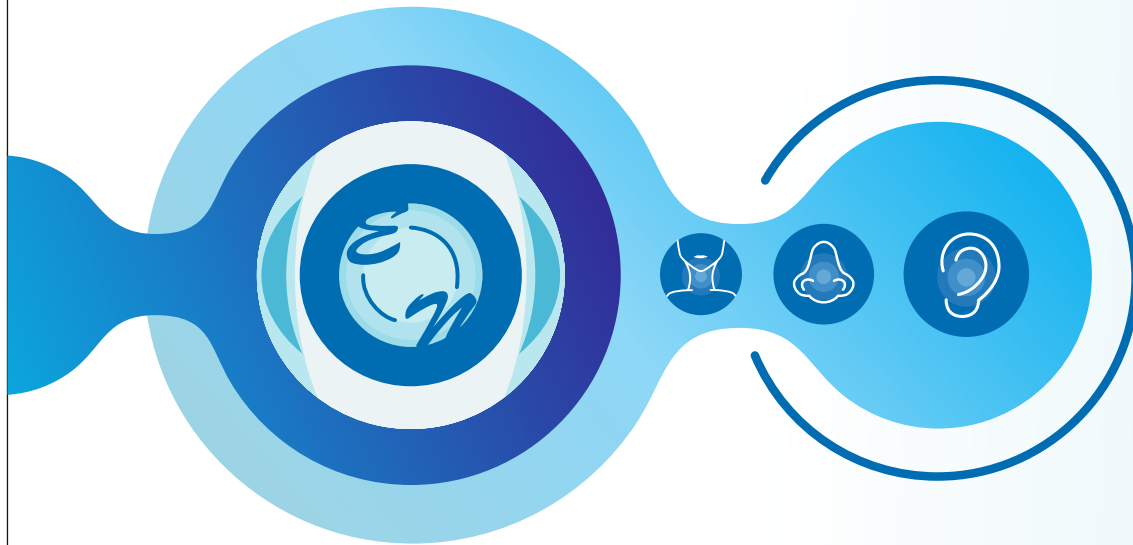

OSSEOUS PRODUCT CATALOG

- OTOLOGICAL MIDDLE EAR PROSTHESIS
- OTOLOGICAL VENTILATION TUBES
- RHINOLOGY PRODUCTS
- MEDICAL PVA DRESSINGS
- LARYNGOLOGY PRODUCTS
- ENT INSTRUMENTS
- ENT PLASMA SYSTEM - Coaglator II
- ABSORBABLE GELATIN SPONGES



**Tita-Prosthesis type partial
Vario Campana (PORP)**

Material : CP Titanium Medical Grade ASTM F 67

REF Number	Shaft Diameter	Disk Diameter	Functional Length	Total Length	Units/Box
E1101	0.30	3.00	5.00-1.75	5.00	1 Unit, Gamma Sterile

Material : CP Titanium Medical Grade ASTM F 67

REF Number	Shaft Diameter	Disk Diameter	Functional Length	Total Length	Units/Box
E1102	0.30	3.00	7.00-3.00	7.00	1 Unit, Gamma Sterile



**Tita-Prosthesis type
Total Vario Cask (TORP)**



**Titanium Universal
Middle Ear Prosthesis**

Material : CP Titanium Medical Grade ASTM F 67 & Fluoroplastic (PTFE)

REF Number	Shaft Diameter	Disk Diameter	Connector Diameter	Total Length	Units/Box
E1138	0.30	3.00	1.00	7.40	1 Unit, Gamma Sterile

Material : CP Titanium Medical Grade ASTM F 67 & HAp

REF Number	Description	Units/Box
E1207	TitaHAp prosthesis type Vario Partial (PORP)	1 Unit, Gamma Sterile
E1208	TitaHAp prosthesis type Vario Total (TORP)	1 Unit, Gamma Sterile



**TitaHAp prosthesis type
PORP & TORP**

All dimensions are in MM



Material : Fluoroplastic (PTFE)

REF Number	Shaft Diameter OD/ID	Disk Diameter	Functional Length	Total Length	Units/Box
E2133	1.8/1.20	3.00	5.00-2.00	5.00	1 Unit, ETO Sterile

Material : Fluoroplastic (PTFE)

REF Number	Shaft Diameter	Disk Diameter	Functional Length	Total Length	Units/Box
E2134	0.8	3.00	7.00-3.00	7.00	1 Unit, ETO Sterile



Material : Fluoroplastic (PTFE)

REF Number	Shaft Diameter OD/ID	Functional Length	Total Length	Units/Box
E2141	1.8/1.20	5.00-2.00	5.00	1 Unit, ETO Sterile

Material : Fluoroplastic (PTFE)

REF Number	Shaft Diameter	Functional Length	Total Length	Units/Box
E2142	0.80	7.00-3.00	7.00	1 Unit, ETO Sterile





Material : Fluoroplastic (PTFE)
 In case of TORP-Shaft OD 0.8mm | In case of PORP-Shaft ID 1.20mm

REF Number	Description	Units/Box
E2139	Fluoroplastic Universal Middle Ear Prosthesis - Offset L (Functional Length) 7.00 to 2.00	1 Unit, ETO Sterile
E2140	Fluoroplastic Universal Middle Ear Prosthesis - Centered L (Functional Length) 7.00 to 2.00	1 Unit, ETO Sterile

Material : CP Titanium Medical Grade ASTM F 67 & Fluoroplastic (PTFE)

REF Number	Description	Shaft Diameter	Units/Box
E1103	Tita-prosthesis Piston type Loop L (Functional Length) 7.00 to 3.50	0.50	1 Unit, Gamma Sterile
E4119	Tita-PTFE Vario Piston type Loop L (Functional Length) 7.00 to 4.00	0.50	1 Unit, Gamma Sterile

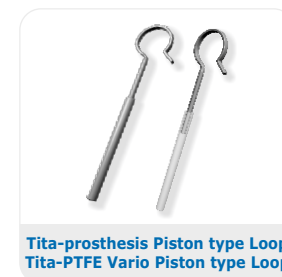

Material : CP Titanium Medical Grade ASTM F 67 & Fluoroplastic (PTFE)

REF Number	Description	Shaft Diameter	Units/Box
E9131	Super Titanium Vario Piston type Loop L (Functional Length) 7.00 to 3.50	0.50	1 Unit, Gamma Sterile
E9132	Super Tita-PTFE Vario Piston type Loop L (Functional Length) 7.00 to 4.00	0.50	1 Unit, Gamma Sterile

Material : NiTiNOL & Fluoroplastic (PTFE)

Shaft Diameter : 0.40mm

REF Number	Description	Units/Box
E5120	Super Elastic NiTiNOL Vario Piston type Loop L (Functional Length) 7.00 to 3.50	1 Unit, Gamma Sterile
E8130	Super Elastic NiTiNOL-PTFE Vario Piston type Loop L (Functional Length) 7.00 to 4.00	1 Unit, Gamma Sterile



All dimensions are in MM

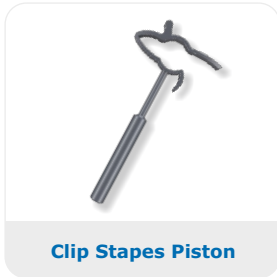

Material : CP Titanium Medical Grade ASTM F 67

REF Number	Description	Shaft Diameter	Units/Box
E1121	Clip Stapes Piston- Titanium L (Functional Length) 7.00 to 3.50	0.40	1 Unit, Gamma Sterile

Material : CP Titanium Medical Grade ASTM F 67 & Fluoroplastic

REF Number	Functional Length	Total Length	Units/Box
E1122	7.00 to 3.50	7.00	1 Unit, Gamma Sterile



Material : Fluoroplastic



REF Number	Shaft Diameter	Loop Inner Diameter	Functional Length	Total Length	Units/Box
E2127	0.5	0.60	6.00-3.50	6.00	1 Unit, ETO Sterile
E2128	0.4	0.60	6.00-3.50	6.00	1 Unit, ETO Sterile
E2129	0.6	0.60	6.00-3.50	6.00	1 Unit, ETO Sterile



**Tita-prosthesis Vent
Tube type collar Button**

Material: CP Titanium Medical Grade ASTM F 67

REF Number	Inner Diameter	Inner Flange Diameter	Outer Flange Diameter	Total Length	Units/Box
E1104	1.40	2.55	2.55	1.20	10 Units, Gamma Sterile
E1105	1.30	2.55	2.55	1.20	10 Units, Gamma Sterile
E1106	1.50	2.75	2.75	1.20	10 Units, Gamma Sterile

Material: CP Titanium Medical Grade ASTM F 67

REF Number	Inner Diameter	Inner Flange Diameter	Outer Flange Diameter	Total Length	Units/Box
E1151	1.14	2.40	2.40	2.20	10 Units, Gamma Sterile



Shepard-Titanium

Material : Fluoroplastic (PTFE)



**Armstrong, Armstrong Blue,
Armstrong with Tail**

REF Number	Inner Diameter	Inner Flange Diameter	Outer Flange Diameter	Total Length	Units/Box
E2109	1.14	3.54	2.40	3.85	10 Units, ETO Sterile
E2109B	1.14	3.54	2.40	3.85	10 Units, ETO Sterile
E2109T	1.14	3.54	2.40	3.85	10 Units, ETO Sterile

Material : Fluoroplastic (PTFE)

REF Number	Inner Diameter	Inner Flange Diameter	Outer Flange Diameter	Total Length	Units/Box
E2110	1.14	3.46	2.50	3.04	10 Units, ETO Sterile
E2110B	1.14	3.46	2.50	3.04	10 Units, ETO Sterile
E2110T	1.14	3.46	2.50	3.04	10 Units, ETO Sterile



**Modified Armstrong, Modified
Armstrong Blue,
Modified Armstrong with Tail**

Material : Fluoroplastic (PTFE)



Shepard & Mini Shepard

REF Number	Inner Diameter	Inner Flange Diameter	Outer Flange Diameter	Total Length	Units/Box
E2114	1.14	2.4	2.4	2.2	10 Units, ETO Sterile
E2114B	1.14	2.4	2.4	2.2	10 Units, ETO Sterile
E2114T	1.14	2.4	2.4	2.2	10 Units, ETO Sterile
E2114W	1.14	2.4	2.4	2.2	10 Units, ETO Sterile
E2114BW	1.14	2.4	2.4	2.2	10 Units, ETO Sterile
E2114BT	1.14	2.4	2.4	2.2	10 Units, ETO Sterile
E2138	1.00	2.4	2.4	2.2	10 Units, ETO Sterile
E2138W	1.00	2.4	2.4	2.2	10 Units, ETO Sterile
E2138T	1.00	2.4	2.4	2.2	10 Units, ETO Sterile
E2138B	1.00	2.4	2.4	2.2	10 Units, ETO Sterile
E2138BW	1.00	2.4	2.4	2.2	10 Units, ETO Sterile
E2138BT	1.00	2.4	2.4	2.2	10 Units, ETO Sterile

Material : Fluoroplastic (PTFE)

REF Number	Inner Diameter	Inner Flange Diameter	Outer Flange Diameter	Total Length	Units/Box
E2137	1.14	2.3	2.3	1.6	10 Units, ETO Sterile
E2137B	1.14	2.3	2.3	1.6	10 Units, ETO Sterile



Reuter Bobbin, Reuter Bobbin Blue

Material : Fluoroplastic (PTFE)

REF Number	Inner Diameter	Inner Flange Diameter	Outer Flange Diameter	Total Length	Units/Box
E2136	1.27	2.8	2.8	2.2	10 Units, ETO Sterile
E2136B	1.27	2.8	2.8	2.2	10 Units, ETO Sterile



Baxter Beveled Bobbin, Baxter Beveled Bobbin Blue

B - Blue, T - Tail, W - Wire, All dimensions are in MM

Material : Fluoroplastic (PTFE)

REF Number	Inner Diameter	Inner Flange Diameter	Outer Flange Diameter	Total Length	Units/Box
E2112	1.14	3.4	2.3	2.4	10 Units, ETO Sterile
E2112B	1.14	3.4	2.3	2.4	10 Units, ETO Sterile
E2112T	1.14	3.4	2.3	2.4	10 Units, ETO Sterile
E2112W	1.14	3.4	2.3	2.4	10 Units, ETO Sterile
E2112BW	1.14	3.4	2.3	2.4	10 Units, ETO Sterile
E2112BT	1.14	3.4	2.3	2.4	10 Units, ETO Sterile
E2113	0.76	2.2	1.5	1.5	10 Units, ETO Sterile
E2113B	0.76	2.2	1.5	1.5	10 Units, ETO Sterile
E2113T	0.76	2.2	1.5	1.5	10 Units, ETO Sterile
E2113W	0.76	2.2	1.5	1.5	10 Units, ETO Sterile



Material : Fluoroplastic (PTFE)

REF Number	Inner Diameter	Inner Flange Diameter	Outer Flange Diameter	Total Length	Units/Box
E2124	1.14	2.3	2.3	2.2	10 Units, ETO Sterile
E2124B	1.14	2.3	2.3	2.2	10 Units, ETO Sterile

Material : Fluoroplastic (PTFE)

REF Number	Inner Diameter	Inner Flange Diameter	Outer Flange Diameter	Total Length	Units/Box
E2117	1.14	2.8	2.8	1.7	10 Units, ETO Sterile
E2117B	1.14	2.8	2.8	1.7	10 Units, ETO Sterile



Material : Fluoroplastic (PTFE)

REF Number	Inner Diameter	Inner Flange Diameter	Outer Flange Diameter	Total Length	Units/Box
E2116	1.14	2.7	1.54	7.25	10 Units, ETO Sterile

B - Blue, T - Tail, W - Wire, All dimensions are in MM

Material : Fluoroplastic (PTFE)

REF Number	Inner Diameter	Inner Flange Diameter	Outer Flange Diameter	Total Length	Units/Box
E2123	1.27	3.0	3.0	2.15	10 Units, ETO Sterile
E2123B	1.27	3.0	3.0	2.15	10 Units, ETO Sterile
E2123T	1.27	3.0	3.0	2.15	10 Units, ETO Sterile
E2125	1.14	2.50	2.50	2.0	10 Units, ETO Sterile
E2125B	1.14	2.50	2.50	2.0	10 Units, ETO Sterile
E2125T	1.14	2.50	2.50	2.0	10 Units, ETO Sterile



Material : Medical Grade Silicone

REF Number	Inner Diameter	Inner Flange Diameter	Outer Flange Diameter	Total Length	Units/Box
E3111	1.10	2.3	2.3	2.2	10 Units, ETO Sterile

Material : Medical Grade Silicone

REF Number	Inner Diameter	Inner Flange Diameter	Outer Flange Diameter	Total Length	Units/Box
E3126	1.10	3.5	2.5	1.65	10 Units, ETO Sterile



Material : Medical Grade Silicone

REF Number	Inner Diameter	Inner Flange Diameter	Total Length	Units/Box
E3115S	1.14	8.0	6.0	10 Units, ETO Sterile
E3115M	1.14	8.0	9.0	10 Units, ETO Sterile
E3115L	1.14	8.0	12.0	10 Units, ETO Sterile

Material : Silver Plated Gold

REF Number	Inner Diameter	Inner Flange Diameter	Outer Flange Diameter	Total Length	Units/Box
E1170	1.25	2.55	2.55	1.20	10 Units, Gamma Sterile



B - Blue, T - Tail, W - Wire, All dimensions are in MM



Material: Medical Grade Silicone

REF Number	Descriptions	Size(cm)	Units/Box
E3145S	Nasal Septal Button - Standard	3.0	1 Unit, ETO Sterile
E3145L	Nasal Septal Button - Large	5.0	1 Unit, ETO Sterile
E3145E	Nasal Septal Button - Elliptical	3.0	1 Unit, ETO Sterile
E3145EL	Nasal Septal Button - Elliptical Large	5.0	1 Unit, ETO Sterile

Material: Medical Grade Silicone

REF Number	Descriptions	Units/Box
E3147S	Internal Nasal Airway Splint - Standard	10 Pairs, ETO Sterile
E3147L	Internal Nasal Airway Splint - Large	10 Pairs, ETO Sterile
E3147P	Internal Nasal Pre-cut Splint	10 Pairs, ETO Sterile



Material: Medical Grade Silicone

REF Number	Size (mm)	Thickness (mm)	Units/Box
E3146S	55x75	3.00	10 Units, ETO Sterile
E3146T	55x75	5.00	10 Units, ETO Sterile
E3146NS	55x75	1.00	10 Units, ETO Sterile
E3146MS	55x75	0.50	10 Units, ETO Sterile
E3146US	55x75	0.25	10 Units, ETO Sterile
E3146UUS	38x50	0.13	10 Units, ETO Sterile



Material: Medical Grade Silicone & Fluoroplastic

REF Number	Descriptions	Thickness (mm)	Units/Box
E3148SS	Silicone-standard	0.50	10 Pairs, ETO Sterile
E3148ST	Silicone-Thick	1.00	10 Pairs, ETO Sterile
E3148FS	Fluoroplastic-Standard	0.50	10 Pairs, ETO Sterile
E3148FT	Fluoroplastic-Thin	0.25	10 Pairs, ETO Sterile
E3148FSP	Pediatric-Standard	0.50	10 Pairs, ETO Sterile
E3148FTP	Pediatric-Thin	0.25	10 Pairs, ETO Sterile

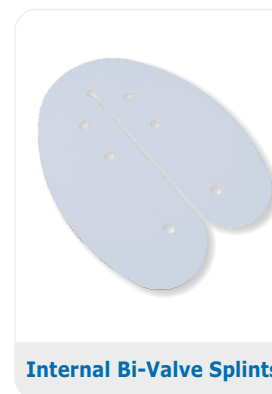

Material: Medical Grade Silicone

REF Number	Size (mm)	Thickness (mm)	Units/Box
E3146BS	50x30	10.00	1 Unit, ETO Sterile
E3146BM	60x40	15.00	1 Unit, ETO Sterile
E3146BL	70x50	20.00	1 Unit, ETO Sterile

REF Number	Descriptions	Units/Box
E5150S	External Thermoplastic Splint Small	10 or 25 Units, ETO Sterile / Non Sterile
E5150M	External Thermoplastic Splint Medium	10 or 25 Units, ETO Sterile / Non Sterile
E5150L	External Thermoplastic Splint Large	10 or 25 Units, ETO Sterile / Non Sterile





REF Number	Descriptions	Units/Box
E6149S	External Aluminium Splints Small	10 or 25 Units, ETO Sterile / Non Sterile
E6149M	External Aluminium Splints Medium	10 or 25 Units, ETO Sterile / Non Sterile
E6149L	External Aluminium Splints Large	10 or 25 Units, ETO Sterile / Non Sterile



Material: Medical Grade Silicone

REF Number	Product Name	Specification	Units/Box
E31030	Epistaxis Balloon Catheter Intra-Pack	30 CC / ml	10 Units, ETO Sterile
E31010	Epistaxis Balloon Catheter Post-Pack	10 CC / ml	10 Units, ETO Sterile
E31031	Epistaxis Balloon Catheter Double Balloon	30/10 CC / ml	10 Units, ETO Sterile

Aluminium Splint Kit **E6149K**

Aluminium Splint (Standard) Or	1 unit
Aluminium Splint (Medium) Or	1 unit
Aluminium Splint (Large)	1 unit
Alcohol Swab	1 unit
Skin Preparation Swab	1 unit
Skin Closure tape	1 unit
Dorsum Pad	1 unit



Aluminium Splint Kit



Thermoplastic Splint Kit

Thermoplastic Splint Kit **E5150K**

Thermoplastic Splint (Standard) Or	1 unit
Thermoplastic Splint (Medium) Or	1 unit
Thermoplastic Splint (Large)	1 unit
Alcohol Swab	1 unit
Skin Preparation Swab	1 unit
Skin Closure tape	1 unit
Dorsum Pad	1 unit

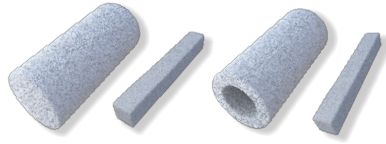

Ear Wicks

REF Number	Product Name	Specification	Product Description	Units/Box
E7161	Ear Wick	Dia.9.0mmX15.0mm	No String	20 Units, Gamma Sterile
E7162	Ear Wick	Dia.9.0mmX24.0mm	No String	20 Units, Gamma Sterile
E7163	Ear Pack	Dia.12.0mmX15.0mm	No String	20 Units, Gamma Sterile
E7164	Ear Pack	Dia.12.0mmX24.0mm	No String	20 Units, Gamma Sterile
E7169	Ear Wick	Dia.9.0mmX15.0mm	Fenestrated	20 Units, Gamma Sterile
E7170	Ear Wick	Dia.9.0mmX24.0mm	Fenestrated	20 Units, Gamma Sterile

REF Number	Product Name	Specification	Product Description	Units/Box
E7165	Ear Pack	Dia.9.0mmX15.0mm	With String	20 Units, Gamma Sterile
E7166	Ear Pack	Dia.9.0mmX24.0mm	With String	20 Units, Gamma Sterile
E7167	Ear Pack	Dia.12.0mmX15.0mm	With String	20 Units, Gamma Sterile
E7168	Ear Pack	Dia.12.0mmX24.0mm	With String	20 Units, Gamma Sterile

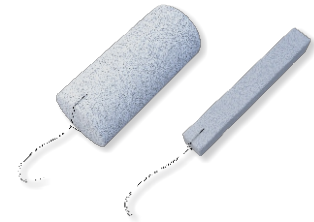

Ear Packs



Anatomical Nasal Dressings

REF Number	Product Name	Specification	Product Description	Units/Box
E7188	Nasal pack Anatomical	8.0cmX1.5cmX3.0cm	With String	10 Units, Gamma Sterile
E7189	Nasal pack Anatomical	8.0cmX1.5cmX3.0cm	With String & Tube	10 Units, Gamma Sterile
E7190	Nasal Anatomical Pack	8.0cmX1.0cmX2.0cm	Thin	10 Units, Gamma Sterile

REF Number	Product Name	Specification	Product Description	Units/Box
E7191	Sinus Packs	3.5cmX1.2cmX0.6cm	With String	10 Pairs, Gamma Sterile
E7192	Sinus Packs	3.5cmX1.2cmX0.9cm	With String	10 Pairs, Gamma Sterile



Sinus Packs



Standard Nasal Dressings

REF Number	Product Name	Specification	Product Description	Units/Box
E7176	Nasal Dressing	4.5cmX1.5cmX2.0cm	No String	10 Units, Gamma Sterile
E7177	Nasal Pack	4.5cmX1.5cmX2.0cm	With String	10 Units, Gamma Sterile
E7178	Nasal Pack	4.5cmX1.5cmX2.0cm	With String & Tube	10 Units, Gamma Sterile
E7179	Nasal Dressing	4.5cmX1.0cmX2.0cm	Thin	10 Units, Gamma Sterile
E7180	Nasal Pack	8.0cmX1.5cmX2.0cm	No String	10/20 Units, Gamma Sterile
E7181	Nasal Pack	8.0cmX1.5cmX2.0cm	With String	10/20 Units, Gamma Sterile
E7182	Nasal Pack	8.0cmX1.5cmX2.0cm	With String & Tube	10 Units, Gamma Sterile
E7183	Nasal Dressing	8.0cmX1.0cmX2.0cm	Thin	10 Units, Gamma Sterile

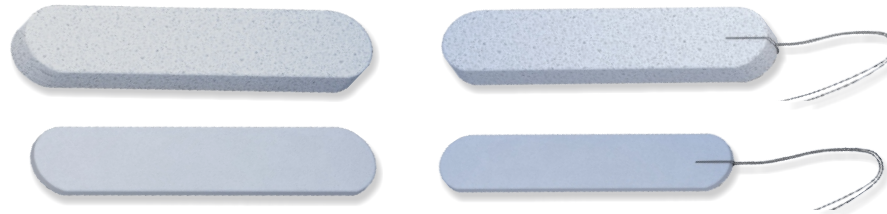

Epistaxis Nasal Dressings

REF Number	Product Name	Specification	Product Description	Units/Box
E7184	Epistaxis Nasal Dressing	10.0cmX1.5cmX2.5cm	No String	10 Units, Gamma Sterile
E7185	Epistaxis Nasal Dressing	10.0cmX1.5cmX2.5cm	With String	10 Units, Gamma Sterile
E7186	Epistaxis Nasal Dressing	10.0cmX1.5cmX2.5cm	With String & Tube	10 Units, Gamma Sterile
E7187	Epistaxis Nasal Dressing	10.0cmX1.0cmX2.5cm	Thin	10 Units, Gamma Sterile
E7193	Epistaxis Nasal Dressing	5.5cmX1.0cmX2.5cm	Pediatric	10 Units, Gamma Sterile

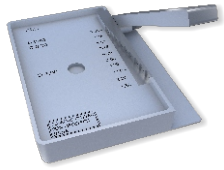

Osseous Cutter

Material : Stainless Steel

REF Number	Units/Box
EI01	1 Unit, Non-Sterile

Material : Stainless Steel

REF Number	Units/Box
EI02	1 Unit, Non-Sterile



Osseous Sizer



Stapes Prosthesis Crimping Forceps

Material : Stainless Steel

REF Number	Units/Box
EI04	1 Unit, Non-Sterile

Material : Stainless Steel

REF Number	Units/Box
EI06	1 Unit, Non-Sterile



Tilleys's Nasal Dressings Forceps



Stapes Prosthesis Handling Forceps

Material : Stainless Steel

REF Number	Description	Units/Box
EI03	Titanium-Stapes Prosthesis Handling Forceps	1 Unit, Non-Sterile
EI05	PTFE-Stapes Prosthesis Handling Forceps	1 Unit, Non-Sterile



Straight Sinus Blades

Units/Box
1 Unit, Non-Sterile

Material : Stainless Steel

REF Number	Type	Size	Angle	Speed
EI2201	Sinus-Straight	4cm	0°	5000rpm
EI2202	Sinus-Curve	4cm	40°	5000rpm
EI2203	Sinus-Curve	4cm	60°	5000rpm
EI2204	Tonsillectomy and Adenoidectomy	4cm	40°	5000rpm



Curved Blades

Units/Box
1 Unit, Non-Sterile

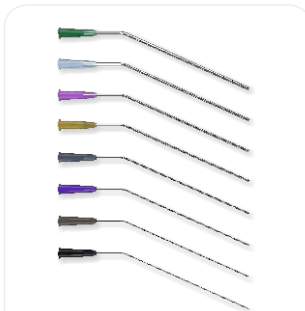

Suction Tube for Ear Disposable

Units/Box
10 Units, ETO Sterile

Material : Stainless Steel & PE

REF Number	Specification
Ei152580	Dia.2.5mmX/80.0mm
Ei153080	Dia.3.0mmX80.0mm
EI152060	Dia.2.0mmX60.0mm
EI152070	Dia.2.0mmX70.0mm
EI152080	Dia.2.0mmX80.0mm
E10110	Dia.2.0mmX100.0mm
E10111	Dia.1.6mmX100.0mm
EI151460	Dia.1.4mmX60.0mm
EI151470	Dia.1.4mmX70.0mm

REF Number	Specification
Ei151480	Dia.1.4mmX80.0mm
E10112	Dia.1.4mmX100.0mm
EI151270	Dia.1.2mmX70.0mm
E10113	Dia.1.2mmX100.0mm
EI151060	Dia.1.0mmX60.0mm
EI151070	Dia.1.0mmX70.0mm
EI151080	Dia.1.0mmX80.0mm
E10114	Dia.1.0mmX100.0mm
EI150870	Dia.0.8mmX70.0mm
E10115	Dia.0.8mmX100.0mm

REF Number	Specification
Ei150760	Dia.0.7mmX60.0mm
EI150780	Dia.0.7mmX80.0mm
E10116	Dia.0.7mmX100.0mm
EI150670	Dia.0.6mmX70.0mm
EI150460	Dia.0.4mmX60.0mm
EI150470	Dia.0.4mmX70.0mm
EI150480	Dia.0.4mmX80.0mm
E10117	Dia.0.4mmX100.0mm
E10120	Ear Disposable Set

Material : Stainless Steel

REF Number	Specification
EI140460	Dia.0.4mmX60.0mm
EI140470	Dia.0.4mmX70.0mm
EI140480	Dia.0.4mmX80.0mm
EI140670	Dia.0.6mmX70.0mm
EI140770	Dia.0.7mmX70.0mm
EI140780	Dia.0.7mmX80.0mm

REF Number	Specification
EI140870	Dia.0.8mmX70.0mm
EI141070	Dia.1.0mmX70.0mm
EI141270	Dia.1.2mmX70.0mm
EI1412100	Dia.1.2mmX100.0mm
EI141470	Dia.1.4mmX70.0mm
EI141480	Dia.1.4mmX80.0mm

REF Number	Specification
EI141670	Dia.1.6mmX70.0mm
EI141770	Dia.1.7mmX70.0mm
EI142070	Dia.2.0mmX70.0mm
EI1420100	Dia.2.0mmX100.0mm
EI142580	Dia.2.5mmX80.0mm
EI143080	Dia.3.0mmX80.0mm
EI141RS	Ear Reusable Set



Suction Tube for Ear Reusable

Units/Box
10 Units, ETO Sterile

Material : Stainless Steel & PE

REF Number	Specification
EI1220100	Dia.2.0mmX100.0mm
EI1220120	Dia.2.0mmX120.0mm
EI1220140	Dia.2.0mmX140.0mm
EI1220150	Dia.2.0mmX150.0mm
EI1220160	Dia.2.0mmX160.0mm
EI1230100	Dia.3.0mmX100.0mm
EI1230120	Dia.3.0mmX120.0mm

REF Number	Specification
EI1230140	Dia.3.0mmX140.0mm
EI1230150	Dia.3.0mmX150.0mm
EI1230160	Dia.3.0mmX160.0mm
EI1235120	Dia.3.5mmX120.0mm
EI1235140	Dia.3.5mmX140.0mm
EI1235160	Dia.3.5mmX160.0mm
EI1240100	Dia.4.0mmX100.0mm

REF Number	Specification
EI1240120	Dia.4.0mmX120.0mm
EI1240140	Dia.4.0mmX140.0mm
EI1240150	Dia.4.0mmX150.0mm
EI1240160	Dia.4.0mmX160.0mm
EI1250120	Dia.5.0mmX120.0mm
EI1250140	Dia.5.0mmX140.0mm
EI1250160	Dia.5.0mmX160.0mm
EI121DS	Nose Disposable Set



Suction Tube for Nose Disposable

Units/Box
10 Units, ETO Sterile

All dimensions are in MM

Material : Stainless Steel



Suction Tube for Nose-Reusable

Units/Box
10 Units, ETO Sterile

REF Number	Specification
EI1320120R	Dia.2.0mmX120.0mm
EI1320120L	Dia.2.0mmX120.0mm
EI1320140R	Dia.2.0mmX140.0mm
EI1320140L	Dia.2.0mmX140.0mm
EI1320160R	Dia.2.0mmX160.0mm
EI1320160L	Dia.2.0mmX160.0mm
EI1325120R	Dia.2.5mmX120.0mm
EI1325120L	Dia.2.5mmX120.0mm
EI1325140R	Dia.2.5mmX140.0mm
EI1325140L	Dia.2.5mmX140.0mm
EI1325160R	Dia.2.5mmX160.0mm
EI1325160L	Dia.2.5mmX160.0mm

REF Number	Specification
EI1330120R	Dia.3.0mmX120.0mm
EI1330120L	Dia.3.0mmX120.0mm
EI1330140R	Dia.3.0mmX140.0mm
EI1330140L	Dia.3.0mmX140.0mm
EI1330160R	Dia.3.0mmX160.0mm
EI1330160L	Dia.3.0mmX160.0mm
EI1335120R	Dia.3.5mmX120.0mm
EI1335120L	Dia.3.5mmX120.0mm
EI1335140R	Dia.3.5mmX140.0mm
EI1335140L	Dia.3.5mmX140.0mm
EI1335160R	Dia.3.5mmX160.0mm
EI1335160L	Dia.3.5mmX160.0mm

REF Number	Specification
EI1340120R	Dia.4.0mmX120.0mm
EI1340120L	Dia.4.0mmX120.0mm
EI1340140R	Dia.4.0mmX140.0mm
EI1340140L	Dia.4.0mmX140.0mm
EI1340160R	Dia.4.0mmX160.0mm
EI1340160L	Dia.4.0mmX160.0mm
EI1350120R	Dia.5.0mmX120.0mm
EI1350120L	Dia.5.0mmX120.0mm
EI1350140R	Dia.5.0mmX140.0mm
EI1350140L	Dia.5.0mmX140.0mm
EI1350160R	Dia.5.0mmX160.0mm
EI1350160L	Dia.5.0mmX160.0mm
EI131RS	Nose Reusable Set

Material : Stainless Steel & PE

REF Number	Product Name	Specification
EI1620250	Suction Tube for Throat	Dia.2.0mmX250.0mm
EI1630250	Suction Tube for Throat	Dia.3.0mmX250.0mm
EI1825150	Suction Tube for Sinus	Dia.2.5mmX150.0mm
EI1830150	Suction Tube for Sinus	Dia.3.0mmX150.0mm
EI1840150	Suction Tube for Sinus	Dia.4.0mmX150.0mm



Suction Tube for Throat and Sinus - Disposable

10 Units, ETO Sterile

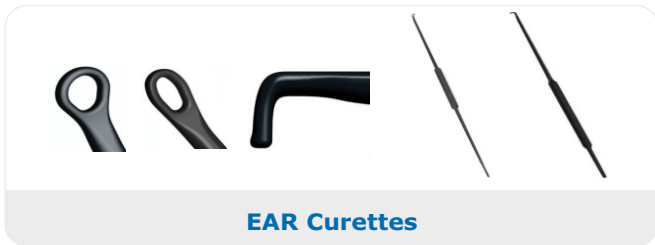

EAR Curettes

Units/Box
100 Units, ETO Sterile / Non Sterile

REF Number	Product Name	Size
EI0962	Jobson Horne Probe-Round	3 mm
EI0963	Jobson Horne Probe-Oval	2.5 mm
EI0964	Cerumen Hook	Standard



EAR Specula

Units/Box

100 Units, ETO Sterile / Non Sterile

Material : Polyethylene

REF Number	Tip Diameter
EI0951	3mm
EI0952	4mm
EI0953	5mm
EI0954	6mm



Suction Controller

Units/Box

10 Units, ETO Sterile / Non Sterile

Material : SS and Polyethylene

REF Number	Length
EI0968	39mm

Material : SS and Polyethylene

REF Number	Length
EI0966	157mm



Myringotomy Knife

Units/Box

1 Unit, ETO Sterile / Non Sterile



Micro Alligator Ear Forceps

Units/Box

1 Unit, ETO Sterile / Non Sterile

Material : SS

REF Number	Jaw Length	Length
EI0969	3.5mm	75mm

Material : Polyethylene

REF Number
EI0959



Rosen Inserter

Units/Box

100 Units, ETO Sterile / Non Sterile



Tungsten Carbide



Stainless Steel



Course Diamond



Fine Diamond

ENT Burs

Units/Box
10 Units, ETO Non-Sterile

REF Number				Length (mm)	Head Diameter (mm)
Stainless Steel	Tungsten Carbide	Fine Diamond	Course Diamond		
EI2105SS	EI2105TC	EI2105FD	EI2105CD	70.0	0.5
EI2110SS	EI2110TC	EI2110FD	EI2110CD	70.0	1.0
EI2115SS	EI2115TC	EI2115FD	EI2115CD	70.0	1.5
EI2120SS	EI2120TC	EI2120FD	EI2120CD	70.0	2.0
EI2125SS	EI2125TC	EI2125FD	EI2125CD	70.0	2.5
EI2130SS	EI2130TC	EI2130FD	EI2130CD	70.0	3.0
EI2135SS	EI2135TC	EI2135FD	EI2135CD	70.0	3.5
EI2140SS	EI2140TC	EI2140FD	EI2140CD	70.0	4.0
EI2145SS	EI2145TC	EI2145FD	EI2145CD	70.0	4.5
EI2150SS	EI2150TC	EI2150FD	EI2150CD	70.0	5.0
EI2155SS	EI2155TC			70.0	5.5
EI2160SS	EI2160TC	EI2160FD	EI2160CD	70.0	6.0
EI2165SS	EI2165TC			70.0	6.5
EI2170SS	EI2170TC		EI2170CD	70.0	7.0



Myringotomy Kit

Myringotomy Kit-Standard	EI0972
Jobson Horne Probe	1 Unit
Ear Specula- 3 MM	1 Unit
4 MM	1 Unit
5 MM	1 Unit
Myringotomy Knife	1 Unit
Suction Tube- 16 Gauge	1 Unit
18 Gauge	1 Unit
Micro Alligator Ear Forceps	1 Unit
Suction Controller	1 Unit
Rosen Inserter	1 Unit
Grommet	1 Unit

Myringotomy Kit-Pediatric	Ei0973
Jobson Horne Probe	1 Unit
Ear Specula- 4 MM	1 Unit
5 MM	1 Unit
6 MM	1 Unit
Myringotomy Knife	1 Unit
Suction Tube- 18 Gauge	1 Unit
20 Gauge	1 Unit
Micro Alligator Ear Forceps	1 Unit
Suction Controller	1 Unit
Rosen Inserter	1 Unit
Grommet	1 Unit

Material: Clear Medical Grade Silicone

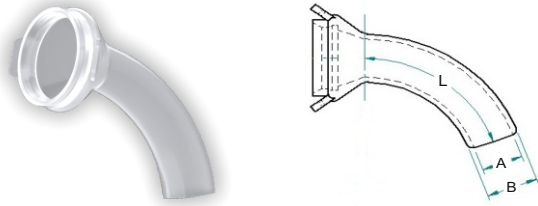

Laryngectomy Tube

Units/Box
1 Unit, ETO Sterile/Non-Sterile

REF Number		Size	Inner Diameter (A) mm	Outer Diameter (B) mm	Length Diameter (L) mm
Standard	Fenestrated				
E3110836S	E3110836F	8/36	9.5	12	36
E3110855S	E3110855F	8/55	9.5	12	55
E3110936S	E3110936F	9/36	10.5	13.5	36
E3110955S	E3110955F	9/55	10.5	13.5	55
E3111036S	E3111036F	10/36	12	15	36
E3111055S	E3111055F	10/55	12	15	55
E3111236S	E3111236F	12/36	13.5	17	36
E3111255S	E3111255F	12/55	13.5	17	55

Material: Clear Medical Grade Silicone

REF Number	Size	Inner Diameter (A) mm	Outer Diameter (B) mm
E3131208	12/8	12	8
E3131408	14/8	14	8
E3131608	16/8	16	8
E3131808	18/8	18	8
E3131218	12/18	12	18
E3131418	14/18	14	18
E3131618	16/18	16	18
E3131818	18/18	18	18

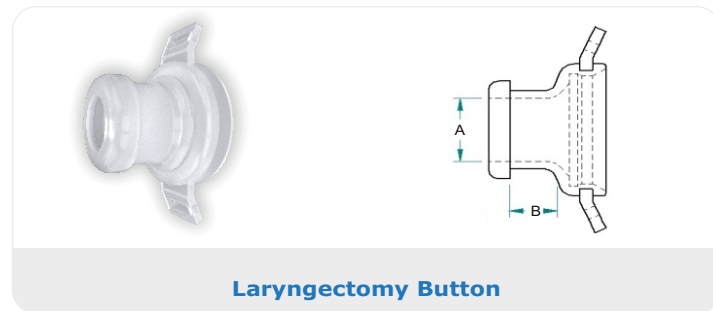

Laryngectomy Button

Units/Box
1 Unit, ETO Sterile/Non-Sterile

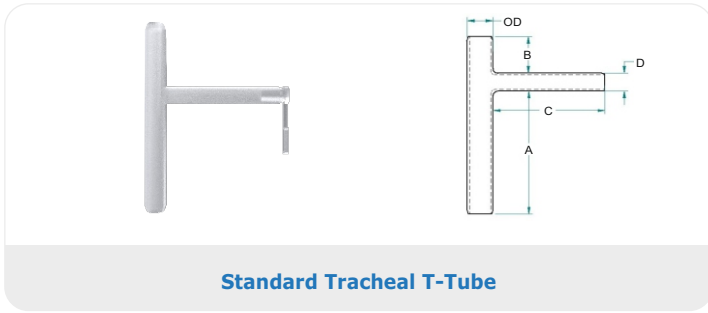

Standard Tracheal T-Tube

Units/Box
1 Unit, ETO Sterile/Non-Sterile

Material: Medical Grade Silicone

REF Number		Outer Diameter (mm)	A (mm)	B (mm)	C (mm)	D (mm)
Clear	White					
E31506CS	E31506WS	6	10	6	48	5
E31508CS	E31508WS	8	16	12	36	6
E31510CS	E31510WS	10	23	17	44	8
E31512CS	E31512WS	12	31	21	55	11
E31514CS	E31514WS	14	32	23	64	11
E31516CS	E31516WS	16	31	23	63	12

REF Number	Descriptions	Units/Box
EA91001	Air-Heat/Moisture Exchanger (HME)	5 Units, Sterile/Non-Sterile
EA91002	Moist-Heat/Moisture Exchanger (HME)	5 Units, Sterile/Non-Sterile



Accessories



Laryngeal Umbrella Keel

Units/Box
1 Unit, ETO Sterile/Non-Sterile

Material: Medical Grade Silicone

REF Number		Size (A) mm	Size (B) mm
Clear	White		
E31212C	E31212W	12	16
E31214C	E31214W	14	16
E31216C	E31216W	16	16



Salivary by-pass tube

Units/Box
1 Unit, ETO Sterile/Non-Sterile

Material: Medical Grade Silicone

REF Number		Size (A) mm	Size (B) mm	Length (C) mm
Clear	White			
E31410C	E31410W	10	24	188
E31412C	E31412W	12	24	188
E31414C	E31414W	14	27	188

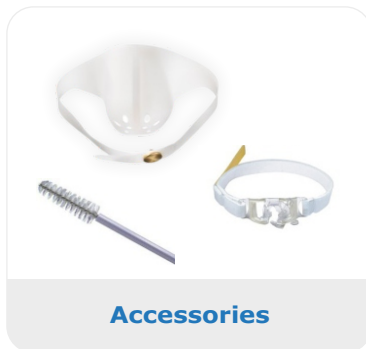

Accessories

REF Number	Descriptions	Units/Box
EA91003	Shower Guard	1 Unit, Sterile/Non-Sterile
EA91004	Laryngeal Tube Brush	1 Unit, Sterile/Non-Sterile
EA91005	Laryngeal Tube Holder	1 Unit, Sterile/Non-Sterile



Long Tracheal T-Tube Extra-Long Tracheal T-Tube

Units/Box
1 Unit, ETO Sterile/Non-Sterile

Material: Medical Grade Silicone

REF Number		Outer Diameter (mm)	A (mm)	B (mm)	C (mm)	D (mm)	Size
Clear	White						
E31506CL	E31506WL	6	34	7	48	5	Long
E31508CL	E31508WL	8	58	12	39	7	Long
E31510CL	E31510WL	10	63	17	50	8	Long
E31512CL	E31512WL	12	72	20	59	11	Long
E31514CL	E31514WL	14	72	23	66	11	Long
E31516CL	E31516WL	16	81	24	70	12	Long
E31506CE	E31506WE	6	40	30	48	5	Extra-Long
E31508CE	E31508WE	8	60	49	40	7	Extra-Long
E31510CE	E31510WE	10	68	48	41	8	Extra-Long
E31512CE	E31512WE	12	98	39	64	11	Extra-Long
E31514CE	E31514WE	14	97	48	74	11	Extra-Long

Osseous Coaglator II System

Plasma system is used in medical surgeries with safety advantages of low temperature, small thermal damage, and no need for neutral plate. It speeds up the surgical process, reduces cutting thermal damage, releases labor intensity, reduces or avoids bleeding, relieves patient pain and reduces postoperative complications.

Plasma system consists of console (including the motherboard, control panel, output interface and power cord), foot switch, and multi-functional plasma surgery electrode.



Osseous Coaglator II System

Working Mode:

Working Modes	Functions		Power Levels
Cutting Mode	Cutting & Vaporization	Power 4-9	6 Adjustable Power Levels
Cutting Mode	Cutting & Coagulation	Power 6-8	3 Adjustable Power Levels
Cutting Mode	Vaporization & Puncture	Power 3-5	3 Adjustable Power Levels
Coagulation Mode	Ablation & Coagulation	Power 3-5	3 Adjustable Power Levels

Timing Function : Timing for coagulation mode : 0-9 seconds adjustable.



EI2601 Flow Control Unit



EI2501 Coaglator II Controller



EI2701 Foot Switch



Wands

Use And Operation Structure Diagram of Console

1. Plasma vaporization / puncture / cutting power level window (yellow zone)
2. Plasma vaporization / puncture / cutting work indicator
3. Plasma ablation / coagulation power level window (blue zone)
4. Plasma ablation / coagulation work indicator
5. Plasma ablation / coagulation timing window (gray zone)
6. Plasma ablation / coagulation timing work indicator
7. Plasma vaporization / puncture / cutting power-up key
8. Power switch button
9. Plasma vaporization / puncture / cutting power-down key
10. Foot switch assembly socket
11. Plasma ablation / coagulation power-up key
12. Plasma ablation / coagulation power-down key
13. Plasma puncture / cutting / ablation / coagulation blue output jack
14. Plasma ablation / coagulation timing increment key (Not count for power 0)
15. Plasma ablation / coagulation timing reduction key (Not count for power 0)
16. Cooling fan inlet
17. External 220V AC power inlet
18. External flow controller link
19. Volume control knob
20. Fuse holder

Coaglator II Specifications

Controller Input Power Requirements	Voltage	220V± 10 %
Controller Input Power Requirements	Frequency	50Hz ± 1Hz
Controller Input Power Requirements	RMS Current	2 Amp
Controller Input Power Requirements	Fuse Rating	10A/250V
Output Power	Fundamental Frequency	450 kHz
Output Power	Max Output Power	≤300W @ 275Ω
Controller Dimensions	Weight (Max)	6.5kg
Controller Dimensions	Height	140mm
Controller Dimensions	Width	350mm
Controller Dimensions	Length	350mm

Classification

This product is classified as follows:

Electric shock protection type: class I, CF type.

Protection against harmful inlet fluid: ordinary equipment.

Protection against flammable anesthesia gas mixture with air, oxygen or nitrous oxide: cannot be used in flammable anesthesia gas mixture with air, oxygen or nitrous oxide.

This product is a fixed type equipment.

Work mode: continuous operation (standby) intermittent loading (work).

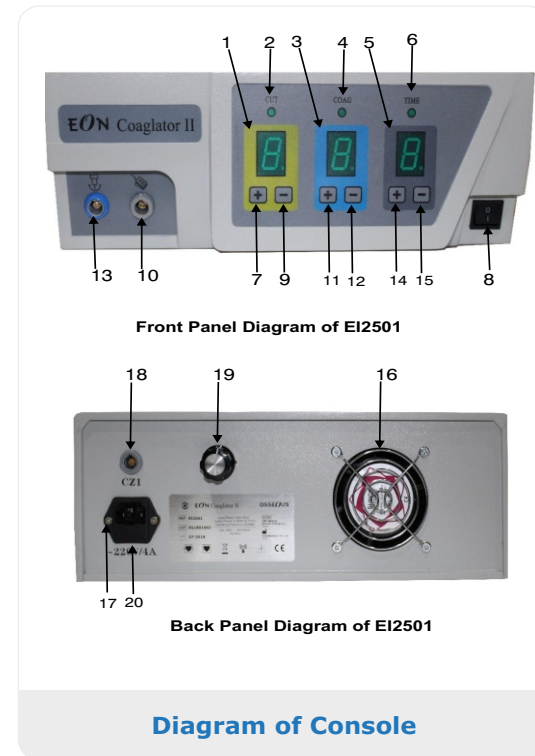

Osseous Plasma Wands

REF Number	Units & Box
EI2301	1 Unit / Sterile



Advance Tonsil Wand



Advance Adenoid Wand

REF Number	Units & Box
EI2303	1 Unit

REF Number	Units & Box
EI2304	1 Unit
EI2305	1 Unit



**Turbinates Wand
1.3mm/1.6mm**



Nasal Hemostasis Wand

REF Number	Units & Box
EI2306	1 Unit



Suction Hemostasis Wand

REF Number	Units & Box
EI2307	1 Unit



Larynx Wand

REF Number	Units & Box
EI2308	1 Unit



Absorbable Haemostatic Gelatin Sponges

REF Number	Product	Specification	Units & Box
E91018050	Gelatin Sponge	80mm x 50mm x 1mm	20 Units, Gamma Sterile
E91017050	Gelatin Sponge	70mm x 50mm x 1mm	20 Units, Gamma Sterile
E91048050	Gelatin Sponge Bilateral	80mm x 50mm x 4mm	10 Units, Gamma Sterile
E91048025	Gelatin Sponge Unilateral	80mm x 25mm x 4mm	10 Units, Gamma Sterile
E91078020	Gelatin Sponge	60mm x 20mm x 7mm	10 Units, Gamma Sterile
E91078015	Gelatin Sponge Nasal	80mm x 15mm x 7mm	10 Units, Gamma Sterile
E91078025	Gelatin Sponge Gynec	80mm x 25mm x 7mm	10 Units, Gamma Sterile
E91072020	Gelatin Sponge	20mm x 20mm x 7mm	10 Units, Gamma Sterile
E91108050	Gelatin Sponge	80mm x 50mm x 10mm	10 Units, Gamma Sterile
E91107050	Gelatin Sponge	70mm x 50mm x 10mm	10 Units, Gamma Sterile
E91108040	Gelatin Sponge Sterifen	80mm x 40mm x 10mm	10 Units, Gamma Sterile
E91108020	Gelatin Sponge Strip	80mm x 20mm x 10mm	10 Units, Gamma Sterile
E9115200	Gelatin Sponge	200mm x 150mm x 15mm	10 Units, Gamma Sterile

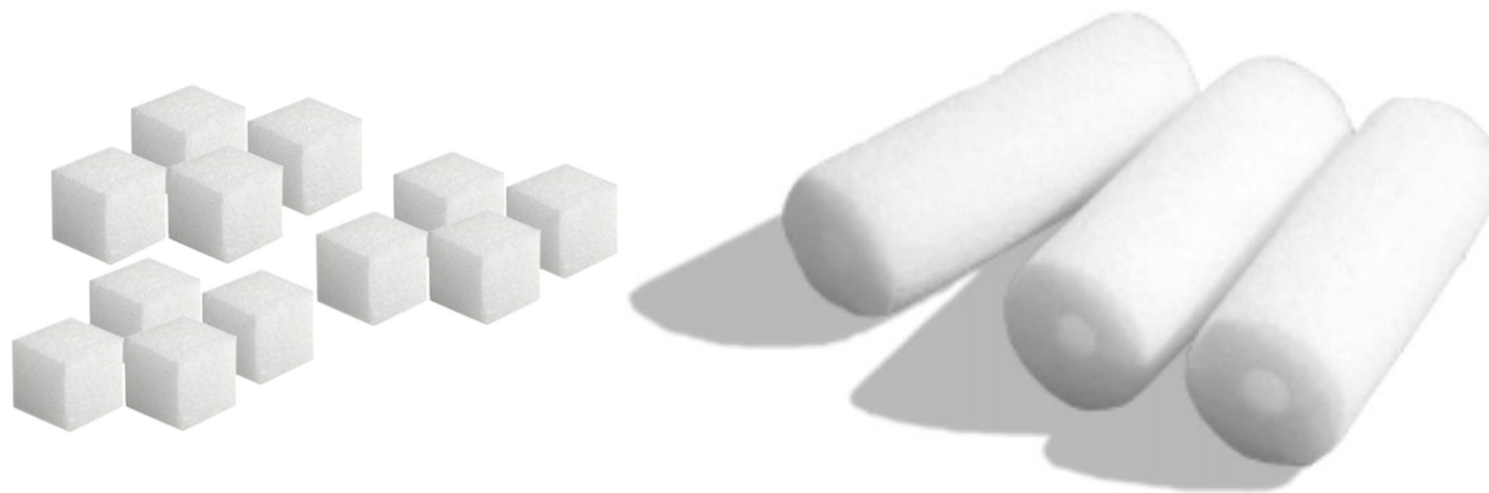

Absorbable Haemostatic Gelatin Sponges

REF Number	Product	Specification	Units & Box
E911010	Gelatin Sponge Dental	10mm x 10mm x 10mm	32 Units, Gamma Sterile
E911030	Gelatin Sponge Dial	30mm x 30mm x 10mm	10 Units, Gamma Sterile
E9110120	Gelatin Sponge 120	120mm x 100mm x 10mm	02 Units, Gamma Sterile
E9110125	Gelatin Sponge	125mm x 80mm x 10mm	02 Units, Gamma Sterile
E9110250	Gelatin Sponge 250	250mm x 80mm x 10mm	02 Units, Gamma Sterile
E9105200	Gelatin Sponge Film	200mm x 70mm x 0.5mm	10 Units, Gamma Sterile
E910203	Gelatin Sponge MicroSponge	3mm x 2mm x 2mm	200 Units, Gamma Sterile
E910404	Gelatin Sponge MicroSponge	4mm x 4mm x 4mm	100 Units, Gamma Sterile
E918005	Gelatin Sponge Nasal Tampon	5mm Dia x 80mm	10 Units, Gamma Sterile
E918030	Gelatin Sponge Anal Tampon	30mm Dia x 80mm	06 Units, Gamma Sterile
E911208	Gelatin Sponge Anal Tampon	8mm Dia x 12mm	32 Units, Gamma Sterile
E9101	Gelatin Powder	1 Gram	06 Units, Gamma Sterile



www.eonmeditech.com



EON MEDITECH PVT. LTD.
12, Gurukrupa Society, Utran Road,
Surat - 394105, Gujrat, INDIA.
Ph.: +91 261-2494330
E-mail : info@eonmeditech.com



CMC MEDICAL DEVICES & DRUGS S.L.
C/Horacio Lengo No. 18, CP 29006,
Malaga, Spain.
E-mail : info@cmcmedicaldevices.com

