

PD-SDC (E4)

Piston Displacement

Dry Type

DN15~40



TCM142/10-4758



INTRODUCTION

PD-SDC is Piston Displacement (Volumetric) water meter with magnetic transmission,

dry type register for residential application with sizes from Dn15 to Dn40 designed and manufactured by NWM and meets to the requirements of Directive 2014/32/EU on

measuring instruments; the European Standard EN14154+A1+A2: Water Meter; intended for the metering of cold potable water.

FEATURES



Corrosion Resistance

All the materials selected by resistance to corrosion;



High Accuracy

Large range ratio, strong repeatability;



ROTARY Indicator Register

pulse output pre-equipped at 10 liters;



Extra Inlet Filter

The filter at the inlet of the meter body permits cleaning it without breaking the metrological seal;



Non Return Valve

to avoid the reserve flow Rate AS OPTION;



Remote Transmission

Reserve remote transmission function to realize data transmission;

SPECIFICATIONS

► Dimension

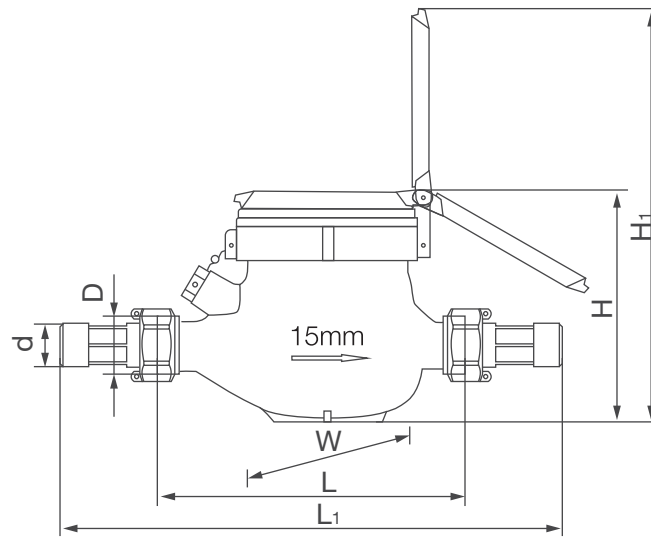

Dimensional drawing of water meter

Size (mm)	Dn15	Dn20	Dn25	Dn32	Dn40
L	110/165/170	190	260	260	300
W	87	98	111	145	174
H	108/114	120/122	135	159	181
d	R1/2	R3/4	R1	R1-1/4	R1-1/2
D	G3/4B	G1B	G1-1/4B	G1-1/2B	G2B

► Metrology

DN	mm	15	20	25	32	40
R	Q_3/Q_1	400	400	250	250	250
Q_4	m^3/h	3.125	5	7.875	12.5	20
Q_3	m^3/h	2.5	4	6.3	10	16
Q_2	l/h	10	16	40.32	64	102.4
Q_1	l/h	6.25	10	25.2	40	64
Max. reading	m^3	99 999.9999				
Min. reading	Liter	0.05				
Pressure loss	Δp	$\Delta p < 63$				
Max, Pressure	MAP	MAP16				
Max, Temperature	$^{\circ}C$	T30 / T50				

(For different Q_3 and R, please contact with NWM manufacture).

► Max Permission Error

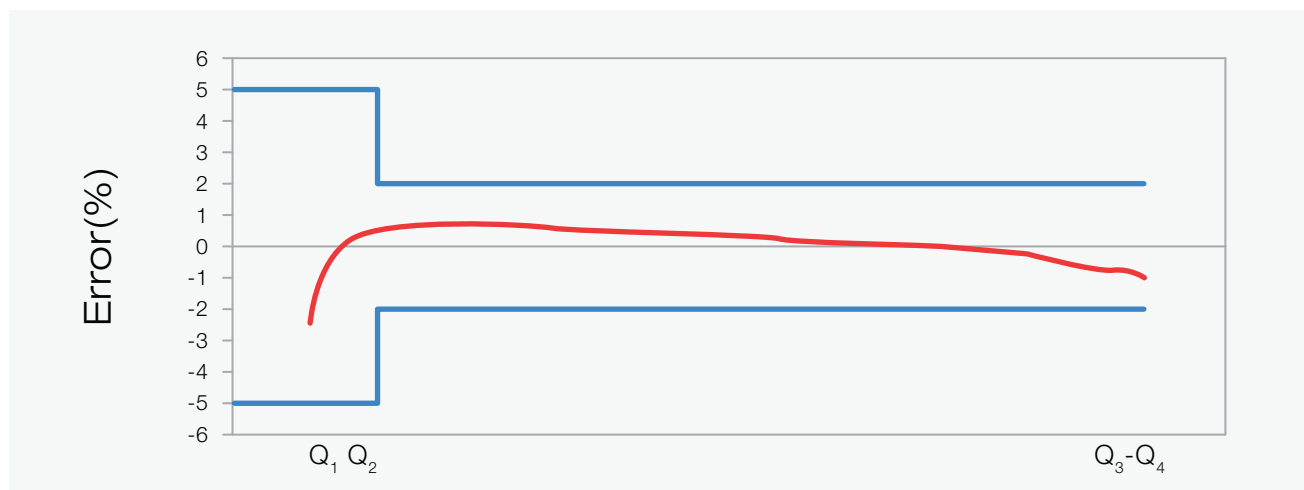

- a. In the lower zone ($Q_1 \leq Q \leq Q_2$): maximum permission error is $\pm 5\%$
- b. In the upper zone ($Q_2 \leq Q \leq Q_4$): maximum permission error is $\pm 2\%$ ($T \leq 30^\circ\text{C}$), maximum permission error is $\pm 3\%$ ($30^\circ\text{C} < T \leq 90^\circ\text{C}$)

► Pressure Loss

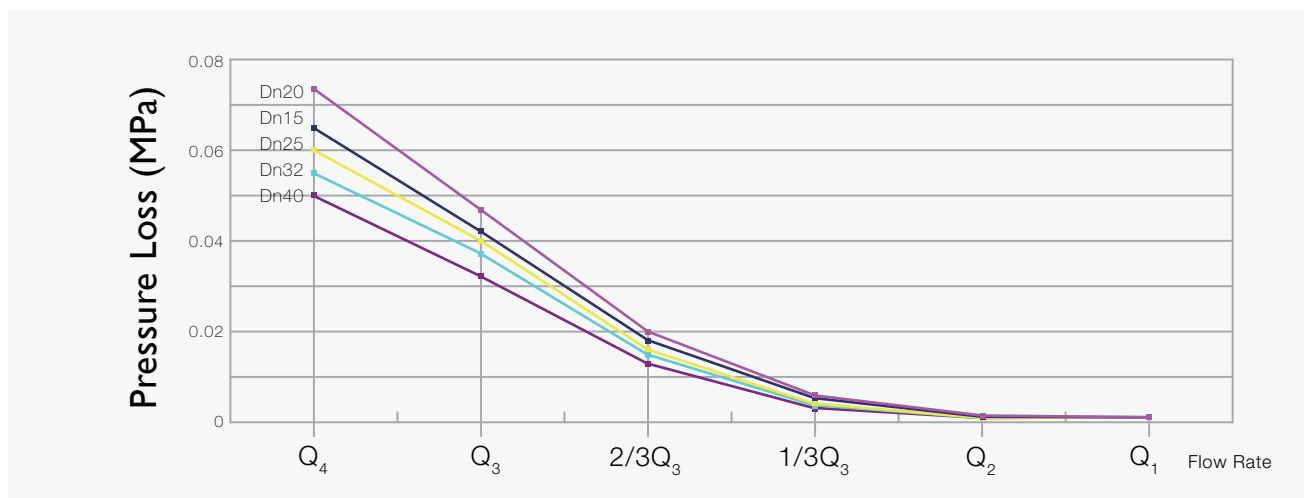

► Register Type



REMOTE TRANSMISSION



INSTALLATION

- The meters should be installed in any position with the direction of the flow as indicated by the arrow cast on the meter body with registerface upwards;
- Pipeline must be flushed before installation;
- The meter should be constantly full of water during operation;
- NWM Suggestto Installation the water meter as:

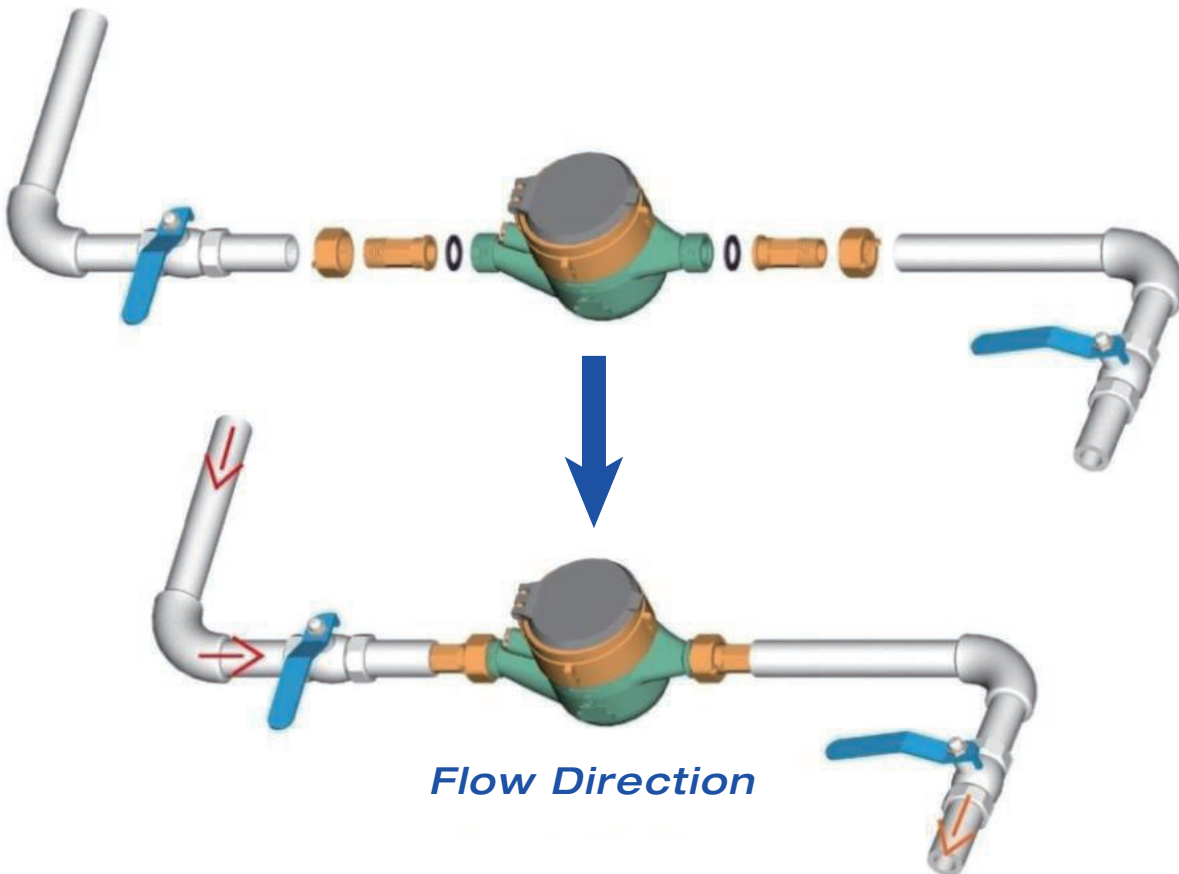

NINGBO WATER METER (GROUP) CO., LTD.

Address: No.355, Hongxing Road, Jiangbei District, Ningbo 315032 China

TEL: +86 574 88195820 FAX: +86 574 88195855

E-mail: sales@nwmwatermeters.com

Website: www.nwmwatermeters.com

Version No.: NWM/EN-PD-SDC(E4-C)/2205-1.1

Copyright © 2022-2026 NWM.All Rights Reserved.



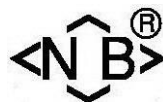

NWM

DECLARATIE DE CONFORMITATE Nr.124/2023

Noi ,NINGBO WATER METER Group CO.LTD ., cu sediul în adresă : NO.355HONGXING ROAD , JEANGBEI DISTRICT NINGBO 315033 CHINA

Declarăm că produsul „CONTOR DE APA „tip PD-LFC ,SG-LFC, MJ-LFC, WP-SDC SJ-SDC PLUS

Nr.	Denumire	Serie Produs
1	Contor volumetric apa rece PD-LFC	
2	Contor apa rece cadran umed SJ-LFC	
3	Contor apa rece multiget MJ-LFC	
4	Contor apa rece tip WOLTMAN WP-SDC	
5	Contor apa rece și caldă tip SJ-SDC PLUS cu MODUL LoRA	

Este conform cu certificatul de examinare CE de tip numărul TCM 142/10 – 4759 , TCM 142/11 – 4855, TCM 142/10 – 4793, TCM 142/10 – 4736 și TCM 142/12 -4922 sunt respectate cerințele esențiale specificate de Directiva 2014/32/EU a parlamentului și al Consiliului European privind mijloacele de măsurare , transpuse în Legislația Națională a R . Moldova Definite în

Anexa N1 Cerințe

Anexa MI-001 Contor apa

Normative armonizate :

SR EN 14154-1+A2:2011- Contoare de apă. Partea 1 : Condiții Generale

SR EN 14154-2+A2:2011- Contoare de apă. Partea 2 : Instalarea și condiții de utilizare

SR EN 14154-3+A2:2011- Contoare de apă. Partea 3 : Condiții Generale Metode și echipamente de încercare

Evaluarea conformității produsului este realizată prin :

- Examinare EC de tip (modul B), organism notificat 1383, care a emis certificatul TCM 142/10 – 4759 , TCM 142/11 – 4855, TCM 142/10 – 4793, TCM 142/10 – 4736 , **TCM 142/12 -4922**
- Asigurarea sistemului calității (modul D), organism notificat 1383, care a emis certificatul revizia 4

Prezenta declarație de conformitate este emisă pe răspunderea exclusivă a **producătorului**

Locul și data emiterii :

NINGBO, 26-01-2023

Name , Function

Signature

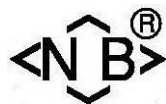

CERTIFICAT DE GARANTIE:

PRODUS:CONTOR APA Seria:
PRODUCATOR: NINGBO WATER METER CO LTD,Adresa NO.355 HONGXING ROAD, JIANGEBI DISTRICT NINGBO 315033 CHINA
IMPORTATOR:
VANZATOR(nume si adresa):.....
CUMPARATOR(nume si adresa):.....
DOCUMENTUL DE VANZARE:.....NR...../.....
NR.DOCUMENT DECLARATIE DE CONFORMITATE 3502/2014
DURATA MEDIE DE UTULIZARE A PRODUSULUI: 10 ANI
MODALITATE DE ASIGURARE A SERVICE~ULUI: REPARARE SAU INLOCUIRE

Garantia asigurata cumparatorului de catre vanzator este in conformitate cu legislatia in vigoare in R.Moldova ,armonizata cu legislatia Uniunii Europene: , republicate cu modificarile si completarile ulterioare,prin care se precizeaza modalitatile de asigurare a garantiei dupa cum urmeaza:Garantia prin reparare se acorda in perioada de garantie, daca instalarea si intretinerea produselor este efectuata de personal autorizat,astfel incat datorita instalarii si intretinerii,produsul sa nu sufere deteoriorari ce ar afecta buna lui functionare,sau ar cauza scoaterea lui din functiune;

1. Garantia prin inlocuire acopera orice defectiune de material sau viciu de fabricatie,care ar aparea in perioada de garantie.
2. Perioada de garantie este de 24 luni,cu incepere de la data livrarii produsului,si prelungindu-se cu perioada ce se scurge de la data reclamatiei,pana la data inlaturarii defectiunii,sau inlocuirii produsului.
3. Defectiunile datorate transportului,depozitarii,montarii,utilizarii sau intretinerii incorecte,folosirii pieselor incompatibile sau neoriginale,greselilor sau modificarilor facute de catre instalator su/sau cumparator,nu fac obiectul garantiei.
4. Remedierea deficientelor aparute la produse ori inlocuirea produselor care nu corespund in cadrul termenului de garantie, care nu sunt imputabile consumatorului se face in termen de maxim 15 zile calendaristice din momentul cand operatorul economic a luat la cunostinta deficientele respective. In cadrul unor vicii ascunse,termenul maxim stabilit (15 zile) curge de la data finalizarii expertizei tehnice efectuate de un organism tehnic neutru.
5. La cumpararea produsului cumparatorul are obligatia sa verifice completarea certificatului de garantie cu toate datele necesare,semnatura si stampilarea de catre vanzator ; totodata poate sa solicite date referitoare la modul de transport,depozitare,instalare,folosire si intretinere corecta a produsului,in afara de cele specificate in cartea tehnica.
6. Pentru a beneficia de drepturile asigurate prin garantie,cumparatorul are obligatia de a prezenta vanzatorului:prezentul certificat de garantie si documentul de cumparare in original,precum si o prezentare cat mai detaliata a defectiunii constatate.
7. In cazul unor defectiuni a caror reparatie este extragarantionala,la cerere,firma furnizoare executa reparatiile necesare contracost.
8. Prin semnarea acestui certificat, cumparatorul isi exprima acordul cu cele curpinse in acest act si delcara ca a preluat produsul in bun stare,a inteles obligatiile ce ii revin pentru a putea beneficia de garantia acordata de vanzator ,conform legislatiei in vigoare.
9. Drepturile conferite prin legea consumatorului nu sunt afectate prin garantia(comerciala,contractuala) oferita de operatorul economic.

SEMNATURA SI STAMPILA PRODUCATOR NWM Signature NWM	SEMNATURA SI STAMPILA IMPORTATOR	SEMNATURA SI STAMPILA VANZATOR	SEMNATURA CUMPARATOR
--	-------------------------------------	-----------------------------------	-------------------------

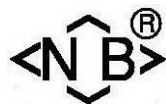

WARRANTY CERTIFICATE

PRODUCT:WATER METER SERIES:
 MANUFACTURER: NINGBO WATER METER CO LTD, Address: NO.355 HONGXING ROAD< JIANGBI DISTRICT NINGBO 315033 CHINA
 IMPORT:
 B1SELLER (name and address):
 BUYER(name and address):.....
 DOCUMENT OF SALES:Nr...../.....
 NO.DOCUMENT DELCLARATION OF CONFORMITY: 3502/2014
 AVERAGE DURATION OF USE: 10 years

How to ensure that servicing: repair or replacement

Our warranty is the buyer by the seller in accordance with the current valid law in R.Moldova , harmonized with Eu legislation: Law 449/ 12.11.2003 and Ordinance no.21 /08.21.1992, republished as amended and supplemented, specifying ways to esnure as follows : The warranty is granted by repaired under warranty, if the instalation and maintenace of products is performed by authorizes personnel,so due installation and maintenance,the product does not sufer damage that would affect reliable operation,or cause his removal from service;

1. Replacement warranty cover any failure of material or manufacturing defect that would occur during the warranty period.
2. The warranty period is 24 moths starting from the date of delivery of the product,and extending - is the period that elapses from the date of complaint until the fault removal or replacement of the product.
3. Damage resulting from transport storage,installation,meintenance or use of incorrect or inconsistent use of non original parts,mistakes or changes made by the installer and /or buyer ,not covered by the warranty.
4. Rectofaction uncurrred in replacing goods or substandard prodcuts within the warranty period that are not attributable to the consumer is made withing 15 calendar days of when the economic operator is aware of such shortcomings.In some hidden defects the maximum set(15 days) run from the date of completion of technical expertise codcted by a neutral technical body.
5. To purchase the product has to verify the completion guarantee cerificate with all the necessary date, signed and stamped by the seller; also can request data on the mode of transport, storage, installation,use and meintenance,correctly the product,in addition to those specified in the techincal.
6. In case of failures whose repair is over warranty period on request,the supplying company runs needed repairs for a fee.
7. To enjoy the rights secured by collateral,the buyer is obliged to sibmit seller:this warranty and the original pruchase document,as well as detailed presentation of the fault detected.
8. By signing this certificate,the buyer agrees to those contained in this act and delcares that took the product in good condition,understood its obligations in order to benefit from the guarantee provided by the seller,as required by law.
9. Consumer rights conferred by law are not affected by the guarantee(commercial,contractual) offered by the trader.

Terms relating to the activities of service rendered on the product.

MANUFACTURER'S SIGNATURE AND STAMP NWM Signature NWM	SIGNATURE AND STAMP OF THE IMPORTER	SELLER'S SIGNATURE AND STAMP	BUYER'S SIGNATURE
---	--	---	--------------------------



EU declaration of conformity Nr.124/2023

We NINGBO WATER METER GROUP CO. LTD Headquartered in

Address:NO.355 HONGXING ROAD,JIANGBEI DISTRICT NINGBO 315033 CHINA

Declare that the product ``water meter`` type SJ-SDC SDC-MJ, MJ-WDC SJ-SDC PLUS

Nr.	Denumire	Serie Produs
1	Cold volumetric water metr PD-LFC	
2	Cold water water meter wet dial SJ-LFC	
3	Cold water multijet water meter MJ-LFC DN	
4	Cold water water metter WOLTMAN WP-SDC	
5	Cold an Hot water meter tip SJ-SDC PLUS and MODULE LoRA	

Compiles with EC type examination certificate number TCM 142/ 11-4857, TCM 142/ 10-4792 TCM 142/ 10-4793 and TCM 142/12 -4922 is in compliance with the essential requirements of directive 2014/32 EU of the European Parliament and of the Council DIRECTIVE 2014/32/EU OF THE EUROPEAN PARLIAMENT AND OF THE COUNCIL, of 26 February 2014

on the harmonization of the laws of the Member States relating to the marking available on the market of measuring instruments(recast), which has been transposed into Romania national legislation by GD no. 711/2015. as defined in:

Annex I, Essential requirements

Annex M1-001 water meter

Harmonized regulations:

SR EN 14154-1 + A2: 2011 – Water meters. Part 1: General

SR EN 14154-2 + A2:2011 – Water meters.Part2:Installation and conditions of use

SR EN 14154-3+ A2:2011 – Water meters.Part3:Methods and test equipment.

Assessment of the product is achieved by:

-EC type examination(module B),Notified Body 1383,with issued the certificates TCM 142/ 11-4857, TCM 142/10-4792,TCM 142/10-4793 , TCM 142/12 -4922

-Ensuring the quality system(module B)Notified Body 1383, which issued 0119-SJ-A004-10,revision 4

This declaration of conformity is under the sole responsibility of the manufacturer .

Place and date of issue

NINGBO, 26-01-2022

Name , surname function (Name Function)

Signature