



Encho Enchev - ETE Ltd.

Bulgaria, 5130 Dolna Oryahovitsa, 25 Dimitar Blagoev St
Tel: +359 6173 22 72; Mob: +359 882 279 759; +359 882 277 414
www.etebg.net ; e-mail: sales@etebg.net



TECHNICAL SPECIFICATION



of
Concrete products from high-performance concrete - elements
for landscaping streets, parks and gardens

1.Product -Concrete litter bin Model 18





1. Description of the product

1.1 General description of the product:

Litter bin with a classic shape combining the strength of two materials - concrete and metal. The concrete is high-performance with an aggregate structure of natural marble or granite stones. Natural stones are defined in size and can be combined in different colors. The surfaces are embossed and treated with a special protective coating, which reduces the deposition of dirt and makes the product even more resistant to aggressive weather conditions. The metal components are coated with ester-epoxy zinc primer and are powder coated. This protects the metal from corrosion and increases its performance. The possibility of anchoring to the flooring, as well as the strength of the materials of which the garbage bin is made, guarantee its long-term operation. The metal lid has an integrated ashtray. The concrete bin has an inner container of galvanized metal for waste collection, providing easy access for cleaning and maintenance. All fasteners are made of stainless steel. The compact dimensions of the concrete litter bin make it suitable for furnishing narrow streets, sidewalks and pedestrian alleys, as well as large gardens and park spaces. A practical and necessary addition to various public areas - bus stops, metro stations, hospitals, schools and playgrounds. Elegant exterior solution for equipment of camping areas, chalets, resorts, holiday villages, beaches and private properties.



1.2 Description of the main components of the product:

The concrete litter bin consists of: **1.** Concrete body; **2.** Metal lid with ashtray; **3.** Internal galvanized metal container with a capacity of 35 liters; **4.** Marking logo; **5.** Decoration stainless steel strip; (*Figure 1*)

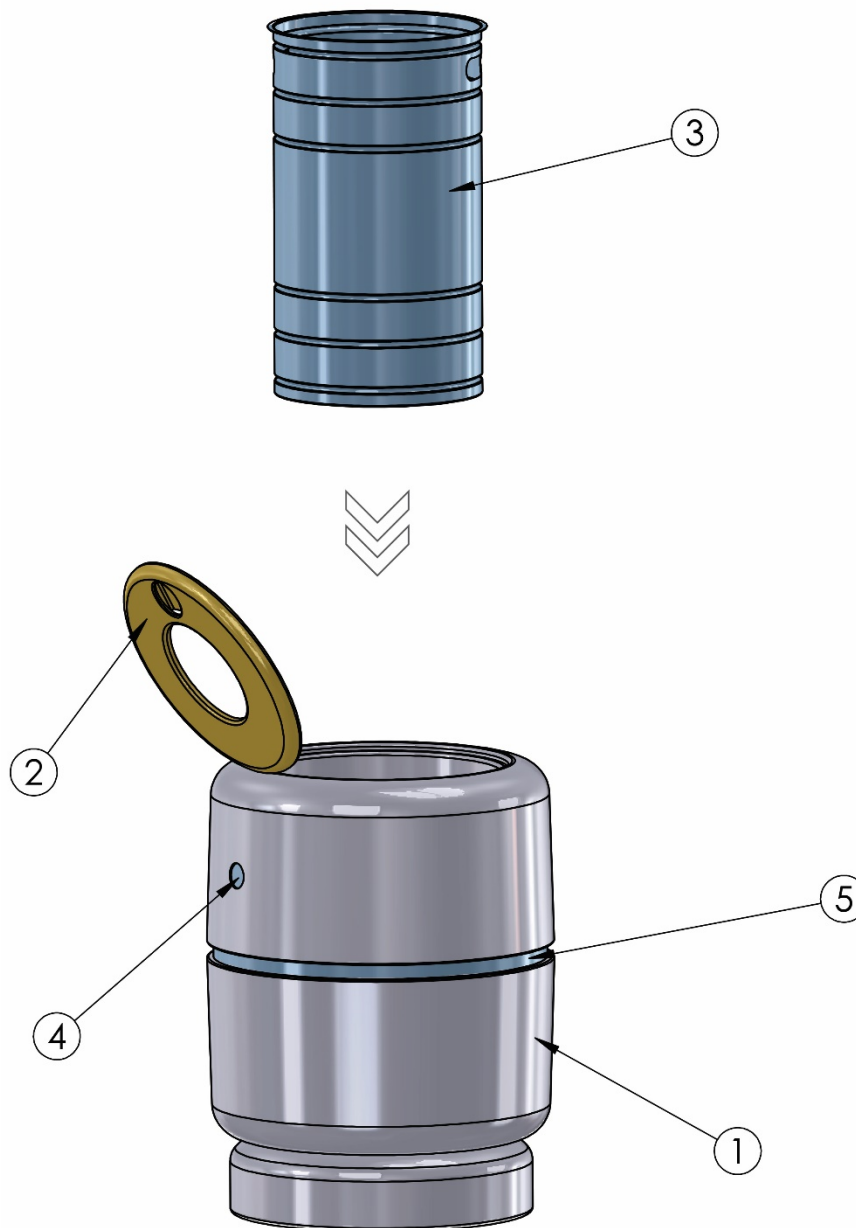

Figure 1



1.3 Description of the main materials of the product:

Concrete

High quality gray or white Portland cement is used in the production of the high-performance concrete (HPC) in combination with natural marble or granite aggregates and inert materials. The concrete structure is reinforced. Concrete is recyclable due to the absence of resins and adhesive polymeric agents.



Natural marble aggregates

The aggregates are a mixture of multi-colored, natural, marble or granite stone fractions with Portland cement and inert materials. The particles have selected structural characteristics and are available in various combinations with grey or white Portland cement, depending on their properties and requirements for the manufacture of the products. Embossed structure of the aggregate.





Steel

Processing of steel elements of different thickness and of different brands, depending on the specification of the product, goes through the following steps:

- cleaning of the steel with a shot blasting machine
- application of zinc ester-epoxide hybrid primer
- application of electrostatic solid powdered polyester

The company Encho Enchev - ETE uses polyester paints with a pearl matte effect as standard, which provide a textured opaque coating.

RAL COLORS OF METAL ELEMENTS

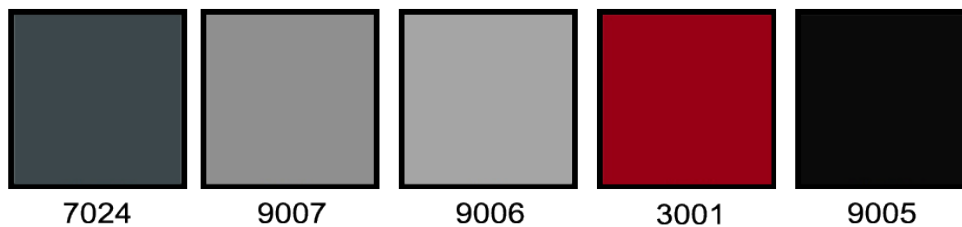

Stainless steel

Encho Enchev - ETE uses AISI 304 stainless steel.

Marking logos and all fasteners used to assemble the product are made of stainless steel.

STAINLESS STEEL

#81

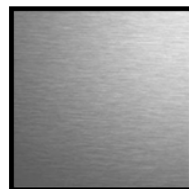

AISI 304

**1.4 Technical description of the product:****Table 1: Technical description**

Component	Dimensions	Material	Covering
Concrete body	Ø: 450 mm H: 600 mm δ: 60 mm	Concrete with marble or granite aggregates (terrazzo), Surface – embossed	Varnish - gloss (EN 1504-2)
Metal lid	Ø: 330 mm δ: 1,5 mm	Steel S 235 JR EN 10025	Ester-epoxide hybrid primer (ISO14001:2015) Electrostatic solid powdered polyester (ISO14001:2015)
Internal container	V:35 L δ: 1 mm	Steel DX51D+Z EN 10346:2015	Galvanization
Marking logos	Ø: 33 mm and Ø: 50 mm	Stainless steel AISI 304	-
Decoration strip	-	Stainless steel AISI 304	-
Fasteners (all bolts)	-	Stainless steel AISI 304	-
General dimensions	Ø: 450 mm H: 600 mm V:35 L Weight: 120 kg	-	-

**2.3.1 Regulatory references applicable to products:****Table 2**

EN 13198:2003; EN 13369:2019; EN 206:2013+A1:2016; EN 206:2013+A1:2016/ NA2017
EN 13043; EN 13139; EN 13242 EN ISO 9001:2015; EN ISO 14001:2015

2.3.2 Declared indicators of the characteristics of the concrete product:**Table 3**

Characteristic	Indicator	Test/calculation/determination method
Tolerances in nominal dimensions	± 2%, Level I	
Corrosion resistance of reinforcement	B235-S235J	EN 13198:2003, EN ISO 15630-1-2004, BDS 4758:2008 / EN10025:2004
Minimum thickness of the concrete cover	60 mm	EN 13198:2003
Concrete strength class	C60/75	EN 12390-3:2019
Environmental impact classes	XC4, XS3, XD3, XF3, XA1	EN206:2013+A1:2016/NA:2017 item NA.5.3
Watertightness	C _w 1.0	EN206:2013+A1:2016/NA:2017 item NA.5.5.3.2
Frost resistance	C _{fr} 150	EN206:2013+A1:2016/NA:2017 item NA.5.5.5



3. Construction and production drawings for Recycling litter bin Model 18

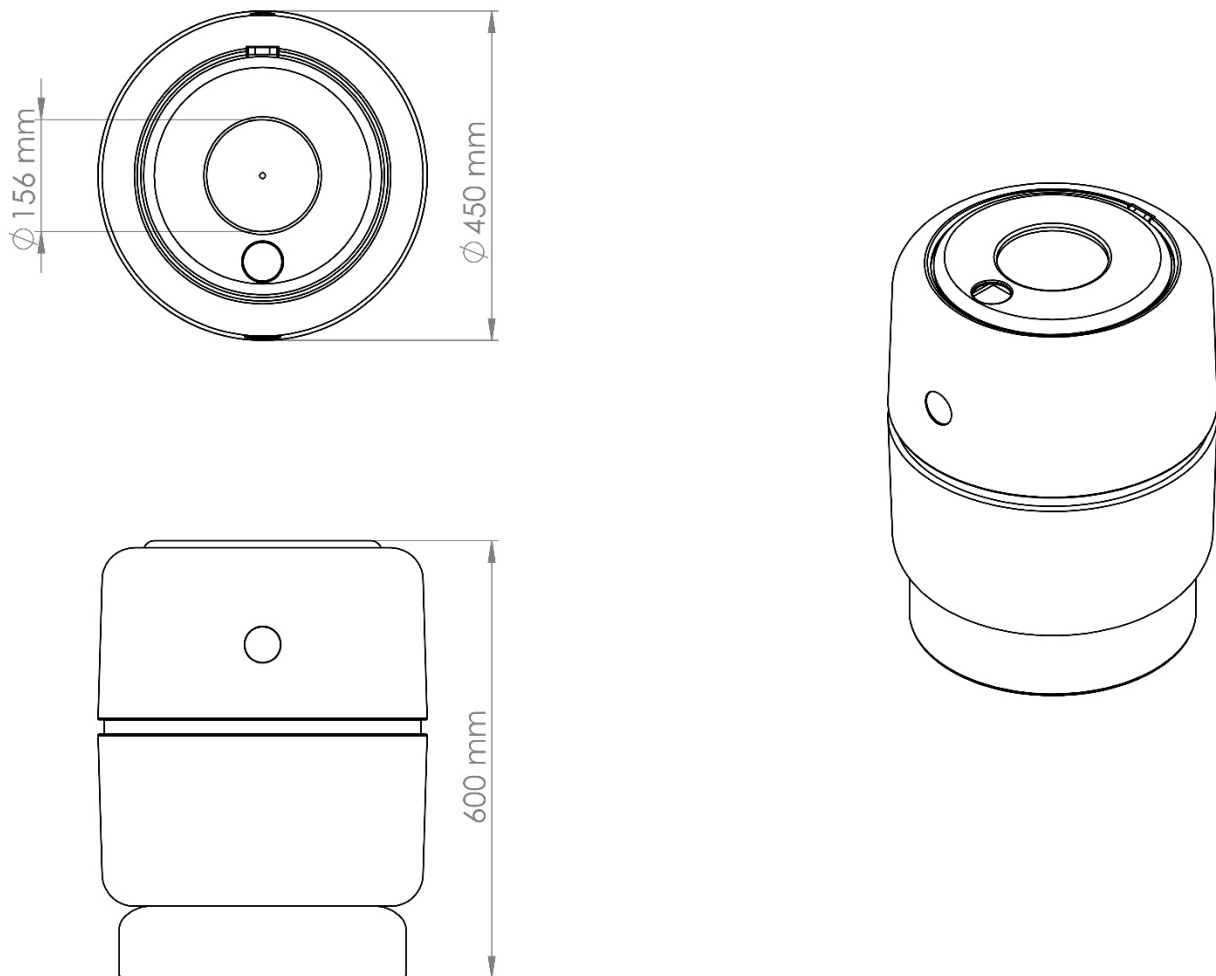

Figure 2



Figure 3 – Inner container (bucket), volume 35 liters

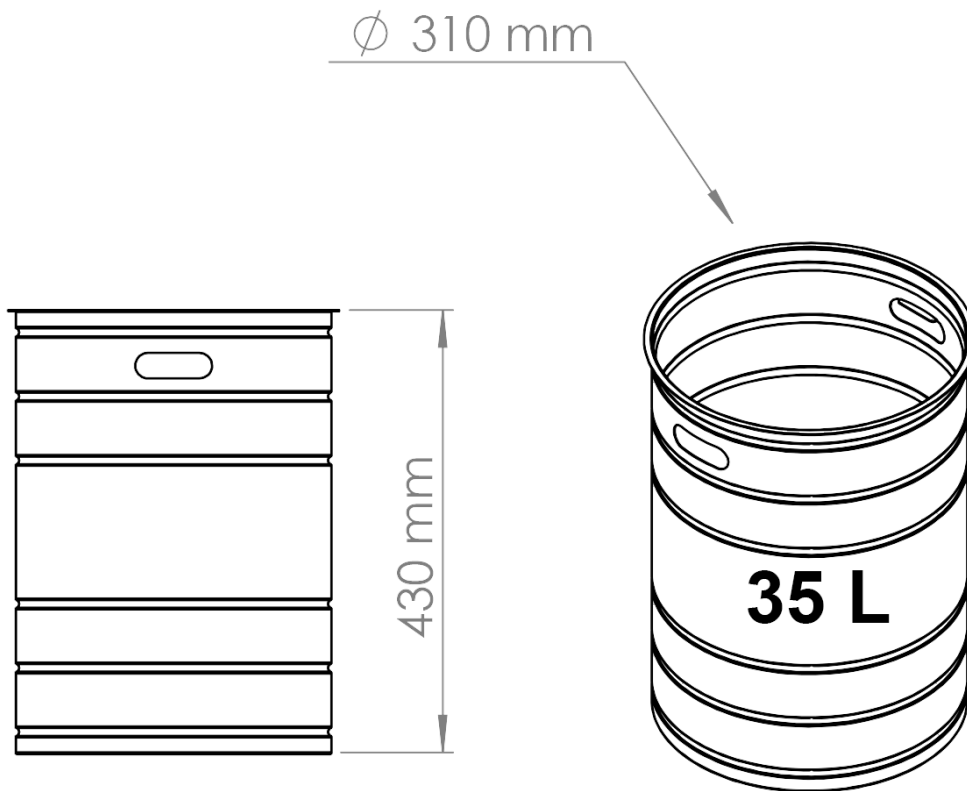

Figure 3



4. Intended use of the product

Application:

Ready-made concrete product for exterior and / or interior application in public and private areas for decorative design with practical and functional application on streets, parks, gardens, recreation areas and others. The concrete litter bin is manufactured for the purpose of household waste collection. This does not include waste with a special regime of storage and destruction (biological and chemical), waste harmful to human health and nature. Recyclable waste (plastic, glass, metal) is recommended to be disposed of in special containers. The product meets the requirements specified in standard EN 13198: 2013, EN 13369: 2019, EN 206: 2013 + A1: 2016 and is manufactured according to an assessed and certified production control system, in accordance with the requirements of EN ISO 9001: 2015 and for protection of the environment according to EN ISO 14001: 2015.

Note:

Any applications other than those specified, may result in damage to the integrity of the product as well as personal injury as a result of improper use.

The product should be serviced, cleaned and maintained by authorized persons.

Company Encho Enchev - ETE is not responsible for improper use and maintenance of the product.

Replaceable parts:

All components of the product listed in **Table 1** can be ordered from the company and replaced with new ones in case of failure.

Maintenance and support:

To keep the appearance of the product unchanged for a long period of time, we recommend that the products be cleaned. Recommendations for cleaning and maintenance can be found on the company's website.

Product recycling:

All materials used in the manufacture of this product are recyclable.



5. Additional information

This TECHNICAL DOCUMENTATION (SPECIFICATION) is issued entirely at the responsibility of the manufacturer and applies to concrete products manufactured according to an assessed and certified production control system, in accordance with the requirements of EN ISO 9001: 2015 and environmental protection requirements according to EN ISO 14001: 2015. These indicators are based on laboratory tests conducted by independent, certified laboratories.

 25 Dimitar Blagoev str.,
Dolna Oryahovitsa, Bulgaria

 +359 88 227 9759 / +359 88 227 7414

 +359 6173 2272

 sales@etebg.net

 www.etebg.net

