ECAM45X.6Y - 45X.8Y

ELETTA EXPLORE

BEAN TO CUP ESPRESSO AND
CAPPUCCINO MACHINE

Instruction for Use

Instructions videos available at:
<https://eletta-explore.delonghi.com>



DeLonghi

A

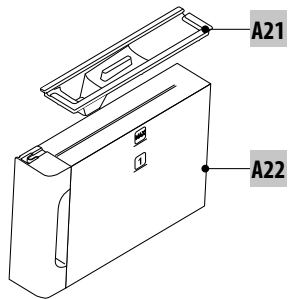
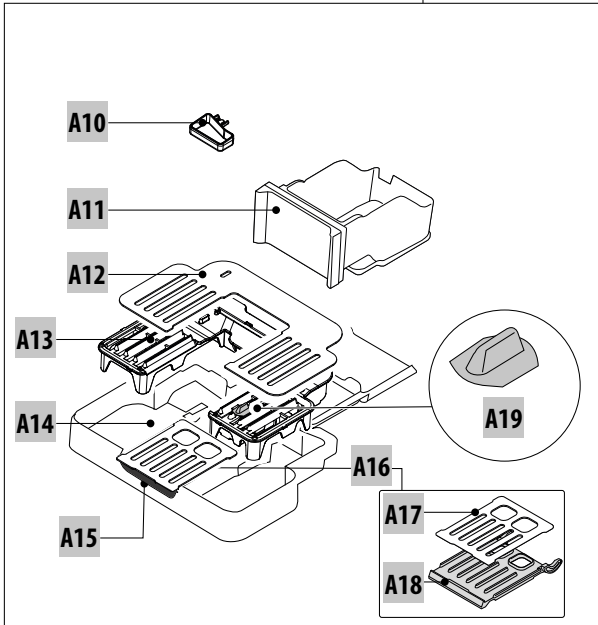
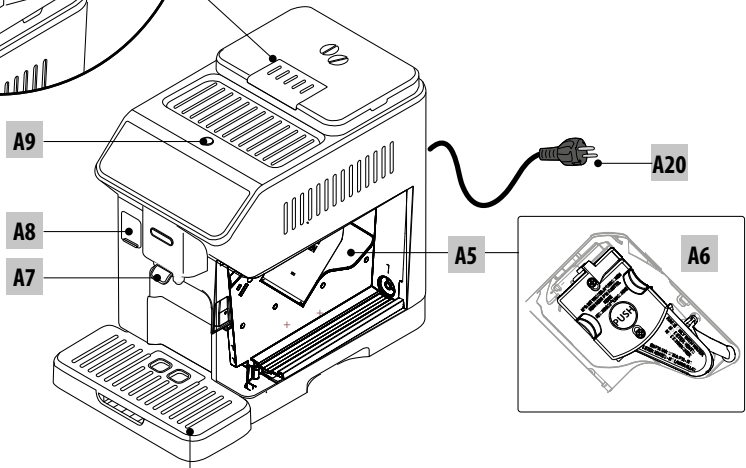
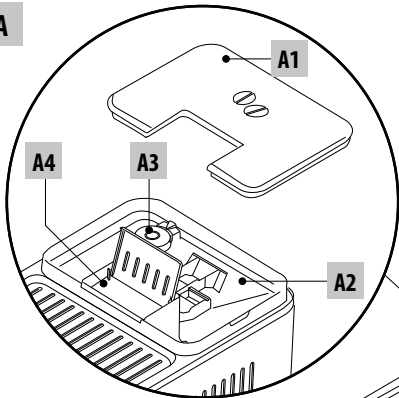

CONTENTS

1. INTRODUCTION	5
1.1 Letters in brackets.....	5
1.2 Troubleshooting and repairs.....	5
1.3 Download the App!.....	5
2. DESCRIPTION	5
2.1 Description of the appliance (A).....	5
2.2 Description of the control panel (B).....	5
2.3 Description of the homepage (main screen) (C).....	5
2.4 Description of the accessories (D) (*varies according to model).....	6
2.5 Description of milk carafe (hot) (E).....	6
2.6 Description of milk carafe (cold) (F).....	6
3. SETTING UP THE APPLIANCE ☺	6
4. TURNING THE APPLIANCE ON ☺	7
5. TURNING THE APPLIANCE OFF	7
6. MENU SETTINGS ☺	7
6.1 Rinsing	7
6.2 Descaling	8
6.3 Connectivity.....	8
6.4 Adjust grinder	8
6.5 Coffee temperature	8
6.6 Languages.....	8
6.7 Create and edit profiles	8
6.8 Set auto-off.....	9
6.9 General	9
6.10 Water filter	9
6.11 Water hardness	9
6.12 Default values	9
6.13 Drain water	9
6.14 Statistics.....	10
7. DRINK SELECTION	10
8. MAKING COFFEE DRINKS ☺	10
8.1 Prepare the machine to make coffee drinks.....	10
8.2 Directly selected drinks	11
8.3 Customising the drinks.....	11
8.4 Making coffee using pre-ground coffee.....	12
8.5 Bean Adapt Technology & Espresso SOUL ...	12
8.6 General indications for making coffee drinks... ..	12
8.7 Tips for a hotter coffee.....	13
8.8 Coffee / Cold Brew pot.....	13
8.9 Cleaning the coffee pot	13
9. MAKING MILK DRINKS ☺	14
9.1 Preparing the milk carafes (E and F).....	14
9.2 Which milk to use?.....	14
9.4 Adjusting the amount of froth.....	14
9.5 Making milk drinks.....	15
9.6 Cleaning the milk carafe after use	15
10. PREPARING HOT WATER AND HOT TEA ☺ ..	15
10.1 Preparing the appliance	15
10.2 Making hot tea.....	15
10.3 Preparing hot water	16
11. FAVOURITE DRINKS ☺	16
12. MAKING “TO GO” DRINKS ☺	16
12.1 Cleaning the travel mug after use	17
13. “MY” FUNCTION (“HOT” DRINKS ONLY) ☺ .	17
14. SELECTING YOUR PERSONAL PROFILE ☺ ..	17
15. CLEANING ☺	17
15.1 Cleaning the machine	17
15.2 Cleaning the internal circuit	18
15.3 Cleaning the coffee grounds container.....	18
15.4 Cleaning the drip tray and drip tray grille... ..	18
15.5 Cleaning the inside of the machine	19
15.6 Cleaning the water tank.....	19
15.7 Cleaning the coffee spouts	19
15.8 Cleaning the pre-ground coffee funnel	19
15.9 Cleaning the brewing unit.....	19
15.10 Cleaning the milk carafes (E) and (F).....	20
16. DESCALING ☺	21
17. SETTING WATER HARDNESS	22
17.1 Measuring water hardness	22
17.2 Setting water hardness	22
18. WATER SOFTENER FILTER	22
18.1 Installing the filter	22
18.2 Replacing or removing the filter.....	23
19. TECHNICAL DATA	23
19.1 Tips for Energy Saving	23
20. DISPLAYED MESSAGES	24
21. TROUBLESHOOTING	27

1. INTRODUCTION

Thank you for choosing this bean to cup espresso and cappuccino machine.

Take a few minutes to read this Instruction for Use. This will avoid all risks and damage to the appliance.

1.1 Letters in brackets

The letters in brackets refer to the description of the appliance on pages 2- 3.

1.2 Troubleshooting and repairs

In the event of problems, first try and resolve them by reading the information given in sections "20. Displayed messages" and "21. Troubleshooting".

If this does not resolve the problem or further information is required, consult the customer services department at the numbers indicated on the website www.delonghi.com.

If repairs are required, contact De'Longhi customer services only. Addresses can be found on the website www.delonghi.com.

1.3 Download the App!



Download the App then follow the instructions in the App to create your account.

In the App, you can find creative recipes, information, tips and curious facts about the world of coffee, together with information on your machine at your fingertips.

MAKE SURE THAT THE APP IS AVAILABLE IN YOUR COUNTRY:

app-availability.delonghi.com

In connected models, you can manage a number of functions remotely from the Coffee Link App.

 This symbol highlights the functions you can control or consult using the App.

You can also create new drinks and save them in your appliance.

Please note:

- To access the functions from the App, enable connectivity from the appliance's settings menu (see "6.3 Connectivity").
- Check compatible devices on "compatibledevices.delonghi.com".

2. DESCRIPTION







2.1 Description of the appliance (A)

- A1. Beans container lid
- A2. Beans container
- A3. Grinding coarseness regulator
- A4. Pre-ground coffee funnel
- A5. Brewing unit flap
- A6. Removable brewing unit
- A7. Coffee spouts (adjustable height)
- A8. Accessories connector
- A9.  button: turns the appliance on and off (standby)
- A10. Coffee grounds container
- A11. Condensate tray
- A12. Cup tray
- A13. Tray grille
- A14. Drip tray
- A15. Travel mug compartment
- A16. Travel mug compartment flap assembly
- A17. Flap grille
- A18. Flap grille support
- A19. Drip tray water level indicator
- A20. Power cord
- A21. Water tank lid
- A22. Water tank

2.2 Description of the control panel (B)

- B1. "Cold" drinks menu
- B2. "To go" drinks menu
- B3. "Hot" drinks menu
- B4. "Favourites" drinks menu

2.3 Description of the homepage (main screen) (C)

- C1. Selectable drinks (direct selection)
- C2. To display and customise the drink settings
- C3. Appliance settings menu
- C4. Indicator lights:
 -  Machine waiting for first connection
 -  Wi-Fi active light
 -  No network light
 -  Energy saving active light
 -  Milk carafe cleaning required light
 -  Descaling required light
 -  Filter exhausted light
- C5. Bean Adapt Technology (enable from App): see "8.5 Bean Adapt Technology & Espresso SOUL"
- C6. Customisable profiles (see "14. Selecting your personal profile")

2.4 Description of the accessories (D) (*varies according to model)

Accessories in the Starter pack:

- D1. "Total Hardness Test" indicator paper
- D2. Pre-ground coffee measure
- D3. Descaler
- D4. Water softener filter
- D5. Cleaning brush
- D6. Hot water spout
- D7. Ice cube tray

- D8. Coffee pot
- D9. Travel mug

2.5 Description of milk carafe (hot) (E)



- E1. Milk carafe lid
- E2. Milk carafe
- E3. Froth adjustment/Clean dial
- E4. Milk carafe connector (removable for cleaning)
- E5. Milk spout (adjustable height)
- E6. Milk intake tube (silicone)
- E7. Milk spout extension

2.6 Description of milk carafe (cold) (F)



- F1. Milk carafe lid
- F2. Milk carafe
- F3. Froth adjustment/Clean dial
- F4. Milk carafe connector (removable for cleaning)
- F5. Milk spout
- F6. Milk intake tube (rigid plastic)

3. SETTING UP THE APPLIANCE

Please note:

- Possible traces of coffee in the grinder are the result of settings tests performed on the appliance before sale, proof of the meticulous care and attention we invest in our products.
- The first time you use the appliance, all removable accessories (milk carafe (E) and (F), travel mug* (D9), coffee pot* (D8), water tank (A21) and (A22)) destined to come into contact with water or milk should be rinsed with hot water. We recommend washing the milk carafes in a dishwasher.
- You should customise water hardness as soon as possible following the instructions in section "17. Setting water hardness".

1. Connect the power cord (A20) to the mains supply (fig. 1).

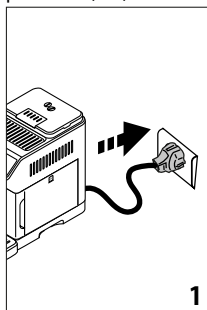

2. Press the flag corresponding to the desired language and confirm the selection by pressing "Done".

Now follow the instructions indicated on the display of the appliance:

3. Remove the water tank (A22) (fig. 2) and fill to the MAX line with fresh potable water (fig. 3);

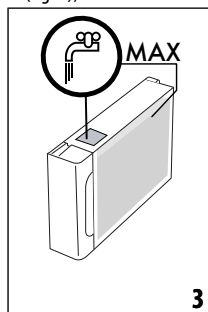
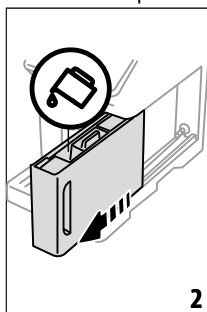

4. Then put the tank back and confirm by pressing "Next";
5. Fill the beans container (A2) (fig. 4), then confirm by pressing "Next".

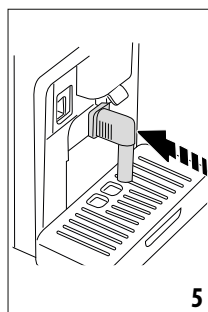
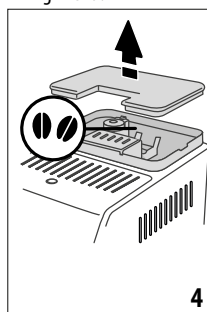

6. Insert the hot water spout (D6) on the accessories connector (A8) (fig. 5) and place a container with a minimum capacity of 200 ml under the coffee spouts (A7) and hot water spout (fig. 6);

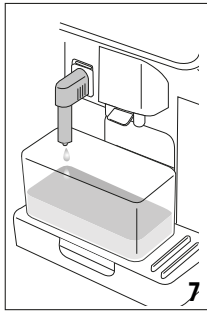
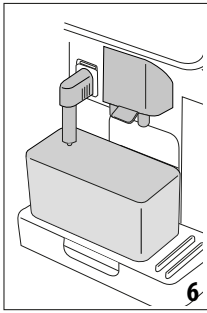

7. Press "OK" to fill the water circuit. The appliance delivers water from the hot water spout (fig. 7);
8. At the end of delivery, the appliance proceeds to warm up by performing a rinse cycle, delivering hot water from the coffee spouts (fig. 8).

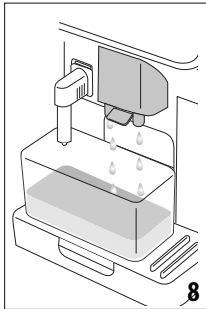

When at temperature, the appliance proposes a tutorial on how to use the machine.

Please note:

- The first time you use the appliance, you need to make 4-5 cappuccinos before the results in the cup will be satisfactory.
- The first time you use the machine, the water circuit is empty and the appliance could be very noisy. The noise becomes less as the circuit fills.

4. TURNING THE APPLIANCE ON

Please note:

- Each time the appliance is turned on, it performs an automatic preheat and rinse cycle which cannot be interrupted. The appliance is not ready for use until the cycle has been completed.
1. To turn the appliance on, press the  button (A9) (fig. 9): the appliance comes on

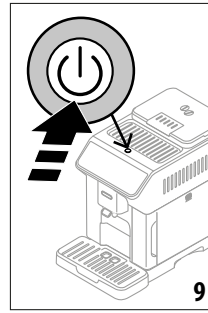

2. When at temperature, the appliance performs a rinse cycle delivering hot water from the coffee spouts (A7); as well as heating the boiler, this also heats the internal circuits by circulating hot water.

5. TURNING THE APPLIANCE OFF

Whenever the coffee machine is turned off after being used to make coffee, it performs an automatic rinse cycle.

1. To turn the appliance off, press the  button (A9) (fig. 9).
2. If envisaged, the appliance rinses the coffee spouts (A7) with hot water, then goes off (stand-by).

Please note:

If you will not be using the appliance for some time, turn off, then unplug from the mains socket.

Important!

Never unplug while the appliance is on.

6. MENU SETTINGS

6.1 Rinsing

Use this function to deliver hot water from the coffee spouts (A7) (and, if inserted, the hot water spout (D6)), to clean and heat the appliance's internal circuit.

Place a container with a minimum capacity of 100 ml under the spouts (fig. 6).

To enable the function, proceed as follows:

1. Press the settings menu (C3);
2. Display "Rinsing";
3. Press "OK" to start delivery. After a few seconds, hot water is delivered to clean and heat the appliance's internal circuit (fig. 7- 8);
4. To stop rinsing, press "Stop" or wait for rinsing to stop automatically.

Please note:

- If the appliance is not used for more than 3-4 days, when you turn it on again, we strongly recommend performing 2-3 rinses before use;
- After cleaning, it is normal for the grounds container (A10) to contain water.

6.2 Descaling





For instructions on descaling, see section “16. Descaling”.

6.3 Connectivity

Use this function to enable or disable connectivity. Proceed as follows:

1. Press the settings menu (C3);
2. Scroll through the pages until “Connectivity” is displayed;
3. Press “Next”;
4. Enable the Wi-Fi connection and remote control (via the De’Longhi Coffee Link App);
5. The appliance PIN, needed to connect to the App, is displayed on the screen;
6. Press “<” to save the new selection and go back to the settings menu;
7. Press “X” to go back to the homepage (C).

On the homepage, the symbol (C4) indicating the connection status alternates with the other symbols (e.g. descaling, etc.)

Symbol on homepage	Meaning
 White symbol on grey background	Connectivity enabled: the machine is waiting for the first connection
 White symbol on blue background	The appliance is connected
 Red symbol on blue background	The appliance is connected to the home Wi-Fi, but there is no network
 White symbol on grey background	The cloud is not reachable
No symbol	The connection is deactivated. To activate it, enter the Settings menu (C3)

Please note:

- If the remote connection is off, a number of the App’s functions will not be available (e.g. drink preparation).
- If you change the name or password of the Wi-Fi network, or if you connect to a new Wi-Fi network, you will need to perform the reset procedure as described below:
 1. Proceed as described above from point 1 to point 3;
 2. Press “Reset”;
 3. Press “OK” to confirm cancellation of the network settings;
 4. Connect with the App again and select the new credentials.

6.4 Adjust grinder

The appliance proposes a tutorial on how to adjust grinding correctly for best results:

1. Press the settings menu (C3);
2. Scroll through the pages until “Adjust grinder” is displayed;

3. Press “Read more” to consult the tutorial on how to adjust the grinding coarseness.

Please note:

- After carrying out the above procedure, we recommend making at least 3 coffees before adjusting again. If the coffee is still not brewed correctly, repeat the procedure.
- The grinding coarseness regulator (A3) must only be turned when the coffee grinder is in operation during the initial phase of coffee preparation.

Bean Adapt Technology

We suggest you access Bean Adapt Technology in the Coffee Link App to adjust this parameter to an appropriate setting for the coffee beans used.

6.5 Coffee temperature

To change the temperature of the water used to make the coffee, proceed as follows:

1. Press the settings menu (C3);
2. Scroll through the pages until “Coffee temperature” is displayed;
3. Press “Set”;
4. Select the required temperature from those proposed;
5. Press “<” to save the new selection and go back to the settings menu.
6. Press “X” to go back to the homepage (C).

Please note:

Varying the temperature has most effect for long drinks.

Bean Adapt Technology

We suggest you access Bean Adapt Technology in the Coffee Link App to adjust this parameter to an appropriate setting for the coffee beans used.

6.6 Languages

To change the language on the homepage, proceed as follows:

1. Press the settings menu (C3);
2. Scroll through the pages until “Languages” is displayed;
3. Press “Next”;
4. Press the flag corresponding to the language you want to set (press “Next” or “Back” to display all the languages available). The display is immediately updated with the selected language;
5. Press “<” to save the new selection and go back to the settings menu;
6. Press “X” to go back to the homepage (C).

6.7 Create and edit profiles

You can use this function to modify the image and colour of the icon for each profile. To customise the icon, proceed as follows:

1. Press the settings menu (C3);
2. Scroll through the pages until “Create and edit profiles” is displayed;

3. Press "Next";
4. To create a new profile, press "Add new";
To edit an existing profile, select the profile and press "Edit";
5. Customise as you wish, then press "Save" to confirm.
6. Press "X" to go back to the homepage (C).

6.8 Set auto-off

Auto-off can be set so that the appliance goes off after 15 or 30 minutes, or 1 or 3 hours of inactivity.

To programme auto-off, proceed as follows:

1. Press the settings menu (C3);
2. Scroll through the pages until "Set auto-off" is displayed;
3. Select the desired time interval (15 or 30 minutes, or 1 or 3 hours).
4. Press "X" to save the new selection and go back to the homepage (C).

6.9 General

1. Press the settings menu (C3);
2. Scroll through the pages until "General" is displayed;

Here you can enable or disable the following functions with a simple touch:

- "Beep sound": when enabled, the appliance beeps whenever an operation is performed.
 - "Energy saving": use this function to enable or disable energy saving. When enabled, the function reduces energy consumption in compliance with European regulations.  is displayed on the homepage to show it is active.
3. Press "X" to save the new selection and go back to the homepage (C).

6.10 Water filter

For instructions on the filter (D4), see section "18. Water softener filter".

6.11 Water hardness

For instructions on setting water hardness, see section "17. Setting water hardness".

6.12 Default values

This resets all menu settings and user customisation back to the default values (with the exception of the language, which remains as set, and the statistics).

Proceed as follows:

1. Press the settings menu (C3);
2. Scroll through the pages until "Default values" is displayed;
3. Press "Next";
4. Select whether you want to reset the entire appliance or a single profile, then press "Next";
5. Follow the instructions, then confirm the reset by pressing "OK".
6. Press "X" to go back to the homepage (C).

Please note:

When the appliance (not the individual profile) has been reset to the default values, the machine proposes the introductory tutorial again.

6.13 Drain water

To avoid the water in the circuit freezing if the appliance is to be left idle for a long period of time, or before taking it to customer services, we recommend emptying the water circuit.

Proceed as follows:

1. Press the settings menu (C3);
2. Scroll through the pages until "Drain water" is displayed;
3. Press "OK" to start the guided procedure;
4. Extract, empty and replace the grounds container (A10) and drip tray (A14) (fig. 10), then press "Next";

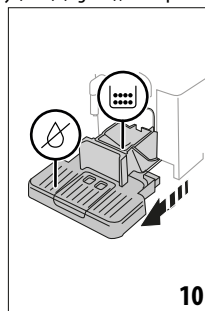

5. Insert the spout (D6) on the connector (A8) (fig. 5);
6. Position a 100 ml container under the spouts (fig. 6). Press "Next";
7. The appliance performs a rinse cycle with hot water from the spouts;
8. At the end of rinsing, extract the water tank (A22) (fig. 11) and empty;
9. If present, remove the water softener filter (D4) from the water tank and press "Next";

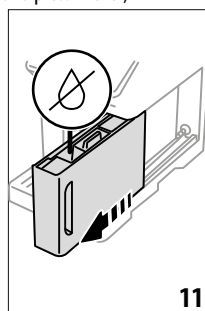

10. Put the empty water tank back in the appliance and press "Next";
11. Wait for the appliance to empty the circuit; (Important: hot water from the spouts!). As the water circuit empties,

the appliance could become noisier. This is part of normal operation.

- When the circuit is empty, extract and empty the drip tray, put back in the appliance and press “Next”;
- Press “OK”. The appliance goes off (standby).

The next time the appliance is turned on, follow the instructions in section “3. Setting up the appliance”.

6.14 Statistics

This displays statistics relating to the machine. To view the statistics, proceed as follows:

- Press the settings menu (C3);
- Scroll through the pages until “Statistics” and the principal statistics are displayed. To view more information, press “Read more”;
- Press “<” to go back to the settings menu.

7. DRINK SELECTION

You can use your machine to make a great variety of drinks.

 the drinks indicated by this symbol are also available in the “To Go” menu.

	Hot	 COLD EXTRACTION TECHNOLOGY	Cold
Espresso	✓	✗	✓
2X Espresso	✓	✗	✗
Coffee	✓	✗	✗
Doppio+	✓	✗	✗
Long	✓	✗	✗
Americano 	✓	✗	✓
Coffee pot	✓	✗	✗
Cold Brew 	✗	✓	✗
Cold Brew Pot	✗	✓	✗
Cold Brew to Mix	✗	✓	✗
Cold Brew Latte 	✗	✓	✗
Cold Brew Cappuccino 	✗	✓	✗
→			

	Hot	 COLD EXTRACTION TECHNOLOGY	Cold
Coffee 	✗	✗	✓
Cappuccino 	✓	✗	✓
Latte Macchiato 	✓	✗	✓
Caffelatte 	✓	✗	✓
Cappuccino Mix 	✓	✗	✓
Espresso Macchiato	✓	✗	✗
Flat White 	✓	✗	✓
Cappuccino +	✓	✗	✗
Cortado	✓	✗	✗
Milk 	✓	✗	✓
Tea function	✓	✗	✗
Hot water	✓	✗	✗

From the panel, access the type of drink you want to make (Hot, Cold, To Go-In Travel Mug) and fit the necessary accessories.

8. MAKING COFFEE DRINKS

8.1 Prepare the machine to make coffee drinks **Important!**

Do not use green, caramelised or candied coffee beans as they could stick to the coffee grinder and make it unusable.

- Place 1 or 2 cups under the coffee spouts (A7);
- Lower the spouts as near as possible to the cup (fig. 12). This makes a creamier coffee.

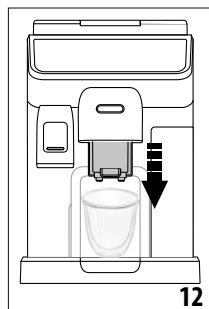

8.2 Directly selected drinks

1. Press the image on the homepage (C) corresponding to the coffee you want to make (C1) (e.g. espresso, fig. 13);

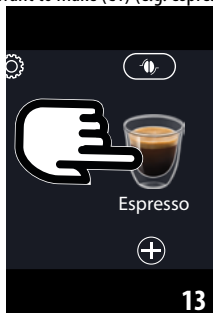

2. **Hot coffee drink:** the appliance starts preparation.

Cold Extraction Technology:

- Select the desired intensity: "Original" or "Intense", then press "Next";
- Before delivery, the appliance suggests the quantity of ice cubes. Add the quantity of ice cubes indicated to the glass (fig. 14), then press "Brew".



- The appliance starts making the drink and a description of each individual phase (grinding, preparing and brewing coffee) appears on the display.

Please note:

- Coffee Extraction Technology is a slow extraction: therefore it will take some minutes.
- Before serving Cold Brew beverages, empty out the water tank, rinse thoroughly and refill with fresh potable water.
- When making Cold Brew drinks after hot preparations, the machine recommends a cold rinse to optimise the temperature of the drink. In this case, proceed making the rinse in a container or skip the tip.

Other cold coffee drinks:

- Select to make an "Ice" or "Extra Ice" drink: press "Next";
- Depending on the previous selection, before delivery, the appliance suggests the quantity of ice cubes. Add

the quantity of ice cubes indicated to the glass (fig. 14), then press "Brew".

- The appliance starts preparation.

A description of each individual phase (grinding, brewing coffee) appears on the display.

At the end of preparation, the appliance is ready to make the next drink.

8.3 Customising the drinks

To make coffee drinks with customised parameters, proceed as follows:

1. Press (+) (C2) at the bottom of the image corresponding to the coffee you want to make (e.g. espresso, fig. 15). The parameters that can be customised according to taste appear on the display:

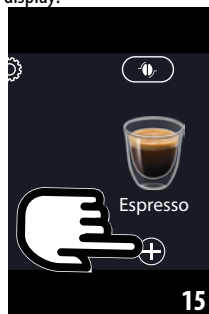

Size	
Intensity	

2. **Hot coffee drink:** After setting the parameters, press "Brew". The appliance starts making the drink and a description of each individual phase (grinding, brewing coffee) appears on the display;

Cold Extraction Technology: Set the size, then press "Start" and proceed as follows:

- Select the desired intensity: "Original" or "Intense", then press "Next";
- Before delivery, the appliance suggests the quantity of ice cubes. Add the quantity of ice cubes indicated to the glass (fig. 14), then press "Brew".
- The appliance starts making the drink and a description of each individual phase (grinding, preparing and brewing coffee) appears on the display.

Please note:

- Coffee Extraction Technology is a slow extraction: therefore it will take some minutes.

- Before serving Cold Brew beverages, empty out the water tank, rinse thoroughly and refill with fresh potable water.
- When making Cold Brew drinks after hot preparations, the machine recommends a cold rinse to optimise the temperature of the drink. In this case, proceed making the rinse in a container or skip the tip.

Other cold coffee drinks: Set the parameters, then press “Start” and proceed as follows:

- Select whether to make an “Ice” or “Extra Ice” drink, then press “Next”;
 - Depending on the previous selection, before delivery, the appliance suggests the quantity of ice cubes. Add the quantity of ice cubes indicated to the glass (fig. 14), then press “Brew”.
 - The appliance starts making the drink and a description of each individual phase (grinding, brewing coffee) appears on the display.
3. At the end of delivery, press “Save” to save the new settings, or “Cancel” to retain the previous parameters.

Please note:

If you save the new settings, they are memorised ONLY in the selected profile.

4. Press “X” to go back to the homepage (C).
The appliance is ready to be used again.

8.4 Making coffee using pre-ground coffee

Important!

- Never add pre-ground coffee when the machine is off or it could spread through the inside of the machine and dirty it. This could damage the machine.
- Never use more than 1 level measure (D2) as it could soil the inside of the coffee machine or block the funnel (A4).

When using pre-ground coffee, only one cup can be made at a time.

- Making **Long** coffee: halfway through preparation, when requested by the appliance, add one level measure of pre-ground coffee and press “OK”.
 - You cannot make **Doppio+, 2x Espresso, Coffee Pot, Cappuccino+ and Cold Brew** drinks using pre-ground coffee.
1. Press **+** (C2) at the bottom of the image corresponding to the coffee you want to make (e.g. espresso, fig. 15). The parameters that can be customised according to taste appear on the display;
 2. Select the quantity and pre-ground coffee **☉** ;
 3. Press “Brew”;
 4. Lift the pre-ground coffee funnel lid, make sure the funnel (A4) is not blocked, then add one level measure (D2) of pre-ground coffee (fig. 16). Press “OK” to make the drink;

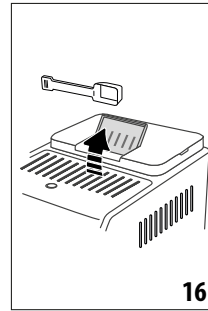

5. The appliance starts making the drink and a description of each individual phase (grinding, brewing coffee) appears on the display.

At the end of preparation, the appliance is ready to make the next drink.

8.5 Bean Adapt Technology & Espresso SOUL

A coffee expert at your fingertips to help you optimise coffee brewing and the result in your cup in just a few steps.

The smart technology guides you to adjust the machine according to the coffee beans used - from grinding coarseness to brewing, each phase will be regulated to get the best results from the coffee bean.

Download and open the Coffee Link App to find out more.

Once the settings have been saved in the “Bean Adapt Technology” section of the App, you can use the “Espresso SOUL” (C1) drink on the homepage (C).

To make espresso coffee, follow the instructions in section “8.2 Directly selected drinks”.

Please note:

You can modify the quantity of the “Espresso SOUL” drink as described in section “8.3 Customising the drinks”.

8.6 General indications for making coffee drinks

- A quantity of water above level 1 is sufficient to complete most drinks. Always filling above level 1 allows the appliance to estimate the amount of water available to make the drinks.
- While the machine is making the coffee, preparation can be interrupted at any moment by pressing “Stop” or “Cancel”.
- As soon as delivery has ended, to increase the quantity of coffee, just press “Extra”. When the required quantity is reached, press “Stop” or “Cancel”.
- Various alarm messages could be displayed while using the appliance (“Please fill the tank with fresh water up to MAX level” etc.). Their meaning is explained in section “20. Displayed messages”.
- **Cold Extraction Technology:** for best results when preparing Cold Brew beverages, fill the water tank with fresh potable water.

- If the coffee is delivered a drop at a time, too weak and not creamy enough, or too cold, consult the tutorial on how to adjust grinding (see section “6.4 Adjust grinder”) and section “21. Troubleshooting”.
- If “Energy Saving” mode is activated, there may be a few seconds delay before the first coffee is delivered.

8.7 Tips for a hotter coffee

To make a hotter coffee, proceed as follows:

- perform a hot rinse cycle before making hot drinks (section “6.1 Rinsing”);
- warm the cups with hot water using the hot water function (see section “10. Preparing hot water and hot tea”);
- increase the coffee temperature (section “6.5 Coffee temperature”).

8.8 Coffee / Cold Brew pot

Coffee Pot and Cold Brew Pot are two coffee drinks to enjoy in company: Coffee Pot is based on Espresso, light and balanced, with a fine layer of crema; Cold Brew Pot is based on the Cold Brew drink, for a refreshing moment to share.

Optional accessory in certain models:	
	Pot (capacity 1 litre)
	Type: DLSC021
	EAN: 8004399333642

To make the drink, proceed as follows:

1. On the homepage (C), press the image corresponding to the “Pot” drink you desire (C1);
2. Selection of the number of cups to make and the desired intensity;

Number of cups	Number of grindings	Total quantity (ml)*	
		Coffee Pot	Cold Brew Pot
2	2	250	240
3	3	375	360
4	4	500	480
5	5	625	600
6	6	750	720

* The quantities indicated are approximate and may vary according to the type of coffee.

3. Press “Start” to move on to the next step;

4. Hot Coffee Pot:

- Fill the tank (A22) with water and fill the beans container (A2) as instructed on the display (fig. 17).

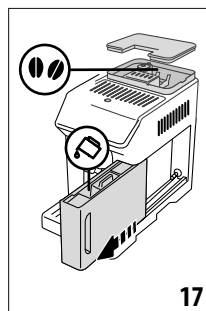

- Once you have made sure there is sufficient water and coffee for the drinks you want to prepare, press “Next”;

Cold Brew Pot:

Please note:

Before serving Cold Brew beverages, empty out the water tank, rinse thoroughly and refill with fresh potable water.

- Select the desired intensity: “Original” or “Intense”; then press “Next”;
 - Fill the tank (A22) with water and fill the beans container (A2) as instructed on the display (fig. 17).
 - Once you have made sure there is sufficient water and coffee for the drinks you want to prepare, press “Next”;
5. Place the coffee pot (D8) under the coffee spouts (A7). Press “Brew”;
 6. The appliance starts making the drink with an appropriate number of grindings for the number of cups to be prepared and a description of each individual phase (grinding, brewing coffee) appears on the display.

Please note:

“Cancel” or “Stop”: press to stop preparation completely and go back to the homepage.

7. When delivery has ended, press “Save” to save the new settings, or “Cancel” to retain the previous parameters.

8. Press “X” to go back to the homepage (C).

The appliance is ready to be used again.

Please note:

If you save the new settings, they are memorised ONLY in the selected profile.

SAFETY WARNING:

After making a pot of hot coffee, leave the appliance to cool for 5 minutes before making another drink. Risk of overheating!

8.9 Cleaning the coffee pot

After each use, you should clean the coffee pot (D8) with hot water and mild washing up liquid.

Rinse thoroughly with hot water to eliminate all detergent residues. The coffee pot is dishwasher safe.

9. MAKING MILK DRINKS ☺

9.1 Preparing the milk carafes (E and F)

Please note:

To avoid milk with poor froth or large bubbles, always clean the milk carafes as described in sections “9.6 Cleaning the milk carafe after use” and “15.10 Cleaning the milk carafes (E) and (F)”.

9.2 Which milk to use?

The quality of the froth will vary depending on:

- the temperature of the milk or plant-based drink (for best results, always use milk or plant-based drinks at refrigerator temperature (5°C);
- type of milk or plant-based drink;
- brand used;
- ingredients and nutritional value.

	LatteCrema HOT ☺	LatteCrema COOL ❄️
Cow's milk		
Whole (fat content >3.5%)		✗
Partially skimmed (fat content between 1.5 and 1.8%)	✓	✗
Skimmed (fat content < 0.5%)		✓
Plant-based drinks		
Soy	✓	✓
Almond	✓	✓
Oat	✓	✓

9.3 Filling and attaching the milk carafes

1. Lift the lid (E1) or (F1) (fig. 18);

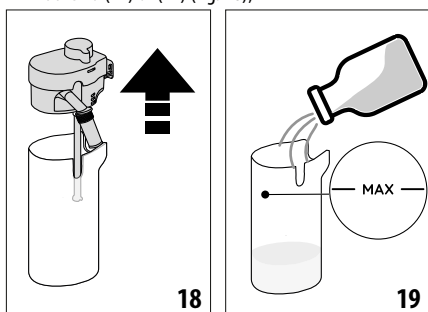

2. Fill the milk carafe (E2) or (F2) with a sufficient quantity of milk, not exceeding the MAX level marked on the carafe (fig. 19);

3. Make sure the milk intake tube (E6) or (F6) is correctly inserted on the bottom of the milk carafe lid (fig. 20);

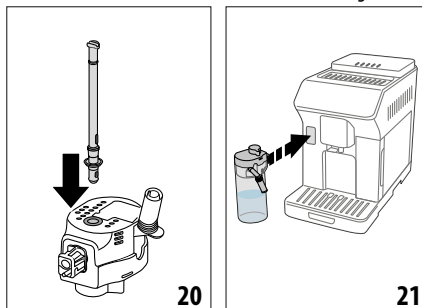



4. Put the lid back on the milk carafe;
5. Attach the carafe to the connector (A8) and push as far as it will go (fig. 21). The machine emits a beep (if the function is enabled);
6. Place a sufficiently large cup under the coffee spouts (A7) and milk spout (E5) or (F5). Only the milk spout (E5) can be lengthened by adjusting the extension;
7. Select the drink you want to make as described in the following paragraphs.

Please note:

If “Energy Saving” mode is enabled (see section “6.9 General”), you may have to wait a few seconds before the appliance makes the drink.

9.4 Adjusting the amount of froth

Turn the froth adjustment dial (E3) or (F3) to adjust the amount of froth on the milk delivered while making milk drinks.

Dial position	Recommended for . . .		
	Hot	 COLD EXTRACTION TECHNOLOGY	Cold
 MIN froth	<ul style="list-style-type: none"> • Caffelatte • Hot milk (not frothed) 	--	<ul style="list-style-type: none"> • Caffelatte
 MED froth	<ul style="list-style-type: none"> • Latte • Macchiato • Flat White • Cortado 	<ul style="list-style-type: none"> • Cold Brew Latte 	<ul style="list-style-type: none"> • Latte • Macchiato • Flat White

 MAX froth	<ul style="list-style-type: none"> • Cappuccino • Cappuccino Mix • Espresso Macchiato • Cappuccino + • Hot milk (frothed) 	<ul style="list-style-type: none"> • Cold Brew Cappuccino 	<ul style="list-style-type: none"> • Cappuccino • Cappuccino Mix • Cold milk (frothed)

9.5 Making milk drinks

On the homepage (C), press the image corresponding to the drink you want to make (C1).

As for coffee drinks, you can make a customised drink by pressing the  (C2) symbol at the bottom of the image on the homepage.

9.6 Cleaning the milk carafe after use

Each time you deliver a milk drink, the appliance asks you to perform the CLEAN function to clean the milk carafe lid (E1) or (F1). To start cleaning, proceed as follows:

1. Leave the milk carafe in the machine (you do not need to empty it);
2. Place a cup or other recipient under the milk spout (E5) or (F5) (fig. 22);

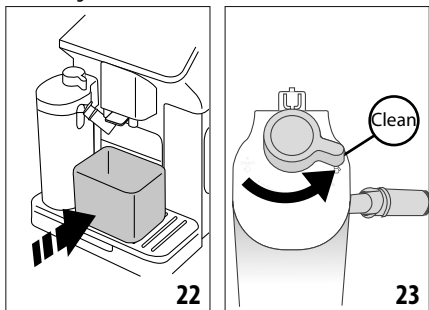

3. Turn the froth adjustment/clean dial (E3) or (F3) to "Clean" (fig. 23). Hot water and steam are delivered from the milk spout. Cleaning stops automatically;
4. Turn the dial back to one of the froth selections;



If you want to make a number of drinks in succession:

- To proceed with making the next drinks, when the "Clean" message is displayed, press "Cancel". Clean the milk carafe after making the last drink.

At the end of preparation, the milk carafe is empty, or there is not enough milk for other drinks

- After cleaning using the "Clean" function, extract the milk carafe and clean all the components as described in section "15.10 Cleaning the milk carafes (E) and (F)"

At the end of preparation, there is enough milk left in the carafe for other drinks

- After cleaning using the "Clean" function, extract the milk carafe and place it immediately in the refrigerator. The "HOT" carafe  can be kept in the refrigerator for no more than 2 days; the "COOL" carafe  can be kept in the refrigerator for no more than 1 day; then all the components should be cleaned as described in section "15.10 Cleaning the milk carafes (E) and (F)".

Important:

If the milk carafe has been left out of the refrigerator for more than **30 minutes**, disassemble and clean all the components as described in section "15.10 Cleaning the milk carafes (E) and (F)".

General notes after making milk drinks:

- If you do not clean the milk carafe, the  symbol appears on the homepage to remind you that it needs cleaning.
- In certain cases, the appliance will need to warm up before the carafe can be cleaned.
- To ensure correct cleaning, wait for the CLEAN function to end. The function is automatic. It must not be interrupted while underway.

10. PREPARING HOT WATER AND HOT TEA

10.1 Preparing the appliance

1. Insert the hot water spout (D6) in the machine (fig. 5);
2. Place a cup under the spout;

To use tall glasses:

- lift the flap (A16) (fig. 24) and place the glass in the compartment (A15);
- turn the water spout (fig. 25).

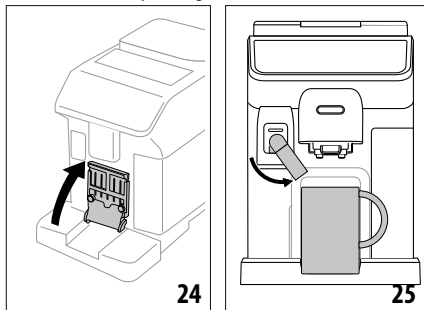

10.2 Making hot tea

1. On the homepage (C), press the image corresponding to tea (C1);
2. Adjust the quantity and temperature;
3. Press "Brew". Preparation begins and stops automatically.

Please note:

- To stop brewing, press "Stop" or "Cancel".

- As soon as delivery has ended, to increase the quantity of water, just press "Extra". When the required quantity is reached, press "Stop" or "Cancel".

10.3 Preparing hot water

Direct selection:

- On the homepage (C), press the image corresponding to hot water (C1). Preparation begins and stops automatically.

Customising the quantity:

- Press  (C2) at the bottom of the image corresponding to hot water: the quantity to select appears on the display;
- Press "Brew". Preparation begins and stops automatically.

Please note:

- To stop brewing, press "Stop" or "Cancel".
- As soon as delivery has ended, to increase the quantity of water, just press "Extra". When the required quantity is reached, press "Stop" or "Cancel".

11. FAVOURITE DRINKS

A collection of favourite drinks can be created for each profile.

Proceed as follows:

- Press  (C2) at the bottom of the image corresponding to the drink you want to include in the collection;

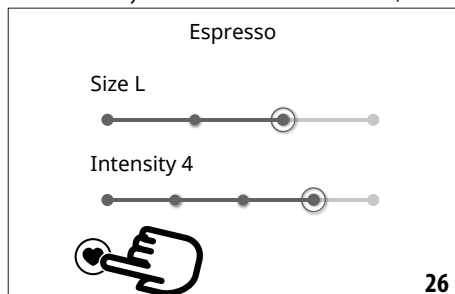

- Select the heart (fig. 26):
- Press "X" to go back to the homepage (C).
The drink is now included in the collection and can be accessed by pressing Favourites (B4) from the control panel (B).

Please note:

The order of drinks in the collection can be changed:

- Press  ;
- Select the drink to be moved;
- Use the arrows to change the order of the drinks;
- Press "X" to go back to the homepage (C).

12. MAKING "TO GO" DRINKS

The "To Go" function is perfect for all those wanting to create a customised drink to take away with them.

Optional accessory in certain models:

	Travel mug (capacity 473 ml/160 mm H)
	Type: DLSC073
	EAN: 8004399024083

- Prepare the machine with the accessories needed to prepare the drink you want to make (E, F);
- Raise the flap (A16) (fig. 24) and place the travel mug in the compartment (A15) (fig. 27);

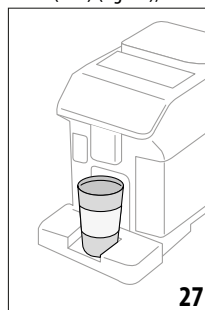

- Press "To Go" (B2);

The first time you use the function:

- Press "Start";
 - Pressing  displays information on the quantities corresponding to the size of the travel mug;
 - Select the size of travel mug you are using (Piccolo, Medio, Grande) and press "Next";
 - The appliance informs you that at the end of preparation, you can adjust the quantity to save the exact capacity of your mug. Press "Next".
- Select the type of drink you want to make (Hot (B3) or Cold (B1));
 - Scroll through the drinks on the homepage (C) until the one you want to make is displayed. Select the drink and customise the parameters proposed by the appliance. Proceed with preparation;
 - At the end of preparation, you can correct the quantity delivered so the next time the machine will make the right amount of drink for the travel mug you are using.

Please note:

- Each time you use a mug different from the one used previously, we recommend you remain nearby to check the quantity of drink delivered.
- If you save the new settings, they are memorised ONLY in the selected profile.
- To maintain the temperature of hot drinks, preheat the travel mug with hot water.

- You should only use the travel mug for the drinks present on the homepage.
- To use a travel mug other than the one supplied, make sure it is no taller than 16 cm.

Important

- Before screwing on the lid, open the closing cap to release the pressure;
- **Drinks with milk:** at the end of preparation, clean the milk carafe (see section “9.6 Cleaning the milk carafe after use”).
- You should use the contents within a maximum of 2 hours. After that time, empty and clean as described in the following section.
- For more information, see the leaflet attached to the travel mug.

12.1 Cleaning the travel mug after use



For hygiene reasons, the travel mug (D9) should always be cleaned after use. Do not use abrasive materials that could damage the surface of the container.

Proceed as follows:

1. Unscrew the lid and rinse the container and lid with hot drinking water (40°C).
2. Soak the components in hot water (40°C) with washing up liquid for at least 30 minutes. Do not use scented detergents.
3. Clean the inside of the container and the lid with a clean sponge and washing up liquid, removing any visible dirt.
4. Rinse all components with hot drinking water (40°C).
5. Dry all components with a clean, dry cloth or paper towels, then reassemble.
6. Wash the lid in the dishwasher once a week. The metal container is not dishwasher safe

13. “MY” FUNCTION (“Hot” drinks only)

With the “my function”, you can customise the drink as follows:

1. Make sure the profile (C6) whose drink you want to customise is active;
 2. Press  (C2) at the bottom of the image corresponding to the drink you want to make;
 3. Press ;
 4. Press “Start” to follow the guided procedure;
 5. If envisaged by the drink, select the desired Intensity and press “Next”;
 6. Press “Brew” to begin preparation;
 7. When the required quantity has been delivered into the cup, press “Stop”.
 8. If you are satisfied with the result in the cup, press “Save” to save the settings, or “Cancel” to retain the previous parameters.
 9. Press “X” to go back to the homepage.
- The appliance goes back to the homepage (C).

Please note:

- If you save the new settings, they are memorised ONLY in the selected profile.
- When you customise a single drink, the respective double version is also customised and the appliance displays the message “Settings saved on both double and single drink”;
- Press “X” to exit programming at any moment. The values will not be saved.
- When a drink has been customised, “Reset” (under the image) and “my” (among the quantity selections) appear in the settings. Press “Reset” to reset the default values for the drink.

Drink quantity table		
Drink	Standard quantity	Programmable quantity
ESPRESSO	40 ml	20-180 ml
2X ESPRESSO	40 ml + 40 ml	20-180 ml + 20-180 ml
COFFEE	180 ml	100-270 ml
LONG	160 ml	115-250 ml
DOPPIO+	120 ml	80-180 ml
AMERICANO	150 ml	70-480 ml
TEA	150 ml	20-420 ml
HOT WATER	250 ml	20-420 ml

14. SELECTING YOUR PERSONAL PROFILE

You can memorise a number of different profiles, each associated with a different icon.

The customised drink settings are saved in each profile. The order in which all the drinks are displayed is based on the frequency of selection.

To select a profile, proceed as follows:

1. From the homepage (C), press the profile currently in use (C6). A list of selectable profiles appears;
2. Then select the required profile.

Please note:

- After making your selection, the drink settings bars will all appear in the same colour as the profile;
- You can rename your profile;
- To customise the profile icon, see section “6.7 Create and edit profiles”.

15. CLEANING

15.1 Cleaning the machine



The following parts of the machine must be cleaned regularly:

- the appliance’s internal circuit;

- coffee grounds container (A10);
- drip tray (A14) and drip tray grille(A13);
- water tank (A22);
- coffee spouts(A7);
- pre-ground coffee funnel (A4);
- brewing unit (A6), extractable after opening the brewing unit flap (A5);
- milk carafes (E) and (F)
- coffee pot (D8) (see section “8.9 Cleaning the coffee pot”);
- travel mug (D9) (see section “12.1 Cleaning the travel mug after use”).

Important!

- Do not use solvents, abrasive detergents or alcohol to clean the coffee machine. With De’Longhi superautomatic coffee machines, no chemical products are required for cleaning purposes.
- Do not use metal objects to remove encrustations or coffee deposits as they could scratch metal or plastic surfaces.

dishwasher safe 	hand wash only 
drip tray (A14)	coffee grounds container (A10)
door grille support (A17)	cup tray (A12)
drip tray grille (A13)	flap grille (A17)
“Hot” milk carafe (E)	water tank (A22)
“Cool” milk carafe (F)	removable brewing unit (A6)

15.2 Cleaning the internal circuit

If the appliance is not used for more than 3/4 days, before using it again, we strongly recommend switching it on and performing 2/3 rinse cycles by selecting the “Rinse” function (section “6.1 Rinsing”).

Please note:

After cleaning, it is normal for the grounds container (A10) to contain water.

15.3 Cleaning the coffee grounds container

When “Please empty grounds container” appears on the display, the grounds container must be emptied and cleaned. The appliance cannot be used to make coffee until you have cleaned the grounds container (A10). Even if not full, the empty grounds container message is displayed 72 hours after the first coffee has been prepared. For the 72 hours to be calculated correctly, the machine must never be disconnected from the mains power supply.

Important! Danger of scalding

If you make a number of milk-based drinks one after the other, the metal cup tray (A12) becomes hot. Wait for it to cool down before touching it and handle it from the front only.

To clean (with the machine on):

1. Remove the drip tray (A14) and grounds container (A10) (fig. 28);

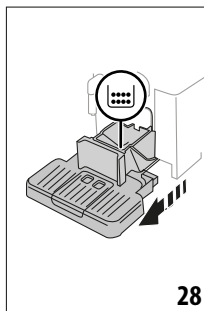

2. Empty the drip tray and grounds container and clean thoroughly to remove all residues left on the bottom. This can be done using the spatula on the brush (D5) provided.
3. Put the drip tray complete with grille and grounds container back in the appliance.

Important!

- When removing the drip tray, the grounds container must be emptied, even if it contains only a few grounds. If this is not done, when you make the next coffees, the grounds container will fill up more than expected and clog the machine.
- The grounds container on certain models is made up of two distinct parts: after cleaning, reassemble the parts before returning the container to the machine.

15.4 Cleaning the drip tray and drip tray grille

Important!

The drip tray (A14) is fitted with a level indicator (A19) (red) showing the amount of water it contains (fig. 29).

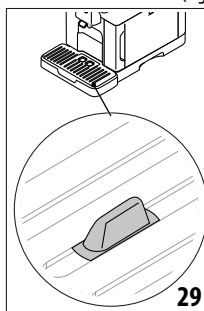

Before the indicator protrudes from the cup tray (A12), the drip tray must be emptied and cleaned, otherwise the water may overflow the edge and damage the appliance, the surface it

rests on or the surrounding area. To remove the drip tray, proceed as follows:

1. Remove the drip tray and coffee grounds container (A10) (fig. 28);
2. Check the red condensate tray (A11) and empty if full;
3. Remove the cup tray (A12) and drip tray grille (A13), then empty the drip tray and grounds container and wash all components;
4. Put the drip tray complete with grille and grounds container back in the appliance.

Important!

When removing the drip tray, the grounds container must be emptied, even if it contains few grounds. If this is not done, when you make the next coffees, the grounds container will fill up more than expected and clog the machine.

15.5 Cleaning the inside of the machine

Danger of electric shock!

Before cleaning internal parts, the machine must be turned off (see section "5. Turning the appliance off") and unplugged from the mains power supply. Never immerse the machine in water.

1. Check regularly (about once a month) that the inside of the appliance (accessible after removing the drip tray (A14)) is not dirty. If necessary, remove coffee deposits with the brush (D5) supplied and a sponge.
2. Remove all residues with a vacuum cleaner (fig. 30).

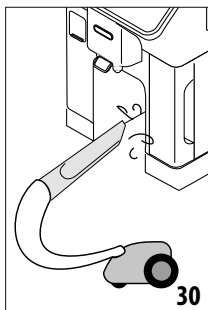

15.6 Cleaning the water tank

Clean the water tank periodically (about once a month) and whenever the softener filter (D4) in the water tank (A22) is replaced.

1. Take out the water tank (fig. 2), remove the water softener filter (if installed) and rinse with running water;
2. Empty the water tank and clean with hot water, if necessary with the aid of a clean, non-abrasive cloth. Rinse thoroughly with water;
3. Reinstall the filter (fig. 31), fill the tank with fresh potable water up to the MAX level (fig. 3) and reposition the tank in the machine;

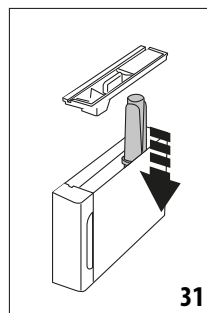

4. (models with water softener filter only) — deliver 100ml of hot water to reactivate the filter.

Please note:

If the appliance is not used for more than 3-4 days, you should clean the tank as described above.

15.7 Cleaning the coffee spouts

1. Clean the coffee spouts (A7) regularly with a sponge or cloth (fig. 32);

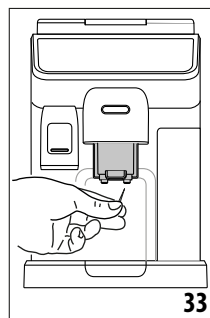
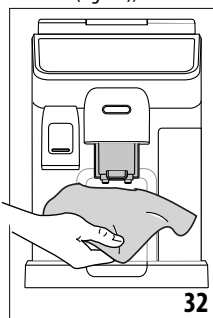

2. Check the holes in the coffee spouts are not blocked. If necessary, remove coffee deposits with a toothpick (fig. 33).

15.8 Cleaning the pre-ground coffee funnel

Clean the pre-ground coffee funnel (A4) regularly (about once a month) with a damp cloth. Proceed as follows:

1. Turn the machine off (see chapter "5. Turning the appliance off");
2. Open the funnel flap;
3. Clean the funnel with the brush provided (D5);
4. Close the flap.

Important!

After cleaning, make sure there are no accessories left in the funnel. The presence of foreign objects in the funnel while the machine is in operation could damage the appliance.

15.9 Cleaning the brewing unit

The brewing unit (A6) must be cleaned at least once a month.

Important!

The brewing unit cannot be extracted while the machine is on.

1. Make sure the machine is correctly turned off (see section "5. Turning the appliance off");
2. Remove the water tank (A22) (fig. 2);
3. Open the brewing unit flap (A5) (fig. 34) on the right side of the appliance;

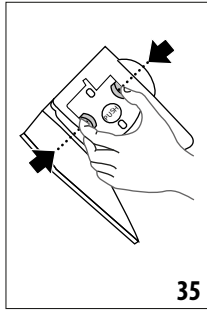
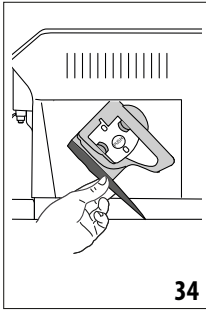

4. Press the two coloured release buttons inwards and at the same time pull the brewing unit outwards (fig. 35);
5. Soak the brewing unit in water for about 5 minutes, then rinse under the tap;

Important!

RINSE WITH WATER ONLY
NO DETERGENTS - NO DISHWASHER

6. Do not use detergents when cleaning the brewing unit, as they could damage it.
7. Use the brush (D5) to remove any coffee residues left in the brewing unit housing, visible through the brewing unit flap;
8. After cleaning, replace the brewing unit by sliding it onto the internal support, then push the PUSH symbol fully in until it clicks into place;

Please note:

If the brewing unit is difficult to insert, before insertion, adapt it to the right size by pressing the two levers (fig. 36).

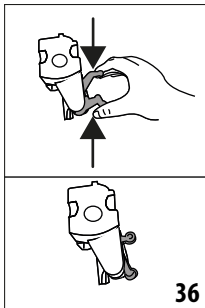

9. Once inserted, make sure the two coloured buttons have snapped out;
10. Close the brewing unit flap;
11. Put the water tank back.

15.10 Cleaning the milk carafes (E) and (F)

Each time you use the milk carafe, clean as described below:

1. Extract the lid of the milk carafe (E1) or (F1) (fig. 18);
2. Extract the milk spout (E5) or (F5), milk spout extension (E7) ("Hot" carafe only) and milk intake tube (E6) or (F6) (fig. 37);

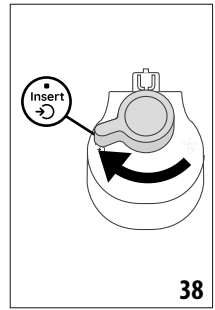
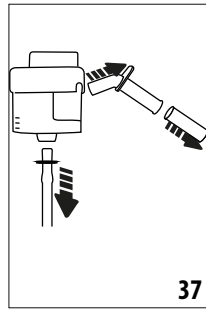

3. Turn the froth adjustment dial (E3) or (F3) clockwise to the "Insert" position (fig. 38) and pull to extract;
4. Turn anticlockwise and remove the milk carafe connector (E4) or (F4) (fig. 39).

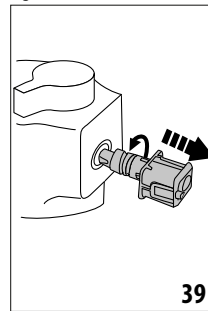

5. Wash in a dishwasher (recommended) or by hand as indicated below:
 - **In a dishwasher:** Rinse all the above components and the milk carafe with hot running drinking water (at least 40°C), then place them in the top basket of the dishwasher and run a programme at 50°C, e.g. standard ECO.
 - **By hand:** Thoroughly rinse all the components and the milk carafe with hot running drinking water (at least 40°C) to remove all visible milk residues; make sure to run the water through the holes in the lid (fig. 40). Then immerse all the components in hot drinking water (at least 40°C) and washing up liquid for at least 30 minutes. Rinse all the above components thoroughly under hot drinking water, rubbing them one at a time with your hands.
6. Make sure there are no milk residues on the hollow and groove under the dial (fig. 41). If necessary, scrape the groove with a toothpick;

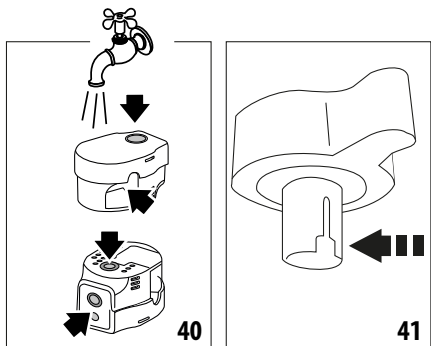

7. Check that the intake tube and spout are not clogged with milk residues;
8. Dry all the components with a clean dry cloth;
9. Reassemble all the lid components;
10. Attach the lid back on the milk carafe.

Please note:

Each week the appliance reminds you to clean the milk carafe thoroughly and proposes the correct cleaning sequence again.

16. DESCALING ☹

Important!

- Before use, read the instructions and labelling on the descaler pack.
- Use De'Longhi descaler only. Using unsuitable descaler and/or performing descaling incorrectly may result in faults not covered by the manufacturer's guarantee.
- Descaler could damage delicate surfaces. If the product is accidentally spilt, dry immediately.

To descale	
Descaler	De'Longhi descaler
Container	Recommended capacity: 2 l
Time	~50min

Descale the appliance when the corresponding message appears on the homepage (C). To descale immediately, press "OK" and follow the instructions from point (5).

To descale the appliance later, press "Cancel". The ☹ symbol (C4) appears on the homepage to remind you the appliance needs descaling. (The message appears each time you turn the appliance on).

To access the descaling menu:

1. Press the settings menu icon (C3) on the homepage;
2. Scroll through the menu items until "Descaling" is displayed;
3. Press "Start" to enter the guided descaling procedure;
4. Press "Start" to begin;
5. Insert the water spout (D6) (fig. 5);

6. Remove and empty the drip tray (A14) and coffee grounds container (A10) (fig. 10), then put both back in the appliance and press "Next";
7. Remove the water tank (A22), lift the lid (A21) and (if inserted) remove the filter (D4). Empty the tank completely.
8. Pour the descaler into the tank up to the level A marked inside the tank (equal to one 100ml pack), then add water (one litre) up to level B (fig. 42). Put the water tank (with lid) back in the appliance and press "Next";

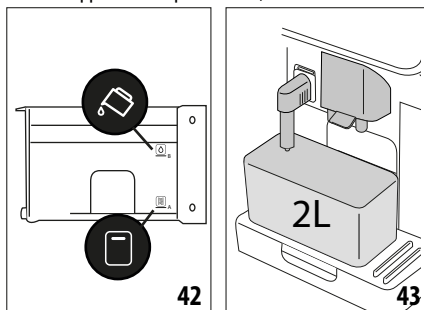

9. Place an empty 2 litre container under the spouts (fig. 43). Press "Next" to start descaling ("Back" to go back to the previous screen or "X" to exit the procedure, remembering to remove the descaling solution from the tank)

Important! Danger of scalding

Hot water containing acid flows out of the spouts. Take care to avoid contact with splashes of this solution.

10. The descale programme starts and the descaler liquid comes out of the hot water and coffee spouts. A series of rinses is performed automatically to remove all the scale residues inside the coffee machine;
After about 40 minutes, the descaling action ceases;
11. The appliance is now ready to be rinsed through with clean water. Empty the container used to collect the descaler solution. Remove the water tank, empty, rinse under running water, fill with fresh water up to the MAX level and put back in the appliance (fig. 44). Press "Next";

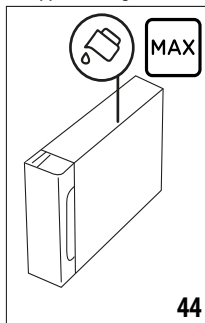

12. Place the container used to collect the descaler solution empty under the spouts and press "Next" to start rinsing;
13. Hot water is delivered from both the hot water spout and coffee spouts;
14. When the water in the tank has run out, empty the container used to collect the rinsing water;
15. Extract the water tank and put back the water softener filter if removed previously. Press "Next" to continue;
16. Fill the tank with fresh water up to the MAX level, put back in the appliance and press "Next" to continue;
17. Place the container used to collect the descaler solution empty under the spouts and press "Next" to start another rinsing cycle;
18. When the water in the tank has run out, empty the container used to collect the rinsing water, remove and empty the drip tray (A14) and grounds container (A10), then put back in the appliance;
19. Extract the water tank, top up to the max level, put back in the appliance and press "Next"
20. The descaling process is now complete". Press "OK". The appliance performs a rapid preheat cycle and then goes back to the homepage.

Please note:

- If the descaling cycle is not completed correctly (e.g. electrical power failure) the appliance will request to complete it next time you switch it on;
- After descaling, it is normal for the grounds container (A10) to contain water.
- If the water tank has not been filled to the MAX level after descaling, the appliance prompts for a third rinse to ensure that the descaler solution has been completely eliminated from the machine's internal circuits. Before starting rinsing, remember to empty the drip tray.

17. SETTING WATER HARDNESS





The descaling alarm is displayed after a period of time established according to water hardness. The machine can also be programmed according to the actual hardness of the local water supply, so that the descaling procedure will be required less frequently.

17.1 Measuring water hardness

1. Remove the "Total hardness test" indicator paper (D1) from its pack (in the welcome box).
2. Immerse the paper completely in a glass of water for about one second.
3. Remove the strip from the water and shake lightly. After about a minute, 1, 2, 3, or 4 red squares appear, depending on the hardness of the water. Each square corresponds to 1 level.

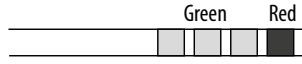
17.2 Setting water hardness

1. Press the settings menu icon (C3) on the homepage (C);
2. Scroll the pages and select "Water hardness";
3. Press "Set";
4. Carry out the procedure described in the previous section and measure water hardness;
5. Press the dot corresponding to the water hardness measured previously as indicated in the following table:

Total Hardness Test (D1)	Water hardness
	Level 1
	Level 2
	Level 3
	Level 4

6. The machine is now reprogrammed with the new water hardness setting.
7. Press "<" to go back to the settings menu.

18. WATER SOFTENER FILTER

Certain models are fitted with a water softener filter (D4). If this is not the case with your model, you are recommended to purchase one from De'Longhi Customer Services.

To use the filter correctly, follow the instructions below.

18.1 Installing the filter

1. Press the settings menu (C3);
2. Scroll through the pages and select "Water filter";
3. Press "OK" to enter the guided procedure
4. Remove the filter from the packaging and turn the date indicator to view the next 2 months (fig. 45);

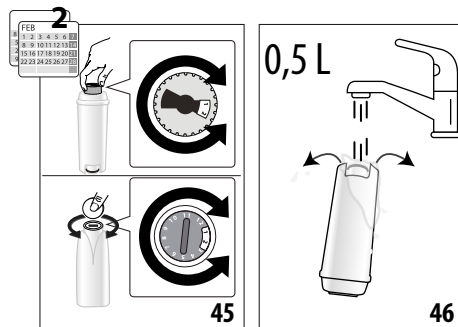

Please note:

The filter lasts about two months if the appliance is used normally. If the machine is left unused with the filter installed, it will last a maximum of 3 weeks.

5. Press "Next" to continue ("Back" to go back to the previous screen; "X" to cancel the operation);
6. To activate the filter, run tap water through the hole in the centre of the filter until water comes out of the openings at the side for more than a minute (fig. 46). Press "Next";

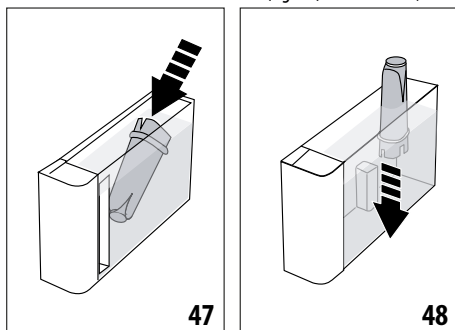

7. Extract the water tank (A22) (fig. 2) and fill with water; insert the filter in the water tank and immerse it completely for about ten seconds, sloping it and pressing it lightly to enable the air bubbles to escape (fig. 47). Press "Next";
8. Insert the filter in the filter housing (fig. 48) and press as far as it will go; press "Next";
9. Close the tank with the lid (A21), then put the tank back in the machine.
10. Insert the hot water spout (D6). Press "Next";
11. Position an empty container with a minimum capacity of 0.5 litres under the hot water spout (fig. 6) and press "Next" to activate the filter;
12. The appliance delivers hot water, then stops automatically. Press "OK" to go back to the homepage;
13. The filter is now active and you can use the coffee machine.

18.2 Replacing or removing the filter

Replace the filter (D4) when the replace filter message appears on the homepage (C). To replace the filter immediately, press "OK" and follow the instructions from point 3 of the previous section. To replace the filter later, press "Cancel". The filter symbol appears on the display to remind you the filter needs replacing.

To replace, proceed as follows:

1. Press the settings menu (C3);
2. Scroll through the pages until "Water filter" is displayed, then press "OK";
3. Press "OK" to enter the guided procedure;
4. Extract the water tank (A22) and exhausted filter.

5. To remove the filter, press "OK" ("Back" to go back to the previous screen; "Cancel" to cancel the operation);
6. To replace the filter, press "Next" and follow the operations described in the previous section from point (4).

Please note:

After two months (see date indicator) or when the appliance has not been used for 3 weeks, you should replace the filter even if the message has not yet been displayed.

19. TECHNICAL DATA

Voltage:	220-240 V ~ 50-60 Hz max. 10 A
Power:	1450 W
Pressure:	1.9 MPa (19 bars)
Water tank capacity:	1.8 l
Size LxDxH:	260x450x385 mm
Cord length:	1200 mm
Weight (varies according to model):	11.2 kg
Beans container capacity:	300 g
Frequency:	2400/2500 MHz
Maximum transmission power	20 mW

De'Longhi reserves the right to modify the technical specification and styling of its products at any moment, without compromising their functionality and quality.







19.1 Tips for Energy Saving

- To reduce energy consumption, after delivering one or more drinks, remove the milk carafes or accessories.
- Set auto-off to 15 minutes (see section "6.8 Set auto-off");
- Enable Energy Saving (see paragraph "6.9 General");
- Always carry out the descaling cycle when prompted by the machine.

20. DISPLAYED MESSAGES

DISPLAYED MESSAGE	MEANING	SOLUTION
Please fill the tank with fresh water up to MAX level. Be sure to fill above Level 1	Insufficient water in the tank (A22).	Take out the tank, fill with fresh potable water to above Level 1, and reposition in the machine.
I don't have enough water for your drink. Please fill the tank with fresh water up to MAX level. Be sure to fill above Level 1		
Please insert the water tank	The tank (A22) is not correctly in place.	Insert the tank correctly and press as far as it will go.
Fill the tank with fresh water. Please empty drip tray and grounds container	The amount of water in the tank is not enough to make the drink and the message to empty the grounds container will be displayed shortly.	The appliance asks for both operations to be performed so that no further intervention will be necessary and more drinks can be made one after the other without interruption.
Please insert the brewing unit	The brewing unit (A6) has not been replaced after cleaning.	Insert the brewing unit as described in section "15.9 Cleaning the brewing unit"
Please empty grounds container	The grounds container (A10) is full.	Clean as described in section "15.3 Cleaning the coffee grounds container"
Please insert grounds container and drip tray	The grounds container (A10) and/or drip tray (A14) is not correctly in place or is missing.	Insert the drip tray complete with grounds container and press as far as it will go.
Please add your preferred pre-ground coffee. - max: one measure!	Preparation with pre-ground coffee has been selected.	Make sure the funnel (A4) is not blocked, then add one level measure (D2) of pre-ground coffee, press "Next" on the display and follow the instructions in section "8.4 Making coffee using pre-ground coffee".
Fill the beans container and press "OK" to resume brewing	The coffee beans have run out.	Fill the beans container (A2) and press "OK" to resume brewing
Please insert the water spout	The spout (D6) is not correctly in place or is missing.	Insert the spout and push as far as it will go (fig. 5). The appliance emits a beep (if the beep function is enabled).
Please insert the cold/hot milk carafe	The milk carafe (E) or (F) is not inserted correctly or is missing.	Insert the milk carafe and push as far as it will go. The machine emits a beep (if the beep function is enabled).
Just doing a little cleaning. I'll be back in a few seconds	The appliance has detected impurities in its internal circuits.	Wait for the appliance to be ready again and reselect the required drink. Contact customer services if the problem persists.
→		

DISPLAYED MESSAGE	MEANING	SOLUTION
The new settings have not been saved	While customising the drinks (see section "13. "My" function ("Hot" drinks only)), preparation has been deliberately interrupted by pressing "X" or an alarm has been triggered.	Press "X" to go back to the homepage (C) to view the alarm causing the interruption. Follow the instructions corresponding to the alarm displayed (see section "20. Displayed messages")
I am unable to complete your drink. Reduce the intensity and try again	The grinding is too fine and the coffee is delivered too slowly or not at all.	Select a milder "Intensity" (see "8.3 Customising the drinks")
	If the water softener filter (D4) is present, an air bubble may have been released inside the circuit, obstructing delivery.	Press "OK" and deliver a little water (see section "10. Preparing hot water and hot tea") until the flow is regular. If the problem continues, remove the filter (see section "18.2 Replacing or removing the filter")
I am unable to complete your drink. Adjust the coffee grinder, increasing the dial position one unit at a time	The grinding is too fine and the coffee is delivered too slowly or not at all.	Press "OK" and adjust the coffee grinder (see "6.4 Adjust grinder").
Please select a lighter intensity or reduce pre-ground coffee quantity	Too much coffee has been used.	Select a milder "Intensity" (see "8.3 Customising the drinks") or reduce the quantity of pre-ground coffee (maximum 1 measure). Press "OK" to go back to the homepage or wait until the message disappears.
Please store the milk carafe in the fridge	A milk-based drink has been prepared and the milk carafe is still inserted in the appliance	Remove the carafe and place in the refrigerator.
The machine needs to be descaled. Press OK to start (~50min)	The machine must be descaled.	To proceed with descaling, press "OK" and follow the guided procedure, otherwise press "Cancel". In this case, the  symbol (C4) appears on the homepage (C) to remind you that descaling is needed (see section "16. Descaling").
The process has been interrupted. Please press Ok to continue	Descaling process interrupted or not correctly completed	Press Ok to continue (see section "16. Descaling").
Please replace the water filter. Press OK to start	The water softener filter (D4) is exhausted.	Press "OK" to replace or remove the filter, or "Cancel" to carry out the procedure later. Follow the instructions in section "18. Water softener filter".
General alarm: Please refer to user manual / Coffee Link App	The inside of the appliance is very dirty.	Clean the inside of the appliance thoroughly, as described in section "15. Cleaning". If the message is still displayed after cleaning, contact De'Longhi Customer Services and/or an approved Service Centre
→		

DISPLAYED MESSAGE	MEANING	SOLUTION
Water circuit empty. Press OK to start filling process	The water circuit is empty	Press "OK" to fill the circuit. Delivery stops automatically. It is normal for there to be water in the drip tray (A14) after filling. If the problem persists, make sure the water tank (A22) is fully inserted.
	A new water softener filter has been inserted (D4)	Make sure you have followed the instructions for inserting the new filter (sections "18.1 Installing the filter" and "18.2 Replacing or removing the filter"). If the problem continues, remove the filter (section "18.2 Replacing or removing the filter").
The coffee beans profile has changed! Remember to brew at least 3 coffees before changing the coffee beans profile	The appliance needs to brew at least 3 coffees before Bean Adapt can be adjusted	Brew at least 3 coffees with the new coffee before changing the Bean Adapt
For an optimal temperature Please start a quick rinse to cool me down a bit. Place a 0,2L container under the spouts and press Start	You want to prepare a "cold brew technology" drink after preparing several hot drinks.	Put a container under the coffee spouts and press "Start" for a quick cold rinse to cool the coffee circuit or press "Skip" to directly brew the desired drink.
For an optimal temperature Please start a quick rinse to heat me up a bit. Place a 0,2L container under the spouts and press Start	You want to prepare a hot drink after preparing "cold brew technology" drinks.	Put a container under the coffee spouts and press "Start" for a quick hot rinse to heat the coffee circuit up or press "Skip" to directly brew the desired drink.
	Energy saving is enabled.	To disable energy saving, proceed as described in section "6.9 General".
	The machine must be descaled.	The descaling procedure described in section "16. Descaling" needs to be performed.
	The filter must be replaced (D4)	Replace the filter or remove it as described in section "18. Water softener filter".
	Remember to clean the milk carafe (E) or (F).	Turn the froth adjustment dial (E3) or (F3) to CLEAN.
	The connection is configured in the appliance settings menu (C3).	Connect to the Coffee Link App.
	Indicates that the appliance is connected.	To disable the connection, proceed as described in section "6.3 Connectivity".
		→

DISPLAYED MESSAGE	MEANING	SOLUTION
	Connectivity is active, but the cloud cannot be reached.	<p>If just turned on, wait for the appliance to complete the start up procedure.</p> <p>If the problem continues, disable the connection then enable again as described in section "6.3 Connectivity".</p> <p>Make sure the lights on the router indicate that the network is active.</p> <p>If the problem continues, turn the appliance and home router off then on again.</p>

21. TROUBLESHOOTING

Below is a list of some of the possible malfunctions.

If the problem cannot be resolved as described, contact customer services.

PROBLEM	POSSIBLE CAUSE	SOLUTION
The appliance does not come on	It is not plugged into the mains socket.	Plug into the mains socket (fig. 1).
The coffee is not hot.	The internal circuits of the appliance have cooled down because 2-3 minutes have elapsed since the last coffee was made.	Before making the coffee, heat the internal circuits by rinsing using the rinse function (see section "6.1 Rinsing").
	Coffee temperature setting too low.	Set a hotter coffee temperature in the settings menu (C3) (see section "6.5 Coffee temperature").
	The cups were not preheated.	Warm the cups by rinsing them with hot water (Please note: you can use the hot water function).
	The machine must be descaled	Proceed as described in section "16. Descaling". Next, check the water hardness ("17.1 Measuring water hardness") and make certain the machine setting matches the local water supply hardness ("17.2 Setting water hardness").
The coffee is weak or not creamy enough.	The coffee is ground too coarsely.	Access the settings menu (C3) and follow the instructions to adjust grinding. The effect is only visible after delivering 3 coffees (see section "6.4 Adjust grinder").
	The coffee is unsuitable.	Use coffee for espresso machines.
	Coffee not fresh.	The coffee pack has been opened for too long and has lost its taste.
The coffee is delivered too slowly or a drop at a time.	The coffee is ground too finely.	Access the settings menu (C3) and follow the instructions to adjust grinding. The effect is only visible after delivering 3 coffees (see section "6.4 Adjust grinder").
		→

PROBLEM	POSSIBLE CAUSE	SOLUTION
Coffee does not come out of one or both spouts.	The coffee spouts (A7) are blocked.	Clean the coffee spouts with a sponge or toothpick.
The coffee delivered is watery.	The funnel (A4) is clogged.	Clean the funnel with the help of the brush (D5) as described in section "15.8 Cleaning the pre-ground coffee funnel".
Too little drink is delivered	Insufficient water in tank	Always fill the tank above Level 1.
The appliance does not make coffee.	The appliance has detected impurities in its internal circuits. "Just doing a little cleaning..." is displayed.	Wait for the appliance to be ready again and reselect the required drink. Contact customer services if the problem persists.
The brewing unit (A6) cannot be extracted.	The appliance has not been turned off correctly	Turn the appliance off by pressing the  button (A9) (see section "5. Turning the appliance off").
At the end of descaling, the appliance requests a third rinse.	During the two rinse cycles, the water tank (A22) has not been filled to the MAX level	Follow the instructions displayed by the appliance, but first empty the drip tray (A14) to avoid the water overflowing.
Milk does not flow from the milk spout (E5) or (F5).	The milk carafe lid (E1) or (F1) is dirty	Clean the milk carafe lid as described in section "15.10 Cleaning the milk carafes (E) and (F)".
	The lid (E1) or (F1) is not assembled correctly.	Assemble all the components correctly as described in sections "9.1 Preparing the milk carafes (E and F)" and "9.4 Adjusting the amount of froth".
The milk contains large bubbles and squirts out of the milk spout (E5) or (F5) there is little froth.	The milk is not cold enough or not suitable for the drink requested	For best results, make sure to use the right type of milk to prepare hot or cold drinks (see section "9.2 Which milk to use?"). Use drinks at refrigerator temperature (about 5° C).
	The milk carafe lid (E1) or (F1) is dirty	Clean the milk carafe as described in section "9.6 Cleaning the milk carafe after use"
	There is water in the groove under the froth adjustment dial (E3) or (F3)	Extract the dial and dry thoroughly.
	Plant-based drinks have been used.	For best results, use drinks at refrigerator temperature (about 5° C). Adjust the amount of froth as described in section "9.4 Adjusting the amount of froth"
The cup shelf (A12) is hot.	A number of drinks have been prepared in rapid succession	
After cleaning, you can't put the drip tray back in the machine	The condensate tray(A11) is not in the correct position	Make sure the condensate tray is inserted correctly
		→

PROBLEM	POSSIBLE CAUSE	SOLUTION
The machine emits noises or small puffs of steam while not in use	The machine is ready for use, or has recently been turned off, and condensate is dripping into the hot vaporiser	This is part of normal operation. To limit the phenomenon, empty the drip tray.
The appliance emits puffs of steam from the drip tray (A14) and/or there is water on the surface the appliance rests on.	The drip tray grille (A13) has not been put back after cleaning.	Put the drip tray grille back in the drip tray.
The To Go drink is too much or has spilled out of the travel mug	An unsuitable quantity has been selected	Choose a smaller quantity (Medio \overline{M} or Piccolo \overline{P})
		Adjust the quantity in the mug so that the next drink is prepared correctly
Too little To Go drink is prepared	An unsuitable quantity has been selected	Choose a larger quantity (Medio \overline{M} or Grande \overline{G})
		Adjust the quantity in the mug so that the next drink is prepared correctly
The travel mug cannot be inserted in the appliance	The travel mug compartment flap (A16) is closed and/or the coffee spouts (A7) are lowered	Open the flap and/or raise the coffee spouts
The App is not working	App malfunction	Close the App, then run it again
The App indicates a problem, but there is no problem with the appliance	The data between the appliance and App are not synchronised	Disable and re-enable connectivity (section "6.3 Connectivity")

Register Now

www.delonghi.com/register

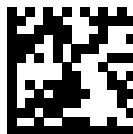

57132C8814_00_1023

De'Longhi Appliances via Seitz, 47 31100 Treviso, Italy delonghi.com