



CERTIFICATE

Certificate registration number: ZSTS/SWZE/6847

The notified body
TÜV AUSTRIA GMBH (identification number 0408)
certifies, that the manufacturer

GasOil Endüstriyel Üretim Sanayi Ticaret A.Ş.
Sasalı Merkez 43 Sok. No:29, 35620 Çiğli / İZMİR

operates a quality assurance system for design, manufacture, final inspection and testing according to Annex III of the Pressure Equipment Directive 2014/68/EU which is subject to surveillance by TÜV AUSTRIA GMBH and is therefore authorized to apply the following conformity assessment procedures according Pressure Equipment Directive 2014/68/EU:

Module H

Scope: **Insulation Joint Size: 1" to 56", Rating: ANSI 150 up to ANSI 1500, Pressure : 6 bar to 250 bar.**

Based on our audit carried out on February 3, 2025 in accordance with Annex III of the Pressure Equipment Directive 2014/68/EU we certify compliance with the requirements.

Results of the audit are recorded in the audit report
24-IS-2064-2025-PED-Modul H-005 dated February 3, 2025.

Pressure equipment and assemblies within the scope of this certificate shall carry the marking as illustrated:

CE 0408

This certificate is valid from March 20, 2025 to March 19, 2028 provided that the terms and conditions of the agreement with the notified body are met.

Vienna, 20.03.2025



Schwarz
DI Martin Schwarz

Notified Body 0408
TÜV AUSTRIA GMBH



SERTİFİKA

Gasoil Endüstriyel Üretim Sanayi Ticaret Anonim Şirketi

Sasalı Merkez Mahallesi 43 Sokak No:29 Çiğli, İzmir, Türkiye

IFC Global Sertifikasyon, yukarıda adı geçen kuruluşun yönetim sisteminin değerlendirildiğini ve aşağıdaki standardın gerekliliklerine uygun olduğunu teyit eder.

Standard:

ISO 9001:2015

Kapsam:

Endüstriyel tesisler, gaz ve petrol boru hatları için ekipman, makine, basınçlı kap üretimi

İlk Yayın Tarihi	: 22.11.2024
Yayın Tarihi	: 22.11.2024
Revizyon No	: 0
Sertifika Geçerlilik Tarihi	: 21.11.2025
Sertifika Bitiş Tarihi	: 21.11.2027
Sertifika No	: IFC-Q-11-24-2413



CB-MS-5156

[Signature]
Onay



CERTIFICATE

Gasoil Endüstriyel Üretim Sanayi Ticaret Anonim Şirketi

Sasalı Merkez Mahallesi 43 Sokak No:29 Çiğli, İzmir, Türkiye

IFC Global Certification confirms that the above-named organization's
management system has been assessed and complies with the
requirements of the following standard.

Standard:

ISO 9001:2015

Scope:

Production of equipment, machinery, pressure vessels for industrial
plants, gas and oil pipelines

Initial Date	: 22.11.2024
Issue Date	: 22.11.2024
Revision Number	: 0
Date of Validity	: 21.11.2025
Expiry Date	: 21.11.2027
Certificate No	: IFC-Q-11-24-2413



CB-MS-8158

[Signature]
Approval

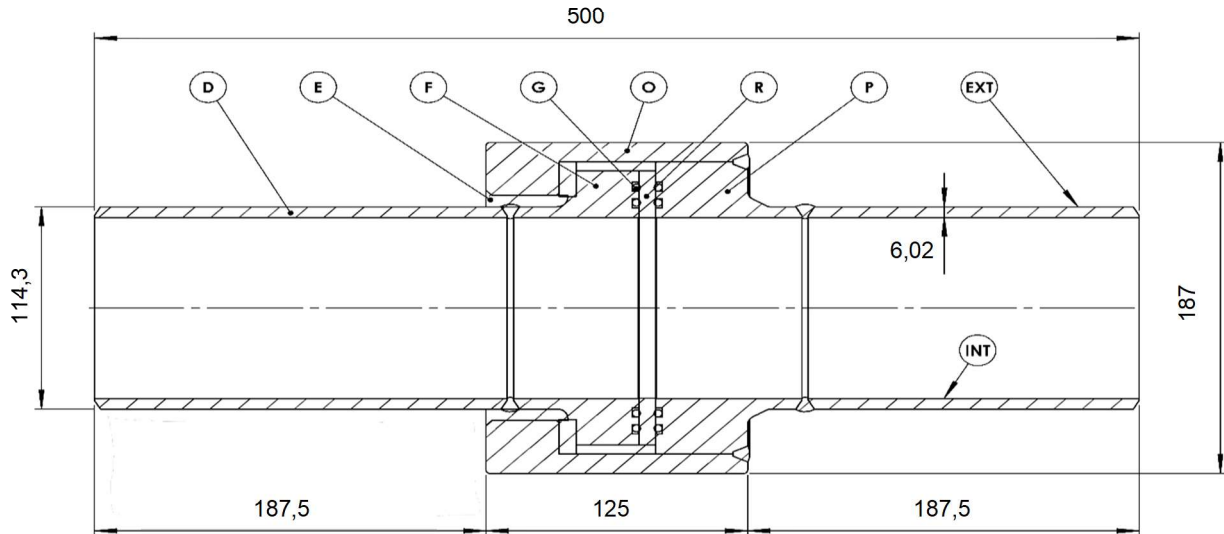

INSULATING JOINT DATA SHEET 4" ANSI #600
QTY : 2

ITEM	DESCRIPTION	
TYPE	INSULATING JOINTS, Monolithic	
DESIGN CODE	ASME B 31.1 - ASME B 31.3 - ASME B 31.4 - ASME B 31.8 - ASME VIII Div.I Appx.2	
DESIGN PRESSURE (barg)	100	
TEST PRESSURE (barg)	150	
DESIGN TEMPERATURE (°C)	-20 / +70 °C	
RATING (ASME/ANSI #) Class	CL600	
ENDS	BUTT WELDED - API 5L / B16.25 / B16.5	
DESIGN FACTOR	According to project datas (standard is 0.6)	
CONNECTION PIPE DN "C" (mm/in.)	114,3 / 4"	
CONNECTION PIPE THK "t" (mm)	6,02	
JOINT OVERALL LENGTH "A"(mm)	500	
MATERIAL	"D" PIPES (API 5L or equivalent)	API 5L - Gr. X52
	"F-O-P" Body Parts	ASTM A694 F52
	"G" O Ring Double Seal Gasket System	ASTM D 2000 Nbr / Viton
	"E" Insulating Filling Material	Epoxy Resin
	"R" Isolating Ring	D 709 G10 / G11
	EXT External Coating	Solvetless Epoxy Paint 3000 µm
	INT Internal Coating	Solvetless Epoxy Paint 500 µm
INSTALLATION	ABOVEGROUND / UNDERGROUND / SUBSEA	
PNEUMATIC TEST	8 bar for 10 min	
HYDROSTATIC TEST	1.5 Times the Design Pressure - 1 hour (Or as per Customer Requirements)	
HYDRO FATIGUE TEST	5 cycles at 80% test pressure	
DIELECTRIC TEST	3 KV @ 1 minute AC 50÷60 Hz (25°C dry air)	
ELECTRIC INSULATION TEST	≥ 5 MΩ @ 1000 Volt DC	
WELDS	W1-W2-W3 are in accordance with ASME Sec.VIII And Sec IX	
NDT TEST	Butt welds W1-W2 are in accordance with ASME Sec V : RT	
	Closure weld W3 is in accordance with ASME Sec.VIII : PT / MT	
MATERIAL CERTIFICATION	EN 10204 - 3.1 (EN 10204 - 3.2 if requested)	
INSPECTION & TEST/ACCEPTANCE	Manufacturer Standard / Customer Applicable Requirements	
CORROSION ALLOWANCE	Standard 1.6 mm / As per Customer Requirements	
SERVICE	Gas, Hydrocarbons, Oil, Chemical Fluids, Water,Toxic, etc.	

General notes :

- 1) Uncoated pipe length is 50 mm at each end for welding.
- 2) All pressure materials are suitable for resistance to H₂S environments.
- 3) This information is approximate. The exact data shall be specified during the PO Stage.
- 4) Material not in contact to the fluid
- 5) Cables Lugs will be installed on Isolating Joint only if requested.

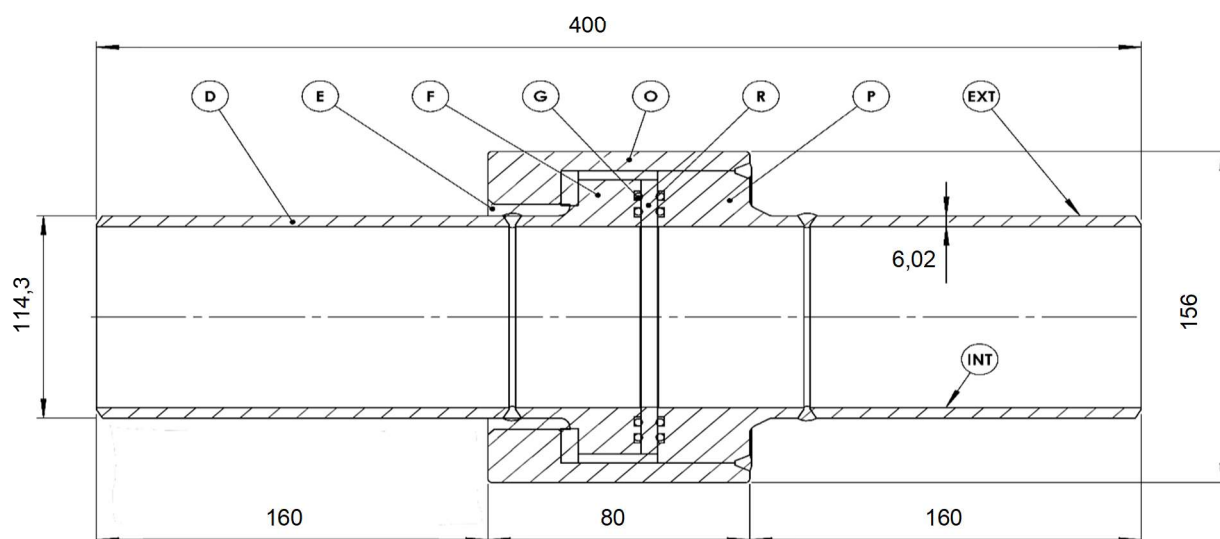
INSULATING JOINT DATA SHEET 4" ANSI #150
QTY : 1

ITEM	DESCRIPTION	
TYPE	INSULATING JOINTS, Monolithic	
DESIGN CODE	ASME B 31.1 - ASME B 31.3 - ASME B 31.4 - ASME B 31.8 - ASME VIII Div.I Appx.2	
DESIGN PRESSURE (barg)	25	
TEST PRESSURE (barg)	37,5	
DESIGN TEMPERATURE (°C)	-20 / +70 °C	
RATING (ASME/ANSI #) Class	CL150	
ENDS	BUTT WELDED - API 5L / B16.25 / B16.5	
DESIGN FACTOR	According to project datas (standard is 0.6)	
CONNECTION PIPE DN "C" (mm/in.)	114,3 / 4"	
CONNECTION PIPE THK "t" (mm)	6,02	
JOINT OVERALL LENGTH "A"(mm)	400	
MATERIAL	"D" PIPES (API 5L or equivalent)	API 5L - Gr. X52
	"F-O-P" Body Parts	ASTM A694 F52
	"G" O Ring Double Seal Gasket System	ASTM D 2000 Nbr / Viton
	"E" Insulating Filling Material	Epoxy Resin
	"R" Isolating Ring	D 709 G10 / G11
	EXT External Coating	Solvetless Epoxy Paint 3000 µm
	INT Internal Coating	Solvetless Epoxy Paint 500 µm
INSTALLATION	ABOVEGROUND / UNDERGROUND / SUBSEA	
PNEUMATIC TEST	8 bar for 10 min	
HYDROSTATIC TEST	1.5 Times the Design Pressure - 1 hour (Or as per Customer Requirements)	
HYDRO FATIGUE TEST	5 cycles at 80% test pressure	
DIELECTRIC TEST	3 KV @ 1 minute AC 50÷60 Hz (25°C dry air)	
ELECTRIC INSULATION TEST	≥ 5 MΩ @ 1000 Volt DC	
WELDS	W1-W2-W3 are in accordance with ASME Sec.VIII And Sec IX	
NDT TEST	Butt welds W1-W2 are in accordance with ASME Sec V : RT	
	Closure weld W3 is in accordance with ASME Sec.VIII : PT / MT	
MATERIAL CERTIFICATION	EN 10204 - 3.1 (EN 10204 - 3.2 if requested)	
INSPECTION & TEST/ACCEPTANCE	Manufacturer Standard / Customer Applicable Requirements	
CORROSION ALLOWANCE	Standard 1.6 mm / As per Customer Requirements	
SERVICE	Gas, Hydrocarbons, Oil, Chemical Fluids, Water,Toxic, etc.	

General notes :

- 1) Uncoated pipe length is 50 mm at each end for welding.
- 2) All pressure materials are suitable for resistance to H₂S environments.
- 3) This information is approximate. The exact data shall be specified during the PO Stage.
- 4) Material not in contact to the fluid
- 5) Cables Lugs will be installed on Isolating Joint only if requested.

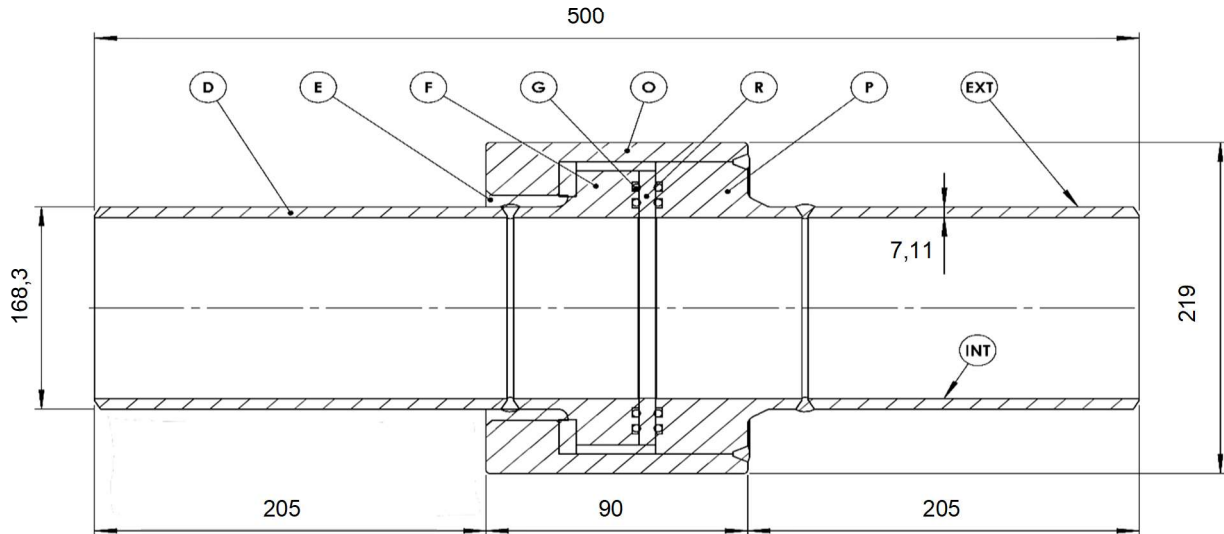
INSULATING JOINT DATA SHEET 6" ANSI #150
QTY : 2

ITEM	DESCRIPTION	
TYPE	INSULATING JOINTS, Monolithic	
DESIGN CODE	ASME B 31.1 - ASME B 31.3 - ASME B 31.4 - ASME B 31.8 - ASME VIII Div.I Appx.2	
DESIGN PRESSURE (barg)	25	
TEST PRESSURE (barg)	37,5	
DESIGN TEMPERATURE (°C)	-20 / +70 °C	
RATING (ASME/ANSI #) Class	CL150	
ENDS	BUTT WELDED - API 5L / B16.25 / B16.5	
DESIGN FACTOR	According to project datas (standard is 0.6)	
CONNECTION PIPE DN "C" (mm/in.)	168,3 / 6"	
CONNECTION PIPE THK "t" (mm)	7,11	
JOINT OVERALL LENGTH "A"(mm)	500	
MATERIAL	"D" PIPES (API 5L or equivalent)	API 5L - Gr. X52
	"F-O-P" Body Parts	ASTM A694 F52
	"G" O Ring Double Seal Gasket System	ASTM D 2000 Nbr / Viton
	"E" Insulating Filling Material	Epoxy Resin
	"R" Isolating Ring	D 709 G10 / G11
	EXT External Coating	Solvetless Epoxy Paint 3000 µm
	INT Internal Coating	Solvetless Epoxy Paint 500 µm
INSTALLATION	ABOVEGROUND / UNDERGROUND / SUBSEA	
PNEUMATIC TEST	8 bar for 10 min	
HYDROSTATIC TEST	1.5 Times the Design Pressure - 1 hour (Or as per Customer Requirements)	
HYDRO FATIGUE TEST	5 cycles at 80% test pressure	
DIELECTRIC TEST	3 KV @ 1 minute AC 50÷60 Hz (25°C dry air)	
ELECTRIC INSULATION TEST	≥ 5 MΩ @ 1000 Volt DC	
WELDS	W1-W2-W3 are in accordance with ASME Sec.VIII And Sec IX	
NDT TEST	Butt welds W1-W2 are in accordance with ASME Sec V : RT	
	Closure weld W3 is in accordance with ASME Sec.VIII : PT / MT	
MATERIAL CERTIFICATION	EN 10204 - 3.1 (EN 10204 - 3.2 if requested)	
INSPECTION & TEST/ACCEPTANCE	Manufacturer Standard / Customer Applicable Requirements	
CORROSION ALLOWANCE	Standard 1.6 mm / As per Customer Requirements	
SERVICE	Gas, Hydrocarbons, Oil, Chemical Fluids, Water,Toxic, etc.	

General notes :

- 1) Uncoated pipe length is 50 mm at each end for welding.
- 2) All pressure materials are suitable for resistance to H₂S environments.
- 3) This information is approximate. The exact data shall be specified during the PO Stage.
- 4) Material not in contact to the fluid
- 5) Cables Lugs will be installed on Isolating Joint only if requested.

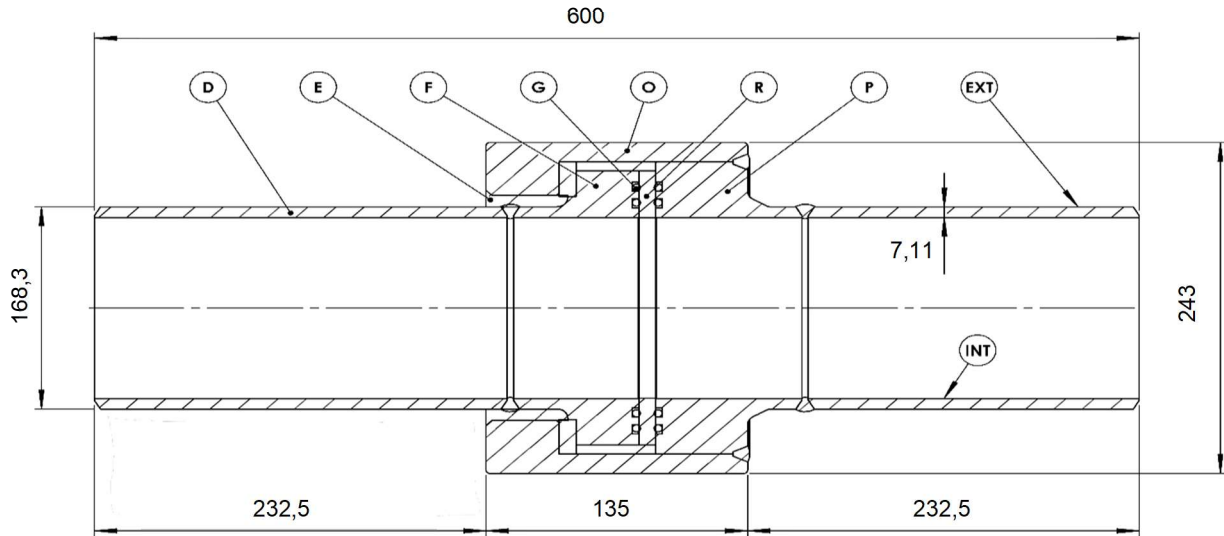
INSULATING JOINT DATA SHEET 6" ANSI #600
QTY : 2

ITEM	DESCRIPTION	
TYPE	INSULATING JOINTS, Monolithic	
DESIGN CODE	ASME B 31.1 - ASME B 31.3 - ASME B 31.4 - ASME B 31.8 - ASME VIII Div.I Appx.2	
DESIGN PRESSURE (barg)	100	
TEST PRESSURE (barg)	150	
DESIGN TEMPERATURE (°C)	-20 / +70 °C	
RATING (ASME/ANSI #) Class	CL600	
ENDS	BUTT WELDED - API 5L / B16.25 / B16.5	
DESIGN FACTOR	According to project datas (standard is 0.6)	
CONNECTION PIPE DN "C" (mm/in.)	168,3 / 6"	
CONNECTION PIPE THK "t" (mm)	7,11	
JOINT OVERALL LENGTH "A"(mm)	600	
MATERIAL	"D" PIPES (API 5L or equivalent)	API 5L - Gr. X52
	"F-O-P" Body Parts	ASTM A694 F52
	"G" O Ring Double Seal Gasket System	ASTM D 2000 Nbr / Viton
	"E" Insulating Filling Material	Epoxy Resin
	"R" Isolating Ring	D 709 G10 / G11
	EXT External Coating	Solvetless Epoxy Paint 3000 µm
	INT Internal Coating	Solvetless Epoxy Paint 500 µm
INSTALLATION	ABOVEGROUND / UNDERGROUND / SUBSEA	
PNEUMATIC TEST	8 bar for 10 min	
HYDROSTATIC TEST	1.5 Times the Design Pressure - 1 hour (Or as per Customer Requirements)	
HYDRO FATIGUE TEST	5 cycles at 80% test pressure	
DIELECTRIC TEST	3 KV @ 1 minute AC 50÷60 Hz (25°C dry air)	
ELECTRIC INSULATION TEST	≥ 5 MΩ @ 1000 Volt DC	
WELDS	W1-W2-W3 are in accordance with ASME Sec.VIII And Sec IX	
NDT TEST	Butt welds W1-W2 are in accordance with ASME Sec V : RT	
	Closure weld W3 is in accordance with ASME Sec.VIII : PT / MT	
MATERIAL CERTIFICATION	EN 10204 - 3.1 (EN 10204 - 3.2 if requested)	
INSPECTION & TEST/ACCEPTANCE	Manufacturer Standard / Customer Applicable Requirements	
CORROSION ALLOWANCE	Standard 1.6 mm / As per Customer Requirements	
SERVICE	Gas, Hydrocarbons, Oil, Chemical Fluids, Water,Toxic, etc.	

General notes :

- 1) Uncoated pipe length is 50 mm at each end for welding.
- 2) All pressure materials are suitable for resistance to H₂S environments.
- 3) This information is approximate. The exact data shall be specified during the PO Stage.
- 4) Material not in contact to the fluid
- 5) Cables Lugs will be installed on Isolating Joint only if requested.

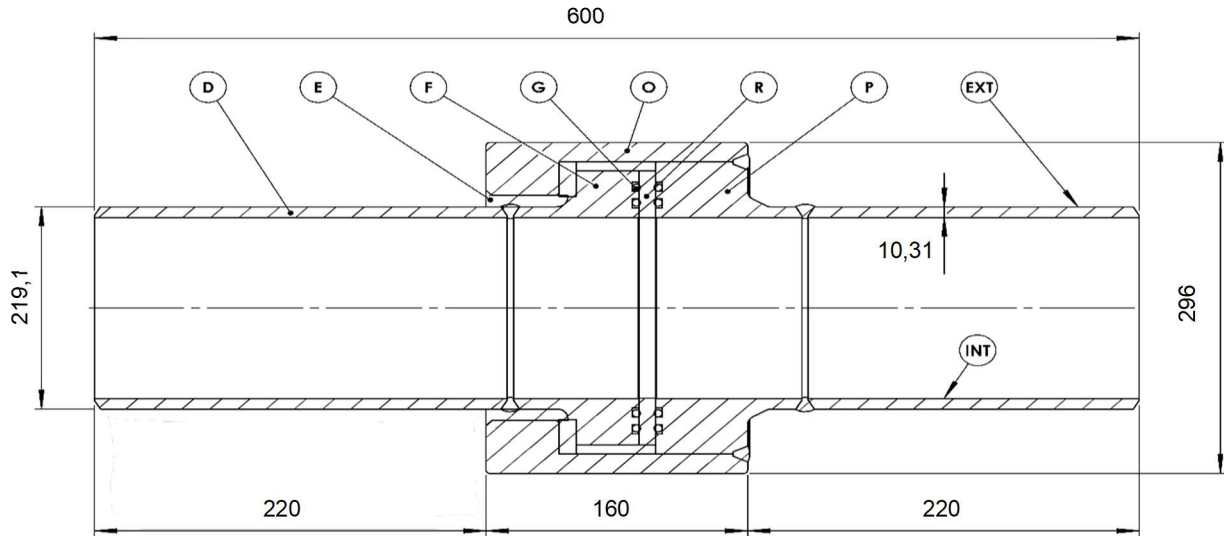
INSULATING JOINT DATA SHEET 8" ANSI #600
QTY : 2

ITEM	DESCRIPTION	
TYPE	INSULATING JOINTS, Monolithic	
DESIGN CODE	ASME B 31.1 - ASME B 31.3 - ASME B 31.4 - ASME B 31.8 - ASME VIII Div.I Appx.2	
DESIGN PRESSURE (barg)	100	
TEST PRESSURE (barg)	150	
DESIGN TEMPERATURE (°C)	-20 / +70 °C	
RATING (ASME/ANSI #) Class	CL600	
ENDS	BUTT WELDED - API 5L / B16.25 / B16.5	
DESIGN FACTOR	According to project datas (standard is 0.6)	
CONNECTION PIPE DN "C" (mm/in.)	219,1 / 8"	
CONNECTION PIPE THK "t" (mm)	10,31	
JOINT OVERALL LENGTH "A"(mm)	600	
MATERIAL	"D" PIPES (API 5L or equivalent)	API 5L - Gr. X52
	"F-O-P" Body Parts	ASTM A694 F52
	"G" O Ring Double Seal Gasket System	ASTM D 2000 Nbr / Viton
	"E" Insulating Filling Material	Epoxy Resin
	"R" Isolating Ring	D 709 G10 / G11
	EXT External Coating	Solvetless Epoxy Paint 3000 µm
	INT Internal Coating	Solvetless Epoxy Paint 500 µm
INSTALLATION	ABOVEGROUND / UNDERGROUND / SUBSEA	
PNEUMATIC TEST	8 bar for 10 min	
HYDROSTATIC TEST	1.5 Times the Design Pressure - 1 hour (Or as per Customer Requirements)	
HYDRO FATIGUE TEST	5 cycles at 80% test pressure	
DIELECTRIC TEST	3 KV @ 1 minute AC 50÷60 Hz (25°C dry air)	
ELECTRIC INSULATION TEST	≥ 5 MΩ @ 1000 Volt DC	
WELDS	W1-W2-W3 are in accordance with ASME Sec.VIII And Sec IX	
NDT TEST	Butt welds W1-W2 are in accordance with ASME Sec V : RT	
	Closure weld W3 is in accordance with ASME Sec.VIII : PT / MT	
MATERIAL CERTIFICATION	EN 10204 - 3.1 (EN 10204 - 3.2 if requested)	
INSPECTION & TEST/ACCEPTANCE	Manufacturer Standard / Customer Applicable Requirements	
CORROSION ALLOWANCE	Standard 1.6 mm / As per Customer Requirements	
SERVICE	Gas, Hydrocarbons, Oil, Chemical Fluids, Water,Toxic, etc.	

General notes :

- 1) Uncoated pipe length is 50 mm at each end for welding.
- 2) All pressure materials are suitable for resistance to H₂S environments.
- 3) This information is approximate. The exact data shall be specified during the PO Stage.
- 4) Material not in contact to the fluid
- 5) Cables Lugs will be installed on Isolating Joint only if requested.

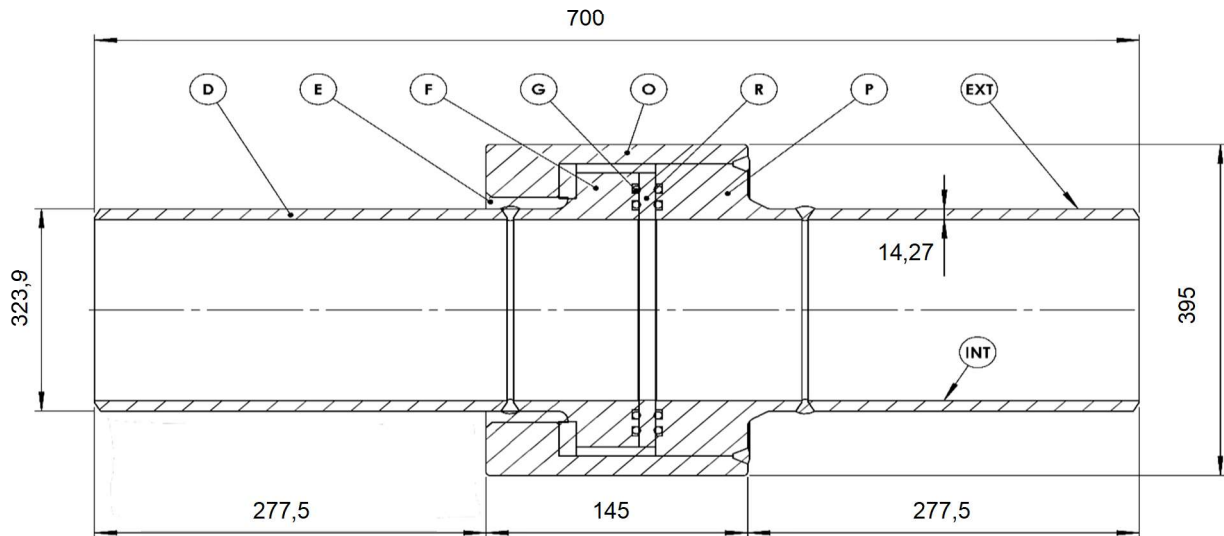
INSULATING JOINT DATA SHEET 12" ANSI #150
QTY : 4

ITEM	DESCRIPTION														
TYPE	INSULATING JOINTS, Monolithic														
DESIGN CODE	ASME B 31.1 - ASME B 31.3 - ASME B 31.4 - ASME B 31.8 - ASME VIII Div.I Appx.2														
DESIGN PRESSURE (barg)	25														
TEST PRESSURE (barg)	37,5														
DESIGN TEMPERATURE (°C)	-20 / +70 °C														
RATING (ASME/ANSI #) Class	CL150														
ENDS	BUTT WELDED - API 5L / B16.25 / B16.5														
DESIGN FACTOR	According to project datas (standard is 0.6)														
CONNECTION PIPE DN "C" (mm/in.)	323,9 / 12"														
CONNECTION PIPE THK "t" (mm)	14,27														
JOINT OVERALL LENGTH "A"(mm)	700														
MATERIAL	<table> <tr> <td>"D" PIPES (API 5L or equivalent)</td><td>API 5L - Gr. X52</td></tr> <tr> <td>"F-O-P" Body Parts</td><td>ASTM A694 F52</td></tr> <tr> <td>"G" O Ring Double Seal Gasket System</td><td>ASTM D 2000 Nbr / Viton</td></tr> <tr> <td>"E" Insulating Filling Material</td><td>Epoxy Resin</td></tr> <tr> <td>"R" Isolating Ring</td><td>D 709 G10 / G11</td></tr> <tr> <td>EXT External Coating</td><td>Solvetless Epoxy Paint 3000 µm</td></tr> <tr> <td>INT Internal Coating</td><td>Solvetless Epoxy Paint 500 µm</td></tr> </table>	"D" PIPES (API 5L or equivalent)	API 5L - Gr. X52	"F-O-P" Body Parts	ASTM A694 F52	"G" O Ring Double Seal Gasket System	ASTM D 2000 Nbr / Viton	"E" Insulating Filling Material	Epoxy Resin	"R" Isolating Ring	D 709 G10 / G11	EXT External Coating	Solvetless Epoxy Paint 3000 µm	INT Internal Coating	Solvetless Epoxy Paint 500 µm
"D" PIPES (API 5L or equivalent)	API 5L - Gr. X52														
"F-O-P" Body Parts	ASTM A694 F52														
"G" O Ring Double Seal Gasket System	ASTM D 2000 Nbr / Viton														
"E" Insulating Filling Material	Epoxy Resin														
"R" Isolating Ring	D 709 G10 / G11														
EXT External Coating	Solvetless Epoxy Paint 3000 µm														
INT Internal Coating	Solvetless Epoxy Paint 500 µm														
INSTALLATION	ABOVEGROUND / UNDERGROUND / SUBSEA														
PNEUMATIC TEST	8 bar for 10 min														
HYDROSTATIC TEST	1.5 Times the Design Pressure - 1 hour (Or as per Customer Requirements)														
HYDRO FATIGUE TEST	5 cycles at 80% test pressure														
DIELECTRIC TEST	3 KV @ 1 minute AC 50÷60 Hz (25°C dry air)														
ELECTRIC INSULATION TEST	≥ 5 MΩ @ 1000 Volt DC														
WELDS	W1-W2-W3 are in accordance with ASME Sec.VIII And Sec IX														
NDT TEST	Butt welds W1-W2 are in accordance with ASME Sec V : RT Closure weld W3 is in accordance with ASME Sec.VIII : PT / MT														
MATERIAL CERTIFICATION	EN 10204 - 3.1 (EN 10204 - 3.2 if requested)														
INSPECTION & TEST/ACCEPTANCE	Manufacturer Standard / Customer Applicable Requirements														
CORROSION ALLOWANCE	Standard 1.6 mm / As per Customer Requirements														
SERVICE	Gas, Hydrocarbons, Oil, Chemical Fluids, Water,Toxic, etc.														

General notes :

- 1) Uncoated pipe length is 50 mm at each end for welding.
- 2) All pressure materials are suitable for resistance to H₂S environments.
- 3) This information is approximate. The exact data shall be specified during the PO Stage.
- 4) Material not in contact to the fluid
- 5) Cables Lugs will be installed on Isolating Joint only if requested.