



# Contact Shock Freezers

# Variants of CSF

## Air-Cooled (L Series)



*Cooling of the condenser is done by air*

## Water-Cooled (W Series)

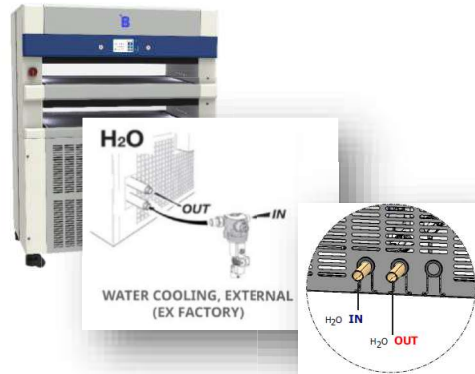

*Cooling of the condenser is done with water*

## Split Model (S Series)



*Cooling of the condenser is done by air with the machine compartment located outside the building*

### Benefits

- Plug and Play
- Stand alone system

- Can directly be connected to the in-house water system
- Can be connected to a separate closed air-conditioning system, also called "A/C water cooling system" or a separate closed water circuit, also called "refrigerated water tower"

- No heat and noise in the operating room and hence avoids the requirement to have an A/C

### Beware

- High heat ejection
- Comparatively High Noise Levels

- Requirement of a water cooling system/centralised cooling systems

- Separate electrical installion/Tubing required

# Freezing Process

## Freezing Process

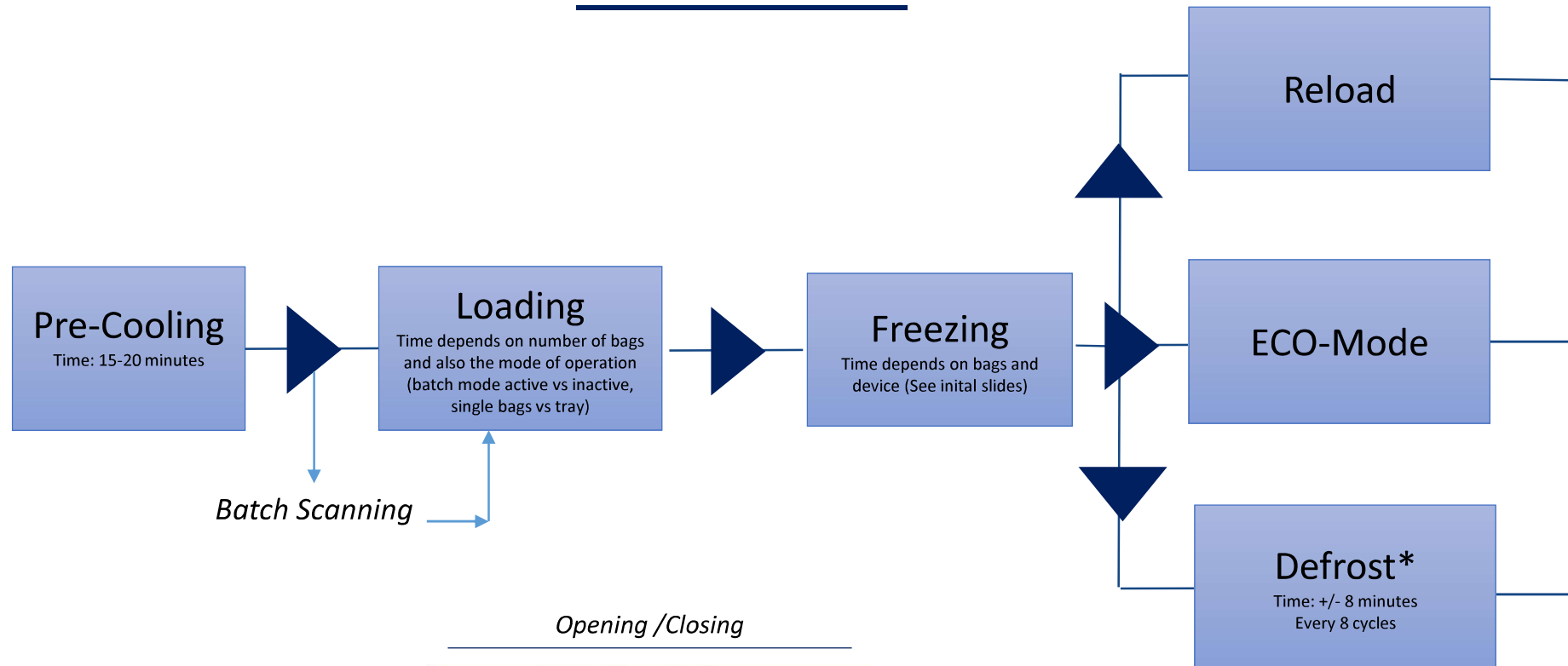

## Opening /Closing

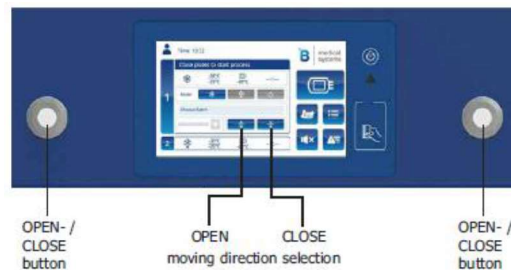

*\*If an ice layer has formed on the freezing plates, the unit has to be defrosted. A defrost cycle should be started at least one time every 8 hours or after 8 freezing processes*

# User Interface

- 7" color touchscreen display
- RFID user log in
- Bluetooth compatible
- USB and SD card for data export

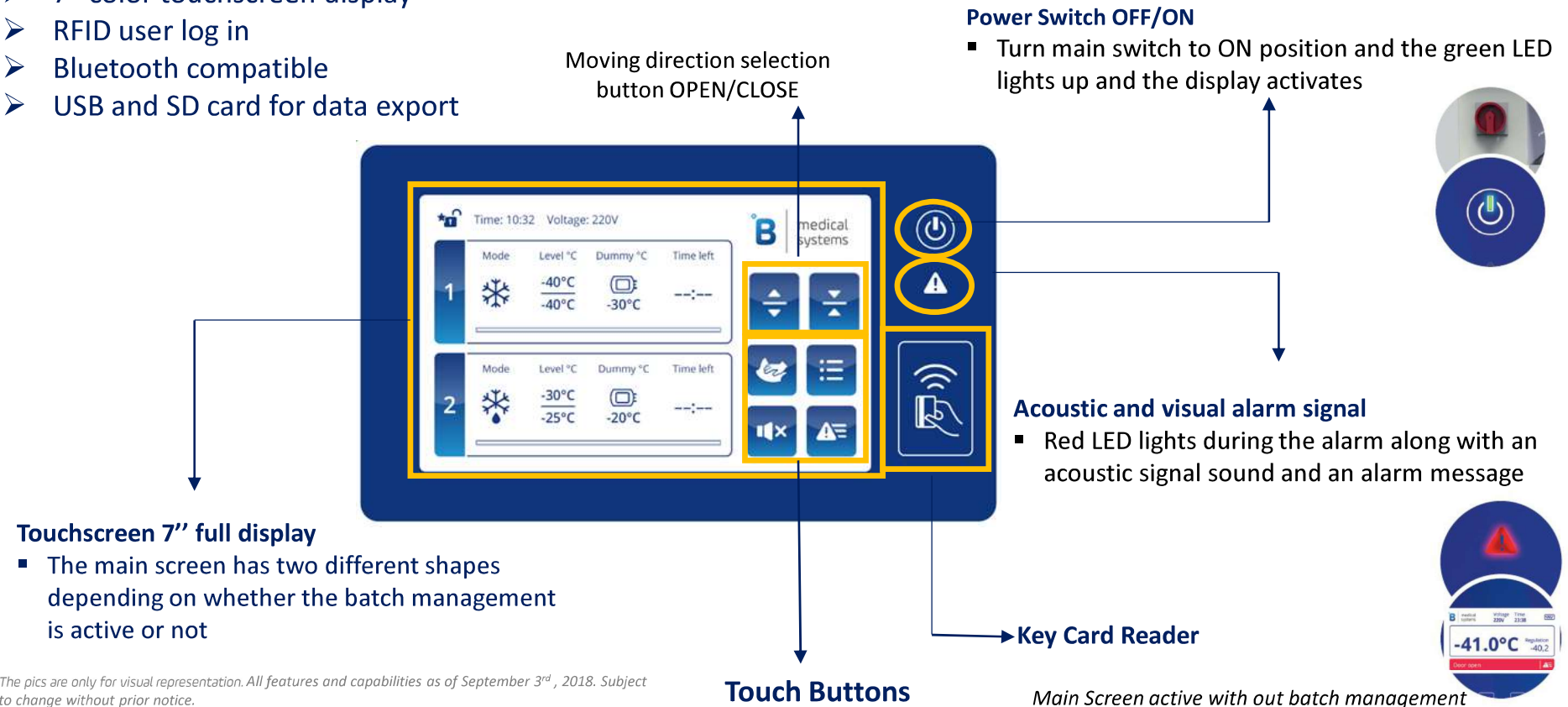

The pics are only for visual representation. All features and capabilities as of September 3<sup>rd</sup>, 2018. Subject to change without prior notice.

# Standard Configuration and Accessories

## Standard Accessories

1. B Medical Systems Electronics 7" full touchscreen display
2. Internal LED Lighting
3. Ambient temperature sensor
4. Potential Free Contact (in case of power failure)
5. Eco Mode
6. Dummy/Reference bag port
7. Ethernet interface/ interface card
8. Condenser Filter
9. Integrated air-cooled condenser
10. B connected\*

\*B Connected Ready

## Optional Accessories



DUMMY /  
REFERENCE  
BAG  
(Shown with  
sensor & cable)



TRANSPORT  
CARRIER



TRANSPORT  
TRAY



BARCODE  
READER



°B CONNECTED



## Pics