

## UbiBot WS1-Pro WIFI Temperature Humidity Light Data Logger IoT System

2.4GHz WiFi only



Model: UBIWS1PRO  
Manufacture warranty: 12 months  
Country of Origin: China

## Descriptions

**WiFi only model:** The device can only connect to 2.4GHz WiFi router network. **5GHz WiFi is NOT supported.**

The UbiBot ® WS1 Pro is a state-of-the-art environmental monitoring system that leverages the latest IoT technologies. Collect environmental data in real-time and automatically sync all the data to the UbiBot ®IoT Platform using WiFi. The clear 4.4" screen allows you to instantly view the latest data. You can also access your device readings in real-time via our App or using a browser anywhere in the world. The embedded RS485 interface ensures your use of external probe in the most extreme conditions.

The device can store over 300,000 records in its internal memory, which can protect your data against network failure. Even if the network fails, the UbiBot WS1 Pro still stores readings, thus ensuring there are no gaps in the data history.

The data sync interval can be set by you. This allows you to balance battery life against frequency of data capture. With the default data sync interval of 15 minutes, using WiFi connection, the device has a battery life of up to 4- 6 months using 4 AA alkaline batteries.



## Features

- Free App & email alerts
- Instant data visualization via LCD screen
- Data sync via WiFi connectivity
- 24/7 temperature & humidity monitoring
- Battery-powered, place it anywhere
- Easy 3 minutes setup
- Customise alert settings
- No hub required

## Applications

- Online real-time detecting temperature, humidity and light level
- Greenhouse
- Museum
- Wine Cellar
- Pharmacy
- Horticulture
- Animal Breeding Warehouse
- Server Room

## Package List

- 1 x WS1 Pro device
- 1 x manual book
- 1 x USB cable
- 1 x stand

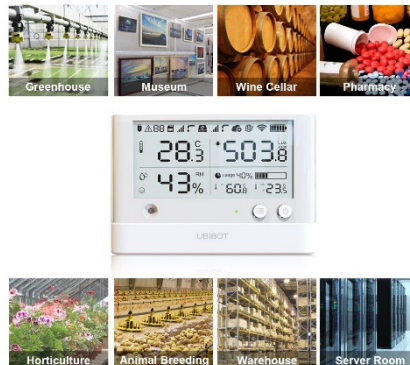

## Specification:

- Temperature
  - Range: -20°C to 60°C (-4°F to 140°F)
  - Accuracy:  $\pm 0.3^{\circ}\text{C}$
- Humidity
  - Range: 0% to 100%
  - Accuracy:  $\pm 3\%\text{RH}$
- Light Level
  - Range: 0 to 83,000 lux
  - Accuracy:  $\pm 2\%$
- Memory: >300,000 sensor records
- WiFi Specifications: **2.4GHz**, channels 1-13 (**5GHz WiFi NOT supported**)
- Screen Size: 10.4 × 5cm (4.4")
- Ports: 2 x Micro USB
- External Probe: Supports DS18B20 probe (optional extra)
- Colour: White
- Material: Flame resistant ABS+PC
- Power Source: 4 x AA batteries / Micro USB (5V/2A)
- Battery Life: 4-6 months (WiFi only)\*
- Dimensions: 12.6 x 8.6 x 2.25 cm
- Weight: 143g  $\pm$  3g

\*The quoted battery life was tested using VARTA industrial batteries under stable signal conditions with default synchronisation and sampling settings.

## External Probe Selection (Optional):

- UbiBot WS1 Pro has two Micro USB ports for connecting external probes or USB power-supply.
- Both Micro USB ports can be used for external DS18B20 temperature probe. Temperature range (-55 to 125 °C) with 3 or 5 meters round cable.
- One of Micro USB ports can be used for RS485 temperature and humidity probe.
- We recommend to buy Micro USB Splitter Cable Adapter (One Male to Two Female) if you want to use external USB power-supply and two external probes at the same time.
- Please note, when the TH30S-B probe connected with our WS1 Pro device, only temperature readings can be displayed on the screen.

The device comes with one Micro USB port, allowing you to

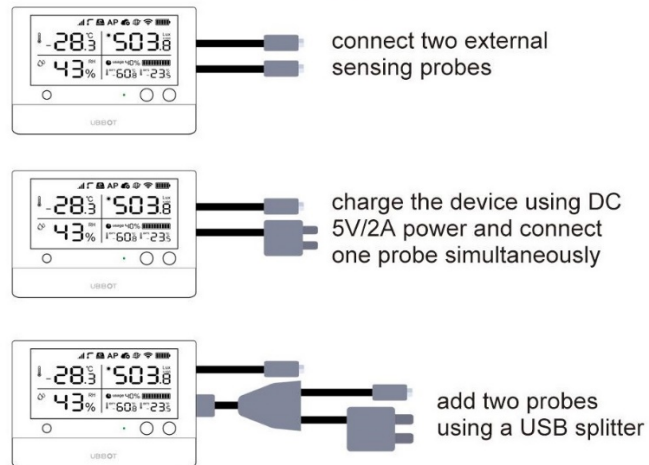

\*The splitter and external probe are optional.

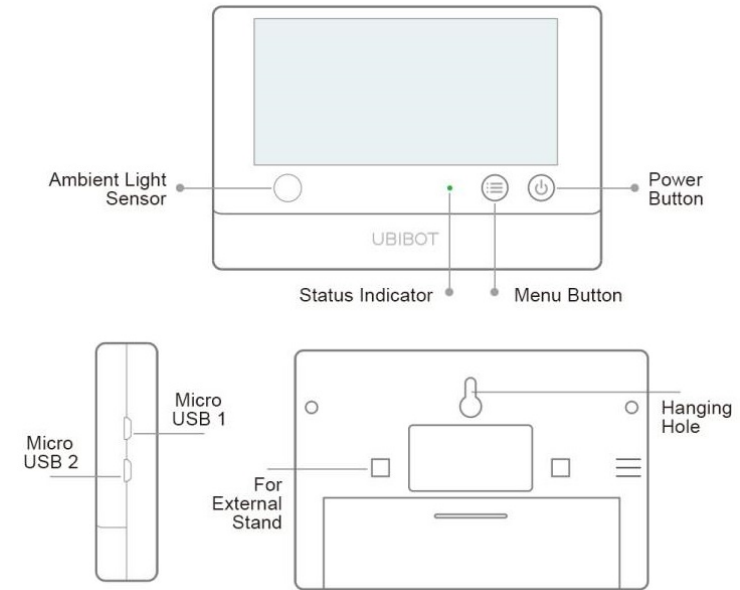

The cloud-based IoT platform offers advanced data analysis and management. It also allows you to setup real-time notifications - if a metric goes outside the range you specify, the platform will notify you through the app, by email or other methods, allowing you to respond promptly before costly damage happens. The IoT platform gives users access to both the real-time data and history via our mobile app or on any browser. We are now working with IFTTT (if this then that), allowing you to build custom link with other smart devices.

The data sync interval can be set by you. This allows you to balance battery life against frequency of data capture. With the default data sync interval of 15 minutes the device has a battery life of up to 4- 6 months using 2 AA alkaline batteries. Power-supply using Micro-USB is supported. You can check the battery voltage of the device remotely and set up rules to be notified when low-battery, network failure or sensor reading exceeds the setting range. Available rule alerts include Email, APP. Please note, charges may apply to SMS text and voice call alert modes. These two modes cost the balance of the credits in your account.

No subscription is needed. Free 200MB Cloud Storage enough to store data over 2 years on default settings. Export the data to CSV or PDF without extra charge.

## View through mobile APP

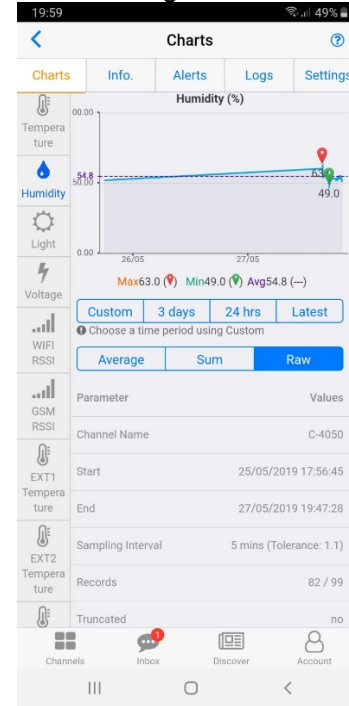

## Data download in CSV format

created_at	field1 (Temperature °C )	field2 (Humidity)	field3(Light)	field4(Voltage)
2019-05-27T15:28:08+08:00	25.88121	60	81.639999	5
2019-05-27T15:28:10+08:00	25.894562	60	76.439995	5
2019-05-27T15:28:12+08:00	25.937286	61	76.919998	5
2019-05-27T15:28:14+08:00	25.937286	61	79.5	5
2019-05-27T15:28:15+08:00	25.96666	62	77.799995	5
2019-05-27T15:28:16+08:00	25.96666	62	75.919998	5
2019-05-27T15:28:18+08:00	26.006714	62	76.860001	5
2019-05-27T15:28:19+08:00	26.022736	62	77.720001	5
2019-05-27T15:28:25+08:00	26.121536	63	78.540001	5
2019-05-27T15:28:47+08:00	26.404594	60	97.439995	5
2019-05-27T15:28:51+08:00				
2019-05-27T15:29:47+08:00	26.615547	58	78.939995	
2019-05-27T15:30:47+08:00	26.658272	58	86.559998	
2019-05-27T15:31:47+08:00	26.700996	57	96.839996	
2019-05-27T15:32:47+08:00	26.700996	57	84.479996	
2019-05-27T15:33:47+08:00	26.743721	57	83.279999	

## View dashboard through PC

