

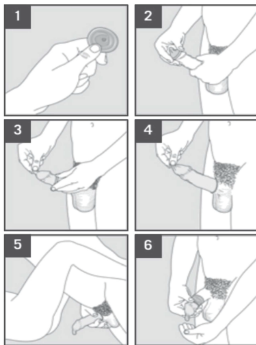

feel safe

INSTRUCTIONS FOR MALE CONDOM USE

When used correctly every time you have sex condoms greatly reduce the risk of unintended pregnancy, HIV/ AIDS and some other sexually transmitted infections. Use a new condom every time you have sex and follow the Instructions carefully.



BEFORE INTERCOURSE

1. Carefully open the package so the condom does not tear. Do not unroll the condom before putting it on.
2. If you are not circumcised, pull back the foreskin. Put the condom on the end of the hard penis.
Note: If the condom is initially placed on the penis backwards, do not turn it around. Throw it away and start with a new one.
3. Pinching the tip of the condom to squeeze out air, roll on the condom until it reaches the base of the penis. Place the condom on the erect penis before any contact occurs between the penis and the partner's body to assist in the prevention of sexually transmitted infections and pregnancy.
4. Check to make sure there is space at the tip and that the condom is not broken. With the condom on, insert the penis for intercourse.

AFTER INTERCOURSE

5. When withdrawing the penis after sex and soon after ejaculation, hold the rim of the condom to keep the condom in place.
6. Remove the condom while the penis is still hard. Be careful not to spill any semen on the woman's genitals.

DISPOSAL OF THE CONDOM

Wrap the used condom in a piece of paper and throw it away safely where children cannot get hold of it. Dispose in a closed rubbish bin, bury or burn. It may be disposed by throwing in a pit latrine. Do not throw it in a flushing toilet.

WARNING!

Use the condom only once. Do not re-use the Condom. Re-use of Condom may result breakage and may increase incidents of pregnancies and diseases. The Condom is made from Natural Rubber Latex which might cause Allergic Reactions including Anaphylactic Shock, if the user is Allergic to Latex. Consult a doctor or pharmacist about the compatibility of topical medicines that might come in contact with the condom.

INSTRUCTIONS FOR MALE CONDOM USE

Storage

Try to keep condoms in a cool, dry place away from direct sunlight. Do not leave them in the sun or carry them in a wallet or back pocket under friction for a long time.

INSPECTING AND OPENING THE PACKET

- Before sex, talk to your partner about using a condom. • Do not use a condom that has expired. Check the expiry date on the package.
- Do not use a condom if the packaging is torn or damaged, if the condom is sticky or dried out, or if the colour has changed. Discard that condom and use a new one from an undamaged package. • Open the packet and handle condoms carefully to avoid damage to the condom by fingernails, jewellery, etc.
- Do not worry if you find a slippery substance in and on the condom when opening the packet. Some condoms have a lubricant to make sex smoother.

IN CASE OF SLIPPING OR BREAKING

- If you feel the condom might be slipping, check it with your hand. It is very important that the condom does not slip off during sex.
- If the condom breaks, stop sex at once. Remove the torn condom and put on another. • If the condom breaks or leaks and the man has ejaculated, take action to prevent pregnancy. Go to the nearest clinic for emergency contraception as soon as possible, within 72 hours of the breakage/leakage.

STANDARD

The Male Latex Condoms made to International Standards: based on ISO 4074:2015.

QMS: NF EN ISO:13485:2016 ISO:9001:2015 & ISO : 14001:2015

LUBRICATION

- Lubrication is very important. The condom covered penis should slide easily in the partner's body. Otherwise the condom may cause pain or may make the body more vulnerable to HIV, or may break. Use only water-based lubricants, such as water, water-based lubricant, or spermicidal foam.
- Do not use lubricants with oil in them, such as petroleum jelly, body lotions, baby oil, butter, mineral oil or cooking oil. Oil weakens latex condoms. • Do not put anything into the vagina to make it drier.



Indus Medicare Private Limited,
Regd.office: Suryodaya, 1-10-60/3,Begumpet,
Hyderabad 500 016.
Factor y: Ramaipally(V), Medak Dist.-502336
Telangana, India.Licence: 46/MD/AP/99/F/R
www.indusmedicare.com



CEpartner4U BV,
Esdoornlaan 13
3951 DB Maarn,
The Netherlands

importeur: Bizzzy Diamond BV www.bizzzydiamond.com



Date of revision 09-2021