



CATALOGUE 2021

CARDIAC CATHETERS
AND CANNULAE



Cardiovascular cannulation

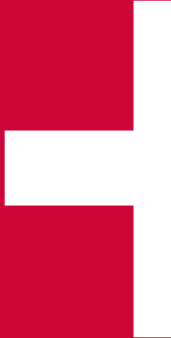

Index

- 4 Arterial cannulae
- 10 Aortic catheters
- 12 Flex line venous cannulae
- 14 Flex line two stage venous
cannulae

Arterial cannulae

REINFORCED, CURVED TIP WITH FLANGE



TYPE A



TYPE B

TYPE A - BODY LENGTH: 30 CM

TYPE B - BODY LENGTH: 21 CM

Description	Size	TYPE A - BODY LENGTH: 30 CM			TYPE B - BODY LENGTH: 21 CM		
		Standard	With vent plug	With vented red cap	Standard	With vent plug	With vented red cap
Without connector	20 Fr	A2016	A2016V	-	B2016	B2016V	-
	22 Fr	A2216	A2216V	-	B2216	B2216V	-
	24 Fr	A2416	A2416V	-	B2416	B2416V	-
With connector	20 Fr	A20161	-	A20161V	B20161	-	B20161V
	22 Fr	A22161	-	A22161V	B22161	-	B22161V
	24 Fr	A24161	-	A24161V	B24161	-	B24161V
With luer connector	20 Fr	A20162	-	A20162V	B20162	-	B20162V
	22 Fr	A22162	-	A22162V	B22162	-	B22162V
	24 Fr	A24162	-	A24162V	B24162	-	B24162V

PRODUCT INFORMATION

Andocor arterial cannulae are intended for use in perfusion of the ascending aorta during cardiopulmonary bypass.

All versions with a vented red cap can be equipped with a vent plug. Upon request the luer connector can be mounted at an angle 180° - facing up.

Q Connection site: 3/8"
Qty/box: 20 Pcs

+ Kink resistant reinforced tubing
Easy tip orientation thanks to indexing marker
Smooth plastic tip

ARTERIAL CANNULA PRESSURE DROP VS FLOW

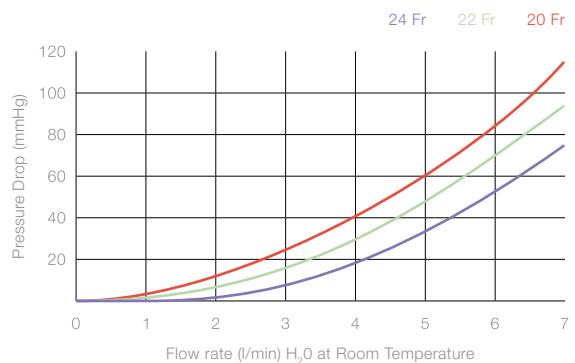

Arterial cannulae

REINFORCED, STRAIGHT TIP WITH RING



TYPE A



TYPE B

TYPE A - BODY LENGTH: 30 CM

TYPE B - BODY LENGTH: 21 CM

Description	Size	TYPE A - BODY LENGTH: 30 CM			TYPE B - BODY LENGTH: 21 CM		
		Standard	With vent plug	With vented red cap	Standard	With vent plug	With vented red cap
Without connector	20 Fr	A2013	A2013V	-	B2013	B2013V	-
	22 Fr	A2213	A2213V	-	B2213	B2213V	-
	24 Fr	A2413	A2413V	-	B2413	B2413V	-
With connector	20 Fr	A20131	-	A20131V	B20131	-	B20131V
	22 Fr	A22131	-	A22131V	B22131	-	B22131V
	24 Fr	A24131	-	A24131V	B24131	-	B24131V
With luer connector	20 Fr	A20132	-	A20132V	B20132	-	B20132V
	22 Fr	A22132	-	A22132V	B22132	-	B22132V
	24 Fr	A24132	-	A24132V	B24132	-	B24132V

PRODUCT INFORMATION

Andocor arterial cannulae are intended for use in perfusion of the ascending aorta during cardiopulmonary bypass.

All versions with a vented red cap can be equipped with a vent plug. Upon request the luer connector can be mounted at an angle 180° - facing up.

Q Connection site: 3/8"
Qty/box: 20 Pcs

+ Kink resistant reinforced tubing
Easy tip orientation thanks to indexing marker
Smooth plastic tip

ARTERIAL CANNULA PRESSURE DROP VS FLOW

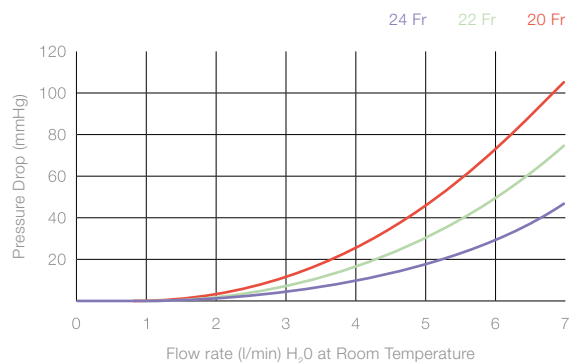

Suckers

Index

- 40 Rigid sucker
- 40 Flexible and malleable suckers
- 40 Yankauer suction tubes
- 41 Pericardial sumps
- 42 Thoracic drains

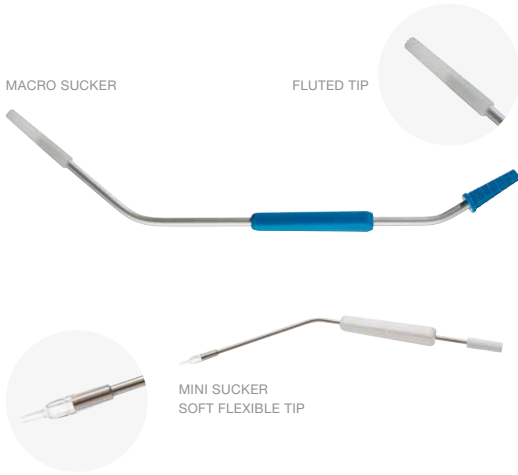

RIGID SUCKER

Tip	Length	Reference
Macro sucker	36 cm	RS01
Mini sucker	25 cm	RS02

PRODUCT INFORMATION

Andocor suckers are used for the removal of excess fluid from the surgical field.

- Q** Connection: 1/4"
Qty/box: 20 Pcs
- +** Metal suction tube with plastic handle
Easy and comfortable directing

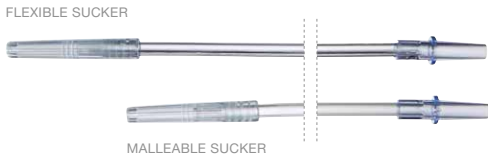

FLEXIBLE AND MALLEABLE SUCKERS

Tubing	Size	Length	Reference
Flexible	17 Fr	36 cm	FS300
Malleable	17 Fr	25 cm	FS301

PRODUCT INFORMATION

Andocor suckers are used for the removal of excess fluid from the surgical field.

- Q** Connection: 1/4"
Qty/box: 20 Pcs
- +** Provides continuous suction
Flexible or malleable tubing



YANKAUER SUCTION TUBES

Tubing	Length	Open tip 22 Fr	Bulb tip 30 Fr
Vented	25 cm	ST04	ST02
Non-vented	25 cm	ST03	ST01

PRODUCT INFORMATION

Andocor yankauer suction tubes are intended to aspirate body waste fluid during surgery.

- Q** Connection: 1/4"
Qty/box: 20 Pcs