

Hi-MO 6

Explorer

LR5-72HTH 560~580M

- Suitable for Distribution Market
- Simple design embodies modern style
- Better energy generation performance
- High-quality module guarantees long-term reliability



15-year Warranty for
Materials and Processing



25-year Warranty for Extra
Linear Power Output

Complete System and Product Certifications

IEC 61215, IEC 61730, UL 61730

ISO9001:2015: ISO Quality Management System

ISO14001: 2015: ISO Environment Management System

ISO45001: 2018: Occupational Health and Safety

IEC62941: Guideline for module design qualification and type approval

LONGI



22.5%
MAX MODULE
EFFICIENCY

0~3%
POWER
TOLERANCE

<1.5%
FIRST YEAR
POWER DEGRADATION

0.40%
YEAR 2-25
POWER DEGRADATION

Additional Value

25-Year Power Warranty

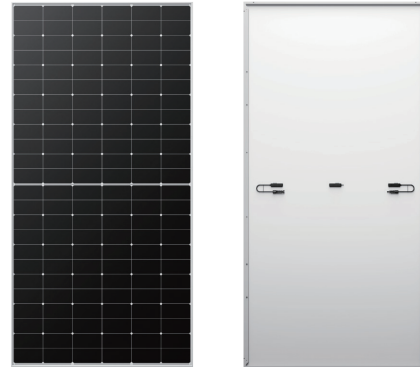
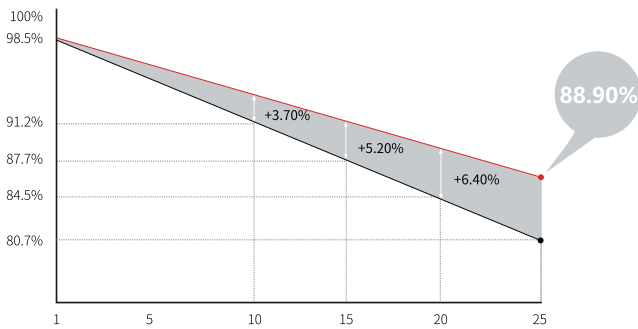

Mechanical Parameters

Cell Orientation	144 (6×24)
Junction Box	IP68, three diodes
Output Cable	4mm ² , +400, -200mm/±1400mm length can be customized
Glass	Single glass, 3.2mm coated tempered glass
Frame	Anodized aluminum alloy frame
Weight	27.5kg
Dimension	2278×1134×35mm
Packaging	31pcs per pallet / 155pcs per 20' GP / 620pcs per 40' HC

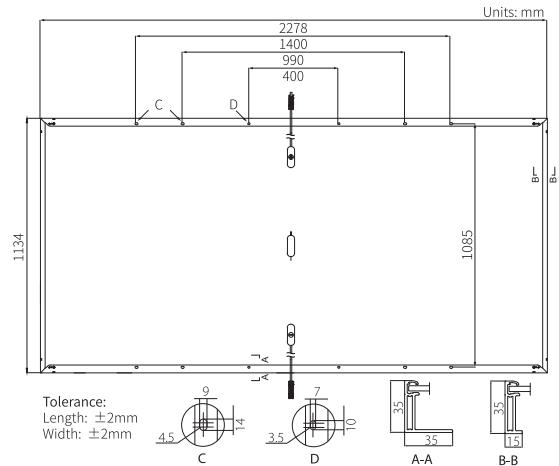

Electrical Characteristics

STC : AM1.5 1000W/m² 25°C

NOCT : AM1.5 800W/m² 20°C 1m/s

Test uncertainty for Pmax: ±3%

Module Type	LR5-72HTH-560M		LR5-72HTH-565M		LR5-72HTH-570M		LR5-72HTH-575M		LR5-72HTH-580M	
	STC	NOCT	STC	NOCT	STC	NOCT	STC	NOCT	STC	NOCT
Maximum Power (Pmax/W)	560	418	565	422	570	426	575	430	580	433
Open Circuit Voltage (Voc/V)	51.61	48.46	51.76	48.60	51.91	48.74	52.06	48.88	52.21	49.02
Short Circuit Current (Isc/A)	13.94	11.26	14.01	11.31	14.07	11.36	14.14	11.42	14.20	11.47
Voltage at Maximum Power (Vmp/V)	43.46	39.66	43.61	39.79	43.76	39.93	43.91	40.07	44.06	40.20
Current at Maximum Power (Imp/A)	12.89	10.55	12.96	10.61	13.03	10.67	13.10	10.72	13.17	10.78
Module Efficiency(%)	21.7		21.9		22.1		22.3		22.5	

Operating Parameters

Operational Temperature	-40°C ~ +85°C
Power Output Tolerance	0 ~ 3%
Voc and Isc Tolerance	±3%
Maximum System Voltage	DC1500V (IEC/UL)
Maximum Series Fuse Rating	25A
Nominal Operating Cell Temperature	45±2°C
Protection Class	Class II
Fire Rating	UL type 1 or 2 IEC Class C

Mechanical Loading

Front Side Maximum Static Loading	5400Pa
Rear Side Maximum Static Loading	2400Pa
Hailstone Test	25mm Hailstone at the speed of 23m/s

Temperature Ratings (STC)

Temperature Coefficient of Isc	+0.050%/°C
Temperature Coefficient of Voc	-0.230%/°C
Temperature Coefficient of Pmax	-0.290%/°C



Product Service

CERTIFICATE

No. Z2 099333 0045 Rev. 19

Holder of Certificate: **LONGi Green Energy Technology Co., Ltd.**
No. 388, Middle Hangtian Road
Chang'an District
710100 Xi'an City, Shaanxi
PEOPLE'S REPUBLIC OF CHINA

Certification Mark:



Product: **Crystalline Silicon Terrestrial Photovoltaic (PV) Modules**
Mono-Crystalline Silicon Photovoltaic Module

The product was tested on a voluntary basis and complies with the essential requirements. The certification mark shown above can be affixed on the product. It is not permitted to alter the certification mark in any way. In addition, the certification holder must not transfer the certificate to third parties. This certificate is valid until the listed date, unless it is cancelled earlier. All applicable requirements of the testing and certification regulations of TÜV SÜD Group have to be complied. For details see: www.tuvsud.com/ps-cert

Test report no.: 704061700516-19

Valid until: 2027-03-17

Date, 2022-03-18

(Zhulin Zhang)

CERTIFICATE

No. Z2 099333 0045 Rev. 19

Model(s):

LR6-72HV-xxxM, (xxx=335-360 in step of 5)
 LR6-60HV-xxxM, (xxx=280-300 in step of 5)
 LR6-72PH-xxxM, (xxx=340-380 in step of 5)
 LR6-60PH-xxxM, (xxx=285-315 in step of 5)
 LR6-72HPH-xxxM, (xxx=365-395 in step of 5)
 LR6-72HIH-xxxM, (xxx=365-395 in step of 5)
 LR6-60HPH-xxxM, (xxx=300-325 in step of 5)
 LR6-60HIH-xxxM, (xxx=300-325 in step of 5)
 LR6-72OPH-xxxM, (xxx=385-415 in step of 5)
 LR6-60OPH-xxxM, (xxx=335-365 in step of 5)
 LR6-72HPH-xxxMC, (xxx=375-390 in step of 5)
 LR6-60HPH-xxxMC, (xxx=305-325 in step of 5)
 LR4-72HPH-xxxM, (xxx=420-465 in step of 5)
 LR4-72HIH-xxxM, (xxx=420-465 in step of 5)
 LR4-60HPH-xxxM, (xxx=350-380 in step of 5)
 LR4-60HIH-xxxM, (xxx=350-380 in step of 5)
 LR4-72ZPH-xxxM, (xxx=420-435 in step of 5)
 LR4-60ZPH-xxxM, (xxx=350-365 in step of 5)
 LR6-60ZPH-xxxM, (xxx=330-355 in step of 5)
 LR4-78ZPH-xxxM, (xxx=455-485 in step of 5)
 LR5-72HPH-xxxM, (xxx=525-555 in step of 5)
 LR5-66HPH-xxxM, (xxx=480-505 in step of 5)
 LR4-66HPH-xxxM, (xxx=395-415 in step of 5)
 LR4-66HIH-xxxM, (xxx=395-415 in step of 5)
 LR5-72HIH-xxxM, (xxx=525-550 in step of 5)
 LR5-66HIH-xxxM, (xxx=480-505 in step of 5)
 LR5-78HPH-xxxM, (xxx=575-595 in step of 5)
 LR5-78ZPH-xxxM, (xxx=565-585, in step of 5)
 LR4-50HPH-xxxM, (xxx=305-320, in step of 5)
 LR4-66HTB-xxxM, (xxx=410-430 in step of 5)
 LR4-60HTB-xxxM, (xxx=370-390 in step of 5)
 LR5-54HPH-xxxM, (xxx=395-415 in step of 5)
 LR4-66HTH-xxxM, (xxx=420-440 in step of 5)
 LR4-60HTH-xxxM, (xxx=380-400 in step of 5)
 LR5-54HIH-xxxM, (xxx=395-415 in step of 5)
 xxx stands for rated output power at STC

Parameters:

Fire Safety Class: Class C according to UL790.
 Safety Class: Class II
 Max. System Voltage: 1500V DC
 Test Laboratory: Yangzhou Opto-Electrical
 Products Testing Institute.
 No.10 West Kaifa Road, Yangzhou
 225009 Jiangsu, P.R. China.
 Construction: Framed, with Junction box, cable and

connector.

Tested according to:

IEC 61215-1:2016
 IEC 61215-1-1:2016
 IEC 61215-2:2016
 IEC 61730-1:2016
 IEC 61730-2:2016
 EN 61215-1:2016
 EN 61215-1-1:2016
 EN 61215-2:2017
 EN IEC 61730-1:2018
 EN IEC 61730-1:2018/AC:2018-06
 EN IEC 61730-2:2018
 EN IEC 61730-2:2018/AC:2018-06