

# Dell Pro Wireless Keyboard and Mouse KM5221W



## User's Guide

Keyboard and Mouse Models: KM5221W  
Regulatory Model: KB3121Wt/MS3121Wt/SD-8160  
KB3121Wp/MS3121Wp/DGRFEO



# Notes, Cautions, and Warnings

---

-  **NOTE:** A NOTE indicates important information that helps you make better use of your computer.
-  **CAUTION:** A CAUTION indicates potential damage to hardware or loss of data if instructions are not followed.
-  **WARNING:** A WARNING indicates a potential for property damage, personal injury, or death.

© 2021-2022 Dell Inc. or its subsidiaries. All rights reserved. Dell, EMC, and other trademarks are trademarks of Dell Inc. or its subsidiaries. Other trademarks may be trademarks of their respective owners.

2022-03

Rev. A01

# Contents

Notes, Cautions, and Warnings.....	2
What's in the box .....	5
Keyboard features .....	6
Mouse features.....	7
Dell Peripheral Manager .....	8
Setting up your wireless keyboard.....	9
Setting up your wireless mouse .....	11
Pairing your wireless keyboard and mouse.....	14
Pairing your keyboard and mouse using the USB dongle.....	14
Keyboard specifications .....	16
General.....	16
Electrical .....	16
Physical characteristics .....	16
Environmental.....	17
Wireless.....	17
Mouse specifications .....	18
General.....	18
Electrical .....	18
Physical characteristics .....	18
Environmental.....	19
Wireless.....	19

Troubleshooting..... 20

Statutory Information..... 23

    Warranty ..... 23

        Limited warranty and return policies ..... 23

        For U.S. customers: ..... 23

        For European, Middle Eastern and African customers: ..... 23

        For non-U.S. customers: ..... 23

# What's in the box

---

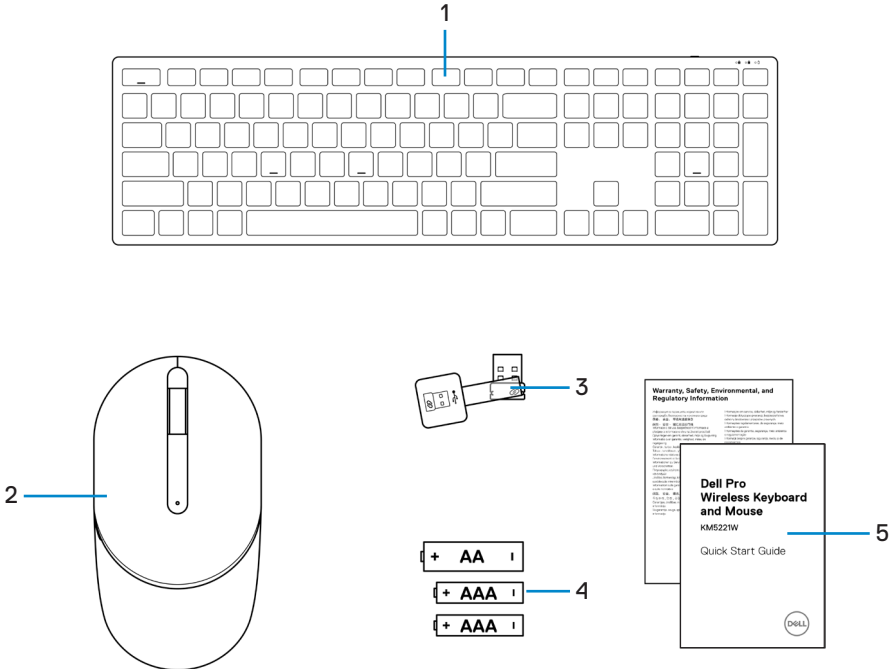

1 Keyboard

3 USB dongle

5 Documents

2 Mouse

4 Batteries (AA-type and AAA-type)

# Keyboard features

---

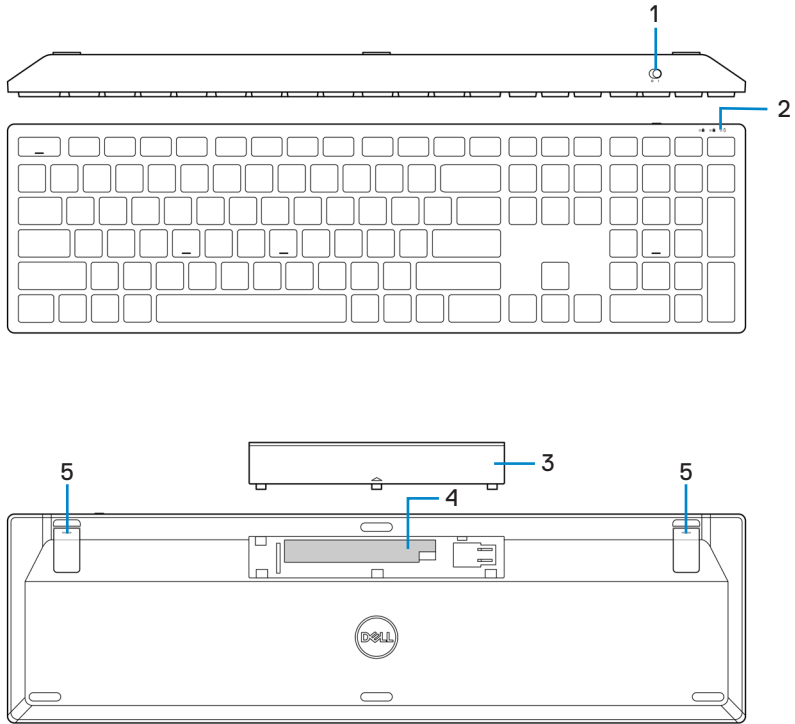

- 1 Power switch
- 2 Battery-status light
- 3 Battery cover
- 4 Battery compartment
- 5 Keyboard feet

# Mouse features

---

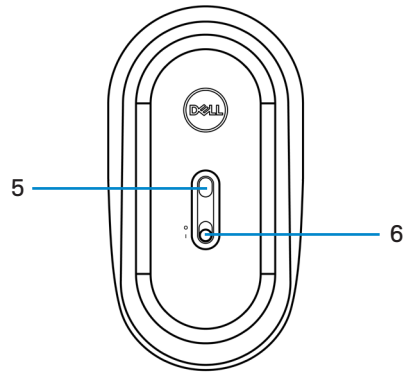
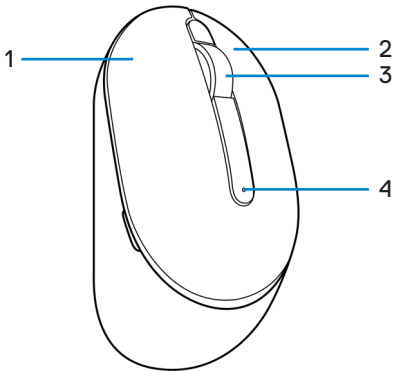

- 1 Left button
- 3 Scroll wheel
- 5 Optical sensor

- 2 Right button
- 4 Battery-status light
- 6 Power switch

# Dell Peripheral Manager

---

Dell Peripheral Manager software enables you to perform the following:

- View device information such as firmware version and battery status through the Info tab.
- Upgrade the latest firmware updates on your devices.

For more information, see *Dell Peripheral Manager User's Guide* on the product page at <https://www.dell.com/support/drivers>.



# Setting up your wireless keyboard

---

1 Using your fingertip, pry open the battery cover.

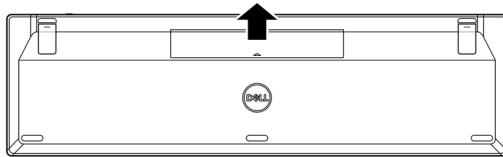

2 Install the AAA batteries into the battery compartment.

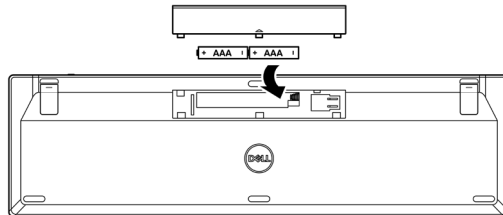

3 Replace the battery cover.

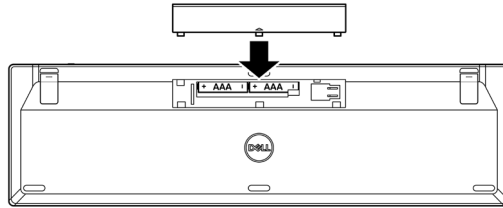

4 Open and extend the keyboard feet.

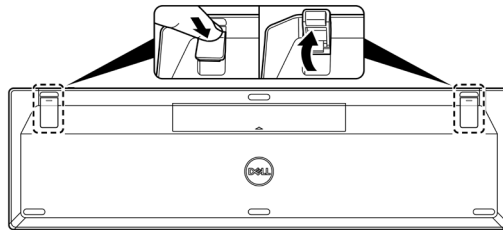

5 Slide the power switch to turn on the keyboard.

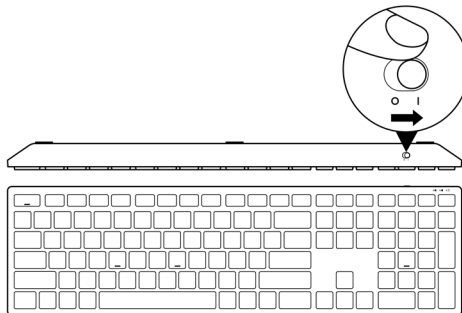

 **NOTE:** Ensure that the distance between your computer and keyboard is within 0.5 meters.

# Setting up your wireless mouse

---

- 1 Locate the slot on the side of the mouse cover. Using your fingertip, pry open the mouse cover.

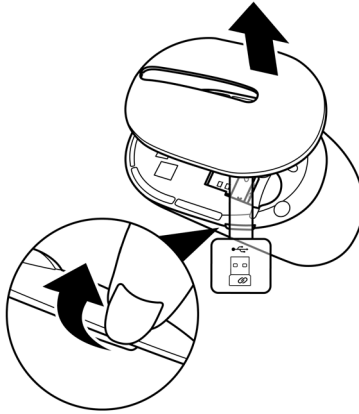

- 2 Remove the USB dongle from its compartment.

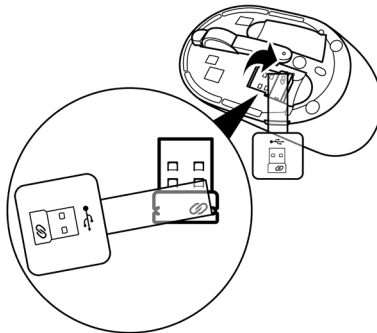

3 Install the AA battery into the battery compartment.

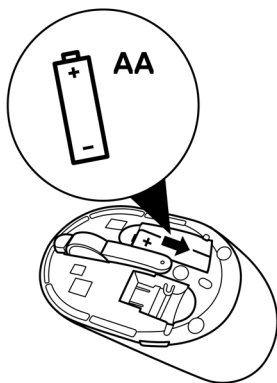

4 Replace the mouse cover.

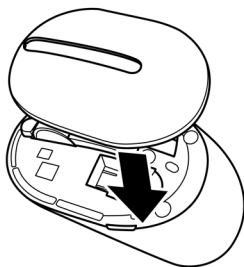

5 Slide the power switch to turn on the mouse.

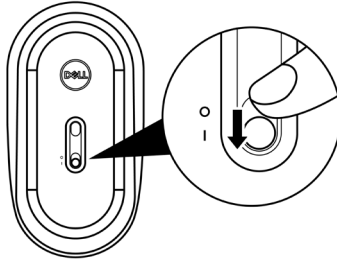

 **NOTE:** Ensure that the distance between your computer and mouse is within 0.5 meters.

# Pairing your wireless keyboard and mouse

Your Dell wireless keyboard and mouse can be paired with devices using the USB dongle. You can pair and switch between a laptop, desktop, or any compatible mobile device.

## Pairing your keyboard and mouse using the USB dongle

 **NOTE:** You can connect a device to your wireless keyboard and mouse using the Dell Universal pairing or Dell Peripheral Manager.

- 1 Detach the dongle tag from the USB dongle.
- 2 Connect the Dell Universal USB dongle to the USB port on your computer.

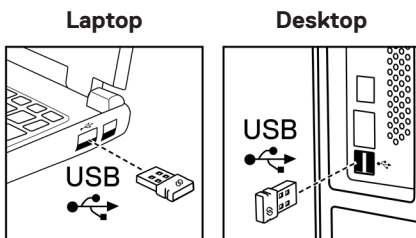

- 3 Slide the power switch to turn on the keyboard.

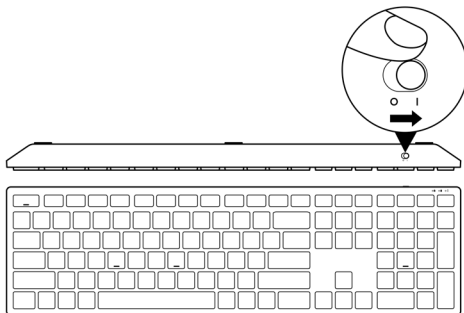

4 Slide the power switch to turn on the mouse.

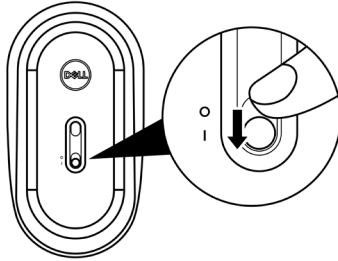

The keyboard and mouse are paired with your computer.

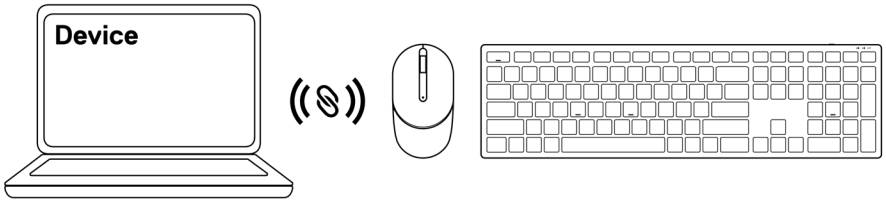

# Keyboard specifications

---

## General

Model number	KB500
Connection type	Wireless (2.4 GHz with nano dongle)
System requirement	<ul style="list-style-type: none"><li>• Windows Server 2012; 2012 R2, 2016 (RF dongle only)</li><li>• Windows 8, 32/64-bit</li><li>• Windows 10, 32/64-bit</li><li>• Windows 11</li><li>• Android</li><li>• Chrome</li><li>• Linux 6.x, Ubuntu</li><li>• Free-DOS (RF dongle only)</li></ul>

## Electrical

Operating voltage	2 V ~ 3.2 V
Battery life	Approximately 36 months
Battery type	AAA Batteries (1400 mAh)

## Physical characteristics

Weight (with battery)	421 g (0.93 lb)
Weight (without battery)	400 g (0.88 lb)
Dimensions:	
Length	123 mm (4.85 in.)
Width	433 mm (17.05 in.)
Height	34 mm (1.34 in.)



## Environmental

Temperature:

Operating -10°C to 50°C (14°F to 122°F)

Storage -40°C to 65°C (-40°F to 149°F)

Storage humidity 95% maximum relative humidity;  
non-condensing

## Wireless

RF protocol 2.4 GHz RF

Range

- Up to 10 m radio range.
- No performance degradation up to maximum radio range (10 m).

# Mouse specifications

---

## General

Model number	MS300
Connection type	Wireless (2.4 GHz with nano dongle)
System requirement	<ul style="list-style-type: none"><li>• Windows Server 2012; 2012 R2, 2016 (RF dongle only)</li><li>• Windows 8, 32/64-bit</li><li>• Windows 10, 32/64-bit</li><li>• Windows 11</li><li>• Android</li><li>• Chrome</li><li>• Linux 6.x, Ubuntu</li><li>• Free-DOS (RF dongle only)</li></ul>

## Electrical

Operating voltage	1.6 V ~ 0.9 V
Battery life	Approximately 36 months
Battery type	AA Battery (2850 mAh)

## Physical characteristics

Weight (with battery)	92 g (0.21 lb)
Weight (without battery)	65 g (0.15 lb)
Dimensions:	
Length	115 mm (4.52 in.)
Width	62 mm (2.44 in.)
Height	39 mm (1.53 in.)

## Environmental

Temperature:

Operating -10°C to 50°C (14°F to 122°F)

Storage -40°C to 65°C (-40°F to 149°F)

Storage humidity 95% maximum relative humidity;  
non-condensing

## Wireless

RF protocol 2.4 GHz RF

Range

- Up to 10 m radio range.
- No performance degradation up to maximum radio range (10 m).

# Troubleshooting

---

Problems	Possible solutions
Keyboard/mouse is not functioning	<ol style="list-style-type: none"><li>1 Check if the batteries are inserted in the correct orientation. The batteries “+” and “-” ends should be placed as indicated on the battery compartment.</li><li>2 Check the battery level.<ul style="list-style-type: none"><li>• If the device uses the rechargeable batteries, ensure that the batteries are fully charged.</li><li>• If the batteries are exhausted, replace them with a new ones.</li></ul></li><li>3 Turn off the device, and then turn it on. Check if the battery-status light is flashing amber 10 times, indicating that the battery power is low. If the batteries are fully depleted, the battery-status light will not turn on.</li><li>4 Restart your computer.</li><li>5 Ensure that the USB dongle is directly connected to your computer.<ul style="list-style-type: none"><li>• Avoid using the port replicators, USB hubs, and so on.</li><li>• Change the USB port.</li></ul></li><li>6 Ensure that the distance between your computer and keyboard/mouse is within 0.5 meters.</li></ol>

Problems	Possible solutions
Unable to pair the keyboard/mouse with your computer	<ol style="list-style-type: none"> <li>1 Check the battery level. <ul style="list-style-type: none"> <li>• If the device uses the rechargeable batteries, ensure that the batteries are fully charged.</li> <li>• If the batteries are exhausted, replace them with a new ones.</li> </ul> </li> <li>2 Turn off the device, and then turn it on. Check if the battery-status light is flashing amber 10 times, indicating that the battery power is low. If the batteries are fully depleted, the battery-status light will not turn on.</li> <li>3 Restart your computer.</li> <li>4 Ensure that the USB dongle is directly connected to your computer. Avoid using the port replicators, USB hubs, and so on.</li> <li>5 Insert the USB dongle into another USB port on your computer.</li> <li>6 Ensure that the distance between your computer and keyboard/mouse is within 0.5 meters.</li> </ol>
Mouse pointer does not move	<ol style="list-style-type: none"> <li>1 Check the battery level. <ul style="list-style-type: none"> <li>• If the device uses the rechargeable batteries, ensure that the batteries are fully charged.</li> <li>• If the batteries are exhausted, replace them with a new ones.</li> </ul> </li> <li>2 Turn off the device, and then turn it on. Check if the battery-status light is flashing amber 10 times, indicating that the battery power is low. If the batteries are fully depleted, the battery-status light will not turn on.</li> <li>3 Restart your computer.</li> <li>4 Ensure that the distance between your computer and keyboard/mouse is within 0.5 meters.</li> </ol>
Mouse left/right button does not work	
Keyboard buttons do not work	
Wireless connection is lost	

Problems	Possible solutions
Solving a slow moving cursor	<ol style="list-style-type: none"> <li>1 Ensure that the sensor is not obstructed or dirty.</li> <li>2 Glass or very smooth glossy surfaces are not suitable for the mouse sensor to capture the mouse movement. Using a dark colored fabric mouse pad can improve the tracking.</li> <li>3 Change the mouse settings to adjust the pointer speed. Click on the tab that matches the Operating System (OS) installed on your laptop/desktop and perform the steps within that section to change the settings. <ol style="list-style-type: none"> <li>a. In the <b>Search</b> box, type <code>main.cpl</code>. The <b>Mouse Properties</b> dialog box appears.</li> <li>b. Click or tap <code>main.cpl</code> in the list of programs.</li> <li>c. Click the <b>Pointer Options</b> tab. In the <b>Motion</b> section, move the slider to adjust the pointer speed to the desired level.</li> <li>d. Click or tap <b>OK</b>.</li> </ol> </li> </ol>

# Statutory information

---

## Warranty

### Limited warranty and return policies

Dell-branded products carry a three-year limited hardware warranty. If purchased together with Dell system, it will follow the system warranty.

#### For U.S. customers:

This purchase and your use of this product are subject to Dell's end user agreement, which you can find at [Dell.com/terms](https://www.dell.com/terms). This document contains a binding arbitration clause.

#### For European, Middle Eastern and African customers:

Dell-branded products that are sold and used are subject to applicable national consumer legal rights, the terms of any retailer sale agreement that you have entered into (which will apply between you and the retailer) and Dell's end user contract terms.

Dell may also provide an additional hardware warranty – full details of the Dell end user contract and warranty terms can be found by going to [Dell.com/terms](https://www.dell.com/terms), selecting your country from the list at the bottom of the “home” page and then clicking the “terms and conditions” link for the end user terms or the “support” link for the warranty terms.

#### For non-U.S. customers:

Dell-branded products that are sold and used are subject to applicable national consumer legal rights, the terms of any retailer sale agreement that you have entered into (which will apply between you and the retailer) and Dell's warranty terms. Dell may also provide an additional hardware warranty – full details of Dell's warranty terms can be found by going to [Dell.com](https://www.dell.com), selecting your country from the list at the bottom of the “home” page and then clicking the “terms and conditions” link or the “support” link for the warranty terms.