

Cod Navision	OFV2023/005268
Offer #	v.iborra_230915155827
Date	15/09/2023
Ref	500m3h@89m
Item	1 of 1
Contact	Vincent

Company	Agrodor	Customer code	
Attention	Ina	Phone	+37323792068
Email	agrodor.succes@gmail.com		

Service data required

Flow (booster set) 500 m³/h
Head 89 m

Operating conditions

Pumped liquid Water
Density 998 (kg/m³)
Kinematic viscosity 1 (mm²/s)
PH 7-8
Maximun liquid temp. 30 °C
Maximun room temperature 40 °C
Max. elevation above sea level 1000 m

Selected pump data

Flow 500 m³/h
Head 89 m
Hydraulic efficiency 79,6%
Absorbed power (duty point). 207,0 / 152,2 (HP/kW)
Absorbed power (end of curve). 242,6 / 178,4 (HP/kW)
N.P.S.H.r 3,52 m
Speed / Hz 1450 R.P.M. / 50 Hz

Pump type
Model
Suction flange
Discharge flange
Rotation
Number of stages
Lubrication

Split case
CPH 150-605
DN200 PN25 DIN 2503
DN150 PN25 DIN2503
clockwise
N/A
Grease

Materials of construction

Materials code A

Pump casing	Cast iron	DIN: GG25 0.6025 / ISO-EN: GJL 250 / ASTM-AISI: A48 4B
Impeller	Cast iron	DIN: GG25 0.6025 / ISO-EN: GJL 250 / ASTM-AISI: A48 4B
Wear ring	Cast iron	DIN: GG25 0.6025 / ISO-EN: GJL 250 / ASTM-AISI: A48 4B
Shaft sleeve	Stainless steel AISI 304 (Casted)	AISI 304 (Casted) / ASTM A351 CF8 / 1.4308
Shaft	Stainless steel AISI 420	AISI 420 / ASTM A276 Gr.S42000 / 1.4021
Sealing	Gland packing	N/A
Packing box DE/NDE	Cast iron	DIN: GG25 0.6025 / ISO-EN: GJL 250 / ASTM-AISI: A48 4B
Bearing housing DE/NDE	Cast iron	DIN: GG25 0.6025 / ISO-EN: GJL 250 / ASTM-AISI: A48 4B
Nuts & bolts	Cadmium plated steel	N/A
Bearing housing cover DE/NDE	Cast iron	DIN: GG25 0.6025 / ISO-EN: GJL 250 / ASTM-AISI: A48 4B

Execution

Pump type	Split case	Motor	Standard IEC
Model	CPH 150-605	Rated power	270 / 200 HP/kW
Execution	Pump with baseplate and electric motor	Poles / Execution	4-p / B3
Coupling	Semi elastic	Frequency	50 Hz
Spacer	No	Voltage	3Ph 400/690V
Paint	Standard	Protection / Insulated class	IP-55 / Isolation F
		Motor frame	315L
		Efficiency level	IE4

Notes



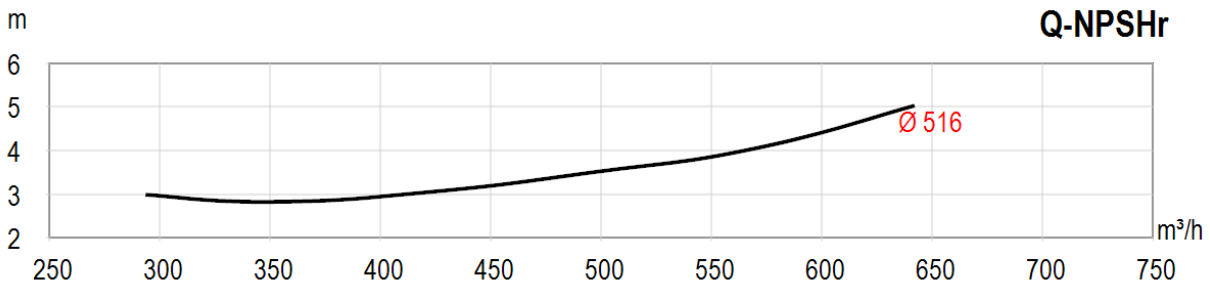
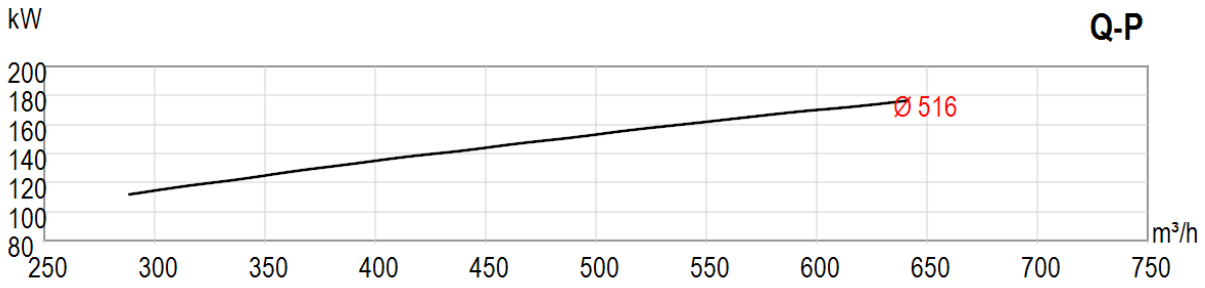
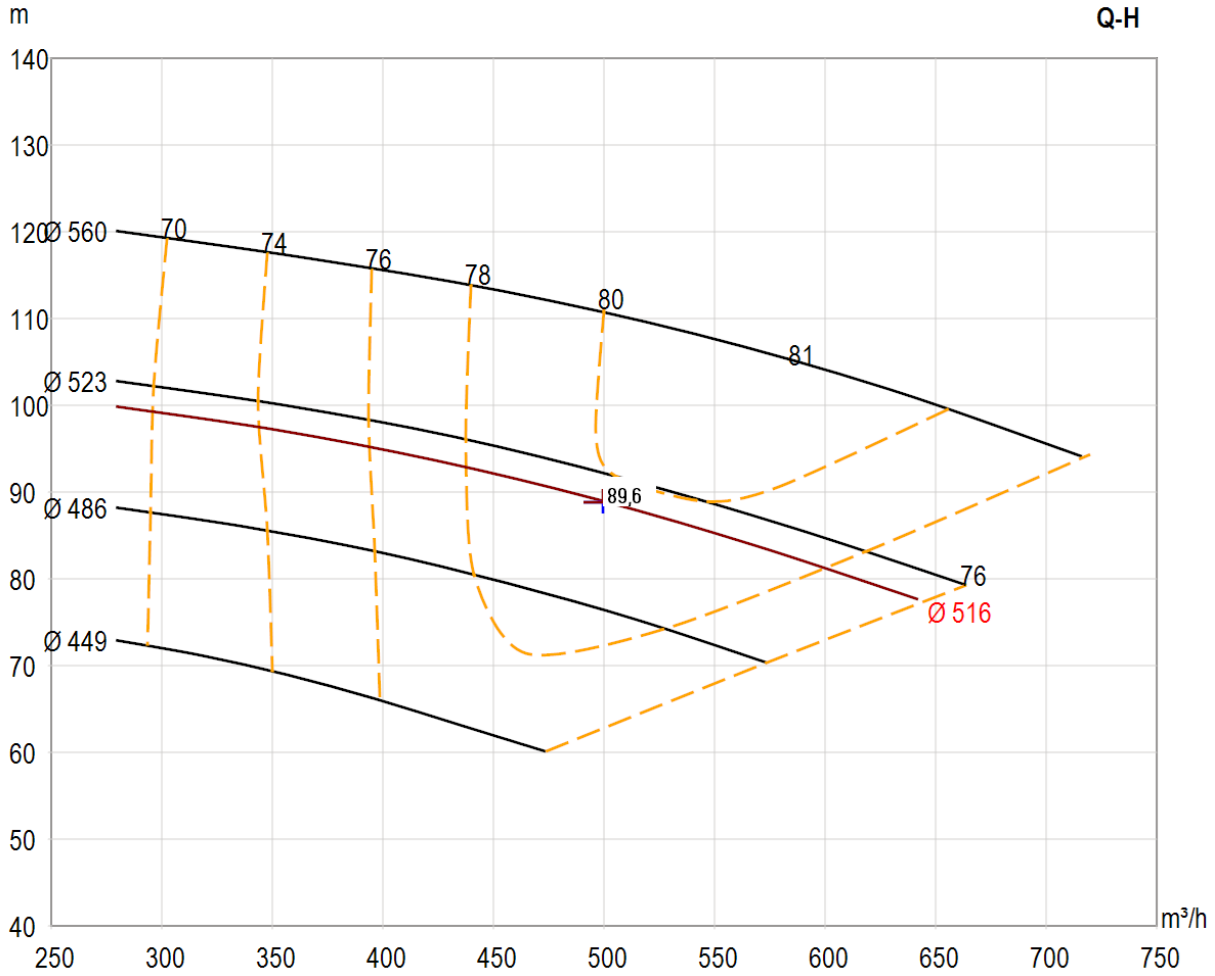

Acceptance tolerances according to ISO 9906 -B gr2 . Powers equal or less than 10 kW, section 4.4.2 applies.

Q 500,00 m³/h
H 89,00 m
 μ 79,63%
N 206,96HP
NPSHr 3,52 m

Fluid Water
998 Kg/m³
Kinematic viscosity 1 (mm²/s)
Maximun liquid temp.30°C

CPH 150-605

1450 R.P.M.

Offer #
v.iberora_23091515582
7
Date:15/09/2023
Item 1 of 1

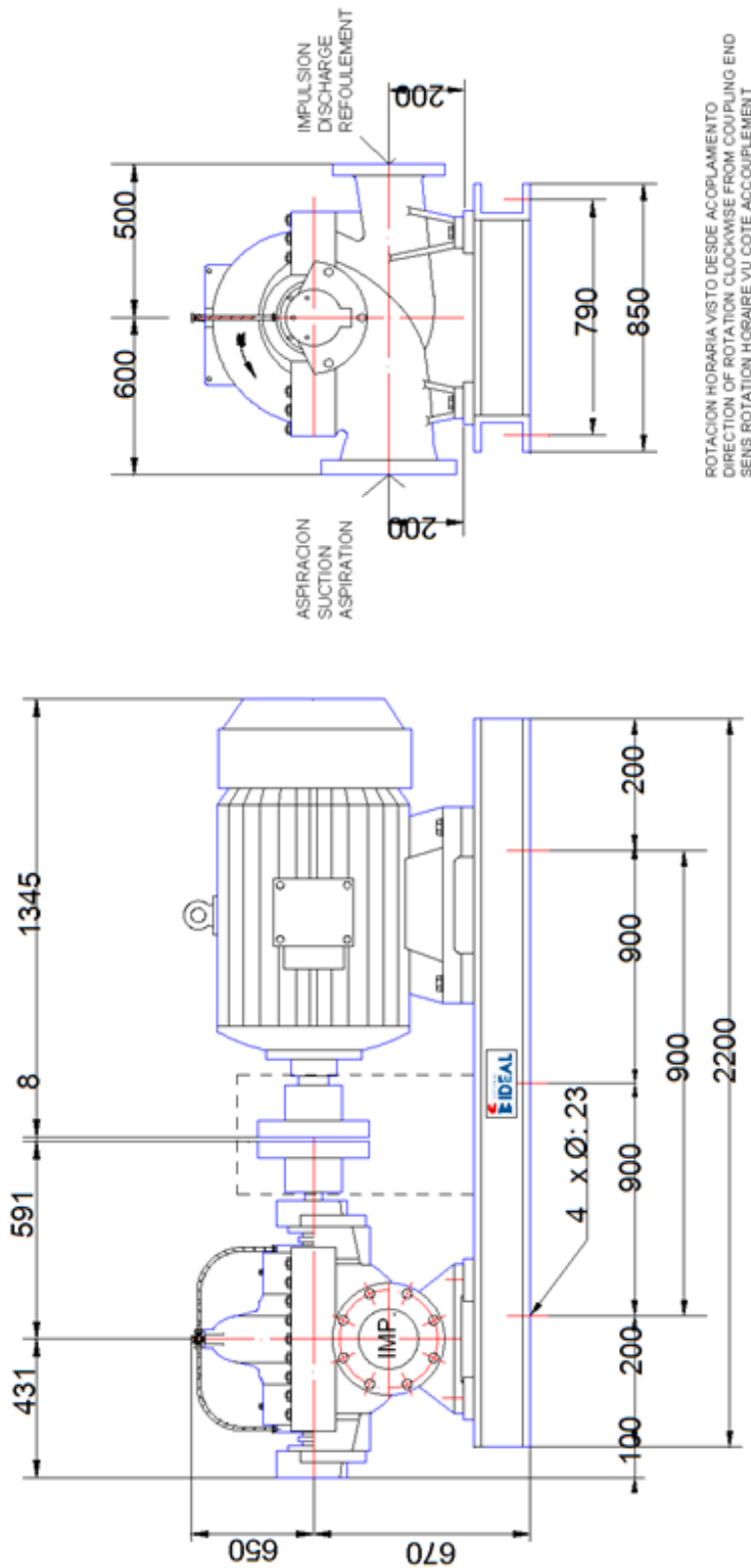

Construction Set net weight 2186 Kg

Pump: IDEAL
Model: CPH 150-605
Suction flange: DN200 PN25 DIN 2503
Discharge flange: DN150 PN25 DIN2503

Power: 270 HP/ 200 kW
Poles/Execution: 4-p / B3
Construction: IP 55/Isolation F

All dimensions in mm. Approximate dimensions. Only valid for quotation purpose.

Total or partial reproduction of this document without permission es prohibited.

RESILIENT SEAT GATE VALVE DUCTILE IRON BODY

TECHNICAL PASSPORT

VOC 4241C-00

RESILIENT SEAT GATE VALVE WITH HANDWHEEL - DUCTILE IRON BODY FLANGE CONNECTION PN10/16

APPLICATION

The TECOFI resilient seat gate valve is intended for use in application such as: water supply and treatment, irrigation and sanitation.



Fluids : water, waste water, sewage water, non-aggressive neutral liquids, etc.

GENERAL CHARACTERISTICS

Range : from DN40 to DN400.

- Resilient seat gate valve for ON/OFF with non-rising stem.
 - PN10 and PN16 flange mounting (drilling of suitable flanges from DN200).
 - Body and bonnet assembled by screws protected by a molded sealing gasket.
 - Wedge in ductile iron covered with a thick layer of elastomer.
 - Ribs (slider from DN350 to DN400) on the wedge outer face to facilitate its guiding in the body.
 - Ipstream-downstream tightness made reliable thanks to the enormous qualities of elasticity and rigidity of the wedge.
 - At the end of closing the latter is pressed onto the flat bottom of the valve and takes perfectly its shape. This results in the absorption of impurities contained in the fluid, such as sand, gravel, etc. From the first moment of opening, impurities or waste are returned to the fluid which evacuates them.
 - Tightness of the upper part guarantees thanks to a system of O-rings placed next to each other and separated by small metal segments.
 - Very economical use without the need for maintenance. Low pressure drop.
 - Full bore at the end of opening. No retention zone.
 - Good corrosion resistance (epoxy coating inside and outside the body)
- fasteners protected from external aggressions by wax coat.

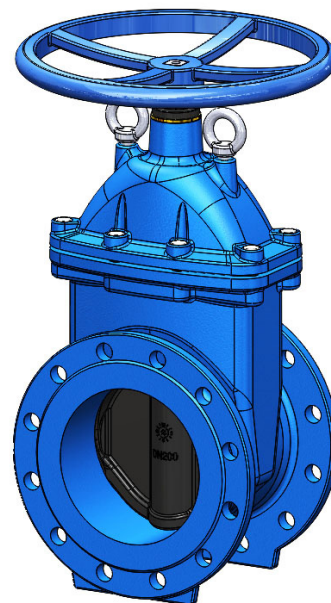

STANDARDS

Design	Manufacture according to standard en 1171.
Face to face	Face to face dimension according to EN 558 serie 14 and DIN 3202 / F4 short pattern
Connection	Mounting flange in accordance with EN1092-2 : ISO PN10 and ISO PN16
Tests	Pressure test according to standards EN12266-1
Certificats	Health compliance certificate (ACS) n° 21 ACC LY 015. / Certification WRAS n° 1606373

PRODUCTS APPROVALS



ISO 9001
ISO 14001
BUREAU VERITAS
Certification



Tecofi France

83 rue Marcel Mérieux - 69960 Corbas
Tél. +33 (0)4 72 79 05 79 - Fax. +33 (0)4 78 90 19 19
E-mail : sales@tecofi.fr - www.tecofi.fr

RESILIENT SEAT GATE VALVE DUCTILE IRON BODY

TECHNICAL PASSPORT

VOC 4241C-00

CONSTRUCTION

The valves are coated with epoxy paint on the outside and inside of the body and the bonnet to protect against corrosion.

Component	Coating
Body (1)	Epoxy powder RAL 5015 250 microns
Bonnet	Epoxy liquid RAL 5015 250 microns
Handwheel (16)	Epoxy liquid RAL 5015 70 microns

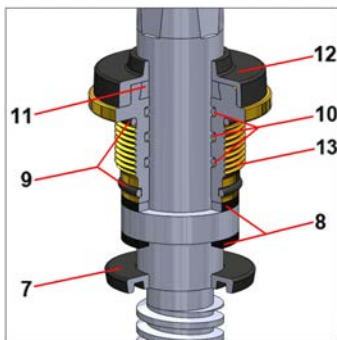

View A

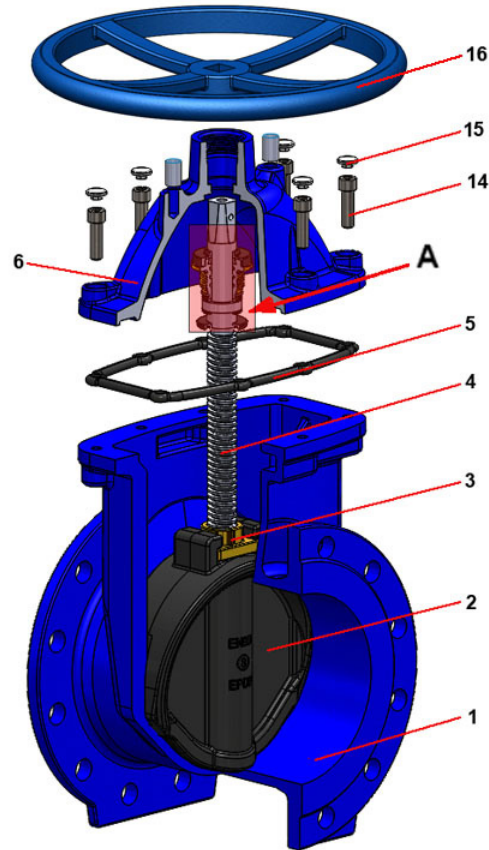

Pos.	Quantity	Description	Material	Equivalences		
				DIN	ASTM	BS
1	1	Body	Ductile iron EN-GJS-500-7	GGG50	A536 65-45-12	1563 EN-JS1050
2	1	Wedge	EPDM coated ductile iron	GGG50	A536 65-45-12	1563 EN-JS1050
3	1	Stem nut	Brass			
4	1	Stem	Stainless steel 420	1.4021	AISI 420	420 S 37
5	1	Joint	EPDM			
6	1	Bonnet	Ductile iron EN-GJS-500-7	GGG50	A536 65-45-12	1563 EN-JS1050
7	1	Joint	EPDM			
8	2	Bearing	PTFE			
9	2	O ring	EPDM			
10	3	O ring	EPDM			
11	1	Stem gasket	EPDM			
12	1	Dust protection	NBR			
13	1	Nut	Brass			
14	n	Screw	Stainless steel 304			
15	n	Wax plug				
16	1	Handwheel	Ductile iron EN-GJS-500-7	GGG50	A536 65-45-12	1563 EN-JS1050

n = 4 (DN40-DN65); 6 (DN100); 8 (DN150-DN300) ; 12 (DN350-DN400)

Tecofi France

83 rue Marcel Mérieux - 69960 Corbas
Tél. +33 (0)4 72 79 05 79 - Fax. +33 (0)4 78 90 19 19
E-mail : sales@tecofi.fr - www.tecofi.fr



RESILIENT SEAT GATE VALVE DUCTILE IRON BODY

TECHNICAL PASSPORT

VOC 4241C-00

DIMENSIONS

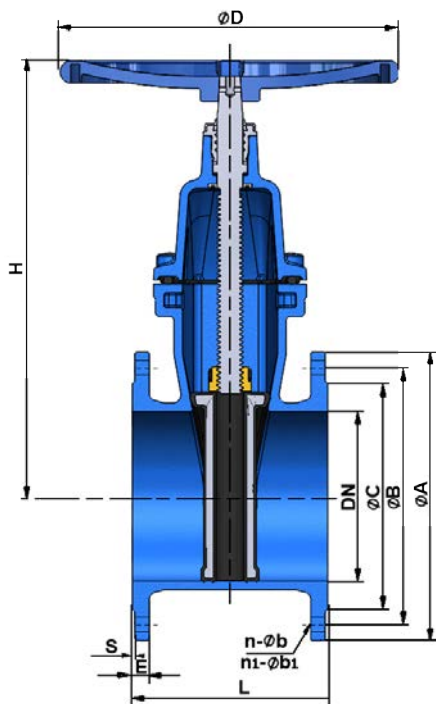

Maneuvering square

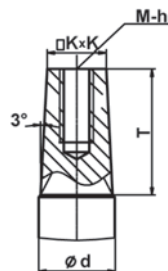

DN		Ød	K	M	h	T
mm	inch					
40	2" 1/2	20	14.3	8	20	29
50	2"	20	14.3	8	20	29
60/65	2" 1/4 / 2" 1/2	24	17.3	10	20	33
80	3"	24	17.3	10	20	33
100	4"	28	19.3	10	20	38
125	5"	28	19.3	10	20	38
150	6"	28	19.3	10	20	38
200	8"	30	24.3	10	20	42
250	10"	36	27.3	12	25	47
300	12"	36	27.3	12	25	47
350	14"	38	27.3	12	25	47
400	16"	38	27.3	12	25	47

DN		L	H	ØD	ØA		ØB		ØC	E	S	n - Øb	n1-Øb1	Weight (kg)
mm	inch				PN10	PN16	ØB1 (PN10)	ØB2 (PN16)				PN10	PN16	
40	2" 1/2	140	220	180	150	110	84	16	3	4 x Ø19	10			
50	2"	150	230	180	165	125	99	16	3	4 x Ø19	10.6			
60/65	2" 1/4 / 2" 1/2	170	265	200	185	135/145	118	16	3	4 x Ø19	12.5			
80	3"	180	290	200	200	160	132	16	3	8 x Ø19	13.8			
100	4"	190	335	250	220	180	156	16	3	8 x Ø19	18			
125	5"	200	380	250	250	210	184	16	3	8 x Ø19	26.5			
150	6"	210	415	300	285	240	211	16	3	8 x Ø23	31.9			
200	8"	230	510	300	340	295	266	17	3	8 x Ø23	54.5			
250	10"	250	600	500	400	355	319	19	3	12 x Ø23	75.5			
300	12"	270	690	500	455	410	370	20.5	4	12 x Ø23	110			
350	14"	290	790	600	520	470	429	22.5	4	16 x Ø23	174.2			
400	16"	310	855	600	580	515	480	24	4	16 x Ø28	226.5			

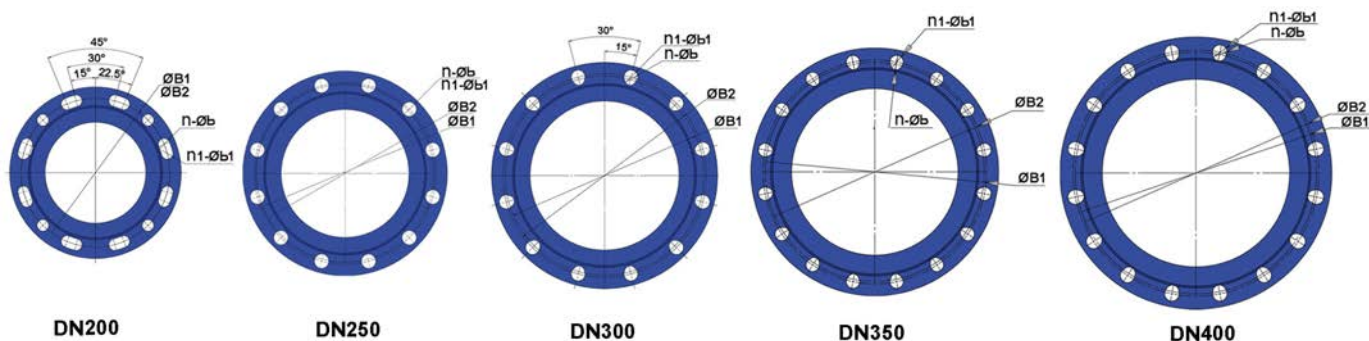

DN200

DN250

DN300

DN350

DN400

Tecofi France

83 rue Marcel Mérioux - 69960 Corbas

Tél. +33 (0)4 72 79 05 79 - Fax. +33 (0)4 78 90 19 19

E-mail : sales@tecofi.fr - www.tecofi.fr



RESILIENT SEAT GATE VALVE DUCTILE IRON BODY

TECHNICAL PASSPORT

VOC 4241C-00

WORKING CONDITIONS

Maximum working pressure : 16 bar

Maximum working temperature : +110°C

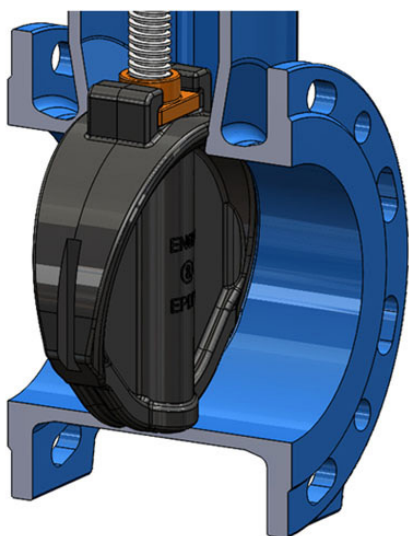

Upstream/downstream tightness

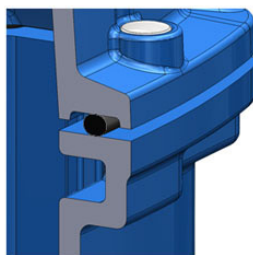

Body/bonnet tightness

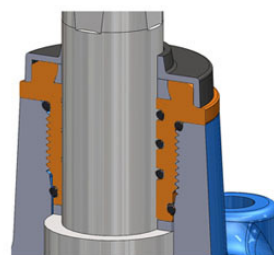

Valve top tightness

TYPES OF CONSTRUCTION

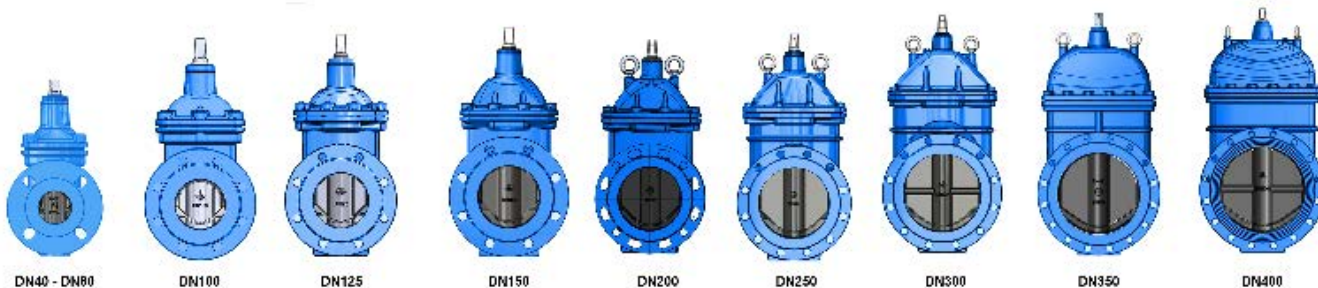

DN40 - DN60

DN100

DN125

DN150

DN200

DN250

DN300

DN350

DN400

Tecofi France

83 rue Marcel Mérieux - 69960 Corbas
 Tél. +33 (0)4 72 79 05 79 - Fax. +33 (0)4 78 90 19 19
 E-mail : sales@tecofi.fr - www.tecofi.fr



Ref. : VOC4241CM-U04.pas

Rev. : Initial

Date : 19/04/2018

Page : 1/1

RESILIENT SEAT GATE VALVE WITH ELECTRIC ACTUATOR AUMA

VOC 4241CM-U04



Tecofi
VALVE DESIGNER - FRANCE



APPLICATION

General use : Water supply, fire protection, irrigation, water treatment.

GENERAL CHARACTERISTICS

Range : from DN40 to DN400.
Non rising stem.
Clockwise to close.
No zone of retention.
Low head losses.
With electric actuator AUMA.

CONSTRUCTION

12	1	Electric actuator		
11	1	Screw	Stainless steel AISI 304	
10		Seal	Brass	
9	1	O ring	EPDM	
8		Wear resistant gasket	EPDM	
7		Bonnet	Ductile iron	DIN: GGG 50 ASTM: A536 65-45-12 BS: 1563 EN-JS1050
6		Bolt	Stainless steel	AISI 304
5	1	Sealing gasket	EPDM	
4	1	Stem	Stainless steel	2Cr13 (AISI420)
3	1	Stem nut	Brass	
2	1	Wedge	EPDM coated ductile iron	DIN: GGG 50 ASTM: A536 65-45-12 BS: 1563 EN-JS1050
1	1	Body	Ductile iron	DIN: GGG 50 ASTM: A536 65-45-12 BS: 1563 EN-JS1050
Pos.	Q-ty	Description	Material	

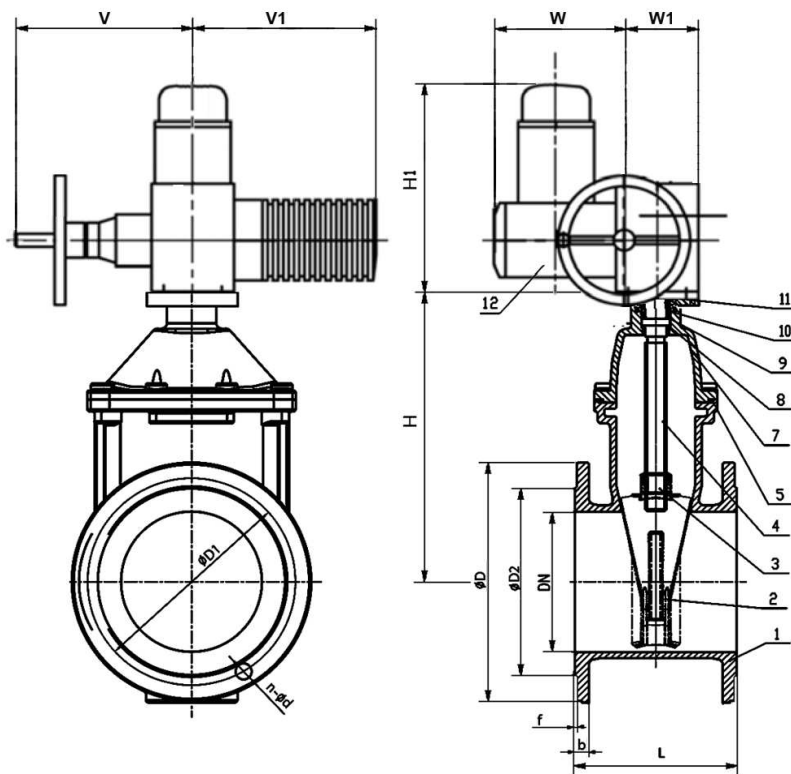

DIMENSIONS

DN		L	H	ØD	ØD1		ØD2	f	b	n-Ød		AUMA actuator					Weight (kg)	
mm	inch				PN10	PN16				PN10	PN16	Actuator reference	V	V1	W	W1		H1
40	1"1/2	140	220	150	110	110	84	3	19	4 x Ø19	4 x Ø19	SA07.6	186	265	238	62	315	31
50	2"	150	230	165	125	125	99	3	19	4 x Ø19	4 x Ø19	SA07.6	186	265	238	62	315	33
65	2"1/2	170	265	185	145	145	118	3	19	4 x Ø19	4 x Ø19	SA07.6	186	265	238	62	315	35
80	3"	180	290	200	160	160	132	3	19	8 x Ø19	8 x Ø19	SA10.2	191	283	248	65	317	39
100	4"	190	335	220	180	180	156	3	19	8 x Ø19	8 x Ø19	SA10.2	191	283	248	65	317	44
125	5"	200	380	250	210	210	184	3	19	8 x Ø19	8 x Ø19	SA10.2	191	283	248	65	317	52
150	6"	210	415	285	240	240	211	3	19	8 x Ø23	8 x Ø23	SA10.2	191	283	248	65	317	60
200	8"	230	510	340	295	295	266	3	20	8 x Ø23	12 x Ø23	SA14.2	242	389	286	91	343	108
250	10"	250	600	400	350	355	319	3	22	12 x Ø23	12 x Ø28	SA14.2	242	389	286	91	343	131
300	12"	270	690	455	400	410	370	4	24,5	12 x Ø23	12 x Ø28	SA14.6	242	389	286	91	343	164
350	14"	290	790	520	460	470	429	4	26,5	16 x Ø23	16 x Ø28	SA14.6	242	389	286	91	343	231
400	16"	310	855	580	515	525	480	4	28	16 x Ø28	16 x Ø31	SA14.6	242	389	286	91	343	274



WORKING CONDITIONS

Maximum working pressure : 16 bar.

Maximum working temperature: +80°C

STANDARDS

Face to face according to DIN 3352 / F4.
Tests according to standard EN1074-2.
Flange connection following EN 1092-2 ISO PN10/16.
Certificat of health conformity n° 16 ACC LY 039.
WRAS certificate n° 1606373

FLANGED TILTING CHECK VALVE

TECHNICAL PASSPORT

TILTING CHECK VALVE - DUCTILE IRON BODY WITH COUNTERWEIGHT PN10/16

CP 4243

APPLICATION

The TECOFI tilting check valve is suitable for fluid transfer applications in pipe systems requiring protection against reverse flow.

Area of use: pumping stations, water distribution, irrigation, fire protection systems, industry.



Fluids: water, waste water, etc.

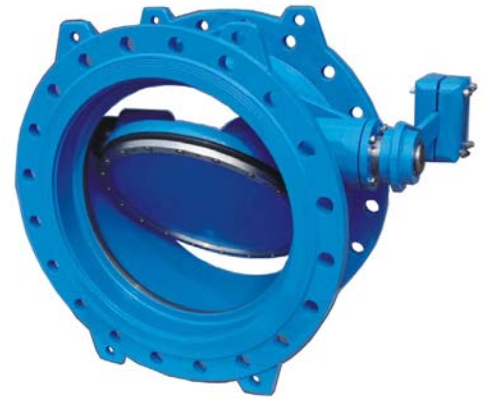

GENERAL CHARACTERISTICS

- Model with long pattern.
- Designed in accordance with BS 5153.
- Range : from DN200 to DN1200.
- Sealing provided by seal on butterfly retained by a stainless steel ring.
- Non pinned stem/disc connection.
- Double eccentric check valve, prevents wear due to the stainless steel seat attached to the body.
- Optimized maneuvering torque.
- Low pressure drop.
- Easy maintenance.
- Mounting on horizontal or vertical ascending piping subject to modification of the orientation of the counterweight.

STANDARDS

Design	According to standard BS 5153
Face to face	face to face dimensions according to ISO 5752 series 14
Connection	Flanged connection in accordance with EN 1092-2 PN10/16, BS4504 - PN10/PN16
Tests	Hydraulic tests according to EN12266-1, DIN 3230, BS 5154 and ISO 5208: <ul style="list-style-type: none">- Body : 24 bar- Seat : 17.5 bar

PRODUCT APPROVALS



Tecofi France

83 rue Marcel Mérieux - 69960 Corbas
Tél. +33 (0)4 72 79 05 79 - Fax. +33 (0)4 78 90 19 19
E-mail : sales@tecofi.fr - www.tecofi.fr



FLANGED TILTING CHECK VALVE

CONSTRUCTION

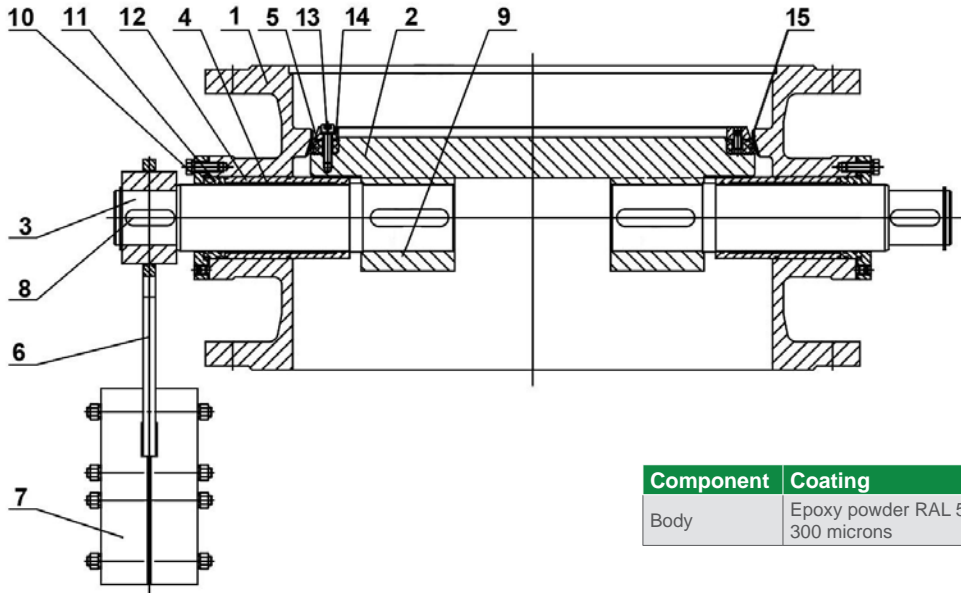

Component	Coating
Body	Epoxy powder RAL 5015 300 microns

Pos.	Q-ty	Description	Material	Equivalences		
				DIN	ASTM	BS
1	1	Body	Ductile iron EN-GJS-500-7	GGG 50	A536 70-50-05	EN-JS1050
2	1	Disc	Ductile iron EN-GJS-500-7	GGG 50	A536 70-50-05	EN-JS1050
3	2	Shaft	Stainless steel 420	X30Cr13		
4	2	Self-lubricating bearing	Stainless steel X5CrNi 18-10	X5CrNi 18 10	A 182 AISI 304	1449-2 304 S15
5	1	Disc seal ring	EPDM			
6	1	Lever	Welded steel			
7	1	Counterweight	Cast iron GG25			
8	4	Key	Stainless steel 420	X30Cr13		
9	2	Disc stub shafts	Stainless steel 420	X30Cr13		
10	2	Cover	Epoxy coated steel			
11	2	Seal bush	Stainless steel X5CrNi 18-10	X5CrNi 18 10	A 182 AISI 304	1449-2 304 S15
12	2	Bush	Stainless steel X5CrNi 18-10	X5CrNi 18 10	A 182 AISI 304	1449-2 304 S15
13	*	Screw mechanically lock	A2-70			
14	1	Retaining ring	Stainless steel X5CrNi 18-10	X5CrNi 18 10	A 182 AISI 304	1449-2 304 S15
15	1	Body seal ring	Stainless steel X5CrNi 18-10	X5CrNi 18 10	A 182 AISI 304	1449-2 304 S15

Clamping ring secured with stainless steel grade 316L
 HYDRAULIC DAMPNER TO BE PROVIDED
 Check valve with protection guard on lever + counterweight in option

Tecofi France

83 rue Marcel Mérieux - 69960 Corbas
 Tél. +33 (0)4 72 79 05 79 - Fax. +33 (0)4 78 90 19 19
 E-mail : sales@tecofi.fr - www.tecofi.fr



FLANGED TILTING CHECK VALVE

DIMENSIONS

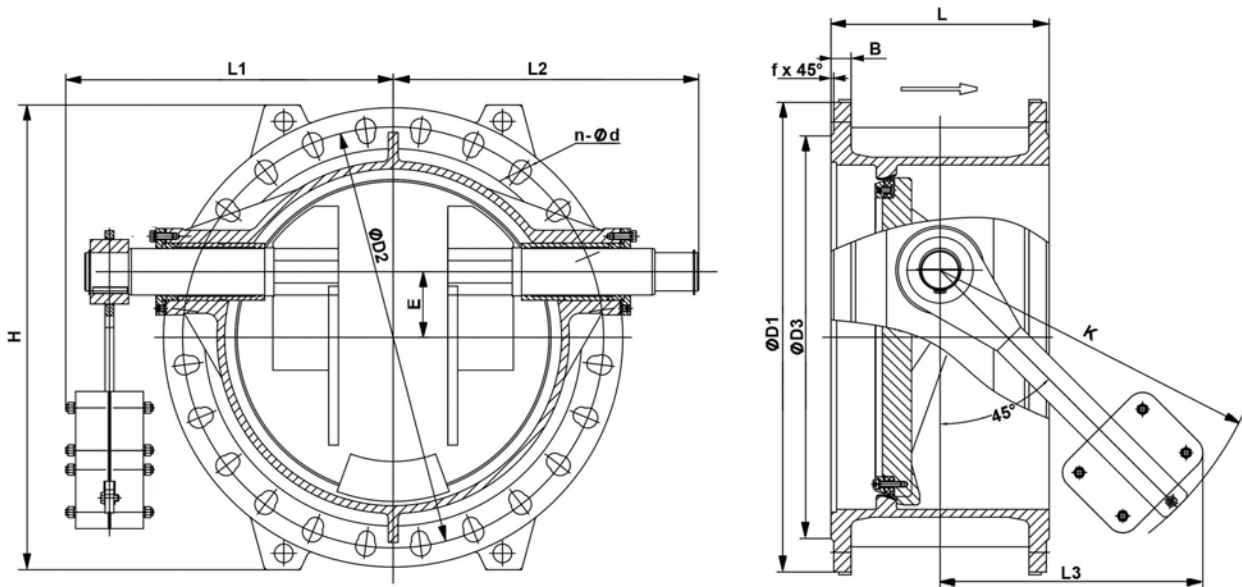

DN	Ø D1		Ø D2		Ø D3		n x Ø d		B	L	f	H	K	L1	L2	L3	E	Weight (kg)
	mm	inch	PN10	PN16	PN10	PN16	PN10	PN16										
200	8"	340	295	295	266	266	8 x Ø23	12 x Ø23	20	230	3x45°	350	200	280	260	180	50	45
250	10"	405	350	355	319	319	12 x Ø23	12 x Ø28	22	250	3x45°	420	300	314	305	247	62.5	76
300	12"	460	400	410	370	370	12 x Ø23	12 x Ø28	26.5	270	4x45°	530	350	351	344	300	70	102
350	14"	520	460	470	429	429	16 x Ø23	16 x Ø28	26.5	290	4x45°	530	350	423	400	300	70	140
400	16"	580	515	525	480	480	16 x Ø28	16 x Ø31	28	310	4x45°	590	400	454	429	340	80	176
450	18"	640	565	585	548	548	20 x Ø28	20 x Ø31	30	330	4x45°	650	450	489	464	356	90	245
500	20"	715	620	650	609	609	20 x Ø28	20 x Ø34	31.5	350	4x45°	725	500	551	517	395	100	300
600	24"	840	725	770	720	720	20 x Ø31	20 x Ø37	36	390	4x45°	850	600	632	552	471	120	432
700	28"	910	840	840	794	794	24 x Ø31	24 x Ø37	39.5	430	4x45°	920	700	675	635	546	140	565
800	32"	1025	950	950	901	901	24 x Ø34	24 x Ø41	43	470	4x45°	1035	800	741	710	610	160	833
900	36"	1125	1050	1050	1001	1001	28 x Ø34	28 x Ø41	46.5	510	4x45°	1135	880	1043	978	657	150	1081
1000	40"	1255	1160	1170	1112	1112	28 x Ø37	28 x Ø44	50	550	4x45°	1265	1000	1015	960	752	200	1268
1200	48"	1485	1380	1390	1328	1328	32 x Ø41	32 x Ø50	57	630	4x45°	1495	1230	1097	1048	971	240	2127

The photographs and technical art works are not contractual. The specifications of the presented products are open to modifications without previous advice

Tecofi France

83 rue Marcel Mérieux - 69960 Corbas
Tél. +33 (0)4 72 79 05 79 - Fax. +33 (0)4 78 90 19 19
E-mail : sales@tecofi.fr - www.tecofi.fr



FLANGED TILTING CHECK VALVE

WORKING CONDITIONS

Maximum working pressure : 16 bar
Maximum working temperature : -10°C / +80°C

Flow characteristics

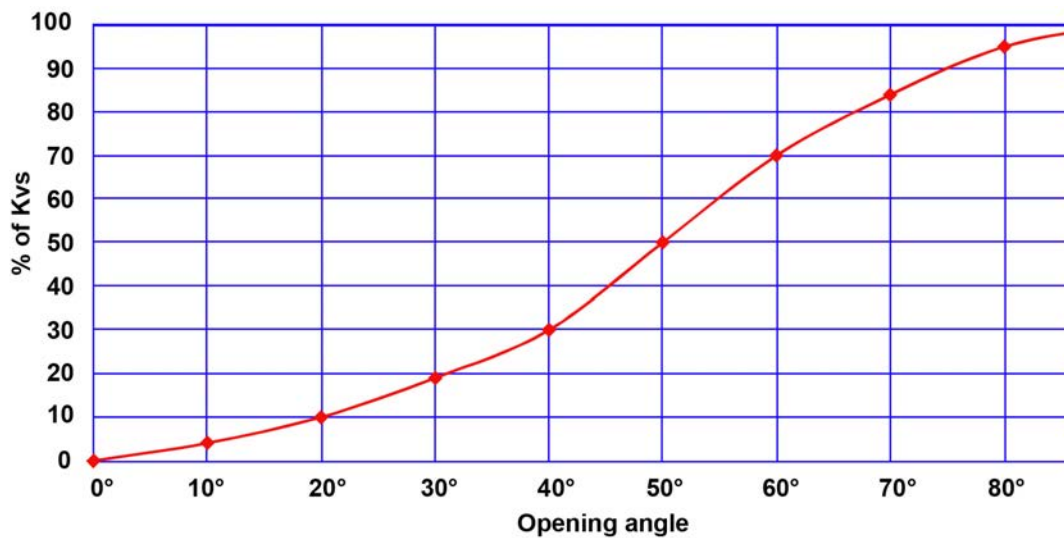

DN	mm	200	250	300	350	400	450	500	600	700	800	900	1000	1200
	inch	8"	10"	12"	14"	16"	18"	20"	24"	28"	32"	36"	40"	48"
Kvs		1880	3800	4950	8000	10900	14200	18250	28000	40500	55100	74000	93338	142516

Tecofi France

83 rue Marcel Mérieux - 69960 Corbas
Tél. +33 (0)4 72 79 05 79 - Fax. +33 (0)4 78 90 19 19
E-mail : sales@tecofi.fr - www.tecofi.fr



DISMANTLING JOINT

TECHNICAL PASSPORT

PN16 DISMANTLING JOINT

JT4243

APPLICATION

Dismantling joints mounted with flanged shut-off valves facilitate their assembly and disassembly by compensating for the axial movement of the piping.



Fluids : water, waste water, drinking water, compatible fluids, etc

GENERAL CHARACTERISTICS

Range : from DN50 to DN2000.
Connection : PN10/16 (DN50-DN150) and PN16 beyond
GEOMET 500® steel tie rods and nuts.
Epoxy coating.
Adjustment of +/-25 mm.



Epoxy coated body according to EN 14901 RAL 5015, 250 µm thickness (WRAS QUALITY)

CONSTRUCTION

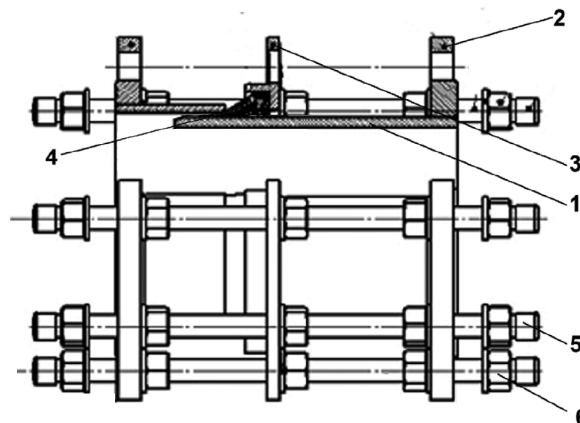

Pos.	Description	Material	Equivalence		
			DIN	ASTM	BS
1	Flanged pipe-long	Ductile iron EN-GJS-500-7	GGG50	A536 70-50-05	BS 500/7
2	Flanged pipe-short	Ductile iron EN-GJS-500-7	GGG50	A536 70-50-05	BS 500/7
3	Retaining flange	Ductile iron EN-GJS-500-7	GGG50	A536 70-50-05	BS 500/7
4	Sealing ring	EPDM (WRAS QUALITY)			
5	Stud bolt	Steel 4.8	GEOMET 500®		
6	Nut & tie rods	Steel	GEOMET 500®		

PRODUCT APPROVALS



Tecofi France

83 rue Marcel Mérieux - 69960 Corbas
Tél. +33 (0)4 72 79 05 79 - Fax. +33 (0)4 78 90 19 19
E-mail : sales@tecofi.fr - www.tecofi.fr



The photographs and technical art works are not contractual. The specifications of the presented products are open to modifications without previous advice.

DISMANTLING JOINT

TECHNICAL PASSPORT

JT4243

DIMENSIONS

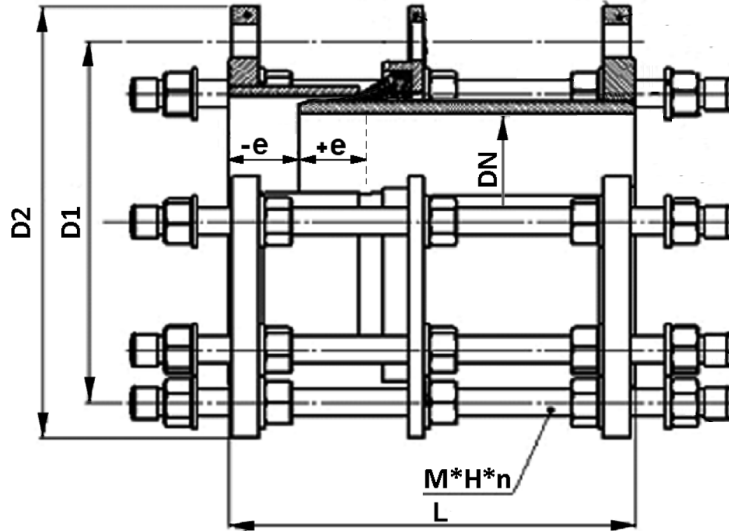

DN		e	L	øD1	øD2	M*H*n	FLANGE THICKNESS	Weight (kg)
mm	inch							
50	2"	25	190	125	165	M16*330*4	16+3	9.9
65	2 1/2"	25	190	145	185	M16*330*4	16+3	11.4
80	3"	25	200	160	200	M16*340*8	16+3	15.7
100	4"	25	200	180	220	M16*340*8	16+3	18.6
125	5"	25	200	210	250	M16*340*8	16+3	27.5
150	6"	25	200	240	285	M20*350*8	16+3	29
200	8"	25	210	295	340	M20*350*12	16+3	39.4
250	10"	25	225	355	400	M24*380*12	19+3	55
300	12"	25	240	410	455	M24*400*12	20.5+3	69.4
350	14"	25	240	470	520	M24*410*16	22.5+3	89
400	16"	25	250	525	580	M27*430*16	24+3	115
450	18"	25	270	585	640	M27*450*20	26+3	158.2
500	20"	25	270	650	715	M30*460*20	27.5+3	198
600	24"	25	290	770	840	M33*500*20	31+3	270
700	28"	25	300	840	910	M33*500*24	34.5+3	296
800	32"	25	315	950	1025	M36*530*24	38+3	386
900	36"	25	325	1050	1125	M36*530*28	41.5+3	456
1000	40"	25	335	1170	1255	M39*570*28	45+3	582
1200	48"	25	345	1390	1485	M45*620*32	52+3	740
1400	56"	25	355	1590	1685	M45*630*36	55+3	1360
1500	60"	25	375	1710	1820	M52*665*36	57+3	1510
1600	64"	25	375	1820	1930	M52*700*40	60+3	1690
1800	72"	25	395	2020	2130	M52*730*44	65+3	2500
2000	80"	25	415	2230	2345	M56*730*48	69+3	2930

WORKING CONDITIONS

Maximum working pressure: 16 bar

Maximum working temperature: +4°C / +110°C

Tecofi France

83 rue Marcel Mérioux - 69960 Corbas

Tél. +33 (0)4 72 79 05 79 - Fax. +33 (0)4 78 90 19 19

E-mail : sales@tecofi.fr - www.tecofi.fr

