



PRODUCT  
CATALOG  
QUALITY  
BY PEOPLE  
FOR PEOPLE

**TRACOE®**



# REF Overview











| REF                    | Page | REF                   | Page | REF                   | Page | REF                  | Page |
|------------------------|------|-----------------------|------|-----------------------|------|----------------------|------|
| <b>TRACOE percutan</b> |      | 311                   | 34   | 158                   | 65   | 730-5                | 88   |
| 320                    | 19   | 311-P                 | 35   | 164                   | 65   | <b>TRACOE select</b> |      |
| 321                    | 19   | 312                   | 34   | 202                   | 55   | 820                  | 94   |
| 322                    | 19   | 312-P                 | 35   | 202-D                 | 55   | 850                  | 95   |
| 888-322                | 19   | 313                   | 34   | 203                   | 57   | <b>TRACOE care</b>   |      |
| 330                    | 19   | 314                   | 35   | 203-A                 | 57   | 677                  | 102  |
| 331                    | 19   | 316                   | 36   | 203-O                 | 57   | 902                  | 102  |
| 332                    | 19   | 316-P                 | 37   | 204                   | 59   | 903                  | 98   |
| 888-332                | 19   | 888-316               | 36   | 204-A                 | 61   | 905                  | 104  |
| 420                    | 18   | 888-316-P             | 37   | 204-A-O               | 61   | 907                  | 104  |
| 421                    | 18   | 501                   | 38   | 205                   | 63   | 908                  | 103  |
| 422                    | 18   | 503                   | 38   | 215                   | 63   | 909                  | 103  |
| 423                    | 18   | 506                   | 38   | <b>TRACOE larynx</b>  |      | 910                  | 104  |
| 424                    | 18   | 521                   | 39   | 580                   | 72   | 915                  | 103  |
| 425                    | 18   | 523                   | 39   | 581                   | 72   | 919                  | 107  |
| 517                    | 15   | <b>TRACOE kids</b>    |      | 582                   | 72   | 921                  | 107  |
| 518                    | 15   | 350                   | 49   | 583                   | 72   | 923                  | 107  |
| 520                    | 15   | 355                   | 49   | 601                   | 73   | 930                  | 100  |
| <b>TRACOE vario</b>    |      | 356                   | 49   | 602                   | 73   | 932                  | 100  |
| 450                    | 22   | 360                   | 47   | 603                   | 73   | 933                  | 101  |
| 450-P                  | 23   | 361                   | 47   | 607-45                | 74   | 934                  | 100  |
| 451                    | 24   | 362                   | 47   | 607-70                | 74   | 935                  | 100  |
| 451-P                  | 25   | 363                   | 47   | 612                   | 72   | 936                  | 101  |
| 455                    | 22   | 370                   | 48   | 613                   | 72   | 938                  | 102  |
| 460                    | 22   | 371                   | 48   | <b>TRACOE modular</b> |      | 940                  | 103  |
| 460-P                  | 23   | 372                   | 48   | 516                   | 82   | 957                  | 105  |
| 461                    | 24   | 373                   | 48   | 621                   | 83   | 958                  | 106  |
| 461-P                  | 25   | <b>TRACOE comfort</b> |      | 640-CT                | 84   | 959                  | 106  |
| 464                    | 23   | 101                   | 54   | 640-S                 | 85   | 960                  | 105  |
| 470                    | 22   | 102                   | 54   | 641                   | 84   | 961                  | 105  |
| 470-P                  | 23   | 102-D                 | 54   | 642                   | 84   | 969                  | 106  |
| 471                    | 24   | 103                   | 56   | 643                   | 84   | 970                  | 102  |
| 471-P                  | 25   | 103-A                 | 56   | 645                   | 82   |                      |      |
| <b>TRACOE twist</b>    |      | 103-A-O               | 58   | 650-S                 | 81   |                      |      |
| 301                    | 30   | 103-O                 | 56   | 650-SO                | 81   |                      |      |
| 301-P                  | 31   | 104                   | 58   | 650-T                 | 80   |                      |      |
| 302                    | 30   | 104-A                 | 60   | 650-TO                | 80   |                      |      |
| 302-P                  | 31   | 104-A-O               | 60   | 650-TO-C              | 80   |                      |      |
| 303                    | 30   | 105                   | 62   | 655-S                 | 83   |                      |      |
| 304                    | 31   | 105-D                 | 62   | 655-T                 | 82   |                      |      |
| 305                    | 32   | 107                   | 64   | <b>TRACOE technic</b> |      |                      |      |
| 306                    | 32   | 108                   | 64   | 702                   | 89   |                      |      |
| 306-P                  | 33   | 114                   | 64   | 720                   | 90   |                      |      |
| 888-306                | 32   | 115                   | 62   | 721                   | 90   |                      |      |
| 888-306-P              | 33   | 157                   | 65   | 725                   | 91   |                      |      |

# Color Coding & Legend to Symbols

## Color Coding

The color coding should help you see the properties of the tube at a glance. All outer packaging of the *twist*, *vario* and *kids* product lines is color-coded in this way.











- |  |   |
|--|---|
|  TRACOE tracheostomy tube without extras  |  TRACOE tracheostomy tube for neonates                                       |
|  TRACOE tracheostomy tube with low-pressure cuff  |  TRACOE tracheostomy tube for children                                       |
|  TRACOE fenestrated tracheostomy tube   |  TRACOE fenestrated tracheostomy tube with low-pressure cuff                 |
|  TRACOE tracheostomy tube with subglottic suction line and low-pressure cuff                      |  TRACOE tracheostomy tube for neonates, with TRACOE H <sub>2</sub> O cuff®   |
|  TRACOE tracheostomy tube with subglottic suction line, fenestrated, and with low-pressure cuff |  TRACOE tracheostomy tube for children, with TRACOE H <sub>2</sub> O cuff® |
|  TRACOE tracheostomy tube for laryngectomized patients  |   |

## Legend to Symbols

Like the color coding, the symbols should help you to identify the main specifications of the tube. These symbols also appear on the outer packaging.



- |  |  |
|--|--|
|  the black stripes indicate a spiral-reinforced tracheostomy tube |  the plus symbol indicates the plus product lines <i>comfort plus</i> and <i>twist plus</i> |
|  PL means a 'proximal longer' tracheostomy tube                   |  XL indicates an extra-long tracheostomy tube   |
|  TRACOE tracheostomy tube for neonates and infants                |  speaking valve or fenestrated tracheostomy tube with integrated speaking valve             |
|  TRACOE tracheostomy tube for children                            |  TRACOE fenestrated tracheostomy tube   |

# TRACOE Product Portfolio



## TRACOE *percutan* 12

TRACOE experc sets for percutaneous dilation tracheostomy (PDT)

## TRACOE *vario* 20

Tracheostomy tubes with variably adjustable neck flange

TRACOE *vario* Page 22

TRACOE *vario* XL Page 24

## TRACOE *twist* 28

Tracheostomy tubes with inner cannulas and adjustable neck flange

TRACOE *twist* Page 30

TRACOE *twist* plus Page 34

## TRACOE *kids* 44

Tracheostomy tubes designed to meet the special requirements of neonates and children

TRACOE *silcosoft* Page 46

TRACOE *mini* Page 49

## TRACOE *comfort* 52

Tracheostomy tubes with inner cannulas for long-term use

TRACOE *comfort* Page 54

TRACOE *comfort* XL Page 55

TRACOE *comfort* plus Page 65

## TRACOE *larynx* 70

stoma and grid buttons, silicone short tubes and button plus

## TRACOE *modular* 76

Speaking valves, heat/moisture exchanger

## TRACOE *technic* 86

Precision medical products for the cuff pressure management

## TRACOE *select* 92

Selected medical devices from external manufacturers

## TRACOE *care* 96

Accessories for product care, cleaning and maintenance

## Contact and Information 108

Contact and information about use and maintenance of tracheostomy tubes



## A Proven Technique

Percutaneous dilation tracheostomy (PTD) has become routine in intensive care. The Ciaglia technique is now the method most widely used. The TRACOE expirc system is based on this proven technique.

The products are tailored to the use of fenestrated and unfenestrated tracheostomy tubes, including tubes with subglottic suction lines, from the TRACOE *twist*, *twist plus*,

and TRACOE *vario* incl. *vario XL* product lines. They are supplied already mounted on their minimally traumatic insertion systems (P-tubes). Inserting the tube into the patient via an inserter is a particular challenge of the percutaneous dilation.



## Our Solution

Thanks to the patented minimally traumatic inserter and minimally traumatic insertion system, the TRACOE P-tubes offer the solution: The soft silicone sleeve at the tip of the instrument bridges the gap in diameter between the inserter and the tube.

## The Variable System

The TRACOE *twist*, including *twist plus*, and TRACOE *vario*, including *vario XL*, product lines include 14 different TRACOE tracheostomy tubes (DEHP-free) with a minimally traumatic insertion system. Six of these tubes have subglottic suction lines. Sets are available in sizes 07 – 09. The TRACOE *twist plus* also comes in size 10. The TRACOE *expirc* sets can therefore be used with the tracheostomy tube that is most appropriate for the patient.

# The Variable Packaging System



Outer packaging of the TRACOE experec dilation set without tube.



Outer packaging of the TRACOE experec Set *vario* and *vario XL* and the packaging of the corresponding P-tube.



Outer packaging of the TRACOE experec Set *twist* and the packaging of the corresponding P-tube.



Outer packaging of the TRACOE experec Set *twist plus* and the packaging of the corresponding P-tube.

The TRACOE *percutan* product line offers the possibility of ordering the dilation set alone or as a set including a P-tube from the *twist*, *twist plus*, *vario* and *vario XL* product lines.

The special feature of the pre-mounted P-tubes is their unique, minimally traumatic inserter. You will find details of the various inserters and how they function on the following pages.

## REF 520

**TRACOE experc Dilation Set**

for percutaneous tracheotomy

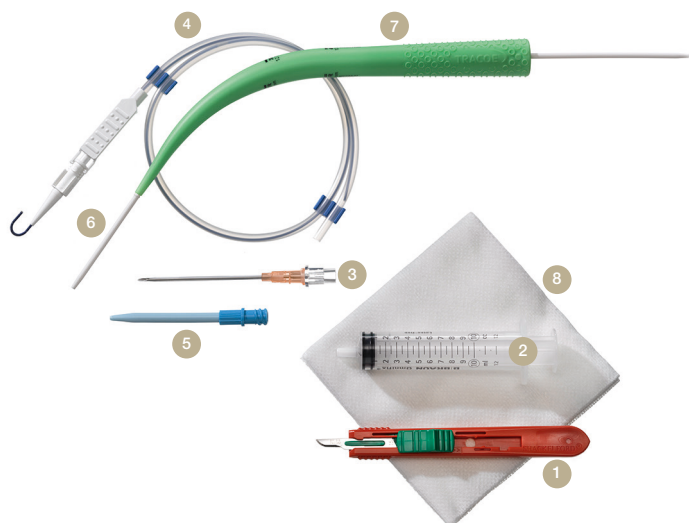

- 1 scalpel
- 2 syringe
- 3 puncture needle (14 G) with Teflon catheter
- 4 Seldinger guide wire made of kink-resistant nitinol with inserter
- 5 short dilator (14 Ch/Fr)
- 6 guiding catheter with safety stop
- 7 TRACOE experc dilator with hydrophilic coating (slides easily after moistening)
- 8 4 compresses

♦ in sterile package

The TRACOE experc dilation set (REF 520) can be used alone or together with the P-tube most appropriate for the patient. You will find an overview on pages 18/19.

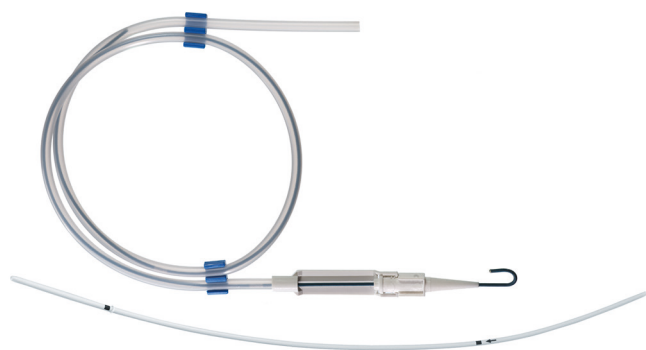

## REF 517

**TRACOE *percutan* Seldinger Guide Wire**

made of kink-resistant nitinol, with guiding catheter

♦ in sterile package

To be used with all TRACOE *twist* tubes with minimally traumatic inserter.

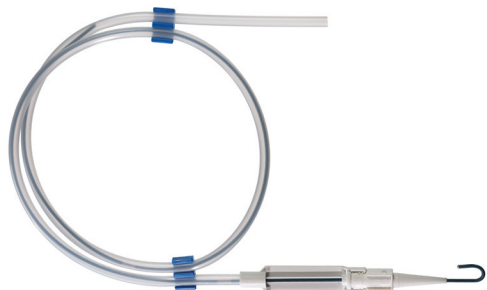

## REF 518

**TRACOE *percutan* Seldinger guide wire**

made of kink-resistant nitinol

Packaging unit: ♦ 5 units  
 ♦ sterile, individually packaged

# The Minimally Traumatic Inserters

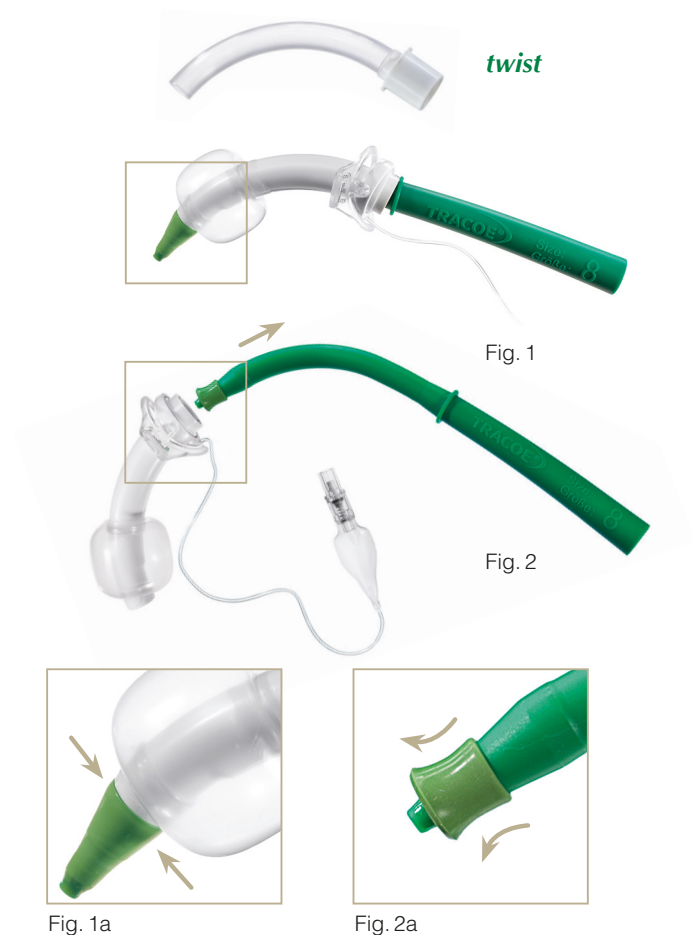

At the tip of the *twist* inserter, there is a folding silicone sleeve that bridges the gap in diameter between the inserter and the end of the tube (Fig. 1a).

The minimally traumatic inserter is characterized by a fit tailored to the respective tube and a stopper at the proximal end of the tube. This minimizes a passage through the distal end of the inserter out of the tube. Once the tube is in the trachea, the inserter is pulled out of the tube. The silicone sleeve flaps back so that the inserter can be removed. (Fig. 2, 2a).

## The Benefits

Dilation is performed using the Ciaglia one-step technique. The minimally traumatic inserter smooths over the gap in diameter between the end of the tube and the inserter.

The separately available P-tubes can also be used for reinsertion and/or for tube change – in combination with a Seldinger guide wire, if necessary (see page 15).

# The Minimally Traumatic Insertion System

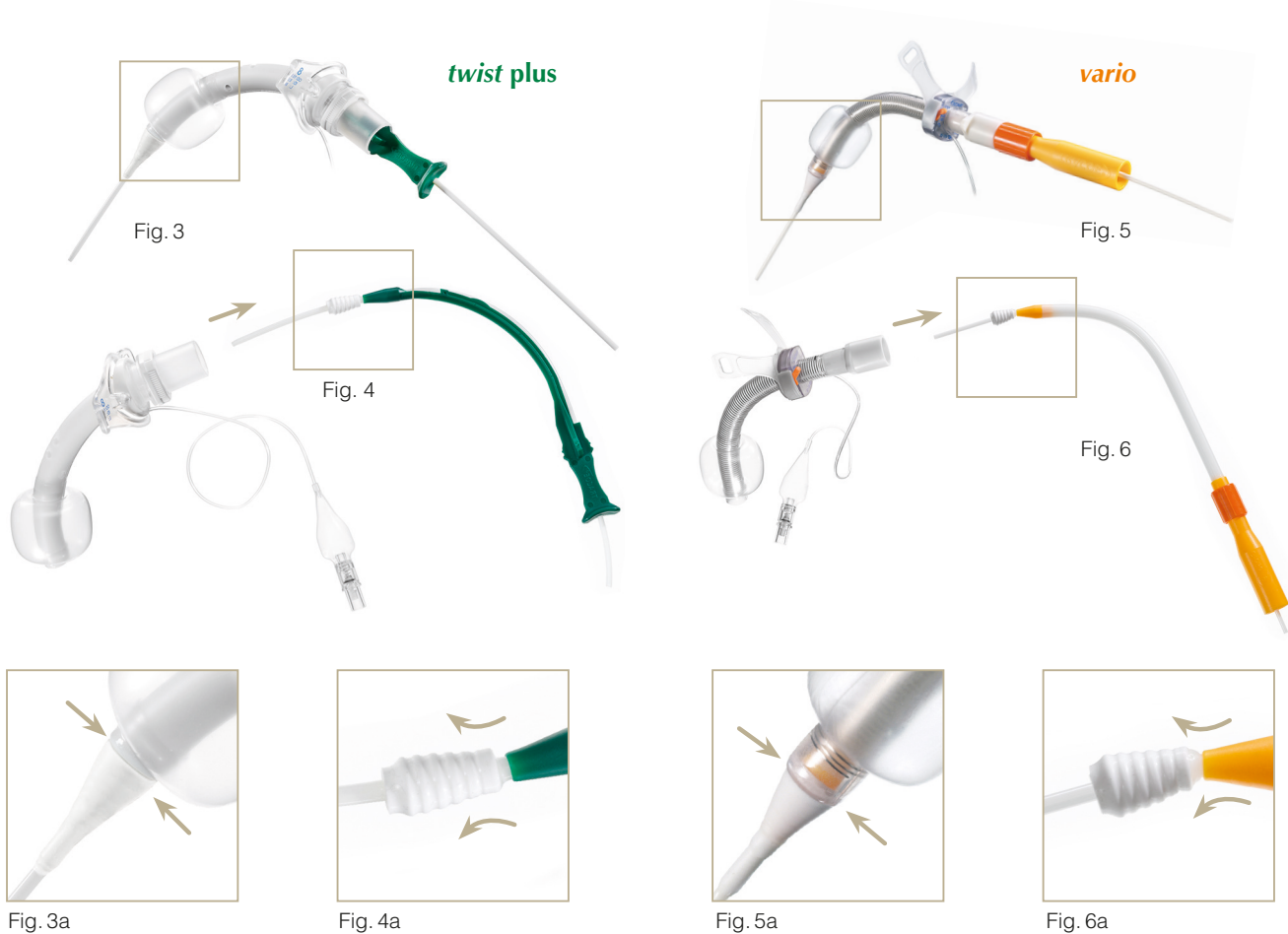

The systems for *twist plus*, *vario*, and *vario XL* consist of two parts: the white guiding catheter with silicone sleeve and the green (*twist plus*) or orange (*vario*) inserter. The silicone sleeve bridges the gap in diameter between the end of the tube and the inserter (Fig. 3a, 5a).

The *twist plus* tracheostomy tube is supplied pre-mounted on the minimally traumatic insertion system, with the inner cannula already in place. The insertion system is adapted to the specific tube shape and length. Once the tube is in the trachea, the colored inserter, the white guiding catheter with the silicone sleeve, and the Seldinger guide wire are

removed together as a single unit. The silicone sleeve flaps back and the unit can be removed (Fig. 4a, 6a).

Alternatively, the colored inserter can be pulled out of the tube first, followed by the white guiding catheter and Seldinger guide wire. The white guiding catheter must never be removed first.

## expERC Sets *vario*



REF 420



**TRACOE expERC Set *vario* including REF 450-P**  
spiral-reinforced, with adjustable neck flange, low-pressure cuff and minimally traumatic insertion system

Details on page 23/26



REF 422



**TRACOE expERC Set *vario* extract including REF 470-P**

with adjustable neck flange, low-pressure cuff, subglottic suction line and minimally traumatic insertion system

Details on page 23/26



REF 423



**TRACOE expERC Set *vario* including REF 460-P**  
with adjustable neck flange, low-pressure cuff and minimally traumatic insertion system

Details on page 23/26

## expERC Sets *vario* XL



REF 421



**TRACOE expERC Set *vario* XL including REF 451-P**  
extra-long, spiral-reinforced, with adjustable neck flange, low-pressure cuff and minimally traumatic insertion system

Details on page 25/26



REF 425



**TRACOE expERC Set *vario* XL extract including REF 471-P**

extra-long, with adjustable neck flange, low-pressure cuff, subglottic suction line, and minimally traumatic insertion system

Details on page 25/26



REF 424



**TRACOE expERC Set *vario* XL including REF 461-P**  
extra-long, with adjustable neck flange, low-pressure cuff and minimally traumatic insertion system

Details on page 25/26

## experc Sets *twist*



REF 320

TRACOE experc Set *twist* including **REF 301-P** with low-pressure cuff and minimally traumatic inserter  
Details on page 31/40



REF 321



TRACOE experc Set *twist* including **REF 302-P** with low-pressure cuff, fenestrated, and minimally traumatic inserter  
Details on page 31/40



REF 322

TRACOE experc Set *twist extract* including **REF 306-P** with low-pressure cuff, subglottic suction line and minimally traumatic inserter  
Details on page 33/40



REF 888-322



TRACOE experc Set *twist extract* including **REF 888-306-P** with low-pressure cuff, fenestration, subglottic suction line and minimally traumatic insertion system  
Details on page 33/40

## experc Sets *twist plus*



REF 330



TRACOE experc Set *twist plus* including **REF 311-P** with low-pressure cuff and minimally traumatic insertion system  
Details on page 35/41



REF 331



TRACOE experc Set *twist plus* including **REF 312-P** with low-pressure cuff, double fenestrated, and minimally traumatic insertion system  
Details on page 35/41



REF 332



TRACOE experc Set *twist plus extract* including **REF 316-P** with low-pressure cuff, subglottic suction line and minimally traumatic insertion system  
Details on page 37/41



REF 888-332



TRACOE experc Set *twist plus extract* including **REF 888-316-P** with low-pressure cuff, double fenestrated, subglottic suction line and minimally traumatic insertion system  
Details on page 37/41



## Patented Precision Work

TRACOE *vario* is a soft, flexible (DEHP-free) tube with an adjustable neck flange. By means of a practical push-button mechanism, the flange can be moved and individually adjusted for each patient.

In this way, the correct length can be achieved. A scale ensures the exact positioning of the neck flange in preparation for a tube change.

The flange is then locked in place by moving the orange lever upward. Locking with a twist lock is no longer necessary.



## A wide range of adjustment options

The flexible wings on the flange of the TRACOE *vario* tube can be adjusted independently of one another, providing further opportunities to accommodate the individual patient's anatomy. The right solution for each patient can be selected from the eight types of TRACOE *vario* tracheostomy tubes available: whether reinforced with a metal spiral, made of transparent plastic (with radio-opaque contrast lines), fenestrated, with or without a low-pressure cuff.

The extra-long TRACOE *vario* XL with metal spiral and TRACOE *vario* extract in transparent plastic equipped with a subglottic suction line, both with low-pressure cuffs, are special varieties – of course also available in the standard lengths.



**REF 450**



## TRACOE *vario* Tracheostomy Tube

spiral-reinforced, with adjustable neck flange, low-pressure cuff, scale, and 15 mm connector

Including: ♦ obturator and neck strap  
♦ in sterile package



**REF 460**



## TRACOE *vario* Tracheostomy Tube

with adjustable neck flange, low-pressure cuff, X-ray contrast line, scale, and 15 mm connector

Including: ♦ obturator and neck strap  
♦ in sterile package

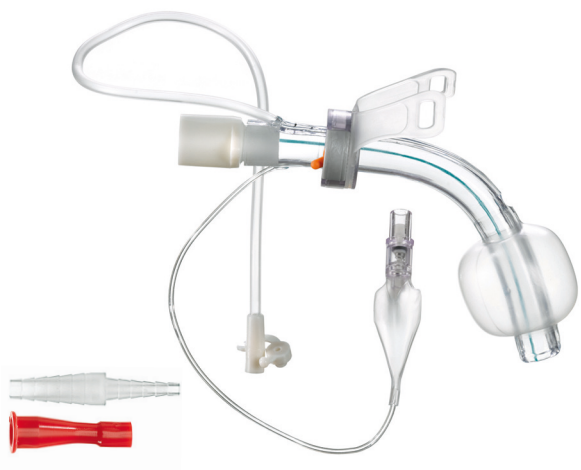

**REF 470**



## TRACOE *vario* extract Tracheostomy Tube

with adjustable neck flange, low-pressure cuff, subglottic suction line, X-ray contrast line, scale and, 15 mm connector

Including: ♦ 2 connectors for suction devices  
♦ obturator and neck strap  
♦ in sterile package



**REF 455**



## TRACOE *vario* Tracheostomy Tube

spiral-reinforced, with adjustable neck flange, scale and, 15 mm connector

Including: ♦ obturator and neck strap  
♦ in sterile package



REF 450-P



## TRACOE *vario* Tracheostomy Tube

with minimally traumatic insertion system, spiral-reinforced, adjustable neck flange, low-pressure cuff, scale and, 15 mm connector

- Including:
- ◆ lubricating jelly
  - ◆ obturator and neck strap
  - ◆ in sterile package

As percutaneous set in REF 420



REF 460-P



## TRACOE *vario* Tracheostomy Tube

with minimally traumatic insertion system, adjustable neck flange, low-pressure cuff, X-ray contrast line, scale, and 15 mm connector

- Including:
- ◆ lubricating jelly
  - ◆ obturator and neck strap
  - ◆ in sterile package

As percutaneous set in REF 423



REF 470-P



## TRACOE *vario* extract Tracheostomy Tube

with minimally traumatic insertion system, adjustable neck flange, low-pressure cuff, subglottic suction line, X-ray contrast line, scale, and 15 mm connector

- Including:
- ◆ lubricating jelly
  - ◆ 2 connectors for suction pump
  - ◆ obturator and neck strap
  - ◆ in sterile package

As percutaneous set in REF 422



REF 464



## TRACOE *vario* Tracheostomy Tube

with adjustable neck flange, fenestrated, X-ray contrast line, scale, and 15 mm connector

- Including:
- ◆ obturator and neck strap
  - ◆ in sterile package



REF 451 **XL**

**TRACOE vario XL Tracheostomy Tube**  
spiral-reinforced, with adjustable neck flange,  
low-pressure cuff, scale, and 15 mm connector

Including: ♦ obturator and neck strap  
♦ in sterile package



REF 461 **XL**

**TRACOE vario XL Tracheostomy Tube**  
with adjustable neck flange, low-pressure cuff,  
X-ray contrast line, scale, and 15 mm connector

Including: ♦ obturator and neck strap  
♦ in sterile package

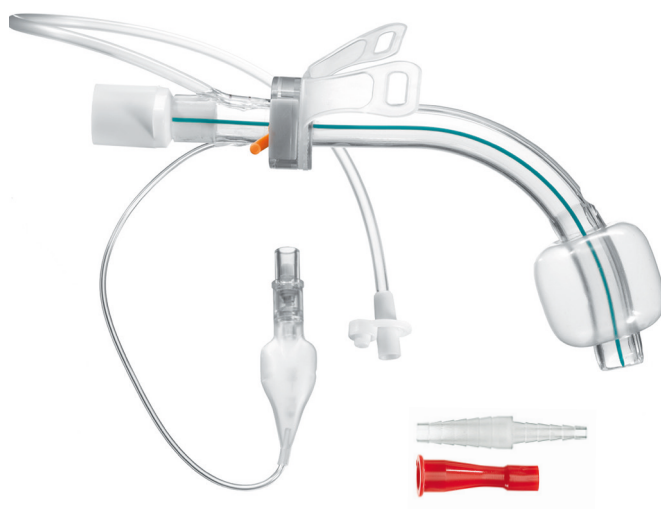

REF 471 **XL**

**TRACOE vario XL extract Tracheostomy Tube**  
with adjustable neck flange, low-pressure cuff,  
subglottic suction line, X-ray contrast line, scale  
and, 15 mm connector

Including: ♦ 2 connectors for suction pump  
♦ obturator and neck strap  
♦ in sterile package

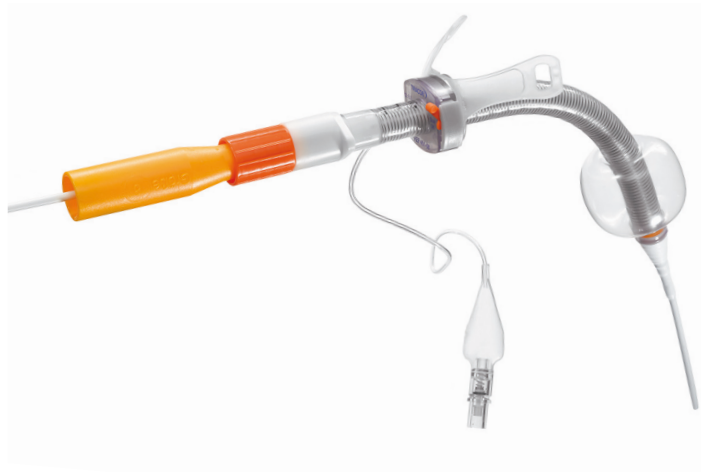

**REF 451-P XL**

**TRACOE vario XL Tracheostomy Tube**  
with minimally traumatic insertion system,  
spiral-reinforced, adjustable neck flange,  
low-pressure cuff, scale, and 15 mm connector

Including: ♦ lubricating jelly  
♦ obturator and neck strap  
♦ in sterile package

**As percutaneous set in REF 421**



**REF 461-P XL**

**TRACOE vario XL Tracheostomy Tube**  
with minimally traumatic insertion system,  
adjustable neck flange, low-pressure cuff,  
X-ray contrast line, scale and 15 mm connector

Including: ♦ lubricating jelly  
♦ obturator and neck strap  
♦ in sterile package

**As percutaneous set in REF 424**



**REF 471-P XL**

**TRACOE vario XL extract Tracheostomy Tube**  
with minimally traumatic insertion system,  
adjustable neck flange, low-pressure cuff,  
subglottic suction line, X-ray contrast line,  
scale, and 15 mm connector

Including: ♦ lubricating jelly  
♦ 2 connectors for suction devices  
♦ obturator and neck strap  
♦ in sterile package

**As percutaneous set in REF 425**

# Technical Data

## TRACOE vario

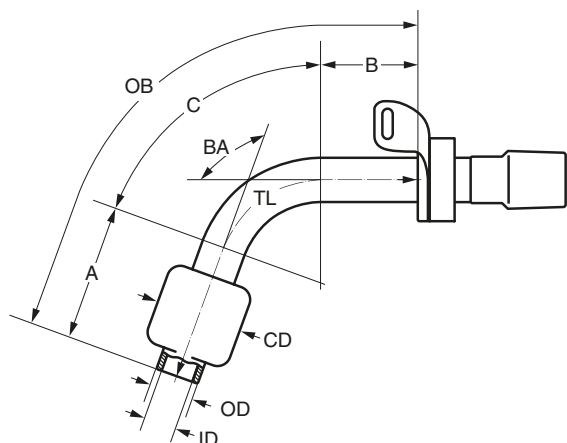

REF 450, REF 455, REF 460

*in sizes 06 – 11*

REF 464

*in sizes 07 – 09*

REF 470

*in sizes 07 – 10*

REF 450-P, REF 460-P

*in sizes 07 – 09*

REF 470-P

*in sizes 08 – 09*

| Size | ID<br>mm | OD<br>mm | A<br>mm | C<br>mm | B<br>mm | TL<br>mm | OB<br>mm | BA<br>° | CD<br>mm |
|------|----------|----------|---------|---------|---------|----------|----------|---------|----------|
| 06   | 6.0      | 8.2      | 30      | 28      | 12      | 70       | 76       | 100     | 18       |
| 07   | 7.0      | 9.7      | 33      | 32      | 15      | 80       | 86       | 100     | 23       |
| 08   | 8.0      | 11.2     | 35      | 35      | 20      | 90       | 97       | 100     | 28       |
| 09   | 9.0      | 12.3     | 38      | 35      | 27      | 100      | 106      | 100     | 30       |
| 10   | 10.0     | 13.7     | 38      | 37      | 35      | 110      | 120      | 100     | 32       |
| 11   | 11.0     | 14.8     | 38      | 37      | 35      | 110      | 121      | 100     | 34       |

## TRACOE vario XL

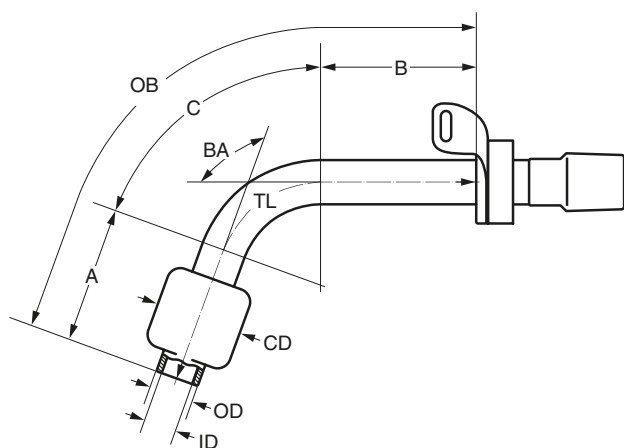

REF 451, REF 461, REF 471

*in sizes 07 – 10*

REF 451-P, REF 461-P

*in sizes 07 – 09*

REF 471-P

*in sizes 08 – 09*

| Size | ID<br>mm | OD<br>mm | A<br>mm | C<br>mm | B<br>mm | TL<br>mm | OB<br>mm | BA<br>° | CD<br>mm |
|------|----------|----------|---------|---------|---------|----------|----------|---------|----------|
| 07   | 7.0      | 9.7      | 35      | 36      | 33      | 104      | 110      | 100     | 23       |
| 08   | 8.0      | 11.2     | 37      | 43      | 40      | 123      | 128      | 100     | 28       |
| 09   | 9.0      | 12.3     | 38      | 43      | 45      | 126      | 134      | 100     | 30       |
| 10   | 10.0     | 13.7     | 38      | 52      | 45      | 135      | 146      | 100     | 32       |

**ID:** inner diameter (clear width) at bottom of cannula; **OD:** outer diameter at bottom of cannula; **A:** length; **C:** length; **B:** length; **TL:** length along center line; **OB:** length along outer bend; **BA:** bending angle; **CD:** cuff diameter

To order, specify **REF + size**, e. g. **REF 450-08**

# Specialty and Scope of Supply

## The Subglottic Suction Line



In all TRACOE tracheostomy tubes equipped with subglottic suction lines, the opening of the line is at the lowest possible point above the cuff. Secretions in the subglottic space can therefore be suctioned off at the lowest point of collection. This reduces the risk of bacterially contaminated secretions entering the lower respiratory tract and the risk of developing aspiration pneumonia.

## Highly Adaptable



The TRACOE *vario* has a variably adjustable neck flange. By means of a practical push-button mechanism, the flange can be moved on the cannula and individually positioned for each patient. The flange is then locked in place by moving the orange lever upward. Locking with a twist lock is no longer necessary.

The flexible wings on the flange of the TRACOE *vario* tube can be adjusted independently of one another, thus providing further opportunities to accommodate the individual patient's anatomy.

## Scope of Supply of TRACOE *vario* and *vario* XL Tubes

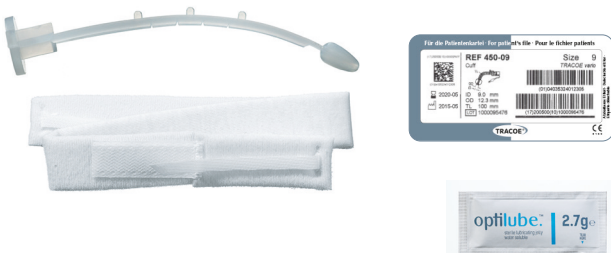

All TRACOE *vario* and *vario* XL tubes are supplied with an obturator, a wide adjustable neck strap and a product info card with two detachable labels.

Lubricating jelly (REF 677) is also supplied with the *vario* P-tubes.





For breathing and ventilation, the lumen should be as large as possible – therefore it is the inner value that counts here. For the patient, every millimeter counts. If the inner diameter of the inner cannula is reduced from 8 to 7 mm, the air supply is reduced by 41%, and the effort required to breathe increases. A change from 8 to 9 mm improves the value by 60%, while the effort required to breathe remains the same.\*

\* Hagen-Poiseuille equation on laminar flow

Fourteen types of DEHP-free tubes in the TRACOE *twist* and *twist plus* product lines offer the wide choice needed to select the best tube for each patient. Cuffed tubes, also with subglottic suction lines, are the first choice for use in percutaneous dilatation procedures – see the TRACOE *percutan* line.



**REF 301**

## TRACOE *twist* Tracheostomy Tube with low-pressure cuff

- Including:
- ◆ 2 inner cannulas with 15 mm connector
  - ◆ obturator (perforated for size 06 and above)
  - ◆ neck strap
  - ◆ in sterile package



**REF 302**



## TRACOE *twist* Tracheostomy Tube with low-pressure cuff and fenestration

- Including:
- ◆ inner cannula, fenestrated, with 15 mm connector
  - ◆ inner cannula with 15 mm connector
  - ◆ occlusion cap for fenestrated tubes
  - ◆ obturator (perforated for size 06 and above)
  - ◆ neck strap
  - ◆ in sterile package



**REF 303**

## TRACOE *twist* Tracheostomy Tube

- Including:
- ◆ 2 inner cannulas with 15 mm connector
  - ◆ obturator (perforated for size 06 and above)
  - ◆ neck strap
  - ◆ in sterile package



## REF 301-P

### TRACOE *twist* Tracheostomy Tube

with minimally traumatic inserter and low-pressure cuff

- Including:
- ◆ 2 inner cannulas with 15mm connector
  - ◆ reinsertion tube
  - ◆ lubricating jelly
  - ◆ perforated obturator
  - ◆ neck strap
  - ◆ in sterile package

As percutaneous set in REF 320



## REF 302-P



### TRACOE *twist* Tracheostomy Tube

with minimally traumatic inserter, low-pressure cuff and fenestration

- Including:
- ◆ inner cannula, fenestrated, with 15 mm connector
  - ◆ 2 inner cannulas with 15 mm connector
  - ◆ occlusion cap for fenestrated tubes
  - ◆ reinsertion tube
  - ◆ lubricating jelly
  - ◆ perforated obturator
  - ◆ neck strap
  - ◆ in sterile package

As percutaneous set in REF 321



## REF 304



### TRACOE *twist* Tracheostomy Tube

with fenestration

- Including:
- ◆ inner cannula, fenestrated, with 15 mm connector
  - ◆ inner cannula with 15 mm connector
  - ◆ occlusion cap for fenestrated tubes
  - ◆ obturator (perforated for size 06 and above)
  - ◆ neck strap
  - ◆ in sterile package



**REF 306**

**TRACOE *twist* extract Tracheostomy Tube**  
with low-pressure cuff and subglottic  
suction line

- Including:
- ◆ 2 inner cannulas with 15 mm connector
  - ◆ 2 connectors for suction devices
  - ◆ obturator (perforated for size 06 and above)
  - ◆ neck strap
  - ◆ in sterile package



**REF 888-306**



**TRACOE *twist* extract Tracheostomy Tube**  
with low-pressure cuff, subglottic suction line,  
and fenestration

- Including:
- ◆ inner cannula, fenestrated,  
with 15 mm connector
  - ◆ inner cannula with 15 mm connector
  - ◆ occlusion cap for fenestrated tubes
  - ◆ 2 connectors for suction devices
  - ◆ obturator (perforated for size 06 and above)
  - ◆ neck strap
  - ◆ in sterile package



**REF 305**

**TRACOE *twist* Laryngectomy Tube**

- Including:
- ◆ inner cannula with 15 mm connector,
  - ◆ inner cannula with grooved low-profile  
connector
  - ◆ obturator
  - ◆ neck strap
  - ◆ in sterile package

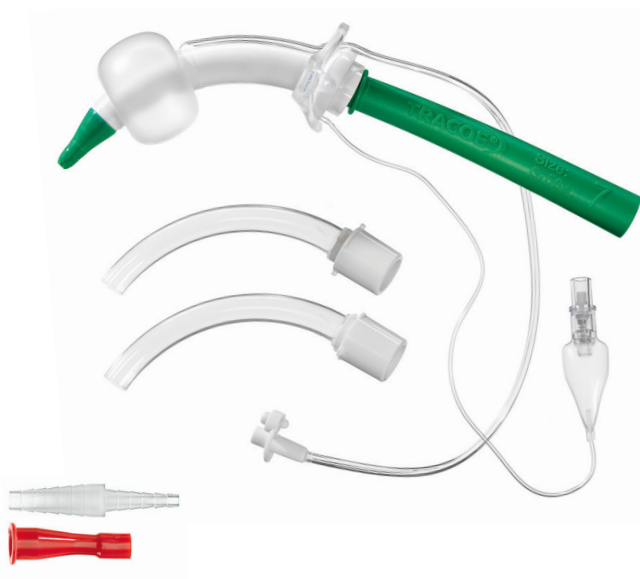

## REF 306-P

**TRACOE *twist* extract Tracheostomy Tube**  
with minimally traumatic inserter, low-pressure cuff  
and subglottic suction line

- Including:
- ◆ 2 inner cannulas with 15mm connector
  - ◆ 2 connectors for suction devices
  - ◆ reinsertion tube
  - ◆ lubricating jelly
  - ◆ perforated obturator
  - ◆ neck strap
  - ◆ in sterile package

As percutaneous set in REF 322



## REF 888-306-P



**TRACOE *twist* extract Tracheostomy Tube**  
with minimally traumatic inserter, low-pressure cuff,  
subglottic suction line and fenestration

- Including:
- ◆ inner cannula, fenestrated,  
with 15mm connector
  - ◆ 2 inner cannulas with 15mm connector
  - ◆ 2 connectors for suction devices
  - ◆ occlusion cap for fenestrated tubes
  - ◆ reinsertion tube
  - ◆ lubricating jelly
  - ◆ perforated obturator
  - ◆ neck strap
  - ◆ in sterile package

As percutaneous set in REF 888-322



**REF 311** 

**TRACOE *twist* plus Tracheostomy Tube**  
with low-pressure cuff

- Including:
- ◆ 2 inner cannulas with 15 mm connector
  - ◆ perforated obturator
  - ◆ neck strap
  - ◆ in sterile package



**REF 312**  

**TRACOE *twist* plus Tracheostomy Tube**  
with low-pressure cuff, double fenestration at inner and outer bend

- Including:
- ◆ inner cannula, double fenestrated with 15 mm connector
  - ◆ inner cannula with 15 mm connector
  - ◆ occlusion cap for fenestrated tubes
  - ◆ perforated obturator
  - ◆ neck strap
  - ◆ in sterile package



**REF 313** 

**TRACOE *twist* plus Tracheostomy Tube**

- Including:
- ◆ 2 inner cannulas with 15 mm connector
  - ◆ perforated obturator
  - ◆ neck strap
  - ◆ in sterile package

REF 311-P



**TRACOE *twist* plus Tracheostomy Tube**  
with minimally traumatic inserter and low-pressure cuff

- Including:
- ◆ 2 inner cannulas with 15mm connector, one pre-mounted
  - ◆ lubricating jelly
  - ◆ perforated obturator
  - ◆ neck strap
  - ◆ in sterile package

As percutaneous set in REF 330

REF 312-P



**TRACOE *twist* plus Tracheostomy Tube**  
with minimally traumatic inserter, low-pressure cuff and double fenestration at inner and outer bend

- Including:
- ◆ 2 inner cannulas with 15mm connector, one pre-mounted
  - ◆ inner cannula, double fenestrated with 15mm connector
  - ◆ occlusion cap for fenestrated tubes
  - ◆ lubricating jelly
  - ◆ perforated obturator
  - ◆ neck strap
  - ◆ in sterile package

As percutaneous set in REF 331

REF 314



**TRACOE *twist* plus Tracheostomy Tube**  
with double fenestration at inner and outer bend

- Including:
- ◆ inner cannula, double fenestrated with 15mm connector
  - ◆ inner cannula with 15mm connector
  - ◆ occlusion cap for fenestrated tubes
  - ◆ perforated obturator
  - ◆ neck strap
  - ◆ in sterile package





**REF 316** 

**TRACOE *twist* plus extract Tracheostomy Tube**  
with low-pressure cuff and subglottic  
suction channel

Including: ♦ 2 inner cannulas with 15 mm connector  
♦ 2 connectors for suction devices  
♦ perforated obturator  
♦ neck strap  
♦ in sterile package



**REF 888-316**  

**TRACOE *twist* plus extract Tracheostomy Tube**  
with low-pressure cuff, subglottic suction channel,  
double fenestration at inner and outer bend

Including: ♦ inner cannula with 15 mm connector  
♦ inner cannula, double fenestrated  
with 15 mm connector  
♦ occlusion cap for fenestrated tubes  
♦ 2 connectors for suction devices  
♦ perforated obturator  
♦ neck strap  
♦ in sterile package



**REF 316-P** 

**TRACOE *twist* plus extract Tracheostomy Tube**  
with minimally traumatic inserter, low-pressure cuff  
and subglottic suction channel

- Including:
- ◆ 2 inner cannulas with 15mm connector, one pre-mounted
  - ◆ 2 connectors for suction devices
  - ◆ lubricating jelly
  - ◆ perforated obturator
  - ◆ neck strap
  - ◆ in sterile package

**As percutaneous set in REF 332**



**REF 888-316-P**  

**TRACOE *twist* plus extract Tracheostomy Tube**  
with minimally traumatic inserter, low-pressure cuff,  
subglottic suction channel, double fenestration at inner  
and outer bend

- Including:
- ◆ 2 inner cannulas with 15mm connector, one pre-mounted
  - ◆ inner cannula, double fenestrated with 15mm connector
  - ◆ 2 connectors for suction devices
  - ◆ occlusion cap for fenestrated tubes
  - ◆ lubricating jelly
  - ◆ perforated obturator
  - ◆ neck strap
  - ◆ in sterile package

**As percutaneous set in REF 888-332**



## REF 501

**TRACOE *twist* Spare Inner Cannulas**  
with 15 mm connector

Packaging unit:

- ◆ 3 units (*in sizes 04 – 10*)
- ◆ 10 units under **REF 501-X**  
(*in sizes 04 – 10*)
- ◆ 30 units under **REF 501-XXX**  
(*in sizes 06 – 09*)
- ◆ sterile, individually packaged



## REF 506



**TRACOE *twist* Spare Inner Cannulas**  
fenestrated, with 15 mm connector

Packaging unit:

- ◆ 3 units (*in sizes 04 – 10*)
- ◆ 10 units under **REF 506-X**  
(*in sizes 04 – 10*)
- ◆ sterile, individually packaged



## REF 503

**TRACOE *twist* Spare Inner Cannulas**  
short, with 15 mm connector, for REF 305

Packaging unit:

- ◆ 3 units (*in sizes 05 – 10*)
- ◆ sterile, individually packaged

**REF 521**

**TRACOE *twist* plus Spare Inner Cannulas**  
with 15 mm connector

- Packaging unit:
- ◆ 3 units (*in sizes 07 – 10*)
  - ◆ 10 units under **REF 521-X**  
(*in sizes 07 – 10*)
  - ◆ 30 units under **REF 521-XXX**  
(*in sizes 07 – 09*)
  - ◆ sterile, individually packaged

**REF 523**

**TRACOE *twist* plus Spare Inner Cannulas**  
double fenestrated, with 15 mm connector

- Packaging unit:
- ◆ 3 units (*in sizes 07 – 10*)
  - ◆ 10 units under **REF 523-X**  
(*in sizes 07 – 10*)
  - ◆ sterile, individually packaged

# Technical Data

## TRACOE *twist*

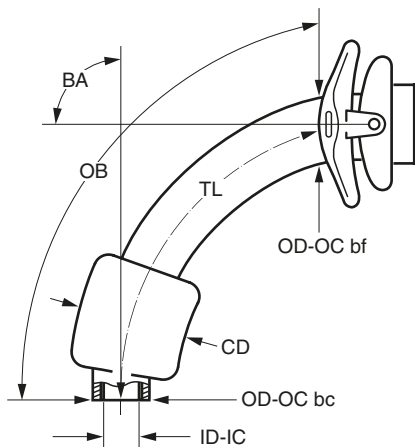

REF 301, REF 302, REF 303,  
REF 304, REF 306,

*in sizes 04 – 10*

REF 888-306

*in sizes 06 – 10*

REF 301-P, REF 302-P,  
REF 306-P, REF 888-306-P

*in sizes 07 – 09*

| Size | ID-IC<br>mm | OD-OC bc<br>mm | OD-OC bf<br>mm | TL<br>mm | OB<br>mm | BA<br>° | CD<br>mm |
|------|-------------|----------------|----------------|----------|----------|---------|----------|
| 04   | 4.0         | 7.2            | 8.6            | 59       | 63.0     | 110     | 15       |
| 05   | 5.0         | 8.6            | 10.1           | 66       | 73.0     | 100     | 18       |
| 06   | 6.0         | 9.2            | 10.8           | 72       | 79.5     | 95      | 23       |
| 07   | 7.0         | 10.4           | 12.0           | 74       | 80.5     | 95      | 26       |
| 08   | 8.0         | 11.4           | 12.7           | 76       | 83.0     | 90      | 28       |
| 09   | 9.0         | 12.5           | 14.2           | 78       | 88.5     | 90      | 30       |
| 10   | 10.0        | 13.8           | 15.2           | 80       | 89.5     | 90      | 32       |

## TRACOE *twist* Laryngectomy Tube

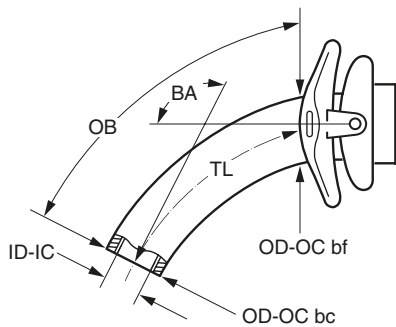

REF 305

| Size | ID-IC<br>mm | OD-OC bc<br>mm | OD-OC bf<br>mm | TL<br>mm | OB<br>mm | BA<br>° |
|------|-------------|----------------|----------------|----------|----------|---------|
| 05   | 5.0         | 9.0            | 10.1           | 47       | 52       | 125     |
| 06   | 6.0         | 9.4            | 10.8           | 50       | 56       | 120     |
| 07   | 7.0         | 10.6           | 12.0           | 52       | 59       | 120     |
| 08   | 8.0         | 11.6           | 12.7           | 56       | 63       | 115     |
| 09   | 9.0         | 12.8           | 14.2           | 58       | 66       | 108     |
| 10   | 10.0        | 14.2           | 15.2           | 60       | 70       | 100     |

**ID-IC:** inner diameter (clear width) at bottom of inner cannula; **OD-OC bc:** outer diameter at bottom of outer cannula; **OD-OC bf:** outer diameter of outer cannula behind the flange; **TL:** length along center line from start of neck flange to bottom of tube; **OB:** length along outer bend from start of neck flange to bottom of tube; **BA:** bending angle; **CD:** cuff diameter

To order, specify: **REF + Size**, e.g., **REF 306-08**

# Technical Data and Scope of Supply

## TRACOE *twist* plus

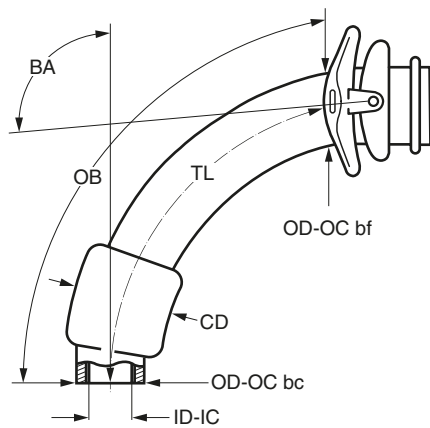

REF 311, REF 312, REF 313, REF 314, REF 316, REF 888-316,  
REF 311-P, REF 312-P, REF 316-P, REF 888-316-P

| Size | ID-IC<br>mm | OD-OC bc<br>mm | OD-OC bf<br>mm | TL<br>mm | OB<br>mm | BA<br>° | CD<br>mm |
|------|-------------|----------------|----------------|----------|----------|---------|----------|
| 07   | 7.0         | 9.8            | 10.1           | 85       | 91       | 100     | 26       |
| 08   | 8.0         | 10.8           | 11.1           | 88       | 95       | 100     | 28       |
| 09   | 9.0         | 11.8           | 12.1           | 90       | 99       | 100     | 30       |
| 10   | 10.0        | 12.8           | 13.1           | 92       | 102      | 100     | 32       |

## Scope of Supply of TRACOE *twist* and *twist* plus Tubes

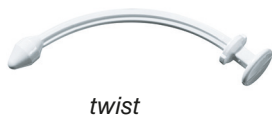

*twist*

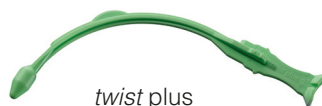

*twist* plus



All TRACOE *twist* and *twist* plus tracheostomy tubes are supplied with a perforated obturator (for *twist* from size 06 and above), a wide adjustable neck strap, and a product info card with two detachable labels. Exception: obturator of REF 305 is not perforated in all sizes.



Lubricating jelly (REF 677) is supplied with the TRACOE *twist* and *twist* plus P-tubes.



All TRACOE *twist* P-tubes come with a reinsertion tube.

# Product Information and Specialities

## Fenestration



### TRACOE *twist* and *twist plus*

Fenestrated *twist* and *twist plus* tubes have fenestration on the outer bend. The *twist plus* tube has double fenestration: in addition to the fenestration, it has two phonation holes on the inner bend.

### TRACOE *twist extract* REF 888-306 and *twist plus extract* REF 888-316

These multifunctional tracheostomy tubes are equipped with a low-pressure cuff, subglottic suction line, and fenestration. This allows them to be used with inflated cuff and closed inner cannula for ventilation, and with deflated cuff and fenestrated or unfenestrated inner cannula for stimulation of the upper airways and phonation.

## Features of the Inner and Outer Cannulas

### Green and White means unfenestrated



- ◆ Green lettering on the neck flange indicates an unfenestrated outer cannula



- ◆ Unfenestrated TRACOE *twist* inner cannulas are identified by white 15mm connectors



- ◆ Unfenestrated TRACOE *twist plus* inner cannulas are identified by a white grooved low-profile connector

### Blue means fenestrated



- ◆ Blue lettering on the neck flange indicates a fenestrated outer cannula



- ◆ Fenestrated TRACOE *twist* inner cannulas are identified by blue 15mm connectors



- ◆ Fenestrated TRACOE *twist plus* inner cannulas are identified by a blue grooved low-profile connector



Videos on our TRACOE *twist* and *twist plus* cannulas can be found on our YouTube channel: <https://bit.ly/398TSmU>

## It's the Inner Values that count!



View of tube end

For the patient, every millimeter counts. If the inner diameter of the inner cannula is reduced from 8 to 7 mm, the air supply is reduced by 41%, and the effort required to breathe increases. A change from 8 to 9 mm improves the value by 60%, while the effort required to breathe remains the same.\*

\* Hagen-Poiseuille equation on laminar flow

Sizing of the TRACOE *twist* and *twist plus* lines always corresponds to the inner diameter of the inner cannula. For example, when it says 08 on the cannula, the lumen of the inner cannula is 8 mm.

## Subglottic suction



Accumulated secretions in the subglottic space can be suctioned off at the lowest point, above the low-pressure cuff. This reduces the risk of bacterially contaminated secretions passing into the lower respiratory tract. In the TRACOE *twist* and *twist plus* extract tubes, the opening of the subglottic suction line is at the lowest point above the low-pressure cuff. Because the tube wall is not very thick, the line runs on the cannula and not within the wall. Funnel and cone connectors are supplied to connect to a suction device.

The innovative, flat and stable suction channel of the *twist plus* extract tube provides a significantly improved suction performance.

The larger flow cross-section and the lower suction point enable efficient suction: Compared with the predecessor model, secretion is suctioned off more rapidly and more thoroughly.

The TRACOE *twist* and *twist plus* multifunctional tubes REF 888-306 and REF 888-316 can be used for ventilation, subglottic suction, and – by means of the ACV option – allow phonation despite a closed cannula.



## The Smaller the Detail, the Greater the Value

True greatness sometimes shows itself in small things. There are two product lines in our TRACOE *kids* product group: the tried and trusted TRACOE mini and the TRACOE silcosoft. The tracheostomy tubes in both these lines have been developed especially for neonates, infants, and children. We have focused particularly on the flange design and the use of comfortable materials.

TRACOE silcosoft are soft, flexible, spiral-reinforced silicone tubes, with and without cuff. Special features include the slightly curved flange and the large, specially reinforced eyelets.

Our tried and trusted TRACOE mini is a soft PVC tube that does not contain DEHP. The flange has a sloping underside to optimize the fit.



## Light and Safe

The specially designed ring obturator is extremely practical. The ring-shaped grip ensures that tubes can be inserted safely, despite their small size and different materials. A proximal extension piece suitable for the TRACOE mini tubes is available. Neck straps, heat/moisture exchangers and special compresses are also available for the TRACOE *kids* products.

## Anatomically Optimized Solutions

To ensure the best solution for each young patient, TRACOE mini is available in 12 different sizes: 4 for use in neonates/infants and 8 for pediatric use. TRACOE silcosoft is available in 11 different sizes: 4 for use in neonates/infants and 7 for pediatric use.

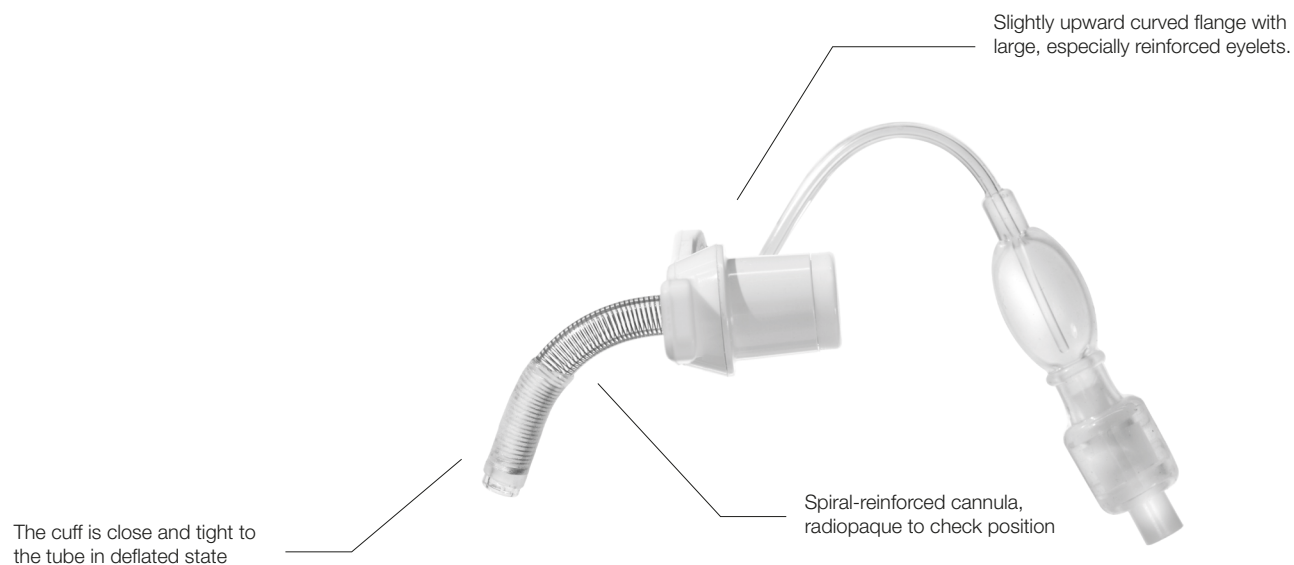

### Special Features

TRACOE silcosoft is a soft, flexible, spiral-reinforced silicone tube. The large, especially reinforced eyelets on the flange prevent the material tearing with a hook-and-loop fastener. Length-specific variants can be supplied from stock. For larger order quantities delivery time on request.

### Obturator with ring-shaped grip

The specially designed ring obturator is extremely practical. The ring-shaped grip ensures that the tube can be inserted safely, despite its small size.

### TRACOE H<sub>2</sub>O Cuff

When the cuff is deflated, it is close and tight to the cannula. It is filled with sterile water. The cuff serves as a seal to prevent aspiration of food and saliva from the pharynx or an unwanted escape of air during ventilation.



Learn more in our product videos  
on our YouTube channel: <https://bit.ly/3NdBI1N>

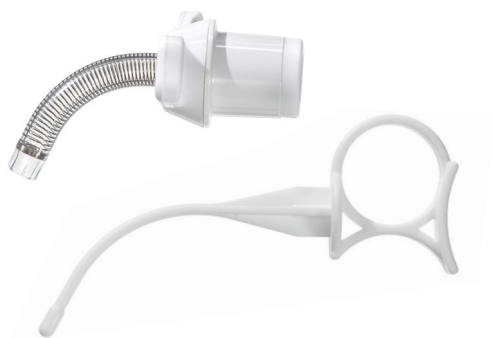

REF 360



**TRACOE silcosoft Tracheostomy Tube**  
for neonates and infants, made from silicone

Including: ♦ ring obturator  
♦ neck strap  
♦ disconnection wedge  
♦ in sterile package



REF 361



**TRACOE silcosoft PL Tracheostomy Tube**  
for neonates and infants, proximal longer,  
made from silicone

Including: ♦ obturator  
♦ neck strap  
♦ disconnection wedge  
♦ in sterile package

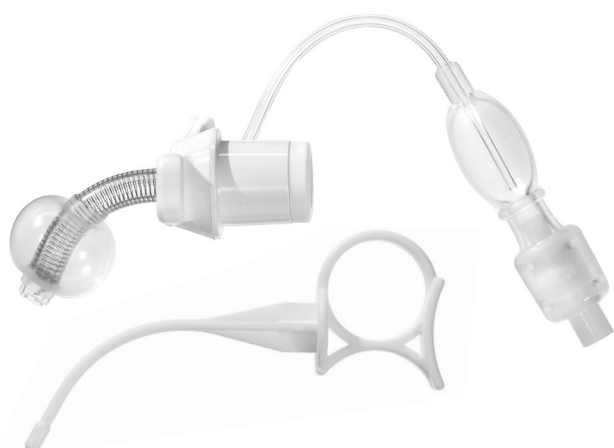

REF 362



**TRACOE silcosoft Tracheostomy Tube**  
for neonates and infants, with H<sub>2</sub>O cuff,  
made from silicone

Including: ♦ ring obturator  
♦ neck strap  
♦ disconnection wedge  
♦ in sterile package



REF 363



**TRACOE silcosoft PL Tracheostomy Tube**  
for neonates and infants, with H<sub>2</sub>O cuff,  
proximal longer, made from silicone

Including: ♦ obturator  
♦ neck strap  
♦ disconnection wedge  
♦ in sterile package



REF 370



**TRACOE silcosoft Tracheostomy Tube**  
for children, made from silicone

Including: ♦ ring obturator  
♦ neck strap  
♦ disconnection wedge  
♦ in sterile package



REF 371



**TRACOE silcosoft PL Tracheostomy Tube**  
for children, proximal longer, made from silicone

Including: ♦ obturator  
♦ neck strap  
♦ disconnection wedge  
♦ in sterile package



REF 372



**TRACOE silcosoft Tracheostomy Tube**  
for children, with H<sub>2</sub>O cuff, made from silicone

Including: ♦ ring obturator  
♦ neck strap  
♦ disconnection wedge  
♦ in sterile package

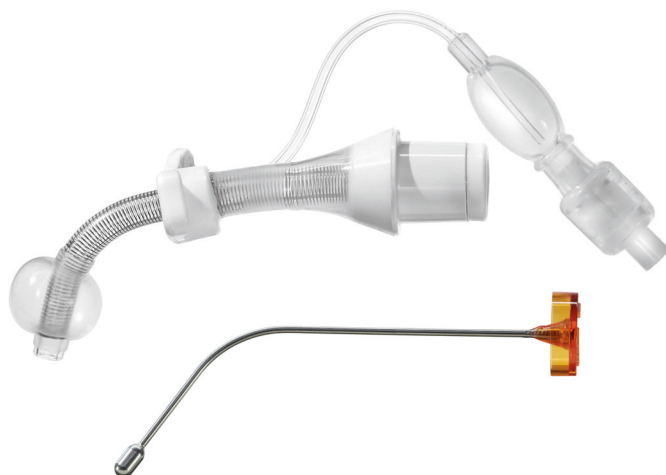

REF 373



**TRACOE silcosoft PL Tracheostomy Tube**  
for children, with H<sub>2</sub>O cuff, proximal longer,  
made from silicone

Including: ♦ obturator  
♦ neck strap  
♦ disconnection wedge  
♦ in sterile package



REF 350



**TRACOE mini Tracheostomy Tube**  
for neonates and infants

Including: ♦ ring obturator  
♦ neck strap  
♦ in sterile package



REF 355



**TRACOE mini Tracheostomy Tube**  
for children

Including: ♦ ring obturator  
♦ neck strap  
♦ in sterile package



REF 356

**TRACOE mini Extension Piece**

Including: ♦ disconnection wedge  
♦ in sterile package

Prevents obstruction of the tube in patients with a short neck or by the patient's chin. The dead space will be increased by approx. 3.5 – 4 ml (cm<sup>3</sup>), which corresponds to the normal dead space of 2 – 3-year-old children. Fits all TRACOE mini tubes up to an inner diameter of 6mm.



REF 643



**TRACOE humid assist *kids* Heat/Moisture Exchanger**  
with paper filter, for attachment to any pediatric tube  
with 15 mm connector, to be used in children with tidal  
volume of 7 to 50 ml

Details of the product are given in the *modular* product line on  
page 85.

# Technical Data and Scope of Supply

## TRACOE silcosoft® for Neonates and Infants

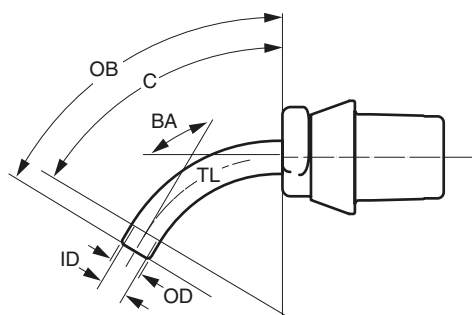

REF 360, REF 362

REF 361 (proximal longer), REF 363 (proximal longer)

| Size | ID<br>mm | OD<br>mm | C<br>mm | TL<br>mm | OB<br>mm | BA<br>° | PL<br>mm |
|------|----------|----------|---------|----------|----------|---------|----------|
| 2.5  | 2.5      | 4.4      | 26.8    | 30       | 32       | 120     | 15       |
| 3.0  | 3.0      | 4.9      | 28.0    | 32       | 34       | 120     | 17       |
| 3.5  | 3.5      | 5.4      | 29.0    | 34       | 37       | 120     | 20       |
| 4.0  | 4.0      | 6.0      | 29.0    | 36       | 39       | 120     | 22       |

For reasons of clarity, this illustration shows TRACOE silcosoft tubes without a proximal extension (REF 360 and REF 362).

## TRACOE silcosoft® for Children

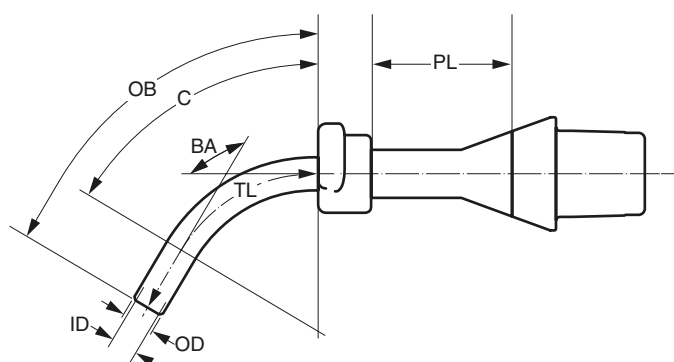

REF 370, REF 372

REF 371 (proximal longer), REF 373 (proximal longer)

| Size | ID<br>mm | OD<br>mm | C<br>mm | TL<br>mm | OB<br>mm | BA<br>° | PL<br>mm |
|------|----------|----------|---------|----------|----------|---------|----------|
| 2.5  | 2.5      | 4.4      | 29.0    | 38       | 40       | 120     | 20       |
| 3.0  | 3.0      | 4.9      | 29.0    | 39       | 41       | 120     | 20       |
| 3.5  | 3.5      | 5.4      | 29.0    | 40       | 43       | 120     | 25       |
| 4.0  | 4.0      | 6.0      | 29.0    | 41       | 44       | 120     | 25       |
| 4.5  | 4.5      | 6.6      | 29.0    | 42       | 45       | 120     | 30       |
| 5.0  | 5.0      | 7.3      | 29.0    | 44       | 48       | 120     | 30       |
| 5.5  | 5.5      | 8.4      | 29.0    | 46       | 50       | 120     | 30       |

For reasons of clarity, this illustration shows proximal longer TRACOE silcosoft tubes (REF 371 and REF 373).

**ID:** inner diameter (clear width) of inner cannula; **OD:** outer diameter of outer cannula; **C:** length of bend; **B:** length; **TL:** length along center line from start of neck flange to bottom of tube; **OB:** length along outer bend from start of neck flange to bottom of tube; **BA:** bending angle; **PL:** proximal longer

To order, specify: **REF + Size**, e.g., **REF 370-2.5**



If required, length variants can also be made for patients with complex anatomical and physiological conditions.

The corresponding ordering forms are available at:

silcosoft: <https://files.tracoe.com/004-kids/tracoe-kids-bestellformular-silcosoft-en-1.0.pdf> or

mini: <https://files.tracoe.com/004-kids/tracoe-kids-bestellformular-produktvarianten-mini-v2-en.pdf>

# Technical Data and Specialities

## TRACOE mini for Neonates and Infants

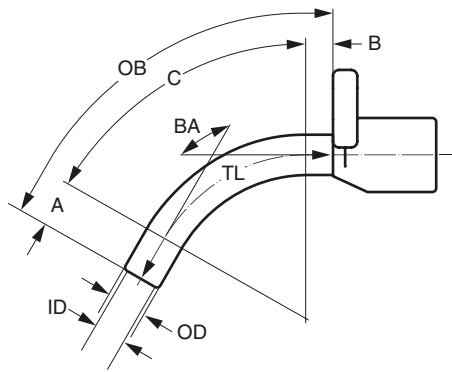

REF 350

| Size | ID<br>mm | OD<br>mm | A<br>mm | C<br>mm | B<br>mm | TL<br>mm | OB<br>mm | BA<br>° |
|------|----------|----------|---------|---------|---------|----------|----------|---------|
| 2.5  | 2.5      | 3.6      | 6       | 22      | 2       | 30       | 32       | 120     |
| 3.0  | 3.0      | 4.3      | 7       | 23      | 2       | 32       | 34       | 120     |
| 3.5  | 3.5      | 5.0      | 8       | 23      | 3       | 34       | 37       | 120     |
| 4.0  | 4.0      | 5.6      | 9       | 24      | 3       | 36       | 40       | 120     |

## TRACOE mini for Children

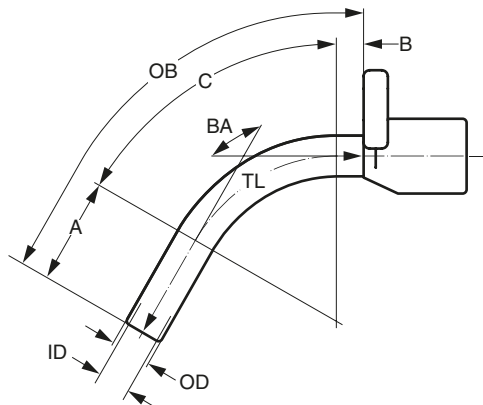

REF 355

| Size | ID<br>mm | OD<br>mm | A<br>mm | C<br>mm | B<br>mm | TL<br>mm | OB<br>mm | BA<br>° |
|------|----------|----------|---------|---------|---------|----------|----------|---------|
| 2.5  | 2.5      | 3.6      | 8       | 22      | 2       | 32       | 34       | 120     |
| 3.0  | 3.0      | 4.3      | 10      | 24      | 2       | 36       | 39       | 120     |
| 3.5  | 3.5      | 5.0      | 12      | 25      | 3       | 40       | 43       | 120     |
| 4.0  | 4.0      | 5.6      | 14      | 27      | 3       | 44       | 48       | 120     |
| 4.5  | 4.5      | 6.3      | 16      | 28      | 4       | 48       | 52       | 120     |
| 5.0  | 5.0      | 7.0      | 18      | 28      | 4       | 50       | 55       | 120     |
| 5.5  | 5.5      | 7.6      | 20      | 30      | 5       | 55       | 60       | 120     |
| 6.0  | 6.0      | 8.4      | 22      | 35      | 5       | 62       | 67       | 120     |

## TRACOE mini Extension Piece

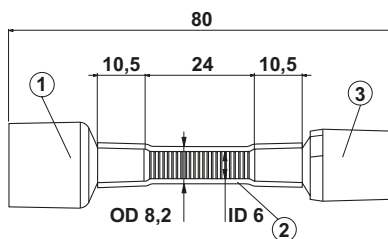

REF 356

- ① 15 mm connector, female; ② spiral-reinforced tube;
- ③ 15 mm connector, male

## Scope of Supply of TRACOE kids Tubes



All TRACOE *kids* tubes are supplied with an obturator, a soft wide adjustable neck strap (REF 903-G), and a product info card with two detachable labels.

All TRACOE silcosoft tubes are supplied with a disconnection wedge.



## Superb Quality

TRACOE *comfort*: The long-term tube has traditionally been handcrafted for the past six decades. It is characterized by its softness and flexibility and is particularly economical to use thanks to its durability.

## Lightweight and Flexible

TRACOE *comfort* tracheostomy tubes are made of clear, thermo-sensitive polymer material (DEHP-free), which becomes softer at body temperature. They are visible on X-rays. They also have a low weight due to the material used.



## As Comfortable as Possible

TRACOE *comfort* tubes provide wearing *comfort* for tracheotomized and laryngectomized patients. Their discreet appearance is an added benefit. To ensure optimum quality, they are largely made by hand.

## Many Models and Sizes

All tube types are available in many different sizes and designs. This variety facilitates the selection of the tube suitable for the respective anatomy of the patient. Also available as TRACOE *comfort* plus with a different bending angle and double fenestration. The tube length of *comfort* plus is between standard and extra-long.



**REF 101**

**TRACOE *comfort* Tracheostomy Tube**

Including: ♦ neck strap

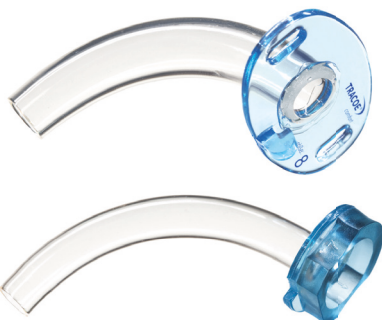

**REF 102**

**TRACOE *comfort* Tracheostomy Tube**

Including: ♦ inner cannula with low profile  
♦ neck strap



**REF 102-D**

**TRACOE *comfort* Tracheostomy Tube**

Including: ♦ 2 inner cannulas with low profile  
♦ neck strap

**REF 202 | XL****TRACOE *comfort* XL Tracheostomy Tube**

Including: ♦ inner cannula with low profile  
♦ neck strap

For permanent wearers and patients with tracheal stenosis.

**REF 202-D | XL****TRACOE *comfort* XL Tracheostomy Tube**

Including: ♦ 2 inner cannulas with low profile  
♦ neck strap

For permanent wearers and patients with tracheal stenosis.



**REF 103**



**TRACOE *comfort* Tracheostomy Tube,**  
fenestrated

Including: ♦ inner cannula, fenestrated, with slide-on speaking valve type A (silver valve holder)  
♦ inner cannula with low profile  
♦ neck strap

For tracheostomized patients with fully or partially intact larynx, for phonation.



**REF 103-O**



**TRACOE *comfort* Tracheostomy Tube,**  
fenestrated with oxygen supply port attached to  
the inner cannula

Including: ♦ inner cannula, fenestrated, with slide-on speaking valve type A (silver valve holder) and oxygen supply port  
♦ inner cannula with low profile  
♦ neck strap

For tracheostomized patients with fully or partially intact larynx, for phonation. Made upon order.



**REF 103-A**



**TRACOE *comfort* Tracheostomy Tube,**  
fenestrated

Including: ♦ inner cannula, fenestrated, with slide-on speaking valve type A (silver valve holder)  
♦ inner cannula with 15mm connector  
♦ inner cannula with low profile  
♦ neck strap

For tracheostomized patients with fully or partially intact larynx, for phonation.

**REF 203** **XL** 
**TRACOE *comfort* XL Tracheostomy Tube,**  
 fenestrated

Including: ♦ inner cannula, fenestrated, with slide-on speaking valve type A (silver valve holder)  
 ♦ inner cannula with low profile  
 ♦ neck strap

For tracheostomized patients with fully or partially intact larynx for phonation or, for example, with tracheal stenosis.

**REF 203-O** **XL** 
**TRACOE *comfort* XL Tracheostomy Tube,**  
 fenestrated with oxygen supply port attached to the inner cannula

Including: ♦ inner cannula, fenestrated, with slide-on speaking valve type A (silver valve holder) and oxygen supply port  
 ♦ inner cannula with low profile  
 ♦ neck strap

For tracheostomized patients with fully or partially intact larynx for phonation or, for example, with tracheal stenosis. Made upon order.

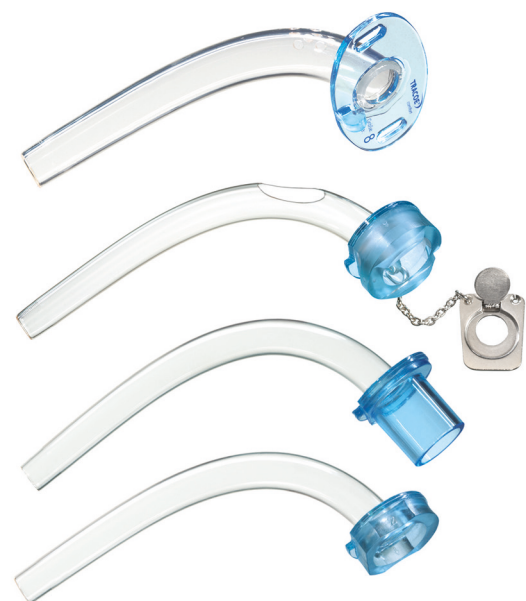
**REF 203-A** **XL** 
**TRACOE *comfort* XL Tracheostomy Tube,**  
 fenestrated

Including: ♦ inner cannula, fenestrated, with slide-on speaking valve type A (silver valve holder)  
 ♦ inner cannula with 15mm connector  
 ♦ inner cannula with low profile  
 ♦ neck strap

For tracheostomized patients with fully or partially intact larynx for phonation or, for example, with tracheal stenosis.



REF 103-A-O



**TRACOE *comfort* Tracheostomy Tube,**  
fenestrated with oxygen supply port attached to  
the inner cannula

Including: ♦ inner cannula, fenestrated, with slide-on  
speaking valve type A (silver valve holder)  
and oxygen supply port  
♦ inner cannula with 15mm connector  
♦ inner cannula with low profile  
♦ neck strap

For tracheostomized patients with fully or partially  
intact larynx, for phonation. Made upon order.



REF 104



**TRACOE *comfort* Tracheostomy Tube,**  
fenestrated

Including: ♦ inner cannula, fenestrated, with swivel  
speaking valve type B  
♦ inner cannula with low profile  
♦ neck strap

For tracheostomized patients with fully or partially  
intact larynx, for phonation.

**REF 204****XL****TRACOE *comfort* XL Tracheostomy Tube,**  
fenestrated

Including: ♦ inner cannula, fenestrated, with swivel  
speaking valve type B  
♦ inner cannula with low profile  
♦ neck strap

For tracheostomized patients with fully or partially  
intact larynx for phonation or, for example, with tracheal  
stenosis.



REF 104-A



**TRACOE *comfort* Tracheostomy Tube,**  
fenestrated

Including: ♦ inner cannula, fenestrated, with swivel speaking valve type B  
♦ inner cannula with 15mm connector  
♦ inner cannula with low profile  
♦ neck strap

For tracheostomized patients with fully or partially intact larynx, for phonation.



REF 104-A-O



**TRACOE *comfort* Tracheostomy Tube,**  
fenestrated with oxygen supply port attached to  
the inner cannula

Including: ♦ inner cannula, fenestrated, with swivel speaking valve type B and oxygen supply port  
♦ inner cannula with 15mm connector  
♦ inner cannula with low profile  
♦ neck strap

For tracheostomized patients with fully or partially intact larynx, for phonation. Made upon order.

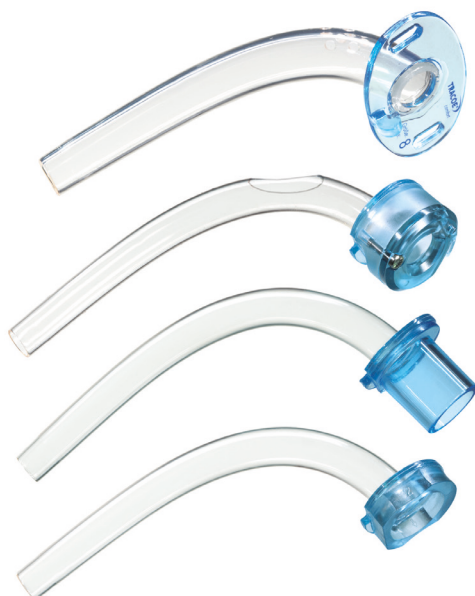

REF 204-A

XL

**TRACOE *comfort* XL Tracheostomy Tube,**  
 fenestrated

- Including:
- ◆ inner cannula, fenestrated, with swivel speaking valve type B
  - ◆ inner cannula with 15mm connector
  - ◆ inner cannula with low profile
  - ◆ neck strap

For tracheostomized patients with fully or partially intact larynx for phonation or, for example, with tracheal stenosis.



REF 204-A-O

XL

**TRACOE *comfort* XL Tracheostomy Tube,**  
 fenestrated with oxygen supply port attached to the inner cannula

- Including:
- ◆ inner cannula, fenestrated, with swivel speaking valve type B and oxygen supply port
  - ◆ inner cannula with 15mm connector
  - ◆ inner cannula with low profile
  - ◆ neck strap

For tracheostomized patients with fully or partially intact larynx for phonation or, for example, with tracheal stenosis. Made upon order.



## REF 105

### TRACOE *comfort* Tracheostomy Tube

Including: ♦ inner cannula with 15mm connector  
♦ neck strap



## REF 105-D

### TRACOE *comfort* Tracheostomy Tube

Including: ♦ 2 inner cannulas with 15mm connector  
♦ neck strap



## REF 115



### TRACOE *comfort* Tracheostomy Tube, fenestrated

Including: ♦ inner cannula, fenestrated,  
with 15mm connector  
♦ inner cannula with 15mm connector  
♦ neck strap



REF 205 | XL

**TRACOE *comfort* XL Tracheostomy Tube**

Including: ♦ inner cannula with 15 mm connector  
♦ neck strap



REF 215 | XL 

**TRACOE *comfort* XL Tracheostomy Tube,  
fenestrated**

Including: ♦ inner cannula, fenestrated,  
with 15 mm connector  
♦ inner cannula with 15 mm connector  
♦ neck strap



**REF 107**



**TRACOE *comfort* Tracheostomy Tube,  
fenestrated**

Including: ♦ inner cannula, fenestrated, with 22mm housing  
♦ inner cannula with 15mm connector  
♦ neck strap



**REF 108**



**TRACOE *comfort* Tracheostomy Tube,  
fenestrated**

Including: ♦ inner cannula, fenestrated, with swivel  
speaking valve type B  
♦ inner cannula, fenestrated, with 22mm housing  
♦ neck strap

For tracheostomized patients with fully or partially  
intact larynx, for phonation.



**REF 114**



**TRACOE *comfort* Tracheostomy Tube,  
fenestrated**

Including: ♦ inner cannula, fenestrated, with swivel  
speaking valve type B  
♦ inner cannula with 15mm connector  
♦ neck strap

For tracheostomized patients with fully or partially  
intact larynx, for phonation.

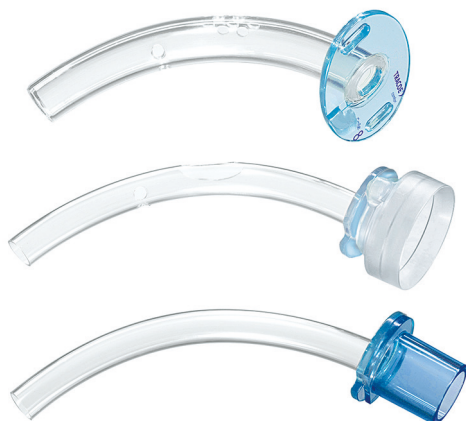
**REF 157** + 

**TRACOE *comfort plus* Tracheostomy Tube,**  
double fenestrated at inner and outer bend

Including: ♦ inner cannula, double fenestrated, with  
22mm housing  
♦ inner cannula with 15mm connector  
♦ neck strap

**REF 158** + 

**TRACOE *comfort plus* Tracheostomy Tube,**  
double fenestrated at inner and outer bend

Including: ♦ inner cannula, double fenestrated, with  
swivel speaking valve type B  
♦ inner cannula, double fenestrated, with  
22mm housing  
♦ neck strap

**REF 164** + 

**TRACOE *comfort plus* Tracheostomy Tube,**  
double fenestrated at inner and outer bend

Including: ♦ inner cannula, double fenestrated, with  
swivel speaking valve type B  
♦ inner cannula with 15mm connector  
♦ neck strap

For tracheostomized patients with fully or partially  
intact larynx, for phonation.

# Technical Data

## TRACOE *comfort*

REF 101, REF 102, REF 102-D, REF 103,  
REF 103-O, REF 103-A, REF 103-A-O,  
REF 104, REF 104-A, REF 104-A-O, REF 105,  
REF 105-D, REF 107, REF 108, REF 114  
REF 115

*in sizes 05 – 12*

*in sizes 05 – 14*

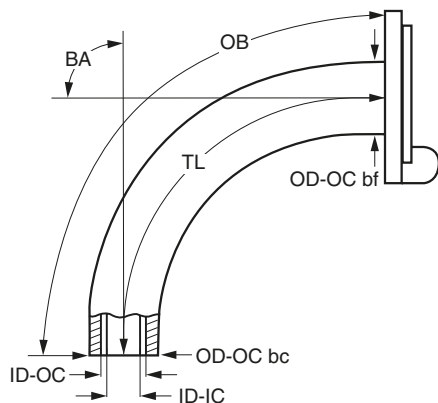

| Size | ID-OC<br>mm | OD-OC bc<br>mm | OD-OC bf<br>mm | ID-IC<br>mm | TL<br>mm | OB<br>mm | BA<br>° |
|------|-------------|----------------|----------------|-------------|----------|----------|---------|
| 05   | 5.0         | 6.7            | 8.7            | 4.0         | 52       | 57       | 90°     |
| 06   | 6.0         | 7.6            | 10.0           | 4.8         | 54       | 60       | 90°     |
| 07   | 7.0         | 8.8            | 10.5           | 5.8         | 57       | 65       | 90°     |
| 08   | 8.0         | 10.0           | 11.3           | 6.8         | 61       | 70       | 90°     |
| 09   | 9.0         | 11.4           | 12.6           | 7.6         | 65       | 75       | 90°     |
| 10   | 10.0        | 12.4           | 13.7           | 8.7         | 74       | 85       | 90°     |
| 11   | 11.0        | 13.1           | 15.0           | 9.7         | 76       | 87       | 90°     |
| 12   | 12.0        | 14.2           | 16.2           | 10.8        | 78       | 90       | 90°     |
| 13   | 13.0        | 15.4           | 17.2           | 11.8        | 87       | 100      | 90°     |
| 14   | 14.0        | 16.6           | 18.2           | 12.6        | 91       | 105      | 90°     |

**ID-OC:** inner diameter (clear width) at bottom of outer cannula; **OD-OC bc:** outer diameter at bottom of outer cannula;  
**OD-OC bf:** outer diameter of outer cannula behind the flange; **ID-IC:** inner diameter at bottom of inner cannula;  
**TL:** length along center line from start of neck flange to bottom of tube; **OB:** length along outer bend (greatest length);  
**BA:** bending angle

To order, specify: **REF + Size**, e.g., **REF 103-08**



Product variants can be made in order to optimize the functionality and wearing comfort and also for patients with complex anatomical and physiological conditions.

The corresponding ordering forms are available at:

[https://files.tracoe.com/005-comfort/attachment-to-order-comfort-2\\_2-en-032022.pdf](https://files.tracoe.com/005-comfort/attachment-to-order-comfort-2_2-en-032022.pdf)

# Technical Data and Scope of Supply

## TRACOE *comfort* XL

REF 202, REF 202-D, REF 203,  
REF 203-O, REF 203-A, REF 204,  
REF 204-A, REF 204-A-O, REF 205,  
REF 215

in sizes 05 – 12  
in sizes 05 – 14

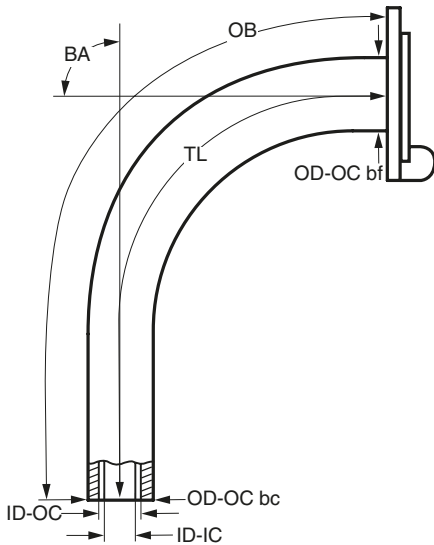

| Size | ID-OC<br>mm | OD-OC bc<br>mm | OD-OC bf<br>mm | ID-IC<br>mm | TL<br>mm | OB<br>mm | BA<br>° |
|------|-------------|----------------|----------------|-------------|----------|----------|---------|
| 05   | 5.0         | 6.6            | 9.0            | 4.0         | 85       | 92       | 90°     |
| 06   | 6.0         | 7.7            | 9.8            | 5.0         | 87       | 95       | 90°     |
| 07   | 7.0         | 8.7            | 10.5           | 6.0         | 93       | 100      | 90°     |
| 08   | 8.0         | 10.5           | 12.2           | 6.7         | 96       | 105      | 90°     |
| 09   | 9.0         | 11.5           | 13.0           | 7.5         | 100      | 110      | 90°     |
| 10   | 10.0        | 12.5           | 14.5           | 8.8         | 104      | 115      | 90°     |
| 11   | 11.0        | 13.5           | 15.5           | 9.2         | 108      | 120      | 90°     |
| 12   | 12.0        | 14.4           | 16.4           | 10.0        | 112      | 125      | 90°     |
| 13   | 13.0        | 15.4           | 18.0           | 11.8        | 116      | 130      | 90°     |
| 14   | 14.0        | 16.4           | 18.2           | 12.6        | 122      | 135      | 90°     |

## TRACOE *comfort* plus

REF 157, REF 158, REF 164

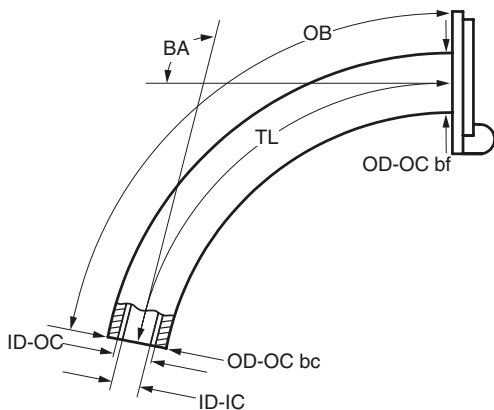

| Size | ID-OC<br>mm | OD-OC bc<br>mm | OD-OC bf<br>mm | ID-IC<br>mm | TL<br>mm | OB<br>mm | BA<br>° |
|------|-------------|----------------|----------------|-------------|----------|----------|---------|
| 07   | 7.0         | 8.8            | 10.5           | 5.8         | 81       | 87       | 100°    |
| 08   | 8.0         | 10.2           | 11.3           | 6.8         | 84       | 91       | 100°    |
| 09   | 9.0         | 11.6           | 12.6           | 7.6         | 86       | 94       | 100°    |
| 10   | 10.0        | 12.0           | 13.7           | 8.7         | 88       | 97       | 100°    |
| 11   | 11.0        | 13.5           | 15.0           | 9.7         | 91       | 100      | 100°    |

## Scope of Supply of TRACOE *comfort* Tubes

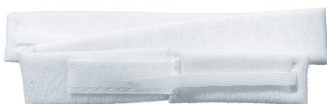

All TRACOE *comfort* tubes are supplied with a wide adjustable neck strap and a product info card with two detachable labels.

# Product Information and Specialities

## Distinguishing features of the speaking valves



### ◆ TRACOE *comfort* Speaking Valve, type A

TRACOE *comfort* tubes with type A speaking valves have a silver valve holder that is attached to the inner cannula with a chain. It can be detached from the inner cannula by sliding it out, if necessary. This allows free access to the inner lumen of the tube, for example, for suctioning off tracheal secretions.



### ◆ TRACOE *comfort* Speaking Valve, type B

The valve holder on TRACOE *comfort* tubes with speaking valve type B can be swiveled. This allows free access to the inner lumen of the tube, for example, for suctioning off tracheal secretions. A stopper blocks the opening of the cap as soon as the valve is swiveled to the side.

## Fenestration



### TRACOE *comfort*

Standard holes for phonation can be found on the outer bend of all outer cannulas.

### TRACOE *comfort plus*

The tubes are characterized by double fenestration: two additional phonation openings on the inner bend provide additional space for the exhaled air to reach the upper airways. The inner cannulas are correspondingly fenestrated.

## Special Features of the 15 mm Connector and 22 mm Housing



### ◆ 15 mm connector

Universal 15 mm connectors allow the use of heat/moisture exchangers and speaking valves.



### ◆ 22 mm housing

Universal 22 mm housing on inner cannulas give a more discreet appearance thanks to accessories with a flat profile, for example a flat speaking valve with silicone membrane (REF 650-S).

## Care of the Tubes

- ◆ use clean, lukewarm, potable tap water to rinse the tubes
- ◆ moisten the inner cannula with one drop (not more) of paraffin oil directly behind the flange



## Accessories and Cleaning Products for TRACOE *comfort* and *comfort plus* Tracheostomy Tubes



### REF 902

#### TRACOE *care* Liquid Paraffin

To be applied to the inner cannula to improve lubricity. Details of the product are given in the *care* product line on page 102.



### REF 930-A/-B

#### TRACOE tube clean Cleaning Kit with cleaning powder REF 932

Details of the product can be found in the *care* product line on page 100.

- ◆ All items from the cleaning set can also be ordered individually.



## Soft, Light, Transparent

TRACOE *larynx* is a product line intended to meet the needs of long-term tracheostomized or laryngectomized patients, in hospitals, rehabilitation, and clinical aftercare.

## The Range

TRACOE *larynx* stoma buttons and short cannulas made of soft flexible silicone have been specially developed for patients who no longer need a standard tracheostomy tube but still require a device to keep the stoma open. They also support speaking valves and/or HMEs.

# TRACOE®

*larynx*



All products in the TRACOE *larynx* line are DEHP-free.

Details and REF numbers of TRACOE heat/moisture exchangers and TRACOE speaking valves can be found in the TRACOE *modular* product line on page 76 onward.



**TRACOE *larynx* Silicone Short Tube**  
with 22 mm housing

**REF 580**

Length: ♦ 36mm  
Including: ♦ neck strap

**REF 582**

Length: ♦ 53mm  
Including: ♦ neck strap

Silicone short tubes are ideal for the use in stable tracheostomas to secure the respiratory tract once no tracheostomy tube is needed anymore.



**TRACOE *larynx* Silicone Short Tube**  
with 22 mm housing, fenestrated

**REF 581**



Length: ♦ 36mm  
Including: ♦ neck strap

**REF 583**



Length: ♦ 53mm  
Including: ♦ neck strap

For tracheostomized patients as well as laryngectomized patients with a voice prosthesis.



**TRACOE *larynx* stoma button**  
made of silicone

**REF 612**

Length: ♦ 22mm  
♦ in sterile package  
Sizes: ♦ 06 – 12

**REF 613**

Length: ♦ 30mm  
♦ in sterile package  
Sizes: ♦ 06 – 12

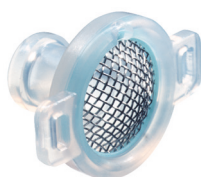
**REF 601**

**TRACOE grid button**  
short, made of silicone

Including: ♦ neck strap  
♦ in sterile package  
Sizes: ♦ 06 – 12

TRACOE grid button with eyes for attaching a neck strap and with a removable grid to prevent inhalation of foreign objects.

**REF 602**

**TRACOE grid button**  
standard, made of silicone

Including: ♦ neck strap  
♦ in sterile package  
Sizes: ♦ 06 – 12

TRACOE grid button with eyes for attaching a neck strap and with a removable grid to prevent inhalation of foreign objects.

**REF 603**

**TRACOE grid button**  
long, made of silicone

Including: ♦ neck strap  
♦ in sterile package  
Sizes: ♦ 06 – 12

TRACOE grid button with eyes for attaching a neck strap and with a removable grid to prevent inhalation of foreign objects.



### TRACOE button plus

Decannulation button made of silicone

#### REF 607-45

Length: ♦ 45mm  
ID: ♦ 8mm  
OD: ♦ 11mm  
Including: ♦ neck strap  
♦ in sterile package

#### REF 607-70

Length: ♦ 70mm  
ID: ♦ 8mm  
OD: ♦ 11mm  
Including: ♦ neck strap  
♦ in sterile package

For therapy of tracheostomized patients after long-term ventilation – for short-term securing of the airways after decannulation. Provides a tracheal seal and is dislocation-proof. The patient is able to cough up the stimulus secretion very fast. With the adjustable neck flange the TRACOE button plus can be positioned optimal to the soft neck tissue.

#### Caution, not suitable for:

- ♦ laryngectomized patients
- ♦ patients with unstable breathing
- ♦ patients who primarily breathe through the tracheostoma

# Technical Data and Scope of Supply

## TRACOE larynx Silicone Short Tubes

REF 580, REF 581, REF 582, REF 583

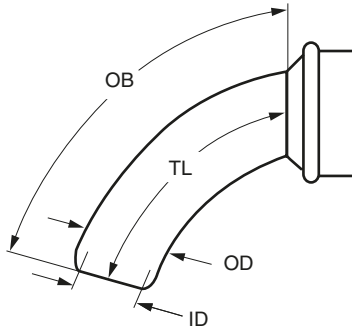

| Size | ID<br>mm | OD<br>mm | REF 580<br>REF 581 |          | REF 582<br>REF 583 |          |
|------|----------|----------|--------------------|----------|--------------------|----------|
|      |          |          | TL<br>mm           | OB<br>mm | TL<br>mm           | OB<br>mm |
| 08   | 9.5      | 12.0     | 36                 | 43       | 53                 | 62       |
| 09   | 10.5     | 13.5     | 36                 | 43       | 53                 | 62       |
| 10   | 12.0     | 15.0     | 36                 | 43       | 53                 | 62       |
| 12   | 13.5     | 17.0     | 36                 | 43       | 53                 | 62       |

## TRACOE larynx grid & stoma buttons

REF 601, REF 602, REF 603, REF 612, REF 613

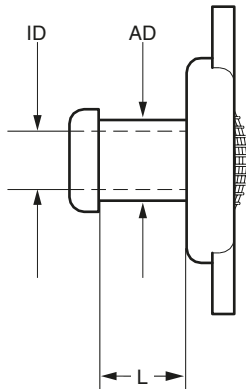

| Size | ID<br>mm | OD<br>mm | REF 601          | REF 602<br>REF 612  | REF 603<br>REF 613 |
|------|----------|----------|------------------|---------------------|--------------------|
|      |          |          | short<br>L<br>mm | standard<br>L<br>mm | long<br>L<br>mm    |
| 06   | 6        | 9        | 16               | 22                  | 30                 |
| 07   | 7        | 10       | 16               | 22                  | 30                 |
| 08   | 8        | 11       | 16               | 22                  | 30                 |
| 09   | 9        | 12       | 16               | 22                  | 30                 |
| 10   | 10       | 13       | 16               | 22                  | 30                 |
| 11   | 11       | 14       | 16               | 22                  | 30                 |
| 12   | 12       | 15       | 16               | 22                  | 30                 |

**ID:** inner diameter; **OD:** outer diameter of tube; **TL:** length along center line;  
**OB:** length along outer bend; **L:** length

To order, specify: **REF + Size**, e.g., **REF 601-08**

## Scope of Supply of TRACOE larynx Products

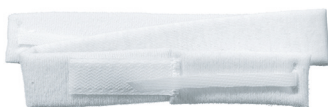

All TRACOE larynx silicone short tubes, grid buttons and button plus products are supplied with a wide adjustable neck strap and a product info card with two detachable labels.



## Modular System

Depending on the requirements and indications, TRACOE speaking valves and heat/moisture exchangers can be attached to different support systems with 15 mm connectors or 22 mm housings. This modular system for tracheostomy tubes, TRACOE *larynx* stoma buttons, short tubes, and adhesive carriers allows personalized solutions for individual patients.

## Speaking Valves

The TRACOE phon assist I speaking valve is used by tracheostomized patients and, thanks to its infinitely adjustable airway resistance, offers new therapeutic options, e.g. for weaning from ventilation, stimulation of the oropharyngeal region, and voice finding for children using 'Find the Voice'. Now also available in orange. The bright orange color is unmistakable and immediately distinguishes the speaking valve from other attachments.



## Heat/Moisture Exchangers (HME)

The TRACOE phon assist II speaking valve offers laryngectomized patients with a voice prosthesis and tracheostomized patients the possibility of handsfree phonation. Both valves can be individually adjusted by the patient.

TRACOE humid assist I to IV and the TRACOE humid assist *kids* are a variety of heat/moisture exchangers (HMEs) that act like an 'artificial nose' to filter, warm, and moisten inhaled air.

# Accessories for 15 mm Connector

## Speaking Valves

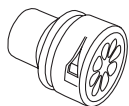

**REF 650-T**

**TRACOE phon assist I**

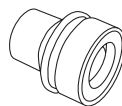

**REF 655-T**

**TRACOE phon assist II**

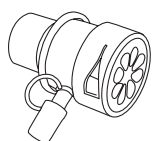

**REF 650-TO**

**TRACOE phon assist I**  
with oxygen supply port

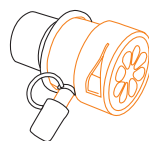

**REF 650-TO-C**

**TRACOE phon assist I**  
In a bright orange color and with oxygen supply port

## Occlusion Cap

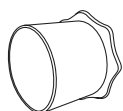

**REF 516**

**TRACOE modular Occlusion Cap**

Products listed here are intended for use with (fenestrated or unfenestrated) tracheostomy tubes with a 15 mm connector. If a cuffed tube is being used, the cuff must be deflated before a speaking valve or occlusion cap is attached.

## Heat/Moisture Exchangers (HME)

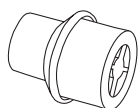

**REF 640-CT**

**TRACOE humid assist I**

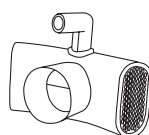

**REF 641**

**TRACOE humid assist III**

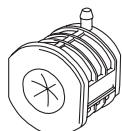

**REF 642**

**TRACOE humid assist IV**



**REF 643**



**TRACOE humid assist kids**

# Accessories for 22mm housing

## Speaking Valves



**REF 650-S**

**TRACOE phon assist I**

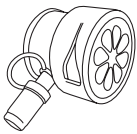

**REF 650-SO**

**TRACOE phon assist I  
with oxygen supply port**

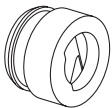

**REF 655-S**

**TRACOE phon assist II**

## Stoppers

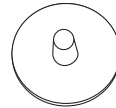

**REF 621**

**TRACOE modular Stopper**

All the speaking valves and stoppers illustrated here can be fitted to fenestrated short silicone tubes, tracheostomy tubes, stoma, and grid buttons, and the adhesive carrier with 22 mm housing.

## Heat/Moisture Exchangers (HME)

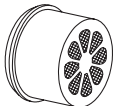

**REF 640-S**

**TRACOE humid assist I**

## Heat/Moisture Exchanger for Speaking Valve REF 655-T and REF 655-S

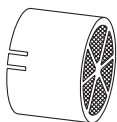

**REF 645**

**TRACOE humid assist II**

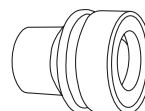

**REF 655-T**

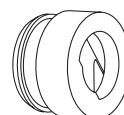

**REF 655-S**

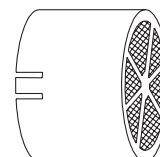

**REF 645**

This heat/moisture exchanger is intended exclusively for use with the handsfree speaking valves REF 655T and REF 655S.



REF 650-T



**TRACOE phon assist I Speaking Valve**

with air supply from the side, infinitely adjustable, for attachment to any fenestrated tube with 15 mm connector

- Packaging unit:
- ◆ 1 unit
  - ◆ in sterile package

**Caution: Not for use by laryngectomized patients!**



REF 650-TO



**TRACOE phon assist I Speaking Valve**

with oxygen supply port and air supply from the side, infinitely adjustable, for attachment to any fenestrated tube with 15 mm connector

- Packaging unit:
- ◆ 1 unit,
  - ◆ 5 units, under REF 650-TO-5
  - ◆ sterile, individually packaged

Including: ◆ adapter for oxygen supply

**Caution: Not for use by laryngectomized patients!**



REF 650-TO-C



**TRACOE phon assist I Speaking Valve**

in a bright color, with oxygen supply port and air supply from the side, infinitely adjustable, for attachment to any fenestrated tube with 15 mm connector

- Packaging unit:
- ◆ 1 unit
  - ◆ 5 units, under REF 650-TO-C-5
  - ◆ sterile, individually packaged
- Including: ◆ adapter for oxygen supply

**Caution: Not for use by laryngectomized patients!**



Learn more in our product video on our YouTube channel: <https://bit.ly/3GZD3Hv>



REF 650-S

**TRACOE phon assist I Speaking Valve**

with air supply from the side, infinitely adjustable, with flat base for attachment to any fenestrated silicone short tube, tracheostomy tube, stoma & grid buttons and adhesive carrier with 22 mm housing

Packaging unit:     ♦ 1 unit  
                              ♦ in sterile package

**Caution: Not for use by laryngectomized patients!**



REF 650-SO

**TRACOE phon assist I Speaking Valve**

with oxygen supply port and with air supply from the side, infinitely adjustable, with flat base for attachment to any fenestrated silicone short tube, tracheostomy tube, stoma & grid buttons and adhesive carrier with 22 mm housing

Packaging unit:     ♦ 1 unit  
                              ♦ in sterile package  
 Including:           ♦ adapter for oxygen supply

**Caution: Not for use by laryngectomized patients!**

## Speaking and Therapy Valve

Airway resistance can be adjusted individually thanks to the infinitely adjustable side openings. Exhalation is partly through the side openings and partly through the natural airway. The more the side openings are closed, the more the patient breathes through the natural airway. The phon assist I Speaking Valves, REF 650TO, REF 650TOC and REF 650SO, allow the additional administration of oxygen when required.

## Examples of Use

- ♦ to reduce airtrapping during weaning from the ventilator:  
by individually adjusting the side openings, expiration can be made easier for the patient.
- ♦ in early rehabilitation, to stimulate of the oropharyngeal region,  
i.e. to stimulate the swallowing reflex.
- ♦ for phonation with a tracheostomy tube in situ (fenestrated or unfenestrated and with deflated cuff).
- ♦ 'Find the Voice' – allowing adjustment of the side openings  
during phonation (particularly useful for children).



REF 655-T



**TRACOE phon assist II Hands-free Speaking Valve**  
infinitely adjustable, for attachment to any fenestrated tube with 15 mm connector

- Packaging unit: ♦ 1 unit  
Including: ♦ 5 units TRACOE humid assist II (REF 645)  
♦ sterile, individually packaged

**Caution: After laryngectomy only to be used in conjunction with a voice prosthesis!**



REF 645

**TRACOE humid assist II Heat/Moisture Exchanger**  
with foam filter for attaching to the TRACOE phon assist II Hands-free Speaking Valves REF 655-T and REF 655-S only

- Packaging unit: ♦ 50 units  
♦ sterile, individually packaged



REF 516

**TRACOE modular Occlusion Cap**  
for attachment to any fenestrated tube with 15 mm connector

- Packaging unit: ♦ 5 units  
♦ sterile, individually packaged

**Caution: Not for use by laryngectomized patients!**



## REF 655-S

**TRACOE phon assist II Hands-free Speaking Valve**

infinitely adjustable, with flat base for attachment to any fenestrated silicone short tube, tracheostomy tube, stoma & grid buttons and adhesive carrier with 22 mm housing

- Packaging unit: ♦ 1 unit  
 Including: ♦ 5 units TRACOE humid assist II (REF 645)  
 ♦ sterile, individually packaged

**Caution: After laryngectomy only to be used in conjunction with a voice prosthesis!**

**Examples of use for REF 645**

REF 645 + REF 655-T



REF 645 + REF 655-S

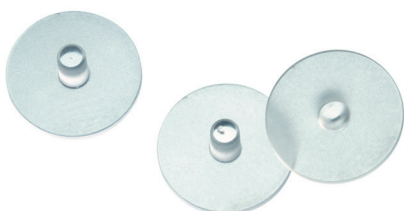

## REF 621

**TRACOE modular Stopper**

to temporarily seal stoma & grid buttons and fenestrated silicone short tubes in patients with unobstructed upper airways and unrestricted breathing

- Packaging unit: ♦ 5 units  
 ♦ in sterile package

**Caution: Not for use by laryngectomized patients!**



#### REF 640-CT

##### **TRACOE humid assist I Heat/Moisture Exchanger**

with foam filter for attachment to any tracheostomy tube with 15 mm connector

Packaging unit:     ♦ 50 units  
                             ♦ sterile, individually packaged

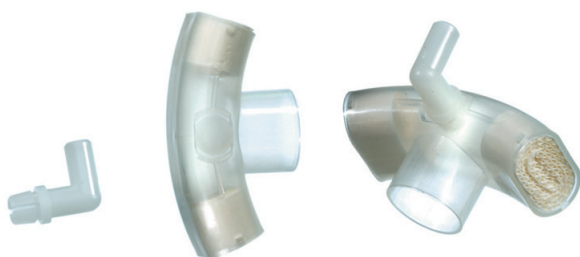

#### REF 641

##### **TRACOE humid assist III Heat/Moisture Exchanger**

with paper filter, optional 360° turnable oxygen supply port, for attachment to any tracheostomy tube with 15 mm connector

Packaging unit:     ♦ 50 units  
                             ♦ individually packaged



#### REF 642

##### **TRACOE humid assist IV Heat/Moisture Exchanger**

with foam filter, integrated oxygen supply port and pressure control valve for expectoration of larger quantities of secretion, for attachment to any tracheostomy tube with 15 mm connector

Packaging unit:     ♦ 30 units  
                             ♦ individually packaged



REF 643



**TRACOE humid assist *kids* Heat/Moisture Exchanger**  
with paper filter, for attachment to any pediatric tube  
with 15 mm connector, to be used in children with tidal  
volume of 7.5 to 50 ml

Packaging unit:      ♦ 50 units  
                             ♦ sterile, individually packaged



REF 640-S

**TRACOE humid assist I Heat/Moisture Exchanger**  
with foam filter and flat base for attachment to  
silicone short tubes, tracheostomy tubes and  
stoma & grid buttons with 22 mm housing

Packaging unit:      ♦ 50 units  
                             ♦ sterile, individually packaged

**For patients with or without voice prosthesis.**



## Cuff Pressure Management

TRACOE *technic* refers to medical devices that allow the pressure in the cuffs of tracheostomy and endotracheal tubes to be set or independently regulated with great precision.

Why is it so important that the cuff is always properly inflated? For one reason, to ensure adequate ventilation at all times.

For another, to prevent silent aspiration, which may sometimes lead to nosocomial ventilator-associated pneumonia (VAP). It also prevents damage to the trachea, for example mucosal necrosis, destruction of cartilage and tracheomalacia.

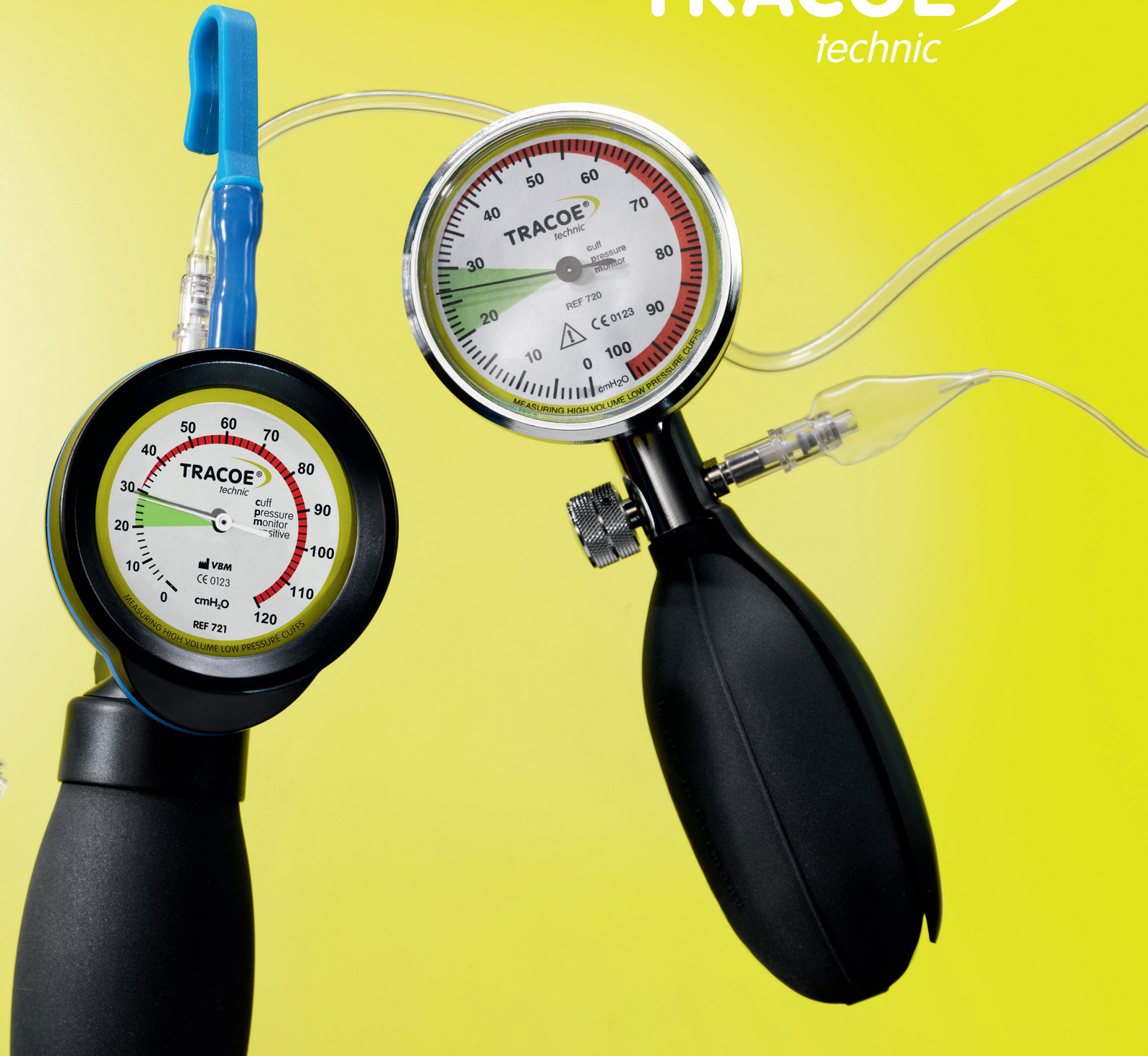

## Two Systems, One Goal

TRACOE *technic* includes two ways of regularly checking the cuff pressure. First, the TRACOE cuff pressure monitor (cpm and cpms) handheld manometers, featuring large easy-to-read dials for quick straightforward measurements. The usual pressure range is marked in green.

Or secondly, the TRACOE smart Cuff Manager, which offers a new benchmark in patient safety by continuous regulation of the pressure in the cuff. It is simple to use and the visual confirmation of optimal cuff pressure assists nursing staff in both hospitals and community settings.



**REF 730-5**

### TRACOE smart Cuff Manager

Packaging unit: ◆ 5 units  
◆ sterile, individually packaged

The TRACOE smart Cuff Manager monitors and regulates the internal pressure of low-pressure cuffs (High-Volume Low-Pressure Cuffs) of tracheostomy tubes as well as endotracheal tubes.

The pressure is maintained between 20 and 30 cmH<sub>2</sub>O. Visual verification of the cuff pressure is indicated by the inflation level of the blue buffer balloon of the TRACOE smart, which should be inflated between 2/3 and 3/4. Additional checks of the cuff pressure may be performed with a cuff pressure manometer (e.g. TRACOE cpm REF 720). Is the cuff pressure too low, the TRACOE smart Cuff Manager refills the cuff quickly to its appropriate pressure.

Short high-pressure peaks e.g. due to coughing will be tolerated by the integrated damping function which inhibits that air escapes instantly from the cuff. The solid shell of the TRACOE smart protects the highly elastic blue balloon from unwanted compression.

TRACOE smart is a latex- and DEHP-free, single patient product with a useful life of 29 days after opening.

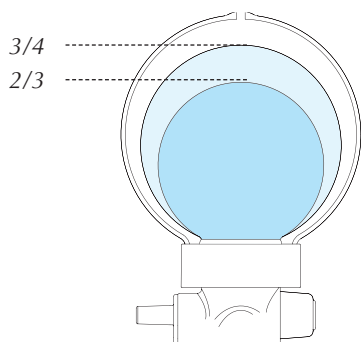

Learn more in our product videos on our YouTube channel: <https://bit.ly/3H2jA90>

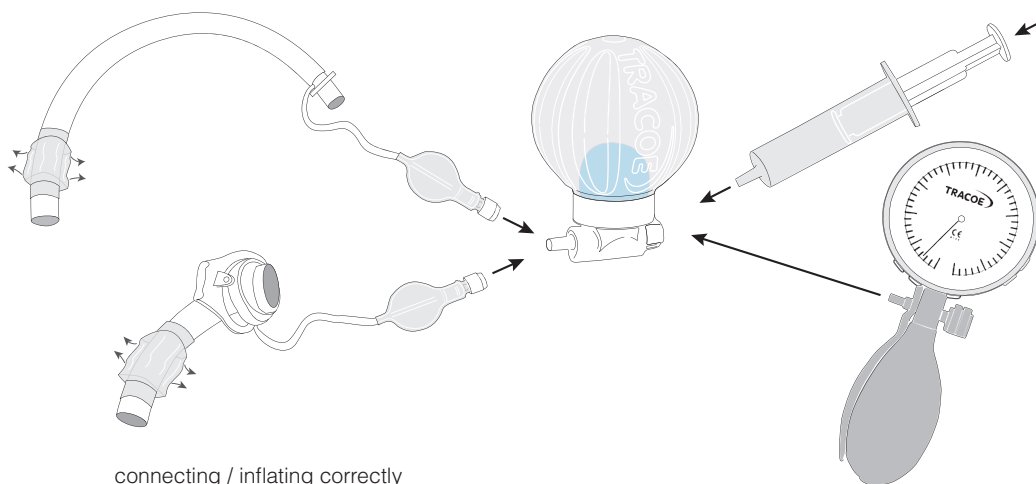

connecting / inflating correctly

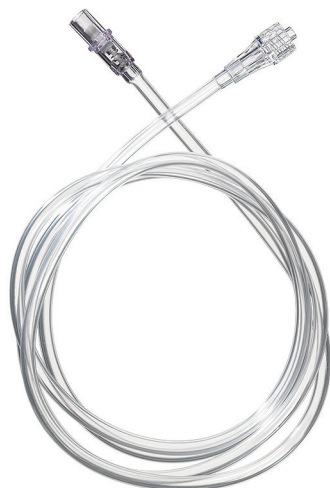
**REF 702****TRACOE *technic* Connecting Tube**

1 m length with check valve

- Length:                   ◆ 1 m  
Packaging unit:       ◆ 10 units  
                              ◆ sterile, individually packaged

Tubes for connecting the TRACOE cpm REF 720, TRACOE cpms REF 721 or TRACOE smart Cuff Manager REF 730-5 to a tracheostomy or endotracheal tube with Luer Lock connectors.

**i**

The subglottic secretion suction with the aim to reduce the VAP rate of patients with an expected ventilation period of more than 72 hours was classified as category IA of the recommendations by the German Commission for Hospital Hygiene and Infectious Disease Prevention (guidelines for hospital hygiene and infection prevention issued by the Robert Koch Institute, KRINKO)\*. The recommendation specifies that the cuff pressure level should be set between 20 and 30 cmH<sub>2</sub>O and checked at regular intervals. The recommendation is part of category IB. When these two actions are taken in combination, they can help to reduce the incidence of pneumonia.

\*Prevention of nosocomial ventilator-associated pneumonia (KRINKO), German Federal Health Gazette 2013 – 56:1578-1590



## REF 720

### TRACOE cuff pressure monitor (cpm)

Packaging unit: ♦ 1 unit  
Including: ♦ 1 connection tube REF 702

The TRACOE cuff pressure monitor (cpm) is used to fill and monitor the pressure of high-volume low-pressure cuffs of tracheostomy and endotracheal tubes.

Its outstanding features and benefits:

- ♦ easy use
- ♦ precise, reproducible pressure indication
- ♦ extra-large, easy-to-read scale from 0 – 100 cmH<sub>2</sub>O
- ♦ widely spaced scale markings with color-coded pressure ranges
- ♦ stable metal hook for attachment



## REF 721

### TRACOE cuff pressure monitor sensitive (cpms)

Packaging unit: ♦ 1 unit  
Including: ♦ 1 connection tube REF 702

The TRACOE cuff pressure monitor sensitive (cpms) is used to fill and monitor the pressure of low-pressure cuffs (High-Volume Low-Pressure Cuffs) of tracheostomy and endotracheal tubes.

Its outstanding features and benefits:

- ♦ easy and safe in- and deflation
- ♦ precise, reproducible pressure indication
- ♦ easy-to-read scale with green color-coded pressure range between 20 and 30 cmH<sub>2</sub>O (from 0 – 120 cmH<sub>2</sub>O)
- ♦ stable/solid and flexible fastening hook
- ♦ vacuum valve for deflation

**REF 725**

**TRACOE high-pressure inflation device**

Packaging unit: ♦ 1 unit

The TRACOE high-pressure inflation device is recommended for filling and emptying the balloon and for monitoring the pressure in the balloon during dilatation procedures.

Components:

- ♦ ratchet lever to control the piston
- ♦ pressure gauge with scale marked in intervals of 1 bar
- ♦ connection tube with rotatable adapter

The disposable plastic instrument is delivered sterile and must be used only with liquid inflation media. It is intended for single use in one patient only.

**Caution: Not suitable for use with low-pressure cuffs (High-Volume Low-Pressure Cuffs)!**



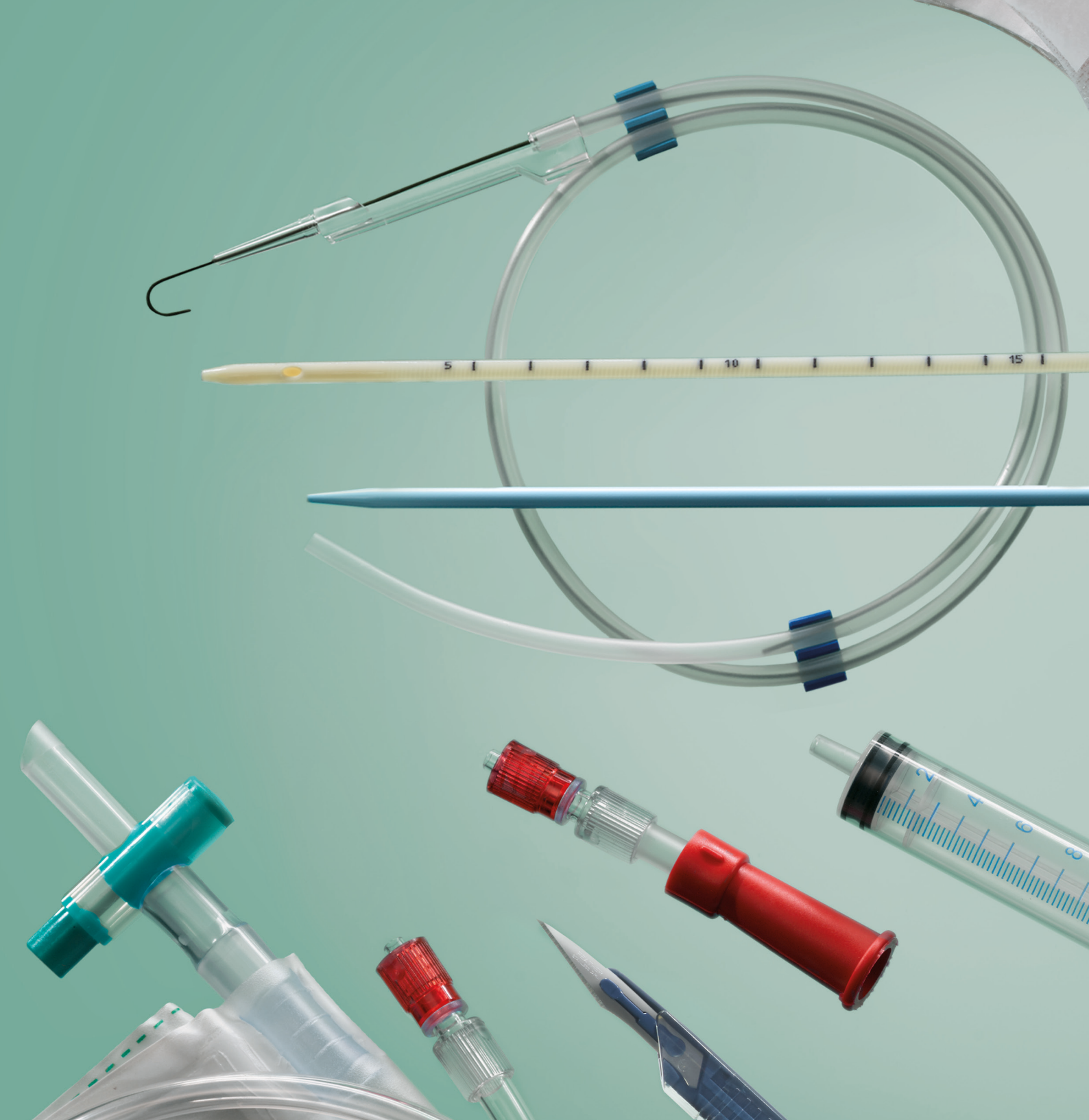

## Superlative Quality

The name of TRACOE medical has always stood for uncompromising quality, in-house Research and Development, and superior craftsmanship. Year by year, we are improving our skills and have developed a meticulous eye for detail, bringing added value for both doctors and patients.

With the same stringent approach, we are opening up our product portfolio and, after careful examination of external know-how, we can now offer you even more products than in the field of tracheostomy and laryngectomy. You will find selected medical devices that meet our firm concepts of quality and user-friendliness listed in the TRACOE *select* product range.



# TRACOE<sup>®</sup>

*select*

## Trust is the Key

We will be including products that have proved themselves in routine clinical practice, as we want you and your patients to have nothing but the best – just as you are accustomed to when using our products.

We have already found two such products in the TRACOE aeris<sup>®</sup> Balloon Dilatation Catheter and the TRACOE Seldinger Pleural Drainage Set.

## Open to New Ideas and Products

An open exchange with physicians and hospitals has made us aware of your incentives and requirements and, with *select*, we are responding to both your individual and collective needs.

TRACOE *select*: always one step ahead!



## REF 820

### TRACOE aeris® Balloon Dilation Catheter

Packaging unit: ♦ 1 unit

The TRACOE aeris Balloon Dilatation Catheter is intended for dilating airway strictures. Minimally invasive balloon dilatation is an efficient, atraumatic treatment method for soft stenoses.

The set is characterized by the following features:

- ♦ innovative non-slip design (two hubs distally and proximally at the ends of the balloon for fixation)
- ♦ absolutely precise, secure placement
- ♦ controlled radial dilatation
- ♦ maintenance of constant pressure against the stenosis

Color coding of the connections correspond to markers on the TRACOE high-pressure inflation device REF 725 to ensure the correct pressure settings.

Dilatation can be repeated several times in succession during the procedure. The balloon is filled using the TRACOE high-pressure inflation device REF 725, which is safe and easy to use.

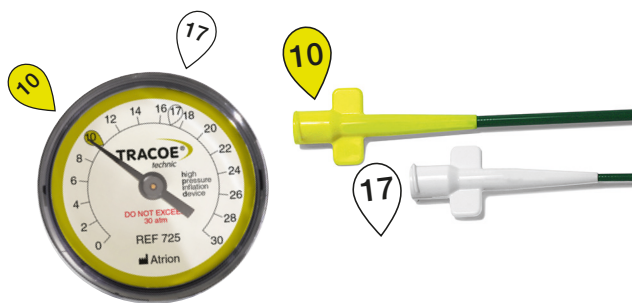

### Accessories for Inflating the TRACOE aeris® Balloon Dilation Catheter



## REF 725

**TRACOE high pressure inflation device**  
for use with the TRACOE aeris® balloon dilation catheter

Details of the product are given in the *technic* product line on page 91

### Technical Data

| Size | Balloon Size<br>(diameter x length) in mm | max. Inflation<br>Pressure<br>atm |
|------|---|-----------------------------------|
| 05   | 5 x 30                                    | 17                                |
| 06   | 6 x 30                                    | 17                                |
| 07   | 7 x 30                                    | 17                                |
| 08   | 8 x 30                                    | 17                                |
| 09   | 9 x 30                                    | 17                                |
| 10   | 10 x 30                                   | 17                                |
| 12   | 12 x 40                                   | 10                                |
| 14   | 14 x 40                                   | 10                                |
| 16   | 16 x 40                                   | 10                                |
| 18   | 18 x 40                                   | 10                                |

To order, specify: **REF + Size**, e. g. **REF 820-08**



Learn more in our product videos on our YouTube channel: <https://bit.ly/3t6OaZp>

REF 850

**TRACOE Pleural Drainage Set  
using the Seldinger Technique**

The Seldinger pleural catheter is used for draining pleural effusion and to relieve a pneumothorax.

- Packaging unit: ♦ 5 units
- Including:
- 1 drainage catheter with inner stylet, radiopaque, kink-resistant due to plastic spiral reinforcement, MR conditional, Luer Lock connector
  - 2 scalpel (11), single use
  - 3 syringe (10 ml)
  - 4 Tuohy puncture needle (1.2 x 1.5 x 90 mm, Gauge 17)
  - 5 coated Seldinger guide wire with nitinol core
  - 6 dilator with depth limiter
  - 7 fixation plaster
  - 8 3-way valve
  - 9 adapter from Luer Lock to funnel connector
  - 10 secretion bag (1.5 l) with Luer Lock connection

The set is characterized by the following features:

- ♦ kink-resistant, thin drainage catheter (12 Fr or 14 Fr ) with embedded plastic spiral reinforcement
- ♦ extra-soft catheter tip with three staggered openings
- ♦ Tuohy puncture needle
- ♦ Seldinger guide wire, kink-resistant due to nitinol core
- ♦ convenient thumb inserter
- ♦ maximum in situ useful life of 28 days
- ♦ radiopaque and MR conditional



Learn more in our product videos on our YouTube channel: <https://bit.ly/3t6OaZp>

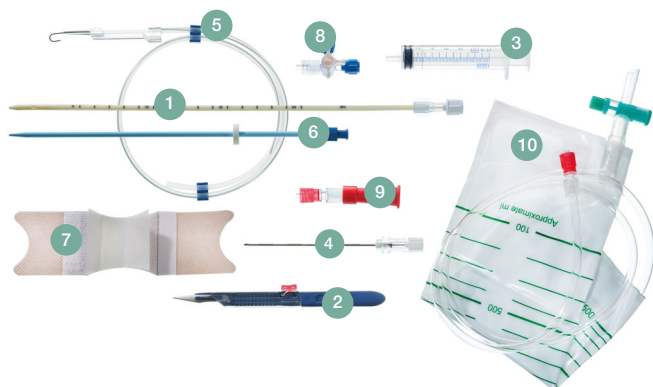



## Tracheostoma Management – as Comfortable as Possible

Tracheostomized and laryngectomized patients require aids that make living with a tube as comfortable as possible. A wide range of accessories is available for the best possible care of tracheostomy tubes and stomas.

Many items in the TRACOE *care* product line, such as neck straps and compresses, help in daily living with a TRACOE tracheostomy tube.



## Special Protection

Tracheal compresses can be used, for example, to provide padding between the tube and the stoma; they also absorb secretions coming from the stoma. Other products, such as special cleaning sets and brushes, help to maintain the extremely important high standards of hygiene. A well-cared tracheostoma ensures that the patient feels comfortable and reduces complications.

Bibs, scarves, and roll-necks can help to replace the missing protective and filtration functions of the nose. They protect the airways from dryness, cold, and dust, but also act as coverings to improve the patient's appearance.



## REF 903-B

### TRACOE care Neck Strap

white, padded, adjustable in length, with hook-and-loop fastener

- Packaging unit:
- ◆ 1 unit
  - ◆ 10 units under **REF 903-B-P**
- Dimensions:
- ◆ max. length approx. 45 cm
  - ◆ width of neck strap approx. 3 cm



## REF 903-D

### TRACOE care Neck Strap

white, padded, consists of two parts, adjustable in length, with hook-and-loop fastener

- Packaging unit:
- ◆ 1 unit
- Dimensions:
- ◆ max. length approx. 49 cm
  - ◆ width of neck strap approx. 2.5 cm



## REF 903-E

### TRACOE care Neck Strap

white, wide, consists of one part, with hook-and-loop fastener

- Packaging unit:
- ◆ 1 unit
  - ◆ 10 units under **REF 903-E-P**
- Dimensions:
- ◆ max. length approx. 42 cm
  - ◆ width of neck strap approx. 3.5 cm

**REF 903-F**
**TRACOE care Neck Strap**

white, consists of two parts, adjustable in length, with hook-and-loop fastener

- Packaging unit: ♦ 1 unit  
 ♦ 10 units under **REF 903-F-P**
- Dimensions: ♦ max. length approx. 43 cm  
 ♦ width of neck strap approx. 2.6 cm

**REF 903-G**

**TRACOE care Neck Strap**

white, padded, consists of two parts, adjustable in length, with hook-and-loop fastener, for neonates, infants, and children

- Packaging unit: ♦ 1 unit
- Dimensions: ♦ max. length approx. 29 cm  
 ♦ width of neck strap approx. 2.6 cm

**TRACOE care Neck Straps**

| Ordering Number    | max. Length (approx.)<br>cm | Width (approx.)<br>cm | Packaging Unit |
|--------------------|-----------------------------|-----------------------|----------------|
| <b>REF 903-B</b>   | 45                          | 3.0                   | 1 unit         |
| REF 903-B-P        | 45                          | 3.0                   | 10 units       |
| <b>REF 903-D</b>   | 49                          | 2.5                   | 1 unit         |
| REF 903-E          | 42                          | 3.5                   | 1 unit         |
| <b>REF 903-E-P</b> | 42                          | 3.5                   | 10 units       |
| REF 903-F          | 43                          | 2.6                   | 1 unit         |
| <b>REF 903-F-P</b> | 43                          | 2.6                   | 10 units       |
| REF 903-G          | 29                          | 2.6                   | 1 unit         |



## TRACOE tube clean Cleaning Kit with cleaning powder REF 932

### REF 930-A

- ◆ with 50 small cleaning swabs (REF 935)

### REF 930-B

- ◆ with 50 large cleaning swabs (REF 936)

Including: ◆ tube clean cleaning tub with mesh basket (REF 934)

For cleaning and maintaining tracheostomy tubes, stoma and grid buttons and the corresponding spare parts and accessories.



### REF 932

## TRACOE tube clean Cleaning Powder

Contents: ◆ 400 g

Cleaning powder for cleaning and maintaining tracheostomy tubes, stoma and grid buttons and the corresponding spare parts and accessories.

Approx. 80 applications, approx. 5 g/500ml water.



### REF 935

## TRACOE tube clean Cleaning Swabs small

Packaging unit: ◆ 50 units

Bendable plastic swabs with polyurethane sponge tip for cleaning tracheostomy tubes and inner cannulas with an inner diameter of 5 – 8 mm.  
For single use.



### REF 934

#### TRACOE tube clean Cleaning Tub with mesh basket

Volume: ♦ 1000 ml

For use with the solution, to clean tracheostomy tubes, stoma, and grid buttons and the corresponding spare parts and accessories.



### REF 933

#### TRACOE tube clean Concentrated Cleaning Liquid

Contents: ♦ 250 ml

Concentrated cleaning liquid for cleaning and maintaining tracheostomy tubes, stoma and grid buttons and the corresponding spare parts and accessories. The enzymes contained in it facilitate effective cleaning.



### REF 936

#### TRACOE tube clean Cleaning Swabs large

Packaging unit: ♦ 50 units

Bendable plastic swabs with polyurethane sponge tip for cleaning tracheostomy tubes with an inner diameter from 8 mm.  
For single use.



Find more information about our products on our website  
<https://en.tracoe.com/products/tracheostoma-management-cleaning-items>



## REF 938

### TRACOE tube clean Cleaning Brushes with microfiber tip

Packaging unit: ♦ 10 units

| Ordering<br>Number | Bristle<br>diameter<br>mm | for tubes<br>Inside Diameter<br>mm | approx.<br>Total Length<br>mm |
|--------------------|---------------------------|------------------------------------|-------------------------------|
| 938-A              | 7                         | 6                                  | 210                           |
| 938-B              | 9                         | 7/8                                | 210                           |
| 938-C              | 11                        | 9/10                               | 210                           |

Angled brushes with nylon bristles for removing incrustations. To reduce scratching, the brushes have a microfiber tip.



## REF 902

### TRACOE care Paraffin

Contents: ♦ 25 ml

Care product for TRACOE *comfort* tubes.  
For application to the inner cannula to improve lubricity.



## REF 677

### TRACOE care Lubricating Jelly

Packaging unit: ♦ 30 sachets each with 2.7 g  
♦ sterile

Before placing slightly coat the product with the lubricating jelly. The jelly is color- and odorless, greaseless, water-soluble and does not stick.



## REF 970

### TRACOE care Skin Cloth

Packaging unit: ♦ 50 units

For the daily cleaning and *care* of the skin around the tracheostoma. With a pH-value of 5.0 – 6.0 adapted to the skin.

**REF 940**
**TRACOE tube clean Cleaning Brushes**  
 flexible

Packaging unit: ♦ 10 units

| Ordering Number | Bristle diameter<br>mm | for tubes<br>Inside Diameter<br>mm | approx.<br>Total Length<br>mm |
|-----------------|------------------------|------------------------------------|-------------------------------|
| 940-A           | 7                      | 5/6                                | 315                           |
| 940-B           | 9                      | 7/8                                | 335                           |
| 940-C           | 11                     | 9/10                               | 360                           |
| 940-D           | 13                     | 11/12                              | 360                           |

Specially made for cleaning tracheostomy tubes. The wire used has a rounded tip and the bristles are made of nylon.

**REF 915**
**TRACOE care Shower Guard**

Silicone shower guard, contains no DEHP or latex. Soft, adjustable, and can be adapted to different-sized necks.

**Caution: May not be used for full-body bathing or swimming!**

**TRACOE care Tracheostoma Protection**
**REF 908**

Dimensions: ♦ approx. 6 x 6.5 cm

Packaging unit: ♦ 10 units

**REF 909**

Dimensions: ♦ approx. 7.2 x 7.2 cm

Packaging unit: ♦ 10 units

TRACOE tracheostoma protection prevents foreign objects from entering the healed tracheostoma. With adhesive strips, for single use. For adults and children.



### REF 905

#### TRACOE care Tracheal Compresses

aluminum coated, with zigzag slit

Dimensions: ♦ approx. 9 x 9.8 cm

Packaging unit: ♦ 10 units

The coating of the tracheal compresses minimizes sticking to the skin. For padding between stoma and tube, allowing absorption of secretions.



#### TRACOE care Tracheal Compresses

two-ply

### REF 907-A

without slit

### REF 907-B

with zigzag slit

Dimensions: ♦ approx. 9 x 10 cm

Packaging unit: ♦ 10 units

Two-ply tracheal compresses for padding between the stoma and the tube, allowing absorption of larger secretions.



#### TRACOE care Tracheal Compresses

### REF 910-A

without slit

### REF 910-B

with zigzag slit

Dimensions: ♦ approx. 9 x 10 cm

Packaging unit: ♦ 10 units

Tracheal compresses for padding between the stoma and the tube, allowing absorption of secretions.

**REF 957**



**TRACOE care Tracheal Compresses**

coated, two-ply, with zigzag slit

Dimensions: ♦ approx. 8 x 10 cm

Packaging unit: ♦ 10 units

The coating of the two-ply tracheal compresses minimizes sticking to the skin.

For padding between the stoma and the tube, allowing absorption of larger secretions.

**REF 960**



**TRACOE care Tracheal Compresses**

coated, with zigzag slit

Dimensions: ♦ approx. 8.2 x 10 cm

Packaging unit: ♦ 10 units

The coating of the two-ply tracheal compresses minimizes sticking to the skin. For padding between the stoma and the tube, allowing absorption of secretions.

**REF 961**



**TRACOE care Tracheal Compresses**

with zigzag slit, for neonates, infants, and children

Dimensions: ♦ approx. 6.5 x 6.3 cm

Packaging unit: ♦ 10 units

Tracheal compresses for padding between the stoma and the tube, allowing absorption of secretions.

The downward-facing opening of the zigzag slit minimizes the risk of accidental removal of the compress.



## REF 969

### TRACOE softpad Tracheostomy Stoma Pads oval

- Dimensions: ♦ approx. 5.8 cm x 3.6 cm  
Packaging unit: ♦ 20 units  
♦ sterile, individually packaged

Oval tracheostomy stoma pads made of absorbent, open-pored polyurethane foam.



### TRACOE purofoam Tracheostomy Compresses with zigzag slit

## REF 958 large

- Dimensions: ♦ approx. 9 x 10 x 0.5 cm  
Packaging unit: ♦ 10 units  
♦ sterile, individually packaged

For tracheostomy tube sizes 06 – 12.



## REF 959 small

- Dimensions: ♦ approx. 6.5 x 6.5 x 0.5 cm  
Packaging unit: ♦ 10 units  
♦ sterile, individually packaged

For tracheostomy tube sizes 03 – 05.



### Features of TRACOE purofoam Tracheostomy Compresses REF 958 and REF 959:

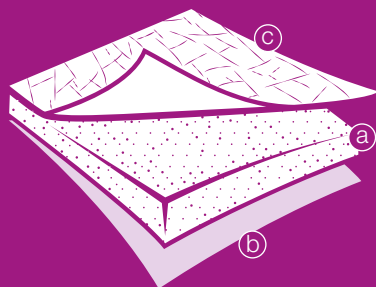

The TRACOE purofoam tracheostomy compresses are made of an absorbent open-pored polyurethane foam (a).

The surface layer of the compress that faces the skin allows the absorption of liquids into the foam's core (b). A net-like film stabilizes the purofoam compresses and thus reduces the deformation with strong secretion after the moisture absorption.

The outer side is covered with a beige coating which prevents leakage of secretion to the outside and reduces bacterial contamination (c).

Due to the circular opening and the zigzag slit the compress can be easily replaced with a new one whilst wearing the tracheostomy tube.

The TRACOE purofoam tracheostomy compresses are used for the wound care of recent or irritated tracheostomies as well as for covering healed but weeping tracheostomies. The compresses comply with the modern principles of moist wound treatment.

**TRACOE care Protective Bibs**

white

**REF 919-A** 3-ply

**REF 919-B** 6-ply



**REF 919-C** 12-ply

The protective bibs filter and warm the respiratory air. At the same time they protect clothes from possible secretions.

Made of polyester, with continuously adjustable hook-and-loop fastener.

**TRACOE care Protective Scarf**

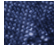
in different colors: gray plaid, beige plaid, dark green, dark blue, burgundy

**REF 921-A** 
**REF 921-D** 
**REF 921-B** 
**REF 921-E** 
**REF 921-C** 

Made of 100% viscose with integrated polyester layer. The TRACOE care protective scarf is worn around the neck like an average scarf and is secured with an continuously adjustable hook-and-loop fastener.



**TRACOE care Protective Roll-Necks**

in different colors: white, gray, beige, dark green, dark blue, burgundy, black

**REF 923-A** 
**REF 923-E** 
**REF 923-B** 
**REF 923-F** 
**REF 923-C** 
**REF 923-G** 
**REF 923-D** 

TRACOE care protective roll-necks are made of 100% cotton with an integrated polyester layer. They are worn underneath the shirt.

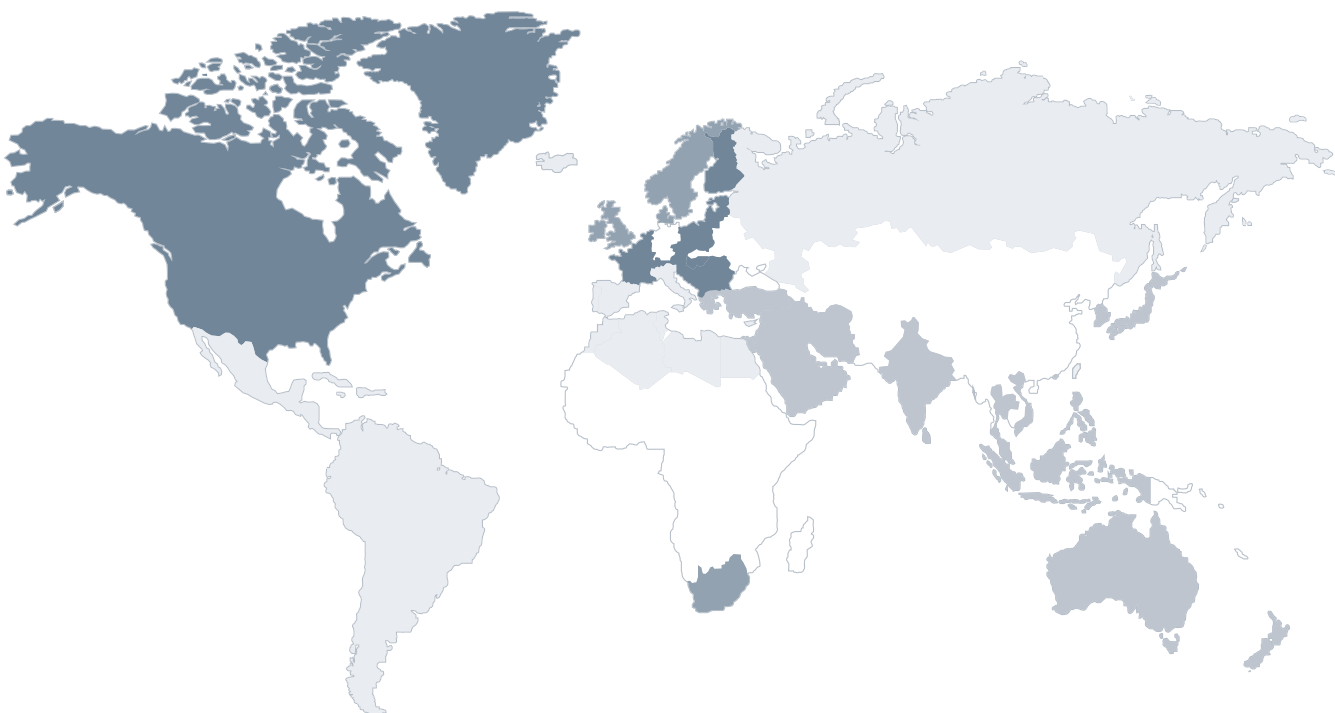
### Contact the TRACOE Product Specialist for your Country!



■ Eastern Europe, France, USA, Canada  
Mobile: +49 162 271 7004

■ Scandinavia, United Kingdom, South Africa, Ireland  
Mobile: +49 151 5500 4391

■ Australia, New Zealand, Asia, Japan, The Middle East  
Mobile: +49 175 904 1644

■ Italy, Spain, Portugal, Latin America, Northern Africa  
Mobile: +49 160 843 7917



**Any questions about orders or delivery?  
Please contact our customer service team at:**

International

☎ Phone: +49 6136 9169-320  
☎ Fax: +49 6136 9169-289  
✉ [order@tracoe.com](mailto:order@tracoe.com)

Germany

☎ Phone: +49 6136 9169-310  
☎ Fax: +49 6136 9169-288  
✉ [bestellung@tracoe.com](mailto:bestellung@tracoe.com)

## Visit our Website!

To obtain information easily and quickly about TRACOE products, new additions or general information, visit our website: <https://en.tracoe.com/>

Our media library contains useful videos about the use and cleaning of certain products: <https://en.tracoe.com/media-library>

You can also find us on Facebook and YouTube.



### Product Training

We will be happy to support you with seminars and workshops on special topics. Our website has details of contact persons in the hospital and community segments: <https://en.tracoe.com/services/leistungsuebersicht>

## Delivery

All TRACOE products are shipped directly ex stock. Non-sterile product variants are generally shipped within 14, sterile ones within 28 working days. Please note: Additional freight charges apply in cases of express deliveries and deliveries to addresses which differ from the address on the invoice.

## Returns

Returns of used products can be accepted only if accompanied by a completed decontamination certificate and a claim form. You can obtain the necessary certificate and form either directly from TRACOE medical or via our website: <https://en.tracoe.com/complaint>

## Tips for Everyday Use of TRACOE Tracheostomy Tubes

### Cleaning and Maintenance

The cleaning of tracheostomy tubes is described in the respective instructions for use. For example, the TRACOE tube clean cleaning kits (REF 930-A/-B or REF 931-A/-B) can be used for this purpose. Never use a strong household cleaning product, a denture cleanser, or strong alcohol to clean the tubes. Soften any solid incrustations and remove them using e.g. TRACOE tube clean cleaning swabs (REF 935 and REF 936). After cleaning, rinse the cannulas thoroughly with water in drinking water quality. Allow the inner and outer cannulas to air-dry.

### Hygiene

When the tracheostoma is stable, the tubes can be cleaned and maintained during replacement. Tubes should not be removed from new tracheostomies without the help of a guide technique. These procedures should be performed only under medical supervision or on a doctor's instructions. Please note that the tube must be taken out of the tracheostoma for cleaning. Care of the stoma depends on mucous accumulation, scab formation, and skin condition, but it should be cleaned at least twice a day. Use the TRACOE *care* protective skin cloth (REF 970) to clean the stoma. Use lint-free material only. Replace the compresses and neck straps regularly.

Select the widest, softest neck strap possible to prevent irritation from the neck strap cutting into the neck. The skin should always be clean and dry (neither desiccated nor waterlogged). If the area around the tracheostoma is chafed, the skin can be treated with appropriate care products according to the physician's orders. A tracheostoma being treated with radiation is often highly sensitive and should be cared for as instructed by your physician or healthcare personnel.



A working group from the Tracheostomy and Laryngectomy division at the German medical devices industry association (BVMed) has compiled two comprehensive brochures on the daily care and maintenance of tracheostomies, tracheostomy tubes, and the necessary accessories. They include details of the necessary measures, explain technical terms, and suggest further reading in the literature. You can find these brochures on our website:  
<https://files.tracoe.com/tracoe-allgemein/bvmed-versorgung-tracheotomierter-patienten.pdf>  
<https://files.tracoe.com/tracoe-allgemein/bvmed-versorgung-laryngektomierter-patienten.pdf>

### Protective Accessories

To prevent particles of dust and dirt, insects, or other objects from entering the trachea through the stoma, special protective articles are needed such as cloths, bibs, roll-necks, filters, etc. (see product lines TRACOE *modular* and TRACOE *care*).

### Suctioning Frequency

In the same patient the necessity to suction can vary from just a few times each day to up to a number of times an hour. It is important to use a high-quality suction device with suitable performance.

### Moistening

To prevent the formation of scab, the use of an "artificial nose" (e.g. TRACOE humid assist I, REF 640-CT) to keep the airways moist is recommended.

### Materials

TRACOE tracheostomy tubes are made from materials approved for medical use. They do not contain any latex or any softeners such as DEHP.

Products must be disposed of in accordance with national regulations for waste materials.

## Product Info Card

Most TRACOE products receive a product info card that contains important information for reordering and documentation. Two detachable labels on the front and rear side make paperwork like patient records easier. If the patient is discharged or transferred to a rehabilitation clinic, the product info card informs the medical staff taking over treatment of the product in question.

To meet the market demands of both today and tomorrow,

TRACOE medical uses the globally recognized GS1 labeling standards (Global Standards One), which is also reflected in the content of the product info card.

QR code containing all information on LOT and GTIN numbers, expiry date

order number and additional information

expiry date

production data

size data

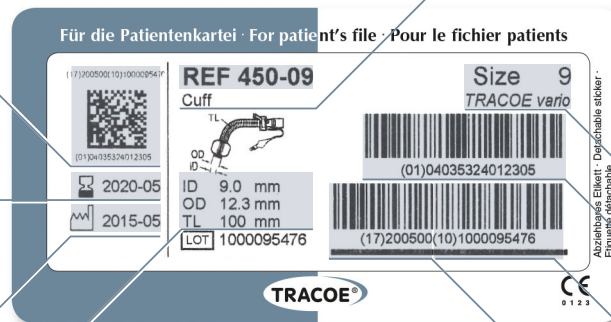

size and product line

GTIN - Global Trade Identification Number

LOT number

expiry date (YYMM00)

## News Service

In addition to our marketing material, TRACOE NEWSFLASH brings you the latest in-depth information on, for example, new products, changes, or particular aspects of the TRACOE medical product range, clearly summarized in just a few pages.

We will be happy to send you the TRACOE news by email, free and without obligation, as soon as we have anything of interest to report.



# TRACOE Worldwide



TRACOE medical distributes its high-quality products (most of them are 'Made in Germany') in more than 85 countries.

The TRACOE international sales team looks after its partners throughout the world. Competent advice and help are always at your service.



All official TRACOE distributors can be found on our website: <https://en.tracoe.com/services/worldwide>

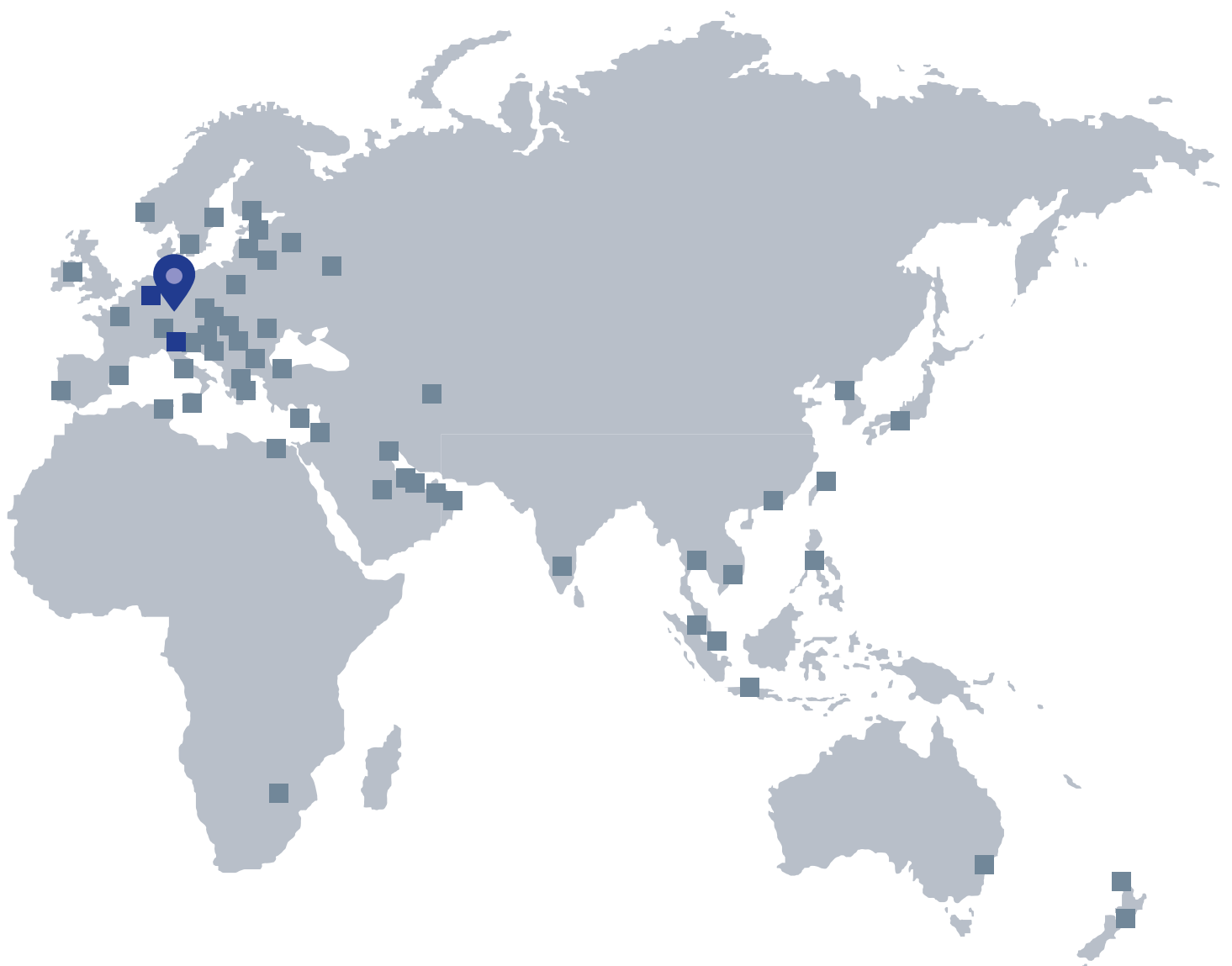

 TRACOE medical GmbH

 TRACOE Austria and MC Europe

 TRACOE distributors



TRACOE medical GmbH  
Reichelsheimer Str. 1 / 3  
55268 Nieder-Olm Germany

Tel.: +49 6136 9169--0

Fax: +49 6136 9169-200

[info@tracoe.com](mailto:info@tracoe.com)

[www.tracoe.com](http://www.tracoe.com)



TRACOE medical GmbH Austria  
Warwitzstrasse 9  
5020 Salzburg  
Austria

Tel.: +43 662 2612-6085

Fax: +43 662 2612-6095

[at.bestellung@tracoe.com](mailto:at.bestellung@tracoe.com)

[www.tracoe.com](http://www.tracoe.com)