

status of the procedure. Select and confirm the options displayed on the overlays. For example:

- Resume the procedure
- End the procedure with fluid return and with product transfer
- End the procedure with no fluid return or product transfer
- Shut down the instrument

Disconnect the Donor

To Disconnect the Line from the Donor

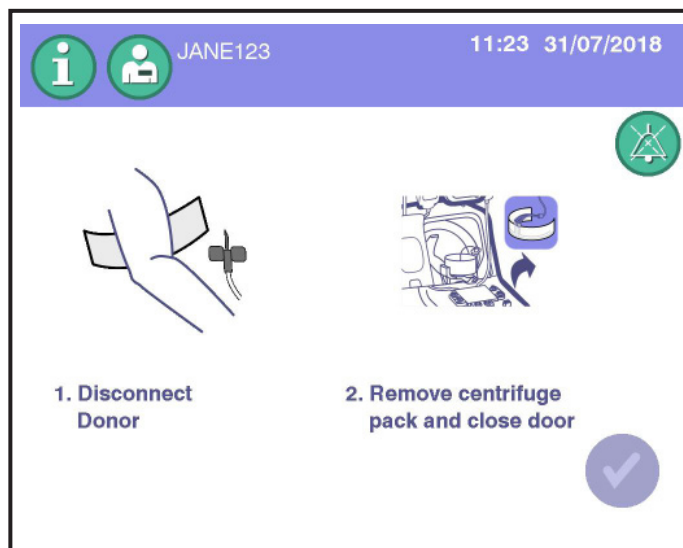

4.36 Typical Disconnect Donor Screen

1. When prompted to disconnect the donor, close the roller clamp on the donor line.
2. Follow your institutional SOPs for needle removal, needle disposal, and donor care.

(Optional) Removal of Apheresis Needle with MasterGuard Anti-Stick Protector

1. Upon completion of the procedure, place a hemostasis dressing over the venipuncture site according to your institutional SOPs. Remove tape.