 Franklin Electric	Technical data			Revision number	Page 1
	EV10/07 FI022 T5 E1				
Customer		Supplier			
Company name					
Dept.					
Editor					
Phone number					
Fax no.					
E-mail					
Operating data specification					
Pumped fluid	Water		Rated flow	m ³ /h	11
Solids	Kind		Nominal head	m	48
	Percentage of solid content	0	Geodetic head	m	0
pH value			Available system NPSH	m	
Temperature	°C	20	Inlet pressure (pin)	kPa	
Density	kg/m ³	998.3	Altitude above sea level	m	100
Kin. viscosity	mm ² /s	1.005			
Vapour pressure	kPa	2.34			
Pump					
Make	FELE		Impeller type	Radial impeller	
Pump type	EV10/07 FI022 T5 E1		Impeller construction	fabricated stainless steel	
Frame size			Impeller Ø	Max.	mm
Design	Vertical multistage			designed	mm
Impeller configuration	07			Min.	mm
Speed	1/min	2884.4	Flow	Nominal	m ³ /h
Max. operating pressure	kPa	695		Min.	m ³ /h
Max. diff. pressure	kPa	695		Max.	m ³ /h
Stages	7		Head	Nominal	m
No. of diffusers	1			Max.	m
				Min.	m
Suction port	Pressure rating	PN25/40	Shut off head		
	Nominal pipe size	DN40		m	70.9
	Standard	Round Flange		m	2.22
Discharge port	Pressure rating	PN25/40	Shaft power	kW	
	Nominal pipe size	DN40	Efficiency	%	
	Standard	Round Flange		68.3	
MATERIALS					
Pump				Shaft seal: E1 - BQE	
10.00 - Pump casing		1.4301 - AISI304		A - Stationary part	Graphite
10.02 - Drain plug		1.4301 - AISI304		B - Rotating part	Silicon carbide
10.06 - Upper flange		1.4301 - AISI304		C - Spring	AISI 316
20.00 Outer case		1.4301 - AISI304		D - Elastomers	EPDM
20.05 - Filling plug		1.4301 - AISI304			
30.00 - Pump shaft & Pin		1.4301 - AISI304			
30.01 - Cartridge mechanical seal					
30.02 - Mechanical seal fastening kit		1.4301 - AISI304			
30.03 - Kit O-Rings		EPDM			
40.00 - Stage housing and diffuser		1.4301 - AISI304			
40.01 - Stage centering outlet		1.4301 - AISI304			
40.02 - Floating neck ring		1.4301 - AISI304 / PPS			
40.03 - Initial stage housing		1.4301 - AISI304			
40.04 - Last stage with diffuser		1.4301 - AISI304			
40.06 - Stage housing and diffuser with bearing		1.4301 - AISI304 / Silicon Carbide			
50.00 - Impeller		1.4301 - AISI304			
50.01 - Impeller spacer		1.4301 - AISI304			
50.02 - Intermediate sleeve		Silicon carbide			
50.03 - Intermediate sleeve spacer		1.4301 - AISI304			
MOTOR					
LAFERT 230/400V 2.2kW					
Rated power	2.2	kW	Speed	2880 1/min	
Electric voltage	3~ 400	V	Electric current	4.6 A	
Degree of protection	IP 55		Number of poles	2	
Motor design	90 S B14				
Acoustic pressure level	62	dB			
Selection ref		Project		Creation software	Issue date
2025-1755EE7F				Spaix® 6-23.3 - 2024/03/06 (Buil	2025-03-25
					Last update
					2025-03-25

Customer

Supplier

 Company name
Dept.
Editor
Phone number
Fax no.
E-mail

Series EV

Impeller type

Radial impeller

Impeller construction

fabricated stainless steel

Sense of rotation

Clockwise from the drive end

Frequency

Hz

50 Hz

Speed

1/min

2884.4

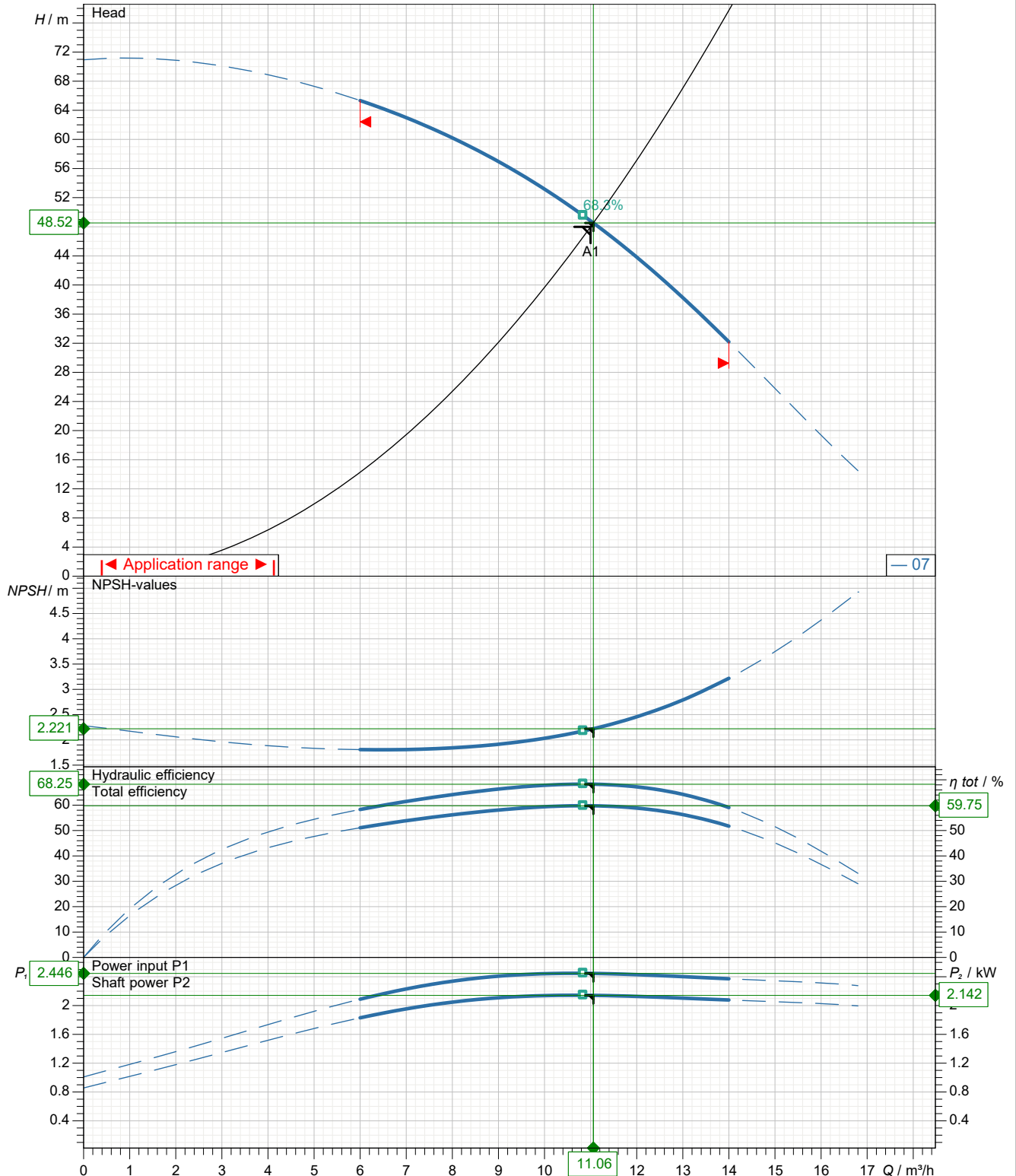

The hydraulic characteristics are guaranteed, according to ISO standard 9906:2012, grade 3B

Project

Creation software

Spaix® 6-23.3 - 2024/03/06 (Buil

Issue date

2025-03-25

Last update

2025-03-25



Customer

Supplier

Company name
Dept.
Editor
Phone number
Fax no.
E-mail

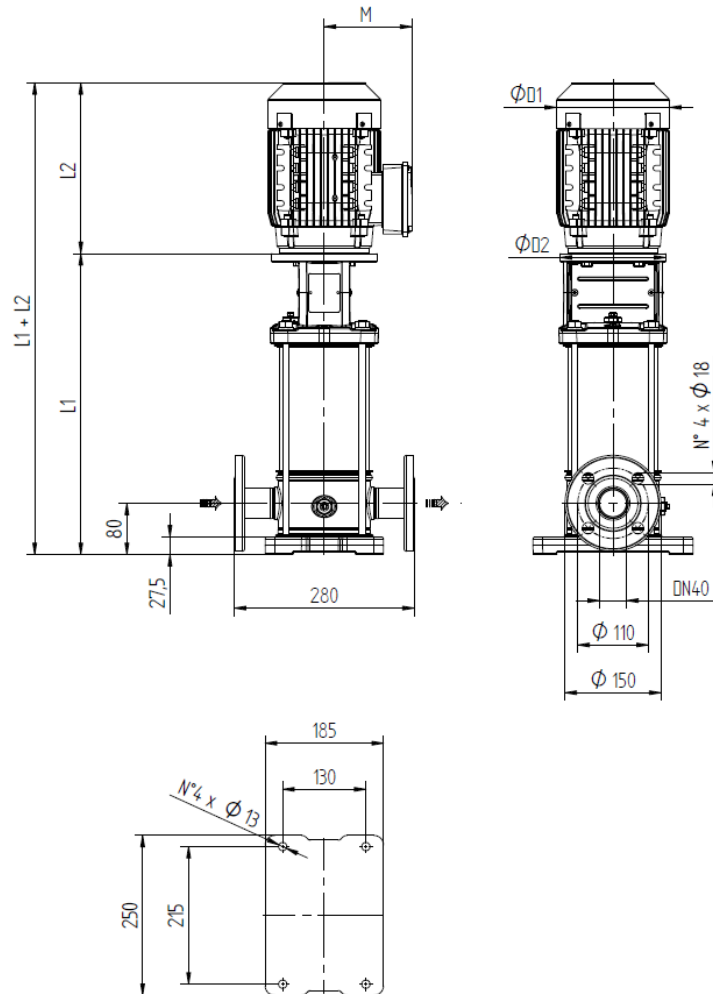
**Inlet / outlet**

Suction port
DN40
PN25/40

Discharge port
DN40
PN25/40

Dimensions

[mm]/[kg]

L1	500
L2	267
M	138
D1	180
D2	170
Pump weight	17.1
Motor weight	16
Electric pump weight	33.1

not to scale

Project

Creation software
Spaix® 6-23.3 - 2024/03/06 (Buil

Issue date
2025-03-25

Last update
2025-03-25