

**BR-120M**

BUCKY STAND

## Features

- 1 Patient-friendly and compact design**  
With the compact vertical dimension of only 552 mm and its lower cutout, the BR-120M Bucky unit easily examines sitting patients. It can also be lowered for effective knee and leg examinations.
- 2 Quick Cassette Changeover**  
The cassette tray makes it easy to insert and remove cassettes. It supports both the up-base and center-base positions. cm or inch size cassette based on IEC standard 60406.
- 3 World-first Automatic Exposure Control Detector with Four Pickup Fields**  
The Four Pickup Fields of the AEC can be independently selected and function for frontal and lateral exposure of the thorax and abdominal radiography in BR-120M. It assures optimal density of images during radiography of the thorax and abdomen.  
\* Four pickup fields detector is acceptable when the cassette is set at up-base position.
- 4 Extensive Options Enhance Detection Efficiency**  
A range of options facilitate examination, such as the PA radiography handle and the lateral radiography overhead hand support.

## Dimensions

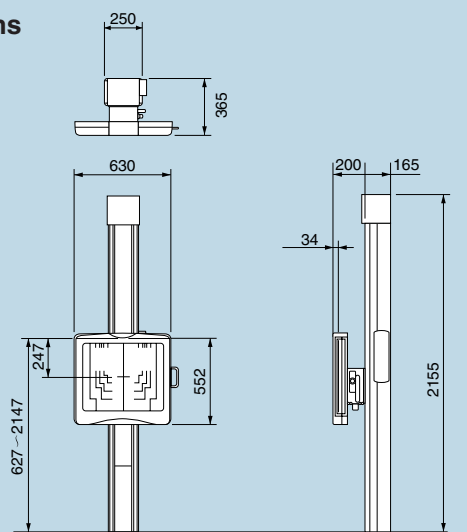

Unit: mm

## Specifications

Bucky upper edge to floor distance	627 to 2147 mm
Operation	Manual, electromagnetic lock
Bucky Unit	Oscillation type
Chin support to film upper edge distance	32 mm
Chin support to Bucky lower edge distance	552 mm
Film size	14" X 17" to 6 1/2" X 8 1/2"
	Vertical or horizontal
Cassette fixing position	Up-base or center-base
Direction of cassette tray mounting	Selectable as left or right during installation
Grid	
Grid ratio	12:1
Grid density	40 line/cm
Focal distance	170 cm
Spacer	Al
Size	479 X 438 mm
Ceiling height for installation	2350 mm min.
Power requirements (supplied from X-ray high-voltage generator)	Single-phase, 100 V, 0.1 kVA, 50/60 Hz
Weight	120 kg

## Options

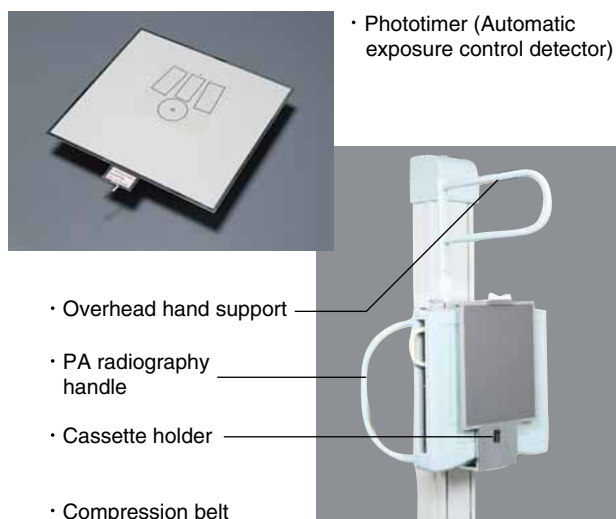

SHIMADZU CORPORATION. International Marketing Division

3. Kanda-Nishikicho 1-chome, Chiyoda-ku, Tokyo 101-8448, Japan Phone: 81(3)3219-5641 Fax: 81(3)3219-5710

SHIMADZU MEDICAL SYSTEMS

20101 South Vermont Ave., Torrance, California 90502, U.S.A.

Phone: 1(310)217-8855 Fax: 1(310)217-0661

SHIMADZU DEUTSCHLAND GmbH

Albert-Hahn-Strasse 6-10, D-47269 Duisburg, F.R. Germany Phone: 49(203)7687-0 Fax: 49(203)766625

SHIMADZU (ASIA PACIFIC) PTE LTD.

16 Science Park Drive #01-01 Singapore Science Park, Singapore 118227, Republic of Singapore

Phone: 65-6778 6280 Fax: 65-6779 2935

SHIMADZU (HONG KONG) LTD.

Suite 1028 Ocean Center, Harbour City, Tsim Sha Tsui, Kowloon, Hong Kong

Phone: 852-2375-4979 Fax: 852-2199-7438

SHIMADZU INTERNATIONAL TRADING (SHANGHAI) Co., LTD. SHANGHAI OFFICE

24th Floor, Shanghai Xin Hualian Building, No.755 Huaihai Zhong Lu, Shanghai, China

Phone: 86-21-6472-8442 Fax: 86-21-6472-8648

SHIMADZU MEDICAL SYSTEMS (OCEANIA) PTY. LTD.

Units E, 10-16 South Street, Rydalmere N.S.W. 2116, Australia

Phone: 61(2)9898-2444 Fax: 61(2)9684-4055

SHIMADZU DO BRASIL COMÉRCIO LTDA.

Avenida Marquês de São Vicente, 1771. Barra Funda CEP: 01139-003-São Paulo-SP, Brasil

Phone: (55)11-3611-1688 Fax: (55)11-3611-2209

Overseas Offices

Istanbul, Moscow

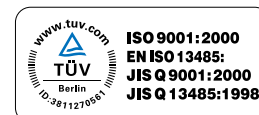
URL <http://www.shimadzu.com>

Shimadzu Corporation Medical Systems Group has been certified by TÜV Rheinland as a manufacturer of medical equipment and systems in compliance with ISO9001:2000 Quality Management Systems and EN ISO13485:2000 Medical Equipment Quality Management Systems.

## Remarks;

- ※Every value in this catalogue is a standard value, and it may vary a little from the actual at each site.
- ※The appearances and specifications are subject to change for reasons of improvement without notice.
- ※Certain configurations may not be available pending regulatory clearance. Contact your Shimadzu representative for information on specific configurations.
- ※Before operating this system, you should first thoroughly review the Instruction Manual.