



雷天温斯顿储能类“水性锂钪动力电池”性能说明

THUNDER SKY WINSTON ENERGY STORAGE TYPE "WATER-BASED LITHIUM YTTRIUM POWER BATTERY" PERFORMANCE SPECIFICATION



单体电池尺寸 DIMENSIONS

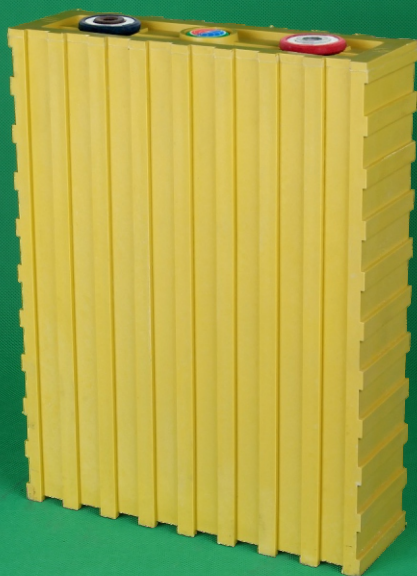

型号(MODEL): TSWB-LYP160AHA-B

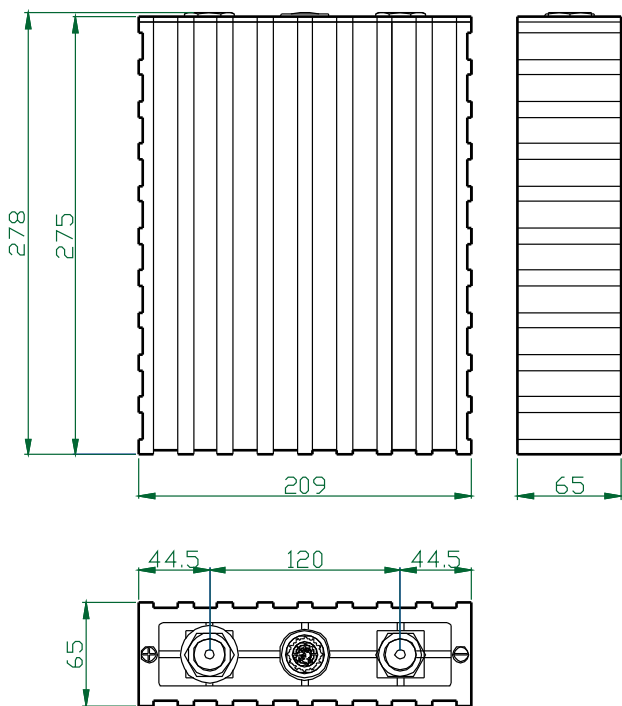

技术参数 SPECIFICATIONS

| 型号 (MODEL) | TSWB-LYP160AHA-B | |
|--|--------------------------|------------|
| 标称容量 Nominal Capacity | 160AH | |
| 规格 Specification | 长 L | 209mm |
| | 宽 W | 65mm |
| | 高 H | 278mm |
| 工作电压 Operation Voltage | 充电 Charge | 3.8(V) |
| | 放电 Discharge | 2.8(V) |
| 内阻 Internal Resistance | ≤0.4(mΩ) | |
| 最大放电电流 Max Discharge Current | 恒电流 Constant Current | ≤3CA |
| | 脉冲试 Impulse Current | ≤10CA |
| 标准充放电电流 Standard Charge/ Discharge Current | 80A(0.5CA) | |
| 循环寿命 Cycle Life | (80%DOD) | ≥5000Times |
| | (70%DOD) | ≥7000Times |
| 壳体耐温性 Temperature Durability Of Case | ≤200°C | |
| 适应环境 Operating Temperature | 充电 Charge | -45°C~85°C |
| | 放电 Discharge | |
| | 存储湿度 Storage Humidity | ≤75%RH |
| 自放电率(月) Self-discharge Rate | ≤1% (月/Monthly) | |
| 单体电池重量 Weight | 5.7kg±150g | |

TSWB-LYP160AHA-B型电池的充放电特性

TSWB-LYP160AHA-B CHARGE&DISCHARGE CHART

不同环境温度下LYP类电池的放电特性曲线

Discharge characteristic curve of LYP type battery under different ambient temperature

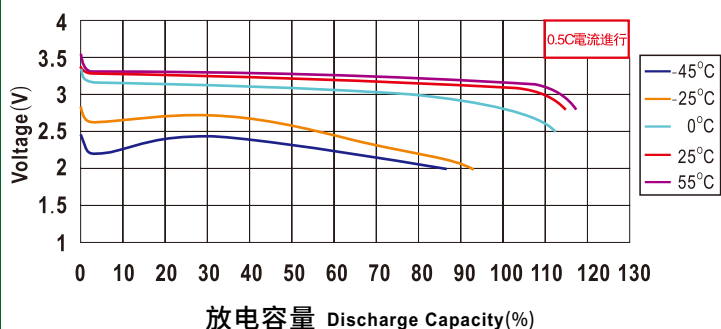

常温下LYP类电池的放电特性曲线

Discharge characteristic curve of LYP type battery under normal temperature

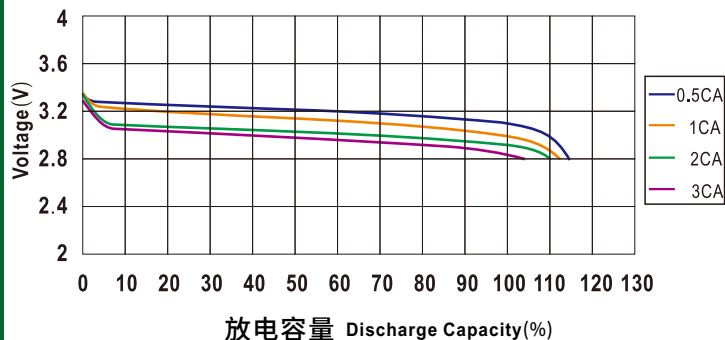

常温下LYP类电池的充电特性曲线

Charge characteristic curve of LYP type battery under normal temperature

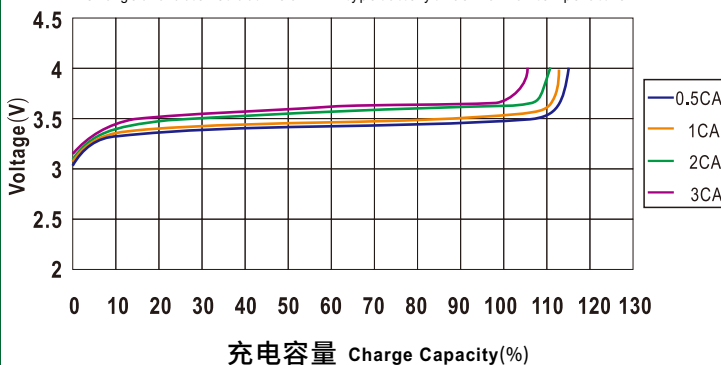

在常温下LYP类电池的存储特性曲线

Storage characteristic curve of LYP type battery under normal temperature

