

SINGLE SEESAW

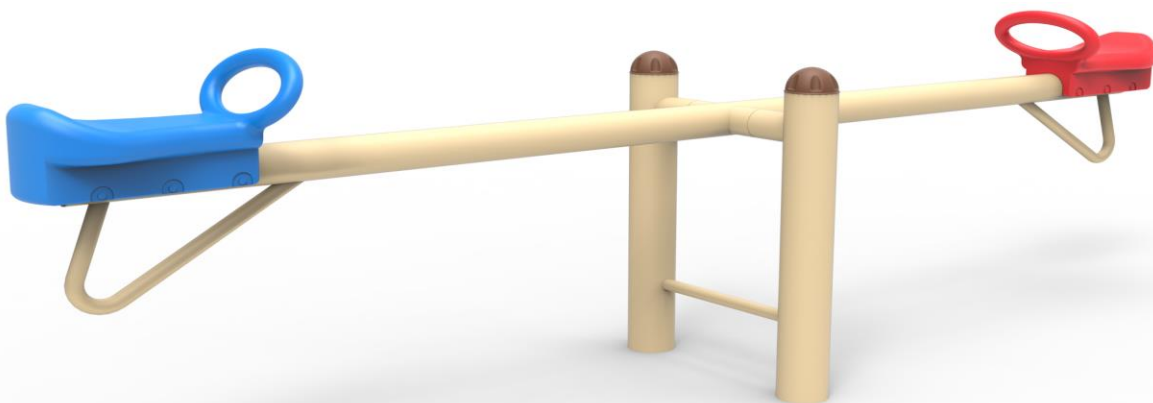

- ❖ Side carrier pipes used in product construction should have a wall thickness of $\text{Ø}114\text{mm}$: between 3-5 mm, middle carrier pipe should have a wall thickness of $\text{Ø}90\text{mm}$ 2-4 mm. Side carrier pipes used in product construction should have a wall thickness of $\text{Ø}114\text{mm}$: between 3-5 mm, middle carrier pipe should have a wall thickness of $\text{Ø}90\text{mm}$ 2-4 mm.
- ❖ The rear middle connection pipes should be manufactured in such a way that the bearing and the carrier shaft have a wall thickness of $\text{Ø}60\text{mm}$: 10 mm and a wall thickness of $\text{Ø}60$: 2.5 mm.
- ❖ Definitely, due to the impact problems, the seesaw seat made of hard and metal material will not be used.
- ❖ After the struts and carrier pipes forming the seesaw are made of galvanized pipe or subjected to degreasing-sandblasting process, they will be produced by applying static oven paint process.

SEESAW SEAT

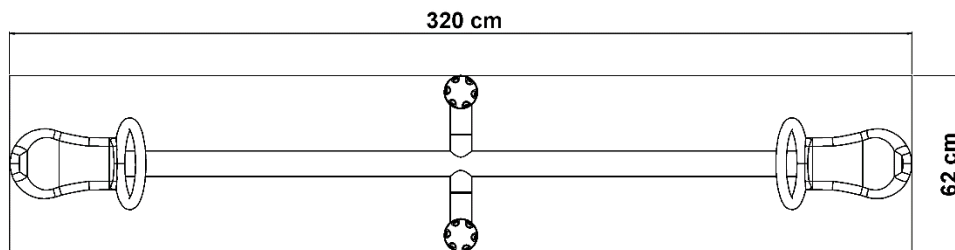
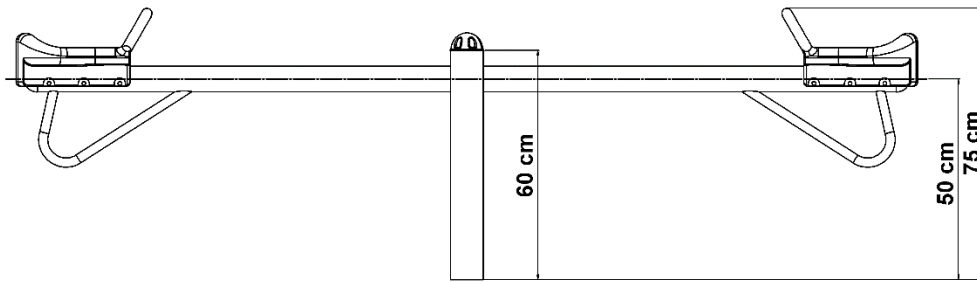
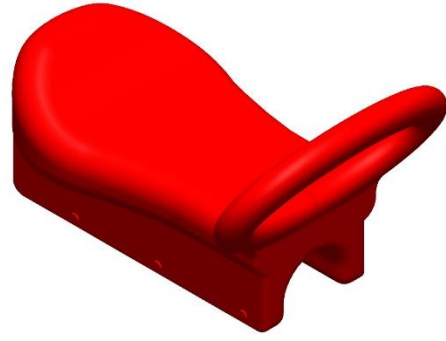
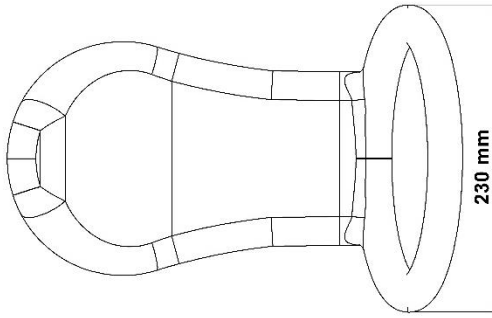
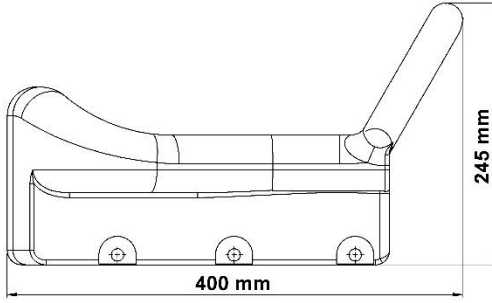

- ❖ The seat should be manufactured by inflating technique from polyethylene material so that the seesaw seat is self-locking.
- ❖ Reclining Seats will be produced from self-colored polyethylene material and with double walls.
- ❖ The Reclining Seats will be designed and manufactured to fit on the Ø90 carrier pipe.
- ❖ According to TS EN 1176-2 / 04.02.2010 It is mandatory to have the expression "POLYETHYLENE" within the scope of the Document.
- ❖ The dyestuffs used in coloring will be in accordance with the children's health and food regulations.
- ❖ The minimum weight of the tube will be 1.7 kg.