

FortiMail™

FortiMail 60D, 200E, 200F, 400E, 400F, 900F, 1000D, 2000E, 3000E, 3200E and VM

FortiMail is a top-rated secure email gateway that stops volume-based and targeted cyber threats to help secure the dynamic enterprise attack surface, prevents the loss of sensitive data and helps maintain compliance with regulations. High performance physical and virtual appliances deploy on-site or in the public cloud to serve any size organization — from small businesses to carriers, service providers, and large enterprises.



Threat Prevention

Powerful antispam and antimalware, are complemented by advanced techniques like outbreak protection, content disarm and reconstruction, sandbox analysis, impersonation detection and other technologies to stop unwanted bulk-email, ransomware, business email compromise and targeted attacks.



Data Protection

Robust data loss prevention, identity-based email encryption and archiving help prevent the inadvertent loss of sensitive information and maintain compliance with corporate and industry regulations.

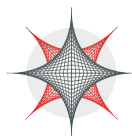

Security Fabric Integration

Integrations with Fortinet products as well as third-party components help customers adopt a proactive approach to security by sharing IoCs across a seamless Security Fabric.



Deployment Modes

- Mail Gateway
- Transparent
- Fully Featured Mail Server



FortiCare Worldwide 24/7 Support

support.fortinet.com



FortiGuard Security Services

www.fortiguardservices.com

Third-Party Certifications



FEATURES

Multi-layered Antispam

More than a dozen sender, protocol and content inspection techniques shields networks and users from unwanted bulk email. It starts with assessing IP, domain and other reputations and continues with various validation methods such as bounce, authentication and recipient verification as well as DMARC, SPF and DKIM checks. Finally, message structure and content are analyzed based on digital signature, keywords in context, image analysis, embedded URIs and more advanced techniques such as behavior analysis and spam outbreak protection. Working together, these techniques consistently identify and block 99.98% of spam in real-world conditions.

Integrated Data Protection

A robust set of capabilities for data loss prevention, email encryption and email archiving safely deliver sensitive emails protect against the inadvertent loss of data. These features facilitate compliance with corporate policies and industry regulations.

Intuitive Email Management

Real-time dashboards, rich reporting, central quarantines and end user controls along with full MTA and mail handling capabilities provide organizations full visibility and easy control over email traffic.

Powerful Antimalware

Combining multiple static with dynamic technologies which include signature, heuristic and behavioral techniques along with optional virus outbreak prevention, FortiMail protects against a wide range of constantly evolving threats.

Advanced Threat Protection

For an even stronger defense against the very latest threat classes like business email compromise and targeted attacks, FortiMail offers optional content disarm and reconstruction, sandbox analysis, sophisticated spoof detection and more.



High Performance, Flexible Deployment

Easily scaling to handle more than 1.5m messages per hour with full antispam and antimalware filtering, FortiMail serves organizations of all sizes, with the option to deploy in gateway, transparent or server modes.

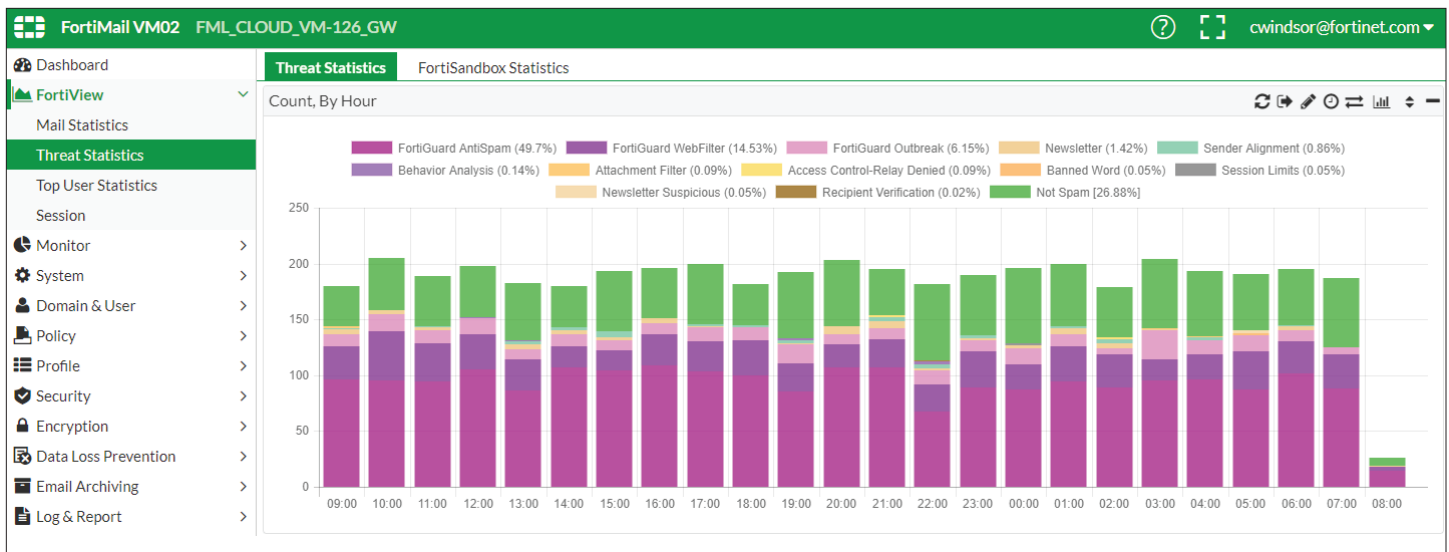

DEPLOYMENT

Choose from three modes of deployment — Transparent, Gateway, or Server mode – to meet your specific email security requirements, while minimizing infrastructure changes and service disruptions:

Gateway Mode: Provides inbound and outbound proxy mail transfer agent (MTA) services for existing email gateways. A simple DNS MX record change redirects email to FortiMail for antispam and antivirus scanning. The FortiMail device receives messages, scans for viruses and spam, then relays email to its destination email server for delivery.

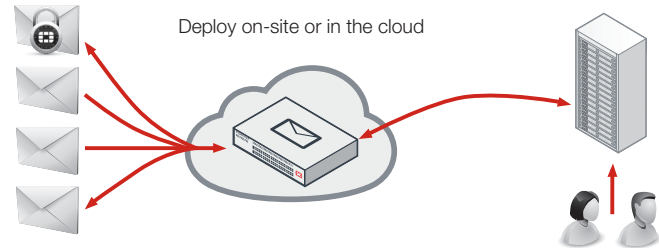

Transparent Mode: Each network interface includes a proxy that receives and relays email. Each proxy can intercept SMTP sessions even though the destination IP address is not the FortiMail appliance. FortiMail scans for viruses and spam, then transmits email to the destination email server for delivery. This eliminates the need to change the DNS MX record, or to change the existing email server network configuration.

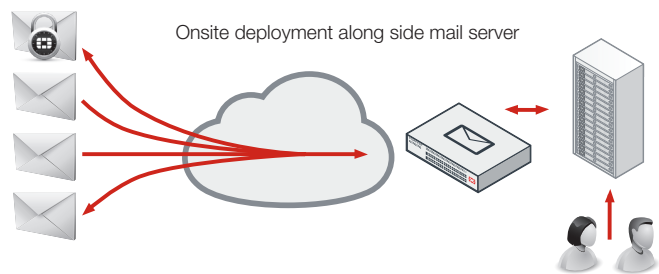

Server Mode: The FortiMail device acts as a stand-alone messaging server with full SMTP email server functionality, including flexible support for secure POP3, IMAP and WebMail access. FortiMail scans email for viruses and spam before delivery. As in Server mode, external MTAs connect to FortiMail, allowing it to function as a protected server.

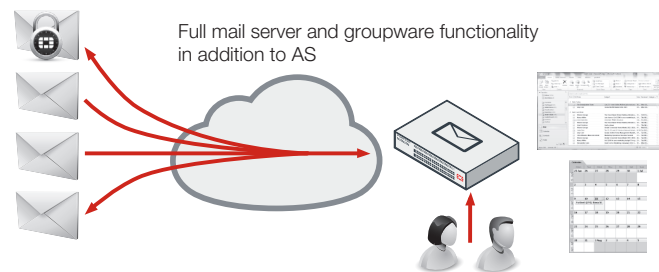

IBE allows FortiMail to deliver confidential and regulated email securely — without requiring additional hardware, software user provisioning, or extra license fees. Use IBE to eliminate paper-based communications and reduce costs.

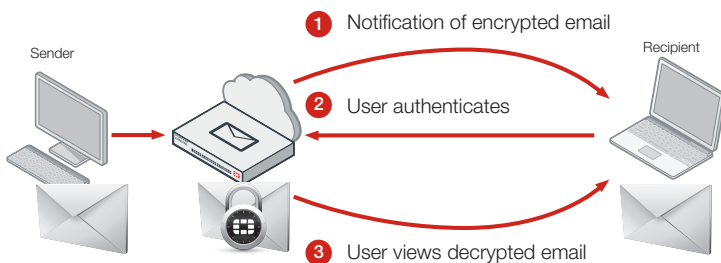

Policy-Based Encryption: Automatically encrypt messages for compliance, based on content or recipient.

Push or Pull Mode: Use Push, Pull, or a combination of modes to meet your requirements.

Easy to Deploy, Use, and Manage: Deploy IBE in any mode, including Transparent mode, without user provisioning or additional hardware or software.

FEATURES SUMMARY

SYSTEM

Wide range of deployment options:

- Transparent, Gateway and Server Mode
- On-prem or public or private cloud deployment
- Cloud-Managed Service

Inbound and Outbound Inspection

Support for multiple email domains with per-domain customization:

- MSSP multi tenant support with white label support
- Multi-tier administration

IPv4 and IPv6 Address Support

Virtual Hosting using Source and/or Destination IP Address Pools

SMTP Authentication Support via LDAP, RADIUS, POP3 and IMAP

LDAP-Based Email Routing

Per User Inspection using LDAP Attributes on a Per Policy (Domain) Basis

Comprehensive Webmail Interface for Server Mode Deployments and Quarantine Management

Mail Queue Management

Multiple Language Support for Webmail and Admin Interface

SMTP RFC Compliance

Modern HTML 5 GUI

Independently tested by VBSpam, NSS, ICSA, SELabs

Compatibility with cloud services e.g. Office365, Google G-Suite

ANTISPAM

FortiGuard antispam service

- Global sender reputation
- Spam object checksums
- Dynamic Heuristic Rules

Real-time FortiGuard spam outbreak protection

Full FortiGuard URL Category Filtering includes:

- Spam, malware and phishing URLs
- Newly registered domains

Business Email Compromise (BEC):

- Multi-level Anti-spoof protection
- Impersonation analysis

Greylisting for IPv4, IPv6 addresses and email accounts

Local sender reputation (IPv4, IPv6 and End Point ID-based)

Behavioral analysis

Deep email header inspection

Integration with third-party spam URI and real-time blacklists (SURBL/RBL)

Newsletter (grey)mail and suspicious newsletter detection

Block/safe lists at global, domain, and user levels

Support for enterprise sender identity standards:

- Sender Policy Framework (SPF)
- Domain Keys Identified Mail (DKIM)
- Domain-Based Message Authentication (DMARC)

Flexible action and notification profiles

Multiple system and per-user self-service quarantines

ANTIMALWARE

FortiGuard Antivirus detection:

- CPRL signature checking
- Heuristic based behavioral detection
- Greyware detection

FortiGuard Virus Outbreak protection:

- Global threat intelligence and data analytics

Active content detection (PDF & Office Documents)

Rescan for threats on quarantine release

Custom file hash checking

TARGETED ATTACK PROTECTION

Content Disarm and Neutralization:

- Neutralize Office and PDF documents (remove macros, active content, attachments and more)
- Neutralize email HTML content
- Remove URL hyperlinking
- Rewrite URLs

URL Click Protect to rewrite URLs and rescan on access

Impersonation analysis — manual and automatic address impersonation detection

Cloud and On-premise sandbox integration supporting file and URL analysis.

CONTENT DETECTION

Mime and file type detection

Comprehensive data-loss prevention with file fingerprinting and sensitive data detection:

- Automatic Windows fileshare and manual upload file fingerprinting
- Healthcare, Finance, personally identifiable information and profanity detection

Automatic decryption of Archives, PDF and Office Documents using built-in and administrator-defined password lists and word detection within email body

PDF Scanning and image analysis

Dynamic Adult Image Analysis Service:

- Identify and report or block the transmission of adult content

MANAGEMENT, LOGGING, AND REPORTING

Basic/advanced management modes

Per domain, role-based administration accounts

Comprehensive activity, configurations change and incident logging and reporting

Built-in reporting module

Centralized quarantine for large scale deployments

Optional centralized logging and reporting with FortiAnalyzer

SNMP support using standard and private MIB with threshold-based traps

Local or external storage server support, including iSCSI devices

External Syslog support

Open REST API for configuration and management

HIGH AVAILABILITY (HA)

High availability supported in all deployment scenarios:

- Active-Passive mode
- Active-Active configuration synchronization mode

Quarantine and mail queue synchronization

Device failure detection and notification

Link status, failover and redundant interface support

ADVANCED

Policy-based e-mail archiving with remote storage options:

- Support for Exchange journal archiving

Comprehensive encryption support:

- Server to server TLS
- Clientless Identity-based Encryption
- S/MIME

Advanced Email Server feature set including:

- Comprehensive webmail interface
- POP3(S), IMAP(S) mail access
- Calendaring functions
- Undo Send

SAML 2.0 SSO and ADFS integration for webmail and quarantine access

Advanced MSSP feature set:

- System wide rebranding
- Multi-tenancy and mass provisioning
- Delegated tiered administration and role-based control

SUPPORT

Simple support options with inclusive bundles

Advanced RMA Support

Professional services and installation support options

SPECIFICATIONS

	FORTIMAIL 60D	FORTIMAIL 200E	FORTIMAIL 200F
Recommended Deployment Scenarios	Demo, testing, and training	Small businesses, branch offices, and organizations	Small businesses, branch offices, and organizations
Hardware Specifications			
10/100/1000 Interfaces (Copper, RJ45)	4	4	4
SFP Gigabit Ethernet Interface	0	0	0
SFP+ 10 Gigabit Ethernet Interface	0	0	0
Redundant Hot Swappable Power Supplies	No	No	No
Storage	1x 500 GB	1x 1TB	1x 1TB
RAID Storage Management	No	No	No
Form Factor	Desktop	1U	1U
Power Supply	External	Single	Single
System Specifications			
Protected Email Domains*	2	20	20
Recipient-based Policies (per Domain / per System) — Incoming or Outgoing	15 / 30	60 / 300	60 / 300
Server Mode Mailboxes	50	150	150
Antispam, Antivirus, Authentication, and Content Profiles (per Domain / per System)	10 / 15	50 / 60	50 / 60
Performance (Messages/Hour) [Without queuing based on 100 KB message size]			
Email Routing (per hour)**	3.6 K	50 K	50 K
FortiGuard Antispam + Virus Outbreak (per hour)**	3.1 K	40 K	40 K
FortiGuard Enterprise ATP (per hour)**	2.7 K	30 K	30 K
Dimensions			
Height x Width x Length (inches)	1.61 x 8.27 x 5.24	1.75 x 17.05 x 13.86	1.73 x 17.24 x 16.61
Height x Width x Length (mm)	41 x 210 x 133	45 x 433 x 352	44 x 438 x 422
Weight	2.4 lbs (1.1 kg)	13.4 lbs (6.1 kg)	11.9 lbs (5.4 kg)
Environment			
Power Source	External Power Supply 19V DC 2.1A 40 W	90–240V AC, 50–60 Hz	100–240V AC, 50–60 Hz
Maximum Current	110V / 2.1A, 220V / 1.2A	100V / 4A, 240V / 2A	100V / 3A, 240V / 1.5A
Maximum Power Required	22 W	72 W	62 W
Power Consumption (Average)	18 W	60 W	51 W
Heat Dissipation	74 BTU/h	280 BTU/h	245 BTU/h
Humidity	10–90% non-condensing	5–95% non-condensing	5–90% non-condensing
Operating Temperature	32–104°F (0–40°C)	32–104°F (0–40°C)	32–104°F (0–40°C)
Storage Temperature	-13–158°F (-25–70°C)	-13–158°F (-25–70°C)	-4–158°F (-20–70°C)
Compliance			
	FCC Part 15 Class B, C-Tick, VCCI, CE, UL/cUL, CB, RoHS	FCC Part 15 Class A, C-Tick, VCCI, CE, UL/cUL, CB, BSMI, RoHS	FCC Part 15 Class A, C-Tick, VCCI, CE, UL/cUL, CB, RoHS
Certification			
	VBSspam and VB100 rated	VBSspam and VB100 rated, Common Criteria NDPP, FIPS 140-2 Compliant	VBSspam and VB100 rated, Common Criteria NDPP, FIPS 140-2 Compliant

* Protected Email Domains is the total number of email domains that can be configured on the appliance. Domain Associations can be used to enable additional domains which share configuration with the primary domain to which they are assigned.

** Tested using FortiMail 6.0



FortiMail 60D



FortiMail 200E



FortiMail 200F

SPECIFICATIONS

	FORTIMAIL 400E	FORTIMAIL 400F	FORTIMAIL 900F
Recommended Deployment Scenarios	Small to midsized organizations	Small to midsized organizations	Mid to large enterprise, education and government departments
Hardware Specifications			
10/100/1000 Interfaces (Copper, RJ45)	4	4	4
SFP Gigabit Ethernet Interface	0	0	2
SFP+ 10 Gigabit Ethernet Interface	0	0	0
Redundant Hot Swappable Power Supplies	No	No	Yes
Storage	2x 1 TB	2x 1 TB	2x 2 TB (2x 2 TB Optional)
RAID Storage Management	Software: 0, 1	Software: 0, 1	Hardware: 0, 1, 5, 10, Hot Spare (Based on Drive Count)
Form Factor	1U	1U	1U
Power Supply	Single (Dual Optional)	Single (Dual Optional)	Dual
System Specifications			
Protected Email Domains*	100	100	800
Recipient-based Policies (per Domain / per System) — Incoming or Outgoing	400 / 1,500	400 / 1,500	800 / 3,000
Server Mode Mailboxes	400	400	1,500
Antispam, Antivirus, Authentication, and Content Profiles (per Domain / per System)	50 /200	50 /200	50 / 400
Performance (Messages/Hour) [Without queuing based on 100 KB message size]			
Email Routing (per hour)**	250 K	250 K	800 K
FortiGuard Antispam + Virus Outbreak (per hour)**	200 K	200 K	500 K
FortiGuard Enterprise ATP (per hour)**	150 K	150 K	400 K
Dimensions			
Height x Width x Length (inches)	1.73 x 17.24 x 16.38	1.73 x 17.24 x 16.38	1.75 x 17.00 x 27.61
Height x Width x Length (mm)	44 x 438 x 416	44 x 438 x 416	44 x 438 x 701
Weight	25.0 lbs (11.0kg)	25.0 lbs (11.0kg)	33.1 lbs (15.00 kg)
Environment			
Power Source	100–240V AC, 50–60 Hz	100–240V AC, 50–60 Hz	100–240V AC, 50–60 Hz
Maximum Current	100V / 5A, 240V / 3A	100V / 5A, 240V / 3A	100V / 5A, 240V / 2.5A
Maximum Power Required	132 W	113 W	190 W
Power Consumption (Average)	103 W	77 W	174 W
Heat Dissipation	482 BTU/h	418 BTU/h	681 BTU/h
Humidity	5–95% non-condensing	5–90% non-condensing	5–90% non-condensing
Operating Temperature	32–104°F (0–40°C)	32–104°F (0–40°C)	32–104°F (0–40°C)
Storage Temperature	-13–167°F (-25–75°C)	-4–158°F (-20–70°C)	-4–158°F (-20–70°C)
Compliance			
	FCC Part 15 Class A, C-Tick, VCCI, CE, RoHS	FCC Part 15 Class A, C-Tick, VCCI, CE, UL/cUL, CB, BSMI, RoHS	FCC Part 15 Class A, C-Tick, VCCI, CE, UL/cUL, CB, BSMI, RoHS
Certification			
	VBSpam and VB100 rated, Common Criteria NDPP, FIPS 140-2 Compliant	VBSpam and VB100 rated, Common Criteria NDPP, FIPS 140-2 Compliant	VBSpam and VB100 rated, Common Criteria NDPP, FIPS 140-2 Compliant

* Protected Email Domains is the total number of email domains that can be configured on the appliance. Domain Associations can be used to enable additional domains which share configuration with the primary domain to which they are assigned.

** Tested using FortiMail 6.0

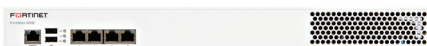

FortiMail 400E



FortiMail 400F



FortiMail 900F

SPECIFICATIONS

	FORTIMAIL 1000D	FORTIMAIL 2000E	FORTIMAIL 3000E	FORTIMAIL 3200E
Recommended Deployment Scenarios				
	Mid to large enterprise, education and government departments	Large enterprise, education and government departments	Highest performing appliance for the largest University, corporate, ISP and carrier customers	
Hardware Specifications				
10/100/1000 Interfaces (Copper, RJ45)	6	4	4	4
SFP Gigabit Ethernet Interface	2	2	2	2
SFP+ 10 Gigabit Ethernet Interface	0	0	0	2
Redundant Hot Swappable Power Supplies	Yes	Yes	Yes	Yes
Storage	2x 2 TB (2x 2 TB Optional)	2x 2 TB (6x 2 TB Optional)	2x 2 TB SAS (10x 2 TB Optional)	2x 2 TB (10x 2 TB Optional)
RAID Storage Management	Hardware: 1, 5, 10, Hot Spare (Based on Drive Count)	Hardware: 1, 5, 10, 50, Hot Spare (Based on Drive Count)	Hardware: 1, 5, 10, 50, Hot Spare (Based on Drive Count)	Hardware: 1, 5, 10, 50, Hot Spare (Based on Drive Count)
Form Factor	2U	2U	2U	2U
Power Supply	Dual	Dual	Dual	Dual
System Specification				
Protected Email Domains*	800	800	2,000	2,000
Recipient-Based Policies (per Domain / per System) — Incoming or Outgoing	800 / 3,000	800 / 3,000	1,500 / 7,500	1,500 / 7,500
Server Mode Mailboxes	1,500	2,000	3,000	3,000
Antispam, Antivirus, Authentication, and Content Profiles (per Domain / per System)	50 / 400	50 / 400	50 / 600	50 / 600
Performance (Messages/Hour) [Without queuing based on 100 KB message size]				
Email Routing (per hour)**	800 K	1.5 Million	2.5 Million	3.4 Million
FortiGuard Antispam + Virus Outbreak (per hour)**	500 K	1.0 Million	1.8 Million	2.4 Million
FortiGuard Enterprise ATP (per hour)**	400 K	700 K	1.5 Million	2.0 Million
Dimensions				
Height x Width x Length (inches)	3.50 x 17.24 x 14.49	3.5 x 17.2 x 25.5	3.5 x 17.2 x 25.5	3.5 x 17.2 x 25.5
Height x Width x Length (mm)	88 x 438 x 368	89 x 437 x 647	89 x 437 x 647	89 x 437 x 647
Weight	27.6 lbs (12.52 kg)	32 lbs (14.5 kg)	40.0 lbs (18.2 kg)	40.0 lbs (18.2 kg)
Environment				
Power Source	100–240V AC, 50–60 Hz	100–240V AC, 50–60 Hz	100–240V AC, 50–60 Hz	100–240V AC, 50–60 Hz
Maximum Current	100V / 5A, 240V / 3A	10.0A / 110V, 3.5A / 240V	9.8A / 110V, 4.9A / 220V	9.8A / 110V, 4.9A / 220V
Maximum Power Required	138 W	219 W	379 W	382 W
Power Consumption (Average)	115 W	189 W	348 W	351 W
Heat Dissipation	471 BTU/h	781 BTU/h	1325 BTU/h	1336 BTU/h
Humidity	5–95% non-condensing	8–90% non-condensing	8–90% non-condensing	8–90% non-condensing
Operating Temperature	32–104°F (0–40°C)	41–95°F (5–35°C)	50–95°F (10–35°C)	50–95°F (10–35°C)
Storage Temperature	-13–158°F (-25–70°C)	-40–140°F (-40–60°C)	-40–158°F (-40–70°C)	-40–158°F (-40–70°C)
Compliance				
	FCC Part 15 Class A, C-Tick, VCCI, CE, UL/cUL, CB, BSMI, RoHS	FCC Part 15 Class A, C-Tick, VCCI, CE, UL/cUL, CB, BSMI, RoHS	FCC Part 15 Class A, C-Tick, VCCI, CE, UL/cUL, CB, BSMI, RoHS	FCC Part 15 Class A, C-Tick, VCCI, CE, UL/cUL, CB, BSMI, RoHS
Certification				
	VBSpam and VB100 rated, Common Criteria NDPP, FIPS 140-2 Certified	VBSpam and VB100 rated, Common Criteria NDPP, FIPS 140-2 Compliant	VBSpam and VB100 rated, NDPP, FIPS 140-2 Compliant	VBSpam and VB100 rated, NDPP, FIPS 140-2 Compliant

* Protected Email Domains is the total number of email domains that can be configured on the appliance. Domain Associations can be used to enable additional domains which share configuration with the primary domain to which they are assigned.

** Tested using FortiMail 6.0



FortiMail 1000D



FortiMail 2000E



FortiMail 3000E and 3200E

SPECIFICATIONS

TECHNICAL SPECIFICATIONS FOR FORTIMAIL VIRTUAL APPLIANCES	VM00	VM01	VM02	VM04	VM08	VM16	VM32
Recommended Deployment Scenarios *	Demo, testing, and training	Small businesses, branch offices, and organizations	Small to midsized organizations	Mid to large enterprise	Large enterprise	Large enterprise	Large enterprise
Technical Specifications							
Hypervisors Supported	VMware ESXi 5.0/5.1/5.5/6.0/6.5, Citrix / OpenSource XenServer 5.6 SP2/6.0 or later, Microsoft Hyper-V 2008 R2/2012/2012 R2/2016, KVM (qemu 0.12.1 and later), AWS (Amazon Web Services), Microsoft Azure ****						
Maximum Virtual CPUs Supported	1	1	2	4	8	16	32
Virtual NICs Required (Minimum/Maximum)	1 / 4	1 / 4	1 / 4	1 / 6	1 / 6	1 / 6	1 / 6
Virtual Machine Storage Required (Minimum/Maximum)	50 GB / 1 TB	50 GB / 1 TB	50 GB / 2 TB	50 GB / 4 TB	50 GB / 8 TB	50 GB / 12 TB	50 GB / 24 TB
Virtual Machine Memory Required (Minimum/Maximum)	2 GB / 2 GB	2 GB / 4 GB	2 GB / 8 GB	4 GB / 16 GB	4 GB / 64 GB	4 GB / 128 GB	4 GB / 128 GB
Performance (Messages/Hour) [Without queuing based on 100 KB message size] **							
Email Routing	3.6 K	34 K	67 K	306 K	675 K	875 K	1.2 M
FortiGuard Antispam	3.1 K	30 K	54 K	279 K	630 K	817 K	1.1 M
FortiGuard Antispam + Antivirus	2.7 K	26 K	52 K	225 K	585 K	758 K	1.0 M
System Specifications							
Protected Email Domains ***	2	20	100	800	1,000	2,000	2,000
Recipient-Based Policies (Domain / System) — Incoming or Outgoing	15 / 30	60 / 300	400 / 1,500	800 / 3,000	800 / 3,000	1,500 / 7,500	1,500 / 7,500
Server Mode Mailboxes	50	150	400	1,500	2,000	3,000	3,000
Antispam, Antivirus, Authentication, and Content Profiles (per Domain / per System)	10 / 15	50 / 60	50 / 200	50 / 400	50 / 400	50 / 600	50 / 600

* Recommended sizing for Gateway and Transparent deployments. For Server Mode, see Server Mode Mailbox metric. If unsure, please validate the model selection by checking the peak mail flow rates and average message size detail with a FortiMail specialist.

** Hardware dependent. Indicative figures based on a VMWare 6.0 system utilizing 2x Intel Xeon E5-2620 v4 @ 2.10 GHz restricted to the specified number of cores.

*** Protected Email Domains is the total number of email domains that can be configured on the appliance. Domain Associations can be used to enable additional domains which share configuration with the primary domain to which they are assigned.

**** Transparent mode deployment is not fully supported on Microsoft HyperV and cloud hypervisors due to limitations in the available network configurations.

ORDER INFORMATION

Product	SKU	Description
FortiMail 60D	FML-60D	Email Security Appliance — 4x GE RJ45 ports, 500 GB storage.
FortiMail 200E	FML-200E	Email Security Appliance — 4x GE RJ45 ports, 1 TB storage.
FortiMail 200F	FML-200F	Email Security Appliance — 4x GE RJ45 ports, 1 TB storage.
FortiMail 400E	FML-400E	Email Security Appliance — 4x GE RJ45 ports, 2 TB storage.
FortiMail 400F	FML-400F	Email Security Appliance — 4x GE RJ45 ports, 2 TB storage.
FortiMail 900F	FML-900F	Email Security Appliance — 4x GE RJ45 ports, 2x GE SFP slots, dual AC power supplies, 4 TB default storage.
FortiMail 1000D	FML-1000D	Email Security Appliance — 6x GE RJ45 ports, 2x GE SFP slots, dual AC power supplies, 4 TB default storage.
FortiMail 2000E	FML-2000E	Email Security Appliance — 4x GE RJ45 ports, 2x GE SFP slots, dual AC power supplies, 4 TB default storage.
FortiMail 3000E	FML-3000E	Email Security Appliance — 4x GE RJ45 ports, 2x GE SFP slots, dual AC power supplies, 4 TB default storage.
FortiMail 3200E	FML-3200E	Email Security Appliance — 4x GE RJ45 ports, 2x 10 GE SFP+ slots, 2x GE SFP slots, dual AC power supplies, 4 TB default storage.
FortiMail VM00	FML-VM00	FortiMail-VM virtual appliance for VMware ESX/ESXi, Microsoft Hyper-V, Citrix XenServer and KVM virtualization platforms. 1x vCPU core.
FortiMail VM01	FML-VM01	FortiMail-VM virtual appliance for VMware ESX/ESXi, Microsoft Hyper-V, Citrix XenServer and KVM virtualization platforms. 1x vCPU core.
FortiMail VM02	FML-VM02	FortiMail-VM virtual appliance for VMware ESX/ESXi, Microsoft Hyper-V, Citrix XenServer and KVM virtualization platforms. 2x vCPU cores.
FortiMail VM04	FML-VM04	FortiMail-VM virtual appliance for VMware ESX/ESXi, Microsoft Hyper-V, Citrix XenServer and KVM virtualization platforms. 4x vCPU cores.
FortiMail VM08	FML-VM08	FortiMail-VM virtual appliance for VMware ESX/ESXi, Microsoft Hyper-V, Citrix XenServer and KVM virtualization platforms. 8x vCPU cores.
FortiMail VM16	FML-VM16	FortiMail-VM virtual appliance for VMware ESX/ESXi, Microsoft Hyper-V, Citrix XenServer and KVM virtualization platforms. 16x vCPU cores.
FortiMail VM32	FML-VM32	FortiMail-VM virtual appliance for VMware ESX/ESXi, Microsoft Hyper-V, Citrix XenServer and KVM virtualization platforms. 32x vCPU cores.
FortiMail Cloud		
FortiMail Cloud — Server	FC-10-0VM01-416-02-DD	FortiMail Cloud — Server (25–100 Mailboxes)
	FC-10-0VM01-417-02-DD	FortiMail Cloud — Server Premium (25–100 Mailboxes)
FortiMail Cloud — Gateway	FC-10-0VM01-414-02-DD	FortiMail Cloud — Gateway (25–100 Mailboxes)
	FC-10-0VM02-414-02-DD	FortiMail Cloud — Gateway (101–1,000 Mailboxes)
	FC-10-0VM04-414-02-DD	FortiMail Cloud — Gateway (1,001–5,000 Mailboxes)
	FC-10-0VM08-414-02-DD	FortiMail Cloud — Gateway (5,001–10,000 Mailboxes)
	FC-10-0VM16-414-02-DD	FortiMail Cloud — Gateway (10,000+ Mailboxes)
	FC-10-0VM01-415-02-DD	FortiMail Cloud — Gateway Premium (25–100 Mailboxes)
	FC-10-0VM02-415-02-DD	FortiMail Cloud — Gateway Premium (101–1,000 Mailboxes)
	FC-10-0VM04-415-02-DD	FortiMail Cloud — Gateway Premium (1,001–5,000 Mailboxes)
FortiMail Cloud — Gateway MSSP	FC-10-0VM08-415-02-DD	FortiMail Cloud — Gateway Premium (5,001–10,000 Mailboxes)
	FC-10-0VM16-415-02-DD	FortiMail Cloud — Gateway Premium (10,000+ Mailboxes)
	FC1-10-EVMSP-415-02-DD	FortiMail Cloud — Gateway Premium for MSSP (500–1,000 Mailboxes)
	FC2-10-EVMSP-415-02-DD	FortiMail Cloud — Gateway Premium for MSSP (1,001–10,000 Mailboxes)
	FC3-10-EVMSP-415-02-DD	FortiMail Cloud — Gateway Premium for MSSP (10,000+ Mailboxes)
Accessories		
AC power adapter for FML-60D	SP-FG80D-PDC	Replacement AC power adapter for FML-60D.
Rack mount tray for FML-60D	SP-RACKTRAY-02	Rack mount tray for FML-60D.
PSU for FML-400E	SP-FAD700-PS	Additional AC power supply for FML-400E.
Power supply for FML-2000E	SP-FML2000E-PS	Replacement AC power supply for FML-2000E.
Power supply for FML-3000E and FML-3200E	SP-FML3000E-PS	Replacement AC power supply for FML-3000E and FML-3200E.
HDD for FML-1000D	SP-D2000	2 TB 3.5" SATA hard drive with tray for FML-1000D.
HDD for FML-3000E	SP-D2TE	2 TB 3.5" SAS hard drive with tray for FML-2000E, FML-3000E and FML-3200E.



GLOBAL HEADQUARTERS
Fortinet Inc.
899 KIFER ROAD
Sunnyvale, CA 94086
United States
Tel: +1.408.235.7700
www.fortinet.com/sales

EMEA SALES OFFICE
905 rue Albert Einstein
06560 Valbonne
France
Tel: +33.4.8987.0500

APAC SALES OFFICE
8 Temasek Boulevard
#12-01 Suntec Tower Three
Singapore 038988
Tel: +65.6395.2788

LATIN AMERICA SALES OFFICE
Sawgrass Lakes Center
13450 W. Sunrise Blvd., Suite 430
Sunrise, FL 33323
United States
Tel: +1.954.368.9990