

MX-S

Variable speed Vortex Mixer

Features

- Variable speed of 0 to 3,000rpm for gentle shaking to rapid mixing of samples
- Touch or continuous operation mode
- Includes a standard top head for mixing a single test tube or other small vessel up to 30mm in diameter
- Electronic speed control maintains constant speed even during changes in load
- Steel base with specially designed vacuum suction feet provides stability and dampens vibration
- Robust aluminum-cast construction



VT1.1 Standard top(Default) Cat. No.18900034

for \varnothing30mm tubes and small vessels



Specifications	MX-S (Adjustable speed)
Voltage,Frequency	100-120V/200-240V,50/60Hz
Power	60W
Mixing motion	Orbital
Orbital diameter	4mm
Motor type	Shaded pole motor
Motor rating input	58W
Motor rating output	10W
Speed range	0-3000rpm
Speed display	Scale
Run type	Touch operation/Continuous
Dimension[W×H×D]	127×130×160mm
Weight	2.0kg
Permissible ambient temperature	5-40°C
Permissible relative humidity	80%RH
Protection class	IP20



VT1.3.1 tube adapter for 48 test tubes, Ø6mm (1mL)	Cat. No.18900020 	VT1.3.10 tube adapter for 4 holes test tubes, Ø28mm (50mL)	Cat. No.18900855 
VT1.3.2 tube adapter for 15 test tubes, Ø10mm (1.5-2mL)	Cat. No.18900021 	VT1.3.11 Tube adapter 12XØ9.8mm+12XØ6.6mm+12XØ5mm (1.5/2.0/0.5/0.2mL)	Cat. No.18900862 
VT1.3.3 tube adapter for 16 test tubes, Ø12mm (5mL)	Cat. No.18900022 	VT1.2 Tube holding rod used with tube adapters	Cat. No.18900044 
VT1.3.4 tube adapter for 8 test tubes, Ø16mm (10mL)	Cat. No.18900023 	VT1.3 Universal top plate Ø 100mm Includes 4 vacuum chuck	Cat. No.18900505 
VT1.3.5 tube adapter for 8 test tubes, Ø20mm (10-15mL)	Cat. No.18900024 	PS1.0 Microplate clamp Includes rectangle PCR tube adapter	Cat. No.18204342 
VT1.3.6 Platform pad Ø99mm, multiple small tubes and vessels	Cat. No.18900043 	VT1.3.12 Large Platform Multi-Specimen Test Tube Adapter 44 holesXØ5mm+55 holesXØ6.6mm+30 holesXØ9.8mm (1.5/2.0/0.5/0.2mL)	Cat. No.18900875 
VT1.3.7 vacuum chuck made of rubber	Cat. No.18900158 	VT1.4 Ampule/Tube Attachment 4pc ampule/tube (0.2mL-15mL)	Cat. No.18204566 
VT1.3.8 tube adapter for 24 holes test tubes, Ø 10mm (1.5-2mL)	Cat. No.18900395 	VT1.5 Erlenmeyer flask attachment 100mL-250mL, Operating speed: 0-1500rpm	Cat. No.18204561 
VT1.3.9 PCR tube adapter for 56 test PCR tubes, strips of 8, Ø5mm (0.1mL-0.5mL)	Cat. No.18204185 		



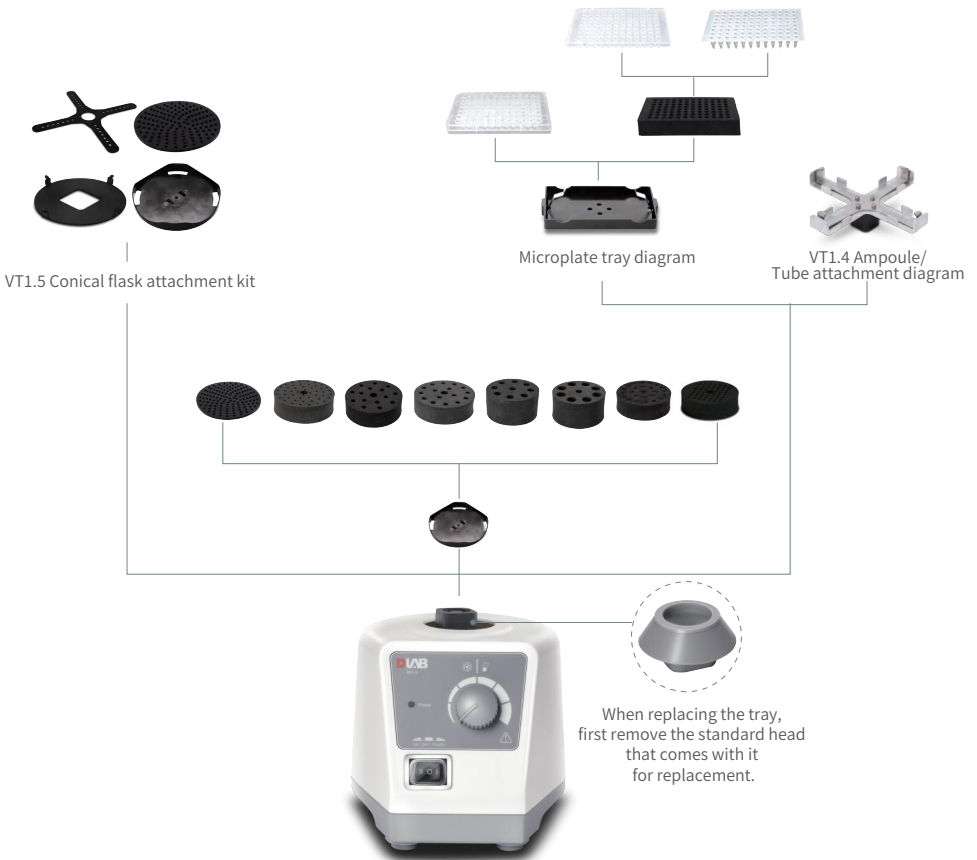

Application of accessories

Accessories	Adjustable speed model (0-2500rpm)	
	Touch mode (High speed area)	Continuous mode (Low speed area)
VT1.1	Y	Y
VT1.2 + VT1.3.1	Y	
VT1.2 + VT1.3.2	Y	
VT1.2 + VT1.3.3	Y	
VT1.2 + VT1.3.4	Y	
VT1.2 + VT1.3.5	Y	
VT1.3 + VT1.3.6	Y	
VT1.3 + VT1.3.1		Y
VT1.3 + VT1.3.2		Y
VT1.3 + VT1.3.3		Y
VT1.3 + VT1.3.4		Y
VT1.3 + VT1.3.5		Y