

Capacity	[KW]	1.50	Evaporating temperature	[°C]	-6.00
Inlet Air Temperature	[°C]	2.00	Refrigerant		R404A
DT	[Δ°C]	8.00			
Minimum number of units in room		0			

Heat exchanger		Casing		
Fan motor feed		Type of fan motor		
Defrost	Electric			

Selected model: 1 x EVS 181		ED		
Capacity	[kW]	1.81	Margin	[%] 20.8
DT	[Δ°C]	6.7	Tot. air flow	[m³/h] 870.0

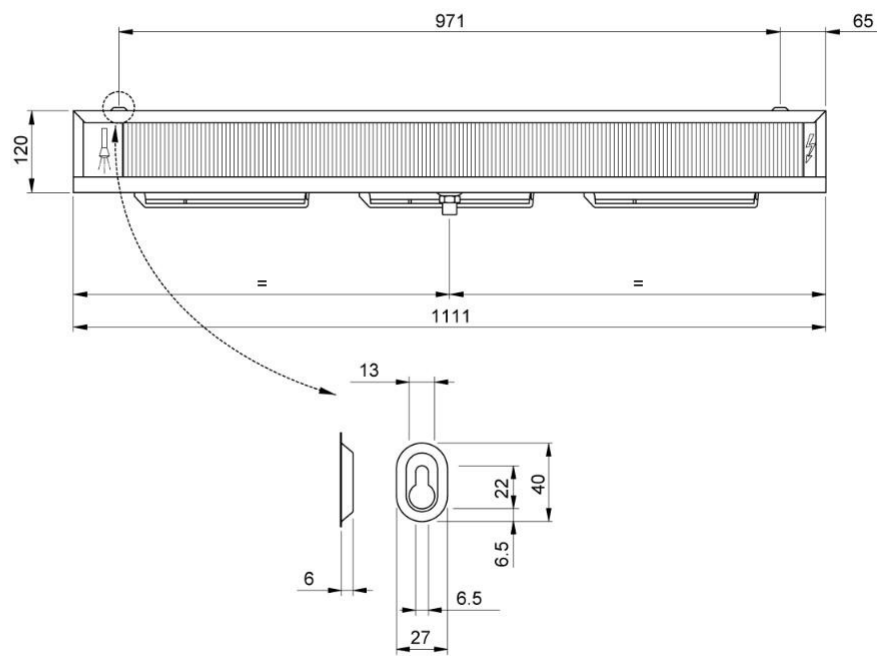
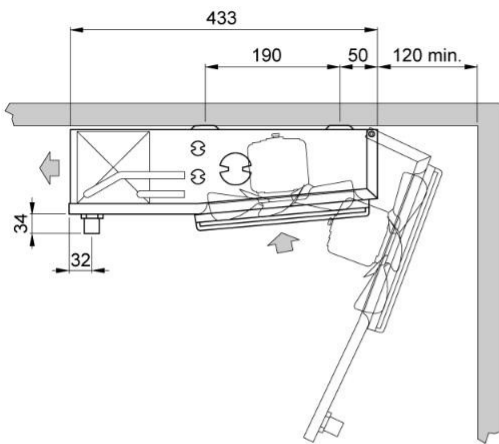

Weight	kg	10.500	PED Category		Cat I
			Design Pressure PS	[bar]	16
Internal surface	m²	0.64	External surface	m²	5.60
Inlet connection		1/2" SAE	Output connection		16 mm
Total circuit capacity	dm³	1.1	Fin spacing	mm	3.5/7
Drain connection		1/2" GAS			

Defrost		Electric		W	1080
Fan Motors	n.	3	Diameter	mm	200
Air flow	m³/h	870	Air throw	m	4.5
Feed	V	230/1/50-60	Rotation speed	rpm	1300
Fan Motor	A	1.05	Absorbed power	W	159
Tot. Pres.S.Lev. 10 m.	dB(A)	37			



* The safety requirements for the use of refrigerants must comply with the provisions of the EN378 standards and the safety data sheets of each fluid used. The risk assessment for the use of A2L mid-flammable refrigerants shall be conducted by the user based on site requirements

We shall not be liable for the performance and the quality of sold products, if fitted or connected fan motor speed regulation or control systems are different from the ones proposed or installed by us.

ED
Heat exchanger
Casing

Fan motor feed

Type of fan motor

Defrost

ED - Electric	EUR 0.00
Base Price	EUR 0.00
Surcharge Water Version	EUR 0.00
Total Options	EUR 0.00
Total Price	EUR 0.00



* The safety requirements for the use of refrigerants must comply with the provisions of the EN378 standards and the safety data sheets of each fluid used. The risk assessment for the use of A2L mid-flammable refrigerants shall be conducted by the user based on site requirements

We shall not be liable for the performance and the quality of sold products, if fitted or connected fan motor speed regulation or control systems are different from the ones proposed or installed by us.