



42250 SELÇUKLU/KONYA

## TECHNICAL DESCRIPTION

### Double swing

**Double swing** - made of five galvanized metal pipes (pipe diameter 11 cm, wall thickness 2.5 mm). The upper parts of the pillars will be provided with plastic plugs, fixed with two aluminum rivets. It will be provided with 2 basket type swing posts made of polyethylene, equipped with chains and fixed by pipes with fasteners.

Swing dimensions: Length - 300 cm, Width - 110 cm, H - 240 cm. The foundation of the construction will have dimensions of LxLxh=400x400x700 mm.

**Installation requirements:** To ensure safe and reliable operation, all supports are to be immersed in the ground (ground) to 0.70m to increase rigidity, then following the concrete process (concrete BC 300). The installation of the elements must exclude the possibility of disassembling them without the use of special purpose tools .

**MD GROUP** MUSTAFA DORNA  
MUSTAFA DORNA İNŞAAT  
ANONİM ŞİRKETİ  
Sakpa V.D. 824/56 16 64 Mersis No: 0705005650001 Tic. Sic. No: 46711  
Adres: Horozluhan Mah. Çarşıbaşı Sok. No: 16 Selçuklu/KONYA  
Tel: (444 960 17) 0 332 233 00 61 62 Fax: 0 332 233 00 63  
İçiş. Bakanlığı Karar No: 3 Organize San. Bölgesi 19. Sk. No: 4  
Tel: 0 332 232 10 79 Selçuklu/KONYA



42250 SELÇUKLU/KONYA



## CLASSIC SWING (SK-100) TECHNICAL SPECIFICATION

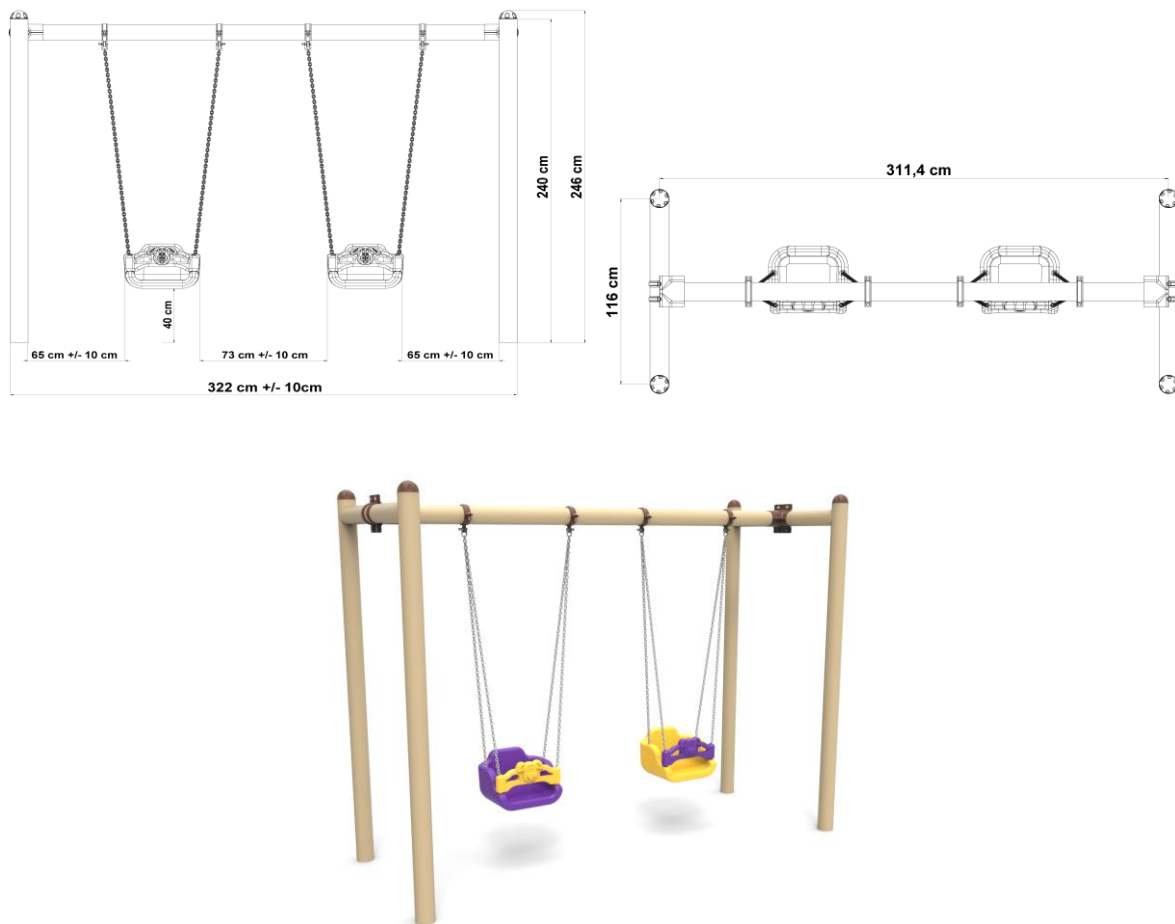

- ❖ It should be formed by connecting a total of 4 ball bearing clamps, 2 for each swing, to a 300 cm long Ø114 mm minimum 2.5 mm pipe, connected with pipes with a minimum wall thickness of Ø 114 mm and a wall thickness of 2.5 mm on both sides.
- ❖ A swing seat made of hard and metal material will definitely not be used due to crash problems.
- ❖ The distance between the bottom surface of the swing seat and the ground surface should be minimum 40cm (+/- 10cm).
- ❖ After the pillars and carrier pipes forming the swing are made of galvanized pipe or sandblasted, the static oven painting process should be applied.
- ❖ Chains will be used as hot dip galvanized with a minimum of 25 microns against rusting. 6 mm caliber and double row chain must be used to prevent finger jamming.
- ❖ Detail concealing polyethylene accessories can be used optionally in combination of swing pillars.

### SWING SEAT

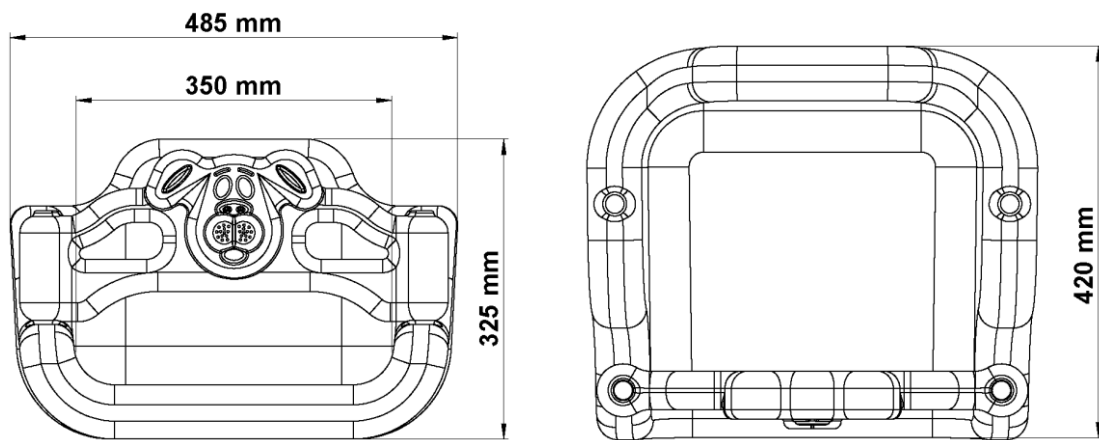

- ❖ The swing seat should be made of polyethylene material with a front protection belt for 3-sided closed safety.
- ❖ The seats should be single seater and there should be a protective belt with animal figures.
- ❖ The swing seat should be produced with a width and length of 48.5x42 cm and a minimum height of 32.5 cm.
- ❖ Seating area width min. It should be 35 cm.
- ❖ The swing seat, together with its handrails, should have a minimum weight of 3.5 kg.
- ❖ Shock absorbing rubber buffers should be used on the front surface of the swing seat to prevent crashes.
- ❖ The statement of "POLYETHYLENE" must be included in the scope of TS EN 1176-2 / 04.02.2010 Certificate.
- ❖ The dyestuffs used in coloring will be suitable for children's health and food regulations.