

AURORING

(MADE FROM CLINICAL QUALITY UV ABSORBING PMMA)

MODIFIED CTR WITH SINGLE & DOUBLE LOOP

These rings are designed to stabilize the capsular bag in cases of damaged or missing zonules. These rings are specially designed for scleral fixation with suture.

- Promotes circular expansion of the capsular bags
- Stabilizes conditions during surgery
- Improves IOL centration
- Resists capsular shrinkage
- Proves to be a better option in case of larger zonular dialysis and in cases of progressive zonulysis

Model Reference: CCI0L, CCI0R, CCI0LR
CCI1L, CCI1R, CCI1LR

Overall diameter	Closed diameter
12.00 mm	10.00 mm
13.00 mm	11.00 mm

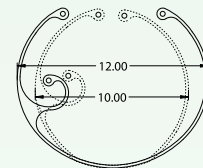

CCI0L

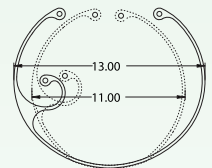

CCI1L

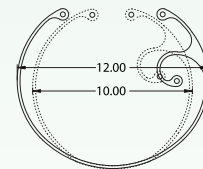

CCI0R

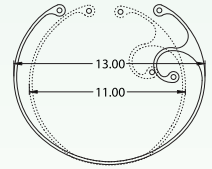

CCI1R

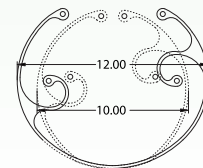

CCI0LR

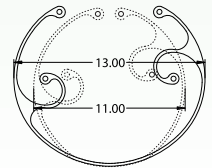

CCI1LR

CAPSULAR TENSION RING

Advantages

- Ensures stable conditions during surgery
- Prevents Capsular Fibrosis

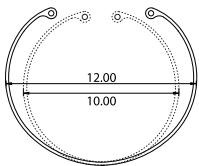

CTR10

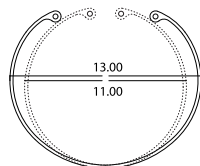

CTR11

Model Reference: CTR 10
CTR 11

Overall diameter	Closed diameter
12.00 mm	10.00 mm
13.00 mm	11.00 mm

CAPSULAR TENSION SEGMENT

This is a zonular support device, that provides support for in-the bag IOL implantation. Its versatility enables early or late placement within the capsular bag. It can be used in cases that cannot be supported by CTRs.

- Partial Ring with a fixation hook
- Can be used in parts of capsule that have insufficient zonular support
- Easy and atraumatic, placement even before phaco
- Can be implanted with minimal capsular or zonular stress

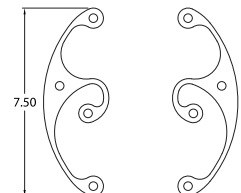

Model Reference: CTS

Other range of products:

SCLERAL FIXATION LENS

UV Absorbing PMMA, Equiconvex Optic, Modified "C" Loop, A Constant: 118.5,
ACD: 5.0 mm, 2 holes in haptics 180°

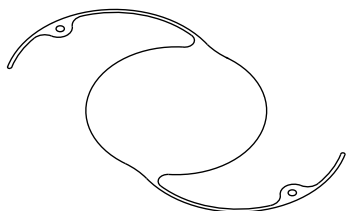

Model	Optic Dia (mm)	Position Holes	Over all Diameter (mm)	Vault Height (mm)	Diopter Range
SC6530	6.50	0	13.00	0.4	6.0D to 30.0D 15.0 to 25.0 in 0.5D

SCLERAL FIXATION SUTURES

Needle	Suture Material	Suture Length	Suture Sizes	
			10-0	9-0
Advanced Side Cutting Spatula AS - 000 - 6 Diameter - 0.15mm Length - 16.0mm Straight Needle		25cm (10")	6002PP	
Advanced Micro Point Spatula AS - 000 - 6 Diameter - 0.15mm Length - 16.0mm Straight Needle	aurolene Polypropylene Blue Monofilament	20cm(8")		6092PP
Advanced Side Cutting Spatula AS - 160 - 6 Diameter - 0.15mm Length - 5.6mm ½ Circle - 160°	aurolene Polypropylene Blue Monofilament	30cm (12")	60602PP	60692PP
Advanced Side Cutting Spatula AS - 000 - 6 Diameter - 0.15mm Length - 16.0mm Straight Needle				

- Advanced Side Cutting Spatula needle for improved penetration through Sclera.
- Straight Needle particularly used for Scleral IOL fixation.
- Rectangular needle body provides excellent handling.
- Blue monofilament polypropylene provides good tensile strength and secured knotting properties.



Information published in this catalogue is subject to change without notification

No 1, Sivagangai Main Road, Veerapanjan, Madurai 625 020, India
Phone: 91452 3096100 Fax: 91 452 2446200
E-mail: info@aurolab.com Web: www.aurolab.com

