



United[®]
Orthopedic Corporation



U2[™] Knee
System

Consistency in U2 Knee System over Time

- Share the same femoral profile of all types allow inter-changeability
- Uniform AP/ML dimensions in all tibial components enhance intraoperative flexibility

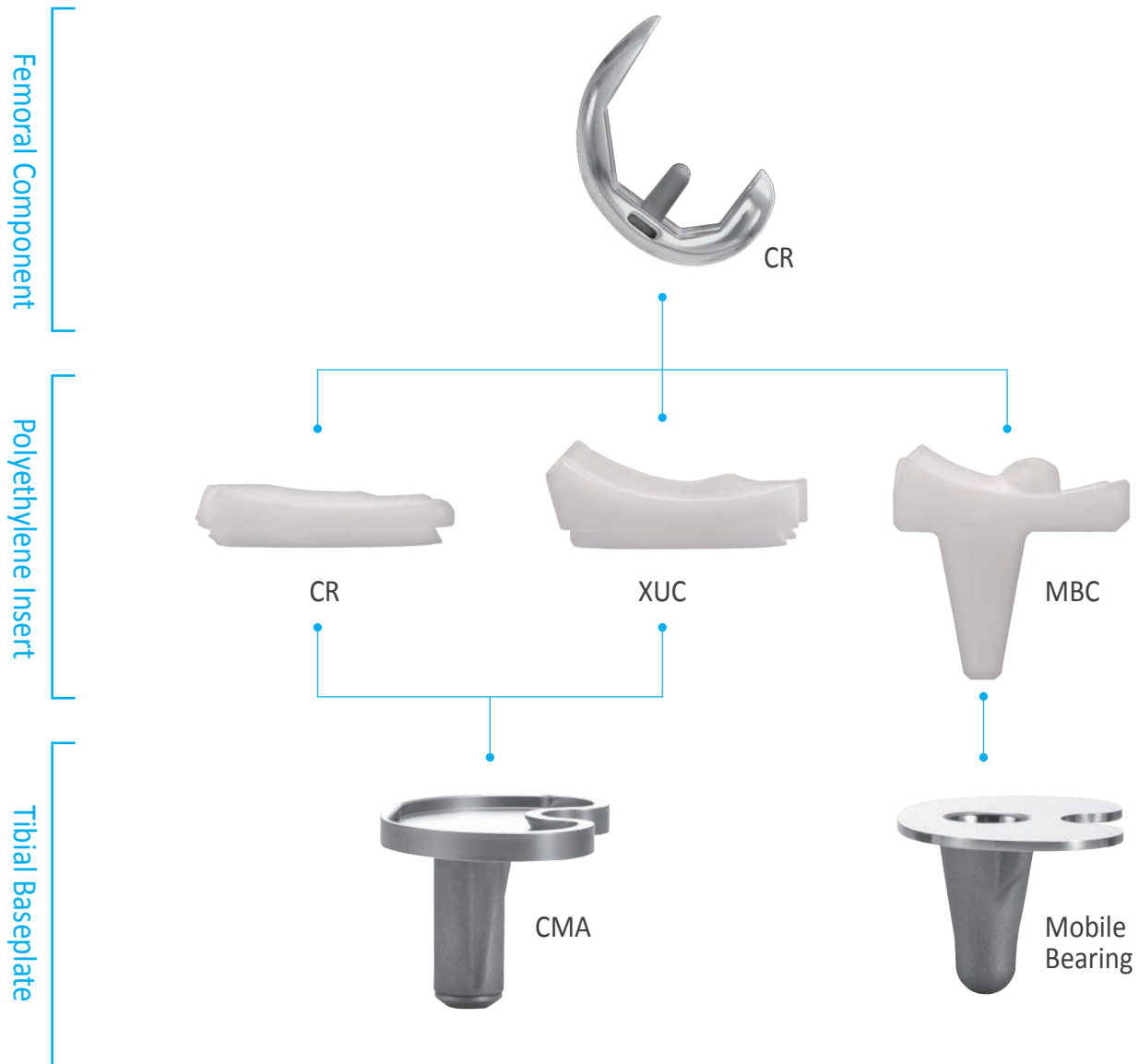



PS



PSA
Revision



PS



MB



PSA



PSA
Low Constrained



CMA



Mobile
Bearing



PSA
Revision

Keep Bone Preservation in Mind...



- 13 sizes of femoral components in 2 mm increments

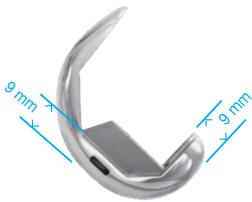

- Bone preserving 9 mm resection in both distal and posterior condyles



- Fully interchangeable among all sizes with the consistent 18 mm intercondylar width

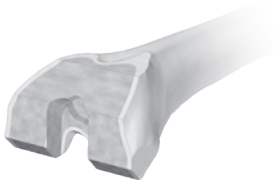

- Limited intercondylar bone removal together with round shaped corner avoids the risk of intercondylar fracture

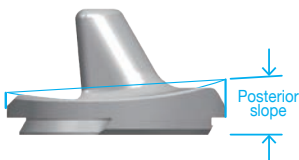

- Horizontal tibial resection surgical technique with built in 5° tibial slope





Optimized Freedom, Better Satisfactory



- 155° flexion without implant impingement

Proven by **ENDOLAB**
MECHANICAL ENGINEERING
GMBH



- A matched "curve on curve" tibial post and box contact, eliminates impact and wear

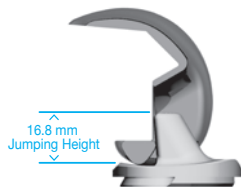

- A refined Cam/Post mechanism minimizes the risk of dislocation and prosthetic loosening

Modular Design Allow Augment and Stem for Moderate Bone Defects

Unilateral titanium augments in 5 or 10 mm thickness with screw fixation



30 mm stem made of titanium alloy to enhance stability

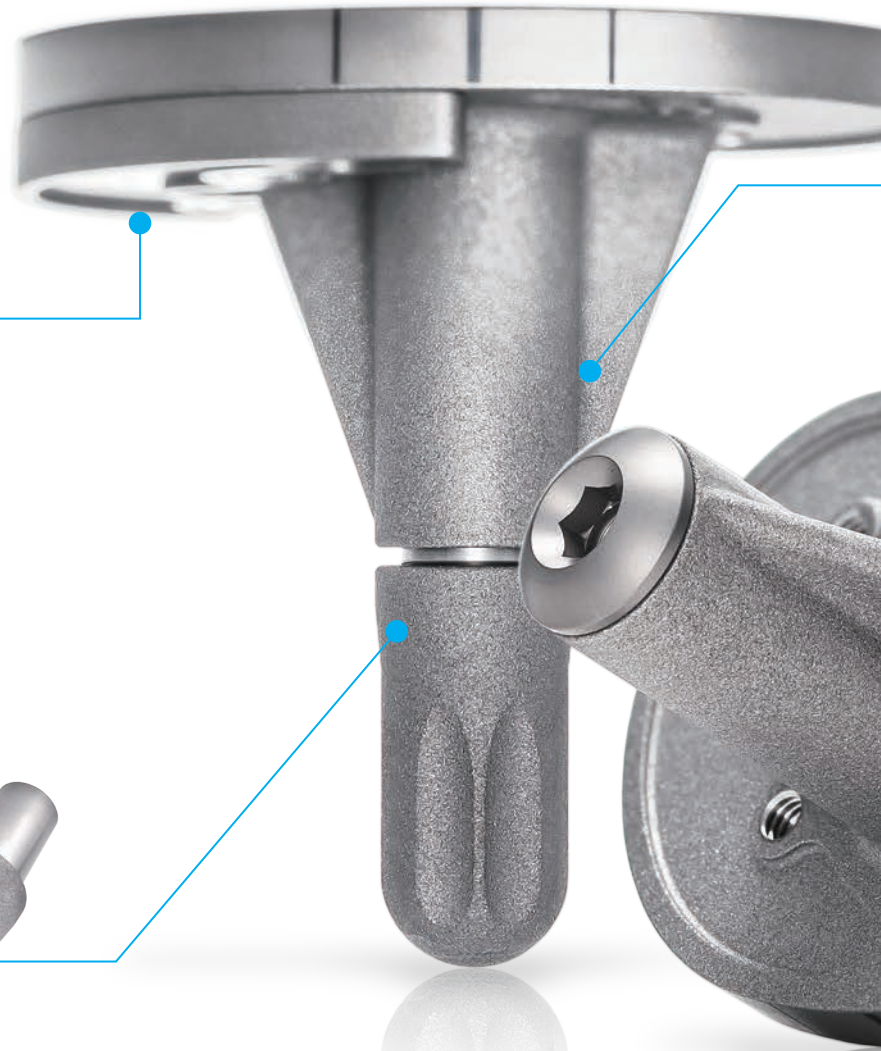



Distal end sealed with
pre-assembled plug



Design without through hole
avoids potential backside wear

CMA™

Cemented Modular Augmentable
Baseplate

Enhanced Stability, Reduced
Operation Time



U2 *Xuc*TM Ultracongruent

- Accommodates CR femoral component and the PCL sacrificed surgical technique for more bone preservation
- Up to 12.5 mm prominent anterior lip and a more conforming articulating surface provide joint stability
- Highly cross-linked UHMWPE reinforces insert longevity
- Mean flexion >150° satisfies patient's demand of activity
- Tibial Baseplate "One up / one down" size pairing

Size Pairing	Insert	CMA Baseplate	Femoral Component												
			#1	#1.5	#2	#2.5	#3	#3.5	#4	#4.5	#5	#5.5	#6	#6.5	#7
	#0	#0	●												
	#1	#1	●	●	●										
	#2	#2	●	●	●	●	●								
	#3	#3			●	●	●	●	●						
	#4	#4					●	●	●	●	●				
	#5	#5						●	●	●	●	●	●		
	#6	#6								●	●	●	●	●	
	#7	#7										●	●	●	

Mobile Bearing Baseplate

Highly mirror-polished platform minimizes backside wear.

The pure axial rotating design based on biomechanical principles proven over decades of clinical usage.

U2 MBC™

Mobile Bearing Congruent

- Accommodate with CR femoral component allows more bone preservation
- Surgical flexibility: PCL either retained or sacrificed
- Central stopper enhances joint M/L stability and also allows 4.5 degrees hyperextension





U2 MB™

Mobile Bearing

- Accommodates with PS femoral component.
- Surgery: Both ACL and PCL sacrificed.

MB / MBC Size Pairing	Mobile Bearing Baseplate	Insert					
		#1	#2	#3	#4	#5	#6
#1	●	●					
#2	●	●	●				
#3	●	●	●	●			
#4	●	●	●	●	●		
#5	●	●	●	●	●	●	
#6	●	●	●	●	●	●	●

★ (MBC Insert) Size of femoral component is equal to insert.

★ (MB Insert) Size of femoral component is fully interchangeable between femoral and insert.

Defined a More Secured Stability with
More Choices

PSA™ Revision System

A More Secured Stability

Enhanced locking mechanism prevents all the locking
screws from backing out

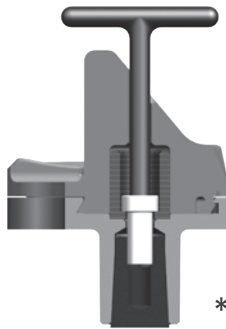

*No. US9044327

Tibia Trays Accommodate All U2 Knee
Femoral Components



Multiple Choices of Extensions

- 5 length 8 diameters of stems in straight or open slot curved from 30 mm to 200 mm
- 4 thicknesses of distal femoral augments in 4, 8, 12, 16 mm
- 2 thicknesses of posterior augments in 4, 8 mm
- 3 thickness of unilateral tibial augments in 5, 10, 15 mm
- 3 selections of offset with full range orientation in 2, 4, 6 mm

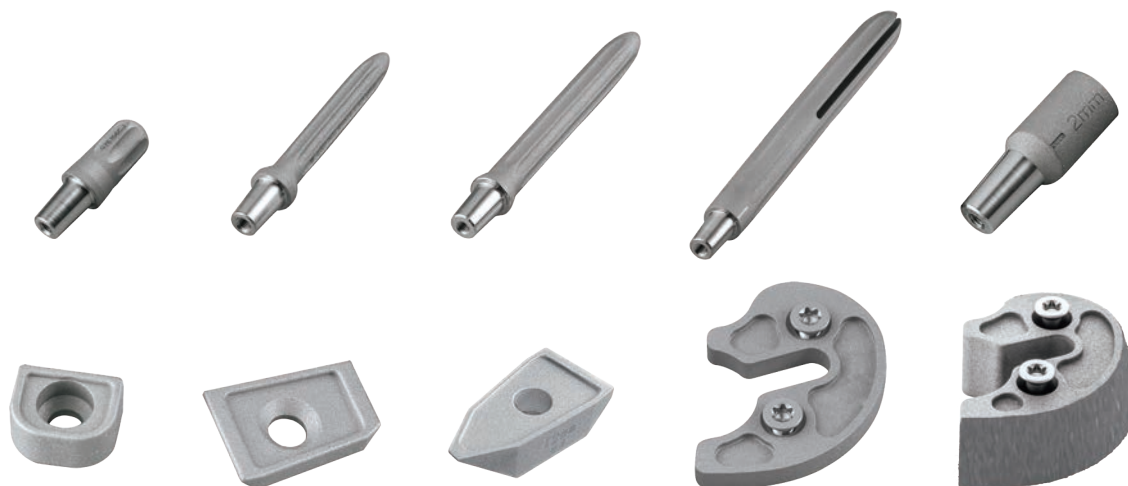



Advanced Bearing Technology

Vitamin E Stabilized Highly Cross-linked UHMWPE

Wear Performance

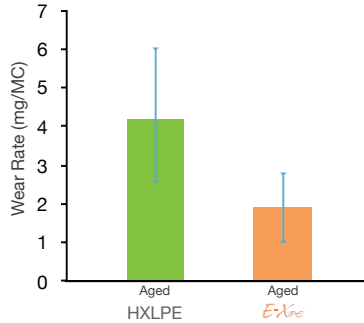

Extraordinary Wear Performance

E-XPE insert shows 60% reduction in gravimetric wear compared to HXLPE after accelerated aging.

Mechanical Strength

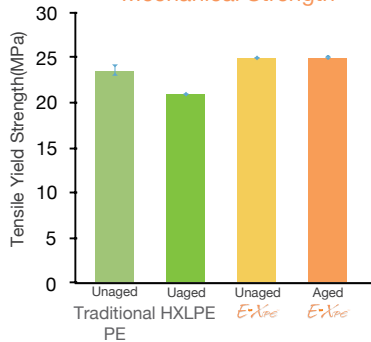

Enhanced Mechanical Property

No heat treatment is required after cross-linking process. Therefore, E-XPE shows a 20% improvement of tensile strength than highly cross-linked polyethylene.

Oxidative Stability

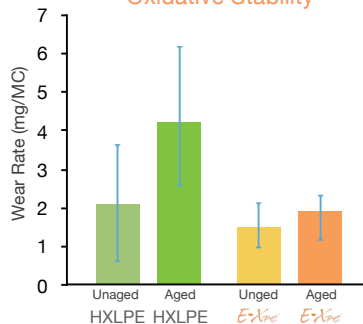

Superior Oxidative Stability

Surface oxidative index of E-XPE shows no oxidation after in vitro accelerated aging test.

U2 Knee Fixed Bearing System



CR

Cruciate Retaining

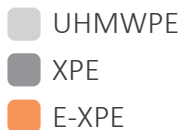

XUC

Ultracongruent



PS

Posterior Stabilized

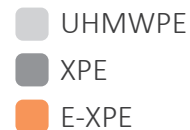

U2 Knee Mobile Bearing System



MBC

Mobile Bearing Congruent



MB

Mobile Bearing



U2 Knee Revision System



PSA

Posterior Stabilized
Augmentable



PSA LC

PSA Low Constrained



Reduce Table Clutter, Mitigate Infection Risk

U2 Knee AiO™

All-in-One Block

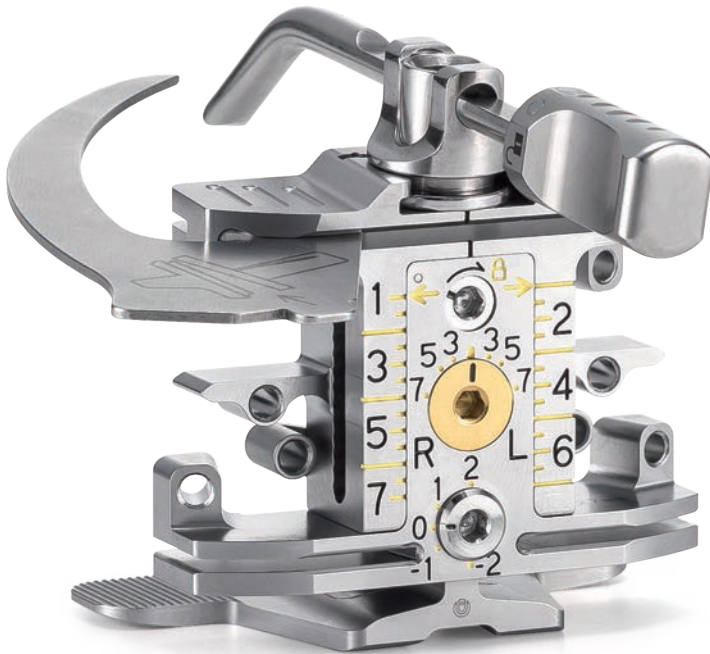

*No. US9974547

Accommodates all 13 sizes of anterior and posterior femoral cuts in one block



7 chamfer cutting guide sizes available for 13 femoral components

U2 Knee MDT™

Modular Disposable Trial



Single-use convenience, reduces sterilization, reprocessing costs and infection risk

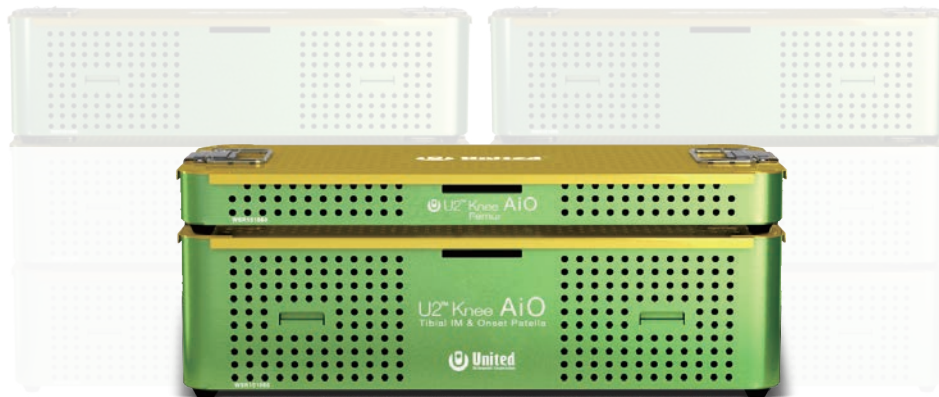

When used together, the U2 Knee AiO™ and MDT™ can reduce instrument trays count from 6 to 1.5

U2 Femoral Component

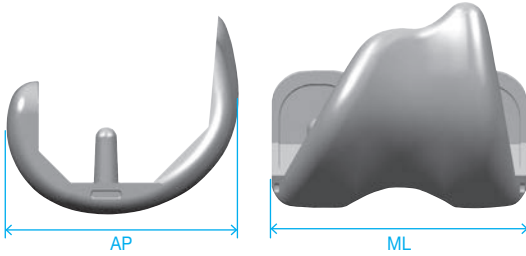

Size	#1	#1.5	#2	#2.5	#3	#3.5	#4	#4.5	#5	#5.5	#6	#6.5	#7
AP	52	54	56	58	60	62	64	66	68	70	72	74	76
ML	56	58	60	62	64	66	68	70	72	74	76	78	80

U2 Tibial Baseplate

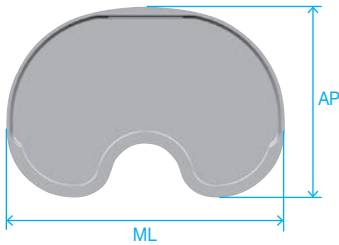

Size	#0	#1	#2	#3	#4	#5	#6	#7
AP	39.5	42	44.5	47	49.5	52.5	55.5	58.5
ML	60	63	66	69	72	76	80	84

Onset Patellar Component

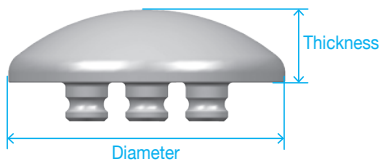

Size	XS	S	M	L	XL	XXL	EL
Thickness	7	8	8.5	9	9.5	10	10.5
Diameter	26	29	32	35	38	41	44

Inset Patellar Component

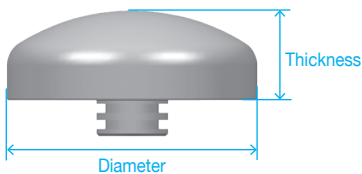

Size	S	M	L	XL
Thickness	8	10	10	10
Diameter	22	25	28	32

Unit : mm

Order Information

U2 Femoral Component

 Special Order Items



Cemented CR

Porous CR



PS



PSA

	Left	Right	Left	Right
#1	2103-1310	2103-1410	2103-1110	2103-1210
#1.5	2103-1315	2103-1415	2103-1115	2103-1215
#2	2103-1320	2103-1420	2103-1120	2103-1220
#2.5	2103-1325	2103-1425	2103-1125	2103-1225
#3	2103-1330	2103-1430	2103-1130	2103-1230
#3.5	2103-1335	2103-1435	2103-1135	2103-1235
#4	2103-1340	2103-1440	2103-1140	2103-1240
#4.5	2103-1345	2103-1445	2103-1145	2103-1245
#5	2103-1350	2103-1450	2103-1150	2103-1250
#5.5	2103-1355	2103-1455	2103-1155	2103-1255
#6	2103-1360	2103-1460	2103-1160	2103-1260
#6.5	2103-1365	2103-1465	2103-1165	2103-1265
#7	2103-1370	2103-1470	2103-1170	2103-1270

	Left	Right
#1	2103-3110	2103-3210
#1.5	2103-3115	2103-3215
#2	2103-3120	2103-3220
#2.5	2103-3125	2103-3225
#3	2103-3130	2103-3230
#3.5	2103-3135	2103-3235
#4	2103-3140	2103-3240
#4.5	2103-3145	2103-3245
#5	2103-3150	2103-3250
#5.5	2103-3155	2103-3255
#6	2103-3160	2103-3260
#6.5	2103-3165	2103-3265
#7	2103-3170	2103-3270

	Left	Right
#1	2103-5110	2103-5210
#2	2103-5120	2103-5220
#3	2103-5130	2103-5230
#4	2103-5140	2103-5240
#5	2103-5150	2103-5250
#6	2103-5160	2103-5260

U2 Tibial Tray



CMA

#0	2203-3200
#1	2203-3210
#2	2203-3220
#3	2203-3230
#4	2203-3240
#5	2203-3250
#6	2203-3260
#7	2203-3270



Mobile Bearing

#1	2203-7010
#2	2203-7020
#3	2203-7030
#4	2203-7040
#5	2203-7050
#6	2203-7060



PSA

#1	2203-5210
#2	2203-5220
#3	2203-5230
#4	2203-5240
#5	2203-5250
#6	2203-5260

Tibial Insert



CR Insert

	UHMWPE									
	9 mm	10 mm	11 mm	12 mm	13 mm	14 mm	15 mm	16 mm	17 mm	18 mm
#0	2303-1201	2303-1206	2303-1202	2303-1207	2303-1203	2303-1208	2303-1204	2303-1209	2303-1200	2303-1205
#1	2303-1211	2303-1216	2303-1212	2303-1217	2303-1213	2303-1218	2303-1214	2303-1219	2303-1210	2303-1215
#2	2303-1221	2303-1226	2303-1222	2303-1227	2303-1223	2303-1228	2303-1224	2303-1229	2303-1220	2303-1225
#3	2303-1231	2303-1236	2303-1232	2303-1237	2303-1233	2303-1238	2303-1234	2303-1239	2303-1230	2303-1235
#4	2303-1241	2303-1246	2303-1242	2303-1247	2303-1243	2303-1248	2303-1244	2303-1249	2303-1240	2303-1245
#5	2303-1251	2303-1256	2303-1252	2303-1257	2303-1253	2303-1258	2303-1254	2303-1259	2303-1250	2303-1255
#6	2303-1261	2303-1266	2303-1262	2303-1267	2303-1263	2303-1268	2303-1264	2303-1269	2303-1260	2303-1265
#7	2303-1271	2303-1276	2303-1272	2303-1277	2303-1273	2303-1278	2303-1274	2303-1279	2303-1270	2303-1275

	XPE									
	9 mm	10 mm	11 mm	12 mm	13 mm	14 mm	15 mm	16 mm	17 mm	18 mm
#0	2303-1601	2303-1606	2303-1602	2303-1607	2303-1603	2303-1608	2303-1604	2303-1609	2303-1600	2303-1605
#1	2303-1611	2303-1616	2303-1612	2303-1617	2303-1613	2303-1618	2303-1614	2303-1619	2303-1610	2303-1615
#2	2303-1621	2303-1626	2303-1622	2303-1627	2303-1623	2303-1628	2303-1624	2303-1629	2303-1620	2303-1625
#3	2303-1631	2303-1636	2303-1632	2303-1637	2303-1633	2303-1638	2303-1634	2303-1639	2303-1630	2303-1635
#4	2303-1641	2303-1646	2303-1642	2303-1647	2303-1643	2303-1648	2303-1644	2303-1649	2303-1640	2303-1645
#5	2303-1651	2303-1656	2303-1652	2303-1657	2303-1653	2303-1658	2303-1654	2303-1659	2303-1650	2303-1655
#6	2303-1661	2303-1666	2303-1662	2303-1667	2303-1663	2303-1668	2303-1664	2303-1669	2303-1660	2303-1665
#7	2303-1671	2303-1676	2303-1672	2303-1677	2303-1673	2303-1678	2303-1674	2303-1679	2303-1670	2303-1675



CR Insert

E-XPE										
	9 mm	10 mm	11 mm	12 mm	13 mm	14 mm	15 mm	16 mm	17 mm	18 mm
#0	2303-1801	2303-1806	2303-1802	2303-1807	2303-1803	2303-1808	2303-1804	2303-1809	2303-1800	2303-1805
#1	2303-1811	2303-1816	2303-1812	2303-1817	2303-1813	2303-1818	2303-1814	2303-1819	2303-1810	2303-1815
#2	2303-1821	2303-1826	2303-1822	2303-1827	2303-1823	2303-1828	2303-1824	2303-1829	2303-1820	2303-1825
#3	2303-1831	2303-1836	2303-1832	2303-1837	2303-1833	2303-1838	2303-1834	2303-1839	2303-1830	2303-1835
#4	2303-1841	2303-1846	2303-1842	2303-1847	2303-1843	2303-1848	2303-1844	2303-1849	2303-1840	2303-1845
#5	2303-1851	2303-1856	2303-1852	2303-1857	2303-1853	2303-1858	2303-1854	2303-1859	2303-1850	2303-1855
#6	2303-1861	2303-1866	2303-1862	2303-1867	2303-1863	2303-1868	2303-1864	2303-1869	2303-1860	2303-1865
#7	2303-1871	2303-1876	2303-1872	2303-1877	2303-1873	2303-1878	2303-1874	2303-1879	2303-1870	2303-1875

Tibial Insert



PS Insert

UHMWPE										
	9 mm	10 mm	11 mm	12 mm	13 mm	14 mm	15 mm	16 mm	17 mm	18 mm
#0	2303-3001	2303-3006	2303-3002	2303-3007	2303-3003	2303-3008	2303-3004	2303-3009	2303-3000	N/A
#1	2303-3011	2303-3016	2303-3012	2303-3017	2303-3013	2303-3018	2303-3014	2303-3019	2303-3010	2303-3015
#2	2303-3021	2303-3026	2303-3022	2303-3027	2303-3023	2303-3028	2303-3024	2303-3029	2303-3020	2303-3025
#3	2303-3031	2303-3036	2303-3032	2303-3037	2303-3033	2303-3038	2303-3034	2303-3039	2303-3030	2303-3035
#4	2303-3041	2303-3046	2303-3042	2303-3047	2303-3043	2303-3048	2303-3044	2303-3049	2303-3040	2303-3045
#5	2303-3051	2303-3056	2303-3052	2303-3057	2303-3053	2303-3058	2303-3054	2303-3059	2303-3050	2303-3055
#6	2303-3061	2303-3066	2303-3062	2303-3067	2303-3063	2303-3068	2303-3064	2303-3069	2303-3060	2303-3065
#7	2303-3071	2303-3076	2303-3072	2303-3077	2303-3073	2303-3078	2303-3074	2303-3079	2303-3070	2303-3075

XPE										
	9 mm	10 mm	11 mm	12 mm	13 mm	14 mm	15 mm	16 mm	17 mm	18 mm
#0	2303-3601	2303-3606	2303-3602	2303-3607	2303-3603	2303-3608	2303-3604	2303-3609	2303-3600	N/A
#1	2303-3611	2303-3616	2303-3612	2303-3617	2303-3613	2303-3618	2303-3614	2303-3619	2303-3610	2303-3615
#2	2303-3621	2303-3626	2303-3622	2303-3627	2303-3623	2303-3628	2303-3624	2303-3629	2303-3620	2303-3625
#3	2303-3631	2303-3636	2303-3632	2303-3637	2303-3633	2303-3638	2303-3634	2303-3639	2303-3630	2303-3635
#4	2303-3641	2303-3646	2303-3642	2303-3647	2303-3643	2303-3648	2303-3644	2303-3649	2303-3640	2303-3645
#5	2303-3651	2303-3656	2303-3652	2303-3657	2303-3653	2303-3658	2303-3654	2303-3659	2303-3650	2303-3655
#6	2303-3661	2303-3666	2303-3662	2303-3667	2303-3663	2303-3668	2303-3664	2303-3669	2303-3660	2303-3665
#7	2303-3671	2303-3676	2303-3672	2303-3677	2303-3673	2303-3678	2303-3674	2303-3679	2303-3670	2303-3675



PS Insert

E-XPE										
	9 mm	10 mm	11 mm	12 mm	13 mm	14 mm	15 mm	16 mm	17 mm	18 mm
#0	2303-3801	2303-3806	2303-3802	2303-3807	2303-3803	2303-3808	2303-3804	2303-3809	2303-3800	N/A
#1	2303-3811	2303-3816	2303-3812	2303-3817	2303-3813	2303-3818	2303-3814	2303-3819	2303-3810	2303-3815
#2	2303-3821	2303-3826	2303-3822	2303-3827	2303-3823	2303-3828	2303-3824	2303-3829	2303-3820	2303-3825
#3	2303-3831	2303-3836	2303-3832	2303-3837	2303-3833	2303-3838	2303-3834	2303-3839	2303-3830	2303-3835
#4	2303-3841	2303-3846	2303-3842	2303-3847	2303-3843	2303-3848	2303-3844	2303-3849	2303-3840	2303-3845
#5	2303-3851	2303-3856	2303-3852	2303-3857	2303-3853	2303-3858	2303-3854	2303-3859	2303-3850	2303-3855
#6	2303-3861	2303-3866	2303-3862	2303-3867	2303-3863	2303-3868	2303-3864	2303-3869	2303-3860	2303-3865
#7	2303-3871	2303-3876	2303-3872	2303-3877	2303-3873	2303-3878	2303-3874	2303-3879	2303-3870	2303-3875

Tibial Insert



XUC Insert

	XPE									
	9 mm	10 mm	11 mm	12 mm	13 mm	14 mm	15 mm	16 mm	17 mm	18 mm
#0	2303-1401	2303-1406	2303-1402	2303-1407	2303-1403	2303-1408	2303-1404	2303-1409	2303-1400	2303-1405
#1	2303-1411	2303-1416	2303-1412	2303-1417	2303-1413	2303-1418	2303-1414	2303-1419	2303-1410	2303-1415
#2	2303-1421	2303-1426	2303-1422	2303-1427	2303-1423	2303-1428	2303-1424	2303-1429	2303-1420	2303-1425
#3	2303-1431	2303-1436	2303-1432	2303-1437	2303-1433	2303-1438	2303-1434	2303-1439	2303-1430	2303-1435
#4	2303-1441	2303-1446	2303-1442	2303-1447	2303-1443	2303-1448	2303-1444	2303-1449	2303-1440	2303-1445
#5	2303-1451	2303-1456	2303-1452	2303-1457	2303-1453	2303-1458	2303-1454	2303-1459	2303-1450	2303-1455
#6	2303-1461	2303-1466	2303-1462	2303-1467	2303-1463	2303-1468	2303-1464	2303-1469	2303-1460	2303-1465
#7	2303-1471	2303-1476	2303-1472	2303-1477	2303-1473	2303-1478	2303-1474	2303-1479	2303-1470	2303-1475



XUC Insert

	E-XPE									
	9 mm	10 mm	11 mm	12 mm	13 mm	14 mm	15 mm	16 mm	17 mm	18 mm
#0	2303-1701	2303-1706	2303-1702	2303-1707	2303-1703	2303-1708	2303-1704	2303-1709	2303-1700	2303-1705
#1	2303-1711	2303-1716	2303-1712	2303-1717	2303-1713	2303-1718	2303-1714	2303-1719	2303-1710	2303-1715
#2	2303-1721	2303-1726	2303-1722	2303-1727	2303-1723	2303-1728	2303-1724	2303-1729	2303-1720	2303-1725
#3	2303-1731	2303-1736	2303-1732	2303-1737	2303-1733	2303-1738	2303-1734	2303-1739	2303-1730	2303-1735
#4	2303-1741	2303-1746	2303-1742	2303-1747	2303-1743	2303-1748	2303-1744	2303-1749	2303-1740	2303-1745
#5	2303-1751	2303-1756	2303-1752	2303-1757	2303-1753	2303-1758	2303-1754	2303-1759	2303-1750	2303-1755
#6	2303-1761	2303-1766	2303-1762	2303-1767	2303-1763	2303-1768	2303-1764	2303-1769	2303-1760	2303-1765
#7	2303-1771	2303-1776	2303-1772	2303-1777	2303-1773	2303-1778	2303-1774	2303-1779	2303-1770	2303-1775



MBC Insert

	UHMWPE				
	9 mm	11 mm	13 mm	15 mm	18 mm
#1	2303-7211	2303-7212	2303-7213	2303-7214	2303-7215
#2	2303-7221	2303-7222	2303-7223	2303-7224	2303-7225
#3	2303-7231	2303-7232	2303-7233	2303-7234	2303-7235
#4	2303-7241	2303-7242	2303-7243	2303-7244	2303-7245
#5	2303-7251	2303-7252	2303-7253	2303-7254	2303-7255
#6	2303-7261	2303-7262	2303-7263	2303-7264	2303-7265



MB Insert

	UHMWPE				
	9 mm	11 mm	13 mm	15 mm	18 mm
#1	2303-7011	2303-7012	2303-7013	2303-7014	2303-7015
#2	2303-7021	2303-7022	2303-7023	2303-7024	2303-7025
#3	2303-7031	2303-7032	2303-7033	2303-7034	2303-7035
#4	2303-7041	2303-7042	2303-7043	2303-7044	2303-7045
#5	2303-7051	2303-7052	2303-7053	2303-7054	2303-7055
#6	2303-7061	2303-7062	2303-7063	2303-7064	2303-7065

Tibial Insert



PSA Insert

UHMWPE								
	9 mm	11 mm	13 mm	15 mm	18 mm	21 mm	25 mm	30 mm
#1	2303-5011	2303-5012	2303-5013	2303-5014	2303-5015	2303-5016	2303-5017	2303-5018
#2	2303-5021	2303-5022	2303-5023	2303-5024	2303-5025	2303-5026	2303-5027	2303-5028
#3	2303-5031	2303-5032	2303-5033	2303-5034	2303-5035	2303-5036	2303-5037	2303-5038
#4	2303-5041	2303-5042	2303-5043	2303-5044	2303-5045	2303-5046	2303-5047	2303-5048
#5	2303-5051	2303-5052	2303-5053	2303-5054	2303-5055	2303-5056	2303-5057	2303-5058
#6	2303-5061	2303-5062	2303-5063	2303-5064	2303-5065	2303-5066	2303-5067	2303-5068

XPE								
	9 mm	11 mm	13 mm	15 mm	18 mm	21 mm	25 mm	30 mm
#1	2303-5611	2303-5612	2303-5613	2303-5614	2303-5615	2303-5616	2303-5617	2303-5618
#2	2303-5621	2303-5622	2303-5623	2303-5624	2303-5625	2303-5626	2303-5627	2303-5628
#3	2303-5631	2303-5632	2303-5633	2303-5634	2303-5635	2303-5636	2303-5637	2303-5638
#4	2303-5641	2303-5642	2303-5643	2303-5644	2303-5645	2303-5646	2303-5647	2303-5648
#5	2303-5651	2303-5652	2303-5653	2303-5654	2303-5655	2303-5656	2303-5657	2303-5658
#6	2303-5661	2303-5662	2303-5663	2303-5664	2303-5665	2303-5666	2303-5667	2303-5668



PSA Insert

	E-XPE							
	9 mm	11 mm	13 mm	15 mm	18 mm	21 mm	25 mm	30 mm
#1	2303-5811	2303-5812	2303-5813	2303-5814	2303-5815	2303-5816	2303-5817	2303-5818
#2	2303-5821	2303-5822	2303-5823	2303-5824	2303-5825	2303-5826	2303-5827	2303-5828
#3	2303-5831	2303-5832	2303-5833	2303-5834	2303-5835	2303-5836	2303-5837	2303-5838
#4	2303-5841	2303-5842	2303-5843	2303-5844	2303-5845	2303-5846	2303-5847	2303-5848
#5	2303-5851	2303-5852	2303-5853	2303-5854	2303-5855	2303-5856	2303-5857	2303-5858
#6	2303-5861	2303-5862	2303-5863	2303-5864	2303-5865	2303-5866	2303-5867	2303-5868



PSA Insert Low Constrained

	XPE, LC type							
	9 mm	11 mm	13 mm	15 mm	18 mm	21 mm	25 mm	30 mm
#1	2303-5211	2303-5212	2303-5213	2303-5214	2303-5215	2303-5216	2303-5217	2303-5218
#2	2303-5221	2303-5222	2303-5223	2303-5224	2303-5225	2303-5226	2303-5227	2303-5228
#3	2303-5231	2303-5232	2303-5233	2303-5234	2303-5235	2303-5236	2303-5237	2303-5238
#4	2303-5241	2303-5242	2303-5243	2303-5244	2303-5245	2303-5246	2303-5247	2303-5248
#5	2303-5251	2303-5252	2303-5253	2303-5254	2303-5255	2303-5256	2303-5257	2303-5258
#6	2303-5261	2303-5262	2303-5263	2303-5264	2303-5265	2303-5266	2303-5267	2303-5268

Patella Component

 Special Order Items



Inset Patella

Size	UHMWPE	XPE	E-XPE
S	2401-1010	2403-3010	2403-5010
M	2401-1020	2403-3020	2403-5020
L	2401-1030	2403-3030	2403-5030
XL	2401-1040	2403-3040	2403-5040



Onset Patella

Size	UHMWPE	XPE	E-XPE
XS	2403-1010	2403-3210	2403-5210
S	2403-1020	2403-3220	2403-5220
M	2403-1030	2403-3230	2403-5230
L	2403-1040	2403-3240	2403-5240
XL	2403-1050	2403-3250	2403-5250
XXL	2403-1060	2403-3260	2403-5260
EL	2403-1070	2403-3270	2403-5270

Extensions

Femoral Augment Set



	Distal				Distal		Posterior	
	4 mm LM/RL	4 mm LL/RM	8 mm LM/RL	8 mm LL/RM	12 mm	16 mm	4 mm	8 mm
#1	2603-5111	2603-5211	2603-5112	2603-5212	2603-5313	2603-5314	2603-5011	2603-5012
#2	2603-5121	2603-5221	2603-5122	2603-5222	2603-5323	2603-5324	2603-5021	2603-5022
#3	2603-5131	2603-5231	2603-5132	2603-5232	2603-5333	2603-5334	2603-5031	2603-5032
#4	2603-5141	2603-5241	2603-5142	2603-5242	2603-5343	2603-5344	2603-5041	2603-5042
#5	2603-5151	2603-5251	2603-5152	2603-5252	2603-5353	2603-5354	2603-5051	2603-5052
#6	2603-5161	2603-5261	2603-5162	2603-5262	2603-5363	2603-5364	2603-5061	2603-5062

Extensions

 Special Order Items

Tibial Augment



	5 mm	10 mm	15 mm LM/RL	15 mm LL/RM
#0	2803-5201	2803-5202	N/A	N/A
#1	2803-5211	2803-5212	2803-5113	2803-5213
#2	2803-5221	2803-5222	2803-5123	2803-5223
#3	2803-5231	2803-5232	2803-5133	2803-5233
#4	2803-5241	2803-5242	2803-5143	2803-5243
#5	2803-5251	2803-5252	2803-5153	2803-5253
#6	2803-5261	2803-5262	2803-5163	2803-5263
#7	2803-5271	2803-5272	N/A	N/A

Offset Adaptor



2 mm	2903-3010
4 mm	2903-3020
6 mm	2903-3030

PSA Femoral Screw



M5 x 14 mm	2903-1014
------------	-----------

Extension Stem



	Straight Stem					Curved Stem	
	30 mm	75 mm	100 mm	150 mm	200 mm	150 mm	200 mm
Ø10	N/A	2703-5011	2703-5021	2703-5051	2703-5061	2703-5031	2703-5041
Ø12	N/A	2703-5012	2703-5022	2703-5052	2703-5062	2703-5032	2703-5042
Ø14	2703-5003	2703-5013	2703-5023	2703-5053	2703-5063	2703-5033	2703-5043
Ø16	N/A	2703-5014	2703-5024	2703-5054	2703-5064	2703-5034	2703-5044
Ø18	N/A	2703-5016	2703-5026	2703-5055	2703-5066	2703-5036	2703-5046
Ø20	N/A	2703-5016	2703-5026	2703-5056	2703-5066	2703-5036	2703-5046

Note:

5 mm / 10 mm augments and 30 mm straight stem are compatible with CMA Baseplate #0, #7 augments are not available with PSA baseplate



Each Step **We Care**

Contact Us

■ Taiwan

United Orthopedic Corporation

12F, No.80, Sec.1, Chenggong Rd., Yonghe Dist.,
New Taipei City 23452, Taiwan

Tel: +886 2 2929 4567 Fax: +886 2 2922 4567

■ China

United Medical Instrument Co., Ltd.

Room 402, Building 7, No.697, Ling Shi Road,
ShangHai 200072, China

Tel: +86 21 3661 8055 Fax: +86 21 6628 3031

■ Japan

United Biomech Japan Inc.

Ginyo Bldg 5th floor, 2-9-40 Kitasaiwai, Nishi-Ku
Yokohama City, Kanagawa, 220-0004, Japan

Tel: +81 45 620 0741 Fax: +81 45 620 0742

■ USA

UOC USA Inc.

20, Fairbanks, Suite 173, Irvine 92618, CA

Tel: +1 949 328 3366 Fax: +1 949 328 3367

■ EU Representative

mdi Europa GmbH

Langenhagener Strasse 71, Langenhagen 30855, Germany

Tel: +49 511 3908 9530 Fax: +49 511 3908 9539

■ Europe

UOC (Suisse) SA

Avenue Général Guisan 60A, 1009 Pully, Switzerland

Tel: +41 21 634 70 70 Fax: +41 21 634 70 76

UOC (France) SAS

7 Allée des Peupliers, 54180 Houdemont, France

Tel: +33 3 83 23 39 72 Fax: +33 3 83 23 39 10

UOC (UK) Limited

Baileys Barn, Pimlico Farm, Austrey Lane,

No Mans Heath, Warwickshire, B79 0PF, UK

Tel: +44 1827 214773



www.uoc.com.tw