

Stay aware of your surroundings. Identify areas of concern. Act instantly.

- See the whole picture with Smart Map in XProtect®

Smart Map is a map function embedded in the XProtect® Smart Client. With its native support for GIS maps and CAD drawings, and support for online map services like Google maps and Bing maps, it visualizes the elements of a surveillance system with geographical, accurate, real-world imagery.

The life of a security operator is not always straightforward. It is their job to guarantee the safety and security of people, premises, and assets. It requires them to be always on top of everything. Large-scale operations often span multiple geographical sites and feature thousands of cameras, sensors, audio devices, doors, and other input devices. Getting a complete overview of a large security installation is no easy task. With Smart Map, we make the security operators' lives easier.



Visualize the installation

It can be hard to remember where each camera and other types of devices are placed in installations that comprise thousands of devices spread across multiple locations. With Smart Map, security operators get real-time visualizations of their unique installation with device icons displaying exact location, status, and field of view.

Key benefits

- Provides visualization of the entire installation.
- Increases system overview and situational awareness.
- Enables seamless geo-navigation.

Key features

- Supports Google Maps and Bing Maps.
- Includes an embedded Milestone Map Service that works out of the box and offers the same functions and visual overviews as other supported online map services.
- Supports the display of cameras, alarms, microphones, and other input devices directly on the map.



Gain situational awareness

Smart Map helps the operators see their entire operation and quickly identify potential threats or emergencies. Alarms are displayed directly on the map, with live or recorded footage just a click away, so they can quickly assess the situation and take immediately action.

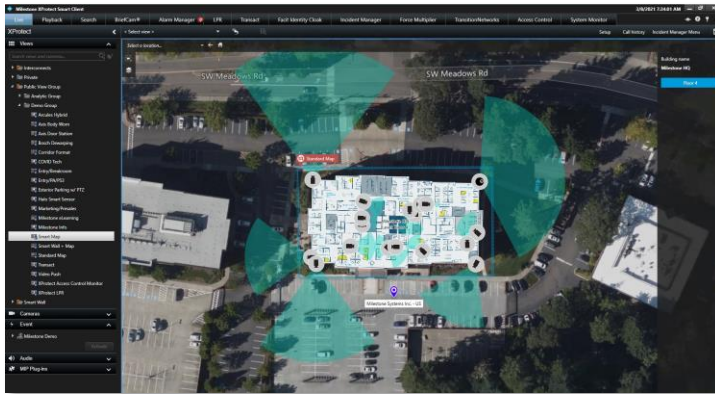

Navigate effortlessly

Smart Map provides operators with instant access to any camera in a XProtect® Corporate or XProtect® Expert VMS system, or any interconnected camera in a remote edge system. It allows operators to navigate easily between different sites and locations via Quick Links placed directly on the Smart Map. This functionality enables the operator to navigate their operation, regardless of size, efficiently.

Control room collaboration

To facilitate efficient collaboration and information exchange in control centers, the Smart Map can be shared on Milestone's video wall solution, the XProtect® Smart Wall. Operators may likewise send individual, or groups of, cameras on the Smart Map to the XProtect Smart Wall, through a few simple clicks.

Creating maps

Smart Map uses online map services and is capable of reusing customer-specific GIS maps and CAD drawings. This means that existing material can be used directly without conversion. Using an easy drag-and-drop and point-and-click definition of cameras, camera field of view, location links and quick links, makes Smart Map easy to populate with cameras and navigation links.

- Ability for users to toggle different map layers on and off.
- Location links for quick navigation across different sites and locations.
- Instant multi-camera selection with camera preview.

Device clustering

- To maintain an easy and clear navigation, Smart Map combines individual devices into clusters when zooming out.



Selection of icons

- Offers a selection of different camera and device icons to reflect device capabilities and to contrast in relation to the underlying map.

Supported products

XProtect Corporate
XProtect Expert

Milestone Systems is a global industry leader in open platform IP video management software, founded in 1998 and now operating as a standalone company in the Canon Group. Milestone technology is easy to manage, reliable and proven in thousands of customer installations, providing flexible choices in network hardware and integrations with other systems. Sold through partners in more than 100 countries, Milestone solutions help organizations to manage risks, protect people and assets, optimize processes, and reduce costs.