

Atlas SPEEDER Head/Neck

APPLICATION

The Atlas SPEEDER Head/Neck (MJAH-177A) is designed for optimal imaging of the head, neck and feet using Atlas SPEEDER advanced parallel imaging technology.

APPLICABLE SYSTEMS

This coil is applicable to the following systems.

System	Software version
Vantage Orian	V4.5 or later
Vantage Fortian	V8.0 or later
Vantage Titan [‡]	V3.1 or later

[‡] To use this coil, RF Receiver Upgrade kit must be installed in the system.

COMPOSITION

- Atlas SPEEDER Head/Neck.....1 set
 - Head/Neck base
 - NV adapter
 - Cervical adapter
 - Base adapter
- Mirror1
- Mats and pads (Tilt pad etc.).....1 set
- Operation manual.....1

PERFORMANCE SPECIFICATIONS

This array coil is part of the Atlas integrated coil design and can be used in combination with the Atlas SPEEDER Spine and Atlas SPEEDER Body. This advanced coil technology permits the use of up to 16 coil elements for excellent coverage as well as a high signal-to-noise ratio. Its patient-friendly design gives the patient a greater feeling of openness.

APPLICABLE SPINE COIL COMBINATION

- Atlas SPEEDER Spine

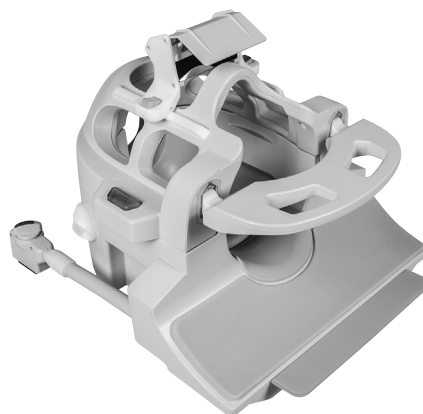

APPLICABLE CODES

- IEC 60601-1 (1988) + Amendment 1 (1991)
+ Amendment 2 (1995)
- IEC 60601-1 (2005) + Amendment 1 (2012)
+ Amendment 2 (2020)
- IEC 60601-1-2 (2001) + Amendment 1 (2004)
- IEC 60601-1-2 (2007)
- IEC 60601-1-2 (2014) + Amendment 1 (2020)
- IEC 60601-2-33 (2002) + Amendment 1 (2005)
+ Amendment 2 (2007)
- IEC 60601-2-33 (2010) + Amendment 1 (2013)
+ Amendment 2 (2015)

IEC CLASSIFICATION

Class II
Type BF Applied Part

DIMENSIONS AND MASS

Unit	Dimensions W × D × H mm	Mass kg (Approx.)
Head/Neck base	542 × 479 × 221	4.2
NV adapter	485 × 417 × 179	2.2
Cervical adapter	493 × 417 × 174	1.7
Base adapter	343 × 417 × 47	0.9
Others		

Atlas SPEEDER Head/Neck

OUTLINE DRAWINGS

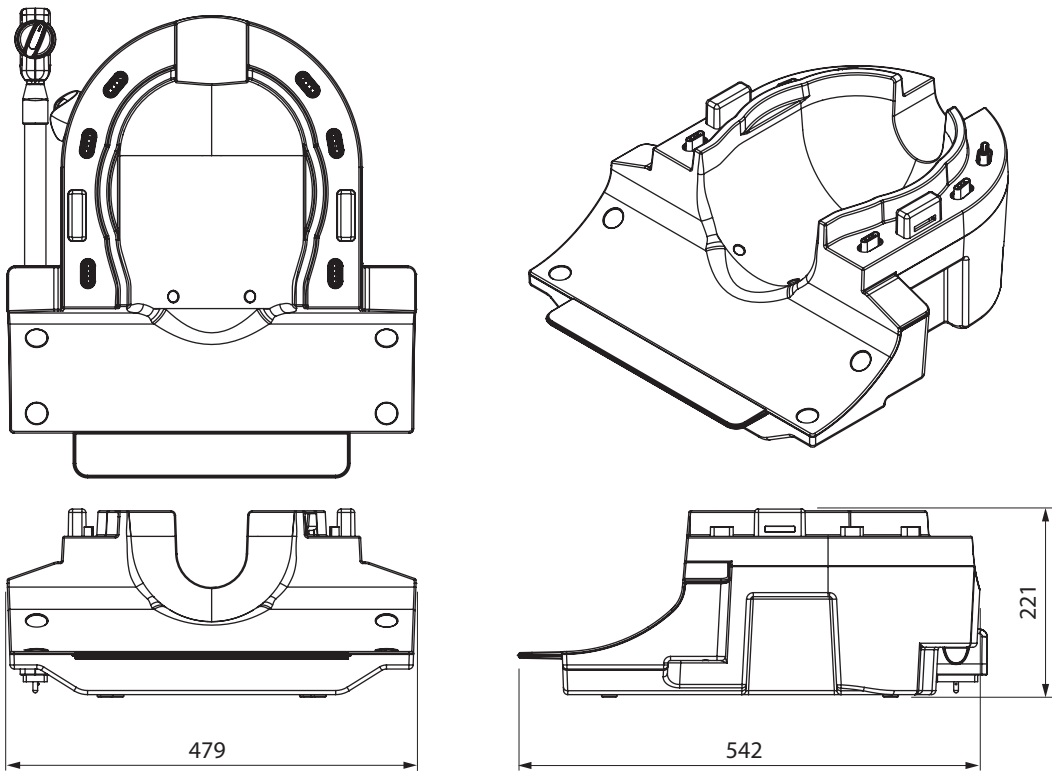

Head/Neck base

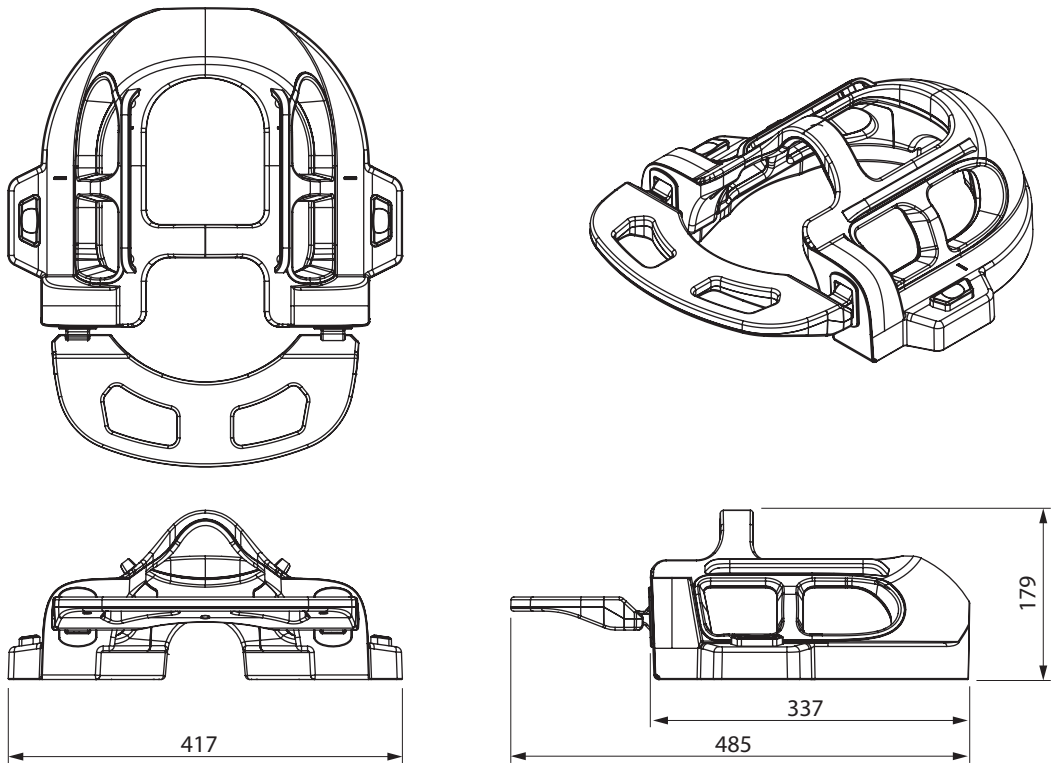

NV adapter

Unit: mm

OUTLINE DRAWINGS

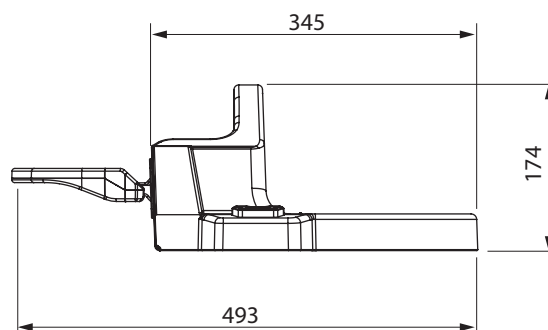
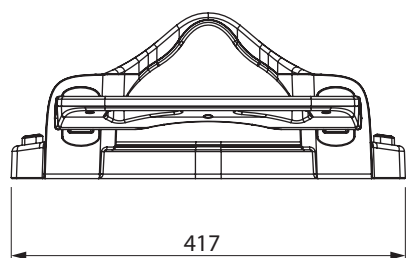
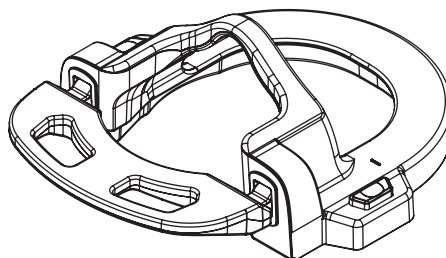
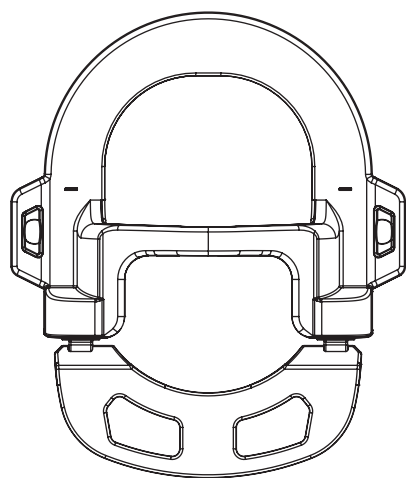
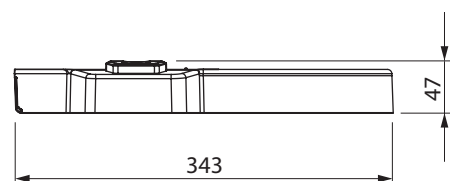
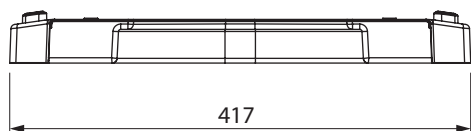
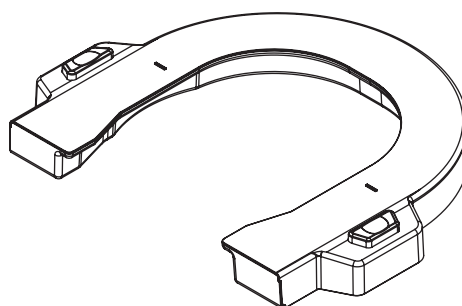
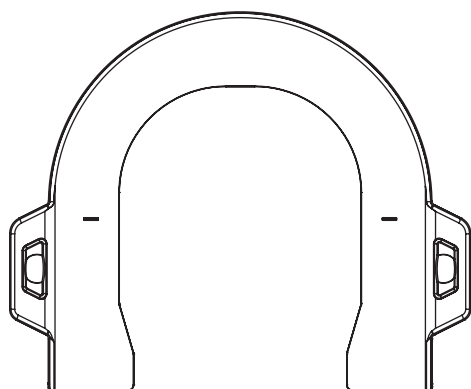
**Cervical adapter****Base adapter**

Unit: mm

OUTLINE DRAWINGS

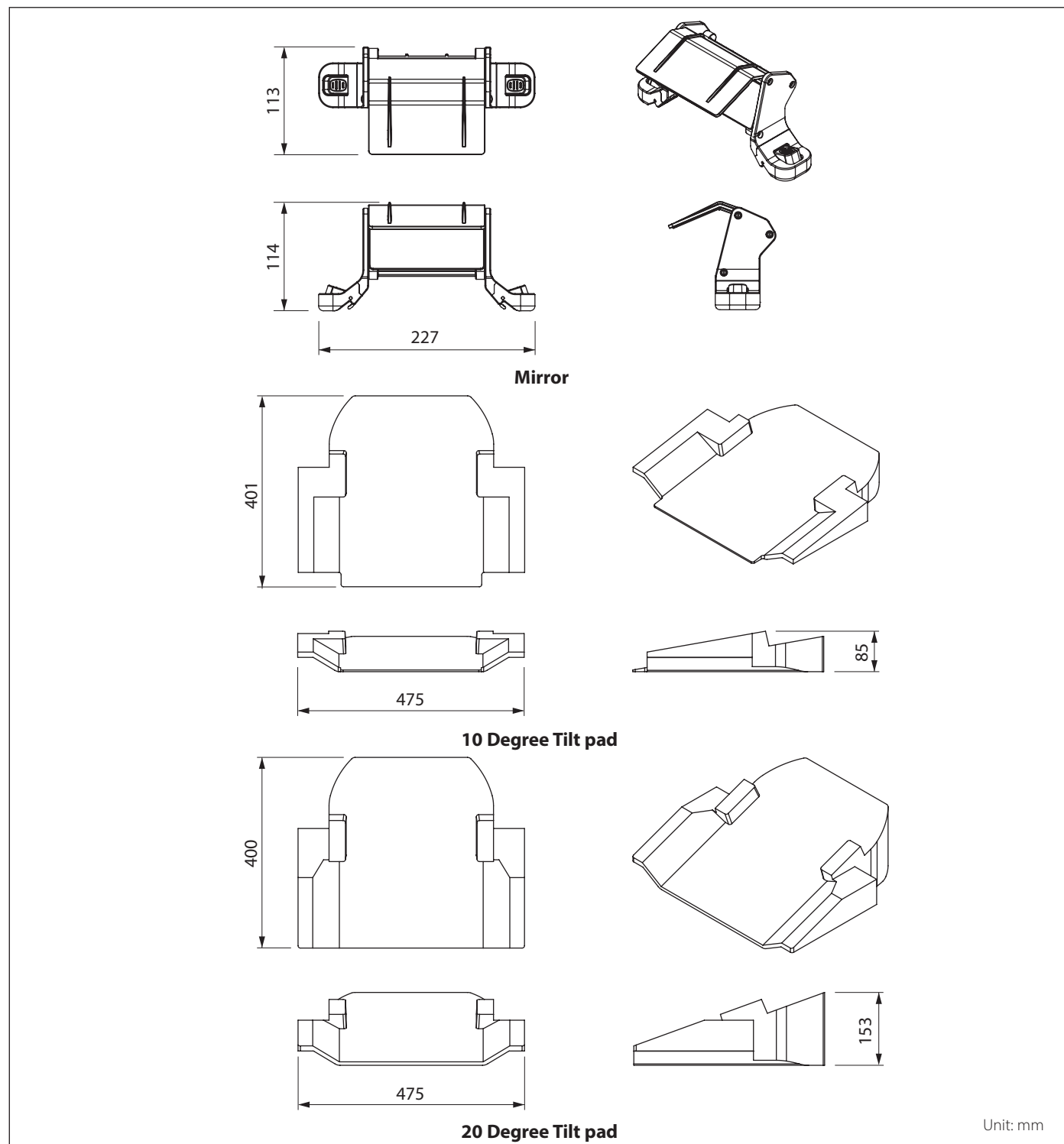

CANON MEDICAL SYSTEMS CORPORATION

1385, Shimoishigami, Otawara-shi, Tochigi 324-8550, Japan

<https://global.medical.canon>

©Canon Medical Systems Corporation 2014-2023. All rights reserved.

Design and specifications are subject to change without notice.

MPDMR0375EAF 2023-05 CMSC/Produced in Japan

Canon Medical Systems Corporation meets internationally recognized standards for Quality Management System ISO 9001, ISO 13485.

Canon Medical Systems Corporation meets the Environmental Management System standard ISO 14001.

Made For life