

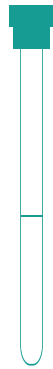

MEDICAL CONSUMABLES

CHANGSHA RENJI MEDICAL EQUIPMENT CO., LTD.

WWW.RENJIGROUP.COM

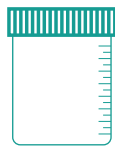
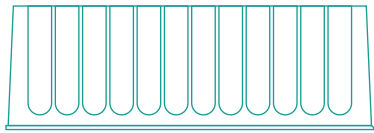

COMPANY PROFILE



“ALL-CHINA FEDERATION OF INDUSTRY&COMMERCE MEDICAL &PHARMACEUTICAL INDUSTRY CHAMBER”governing unit
 “White List” Enterprise of the Ministry of Commerce Medical Material Export

Changsha Renji Medical Equipment Co., Ltd. is a medical consumable products industrial chain company with developing and manufacturing a complete product line for molecular laboratories, ranging from upstream consumable medical products, nucleic acid extraction kits and full automatic instruments to downstream real time PCR diagnostic & research kits and fluorescence systems.

Based on innovative R&D center in Changsha, China, Renji understands its capability and social responsibility to offer molecular diagnostic products consistent in quality, accurate and reliable in test results, easy to use and accessible to laboratories of all levels despite their variety in lab environment. Renji is gradually winning its reputation all over the world through growing influence on popularizing RT-PCR technologies towards they are supposed to be as affordable and accessible human health care means.

In the future , “RENJI” will be committed to integrating the development of enterprise into the national health industry development strategy, building a new pattern of innovation and development and building a new high ground of modern medical plastics industry chain. “RENJI” will bear in mind the original intention that quality is the survival foundation of enterprise and product is equal to people’s charter to build “RENJI” brand and make progress hands in hands with counterparts at home and abroad for contribution to the human health.



ISO 13485



CE Certificate

BLOOD COLLECTION TUBE

2

SPECIMEN CONTAINER

9

BIOLOGICAL CULTURE VESSEL

16

CENTRIFUGR TUBE

21

CRYOVIALS

23

TEST TUBE

26

SWAB

29

TRANSFER PIPETTE

33

PIPETTE TIP

35

MEDICAL TESTING

39

HISTOLOGY & ACCESSORIES

43









LABORATORY INSTRUMENTS

45

PRODUCT CATALOG

Vacuum Blood Collection Tube

Product Category

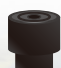
Category	Tube Name	Additive	Cap Colour	Tube Size(mm)	Draw Volume (mL)	Material
Serum Blood Collection Tube	No Additive	No Additive	 White	13x75	3.5/4	Glass/Plastic
				13x100	5/6/7	
				16x100	8/9/10	
	Clot Activator	Clot Activator	 Red	13x75	3.5/4	Glass/Plastic
				13x100	5/6/7	
				16x100	8/9/10	
	Gel & Clot Activator	Gel & Clot Activator	 Yellow	13x75	3.5/4	Glass/Plastic
				13x100	5/6/7	
				16x100	8/9/10	
Plasma Blood Collection Tube	EDTA & NaF	EDTA & NaF	 Grey	13x75	2/3/4	Glass/Plastic
				13x100	5	
				/	/	
	Lithium Heparin	Lithium Heparin	 Green	13x75	2/3/4	Glass/Plastic
				13x100	5/6/7	
				16x100	8/9/10	
	Sodium Heparin	Sodium Heparin	 Green	13x75	2/3/4	Glass/Plastic
				13x100	5/6/7	
				16x100	8/9/10	
	Sodium Citrate	Sodium Citrate	 Blue	13x75	2/3/4	Glass/Plastic
				13x100	5/6/7	
				16x100	8/9/10	
Whole Blood Collection Tube	K2EDTA	K2EDTA	 Purple	13x75	1/2/3/4	Glass/Plastic
				13x100	5/6/7	
				16x100	8/9/10	
	K3EDTA	K3EDTA	 Purple	13x75	1/2/3/4	Glass/Plastic
				13x100	5/6/7	
				16x100	8/9/10	
	ESR	Sodium Citrate	 Black	13x75	1.6/2/2.4/3/4	Glass/Plastic
				8x120	1.28/1.6	
				/	/	

The above table information does not include PRP blood collection tube and micro blood collection tube. For information on PRP blood collection tube and micro blood collection tube, please contact our sales manager.



Clot Activator

Clot Activator Tubes are covered with clot activator powder to accelerate blood coagulation.

Silica (clot activator) is used as the activator.

Serum is a substance freed from the fibrinogen but containing fragments of thrombocyte and product of the metabolism.

Usage: to research serum in the clinical chemistry, immunology, serology, protein electrophoresis.

Specimen: serum.

Clotting time: from 10 to 30 minutes.

Conditions of centrifugation: 1500-1800 g for 10 minutes.

REF	Tube Size (mm)	Draw Volume (mL)	Tube Materia	Pack/Carton
C104035			PET	100PCS/1200PCS
C304035	13x75	3.5mL	GLASS	100PCS/1200PCS
C104040			PET	100PCS/1200PCS
C304040	13x75	4mL	GLASS	100PCS/1200PCS
C104050			PET	100PCS/1200PCS
C304050	13x100	5mL	GLASS	100PCS/1200PCS
C104060			PET	100PCS/1200PCS
C304060	13x100	6mL	GLASS	100PCS/1200PCS
C104070			PET	100PCS/1200PCS
C304070	13x100	7mL	GLASS	100PCS/1200PCS
C104080			PET	100PCS/1200PCS
C304080	16x100	8mL	GLASS	100PCS/1200PCS
C104090			PET	100PCS/1200PCS
C304090	16x100	9mL	GLASS	100PCS/1200PCS
C104100			PET	100PCS/1200PCS
C304100	16x100	10mL	GLASS	100PCS/1200PCS



Gel & Clot Activator

As the activator it is used silica dioxide and biologically inert olefin gel.

Gel provides the separation of serum and clot up to 48 hours without re- centrifugation.

Gel is the special material intended for formation of barrier between cellular components of blood and serum during centrifugation.

Usage: to research serum in the clinical chemistry, immunology, serology, protein electrophoresis.

Specimen: serum.

Clotting time: from 5 to 30 minutes.

Conditions of centrifugation: 1800-2000 g for 10 minutes.

REF	Tube Size (mm)	Draw Volume (mL)	Tube Materia	Pack/Carton
C105035			PET	100PCS/1200PCS
C305035	13x75	3.5mL	GLASS	100PCS/1200PCS
C305040	13x75	4mL	GLASS	100PCS/1200PCS
C105050			PET	100PCS/1200PCS
C305050	13x100	5mL	GLASS	100PCS/1200PCS
C105060			PET	100PCS/1200PCS
C305060	13x100	6mL	GLASS	100PCS/1200PCS
C105070			PET	100PCS/1200PCS
C305070	13x100	7mL	GLASS	100PCS/1200PCS
C105080			PET	100PCS/1200PCS
C305080	16x100	8mL	GLASS	100PCS/1200PCS
C105090			PET	100PCS/1200PCS
C305090	16x100	9mL	GLASS	100PCS/1200PCS
C105100			PET	100PCS/1200PCS
C305100	16x100	10mL	GLASS	100PCS/1200PCS



K2EDTA

Intended to be used in hematology laboratory for withdrawing Whole blood or EDTA Plasma in order to examine various kinds of blood cells.

Tubes manufactured using transparent PET or Glass.Caps manufactured using polyethylene.

Specimen: whole blood.

After taking blood into the tube it should be mixed by turning 6-8 times. Lack of mixing can also cause platelet aggregation, coagulation or formation of micro clots.

■ In addition, we can provide EDTA blood collection tube with Na₂EDTA as additive. If you need to order, please contact our sales manager.

REF	Tube Size (mm)	Draw Volume (mL)	Tube Materia	Pack/Carton
C102010			PET	100PCS/1200PCS
C302010	13x75	1mL	GLASS	100PCS/1200PCS
C102020			PET	100PCS/1200PCS
C302020	13x75	2mL	GLASS	100PCS/1200PCS
C102030			PET	100PCS/1200PCS
C302030	13x75	3mL	GLASS	100PCS/1200PCS
C102040			PET	100PCS/1200PCS
C302040	13x75	4mL	GLASS	100PCS/1200PCS
C102050			PET	100PCS/1200PCS
C302050	13x100	5mL	GLASS	100PCS/1200PCS
C102060			PET	100PCS/1200PCS
C302060	13x100	6mL	GLASS	100PCS/1200PCS
C102070			PET	100PCS/1200PCS
C302070	13x100	7mL	GLASS	100PCS/1200PCS
C102080			PET	100PCS/1200PCS
C302080	16x100	8mL	GLASS	100PCS/1200PCS
C102090			PET	100PCS/1200PCS
C302090	16x100	9mL	GLASS	100PCS/1200PCS
C102100			PET	100PCS/1200PCS
C302100	16x100	10mL	GLASS	100PCS/1200PCS



K3EDTA

Intended to be used in hematology laboratory for withdrawing Whole blood or EDTA Plasma in order to examine various kinds of blood cells.

Tubes manufactured using transparent PET or Glass.Caps manufactured using polyethylene.

Specimen: whole blood.

After taking blood into the tube it should be mixed by turning 6-8 times. Lack of mixing can also cause platelet aggregation, coagulation or formation of micro clots.

■ In addition, we can provide EDTA blood collection tube with Na₂EDTA as additive. If you need to order, please contact our sales manager.

REF	Tube Size (mm)	Draw Volume (mL)	Tube Materia	Pack/Carton
C103010			PET	100PCS/1200PCS
C303010	13x75	1mL	GLASS	100PCS/1200PCS
C103020			PET	100PCS/1200PCS
C303020	13x75	2mL	GLASS	100PCS/1200PCS
C103030			PET	100PCS/1200PCS
C303030	13x75	3mL	GLASS	100PCS/1200PCS
C103040			PET	100PCS/1200PCS
C303040	13x75	4mL	GLASS	100PCS/1200PCS
C103050			PET	100PCS/1200PCS
C303050	13x100	5mL	GLASS	100PCS/1200PCS
C103060			PET	100PCS/1200PCS
C303060	13x100	6mL	GLASS	100PCS/1200PCS
C103070			PET	100PCS/1200PCS
C303070	13x100	7mL	GLASS	100PCS/1200PCS
C103080			PET	100PCS/1200PCS
C303080	16x100	8mL	GLASS	100PCS/1200PCS
C103090			PET	100PCS/1200PCS
C303090	16x100	9mL	GLASS	100PCS/1200PCS
C103100			PET	100PCS/1200PCS
C303100	16x100	10mL	GLASS	100PCS/1200PCS



Lithium Heparin

Heparin is a natural anticoagulant which presents in any healthy body. Heparin is used to take the plasma and in chemical researches.

Heparin Blood Collection Tubes are intended to be used for analysis of blood withdrawn from patients under anticoagulant therapy.

The anticoagulant heparin activates antithrombin, thus blocking the coagulation cascade and producing a whole blood / plasma sample making it ideal for the analysis.

Tubes manufactured using transparent PET or Glass.Caps manufactured using polyethylene.

Specimen: heparin plasma.

Conditions of centrifugation: 1300 g for 10 minutes.

REF	Tube Size (mm)	Draw Volume (mL)	Tube Materia	Pack/Carton
C106020	13x75	2mL	PET	100PCS/1200PCS
C306020			GLASS	100PCS/1200PCS
C106030	13x75	3mL	PET	100PCS/1200PCS
C306030			GLASS	100PCS/1200PCS
C106040	13x75	4mL	PET	100PCS/1200PCS
C306040			GLASS	100PCS/1200PCS
C106050	13x100	5mL	PET	100PCS/1200PCS
C306050			GLASS	100PCS/1200PCS
C106060	13x100	6mL	PET	100PCS/1200PCS
C306060			GLASS	100PCS/1200PCS
C106070	13x100	7mL	PET	100PCS/1200PCS
C306070			GLASS	100PCS/1200PCS
C106080	16x100	8mL	PET	100PCS/1200PCS
C306080			GLASS	100PCS/1200PCS
C106090	16x100	9mL	PET	100PCS/1200PCS
C306090			GLASS	100PCS/1200PCS
C106100	16x100	10mL	PET	100PCS/1200PCS
C306100			GLASS	100PCS/1200PCS



Sodium Heparin

Heparin is a natural anticoagulant which presents in any healthy body. Heparin is used to take the plasma and in chemical researches.

Heparin Blood Collection Tubes are intended to be used for analysis of blood withdrawn from patients under anticoagulant therapy.

The anticoagulant heparin activates antithrombin, thus blocking the coagulation cascade and producing a whole blood / plasma sample making it ideal for the analysis.

Tubes manufactured using transparent PET or Glass.Caps manufactured using polyethylene.

Specimen: heparin plasma.

Conditions of centrifugation: 1300 g for 10 minutes.

REF	Tube Size (mm)	Draw Volume (mL)	Tube Materia	Pack/Carton
C107020	13x75	2mL	PET	100PCS/1200PCS
C307020			GLASS	100PCS/1200PCS
C107030	13x75	3mL	PET	100PCS/1200PCS
C307030			GLASS	100PCS/1200PCS
C107040	13x75	4mL	PET	100PCS/1200PCS
C307040			GLASS	100PCS/1200PCS
C107050	13x100	5mL	PET	100PCS/1200PCS
C307050			GLASS	100PCS/1200PCS
C107060	13x100	6mL	PET	100PCS/1200PCS
C307060			GLASS	100PCS/1200PCS
C107070	13x100	7mL	PET	100PCS/1200PCS
C307070			GLASS	100PCS/1200PCS
C107080	16x100	8mL	PET	100PCS/1200PCS
C307080			GLASS	100PCS/1200PCS
C107090	16x100	9mL	PET	100PCS/1200PCS
C307090			GLASS	100PCS/1200PCS
C107100	16x100	10mL	PET	100PCS/1200PCS
C307100			GLASS	100PCS/1200PCS



EDTA & NaF

EDTA & NaF Blood Collection Tube is also called blood glucose tube or fluoride tube. EDTA & NaF Blood Collection Tube are intended to be used for specially glucose blood tests.

Tubes are recommended for glucose analysis when transportation time is crucial. Tubes contain fluoride as a glycolysis inhibitor and EDTA as anticoagulant.

Usage: EDTA & NaF Tubes are used for glucose determinations like blood sugar, sugar tolerance.

Specimen: plasma.

Conditions of centrifugation: 1300 g for 10 minutes.
Centrifugation should be made right after taking the blood into the tubes.

REF	Tube Size (mm)	Draw Volume (mL)	Tube Material	Pack/Carton
C108020	13x75	2mL	PET	100PCS/1200PCS
C308020			GLASS	100PCS/1200PCS
C108030	13x75	3mL	PET	100PCS/1200PCS
C308030			GLASS	100PCS/1200PCS
C108040	13x75	4mL	PET	100PCS/1200PCS
C308040			GLASS	100PCS/1200PCS
C108050	13x100	5mL	PET	100PCS/1200PCS
C308050			GLASS	100PCS/1200PCS



Sodium Citrate

Sodium Citrate Blood Collection Tube are also known as Coagulation Tubes or Citrate Tube. Sodium Citrate Blood Collection Tube are used to collect venous blood for coagulation tests.

Sodium Citrate Tube have a buffered sodium citrate solution of 0.109 mol/l (3.2%) or 0.129 mol/l (3.8%).

Usage: to research the hemostatic system.

Specimen: plasma.

Conditions of centrifugation: 2000-2500 g for 10-15 minutes.

Immediately after taking the blood into the tube with citrate it must be carefully mixed at least 5 times to prevent micro clots.

REF	Tube Size (mm)	Draw Volume (mL)	Tube Material	Pack/Carton
C109018	13x75	1.8mL	PET	100PCS/1200PCS
C309018			GLASS	100PCS/1200PCS
C109020	13x75	2mL	PET	100PCS/1200PCS
C309020			GLASS	100PCS/1200PCS
C109030	13x75	3mL	PET	100PCS/1200PCS
C309030			GLASS	100PCS/1200PCS
C109040	13x75	4mL	PET	100PCS/1200PCS
C309040			GLASS	100PCS/1200PCS
C109050	13x100	5mL	PET	100PCS/1200PCS
C309050			GLASS	100PCS/1200PCS
C109060	13x100	6mL	PET	100PCS/1200PCS
C309060			GLASS	100PCS/1200PCS
C109070	13x100	7mL	PET	100PCS/1200PCS
C309070			GLASS	100PCS/1200PCS
C109080	16x100	8mL	PET	100PCS/1200PCS
C309080			GLASS	100PCS/1200PCS
C109090	16x100	9mL	PET	100PCS/1200PCS
C309090			GLASS	100PCS/1200PCS
C109100	16x100	10mL	PET	100PCS/1200PCS
C309100			GLASS	100PCS/1200PCS



ESR

ESR Tube contain 3.8% sodium citrate for ESR test.ESR measurements refer to the Westergren method.

The tube are available with an open or closed sedimentation system.

Usage: ESR Blood Collection Tube are intended to be exclusively used for venous blood collection for determination of the Erythrocyte Sedimentation Rate.

Specimen: whole blood.

REF	Tube Size (mm)	Draw Volume (mL)	Tube Materia	Pack/Carton
C110016	13x75	1.6mL	PET	100PCS/1200PCS
C310016			GLASS	100PCS/1200PCS
C110020	13x75	2mL	PET	100PCS/1200PCS
C310020			GLASS	100PCS/1200PCS
C110024	13x75	2.4mL	PET	100PCS/1200PCS
C310024			GLASS	100PCS/1200PCS
C110030	13x75	3mL	PET	100PCS/1200PCS
C310030			GLASS	100PCS/1200PCS
C110040	13x75	4mL	PET	100PCS/1200PCS
C310040			GLASS	100PCS/1200PCS
C111012	8x120	1.28mL	PET	100PCS/1200PCS
C311012			GLASS	100PCS/1200PCS
C111016	8x120	1.6mL	PET	100PCS/1200PCS
C311016			GLASS	100PCS/1200PCS



No Additive

Plain Without Additives Blood Collection Tube are intended to be used in laboratory mainly for biochemistry, immunological & serological tests.

Usage: researches of biological fluids in clinical chemistry, serology, immunology.

Specimen: serum or other biological fluids.

Clotting time: 60 minutes.

Conditions of centrifugation: 1300 g for 10 minutes.Before centrifuging the tube with serum it is necessary to wait until blood clotting.

REF	Tube Size (mm)	Draw Volume (mL)	Tube Materia	Pack/Carton
C100010	13x75	1mL	PET	100PCS/1200PCS
C300010			GLASS	100PCS/1200PCS
C100020	13x75	2mL	PET	100PCS/1200PCS
C300020			GLASS	100PCS/1200PCS
C100030	13x75	3mL	PET	100PCS/1200PCS
C300030			GLASS	100PCS/1200PCS
C100040	13x75	4mL	PET	100PCS/1200PCS
C300040			GLASS	100PCS/1200PCS
C100050	13x100	5mL	PET	100PCS/1200PCS
C300050			GLASS	100PCS/1200PCS
C100060	13x100	6mL	PET	100PCS/1200PCS
C300060			GLASS	100PCS/1200PCS
C100070	13x100	7mL	PET	100PCS/1200PCS
C300070			GLASS	100PCS/1200PCS
C100080	16x100	8mL	PET	100PCS/1200PCS
C300080			GLASS	100PCS/1200PCS
C100090	16x100	9mL	PET	100PCS/1200PCS
C300090			GLASS	100PCS/1200PCS
C100100	16x100	10mL	PET	100PCS/1200PCS
C300100			GLASS	100PCS/1200PCS



Micro Blood Collection Tube



Micro blood collection tube has humanized design and snap sealed safety cap, the tube can effectively prevent blood leakage. Owing to its multi-dentation and double orientation structure, it's convenient for safe transportation and simple operation, free of blood spatter.

The color coding of safety cap is consistent with International Standard, Easy for identification. Salient design for the edge of the tube mouth is easy for users shoveling blood into the tube. Simple, fast and intuitive, the blood volume can be easily read with clear graduation line.

Special treatment inside the tube, it's smooth on the surface with no blood adhesion. Renji can customize barcode, and sterilize the tube with gamma rays as per clients' requirements

BLOOD COLLECTION TUBE

REF	Additive	Cap Colour	Tube Size (mm)	Draw Volume (mL)	Tube Material	Pack/Carton	Label
C202002	K2EDTA	● Purple	8x45	0.25mL	PET	100PCS/3000PCS	Paper
C202005	K2EDTA	● Purple	8x45	0.5mL	PET	100PCS/3000PCS	Paper
C204002	Clot Activator	● Red	8x45	0.25mL	PET	100PCS/3000PCS	Paper
C204005	Clot Activator	● Red	8x45	0.5mL	PET	100PCS/3000PCS	Paper

Non-vacuum Blood Collection Tube

Renji also provides products such as non-vacuum blood collection tube, PRP, ACD blood collection tube.

Since we have our own plastic factory, we even offer blood collection tube accessories for sale. (Blood collection tube cover and empty blood collection tube).

You can log in to our official website for more information, or contact our sales manager directly.

Urine Container



Product Name	REF	Cap Colour	Size (mm)	Volume Capacity (mL)	Material	Pack/Carton	Detailed Information
Urine Cup	H501-R	● Red	Φ49x57	60mL	PP	20PCS/600PCS	Screw Cap
Urine Cup	H501-B	● Blue	Φ49x57	60mL	PP	20PCS/600PCS	Screw Cap
Urine Cup	H502-R	● Red	Φ60x73	100mL	PP	250PCS	Screw Cap
Urine Cup	H502-B	● Blue	Φ60x73	100mL	PP	250PCS	Screw Cap
Urine Cup	H503-R	● Red	Φ59x88	120mL	PP	250PCS	Screw Cap
Urine Cup	H503-B	● Blue	Φ59x88	120mL	PP	250PCS	Screw Cap
Urine Cup	H504-R	● Red	Φ48x47	40mL	PP	20PCS/600PCS	Snap Cap
Urine Cup	H504-B	● Blue	Φ48x47	40mL	PP	20PCS/600PCS	Snap Cap
Disposable Urine Cup	H505-T	Transparent	78x36	40mL	PVC	500PCS/10000PCS	Bluk Pack
Disposable Urine Cup	H505-W	White	78x36	40mL	PVC	500PCS/10000PCS	Bluk Pack

Mid-section Urine Sampling System

- Automatically remove the first part of the urine and collect the middle part of the urine sample**
 Compared with traditional collection methods, this product is a new frontier in urine sample collection, which can reduce contamination to less than 3%, provide accurate analysis and diagnosis, avoid repeated urine analysis, and save a lot of costs for patients.
- Designed for ease of use and patient dignity**
 Traditional collection methods result in the spread of wet bottles, wet hands, and infected urine in clinical settings, exposing staff and patients to cross-contamination and a lack of dignity. Using this product does not easily soil the user's hands and legs, nor does it stain pipes, toilet seats and floors.
- Keep it clean and improve efficiency**
 The spill-proof, odor-free design of this product can greatly limit facility contamination. In a laboratory setting, collection tubes can often be placed directly into test tube racks or inserted into test strips for urinalysis, increasing the efficiency of laboratory staff.



SPECIMEN CONTAINER

Product Name	REF	Cap Colour	Size (mm)	Volume Capacity (mL)	Material	Pack/ Carton	Detailed Information
Urine Sediment Tube	H506-G	Green	Φ20x110	12mL	PS	20PCS/600PCS	Screw Cap
Urine Sediment Tube	H506-B	Blue	Φ20x110	12mL	PS	20PCS/600PCS	Screw Cap
Mid-section Urine Sampler	H506-TP	Transparent			PP	20PCS/600PCS	Bluk Pack

How To Use

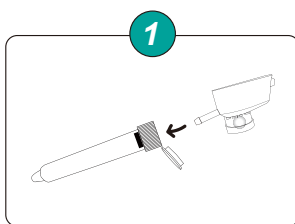

1. Open the packaging bag and insert one end of the urine cup into the tube body to complete the assembly.

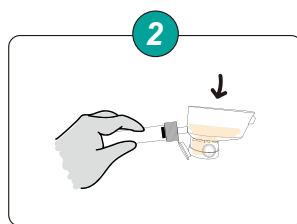

2. After collecting 10ml of urine, gently pull the urine cup out of the collection tube.

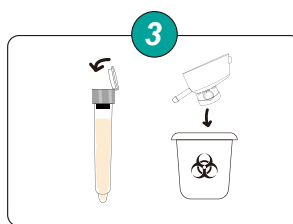

3. After collecting 10ml of urine, gently pull out the urine cup from the collection tube.

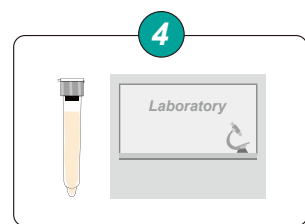

4. Send the urine sample to the relevant window for inspection.

Stool Container



H507-B



H507-W



H507-Y



H508-R



H508-R2



H508-W



H509-BK



H509-W

Product Name	REF	Cap Colour	Size (mm)	Volume Capacity (mL)	Material	Pack/Carton	Detailed Information
Stool Container	H507-B	Blue	Φ30x55	40mL	PP	20PCS/500PCS	Screw Cap
Stool Container	H507-W	White	Φ30x55	40mL	PP	20PCS/500PCS	Screw Cap
Stool Container	H507-Y	Yellow	Φ30x55	40mL	PP	20PCS/500PCS	Screw Cap
Stool Container	H508-R	Red	Φ49x57	60mL	PP	20PCS/500PCS	Screw Cap
Stool Container	H508-R2	Red	Φ49x57	60mL	PP	20PCS/500PCS	Screw Cap
Stool Container	H508-W	White	Φ49x57	60mL	PP	20PCS/500PCS	Screw Cap
Stool Container	H509-BK	Black cup	Φ48x47	30mL	PP	20PCS/600PCS	Snap Cap
Stool Container	H509-W	White cup	Φ78x36	30mL	PP	500PCS/10000PCS	Snap Cap

Saliva Container



SPECIMEN CONTAINER

Product Name	REF	Cap Colour	Size (mm)	Volume Capacity (mL)	Material	Pack/Carton	Detailed Information
Saliva Cup	H510-R	● Red	Φ48x47	40mL	PP	40PCS/800PCS	Snap Cap
Saliva Cup	H510-B	● Blue	Φ48x47	40mL	PP	40PCS/800PCS	Snap Cap
Saliva Cup	H510-RL	● Red	Φ48x47	40mL	PP	40PCS/800PCS	Snap Cap+Label
Saliva Cup	H510-BL	● Blue	Φ48x47	40mL	PP	40PCS/800PCS	Snap Cap+Label
Saliva Cup	H511-R	● Red	Φ42x59	40mL	PP	40PCS/800PCS	Screw Cap
Saliva Cup	H511-B	● Blue	Φ42x59	40mL	PP	40PCS/800PCS	Screw Cap
Saliva tube	H512-R	● Red	Φ31x93	30mL	PP	40PCS/800PCS	Screw Cap
Saliva tube	H512-W	● White	Φ31x93	30mL	PP	40PCS/800PCS	Screw Cap

Saliva Collection Kit

This collector can be directly used for the collection, preservation and transportation of saliva, and the cDNA (CellFree DNA) or virus samples in it can be stabilized by the preservation solution. It can be used for molecular diagnostic testing (including but not limited to PC or branched DNA amplification technology), virus testing or other in vitro testing of saliva samples.

● **Applicable sample types:**

Saliva.

● **Storage and transportation of samples:**

After the sample is collected, it should be transported to the corresponding laboratory for testing within 48 hours, and the storage temperature is 2-8°C. If it cannot be transported to the laboratory within 48 hours, it should be stored at -20 °C or below and sent to the corresponding laboratory within one week. The sample should avoid repeated freezing and thawing.



Product Name	REF	Cap Colour	Size (mm)	Volume Capacity (mL)	Material	Box/Carton	Detailed Information
Saliva Collection Kit	SL901B	● Red	16x60	5mL	Tube:PP,Cap:PE	30 kits/10boxes	Thread type
Saliva Collection Kit	SL901I	● Red	16x60	5mL	Tube:PP,Cap:PE	30 kits/10boxes	Insert type
Saliva Collection Kit	SL901B	● Blue	13x84	7mL	Tube:PP,Cap:PE	30 kits/10boxes	Thread type
Saliva Collection Kit	SL901I	● Blue	13x84	7mL	Tube:PP,Cap:PE	30 kits/10boxes	Insert type
Saliva Collection Kit	SL901B	● Red	16x100	10mL	Tube:PP,Cap:PE	30 kits/10boxes	Thread type
Saliva Collection Kit	SL901I	● Red	16x100	10mL	Tube:PP,Cap:PE	30 kits/10boxes	Insert type

Collection Tube



SPECIMEN CONTAINER



50Kits/Box



25mL



10mL



7mL



5mL



Product Name	REF	Cap Colour	Size (mm)	Volume Capacity (mL)	Material	Pack/Carton	Detailed Information
Universal Container	H514-R	● Red	Φ15x60	5mL	PP	10PCS/500PCS	Screw Cap
Universal Container	H514-B	● Blue	Φ15x60	5mL	PP	10PCS/500PCS	Screw Cap
Universal Container	H515-R	● Red	Φ15x100	10mL	PP	10PCS/500PCS	Screw Cap
Universal Container	H515-B	● Blue	Φ15x100	10mL	PP	10PCS/500PCS	Screw Cap
Universal Container	H515-Y	● Yellow	Φ15x100	10mL	PP	10PCS/500PCS	Screw Cap
Universal Container	H516-B	● Blue	Φ20x100	20mL	PP	10PCS/500PCS	Screw Cap
Universal Container	H516-R	● Red	Φ20x100	20mL	PP	10PCS/500PCS	Screw Cap
Universal Container	H517-B	● Blue	Φ25x100	30mL	PP	10PCS/500PCS	Screw Cap
Universal Container	H517-R	● Red	Φ25x100	30mL	PP	10PCS/500PCS	Screw Cap

Petri Dish

- Made of high transparency medical grade PS material, Used for fungus, bacteria and other microorganism culture.
- Superior production technique makes the dish thickness uniform. The dish bottom is smooth and clean without deformation, which makes the quantitative analysis more precise.
- Easy to stack up with the stack up circle.
- Vent design for easy air exchange.
- E.O or Gamma radiation sterile available.



Product Name	REF	Size (mm)	Weight (g)	Material	Pack/Carton	Detailed Information
Petri Dish	H518-1	Φ35x13	5.6g	PS	10PCS/500PCS	Round
Petri Dish	H518-2	Φ60x15	7.4g	PS	10PCS/500PCS	Round
Petri Dish	H518-3	Φ70x15	10.8g	PS	10PCS/500PCS	Round
Petri Dish	H518-4	Φ90x15	14/17/21g	PS	10PCS/500PCS	Round
Petri Dish	H518-5	Φ90x13.8	13.7g	PS	10PCS/500PCS	Round
Petri Dish	H518-6	Φ150x20	48g	PS	10PCS/500PCS	Round
Petri Dish	H518-7	100x100	26g	PS	10PCS/500PCS	Square
Petri Dish	H518-8	120x120	40.2g	PS	10PCS/500PCS	Square

Multi Well Plate

- Made of high quality PS material by ultraprecise mould with automatic technique. Used for fungus, bacteria and other microorganism culture.
- 5 optional types: 6, 12, 24, 48, 96 wells. Available in transparent, white and black plate.
- According to the shape of bottom, it can be classified to: Flat bottom, U-bottom and V-bottom.
- Single direction lid design with coherent ring reduces contamination.
- A good combination of the lid and plate, convenient for air exchange and avoid medium contamination or loss.
- Hange design for the wells prevents cross contamination. Molded letters and numbers helps locating in experiment.
- Can be stacked up to save the space and good for lab environment.
- Good compatibility, adapted to most of the machines.
- Available in E.O. or Gamma radiation sterile.

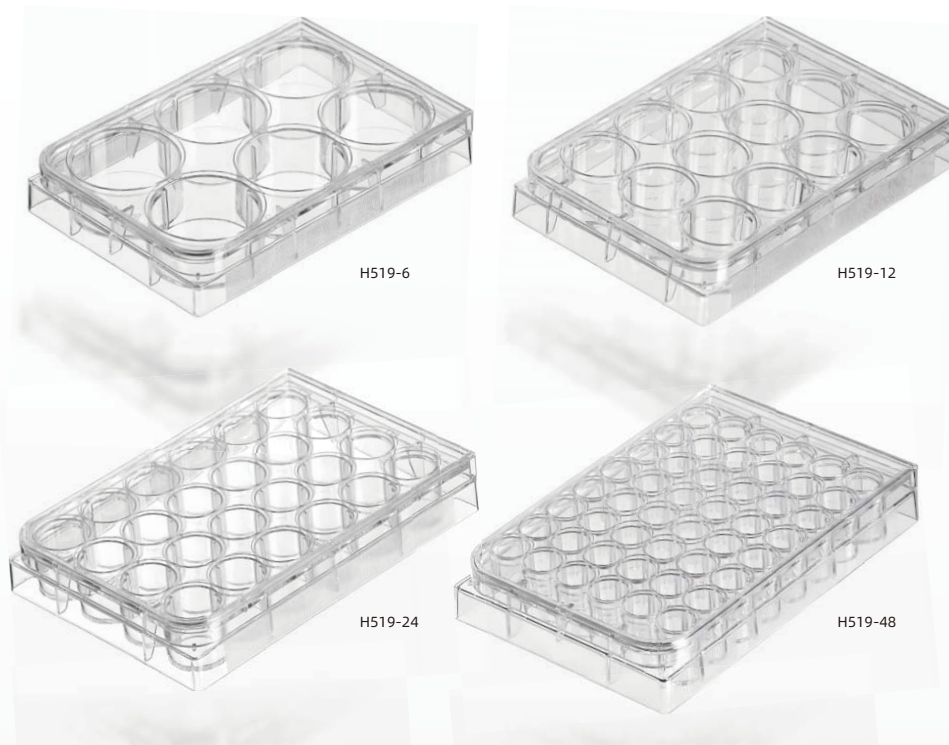

Product Name	REF	Size (mm)	Specification	Material	Pack/ Carton	Detailed Information
Multi Well Plate	H519-6	127x85x23	6 Wells	PS	1PCS/100PCS	Flat Bottom
Multi Well Plate	H519-12	127x85x23	12 Wells	PS	1PCS/100PCS	Flat Bottom
Multi Well Plate	H519-24	127x85x23	24 Wells	PS	1PCS/100PCS	Flat Bottom
Multi Well Plate	H519-48	127x85x23	48 Wells	PS	1PCS/100PCS	Flat Bottom
Multi Well Plate	H519-96	128x85x16	96 Wells	PS	1PCS/100PCS	Flat Bottom
Multi Well Plate	H520-U	128x85x16	96 Wells	PS	1PCS/100PCS	U Bottom
Multi Well Plate	H520-V	128x85x16	96 Wells	PS	1PCS/100PCS	V Bottom

Deepwell Plate

- Made of high quality PP material, High chemical stability, Can be sterilized under high temperature, Adapted to multi-channel pipette and autom-atic machine.
- Square well, U-bottom design ensures minimum sample residual.
- Moulded letters and numbers, convenient for locating.
- Confirm to BS regulation, can be stacked up stably.
- Good sealing performance, Top of the plate is flat and uniform to keep effective sealing.
- Optional Gamma radiation sterile, DNase, RNase free and Non-pyrogenic.



Product Name	REF	Size (mm)	Specification	Materia	Pack/Carton	Detailed Information
Deepwell Plate	H521-U1	125x85x40	96 Wells	PP	1PCS/100PCS	Square Wells,U Bottom
Deepwell Plate	H521-V1	125x85x43	96 Wells	PP	1PCS/100PCS	Square Wells,V Bottom
Deepwell Plate	H521-U1	125x85x30	96 Wells	PP	1PCS/100PCS	Circular Wells,U Bottom
Deepwell Plate	H521-V2	125x85x33	96 Wells	PP	1PCS/100PCS	Circular Wells,V Bottom

Magnetic Rod Sleeve

- It is made of high-purity and biologically inert polypropylene (PP) by injection molding, which has strong chemical corrosion resistance, good heat resistance and low adsorption. Model 96 well square well plates are used.
- Protect the separation of the magnetic rod from the liquid reagent and prolong the service life of the magnetic rod;
- Through the up and down movement of the magnetic rod cover, the sample can be mixed, lysed, combined, washed and eluted in the corresponding magnetic bead method reagent;
- Through the coordinated movement of the magnetic rod and the magnetic rod sleeve, the transfer of the magnetic bead and the magnetic bead-target substance complex is realized;
- Release magnetic beads and magnetic beads-target substance complexes through the separation of the magnetic rod and the magnetic rod sleeve.
- Autoclavable (121°C, 20min)
- Adapt to the automated magnetic bead nucleic acid extractor

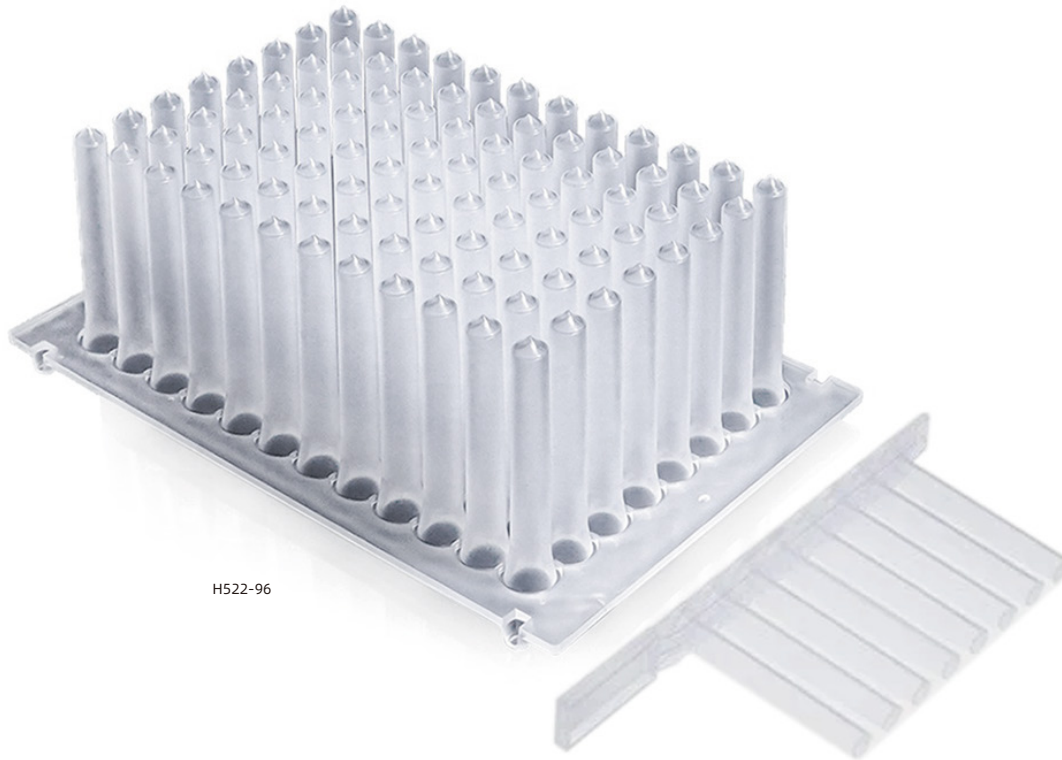

H522-96

H522-8

Product Name	REF	Size (mm)	Specification	Material	Pack/ Carton	Detailed Information
Multi Well Plate	H522-8	11x100x40	8 Wells	PP	2PCS/100PCS	with handle
Multi Well Plate	H522-96	127x85x40	96 Wells	PP	2PCS/168PCS	Without handle
Multi Well Plate	H523-96	127x85x40	96 Wells	PP	2PCS/168PCS	with handle

PCR Tube

- Made of clean PP material, thin wall and uniform thickness can keep good heat transfer.
- 0.2ml strips is available in two types: Transparent and white, respectively applicable to normal PCR and real-time PC(qPCR) reaction.
- Good sealing performance of the 8-strip while lid closed. Easy to open the cap without contamination.
- Adapted to PC instrument with corresponding module.
- Sterilized by Gamma radiation.

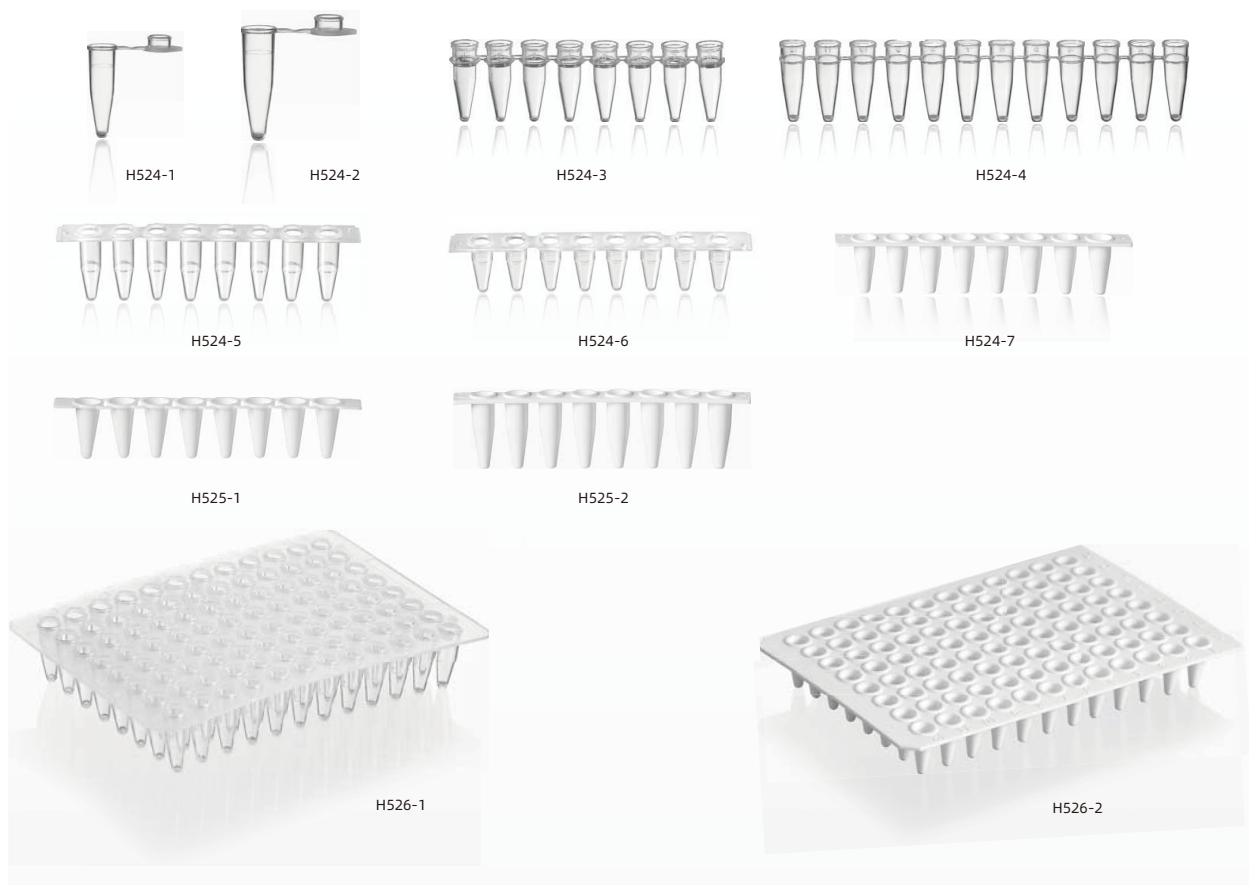

Product Name	REF	Colour	Size (mm)	Volume Capacity (mL)	Material	Pack/ Carton	Detailed Information
PCR Tube Strips	H524-1	Transparent		0.2mL	PP	1000PCS/50000PCS	Thin-Walled
PCR Tube Strips	H524-2	Transparent		0.5mL	PP	1000PCS/20000PCS	Thin-Walled
PCR Tube Strips	H524-3	Transparent	80x8	0.2mLx8	PP	200PCS/2000PCS	8 Strips,Thin-Walled
PCR Tube Strips	H524-4	Transparent	155x8	0.2mLx12	PP	200PCS/6000PCS	12 Strips,Thin-Walled
PCR Tube Strips	H524-5	Transparent	80x8	0.1mLx8	PP	200PCS/2000PCS	8 Strips,Thin-Walled
PCR Tube Strips	H524-6	White	80x8	0.1mLx8	EU	200PCS/2000PCS	8 qPCR Tube Strips
PCR Tube Strips	H524-7	White	80x8	0.2mLx8	EU	200PCS/2000PCS	8 qPCR Tube Strips
PCR Cap Strips	H525-1	Transparent	80x8		PP	200PCS/2000PCS	8 Cap Strips
PCR Cap Strips	H525-2	Transparent	155x8		PP	200PCS/2000PCS	12 Cap Strips
PCR Plates	H526-1	Transparent	122x80	0.2mLx96	PP	1PCS/200PCS	96 Strips
PCR Plates	H526-2	White	122x80	0.1mLx96	EU	1PCS/200PCS	96 Strips

BIOLOGICAL CULTURE VESSEL

Micro Centrifuge Tube

- Made of High transparency PP material, adapted to micro centrifuge, widely used in molecular biology, clinical chemistry and bio-chemistry researchn.
- Available in various volume: 0.2ml, 0.5ml, 1.5ml, 2ml, 5ml, etc.
- Chemical corrosion and low temperature resistance.
- No release reagent, plasticizer and fungistat added during production, free of heavy metal.
- Stable under high centrifuge speed, up to 1500U rpm. It can guarantee staff safety and environment while testing toxic samples.
- Adapted to wide range of temperature from -80 °C to 121°C. no distortion.
- Clear graduation on the wall for easier observation.
- Frosted area on the cap and tube for convenient mark and identification.
- Available in sterile by E.O or Gamma radiation.

CENTRIFUGR TUBE

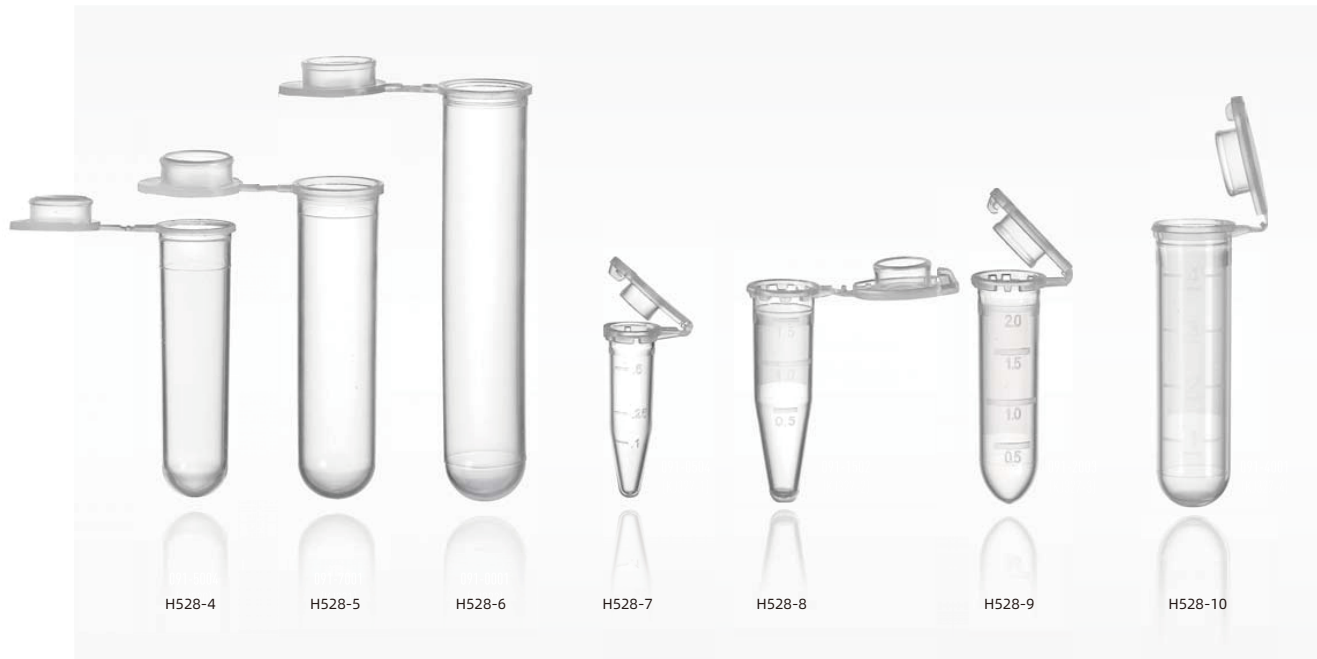

Product Name	REF	Volume Capacity (mL)	Relative centrifugal force	Material	Pack/Carton	Detailed Information
Micro Centrifuge Tube	H528-1	0.2mL	17800xg	PP	1000PCS/50000PCS	Transparent/Yellow / Blue / Red
Micro Centrifuge Tube	H528-2	0.5mL	17800xg	PP	1000PCS/20000PCS	Snap Cap
Micro Centrifuge Tube	H528-3	1.5mL	17800xg	PP	500PCS/10000PCS	Snap Cap, Toothed
Micro Centrifuge Tube	H528-4	2mL	17800xg	PP	500PCS/9000PCS	Round bottom, Toothed
Micro Centrifuge Tube	H528-5	1.5mL	16000xg	PP	500PCS/10000PCS	Snap Cap, Transparent
Micro Centrifuge Tube	H528-6	5mL	19300xg	PP	200PCS/4000PCS	Snap cap, Transparent
Micro Centrifuge Tube	H528-7	5mL	19300xg	PP	500PCS/6000PCS	Snap Cap, Round Bottom
Micro Centrifuge Tube	H528-8	7mL	19300xg	PP	200PCS/2400PCS	Snap Cap, Round Bottom
Micro Centrifuge Tube	H528-9	10mL	16000xg	PP	200PCS/1600PCS	Snap Cap, Round Bottom
Micro Centrifuge Tube	H528-10	4mL	19300xg	PP	500PCS/6000PCS	Snap Cap, Round Bottom, Toothed

Centrifuge Tube

- Made of high grade transparent PP material, widely used in molecular biology, clinical chemistry, biochemistry research.
- Clear white or black graduation on tubes, Large white writing area for easy marking.
- Easy One-hand operation to open or close the cap.
- Maximum CF at 12000xg.
- Adapted to wide range temperatures from -80°C to 120°C.
- Available in bulk or individual pack.
- Available in sterile by E.O. or Gamma radiation.

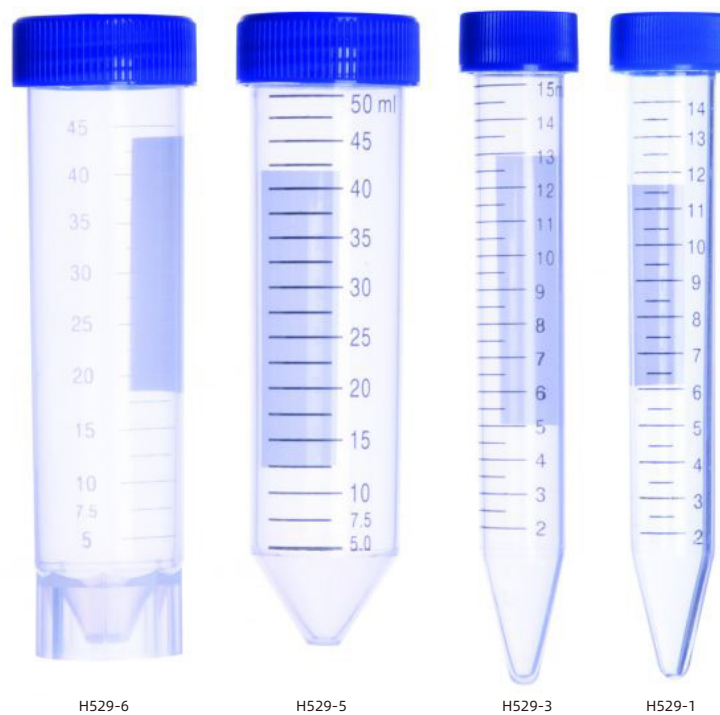

CENTRIFUGER TUBE

Product Name	REF	Volume Capacity (mL)	Relative centrifugal force	Material	Pack/Carton	Detailed Information
Centrifuge Tube	H529-1	10mL	11000xg	PP	100PCS/2000PCS	Screw Cap
Centrifuge Tube	H529-2	10mL	16000xg	PP	200PCS/1600PCS	Snap Cap, Round Bottom
Centrifuge Tube	H529-3	15mL	9000xg	PP	100PCS/1800PCS	Screw Cap
Centrifuge Tube	H529-4	15mL	9000xg	PP	100PCS/1800PCS	Screw Cap, Round Bottom
Centrifuge Tube	H529-5	50mL	9000xg	PP	50PCS/500PCS	Screw Cap
Centrifuge Tube	H529-6	50mL	9000xg	PP	50PCS/500PCS	Screw Cap, Self standing

Cryogenic Tube

- RENJI cryogenic tube is made of medical grade polypropylene (PP) and is endotoxin-free. They are disposable laboratory consumables dedicated to storing biological samples.
- The anti-slip lines on the cap and the tube body are easy for screw.
- Built-in O-ring to prevent liquid leakage
- The cryogenic tube can be stored in the gas phase liquid nitrogen and can withstand low temperature to -196°C.
- Multiple color options for the cap.
- According to different requirements, there are ordinary grade and PCR grade. PC-grade is free from DNA, DNase, RNase and endotoxin. Sterilized by gamma irradiation.



Product Name	REF	Volume Capacity (mL)	Size (mm)	Temperature range	Material	Pack/ Carton	Detailed Information
Cryogenic Tube	H530-1	0.5mL	Φ10x47	-196~121°C	PP	500PCS/5000PCS	Self standing
Cryogenic Tube	H530-2	1.5mL	Φ10x47	-196~121°C	PP	500PCS/5000PCS	Self standing
Cryogenic Tube	H530-3	1.5mL	Φ10x47	-196~121°C	PP	500PCS/5000PCS	Self standing
Cryogenic Tube	H530-4	2mL	Φ10x47	-80~121°C	PP	500PCS/5000PCS	Self standing
Cryogenic Tube	H530-5	2mL	Φ10x47	-80~121°C	PP	500PCS/5000PCS	Self standing
Cryogenic Tube	H530-6	2mL	Φ10x50	-80~121°C	PP	500PCS/5000PCS	Self standing
Cryogenic Tube	H530-7	1.8mL	Φ12x45	-80~121°C	PP	500PCS/5000PCS	Self standing
Cryogenic Tube	H530-8	5mL	Φ16x60	-80~121°C	PP	500PCS/5000PCS	Self standing

External Thread Cryotube

- The cryotube uses medical grade polypropylene (PP) as raw material and is a disposable laboratory consumable dedicated to storing biological samples.
- In the gas phase liquid nitrogen (that is, in the gaseous environment above the liquid nitrogen), it can withstand low temperatures to -196°C.
- The external screw cap can reduce the chance of sample contamination
- The cap has a built-in silicone O-ring to prevent liquid leakage. When operating according to the standard, there is no bursting, good sealing and no leakage. The tightness can be guaranteed even at the lowest storage temperature, ensuring the safety of samples and laboratories.
- The cap lines make it easy to screw the cap. The cap is equipped with an embedded small color lid for easy identification (Multiple color options).
- The cap and the tube are made of PP raw materials with the same batch and model, so the same expansion coefficient ensures sealing.
- Bar codes and double-digit codes are used for sample digital management and easy identification, and a large white area is convenient for marking.
- The cured bottom design is convenient for centralized liquid handling and reduces residue.
- According to different requirements, there are ordinary grade and PC grade. PCR-grade is free from DNA, DNase, RNase and endotoxin. Sterilized by gamma irradiation.

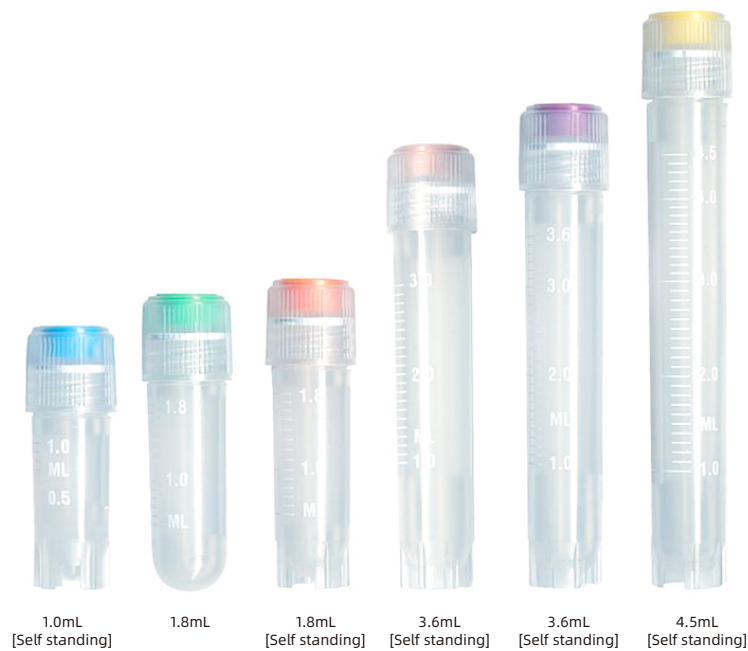

CRYOVIALS

Product Name	REF	Volume Capacity (mL)	Size (mm)	Temperature range	Material	Pack/ Carton	Detailed Information
External Thread Cryotube	H531-1	1.0mL	Φ12.5x42	-196~121°C	PP	500PCS/5000PCS	Self standing
External Thread Cryotube	H531-2	1.8mL	Φ12.5x47	-196~121°C	PP	500PCS/5000PCS	Round bottom
External Thread Cryotube	H531-3	1.8mL	Φ12.5x49	-196~121°C	PP	500PCS/5000PCS	Self standing
External Thread Cryotube	H531-4	3.6mL	Φ12.5x75	-196~121°C	PP	200PCS/2000PCS	Round bottom
External Thread Cryotube	H531-5	3.6mL	Φ12.5x77	-196~121°C	PP	200PCS/2000PCS	Self standing
External Thread Cryotube	H531-6	4.5mL	Φ12.5x89	-196~121°C	PP	200PCS/2000PCS	Round bottom
External Thread Cryotube	H531-7	4.5mL	Φ12.5x90	-196~121°C	PP	200PCS/2000PCS	Self standing

Internal Thread Cryotube

- The cryotube uses medical grade polypropylene (PP) as raw material and is a disposable laboratory consumable dedicated to storing biological samples.
- The internal thread cryotube is specially designed for freezing samples in gas phase liquid nitrogen, and can withstand low temperatures to -196°C.
- The internal screw cap can reduce the chance of sample contamination.
- The silicone O-ring in the cap enhances the sealing, ensuring the safety of the sample and the laboratory
- The cap lines makes it easy to screw the cap. The cap is equipped with an embedded small color lid for easy identification (Multiple color options).
- The cap and the tube are made of PP raw materials with the same batch and model, so the same expansion coefficient ensures sealing.
- Bar codes and double-digit codes are used for sample digital management and easy identification, and a large white area is convenient for marking.
- The curved bottom design is convenient for centralized liquid handling and reduces residue.
- According to different requirements, there are ordinary grade and PC grade. PC-grade is free from DNA, DNase, RNase and endotoxin. Sterilized by gamma irradiation.



Product Name	REF	Volume Capacity (mL)	Size (mm)	Temperature range	Material	Pack/ Carton	Detailed Information
Internal Thread Cryotube	H532-1	1.0mL	Φ12.5x40	-196~121°C	PP	500PCS/5000PCS	Self standing
Internal Thread Cryotube	H532-2	1.8mL	Φ12.5x49	-196~121°C	PP	500PCS/5000PCS	Round bottom
Internal Thread Cryotube	H532-3	1.8mL	Φ12.5x50	-196~121°C	PP	500PCS/5000PCS	Self standing
Internal Thread Cryotube	H532-4	3.6mL	Φ12.5x77	-196~121°C	PP	200PCS/2000PCS	Round bottom
Internal Thread Cryotube	H532-5	3.6mL	Φ12.5x79	-196~121°C	PP	200PCS/2000PCS	Self standing
Internal Thread Cryotube	H532-6	4.5mL	Φ12.5x91	-196~121°C	PP	200PCS/2000PCS	Round bottom
Internal Thread Cryotube	H532-7	4.5mL	Φ12.5x93	-196~121°C	PP	200PCS/2000PCS	Self standing

Test Tube

- RENJI test tube is made of superior PE/PP/PS material, it has a good chemical compatibility. Adapted to storage for most of polar organic solvent, weak acid, weak base.
- PS/PP test tube is manufactured with excellent technique, Some products can stand centrifuge speed up to 4500 rpm without crack or leakage.
- Multiple sizes and types can meet various test requirements.
- Labels can be customized to meet specific test demand.

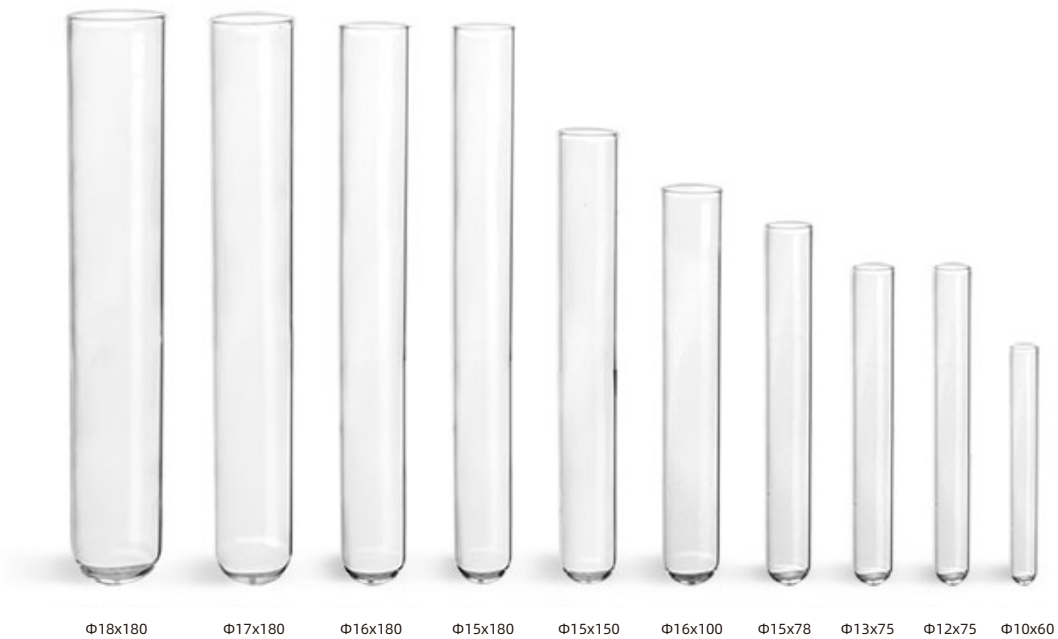

TEST TUBE

Product Name	REF	Volume Capacity (mL)	Size (mm)	Material	Pack/Carton	Detailed Information
Test Tube	H533-1		Φ10x75	PE	900PCS/1800PCS	Disposable
Test Tube	H533-2		Φ12x75	PE	600PCS/1200PCS	Disposable
Test Tube	H533-3		Φ10x100	PE	700PCS/12600PCS	Disposable
Test Tube	H533-4		Φ12x100	PE	500PCS/9000PCS	Disposable
Test Tube	H533-5		Φ15x100	PE	300PCS/5400PCS	Disposable
Test Tube	H533-6		Φ12x75	PP	500PCS/5000PCS	
Test Tube	H533-7	5mL	Φ13x75	PP	400PCS/4000PCS	
Test Tube	H533-8		Φ13x78	PP	400PCS/4000PCS	
Test Tube	H533-9		Φ12x100	PP	300PCS/3000PCS	
Test Tube	H533-10		Φ15x100	PP	250PCS/2250PCS	
Test Tube	H533-11		Φ16x100	PP	200PCS/2000PCS	
Test Tube	H533-12		Φ16x75	PP	300PCS/3000PCS	

Test Tube & Cap



Flanged plug cap

Product Name	REF	Volume Capacity (mL)	Size (mm)	Material	Pack/Carton	Detailed Information
Test Tube	H534-1		Φ15x100	PS	200PCS/2000PCS	With Cap
Test Tube	H534-2		Φ16x100	PP	200PCS/2000PCS	With Cap
Test Tube	H534-3		Φ16x100	PS	200PCS/2000PCS	With Cap
Test Tube	H534-4		Φ12x75	PP	400PCS/4000PCS	Multiple colour
Test Tube Cap	H534-5		Φ12	PE	2000PCS/20000PCS	Flanged plug cap
Test Tube Cap	H534-6		Φ13	PP	2000PCS/20000PCS	Flanged plug cap
Test Tube	H534-7		Φ16	PP	1000PCS/10000PCS	Flanged plug cap
Test Tube	H534-8		Φ12	PP	2000PCS/20000PCS	Plug cap
Test Tube	H534-9		Φ13	PP	2000PCS/20000PCS	Plug cap
Test Tube	H534-10		Φ15	PP	1000PCS/10000PCS	Plug cap

Rack for Test Tube

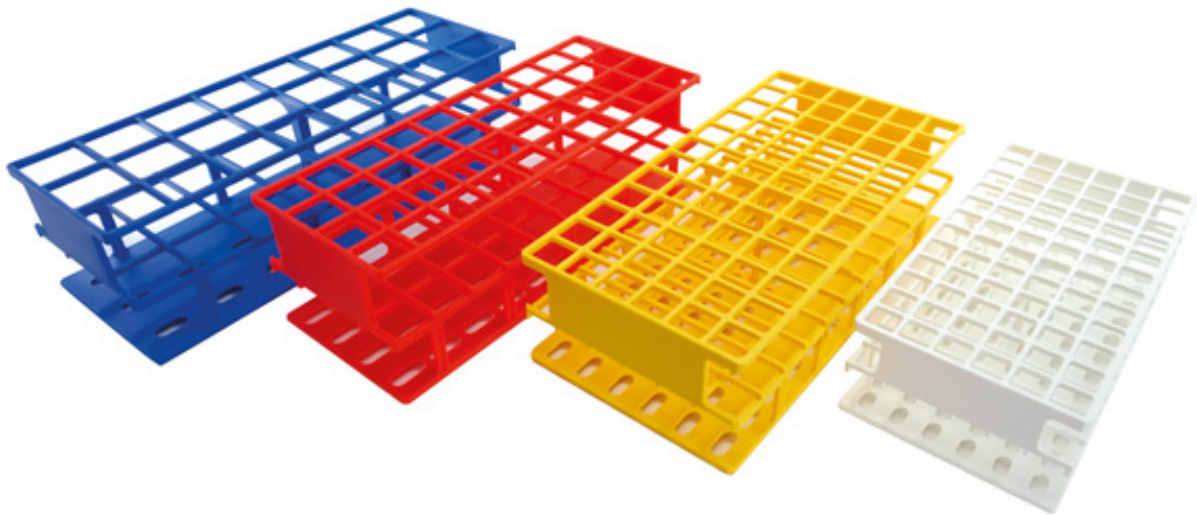
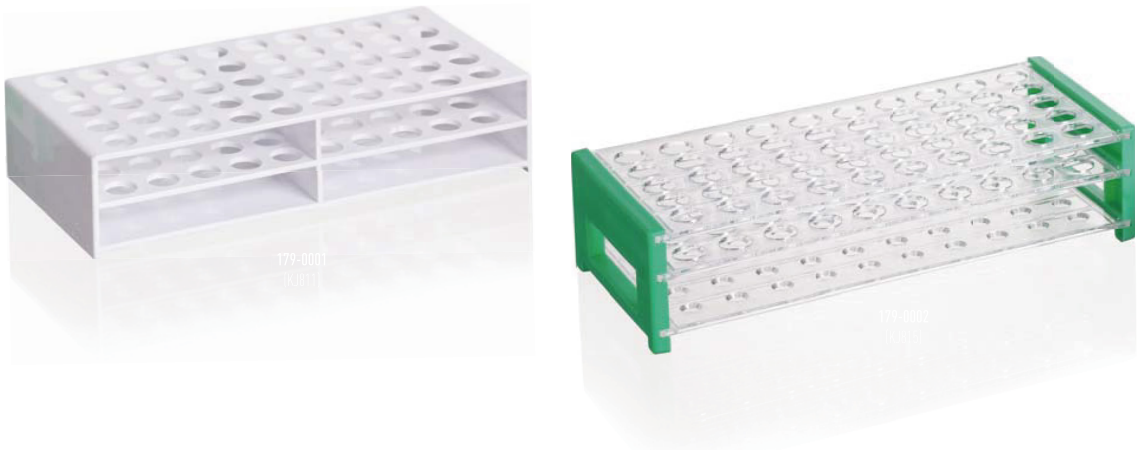

TEST TUBE

Product Name	REF	Size (mm)	Materia	Pack/ Carton	Detailed Information
Transport Swab With Tube	H535-1	Φ13x178	Stick:PP , Tip:Viscose	100PCS/2000PCS	Bulk or Individual Pack
Transport Swab With Tube	H535-2	Φ13x178	Stick:PP , Tip:Polyester	100PCS/2000PCS	Bulk or Individual Pack
Transport Swab With Tube	H535-3	Φ13x178	Stick:Wood , Tip:Cotton	100PCS/2000PCS	Bulk or Individual Pack
Transport Swab With Tube	H535-4	Φ13x178	Stick:Wood , Tip:Viscose	100PCS/2000PCS	Bulk or Individual Pack
Transport Swab With Tube	H535-5	Φ13x178	Stick:Stainless Steel , Tip:Viscose	100PCS/2000PCS	Bulk or Individual Pack
Transport Swab With Tube	H535-6	Φ13x178	Stick:PP , Tip:Cotton	100PCS/2000PCS	Bulk or Individual Pack

Transport Swab With Tube

Transport Swab with PP Tube

- This kind of swab is composed of collection swab, tip and PP sealing tube. According to different requirements, the swab stick has optional material like wood, PP or PS. The swab tip material is available in superior absorbent cotton, artificial cotton, polyester fiber.
- Used for sampling from the parts of vagina, urogenital canal, etc.
- Adapted to sampling from the parts of urethra and so on.
- Individual or bulk pack available.



SWAB

Product Name	REF	Size (mm)	Material	Pack/Carton	Detailed Information
Transport Swab With Tube	H536-1	Φ13x178	Stick:PP , Tip:Viscose	100PCS/2000PCS	Bulk or Individual Pack
Transport Swab With Tube	H536-2	Φ13x178	Stick:PP , Tip:Polyester	100PCS/2000PCS	Bulk or Individual Pack
Transport Swab With Tube	H536-3	Φ13x178	Stick:Wood , Tip:Cotton	100PCS/2000PCS	Bulk or Individual Pack
Transport Swab With Tube	H536-4	Φ13x178	Stick:Wood , Tip:Viscose	100PCS/2000PCS	Bulk or Individual Pack
Transport Swab With Tube	H536-5	Φ13x178	Stick:Stainless Steel , Tip:Viscose	100PCS/2000PCS	Bulk or Individual Pack
Transport Swab With Tube	H536-6	Φ13x178	Stick:PP , Tip:Cotton	100PCS/2000PCS	Bulk or Individual Pack

Throat Swab & Nasal Swab

- The standard swab consists of a swab stick and cotton head. The swab stick is made of wood or PS or PP. The cotton head is made of high-quality absorbent cotton, artificial cotton or polyester cotton, which can be customized according to needs.
- The flocked swab adopts innovative technology of nylon fiber spray implantation to maximize the sampling efficiency of the sampling swab. The nylon fibers are vertically and evenly attached to the surface of the swab head. The upright nylon fibers are like a soft brush to collect more samples. The capillary action between the nylon fibers enhances the capacity of water-based samples, and the samples are concentrated on the surface of the swab, which makes it easier to elute. Outstanding sample collection and release capabilities, capable of quickly adsorbing small amounts of samples, and high efficiency during release. The increase in the number of targeted cells helps to improve the sensitivity of rapid diagnostic tests. It is especially suitable for sample collection of various viruses, RNA/DNA, etc. The swab stick made of ABS has a breaking point design to facilitate sample handling, storage and transportation.
- Gamma-irradiation sterilization, individual or bulk pack for various options.



Nasal Swab



Oral Swab

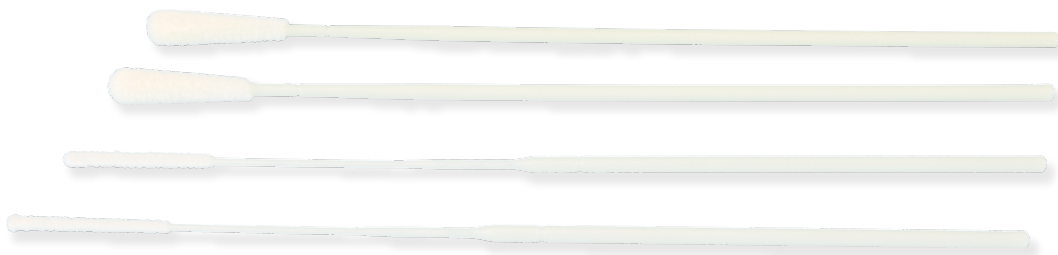

SWAB

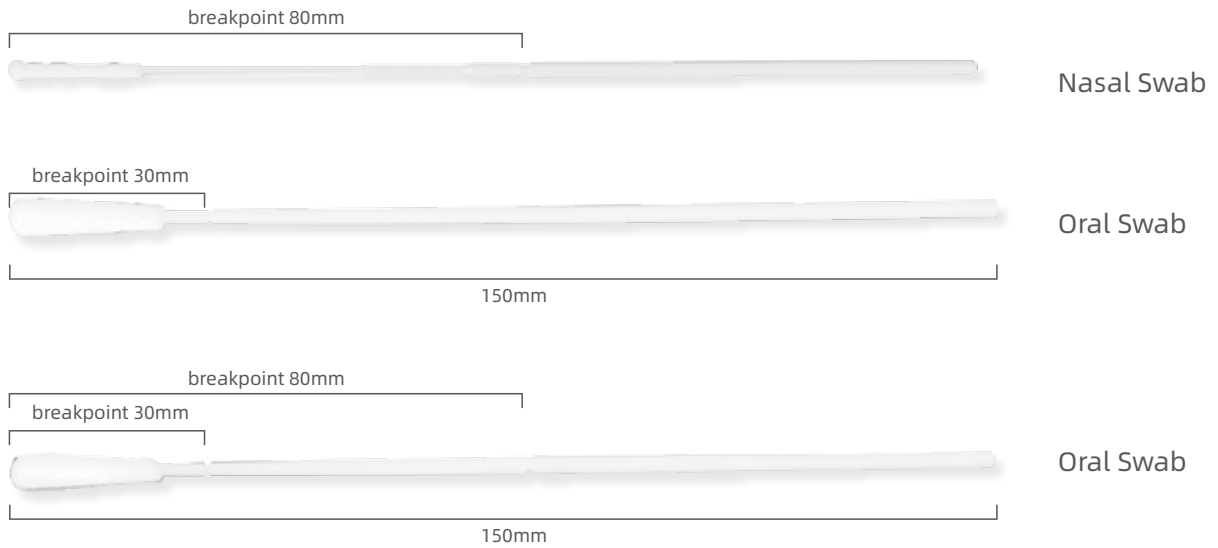

Product Name	REF	Size (mm)	Material	Pack/Carton	Detailed Information
Oral Swab	RJ-1	150	Stick:ABS , Tip:Nylon Flocked	450PCS/bos,16boxes/Carton	Bulk Pack
Oral Swab	RJ-1	150	Stick:ABS , Tip:Nylon Flocked	450PCS/bos,16boxes/Carton	Individual Pack
Nasal Swab	RJ-1	150	Stick:ABS , Tip:Nylon Flocked	450PCS/bos,16boxes/Carton	Bulk Pack
Nasal Swab	RJ-1	150	Stick:ABS , Tip:Nylon Flocked	450PCS/bos,16boxes/Carton	Individual Pack
Nasal Swab	RJ-1	90	Stick:ABS , Tip:Nylon Flocked	450PCS/bos,16boxes/Carton	Bulk Pack

Disposable Virus Specimen Collection Tube

● Product Application

Our disposable virus specimen collection tube are used for the collection and transportation of Novel Coronavirus/SARS COV-2, Influenza, Avian Influenza, Hand, Foot and Mouth Disease, Measles, Chlamydia, Mycoplasma, and Urea plasma specimens.

● Sample Requirements

1. Swab and Tube are sterilized using High Energy Electron Beam Irradiation, which can ensure the biological safety of the sampled person
2. Lot number located on each kit to allow for full specimen traceability Kits can be stored up to 2 year at room temperature
3. Expiration date on each tube, swab and kit Biohazard Bags with absorbent pad are available
4. Samples available to test and verify
5. Bulk packaging available to save you money



Individual Pack



Bulk Pack



SWAB

Product Name	REF	Size	Material	Box/Carton	Preservation Medium
Disposable Virus Specimen Collection Tube	SL901A	Tube:Φ16x100mm,10mL Swab:150mm	Tube:PP Stick:ABS Tip:Nylon Flocked	50kits/16box	Individual Pack
Disposable Virus Specimen Collection Tube	SL901A	Tube:Φ13x84mm,7mL Swab:150mm	Tube:PP Stick:ABS Tip:Nylon Flocked	50kits/20box	Bulk Pack

How To Use

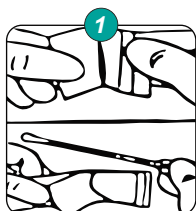

Open the package.

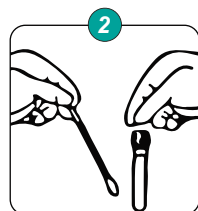

Collect the sample as required.

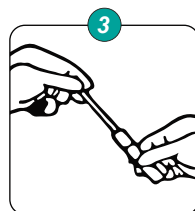

After collecting the sample, place the swab in the sampling solution.

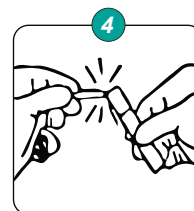

Break the handle at the break point of the swab and leave the swab head in the tube.

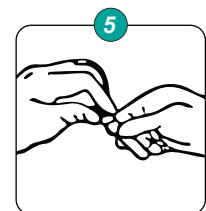

Tighten the cap and mark the sample information on the tube label.

Transfer Pipette

- Made of superior FDA certified LOPE material, Non-toxic, adapted to draw, transfer or carry for small volume liquid.
- Optimizing process on surface tension, easy for the liquid flowing.
- High transparency, easy to observe.
- Can be bend with a certain angle, which is convenient for drawing or adding liquid in irregular or micro container.
- High elasticity, adapted to fast liquid transfer without leakage.
- Convenient and accurate for use with good repeatability.
- Heat seal on the tip of the pipette can achieve liquid carry.
- Available in bulk or individual pack.
- Available in E.O. or Gamma radiation sterile.

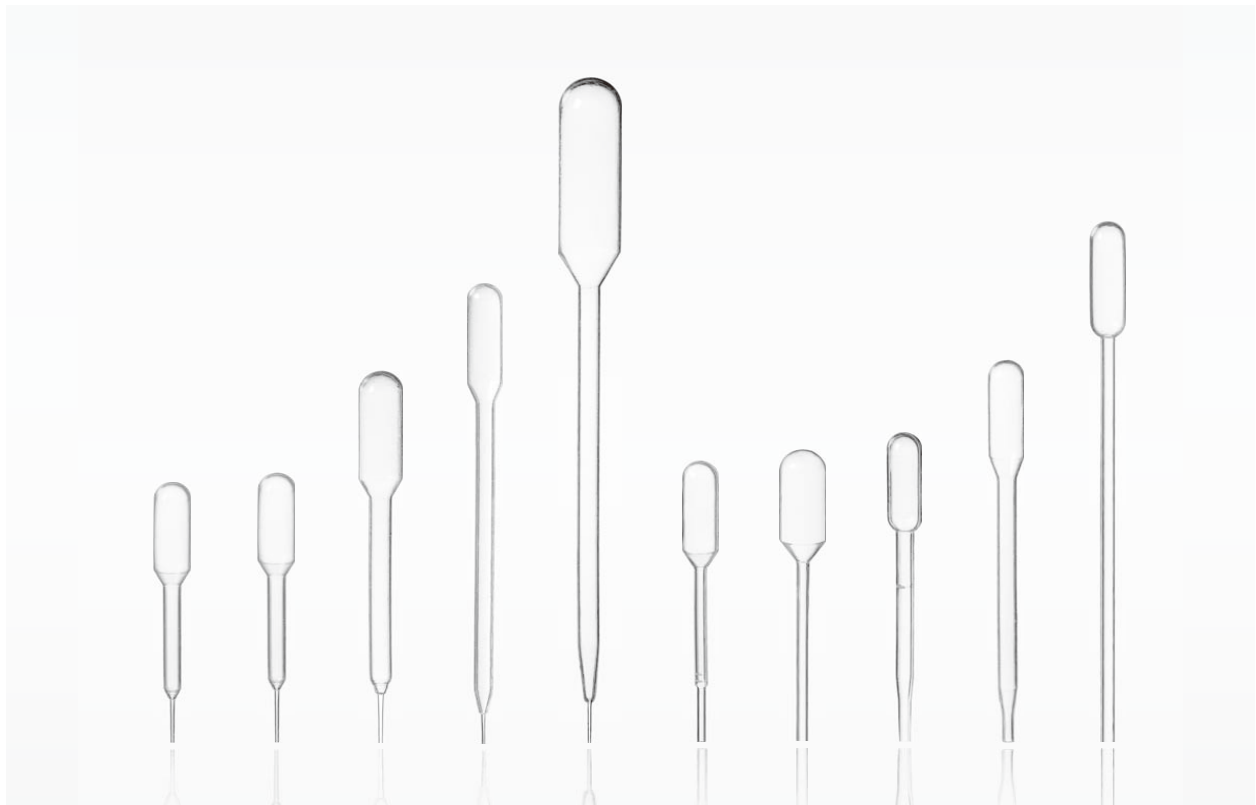

Product Name	REF	Size (mm)	Volume Capacity	Material	Pack/ Carton	Detailed Information
Transfer Pipette	H539-1	155	3mL	LDPE	100PCS/10000PCS	Individual Pack STERILE
Transfer Pipette	H539-2	113	0.5mL	LDPE	500PCS/40000PCS	STERILE
Transfer Pipette	H539-3	145	1mL	LDPE	100PCS/10000PCS	STERILE
Transfer Pipette	H539-4	150	2mL	LDPE	100PCS/10000PCS	STERILE
Transfer Pipette	H539-5	155	3mL	LDPE	100PCS/10000PCS	STERILE
Transfer Pipette	H539-6	185	3mL(Lengthened)	LDPE	100PCS/10000PCS	STERILE
Transfer Pipette	H539-7	210	5mL	LDPE	100PCS/5000PCS	STERILE
Transfer Pipette	H539-8	310	10mL	LDPE	100PCS/2500PCS	STERILE

Serological Pipette

The product is made of imported high quality polystyrene (GPPS) in class 100,000 clean workshop. Novel aspiration area design can fit most of the pipettors on the market. Mainly used for accurate measure or transfer for certain volume liquid and is widely employed in the field of cell culture, bacteriology, clinical research, etc..

- Available in six capacity: 1.0ml, 2.0ml, 5.0ml, 10.0ml, 25.0ml, 50.0ml. Graduations are calibrated within +2%.
- 1.0ml, 2.0ml, 5.0ml pipettes are shaped by stretching method.
- 5.0ml, 10.0ml, 25.0ml, 50.0ml pipettes tips are welded to the tube by supersonic wave.
- Smooth and clean without drawing lines.
- Different colors correspond to different specification, easy to distinguish.
- Maximally reduce the liquid adhesion to the tube inner wall and thus improve the sampling accuracy.
- Excellent double-side graduation design ideally meet with the demand for liquid adding or reducing.
- Clear and simple graduation, as well as the negative one for extra volume, makes the liquid drawing and reading easier.
- All serological pipettes are assembled with high quality filters.
- Strict integrity test on every pipette.
- Non-sterile or sterilized by Gamma radiation/E.O.
- Available with non-pyrogenic and DNase/RNase-free.

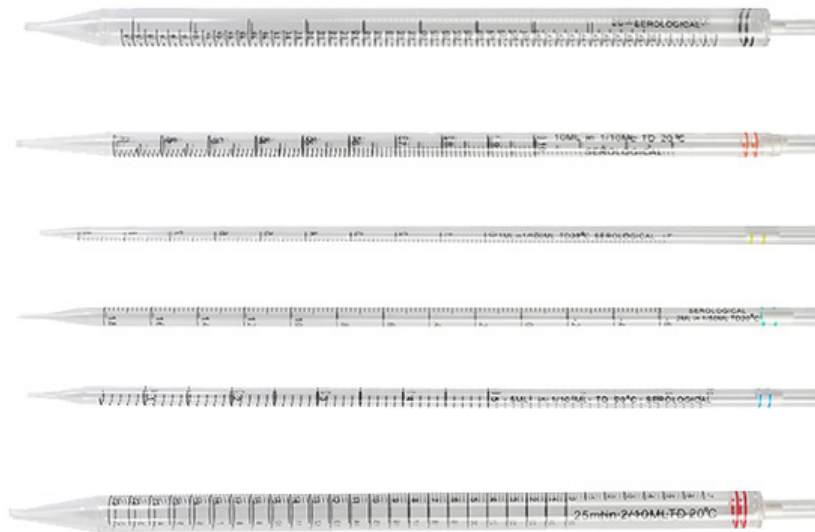

TRANSFER PIPETTE

Product Name	REF	Size (mm)	Volume Capacity	Materia	Box/Carton	Detailed Information
Transfer Pipette	H540-1	Φ5x280	1mL	GPPS	300PCS/1800PCS	Individual Pack STERILE
Transfer Pipette	H540-2	Φ6x280	2mL	GPPS	300PCS/1800PCS	Individual Pack STERILE
Transfer Pipette	H540-3	Φ8x347	5mL	GPPS	300PCS/1800PCS	Individual Pack STERILE
Transfer Pipette	H540-4	Φ8x345	5mL	GPPS	300PCS/1800PCS	Individual Pack STERILE
Transfer Pipette	H540-5	Φ10x342	10mL	GPPS	300PCS/1800PCS	Individual Pack STERILE
Transfer Pipette	H540-6	Φ10x340	10mL	GPPS	300PCS/1800PCS	Individual Pack STERILE
Transfer Pipette	H540-7	Φ15x310	25mL	GPPS	300PCS/1800PCS	Individual Pack STERILE
Transfer Pipette	H540-8	Φ18x355	50mL	GPPS	300PCS/1800PCS	Individual Pack STERILE

Universal Pipette Tip

- The tips are produced in Class 100,000 clean workshop, made from imported polypropylene material. Each batch is strictly evaluated, DNase-free, RNase-free, pyrogen-free, Without endotoxin or PC inhibitor.
- RENJI Universal Pyrogen-free pipette tip could be adapted to various pipettes like: Gilson; Eppendorf, Thermo(Finn);Keeven; Dragonlab etc.
- The High quality pipette tip could simply the strict workflow, Hydrophobic filter avoids cross-contamination of aerosols and liquids, Low-adhere tip could be adapted to viscose liquid and liquid with less surface tension, and reduce the liquid residue on the inner wall to ensure accurate research results.

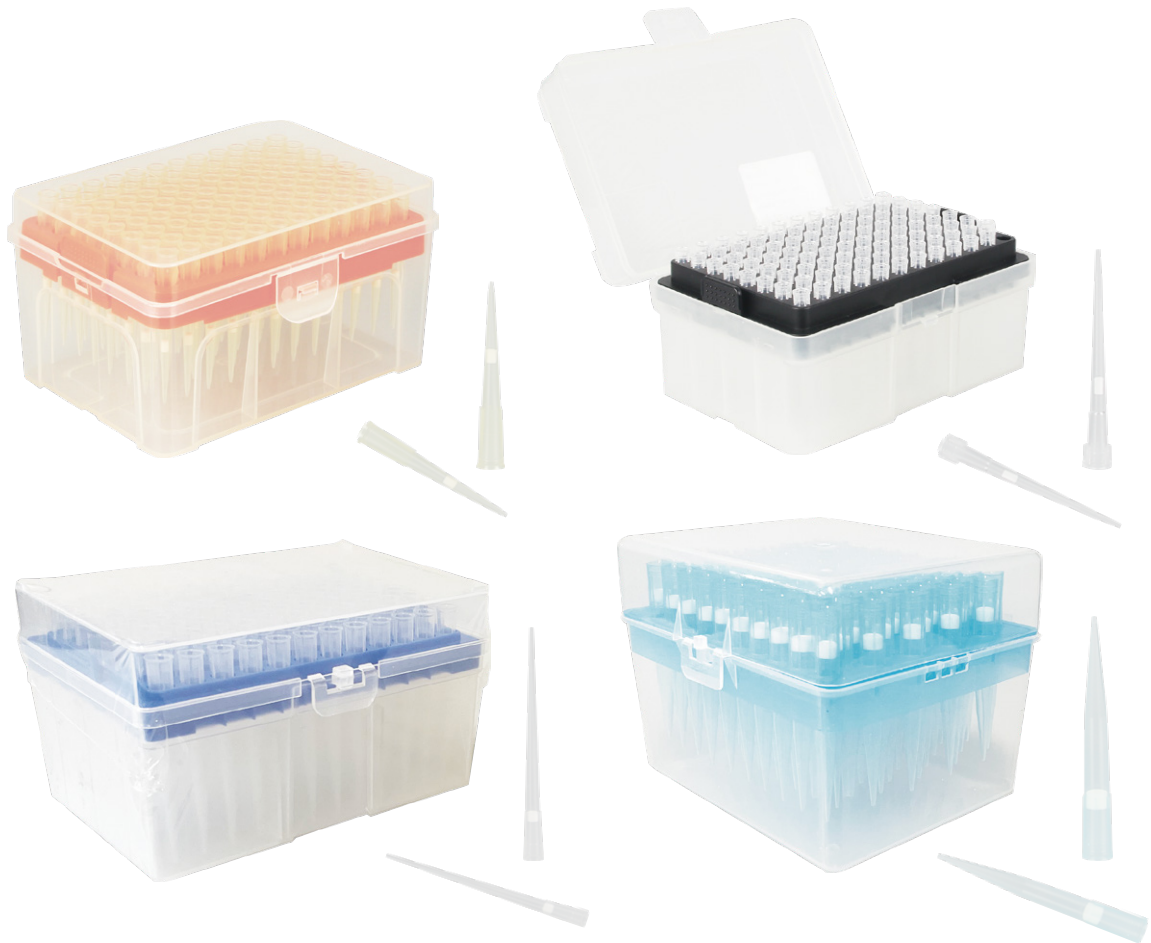

Product Name	REF	Size (mm)	Volume Capacity (mL)	Material	Box/Carton	Detailed Information
Universal Pipette Tip	H541-1	32	10µl	PP	96PCS/4800PCS	Natural Color Boxed
Universal Pipette Tip	H541-2	45	100µl(Lengthened)	PP	96PCS/4800PCS	Natural Color Boxed
Universal Pipette Tip	H541-3	48	20µl	PP	96PCS/4800PCS	Natural Color Boxed
Universal Pipette Tip	H541-4	48	100µl	PP	96PCS/4800PCS	Natural Color Boxed
Universal Pipette Tip	H541-5	51	200µl	PP	96PCS/4800PCS	Yellow/Natural Color with Filter, Boxed
Universal Pipette Tip	H541-6	89	200µl(Lengthened)	PP	96PCS/4800PCS	Yellow/Natural Color with Filter, Boxed
Universal Pipette Tip	H541-7	78	1000µl	PP	96PCS/4800PCS	Blue with Filter, Boxed
Universal Pipette Tip	H541-8	125	1000µl(Lengthened)	PP	96PCS/4800PCS	Blue with Filter, Boxed

Pipette tip for Automatic System

- These tips are designed for excellent liquid treatment result, Under strict quality control procedures to ensure consistency to get excellent tip straightness and reduced variation coefficient.
- The tips are produced in Class 100,000 clean workshop, made from imported polypropylene material. Each batch is strictly evaluated, DNase-free, RNase-free, pyrogen-free, Without endotoxin or PC inhibitor.



PIPETTE TIP

Product Name	REF	Size (mm)	Volume Capacity (mL)	Carton	Detailed Information
Pipette tip for Automatic System	H542-1	127x88x95	200µl	[96+96]x12x4	For TECAN automatic system, 96 PCS Natural tip + 96 PCS Conductive Tip in paper box.
Pipette tip for Automatic System	H542-2	127x88x159	1000µl	[96+96]x12x4	For TECAN automatic system, 96 PCS Natural tip + 96 PCS Conductive Tip in paper box.
Pipette tip for Automatic System	H542-3	125x82x96	300µl	192x12x4	For ADDCARE automatic system, 96+96 PCS natural tip in paper box.
Pipette tip for Automatic System	H542-4	125x82x126	800µl	192x12x4	For ADDCARE automatic system, 96+96 PCS natural tip in paper box.
Pipette tip for Automatic System	H542-5	127x88x95	200µl	96x50	Boxed tips for TECAN
Pipette tip for Automatic System	H542-6	127x88x159	1000µl	96x50	Boxed tips for TECAN
Pipette tip for Automatic System	H542-7	125x82x96	30µl	384x50	Boxed tips for Agilent
Pipette tip for Automatic System	H542-8	125x82x126	250µl	96x50	Boxed tips for Beckman

Pipette Tip & Box for Tips

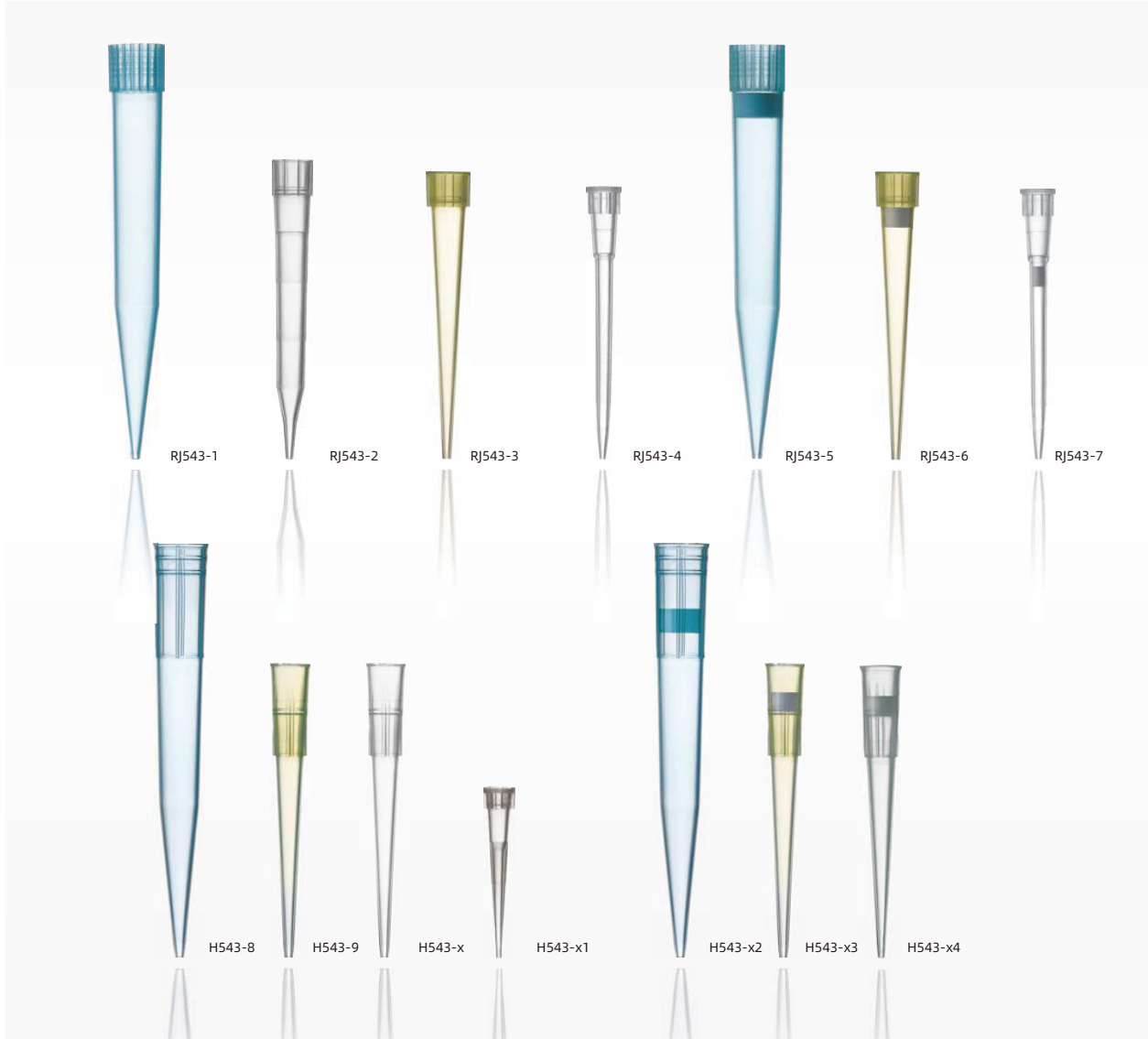

Product Name	REF	Size (mm)	Volume Capacity (mL)	Material	Pack/ Carton	Detailed Information
Pipette Tip	H543-1	Φ8x71	1000μl	PP	1000PCS/50000PCS	Natural Color Boxed
Pipette Tip	H543-2		300μl	PP	1000PCS/50000PCS	Natural Color Boxed
Pipette Tip	H543-3	Φ6x52	200μl	PP	1000PCS/50000PCS	Natural Color Boxed
Pipette Tip	H543-4	Φ5x32	10μl	PP	1000PCS/50000PCS	Natural Color Boxed
Pipette Tip	H543-5	Φ8x71	1000μl	PP	500PCS/20000PCS	Yellow/Natural Color with Filter, Boxed
Pipette Tip	H543-6	Φ6x52	200μl	PP	500PCS/20000PCS	Yellow/Natural Color with Filter, Boxed
Pipette Tip	H543-8	Φ5x32	10μl	PP	500PCS/12000PCS	Blue with Filter, Boxed
Pipette Tip	H543-9	Φ8x71	1000μl	PP	500PCS/12000PCS	Blue with Filter, Boxed
Pipette Tip	H543-x	Φ6x52	200μl	PP	500PCS/20000PCS	Yellow/Natural Color with Filter, Boxed
Pipette Tip	H543-x1	Φ5x32	10μl	PP	500PCS/20000PCS	Yellow/Natural Color with Filter, Boxed
Pipette Tip	H543-x2	Φ8x71	1000μl	PP	500PCS/12000PCS	Blue with Filter, Boxed
Pipette Tip	H543-x3	Φ6x52	200μl	PP	500PCS/12000PCS	Blue with Filter, Boxed

Pipette Tip & Box for Tips



PIPETTE TIP

Product Name	REF	Size (mm)	Volume Capacity (mL)	Materia	Pack/Carton	Detailed Information
Pipette Tip	H543-x4	32	10µl	PP	1000PCS/50000PCS	Natural Color Boxed
Pipette Tip	H543-x5	45	10µl(Lengthened)	PP	1000PCS/50000PCS	Natural Color Boxed
Pipette Tip	H543-x6	48	20µl	PP	1000PCS/50000PCS	Natural Color Boxed
Pipette Tip	H543-x7	48	100µl	PP	1000PCS/50000PCS	Natural Color Boxed
Pipette Tip	H543-x8	51	200µl	PP	500PCS/20000PCS	Yellow/Natural Color with Filter, Boxed
Pipette Tip	H543-x9	89	200µl(Lengthened)	PP	500PCS/20000PCS	Yellow/Natural Color with Filter, Boxed
Pipette Tip	H543-x10	78	1000µl	PP	500PCS/12000PCS	Blue with Filter, Boxed
Pipette Tip	H543-x11	125	1000µl(Lengthened)	PP	500PCS/12000PCS	Blue with Filter, Boxed

Product Name	REF	Size (mm)	Specification	Materia	Pack/Carton	Detailed Information
Box for Tips	H544-1	120x85x55	96 Wells	PP	1000PCS/50000PCS	Box for 10ul tips
Box for Tips	H544-2	120x85x60	96 Wells	PP	1000PCS/50000PCS	Box for 200ul tips
Box for Tips	H544-3	120x85x75	96 Wells	PP	1000PCS/50000PCS	Box for 1000ul tips
Box for Tips	H544-4	125x85x115	96 Wells	PP	1000PCS/50000PCS	Box for 1000ul(Lengthened) tips
Box for Tips	H544-5	100x85x75	28 Wells	PP	500PCS/20000PCS	Box for 5ml tips
Box for Tips	H544-6	100x85x115	15 Wells	PP	500PCS/20000PCS	Box for 10ml tips

Extraction Tube



Product Name	REF	Size (mm)	Volume Capacity	Material	Pack/ Carton	Detailed Information
Extraction Tube	H545-1	80	3mL	PP	5PCS/5000PCS	STERILE
Extraction Tube	H545-2	50	3mL	PP	10PCS/10000PCS	STERILE
Extraction Tube	H545-3	40	1mL	PP	10PCS/10000PCS	STERILE
Extraction Tube	H545-4	45	3mL	PP	10PCS/10000PCS	STERILE

Disposable Vaginal Speculum

- Made of polystyrene with see-through clarity. Smooth one-handed operation for easier insertion. Single patient use eliminates cross-contamination. Self locking feature speeds examination and saves time. Graves style. Available in small, medium and large.



MEDICAL TESTING

Product Name	REF	Size (mm)	Volume Capacity	Material	Pack/ Carton	Detailed Information
Disposable Vaginal Speculum	H547-1			PP/PE	1PCS/100PCS	STERILE
Disposable Vaginal Speculum	H547-2			PP/PE	1PCS/100PCS	STERILE
Disposable Vaginal Speculum	H547-3			PP	1PCS/100PCS	STERILE
Disposable Vaginal Speculum	H547-4			PP	1PCS/100PCS	STERILE

Disposable Automatic Venous Compression Band



MEDICAL TESTING

Disposable Automatic Venous Compression Band

- **1. No need for manual continuous pressing**
Place the center of the automatic pressure medical applicator on the puncture hole, stick the stickers on both sides of the product on the epidermis with one hand, and quickly press the product pressing part after the needle is pulled out to achieve the effect of continuous pressing and hemostasis. Eliminate the risk of blood infection caused by the hands of the press personnel touching the blood.
- **2. Can be operated with one hand**
Through the unique product design and packaging design, the automatic intravenous compression medical applicator realizes that the product can be taken out of the packaging and pressed to stop bleeding with one hand. It is the only one-handed operation among similar products at home and abroad. Venous pressure hemostatic patch.
- **3. Safe and effective**
The pressure area of the automatic venous pressure medical applicator greatly exceeds the clinical safety range of 5mm around the puncture point. It can effectively compress the epidermal puncture port and the blood vessel puncture port, and will not cause subcutaneous bleeding and cause subcutaneous bruising. It can be effective after puncture and needle removal Hemostasis and protects the patient's blood vessels.
- **4. Wide range of applications**
The automatic venous compression medical applicator can be used for steel needles and indwelling needles in any part of the human body, after venipuncture and infusion needles are pulled out and the needles are pressed to stop.

Needle Filters

RENJI syringe filters are suitable for applications such as solution preparation, sterile filtration, biological sample preparation, and more.

- **Mixed Cellulose (MCE) Syringe Filter Water System**

Mixed cellulose (MCE) needle filter has good hydrophilicity, high porosity and filtration speed, and is mainly used for: 1. sterilization and particle removal in laboratory and small test processes; 2. culture medium 3. Determination of bacterial flora in water.

- **Cellulose Acetate (CA) Syringe Filter Water System**

Cellulose acetate (CA) needle filter has good hydrophilicity, low protein adsorption and no nitrate, mainly used for: 1. groundwater filtration; 2. biological and clinical fluid filtration.

- **Polytetrafluoroethylene (PTFE) Syringe Filter Organic**

Polytetrafluoroethylene (PTFE) needle filter has excellent chemical stability and inertness, mainly used for: 1. filtration of strong chemical corrosive organic solvents; 2. filtration of strong acid solvents; 3. gas filtration; 4. Steam filtration.



Product Name	REF	Size (mm)	Pore diameter	Material	Box/ Carton	Detailed Information
Needle Filters	H549-M1	Φ13	0.22μm	MCE	100PCS/1800PCS	For water system
Needle Filters	H549-M2	Φ13	0.45μm	MCE	100PCS/1800PCS	For water system
Needle Filters	H549-M4	Φ25	0.22μm	MCE	100PCS/1800PCS	For water system
Needle Filters	H549-M5	Φ25	0.45μm	MCE	100PCS/1800PCS	For water system
Needle Filters	H549-C1	Φ13	0.22μm	CA	100PCS/1800PCS	For water system
Needle Filters	H549-C2	Φ13	0.45μm	CA	100PCS/1800PCS	For water system
Needle Filters	H549-C3	Φ25	0.22μm	CA	100PCS/1800PCS	For water system
Needle Filters	H549-C4	Φ25	0.45μm	CA	100PCS/1800PCS	For water system
Needle Filters	H549-P1	Φ13	0.22μm	PTFE	100PCS/1800PCS	For organic system
Needle Filters	H549-P2	Φ13	0.45μm	PTFE	100PCS/1800PCS	For organic system
Needle Filters	H549-P3	Φ25	0.22μm	PTFE	100PCS/1800PCS	For organic system
Needle Filters	H549-P4	Φ25	0.45μm	PTFE	100PCS/1800PCS	For organic system

Needle Holder

- This eliminates the hazards associated with reusable needle holders
- The needle holder fits both 13mm and 16mm blood collection tubes and all common needle units
- The holder completes the blood collection assembly when combined



Product Name	REF	Auge	Needle Outer Diamete	Materia	Pack/Carton	Needle Length
Needle Holder	H556-1	21G	0.8mm	PP	100PCS/3000PCS	1" & 1 1/2" & 1 1/4"
Needle Holder	H556-2	22G	0.7mm	PP	100PCS/3000PCS	1" & 1 1/2" & 1 1/4"

Slide Storage Box

- Made of ABS material, available in mode of 25-place, 50-place and 100-place, etc. These boxes accommodate slides with thickness less than 2mm.
- Easy for cleaning and storage, corrosion-resistant, shock-resistant.
- The box base is cork lined for extra protection.



HISTOLOGY & ACCESSORIES

Product Name	REF	Size (mm)	Specification	Box/Carton	Detailed Information
Slide Storage Box	H551-1	210x160x35	100-Place	1PCS/50PCS	Buckled Slide Storage Box, Colour: cream
Slide Storage Box	H551-2	210x160x30	100-Place	1PCS/50PCS	Slide Storage Box, Colour: cream
Slide Storage Box	H551-3	210x80x30	50-Place	1PCS/100PCS	Slide Storage Box, Colour: cream
Slide Storage Box	H551-4	82x95x32	25-Place	1PCS/200PCS	Slide Storage Box, Colour: cream
Slide Storage Box	H551-5	210x80x30	50-Place	1PCS/100PCS	Slide Storage Box, Cork lined, Colour: cream
Slide Storage Box	H551-6	210x160x30	100-Place	1PCS/50PCS	Slide Storage Box, Cork lined, Colour: cream
Glass Slide	H552	25.4x76.2		50PCS/10000PCS	
Coverslip	H553	2.24x24		100PCS/20000PCS	

Full Automatic Nucleic Acid Extraction Instrument

- RJ40 can process 96 samples simultaneously
- Open and multiple functions design can be provided more methods for reagent optimization, and also a reliable choice
- Touchscreen interface and easy operation, parameters can be tuned based on experimental requirements
- Accurate temperature control system ensures stability of purification performance
- Patent design for automatic loading and unloading structure of magnetic rod tip comb, which guaranteed stability and liability (Success rate >99.99%)

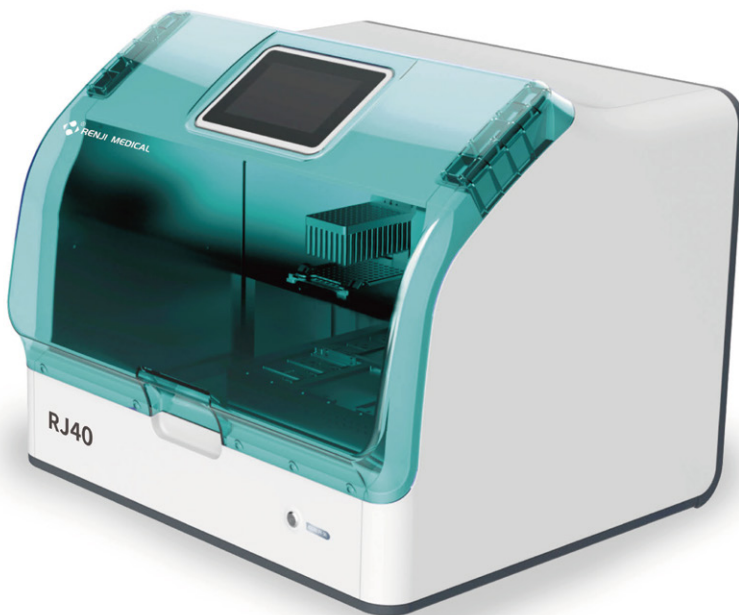

HD large screen display

Flexible

Security

Efficient



Full Automatic Nucleic Acid Extraction Instrument-RJ40

Full Automatic Nucleic Acid Extract Instrument is the latest nucleic acid extraction and purification system designed by Renji , with model number of RJ40.

Extracting nucleic acid method is based on the magnetic bead. The magnetic bead and nucleic acid molecules are specifically identified and combined with high efficiency. The magnetic rod is used to adsorb, transfer and release the magnetic bead to realize the transfer of magnetic bead/sample and complete the operation of nucleic acid extraction and purification. Touch button, easy to operate, built-in UV lamp, effectively prevent cross-contamination between samples. 96 samples could be processed at the same time without wasting reagent. The purified nucleic acid was extracted from respiratory tract and genital tract swabs, serum/plasma and puncture fluid, whole blood, feces, urine, amniotic fluid, sputum, bacteria, cultured cells and viruses.

Sample Processing System

Double channels in the cice treatment system: open the cover module, dual channel pipette, can complete the sample scan code, information entry, open cover, pipette, stream and PCR reaction system formulation, and full It is in a closed negative pressure environment to avoid pollutants leakage

Fast & accurate

- Built-in Independent double channel: open the cover module, pipetting module
- Slim pipetting can be added at irregular spacing, with spacing adjustable from 9-26mm;
- Effective pipetting range: 2ul-1000 ul ;
- Pipetting accuracy: 2ul cv≤5%. 10ul cv≤2.5%. >50ul cv≤0.5%;
- The dual-channel pipetting module adopts capacitive sensing and pressure sensing detection to realize micro and precise pipetting,
- Scan the code, open the lid, pipet and cap 96 samples in 20 minutes.
- Build a pcr system for 96 samples in 8-13 minutes
- Daily throughput: more than 6000 samples, improve the detection flux, save manpower input;

Safety protection

- Automatic unloading, real-time monitoring of pin loading/unloading, improve the efficiency and reliability of unloading
- Built-in hepa negative pressure filtration system and u disinfection system, the filtration efficiency of 0.3um diameter particles is not lower than 99.999%, effectively prevent aerosol pollutants leakage
- With startup self - check, error alarm, the whole closed loop state monitoring function

Compatibility

- Compatible with dry mixing tubes and supports 5 in 1 and 10 in 1 sampling tubes, allowing you to take a sample without taking a swab out.
- Compatible with the wet mixing cup mode: 2 in 1, 3 in 1, 4 in 1, 5 in 1, 10 in 1. etc
- Compatible with sampling tube with diameter of 11-16mm and height of 50-150mm
- Support not less than 8 sampling tubes of different specifications to operate on the computer at the same time
- Compatible 10 ul. 50 ul. 200 ul. 1000 ul tip on the machine at the same time:
- Compatible with a variety of nucleic acid extraction deep well platés: 8 / 16 / 48 / 96 person /plate nuclei acid extraction plate
- Compatible with various systems to prepare per reaction tubest the carrier can be equipped with 0.1ml/0.2ml single tube. 8-tube and 96 well per reaction plate

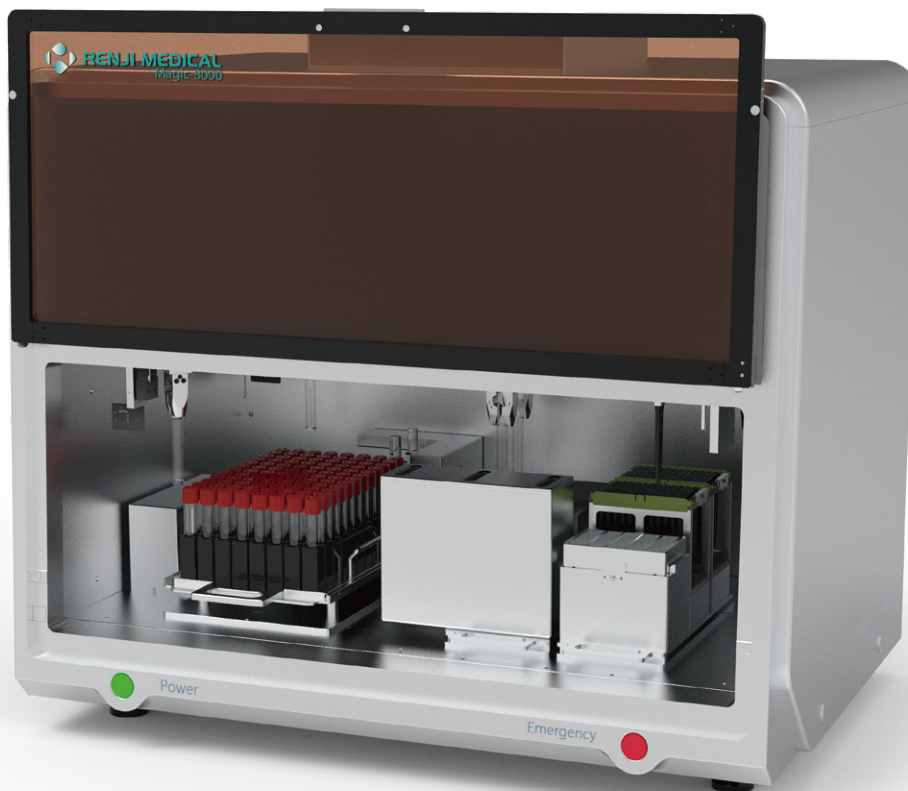

Sample Dispensing System Magic-8000

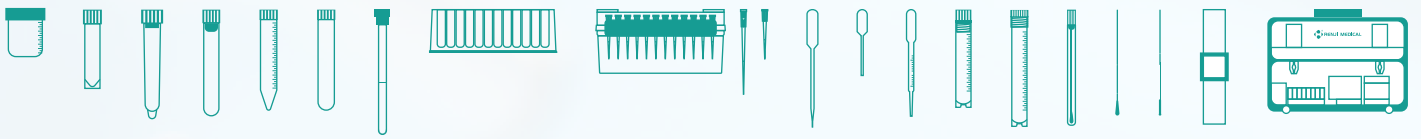

Changsha Renji Medical Equipment Co., Ltd.

TEL: +86 0731-83075656

Mobile/WhatsApp: +86 15577087967

E-mail: vivien@renjigroup.com

Website: www.renjigroup.com

Factory ADD: Workshop 201, Stage 4, Changsha E Center, No.18 Xiangtai Road, Liuyang Jingkai District, Changsha City, Hunan Province, China.

Sales Office: R.1403, Wangdefu Kaiyue International Building, No. 526 Sanyi Avenue, Changsha City, Hunan Province, China.

The copyright of this manual belongs to Changsha Renji Medical Equipment Co., Ltd. Without the written permission of the company, no other individual or organization may copy, copy, edit or translate the contents of this manual into other languages in any form. All trademarks or logos in this manual belong to Changsha Renji Medical Equipment Co., Ltd. and its suppliers.

Version: September 2022 | RJ@HUI

The information on which this manual is based is as of September 13, 2022. All contents are for reference only, and do not constitute any commitment or guarantee of the company. The final signed contract shall prevail.