

NOTA EXPLICATIVA
 1. Amplasarea pe plan a conductelor si cablurilor este schematica.
 2. Amplasarea pe plan a aspersoarelor - la scara desenului.
 3. In locul intersectarii conductelor si cablurilor cu drumuri, alei, trotuare se instaleaza tocuri din plastic cu diametrul de 90 mm.

DETALIU MONTARE CONTROLER SI SENSOR DE PLOAIE SI INGHEȚ

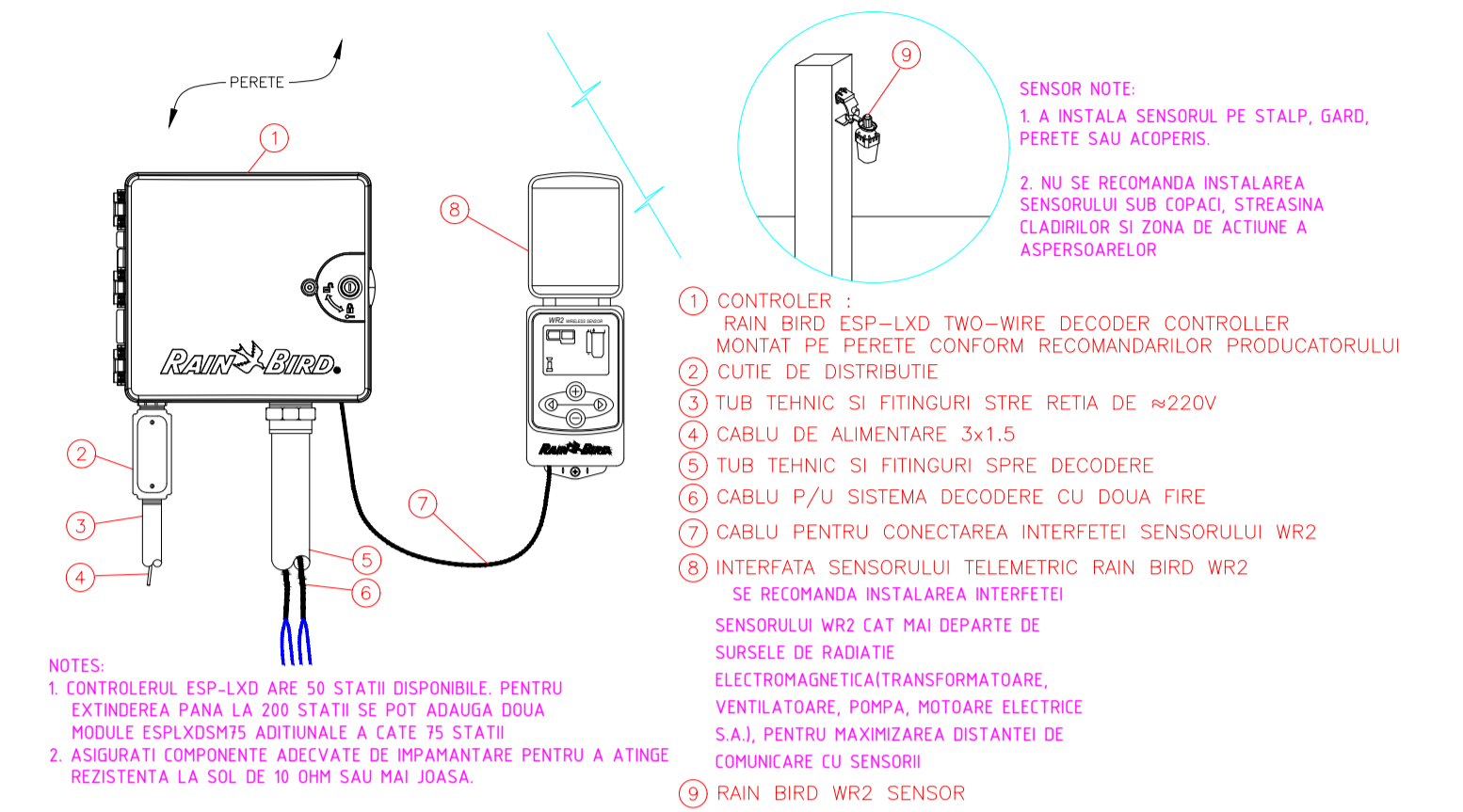

SEMNICIFICATI CONVENTIONALE

Symbol	Description	Part #
	Rain Bird 6-VAN 180 - 1804	6-VAN
	Rain Bird 8-VAN 180 - 1804	8-VAN
	Rain Bird 8-VAN 180 - US-400	8-VAN
	Rain Bird 10-VAN 180 - 1804	10-VAN
	Rain Bird 10-VAN 180 - US-400	10-VAN
	Rain Bird 10-VAN 90 - 1804	10-VAN
	Rain Bird 12-VAN 180 - 1804	12-VAN
	Rain Bird 12-VAN 90 - 1804	12-VAN
	Rain Bird HE-VAN-12 90 - US-400	HE-VAN-12
	Rain Bird 3500 Series 0.75 - 3504-PC	0.75
	Febco 850 - 2"	850 - 2"
	Rain Bird 200-PGA Globe	200-PGA Globe
	Rain Bird ESPLXMI-12	ESPLXMI-12
	Nibco 2" isolation valve	
	Rain Bird FS200P	FS200P
	Rain Bird RSD-BEx	RSD-BEx
	Irricable-3 fire	0
	Lateral - 50mm	0
	Mainline - 63mm	0
	XFD-09-12	XFD-09-12

DETALIU MONTARE ASPERSOARE

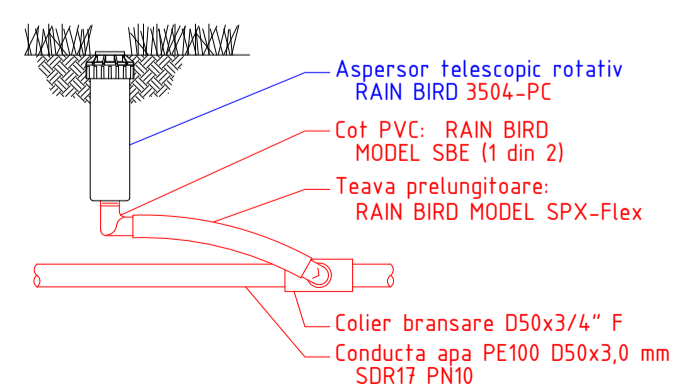

DETALIU POZARE CONDUCTE SI CABLURI IN SANT

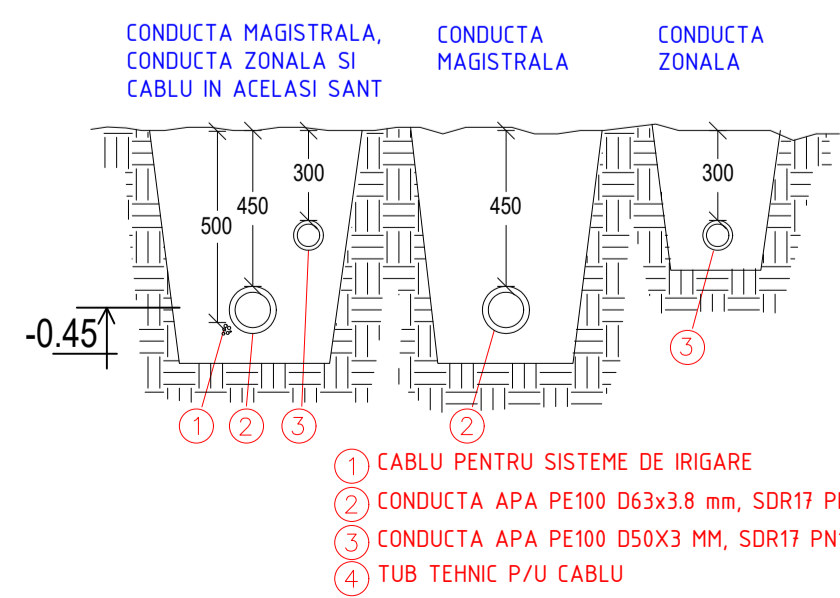

DETALIU MONTARE ELECTROVALVA IN BOXA

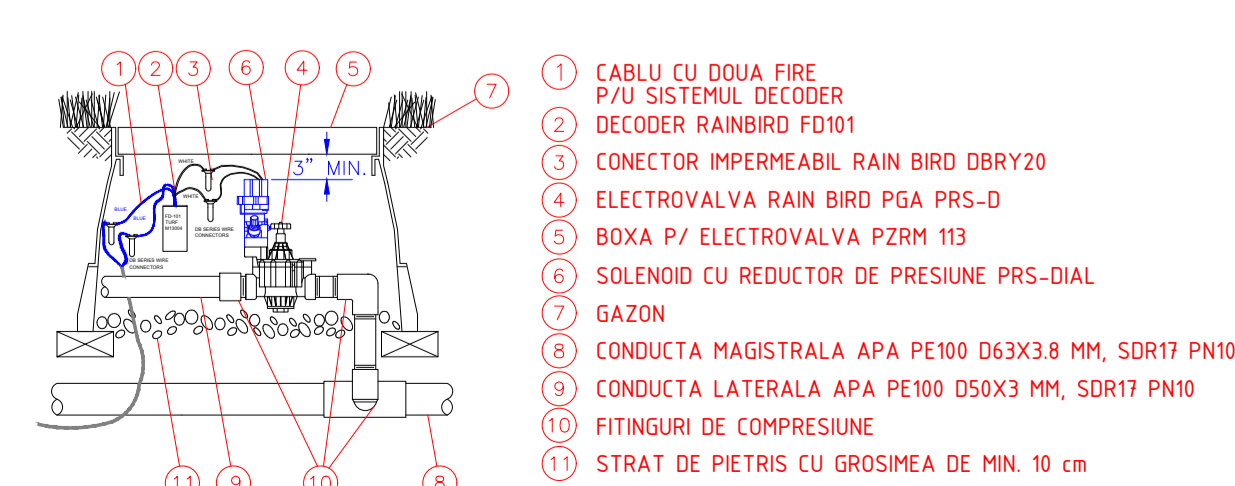

164/KO-2020-IR				
Reabilitarea scuarului Mihai Eminescu in municipiul Chisinau, sectorul Centru, bd. Stefan cel Mare				
Modif.	Part.	Coala	Nr. doc.	Semnatura
A.S.P.				
Intocmit	Grosu lu			
Beneficiar: I.M. "Asociatia de gospodarie a spatiilor verzi"			Faza	Coala
Plan sistem de irigare S1:200			PE	1