

Hi-MO 6

Explorer

LR5-72HTH 560~580M

- Suitable for Distribution Market
- Simple design embodies modern style
- Better energy generation performance
- High-quality module guarantees long-term reliability



15-year Warranty for
Materials and Processing



25-year Warranty for Extra
Linear Power Output

Complete System and Product Certifications

IEC 61215, IEC 61730, UL 61730

ISO9001:2015: ISO Quality Management System

ISO14001: 2015: ISO Environment Management System

ISO45001: 2018: Occupational Health and Safety

IEC62941: Guideline for module design qualification and type approval

LONGI



22.5%
MAX MODULE
EFFICIENCY

0~3%
POWER
TOLERANCE

<1.5%
FIRST YEAR
POWER DEGRADATION

0.40%
YEAR 2-25
POWER DEGRADATION

Additional Value

25-Year Power Warranty

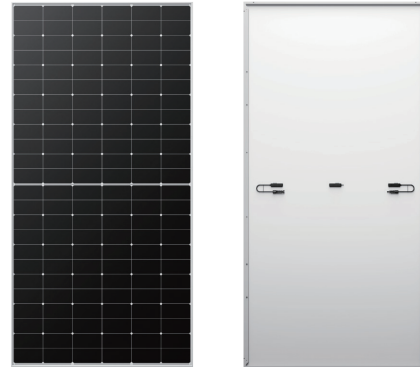
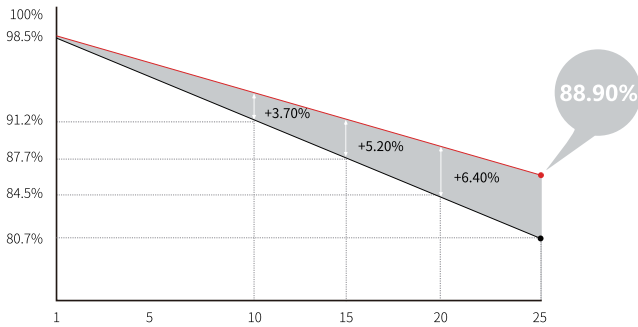

Mechanical Parameters

Cell Orientation	144 (6×24)
Junction Box	IP68, three diodes
Output Cable	4mm ² , +400, -200mm/±1400mm length can be customized
Glass	Single glass, 3.2mm coated tempered glass
Frame	Anodized aluminum alloy frame
Weight	27.5kg
Dimension	2278×1134×35mm
Packaging	31pcs per pallet / 155pcs per 20' GP / 620pcs per 40' HC

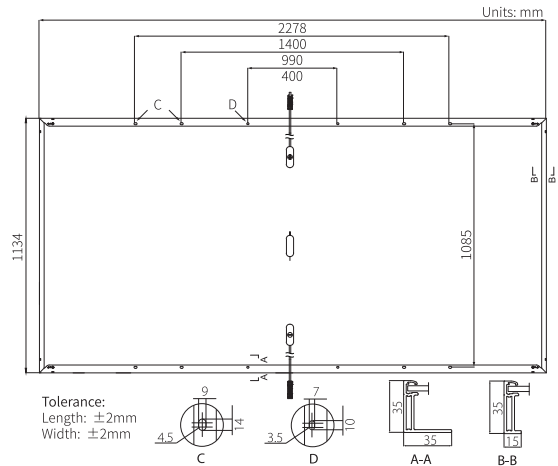

Electrical Characteristics

STC : AM1.5 1000W/m² 25°C NOCT : AM1.5 800W/m² 20°C 1m/s Test uncertainty for Pmax: ±3%

Module Type	LR5-72HTH-560M		LR5-72HTH-565M		LR5-72HTH-570M		LR5-72HTH-575M		LR5-72HTH-580M	
	STC	NOCT	STC	NOCT	STC	NOCT	STC	NOCT	STC	NOCT
Maximum Power (Pmax/W)	560	418	565	422	570	426	575	430	580	433
Open Circuit Voltage (Voc/V)	51.61	48.46	51.76	48.60	51.91	48.74	52.06	48.88	52.21	49.02
Short Circuit Current (Isc/A)	13.94	11.26	14.01	11.31	14.07	11.36	14.14	11.42	14.20	11.47
Voltage at Maximum Power (Vmp/V)	43.46	39.66	43.61	39.79	43.76	39.93	43.91	40.07	44.06	40.20
Current at Maximum Power (Imp/A)	12.89	10.55	12.96	10.61	13.03	10.67	13.10	10.72	13.17	10.78
Module Efficiency(%)	21.7		21.9		22.1		22.3		22.5	

Operating Parameters

Operational Temperature	-40°C ~ +85°C
Power Output Tolerance	0 ~ 3%
Voc and Isc Tolerance	±3%
Maximum System Voltage	DC1500V (IEC/UL)
Maximum Series Fuse Rating	25A
Nominal Operating Cell Temperature	45±2°C
Protection Class	Class II
Fire Rating	UL type 1 or 2 IEC Class C

Mechanical Loading

Front Side Maximum Static Loading	5400Pa
Rear Side Maximum Static Loading	2400Pa
Hailstone Test	25mm Hailstone at the speed of 23m/s

Temperature Ratings (STC)

Temperature Coefficient of Isc	+0.050%/°C
Temperature Coefficient of Voc	-0.230%/°C
Temperature Coefficient of Pmax	-0.290%/°C

SOFAR 25K~50KTLX-G3

25 / 30 / 33 / 36 / 40 / 45 / 50 kW

THREE-PHASE THREE TO FOUR MPPTS



Product advantages

- Max. efficiency up to 98.80%
- Up to 4 MPPTs with DC overload capability (up to 150%)
- Type II SPD for both DC and AC side
- Prolonged AC overload capability (110%)
- Low start-up voltage, wide MPPT voltage range
- Compatible with 500 W+ modules
- I-V curve scanning function



Model	SOFAR 25KTLX-G3	SOFAR 30KTLX-G3	SOFAR 33KTLX-G3	SOFAR 36KTLX-G3	SOFAR 40KTLX-G3	SOFAR 45KTLX-G3	SOFAR 50KTLX-G3
Input (DC)							
Max. input voltage	1100V						
Rated input voltage	620V						
Start-up voltage	200V						
MPPT operating voltage range	180V-1000V						
Number of MPP trackers	3			4			
Number of DC inputs	2 for each MPPT						
Max. input MPPT current	3*40A	3*40A	3*40A	3*40A	4*40A	4*40A	4*40A
Max. input short circuit current	3*50A	3*50A	3*50A	3*50A	4*50A	4*50A	4*50A
Output (AC)							
Rated output power	25000W	30000W	33000W	36000W	40000W	45000W	50000W
Max. apparent power	28000VA	34000VA	37000VA	40000VA	44000VA	50000VA	55000VA
Max. output current	42.4A	51.5A	56A	60.6A	66.7A	75.8A	83.3A
Rated output voltage	3/N/PE, 230/400Vac						
Output voltage range	310Vac-480Vac						
Rated output frequency	50/60Hz						
Output frequency range	45Hz-55Hz/55Hz-65Hz						
Active power adjustable range	0-100%						
THDi	<3%						
Power factor	1 (adjustable +/-0.8)						
Efficiency							
Max. efficiency	98.6%	98.6%	98.6%	98.6%	98.8%	98.8%	98.8%
European efficiency	98.2%	98.2%	98.2%	98.2%	98.2%	98.2%	98.2%
Protection							
DC reverse polarity protection	Yes						
Anti-islanding protection	Yes						
Leakage current protection	Yes						
Ground fault monitoring	Yes						
PV-array string fault monitoring	Yes						
DC switch	Yes						
SPD	PV: type II, AC: type II						
General Data							
Ambient temperature range	-30°C~+60°C						
Self-consumption at night	<3W						
Topology	Transformerless						
Degree of protection	IP65						
Allowable relative humidity range	0-100%						
Max. operating altitude	4000m						
Cooling	Smart air cooling						
Dimension (W*H*D)	585*480*220mm						
Weight	36kg			37kg			
Display	LCD & Bluetooth +APP						
Communication	RS485/WiFi						
Standard	IEC/EN 61000-6-1/2/3/4, IEC 62116, IEC 61727, IEC 61683, IEC 60068-1/2/14/30, IEC/EN 62109-1/2, G99, VDE-AR-N 4105, VDE V 0126-1-1, CEI0-21, EN 50549-1, NRS 097-2-1, UNE 217002-2020						

*All specifications are subject to change without notice.