

# hs-CRP+CRP

The sensitive indicator for diagnosis and identification of virus infection or bacterial infection

One Step Test for hs-CRP+CRP

### Clinical Applications

- Diagnosis and identification of virus infection or bacterial infection
- Detection of severity of conventional inflammation
- Monitoring of postoperative infection and complication
- Prediction of cardiovascular event risk probability

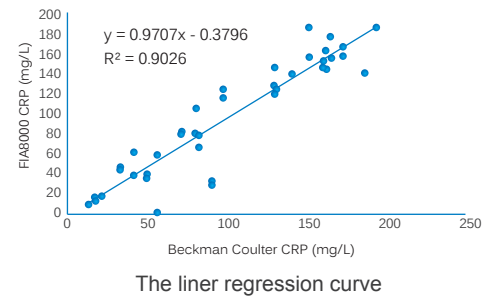

# HCG+β

As an aid diagnosis of early pregnancy

One Step Test for HCG+β

### Clinical Applications

- Diagnosis of early pregnancy
- Diagnose and monitor the status of the embryonic development
- Diagnosis of ectopic pregnancy
- Observation of threatened abortion and incomplete abortion
- To assist the diagnosis of Down's syndrome (DS) with AFP and FE3
- Diagnosis of trophoblastic disease, therapeutic effect and prognosis

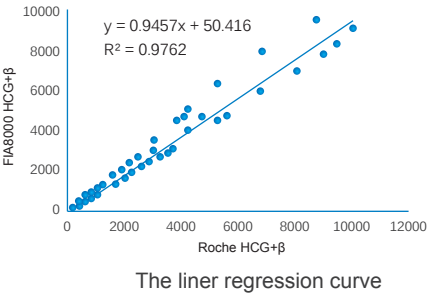

# D-Dimer

The specific indicator for the exclusion of venous thromboembolism (VTE)

One Step Test for D-Dimer

### Clinical Applications

- Aid in the exclusion of venous thromboembolism (VTE)
- Aid in the exclusion of pulmonary embolism (PE)
- Aid in the diagnosis of disseminated intravascular coagulation (DIC)
- Aid in the diagnosis of acute coronary syndrome (ACS)
- Aid in the evaluation of coagulation status of pregnancy-induced hypertension
- Aid in the diagnosis and prognosis of patients with surgery; monitor the thrombolytic therapy.

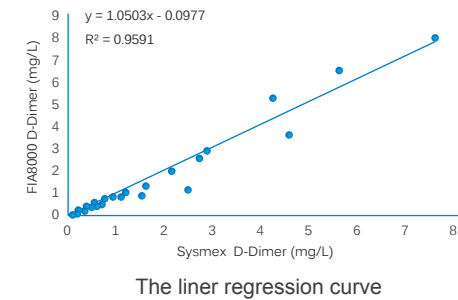

# NT-proBNP

The ideal biomarker for the evaluation of the heart function

One Step Test for NT-proBNP

### Clinical Applications

- Early detection for patients with heart failure
- Diagnosis and risk stratification of heart failure
- Distinguishing dyspnea caused by heart failure from other disease
- Monitoring and prognostic assessment of heart failure treatment
- Screening and diagnosis for non-cardiac heart failure patients
- As an aid in the risk stratification for ACS

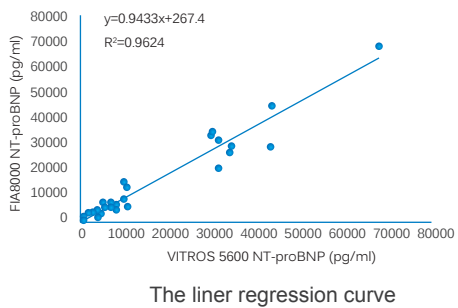

# FIA8000

Test Items

Cat.#	Test Item	Disease	Measuring Range	Sample	Cut-off Value	Reaction Time	Qualification
CG 1001	cTnI	Myocardial infarction	0.5~50.0 ng/ml	S/P/W.B.	0.5 ng/ml	15 min	CFDA
CG 1002	NT-proBNP	Heart failure	100~35000 pg/ml	S/P/W.B.	300 pg/ml	15 min	CFDA
CG 1003	hs-CRP+CRP	Cardiovascular inflammatory diseases; Inflammatory disorders	0.5~200 mg/L	S/P/W.B./ Fingertip blood	3 mg/L 10 mg/L	90 s	CFDA
CG 1004	NT-proBNP /cTnI	Heart failure; Acute coronary syndrome	100~12000 pg/ml 0.5~50.0 ng/ml	S/P/W.B.	300 pg/ml 0.5 ng/ml	18 min	CFDA
CG 1005	CK-MB /cTnI /Myo	Myocardial injury	2.5~80.0 ng/ml 0.5~50.0 ng/ml 30~1000 ng/ml	S/P/W.B.	5 ng/ml 0.5 ng/ml 70 ng/ml	15 min	CFDA
CG 1006	D-Dimer	Venous thromboembolism; Pulmonary embolism	0.1~10.0 mg/L	P/W.B.	0.5 mg/L	7 min	CFDA
CG 1007	PCT	Sepsis; Septic shock	0.1~50.0 ng/ml	S/P/W.B.	0.1ng/ml	15min	CFDA
CG 1008	CysC	Early diagnosis of kidney disease; Detection of kidney damage for surgery patients	0.5~10.0 mg/L	S/P/W.B.	0.51~1.09 mg/L	3 min	CFDA
CG 1009	mAlb	Early diagnosis and evaluation of diabetic nephropathy	10~200 mg/L	Urine	20 mg/L	3 min	CFDA
CG 1010	NGAL	The best indicator of early renal injury	50~5000 ng/ml	S/Urine	Serum:200 ng/ml Urine:100 ng/ml	3 min	CFDA
CG 1011	β <sub>2</sub> - MG	Kidney damage for diabetic & hypertensive patients	0.5~20.0 mg/L	S/P/W.B.	0.8~3.0 mg/L	3 min	CFDA
CG 1012	CK-MB /cTnI	Myocardial injury	2.5~80.0 ng/ml 0.5~50.0 ng/ml	S/P/W.B.	5 ng/ml 0.5 ng/ml	15 min	CFDA
CG 1013	HCG+β	Pregnancy early test	5~100000 mIU/ml	S/P	5.1 mIU/ml	10min	CFDA
CG 1017	HbA1c	Diabetes mellitus	2%~14%	W.B.	3.8%~5.8%	3 min	CFDA NGSP
CG 1018	CK-MB	Myocardial injury	2.5~80.0 ng/ml	S/P/W.B.	5 ng/ml	15 min	CFDA
CG 1024	TSH	Thyroid diseases	0.1-50.00 μIU/ml	S/P	0.27-4.2 μIU/ml	15 min	CFDA

**GP** Getein Biotech, Inc.

Add: No.9 Bofu Road, Luhe District, Nanjing, 211505, China  
Tel: +86-25-68568594; 68568508; 68568528  
Fax: +86-25-68568500  
E-mail: sales@getein.com.cn; tech@getein.com.cn  
Http: //www.bio-GP.com.cn



**GP** Getein  
Biotech, Inc.



IVD Industry  
POCT Leading Brand

# FIA8000

Quantitative Immunoassay Analyzer

PREMIUM POINT-OF-CARE SOLUTION



Getein Biotech, Inc.

WPT3-8000-02



- ▶ **Portable Design**  
Small in size (250×250×120 mm);  
Light in weight (1.8 kg)
- ▶ **Easy to Use**  
Ready-to-use cassette, One-step test,  
automatic print, quantitative result
- ▶ **Multiple Test Items**  
Cardiac; Inflammation monitoring;  
Diabetes mellitus; Renal Function ect.
- ▶ **Reliable Performance**  
CV≤1%; r≥0.990
- ▶ **LIS and HIS Connectivity**

## Test Items

Cardiac	cTnI	NT-proBNP	CK-MB	CK-MB/cTnI	NT-proBNP/cTnI
	CK-MB/cTnI/Myo		H-FABP	CK-MB/cTnI/H-FABP	
Venous Thromboembolism	D-Dimer				
Inflammation Monitoring	hs-CRP+CRP	PCT			
Diabetes Care	HbA1c				
Renal Function	mAlb	β <sub>2</sub> -MG	CysC	NGAL	
Fertility	HCG+β				
Hormone	TSH				

\*Under developing

## Application Departments

The analyzer can be widely applied to many clinical departments as follows:

- Cardiology Dept.
- Clinical Laboratory.
- Emergency Dept.
- ICU
- Oncology Dept.
- Nephrology Dept.
- Pediatrics Dept.
- Endocrinology Dept.
- Gynecology Dept.
- Respiratory Dept.
- Gastroenterology Dept.
- Urology Dept.

## Flexible Operation Modes

Inside mode (Automatic Timing)

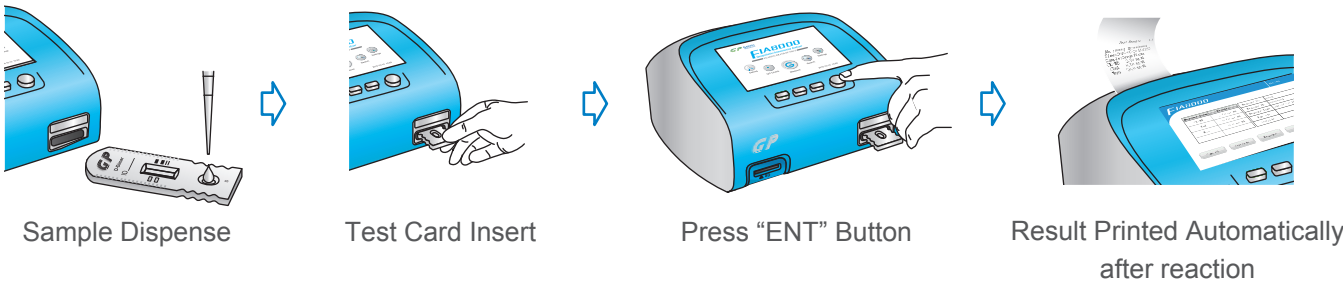

Outside mode (Manual Timing)

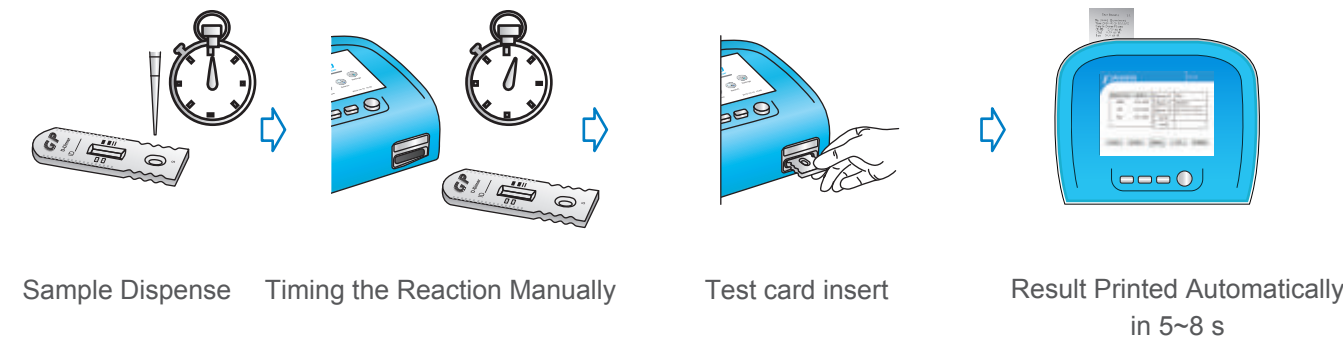

## Technical Data

Assay Method	Lateral Flow Chromatography (Colloidal Gold)
Test Result	Quantitative
Language	English/Chinese/German/Spanish/Serbian (French, Russian, Arabic, Vietnamese etc. are under developing)
Display	5.6 Inch Touch Screen; Resolution 640×480
Printer	Internal Thermal Printer
Working Environment	Temperature: +15 °C ~35 °C Relative humidity: 10%~85% Air pressure: 70.0 kPa~106.0 kPa
Power Supply	AC100 V~AC240 V, 50 Hz~60 Hz
Storage Capacity	10,000 results can be saved
Dimensions	250 mm×250 mm×120 mm (D×W×H)
Weight	1.8 kg

## HbA1c

The golden standard in the evaluation of Glycemic control

NGSP Certified

One Step Test for HbA1c

### Clinical Applications

- Early screening and diagnosis of diabetes
- Evaluation of Glycemic control
- Prediction of chronic diabetic complications
- Identification of stress hyperglycemia and diabetes
- Diagnosis and treatment of GDM, etc.

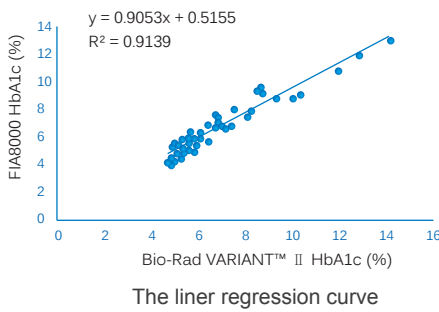

## cTnI

The golden standard in the diagnosis of Acute Myocardial Infarction (AMI)

One Step Test for cTnI

### Clinical Applications

- As an aid in the early diagnosis of acute myocardial infarction (AMI)
- Acute myocarditis, unstable angina, acute coronary syndrome(ACS)
- Evaluate the severity of myocardial damage
- As an aid in the prognosis of ACS

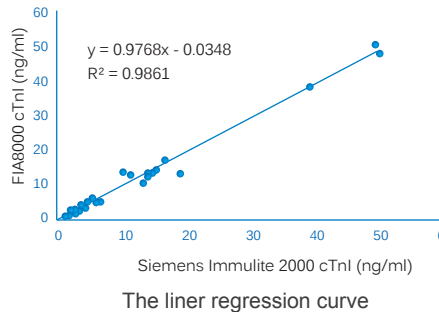

## CK-MB/cTnI/Myo

Combining the advantages of three biomarkers, higher sensitivity and specificity, lower rate of missed diagnosis and misdiagnosis

One Step Test for CK-MB/cTnI/Myo

### Clinical Applications

- Identification and diagnosis of ACS patients suspected
- Evaluating the efficacy of Myocardial-Reperfusion
- Aid in the detection and assessment of AMI to the chest pain
- Monitoring the clinical curative effect of therapeutic drug

### Product Advantages

- Combined advantages of three biomarkers with higher sensitivity and specificity
- Three biomarkers in one cartridge simplified test operation
- As an aid in clinic to lower the rate of missed diagnosis and misdiagnosis to guarantee early diagnosis and prevention

