

Fatada 1-3
/ oglindit /

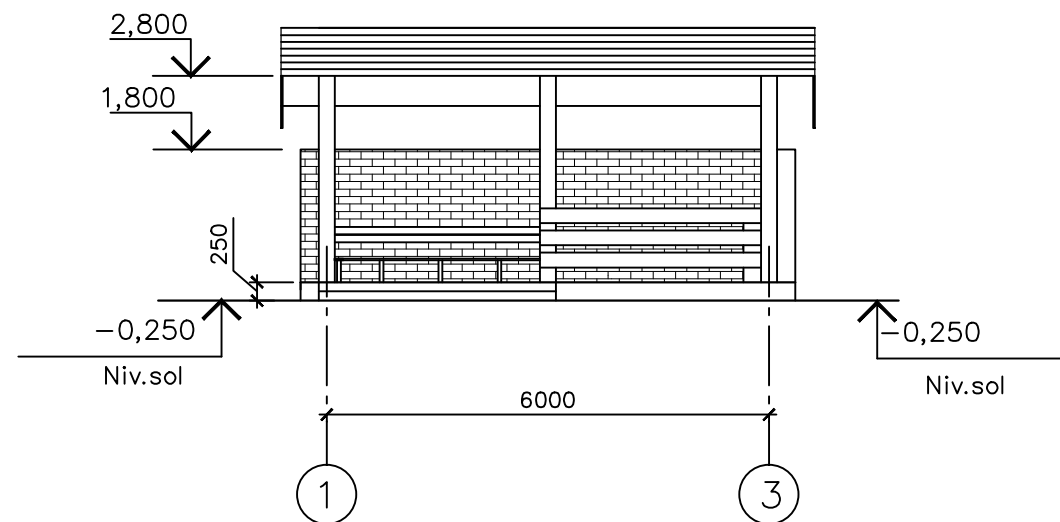

1

3 S=poz.2 -1,70 m²

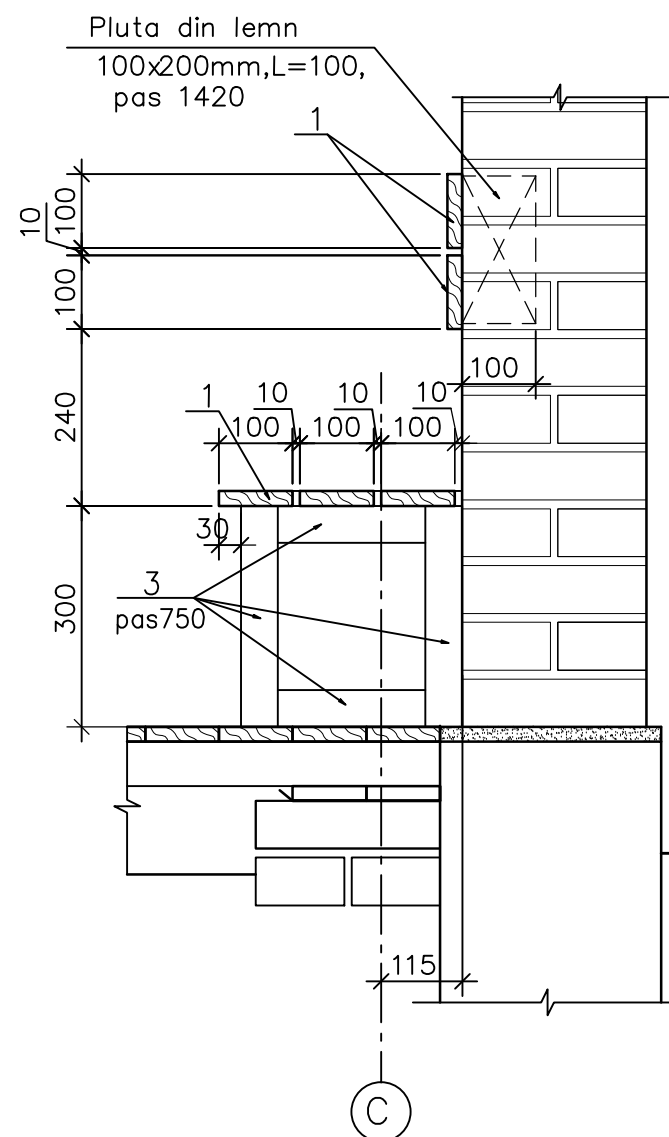

Placa de ceramica (striat)	
pe compositie adeziva	- 5mm
Trepte de beton clasa B12,5	
Pat de beton clasa B12,5 ,armat Ø4Br I	
pas 150x150mm	- 80mm
Strat de petris batatorit	- 40mm
Sol tasat	

Fatada C-A

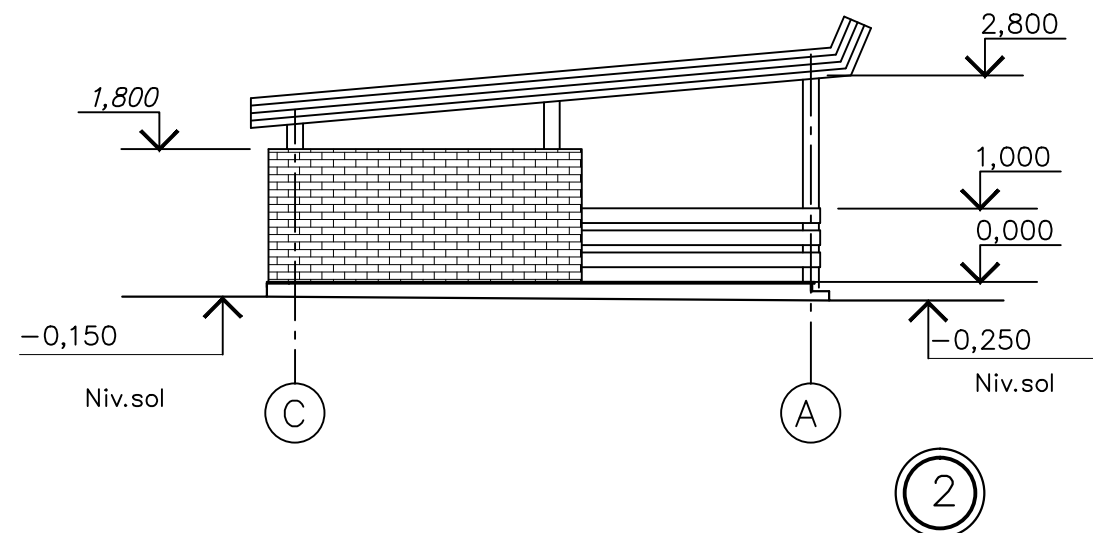

2

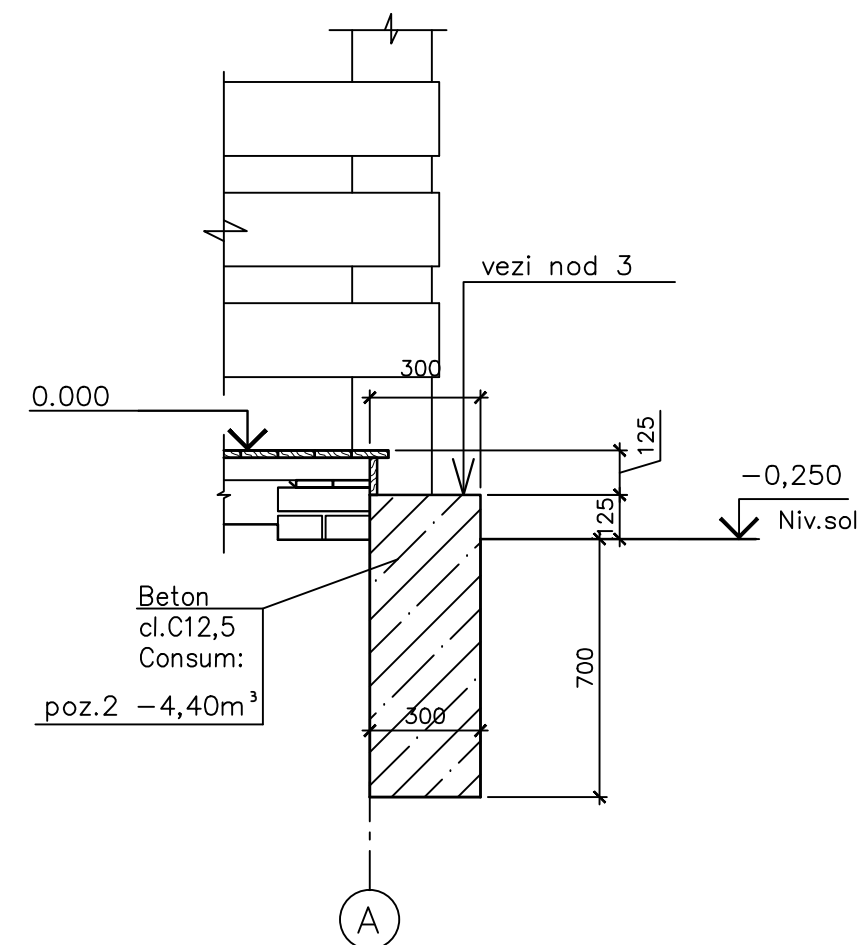

						0610/2021			
						Pavilion pentru copii la gradinite subordonate DETS sectorului Buiucani mun.Chisinau			
Sch.	Cant.	Foaia	N doc.	Semn.	Data	Sopron parasolar-tip-1	Etapă	Foaia	Foi
AŞP		Sava I.			10.21		S.P.	3	
Sp.princ.		Svet I			"	Fatada 1-3 si C-A. Nod 1 si 2.		SRL"PROI-DEVI" mun.Chisinau	