

## RESILIENT SEATED GATE VALVE

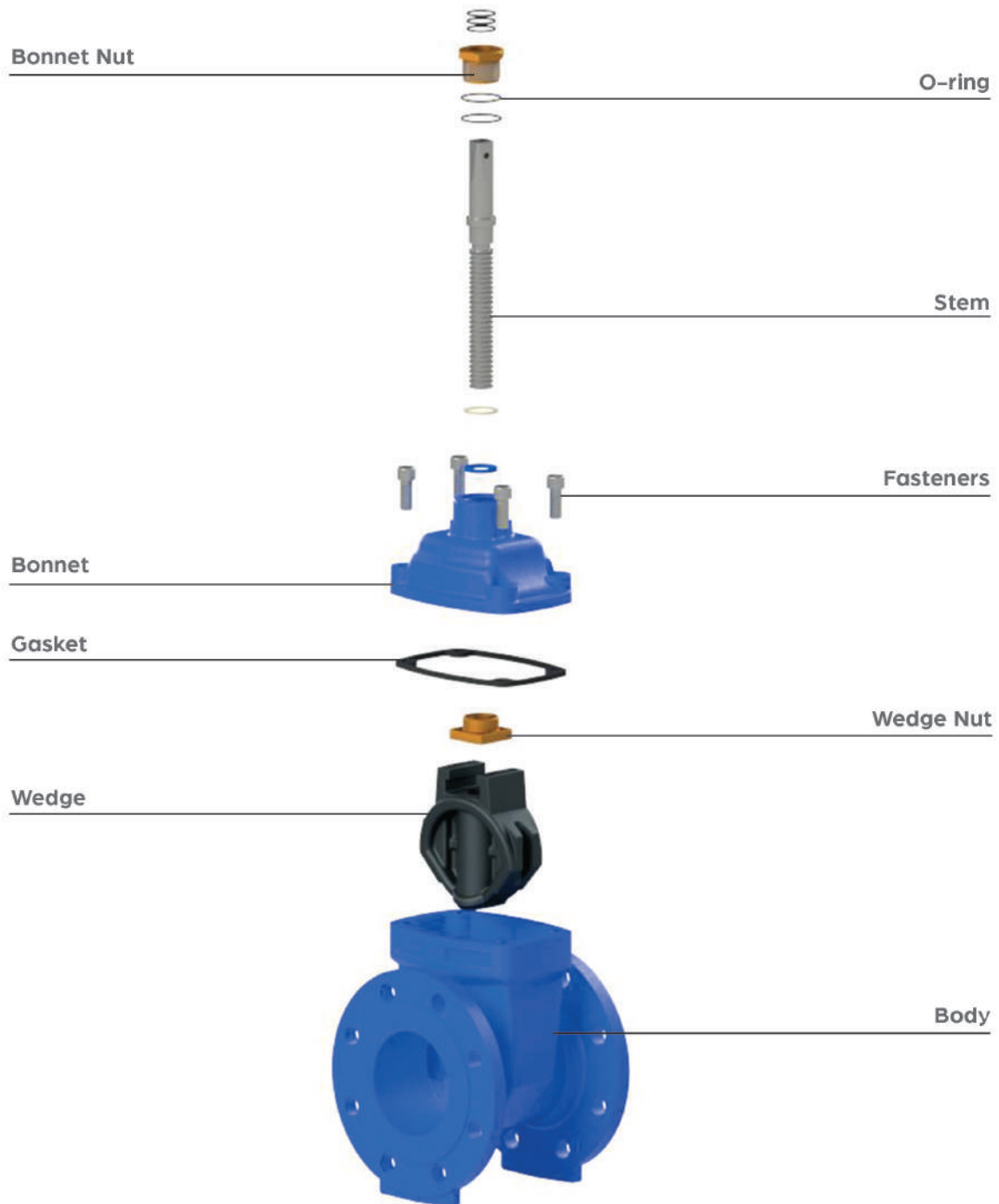

## EN 558-1 SERIES 14 (DIN 3202 – F4) RESILIENT SEATED



### Available Pressures

PN 10  
PN 16

### Paint:

DN40-800 -- Electrostatic Fusion Bonded Powder Epoxy Blue

*min 250 microns (higher thickness available upon request)*

Parts	Main Materials	Optional Materials
<b>Body</b>	Ductile Iron	Nickel Aluminium Bronze
<b>Bonnet</b>		
<b>Wedge</b>	Ductile Iron + EPDM	Ductile Iron + NBR
<b>Stem</b>	X20Cr13	SS 304, SS 316, Duplex, NAB
<b>Bonnet &amp; Wedge Nuts</b>	Copper Alloy	SS 304, SS 316, NAB
<b>Seals</b>	EPDM	NBR
<b>Fasteners</b>	8:8 (Galv.)	SS 304, SS 316, SS 316L
<b>Handwheel</b>	Ductile Iron	
<b>NOTES</b>	<p>Different Flange Drillings are available such as ISO, EN, ANSI etc.</p> <p>Standard Operating Temperature is -10°C to +80°C.</p> <p>All RAL Colors are available.</p> <p>Potable Water Certified Coating is available.</p> <p>Thermoset and Thermoplastic Coatings are available.</p> <p>DVD welcomes you for any other options and designs.</p> <p>All DVD products are MADE IN TURKEY.</p>	

#### APPLICATION

DVD Gate Valves are used for isolation purposes and provide drip tight sealing once they are closed. When open, they provide undisturbed water flow. DVD Gate Valves are not suitable for regulation purposes.

#### FEATURES

- Rolled stem design provides low operating torque values.
- Gearbox and Actuator accessories are available upon request.
- Suitable for above or underground installations with handwheel, chainwheel, fixed and telescopic extension spindle and surface box accessories.
- Optional wedge guide is available upon request for specific sizes.

#### A GOOD HARMONY OF THE STEM & WEDGE

DVD Gate Valve Stem is manufactured from single piece stainless steel material. Furthermore, it is roll threaded. Roll threading allows smooth stem threads, thereby providing low torque operation and less wear. The wedge is fully vulcanized with EPDM, and vulcanization is inspected for Compression Set according to EN 681-1 and Bonding Testing. In order to provide lower torque values, the wedge is available with wedge guides upon request. Wedge nut provides the connection of the stem to the wedge, enabling these two crucial items to work in harmony.

#### ROBUST POWDER COATING

In DVD Valves, both thermoset and thermoplastic coating is available. Not just that, also optional UV protection coating is available upon request. DVD can do coating up to C5-I High (H, more than 15 years) according to EN ISO 12944-1. Coating quality is assured by the coating laboratory, providing sophisticated testing such as Dew Point Measurement, Blast Surface Roughness Measurement, Blast Surface Particle Measurement, Coat Thickness Measurement, Holiday Testing, Impact Testing, Doly Testing, Cross-Cut Testing, Salt Spay Testing and more.

#### QUALITY ASSURANCE

DVD Resilient Seated Gate Valves are WRAS approved for potable water applications. Furthermore, certificate of conformity to EN 1171 is available. DVD in-house hydraulic laboratory can do all the tests mentioned in EN 1074-2 such as cycle testing, bending testing, torque testing. Customer demonstration is also possible upon request.

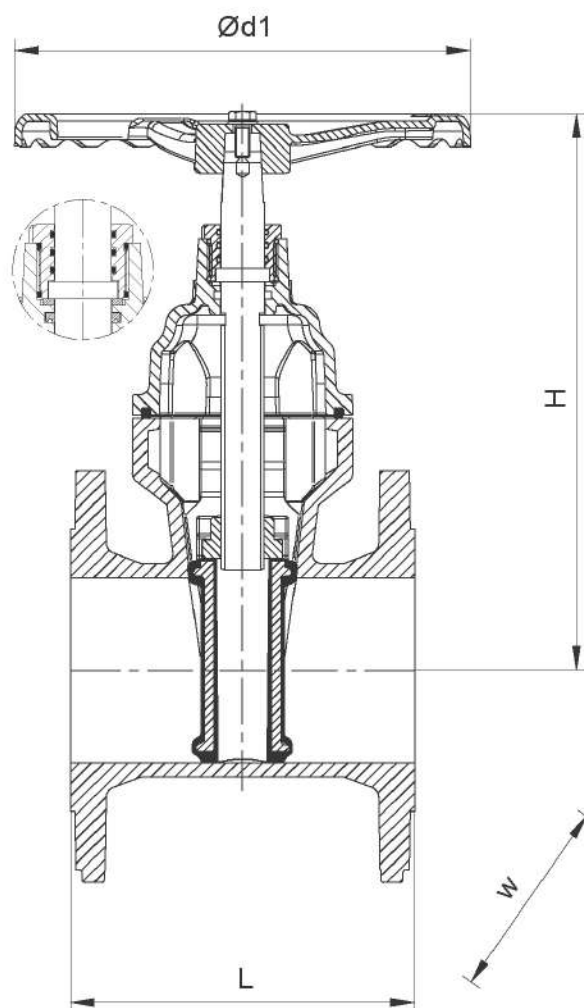

DVD Gate Valves have a revolving, non-rising, rolled, mono-block stem which is transmitting the handwheel rotation to the wedge. Stem revolves inside the bonnet nut and is connected to the wedge by means of the wedge nut. Bonnet nut is threaded to the bonnet and holds the stem firm against axial movement. Wedge is guided in the body in a precast groove and provides undisturbed water flow when the valve is fully open. The wedge is fully vulcanized by rubber to have drip tight sealing when the valve is closed.

DN	DIMENSIONS (mm)																
	50	65	80	100	150	200	250	300	350	400	450	500	600	700	800	900	1000
d1	200	200	200	315	315	400	500	500	500	500	500	650	650	650	650	800	900
H	213	260	265	305	395	500	594	677	810	900	985	1065	1265	1330	1480	1838	2079
W	165	185	200	220	285	340	405	360	520	580	640	715	840	910	1025	1201	1555
L	150	170	180	190	210	230	250	270	290	310	330	350	390	430	470	510	550
Weight (Kg)	10	11	16	21	35	50	90	108	171	205	600	620	650	1038	1388	-	-