

THE NETHERLANDS  
(N E D E R L A N D)

## COMMUNICATION

Concerning<sup>(1)</sup>:

- ~~approval granted~~
- approval extended
- ~~approval refused~~
- ~~approval withdrawn~~
- ~~production definitely discontinued~~

of a type of tyre for motor vehicles pursuant to Regulation number 54.

**Approval number: E4-54R-0038016 Ext.06**

1. Manufacturer's name and address : Shandong Huasheng Rubber Co., Ltd.  
Daozhuang Industry Zone, Guangrao County,  
Dongying City, Shandong Province 257336,  
China (PRC)
2. Tyre type designation<sup>(2)</sup>
  - 2.1. Brand name(s)/trademark(s) : HUASHENG or JINXIN or TAITONG or  
HONGTU or KAPSEN or SUNTRAC or  
NEXUS or XCEED or ORNET or COTSA or  
NAMA or ALPINA or TANZA or SPRUT or  
DOUBLE ROAD or DONLLUP or ~~HAMILTON~~ or  
HUMSUNG or SAYAN or COUGAR TYRES or  
RADAR or TOYOMOTO or TEXXAN or  
TERRAKING or JINJI or SATOYA or  
DAILYWAY or ADDO INDIA or  
GREENTOUR or NORMAKS or KETER or  
AIMONE or BUNGRAH TIRES or IPLAS or  
A-ONE or STUD or SUPERIA or ZEETEX or  
TOLEDO or CARGOFORCE or FIRELION or  
TIREBOT or AENEAS or FULUTONG or  
FURUITONG or HABLEAD or ROADBOSS  
or TYSONKING or UNITED or DOLLUP or  
MESHILINE or TORYO or TOURTRACK or  
ROOGOO or LAZZA or SUPERHAHARI or  
ALTAIRE or GRAND or ETERNITY or  
RODEO or PETROMAX

- 2.2. Trade description (s)/Commercial name(s) : HS106 or ST908 or NXS02 or XD619XLECO or OR619XLECO or KT106 or KR186 or NA07 or CA07 or RM106 or LX-A88 or T031 or JS106 or AF33 or AVHS111 or OD919 or ZH809 or TT611 or ST520 or RSS701 or TS506 or AVHS333 or KA300 or DR816 or H164 or HMT99 or SA895 or CGR999 or RAS1 or TRANS216 or SN558 or EGS868 or TX113 or ST-084 or TV906 or DL516 or ROAD GRIP 404 or T64 or NT106 or RAS+ or HS209 or DL518 or DR827 or T75 or RAS1+ or KTMA1 or HS166 or NT022 or ST-082 or RAS166 or KTMA2 or ST-082-II or KTMT1 or KTMT2 or KTMT3 or AIM216 or AIM219 or LLF055 or IP800 or IP700 or A648 or TEC333 or SU100 or ZOH11 vfm or ZOH12 vfm or DR305 or DR310 or FS06 or CTC381 or CAC881 or CAC882 or OR619 or XD620 or TRANS215 or TRANS227 or UT556 or RG106 or KTHD9 or LZ505 or M516 or AT301 or AT302 or AT303 or TEC450 or TEC340 or GD106 or EXA890\* or RT203 or RT208 or RT209 or PT518 or TKT09 or TKT29 or TKT19
3. If applicable, name and address of the manufacturer's representative : Not applicable
4. Summarized description:
- 4.1. Size of tyre : 385/65R22.5
- 4.2. Category of use : normal/snow/special<sup>(1)</sup>
- 4.3. Structure : ~~diagonal (bias ply)~~/radial<sup>(1)</sup>
- 4.4. Tyre class : ~~E2~~/C3<sup>(1)</sup>
- 4.5. Speed category symbol
- 4.5.1. nominal : K
- 4.5.2. additional (if applicable) : Not applicable
- 4.6. Load-capacity indices:
- 4.6.1. Corresponding to nominal speed:  
 – single : 160  
 – twinned (dual) : ---
- 4.6.2. Corresponding to additional speed:  
 – single : ---  
 – twinned (dual) : ---



**Approval number: E4-54R-0038016 Ext.06**

5. Technical service and, where applicable, test laboratory approved for purposes of approval or of verification of conformity : TÜV SÜD Auto Service GmbH  
Westendstraße 199  
D-80686 München
6. Date of report issued by that service : 2018-10-10;  
2020-10-22
7. Number of report issued by that service : 86-R54-3495/18-00;  
20-01840-CX-SHA-00
8. Reason(s) for extension (if applicable) : Additional of trade mark and tread pattern;  
Change of technical service  
Upgrade UN-Reg. 54-00 to Suppl. 23
9. Any remarks : ---
10. Place : Zoetermeer
11. Date : 02 November 2020
12. Signature :

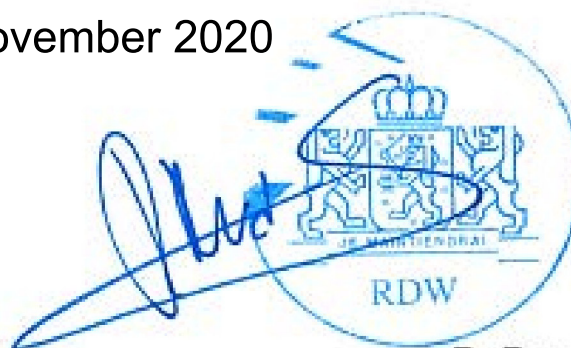

**R. R. van der Spek**

13. Annexed to this communication is a list of documents in the approval file deposited at the administrative service having delivered the approval and which can be obtained upon request.
- Application form relating to ECE approval for a pneumatic tyre pursuant to Regulation number 54.
  - The drawing of the tyre's sidewalls, tread and dimensioned cross-section.
  - The test report as mentioned in item 7.

---

<sup>(1)</sup> Strike out what does not apply.

<sup>(2)</sup> A list of brand name(s)/trademark(s) or Trade description(s)/ Commercial name(s) may be annexed to this communication.

**APPLICATION FOR APPROVAL OF A TYPE OF PNEUMATIC TYRE ACCORDING TO ECE REGULATION No. 54, 00 SERIES OF AMENDMENTS**

---

- |        |  |   |  |
|--------|--|---|--|
| 1.     | Manufacturer's name or trade mark <sup>(2)</sup>                 | : | HUASHENG;JINXIN;TAITONG;HONGTU;KAPSEN;SUNTRAC;NEXUS;XCEED;ORNET;COTSA;NAMA;ALPINA;TANZA;SPRUT;DOUBLE ROAD;DONLLUP; <u>HAMILTON</u> ;HUMSUNG;SAYAN;COUGAR TYRES;RADAR;TOYOMOTO;TEXXAN;TERRAKING;JINJI;SATOYA;DAILYWAY;ADDO INDIA;GREENTOUR;NORMAKS;KETER;AIMONE;BUNGRAH TIRES;IPLAS;A-ONE;STUD;SUPERIA;ZEETEX;TOLEDO;CARGOFORCE;FIRELION;TIREBOT;AENEAS;FULUTONG;FURUITONG;HABILEAD;ROADBOSS;TYSONKING;UNITED;DOLLUP;MESHILINE;TORYO;TOURTRACK;ROOGOO;LAZZA;SUPERHAHARI;ALTAIRE;GRAND;ETERNITY;RODEO; <u>PE TROMAX</u>  |
| 2.     | Tyre type designation by the manufacturer <sup>(2)</sup>         | : | HS106;ST908;NXS02;XD619XLECO;OR619XLECO;KT106;KR186;NA07;CA07;RM106;LX-A88;T031;JS106;AF33;AVHS111;OD919;ZH809;TT611;ST520;RSS701;TS506;AVHS333;KA300;DR816;H164;HMT99;SA895;CGR999;RAS1;TRANS216;SN558;EGS868;TX113;ST-084;TV906;DL516;ROAD GRIP 404;T64;NT106;RAS+;HS209;DL518;DR827;T75;RAS1+;KTMA1;HS166;NT022;ST-082;RAS166;KTMA2;ST-082-II;KTMT1;KTMT2;KTMT3;AIM216;AIM219;LLF055;IP800;IP700;A648;TEC333;SU100;ZOH11 vfm;ZOH12 vfm;DR305;DR310;FS06;CTC381;CAC881;CAC882;OR619;XD620;TRANS215; TRANS227;UT556;RG106;KTHD9;LZ505;M516;AT301;AT302;AT303;TEC450;TEC340;GD106;EXA890*;RT203;RT208;RT209; <u>PT518;TKT09 ;TKT29;TKT19</u> |
| 3.     | Manufacturer's name and address                                  | : | Shandong Huasheng Rubber Co.,Ltd<br>Daozhuang Industry Zone,<br>Guangrao County,Dongying City,<br>Shandong Province257336,<br>P.R. China   |
| 4.     | If applicable, name and address of manufacturer's representative | : | not applicable   |
| 5.     | Summarised description,  |   |  |
| 5.1.   | Tyre size designation  | : | 385/65R22.5  |
| 5.2.   | Category of use  | : | normal/ <del>special</del> /snow   |
| 5.3.   | Structure  | : | <del>diagonal (bias-ply)</del> / radial  |
| 5.4.   | Speed category symbol  |   |  |
| 5.4.1. | Nominal  | : | K  |
| 5.4.2. | Additional (if applicable)                                       | : | not applicable   |
| 5.5.   | Load capacity indices  |   |  |
| 5.5.1. | corresponding to nominal speed                                   | : | single: 160 , twinned (dual): ---  |
| 5.5.1. | corresponding to additional speed                                | : | single: --- , twinned (dual): ---  |
| 6.     | Overall dimensions   | : | calculated/ <del>Annex 5</del>   |
|        | overall section width  | : | 389  |
|        | outer diameter   | : | 1065   |
| 7.     | Factor 'x'   | : | 0.75   |
| 8.     | Ply-rating number for diagonal (bias ply) tyres                  | : | not applicable   |
| 9.     | Rims on which the tyre can be mounted                            | : | 11.75  |
| 10.    | Measuring rim and test rim                                       | : | see attached test report   |
| 11.    | Tyre class   | : | €2 / C3  |

(1) Strike out what does not apply.

(2) Modified points are underlined for extension.

12. State whether the tyre is : tube less / ~~tube type~~
13. Traction tyre : ~~Yes / no~~ (see the tread pattern detail in drawing)
14. State if special use tyre : n.a.
- Professional Off-Road : ~~Yes / no~~
- Tread depth : n.a.
- Void to fill ratio : n.a.
15. Inflation pressure and index for measuring and testing : see attached test report
16. Submitted for approval on (date) : Oct 20, 2020

We herewith declare that we have not applied and will not apply for approval with another Contracting Party of the ECE for the same type of product.

MANUFACTURER'S STAMP

Signature : 

Name: LIUJIANQUN



THIS APPLICATION IS ACCOMPANIED BY:

- A drawing of the tyre's side wall, tread and dimensioned cross section.
- The test report.

(1) Strike out what does not apply.  
(2) Modified points are underlined for extension.

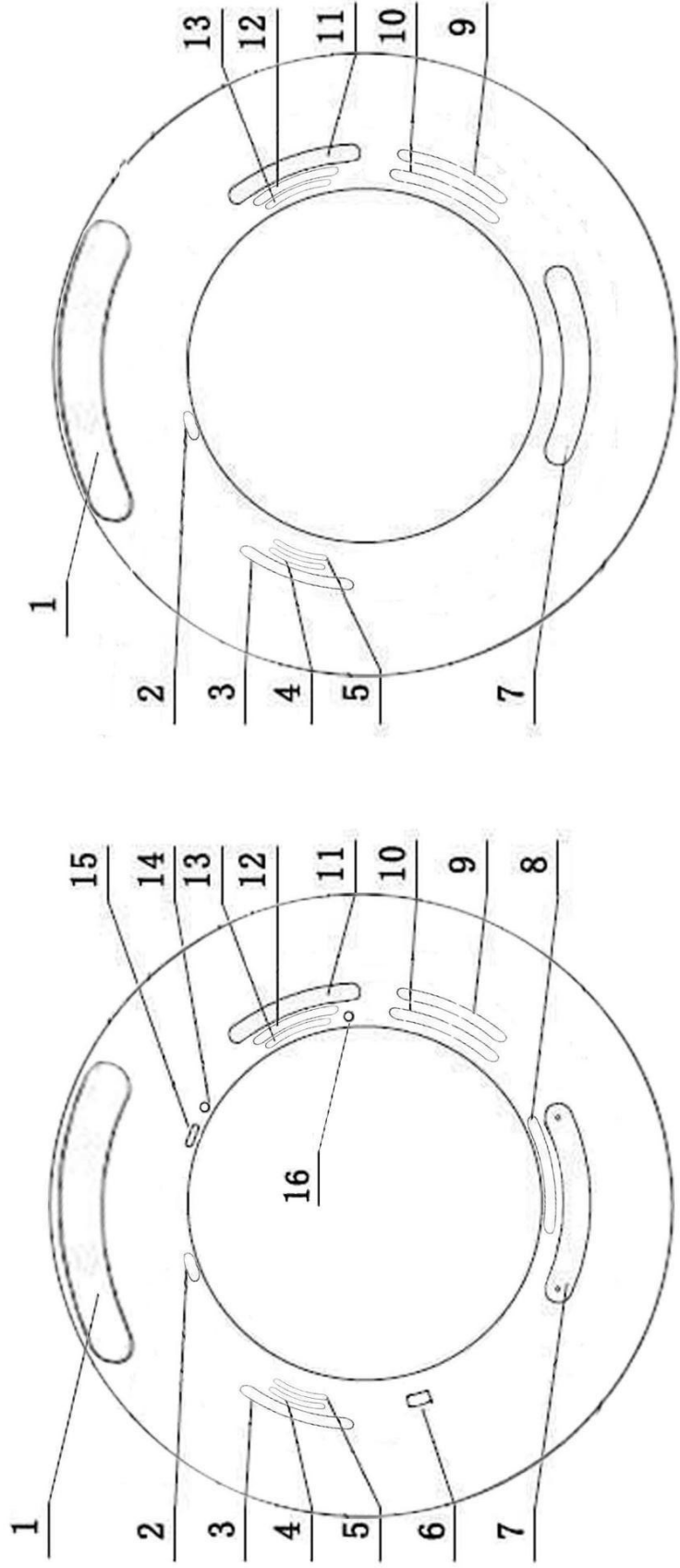
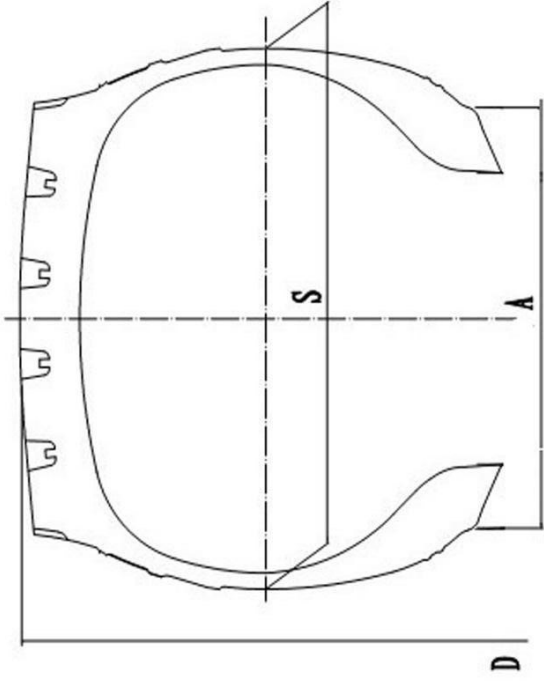



**TREAD PATTERN  
REFER TO ATTACHMENT No.1**

16	900KPa						
15	DATE CODE XXXX						
14	E4 XXXXXX						
13	STANDARD RIM 11.75						
12	REGROOVABLE						
11	385/65R22.5						
10	MAX LOAD SINGLE 9920 LBS(4500 KG) DUAL LBS( KG) AT 130 PSI(900KPa) COLD LOAD RANGE M						
9	160 K 20PR						
8	SAFETY WARNING						
7	TREAD PATTERN REFER TO ATTACHMENT No.1						
6	CCC						
5	TREAD 5 STEEL PLYS SIDEWALL 1 STEEL PLY						
4	TUBELESS						
3	RADIAL ALL STEEL						
2	MADE IN CHINA						
1	TRADEMARK REFER TO ATTACHMENT No.1						
	385/65R22.5	160 K	1072	389	298	15.5	
	TIRE SIZE	LOAD INDEX	TUBELESS	D (mm)	S (mm)	A (mm)	SKID DEPTH (mm)
			TYPE				
Wang Haizhen			APPROVED BY	Liu Zhiping			SHANDONG HUASHENG RUBBER CO., LTD
Zhang Yuanguang			CHECKED BY				

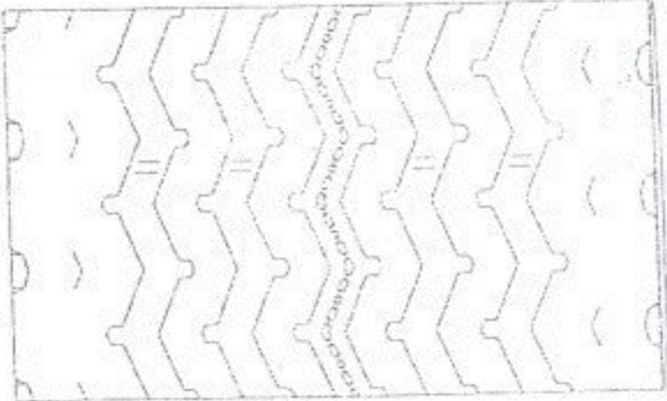

# ATTACHMENT NO.1

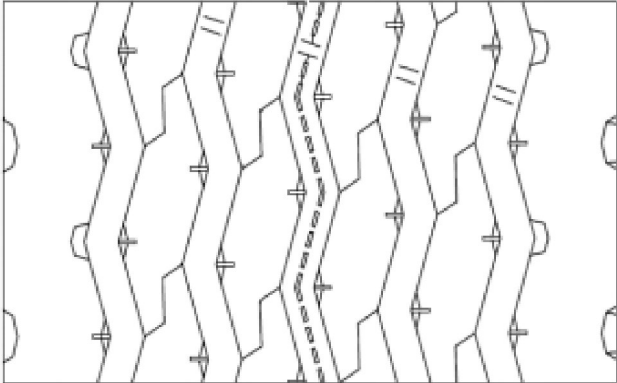
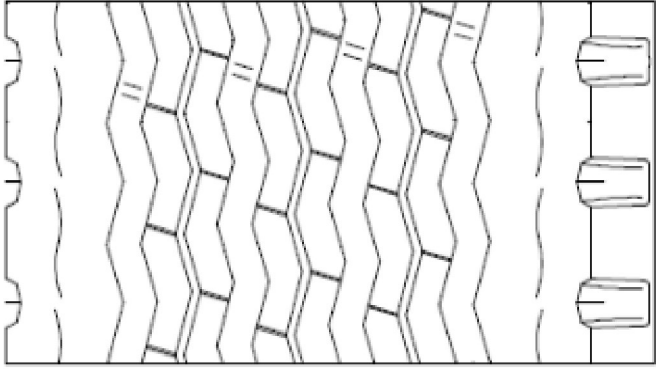
TREAD PATTERN	TYRE SIZE: 385-65R22.5 160K	APPROVAL NO. : E4-54R-0038016
	TRADE MARK	TREAD PATTERN NAME
	<p>HUASHENG; JINXIN; TAITONG; HONGTU; KAPSEN;            SUNTRAC; NEXUS; XCEED; ORNET; COTSA; NAMA;            ALPINA; TANZA; SPRUT; DOUBLE ROAD; DONLLUP;  <b>HAMILTON</b>; HUMSUNG; SAYAN; COUGAR TYRES;            HANBAK; TOYOMOTO; TEXXAN; TERRAKING; JINJI;            SATOYA; DAILYWAY; ADDO INDIA; GREENTOUR;            NORMAKS; KETER; AIMONE; BUNGRAH TIRES; IPLAS;            A-ONE; STUD; SUPERIA; ZEETEX; TOLEDO; CARGOFORCE;            FIRELION; TIREBOT; AENEAS; FULUTONG; FURUITONG;            HABLEAD; ROADBOSS; TYSONKING; UNITED; DOLLUP;            MESHILINE; TORYO; TOURTRACK; ROOGOO; LAZZA;            SUPER            HAHARI; ALTAIRE; GRAND; ETERNITY; RODEO; PETROMAX</p> 	<p>HS106; ST908; NXS02; XD619XLECO; OR619XLECO;            KT106; KR186; NA07; CA07; RM106; LX-A88;            T031; JS106; AF33; AVHS111; OD919; ZH809; TT611;            ST520; RSS701; TS506; AVHS333; KA300; DR816; H164;            HMT99; SA895; CGR999; RAS1; TRANS216; SN558;            EGS868; TX113; ST-084; TV906; DL516;            ROAD GRIP 404; T64; NT106; RAS+; AIM216; LLF055;            IP700; A648; TEC333; SU100; DR305; FS06; CTC381;            OR619; XD620; KTMT3; UT556; RG106; KTHD9; LZ505; M            516; AT301; GD106; EXA890*; RT203; PT518; TKT09</p>
		<p>HS209; DL518; DR827; T75; RAS1+; KTMA1; KTMT1;            ZOH12 vfm; CAC882; TRANS227; AT303; TEC340;            RT209; TKT19</p>
		<p>HS166; NT022; ST-082; RAS166; KTMA2; ST-082-II;            KTMT2; AIM219; IP800; ZOH11 vfm; DR310; CAC881;            TRANS215; TRANS227; UT556; RG106; KTHD9;            LZ505; M516; AT301; AT302; AT303;            TEC450; RT208; TKT29</p>