

High-Flow Nephroscope

OES Pro

(cont.)

Hand Instruments, Handle With Finger Rest

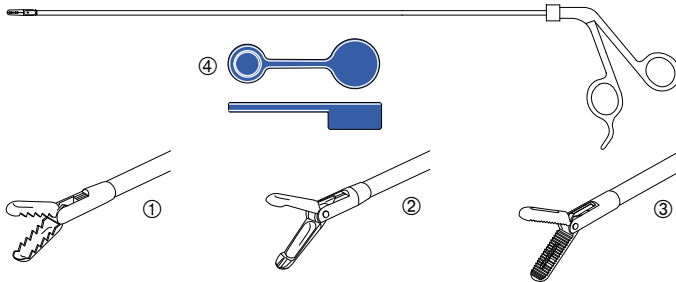

- | | | |
|---|-----------------|--|
| ① | WA63810A | Grasping forceps, toothed, 3.25 x 400 mm, with lumen |
| ② | WA63813A | Grasping forceps, 3.25 x 400 mm, with lumen |
| ③ | WA63815A | Grasping forceps, 3.25 x 400 mm, fine-toothed |
| ④ | A0400 | Sealing cap, blue, for Luer-lock, 6 pcs.
▪ Reusable |

Hand Instruments, U-Shaped Handle

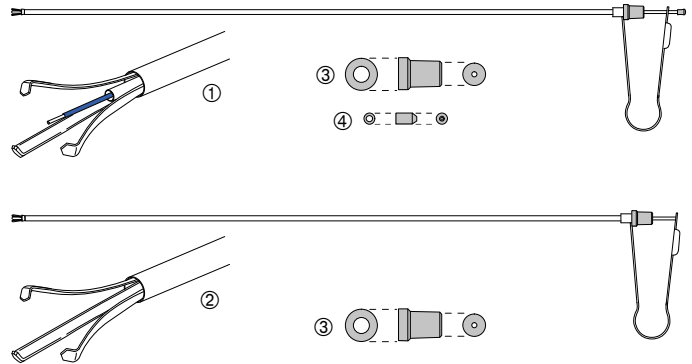

- | | | |
|---|-----------------|---|
| ① | WA63817A | Grasping forceps, three-nail, 3.5 x 400 mm, with channel 1.1 mm |
| ② | WA63819A | Grasping forceps, three-nail, 3.25 x 400 mm |
| ③ | WA63821A | Sealing cap, 0.7 mm, 20 pcs., for WA63817A
▪ Reusable/non-sterile |
| ④ | A0223 | Sealing cap, 1.6 mm, 10 pcs., for WA63817A/-19A
▪ Reusable/non-sterile |