



March 18th, 2025

Declaration Letter

To Whom It May Concern:

We, ACON Laboratories, Inc., with a registered office at 5850 Oberlin Drive #340, San Diego, CA 92121, authorize SRL Sanmedico, with a registered office at A. Corobceanu Street 7A, Apt. 9, Chişinău, MD-2012, Moldova, to register, notify, renew, or modify the registration of medical devices in the territory of the Republic of Moldova.

Sincerely,

A handwritten signature in black ink, appearing to read "Qiyi Xie", is written over a horizontal line.

Qiyi Xie
V.P. of Regulatory Affairs & Clinical Affairs
ACON Laboratories, Inc.





Certificate

No. Q5 104507 0001 Rev. 03

Holder of Certificate: **ACON Laboratories, Inc.**
5850 Oberlin Drive, #340
San Diego CA 92121
USA

Certification Mark:



Scope of Certificate: **Design and Development, Manufacture and distribution of In Vitro Diagnostic Test Kits and Reagents for the Determination of Infectious Diseases, Clinical Chemistry, Drugs of Abuse, Tumor/Cardiac Marker, Fertility/Pregnancy and Blood Glucose Monitoring System, Lancing Devices and Lancets**

The Certification Body of TÜV SÜD Product Service GmbH certifies that the company mentioned above has established and is maintaining a quality management system, which meets the requirements of the listed standard(s). All applicable requirements of the testing and certification regulation of TÜV SÜD Group have to be complied with. For details and certificate validity see: www.tuvsud.com/ps-cert?q=cert:Q5 104507 0001 Rev. 03

Report No.: SH22743A01

Valid from: 2022-09-15
Valid until: 2025-09-06

Date, 2022-09-15

Christoph Dicks
Head of Certification/Notified Body

Certificate

No. Q5 104507 0001 Rev. 03

Applied Standard(s):

EN ISO 13485:2016
Medical devices - Quality management systems -
Requirements for regulatory purposes
(ISO 13485:2016)
DIN EN ISO 13485:2016

Facility(ies):

ACON Laboratories, Inc.
5850 Oberlin Drive, #340, San Diego CA 92121, USA

Address holder for registration only

ACON Laboratories, Inc.
10125 Mesa Rim Road, San Diego CA 92121, USA

Manufacture and distribution of
In Vitro Diagnostic Test Kits and Reagents for the Determination of
Infectious Diseases, Clinical Chemistry, Drugs of Abuse,
Tumor/Cardiac Marker, Fertility/Pregnancy and Blood Glucose
Monitoring System, Lancing Devices and Lancets

ACON Laboratories, Inc.
6865 Flanders Dr., Suite B, San Diego CA 92121, USA

Storage of
In Vitro Diagnostic Test Kits and Reagents for the Determination of
Infectious Diseases, Clinical Chemistry, Drugs of Abuse,
Tumor/Cardiac Marker, Fertility/Pregnancy and Blood Glucose
Monitoring System, Lancing Devices and Lancets

AZURE Institute, Inc.
10125 Mesa Rim Road, San Diego CA 92121, USA

Design and Development of
In Vitro Diagnostic Test Kits and Reagents for the Determination of
Infectious Diseases, Clinical Chemistry, Drugs of Abuse,
Tumor/Cardiac Marker, Fertility/Pregnancy and Blood Glucose
Monitoring System, Lancing Devices and Lancets

Acon Laboratories Inc.
Guerrero Negro 9942 Parque Industrial Pacifico IV, 22644
Tijuana B.C. CP, MEXICO

Manufacture of
blood glucose test strips, antigen rapid test and IgG/IgM antibody
rapid test for infectious disease.



Benannt durch/Designated by
Zentralstelle der Länder
für Gesundheitsschutz
bei Arzneimitteln und
Medizinprodukten
www.zlg.de
ZLG-BS-245.10.07



Product Service

EC Certificate

Full Quality Assurance System

Directive 98/79/EC on In Vitro Diagnostic Medical Devices (IVDD), Annex IV excluding (4, 6)
(List A and B and devices for self-testing)

No. V1 104507 0003 Rev. 06

Manufacturer:

ACON Laboratories, Inc.

5850 Oberlin Drive, #340
San Diego CA 92121
USA

**Product Category(ies): Blood glucose measuring systems for self testing
and self-testing devices for clinical chemistry,
hematology and pregnancy and ovulation**

The Certification Body of TÜV SÜD Product Service GmbH declares that the aforementioned manufacturer has implemented a quality assurance system for design, manufacture and final inspection of the respective devices / device families in accordance with IVDD Annex IV. This quality assurance system conforms to the requirements of this Directive and is subject to periodical surveillance. For marketing of List A devices an additional Annex IV (4) certificate is mandatory. All applicable requirements of the testing and certification regulation of TÜV SÜD Group have to be complied with. For details and certificate validity see: [www.tuvsud.com/ps-cert?q=cert:V1 104507 0003 Rev. 06](http://www.tuvsud.com/ps-cert?q=cert:V1_104507_0003_Rev.06)

Report no.:

SH22743EXT01

Valid from:

2022-05-04

Valid until:

2025-05-26

Date,

2022-05-04

Christoph Dicks
Head of Certification/Notified Body



EC Certificate

Full Quality Assurance System

Directive 98/79/EC on In Vitro Diagnostic Medical Devices (IVDD), Annex IV excluding (4, 6)
(List A and B and devices for self-testing)

No. V1 104507 0003 Rev. 06

Model(s):

On Call Plus Blood Glucose Monitoring System,
On Call Plus Blood Glucose Test Strips,
On Call EZ II Blood Glucose Monitoring System,
On Call Advanced Blood Glucose Monitoring System,
On Call Advanced Blood Glucose Test Strips,
On Call Chosen Blood Glucose Test Strips,
On Call Vivid Blood Glucose Monitoring System (OGM-101),
On Call Vivid Blood Glucose Test Strips (OGS-101),
On Call Sharp Blood Glucose Monitoring System (OGM-121),
On Call Sharp Blood Glucose Test Strips (OGS-121)
On Call Plus II Blood Glucose Monitoring System (OGM-171),
On Call Plus II Blood Glucose Test Strips (OGS-171),
On Call Extra Blood Glucose Monitoring System (OGM-191),
On Call Extra Blood Glucose Test Strips (OGS-191),
On Call GK Dual Blood Glucose & Ketone Monitoring System (OGM-161),
On Call Blood Ketone Test Strips (OGS-161),
Urinalysis Reagent Strips (Urine),
UTI Urinary Tract Infection Test Strips,
Cholesterol Monitoring System (CCM-111),
CHOL Total Cholesterol Test Devices (CCS-111),
TRIG Triglycerides Test Devices (CCS-112),
HDL High Density Lipoprotein Test Devices (CCS-113),
3-1 Lipid Panel Test Devices (CCS-114),
Cholesterol CTRL Control Devices,
Cholesterol Monitoring System (CCM-101),
CHOL Total Cholesterol Test Strips (CCS-101),
PT/INR Monitoring System (CCM-151),
PT/INR Test Strips (CCS-151),
Hemoglobin Testing System (CCM-141),
Hemoglobin Test Strips (CCS-141),
hCG Pregnancy Rapid Test Cassette (Urine),
Pregnancy Rapid Test Midstream,
On Call Extra Mobile Blood Glucose Monitoring System (OGM-281),
On Call Sure Blood Glucose Monitoring System (OGM-211),
On Call Sure Sync Blood Glucose Monitoring System (OGM-212),
On Call Sure Blood Glucose Test Strips (OGS-211),
GIMA Blood Glucose Monitoring System,
GIMA Bluetooth Blood Glucose Monitoring System,
GIMA Blood Glucose Test Strips,
On Call GU Dual Blood Glucose & Uric Acid Monitoring



EC Certificate

Full Quality Assurance System

Directive 98/79/EC on In Vitro Diagnostic Medical Devices (IVDD), Annex IV excluding (4, 6)
(List A and B and devices for self-testing)

No. V1 104507 0003 Rev. 06

System (OGM-201),
On Call Blood Uric Acid Test Strips (OGS-201),
LH Ovulation Rapid Test Cassette (Urine),
Ovulation Rapid Test Midstream,
Ovulation & Pregnancy Test Combo Pack,
On Call Extra Voice Blood Glucose Monitoring System
(OGM-291),
Early Detection Pregnancy Test,
Digital Pregnancy Test,
Go-Keto Blood Glucose & Ketone Monitoring System (OGM-
161),
Go-Keto Blood Ketone Test Strips (OGS-161),
Go-Keto Blood Glucose Test Strips,
On Call Extra GM Blood Glucose Monitoring System(OGM-
191),
On Call Extra GM Blood Glucose Test Strips (OGS-191),
On Call Plus GM Blood Glucose Monitoring System,
On Call Plus GM Blood Glucose Test Strips,
Go-Keto Urinalysis Reagent Strips

Facility(ies):

ACON Laboratories, Inc.
5850 Oberlin Drive, #340, San Diego CA 92121, USA

ACON Laboratories, Inc.
10125 Mesa Rim Road, San Diego CA 92121, USA

AZURE Institute, Inc.
10125 Mesa Rim Road, San Diego CA 92121, USA

Acon Laboratories Inc.
Guerrero Negro 9942 Parque Industrial Pacifico IV, 22644 Tijuana
B.C. CP, MEXICO

Declaration of Conformity

ACON Laboratories, Incorporated
5850 Oberlin Drive #340
San Diego, CA 92121, USA

**We, the manufacturer, declare under our sole responsibility that the
in vitro diagnostic device:**

Mission[®] Urinalysis Reagent Strips (U031-XX1)

classified as Others in the directive 98/79/EC,

**meets all the provisions of the directive 98/79/EC on *in vitro* diagnostic
medical devices which apply to it**

**The self-declaration is according to Annex III
(excluding Section 6) of the Directive.**

Authorized Representative:
Medical Device Safety Service GmbH
Schiffgraben 41
30175 Hannover, Germany

Signed this 11 day of February, 2020
in San Diego, CA USA



Qiyi Xie, MD, MPH
Senior Staff, Regulatory Affairs & Clinical Affairs
Acon Laboratories, Inc.





ACON Laboratories, Inc.

10125 Mesa Rim Road. • San Diego, CA 92121 • USA
Tel: (858) 875-8000 • Fax: (858) 875-8099 • E-mail: info@aconlabs.com

November 11th 2016

CERTIFICATION LETTER

This letter is to certify that, Vitalie Goreacii, employed by Sanmedico SRL located at: Republic of Moldova, city Chisinau, str. Petricani 88/1 of. 10, MD-2059, have received all required training and is enabled and authorized to provide services with installation, commissioning, and maintenance to the products listed below:

Mission® U120 Urine Analyzer
Mission® U120 Ultra Urine Analyzer
Mission® U500 Urine Analyzer
Mission® PT/INR Coagulation Monitoring System
Mission® Cholesterol Monitoring System
Mission® Ultra Cholesterol Monitoring System
Mission® HB Hemoglobin Testing System
Mission® Plus HB Hemoglobin Testing System
OnCall® Glucose Meter

For further questions or inquiries regarding this matter, please refer to the contact information below.

Sincerely

A handwritten signature in black ink, appearing to read "Jassy Alvarenga", is written over a red circular stamp.

Jassy Alvarenga
International Account Manager
ACON Laboratories, Inc. S.A.

jalvarenga@aconlabs.com

+1 858 875 8085

Mission® Urinalysis Reagent Strips and Urine Analyzers

Obtain reliable and cost-effective results with *Mission®* Urinalysis Reagent Strips and Urine Analyzers!

- *Accurate*
- *Reliable*
- *Convenient*



Global Diagnostics for Local Markets™

Urinalysis Reagent Strips

Simple and Accurate

- Analytical sensitivity better than or comparable to market leaders
- High quality color chart ensures accurate visual reading

Flexible

- Compatible for visual and analyzer reading
- More than 30 different combinations available

Multiple Packaging Options and Long Shelf Life

- Canister Packaging
 - Available in 25, 50, 100 and 150 strips per kit
 - 2 year shelf life for unopened canisters which offers cost savings and convenience for high volume testing
 - 3 month shelf life for strips in opened canisters
- Pouch Packaging *New!*
 - Single-strip Pouch
 - Individually packaged strips with 1, 3, 6 and 20 strips and 1 color chart per kit for OTC or low volume testing
 - Unique packaging maintains 2 year shelf life for all strips in the kit compared to 3 months for remaining strips in an opened canister
 - Multi-strip Pouch
 - Canister Refill Kits with 25 strips/pouch uniquely packaged to save cost for low volume testing and extended shelf life by using the canister for refills

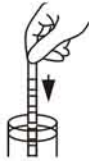

Step 1: Immerse strip into urine



Step 2: Remove excess urine

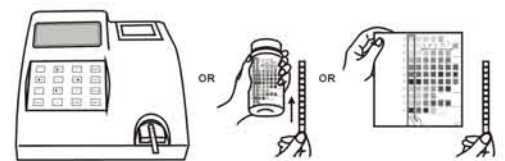

Step 3: Obtain results by analyzer or visual reading

Catalog No.	No. of Parameters	Type of Strip [♦]		Strips per Canister [◊]	Pouch Packaging [▲]	Reading Method			Analyzer-Read Strips: Standard (S) or Additional (A)	Parameters												
		For Visual Reading	For Analyzer Reading (U120/U500)			Visual	U120	U500		ASC	GLU	BIL	KET	SG	BLO	pH	PRO	URO	NIT	LEU	ALB	CRE
U031-131	13	13C	NA	100 [■]	✓	✓	NA	NA	A	*	*	*	*	*	*	*	*	*	*	*	*	*
U031-111	11	11A		100	✓	✓	✓	✓	S	*	*	*	*	*	*	*	*	*	*	*		
U031-101	10	10U		100	✓	✓	✓	✓	S		*	*	*	*	*	*	*	*	*	*		
		10A				✓	✓	✓	A	*	*	*	*	*	*	*	*	*	*			
		10C				✓	✓	✓	S		*	*	*	*	*	*	*	*	*	*	*	
U031-091	9	9U		100	✓	✓	✓	✓	S		*	*	*	*	*	*	*	*	*			
U031-081	8	8U		100	✓	✓	✓	✓	A		*	*	*	*	*	*	*	*	*			
		8N				✓	✓	✓	S		*	*	*	*	*	*	*	*	*			
		8S				✓	✓	✓	A		*	*	*	*	*	*	*	*	*	*		
U031-071	7	7N		100	✓	✓	✓	✓	A		*	*	*	*	*	*	*	*	*			
U031-061	6	6N	6NE	100	✓	✓	✓	✓	A		*	*	*	*	*	*	*	*	*			
		6U	6UE			✓	✓	✓			*	*	*	*	*	*	*	*	*			
U031-051	5	5B	5BE	100	✓	✓	✓		A		*	*	*	*	*	*	*	*	*			
		5N	5NE			✓	✓	✓			*	*	*	*	*	*	*	*	*			
		5S	5SE			✓	✓				*	*	*	*	*	*	*	*	*			
		5U	5UE			✓	✓				*	*	*	*	*	*	*	*	*			
U031-041	4	4S	4SE	100	✓	✓	✓	✓	A		*	*	*	*	*	*	*	*	*			
		4B	4BE			✓	✓				*	*	*	*	*	*	*	*				
		4K	4KE			✓	✓	✓			*	*	*	*	*	*	*	*	*			
		4G	4GE			✓	✓				*	*	*	*	*	*	*	*	*			
		4N	4NE			✓	✓	✓			*	*	*	*	*	*	*	*	*	*		
		4P	4PE			✓	✓	✓			*	*	*	*	*	*	*	*	*	*		
U031-031	3	3P	3PE	100	✓	✓	✓	✓	A		*	*	*	*	*	*	*	*	*			
		3K	3KE			✓	✓	✓			*	*	*	*	*	*	*	*	*			
		3G	3GE			✓	✓	✓			*	*	*	*	*	*	*	*	*			
		3N	3NE			✓	✓	✓			*	*	*	*	*	*	*	*	*			
U031-021	2	2G	2GE	100	✓	✓	✓	✓	A		*	*	*	*	*	*	*	*	*			
		2K	2KE			✓	✓	✓			*	*	*	*	*	*	*	*	*			
		2N	2NE			✓	✓	✓			*	*	*	*	*	*	*	*	*			
		2B	2BE			✓	✓	✓			*	*	*	*	*	*	*	*	*			
		2U	2UE			✓	✓	✓			*	*	*	*	*	*	*	*	*			
		2S	2SE			✓	✓	✓			*	*	*	*	*	*	*	*	*			
		2C	2CE	100 [■]	✓	✓	✓		*	*	*	*	*	*	*	*	*	*	*			
U031-011	1	1B	1BE	100	✓	✓	✓		A		*	*	*	*	*	*	*	*	*			
		1P	1PE			✓	✓	✓			*	*	*	*	*	*	*	*	*			
		1G	1GE			✓	✓	✓			*	*	*	*	*	*	*	*	*			
		1K	1KE			✓	✓	✓			*	*	*	*	*	*	*	*	*			
		1R	1RE			✓	✓	✓			*	*	*	*	*	*	*	*	*	*	*	

♦ Type of Strip:
Visual Strip Size
1-6 Parameters: 5 mm x 80 mm; 7-11 Parameters: 5 mm x 108 mm;
12-13 Parameters: 5 mm x 121 mm
U120/U500 Strip Size
1-11 Parameters: 5 mm x 108 mm;
"E" means extended strip length for 1-6 Parameters

◊ Also available in canisters of 25, 50 and 150 strips

■ Not available in canisters of 150 strips

▲ Single-strip Pouch available in 1, 3, 6 and 20 strip kit

Canister Refill Kit, with 25 strips per pouch or canister, available in 3-pouch and 1- canister kit, or 4-pouch kit

CE Marked for sale in the European Community
Cleared for US 510(k)



U120 Urine Analyzer



Accurate

- Up to 120 tests/hour in Continuous Test Option
- Capable of reading 1 strip at a time in Single Test Option
- Test modes include Routine, STAT and QC
- Automatic calibration for accurate results and easy operation

Reliable

- Can read up to 4 Strip combinations with 8, 9, 10, 11 parameters, additional strips with 1-11 parameters available upon request
- Minimal training required

Convenient Operation

- Saves and recalls the last 2,000 results automatically
- Audible beep signals operator to dip strips in urine
- Can print up to 3 copies per test for convenient reviewing and easy record keeping
- Option to print results on sticker paper for quick and simple record management

Easy Data Management

- Includes RS232C port for easy data transfer to an external computer or LIS
- Optional Barcode Reader to record patient ID

Unique Lockout Functions *new!*

- Strip Lockout
 - Prevents using strips of another brand on the U120 Urine Analyzer
 - Requires barcode reader scan or manual entry of the canister code
- User Lockout
 - Eliminates unapproved users from testing
 - Up to 10 lab operators can perform testing, but only the lab administrator can change analyzer settings
- QC Lockout
 - Prevents testing without passing QC
 - QC tests can be performed once every 8 hours, day, week or month
 - Analyzer will alert when to run QC test
 - If QC tests fail, analyzer will switch to STAT mode and list "E" at the end of each test number

Specifications

Feature	Specifications
Analyzer Type	Manual
Methodology	Reflectance Photometry
Detection	Photosensitive Diode
Throughput	Single Test Option: 60 tests/hour Continuous Test Option: 120 tests/hour
Test Modes	Routine, STAT and QC
Lockout Functions	Strip Lockout: Available Upon Request; User/QC Lockout: Included with option to turn ON/OFF
Memory	Last 2,000 results
Strip Incubation Time	1 Minute
Wavelength of Monochromatic LED	525 nm and 635 nm
Standard Strips	8, 9, 10, 11 Parameters (5 mm x 108 mm)
Additional Strips Available	1-11 Parameters (5 mm x 108 mm); see URS Parameters
Total Combinations Per Analyzer	4 Combinations
Analyzer Ports	Standard RS232C Port for Barcode Reader or Data Transfer USB Port for Data Transfer 25 Pin Parallel Port for External Printer
Capabilities	Internal Thermal Printer (included) RS232C Barcode Reader (optional) Optional External Printer (not included) USB or RS232C Data Transfer Cable (optional)
Major Readable Barcodes	Code 128, Code 39, Codabar (NW-7), Interleaved 25, UPC-A, UPC-E, EAN 8, EAN 13
Calibration	Automatic
Available Languages on the Screen	English and additional language(s)
Operating Conditions	0-40°C (32-104°F); ≤ 85% RH
Storage Conditions	-5-50°C (23-122°F); ≤ 90% RH
Power Source	100-240 VAC, 50-60 Hz
Dimensions (L x W x H)	27.2 cm x 26.9 cm x 14.6 cm (10.7" x 10.6" x 5.7")
Display Dimensions (L x W)	10.8 cm x 5.7 cm (4.2" x 2.2")
Weight	2.6 kg (5.7 lbs)

Ordering Information

Product Name	Catalog No.	Components		Kit Box Dimensions (L x W x H) & Weight	Carton Dimensions (L x W x H) & Weight	Number of Kits/Carton
U120 Urine Analyzer	U111-101 [†]	1 Urine Analyzer 1 Strip holder 2 Printer Paper Rolls	2 Fuses (2.0A) 1 Power Cord 1 Quick Start Guide 1 Instruction Manual	42.0 cm x 41.5 cm x 31 cm; 5.0 kg 16.4" x 16.2" x 12.1"; 176.4 oz		1
U120 Urine Analyzer with Barcode Reader	U111-111 [†]	1 Urine Analyzer 1 Strip holder 2 Printer Paper Rolls 1 Barcode Reader (RS232C)	2 Fuses (2.0A) 1 Power Cord 1 Serial Splitter Cable (RS232C) 1 Quick Start Guide 1 Instruction Manual	44.5 cm x 44.5 cm x 40.0 cm; 5.5 kg 17.5" x 17.5" x 15.7"; 194 oz		1
Barcode Reader	U221-111 [†]	1 Barcode Reader (RS232C)	1 Serial Splitter Cable (RS232C)	23.6 cm x 10.8 cm x 7.8 cm; 0.482 kg 9.3" x 4.3" x 3.1"; 17.0 oz	63.0 cm x 37.0 cm x 30.0 cm; 12.0 kg 24.8" x 14.6" x 11.8"; 423.3 oz	22
Printer Paper Rolls	U121-101	4 Printer Paper Rolls	Thermal Paper (0.06 m x 20 m): 200 results/roll Sticker Paper (0.06 m x 9 m): 100 results/roll	12.0 cm x 12.0 cm x 6.5 cm; 0.36 kg 4.7" x 4.7" x 2.6"; 12.7 oz	63.0 cm x 37.0 cm x 30.0 cm; 19.4 kg 24.8" x 14.6" x 11.8"; 684.3 oz	50
U120 Data Transfer Kit	U221-131 [†]	1 Data Transfer Cable (RS232C)	1 Package Insert	12.0 cm x 12.0 cm x 6.5 cm; 0.4 kg 4.7" x 4.7" x 2.6"; 14.1 oz	63.0 cm x 37.0 cm x 30.0 cm; 21.4 kg 24.8" x 14.6" x 11.8"; 684.3 oz; 754.9 oz	8

U500 Urine Analyzer



Accurate and Efficient

- Up to 500 tests/hour for medium/large volume sample testing
- Professional accuracy equivalent to market leader
- Automatic strip detection and alignment for better efficiency
- Test modes include Routine, STAT and QC

Easy to Operate

- Large touch screen LCD offers simple menu navigation
- Uniquely designed strip platform/waste tray unit for easy one-step cleaning

Convenient

- Automatic calibration and waste disposal reduce hands-on time
- Can read strips with 8, 9, 10, 11 parameters, additional strips with 1-11 parameters available upon request
- Strip selection of up to 4 combinations for analyzer reading
- Stores up to 2,000 records and automatically flags abnormal results
- Capable of printing results on sticker paper for quick and easy record management

Data Management Capability

- Includes RS232C port for easy data transfer to an external computer or LIS
- Optional Barcode Reader to record patient ID

Unique Lockout Functions Coming Soon!

- Strip Lockout
 - Prevents using strips of another brand on the U500 Urine Analyzer
 - Requires barcode reader scan or manual entry of the canister code
- User Lockout
 - Eliminates unapproved users from testing
 - Up to 10 lab operators can perform testing, but only the lab administrator can change analyzer settings
- QC Lockout
 - Prevents testing without passing QC
 - QC tests can be performed once every 8 hours, day, week or month
 - Analyzer will alert when to run QC test
 - If QC tests fail, analyzer will switch to STAT mode and list "E" at the end of each test number

Specifications

Feature	Specifications
Analyzer Type	Semi-Automatic
Methodology	Reflectance Photometry
Detection	Photosensitive Diode
Throughput	500 tests/hour (Measuring cycle: 7 seconds/test)
Test Modes	Routine, STAT and QC
Lockout Functions	Strip Lockout: Available Upon Request; User/QC Lockout: Included with option to turn ON/OFF
Memory	Last 2,000 Records
Strip Incubation Time	1 Minute
Wavelength	525 and 635 nm
Standard Strips	8, 9, 10, 11 Parameters (5 mm x 108 mm)
Additional Strips Available	1-11 Parameters (5 mm x 108 mm); see URS Parameters
Total Combinations Per Analyzer	4 Combinations
Waste Disposal Capacity	Up to 150 Strips
Analyzer Ports	Standard RS232C Port for Barcode Reader or Data Transfer 25 Pin Parallel Port for External Printer
Capabilities	Internal Thermal Printer (included) RS232C Barcode Reader (optional) Optional External Printer (not included) RS232C Data Transfer Cable (optional)
Major Readable Barcodes	Code 128, Code 39, Codabar (NW-7), Interleaved 25, UPC-A, UPC-E, EAN 8, EAN 13
Calibration	Automatic
Available Languages on the Screen	English and additional language(s)
Operating Conditions	0-40°C (32-104°F); ≤85% RH
Storage Conditions	-5-50°C (23-122°F); ≤90% RH
Power Source	100-240 VAC, 50-60 Hz
Dimensions (L x W x H)	36.6 cm x 28.3 cm x 19.5 cm (14.4" x 11.1" x 7.7")
Display Dimensions (L x W)	11.5 cm x 9.0 cm (4.5" x 3.5")
Weight	4.0 kg (8.8 lbs)

Ordering Information

Product Name	Catalog No.	Components	Kit Box Dimensions (L x W x H) & Weight	Carton Dimensions (L x W x H) & Weight	Number of Kits/Carton
U500 Urine Analyzer	U211-101✓	1 Urine Analyzer 1 Strip Platform/Waste Tray 2 Printer Paper Rolls	2 Fuses (2.0A) 1 Power Cord 1 Instruction Manual	51.0 cm x 42.0 cm x 38.5 cm; 7 kg 20.1" x 16.5" x 15.2"; 246.9 oz	1
U500 Urine Analyzer with Barcode Reader	U211-111✓	1 Urine Analyzer 1 Strip Platform/Waste Tray 2 Printer Paper Rolls 1 Barcode Reader (RS232C)	2 Fuses (2.0A) 1 Power Cord 1 Serial Splitter Cable (RS232C) 1 Instruction Manual	55.0 cm x 55.0 cm x 55.0 cm; 9.2 kg 21.7" x 21.7" x 21.7"; 324.5 oz	1
Barcode Reader	U221-111✓†	1 Barcode Reader (RS232C)	1 Serial Splitter Cable (RS232C)	23.6 cm x 10.8 cm x 7.8 cm; 0.482 kg 9.3" x 4.3" x 3.1"; 17.0 oz	22
Printer Paper Rolls	U121-101	4 Printer Paper Rolls	Thermal Paper (0.06 m x 20 m): 200 results/roll Sticker Paper (0.06 m x 9 m): 100 results/roll	12.0 cm x 12.0 cm x 6.5 cm; 0.360 kg 4.7" x 4.7" x 2.6"; 12.7 oz	50
U500 Data Transfer Kit	U221-131✓	1 Data Transfer Cable (RS232C)	1 Package Insert	12.0 cm x 12.0 cm x 6.5 cm; 0.40 kg 4.7" x 4.7" x 2.6"; 14.1 oz	8

We also offer other rapid diagnostic and medical products:

Blood Glucose Monitoring Systems, Immunoassay EIA/ELISA and more.

✓ CE Marked for sale in the European Community **CE**
† Cleared for US 510(k)



ACON Laboratories, Inc., 10125 Mesa Rim Road, San Diego, CA 92121, U.S.A. • Tel: 1-858-875-8000 • Fax: 1-858-200-0729 • E-mail: info@aconlabs.com
Please visit our website for details: www.aconlabs.com

Mission® Urinalysis Reagent Strips (Urine)

Package Insert

REF U031-011	REF U031-051	REF U031-091	English
REF U031-021	REF U031-061	REF U031-101	
REF U031-031	REF U031-071	REF U031-111	
REF U031-041	REF U031-081		

For rapid detection of multiple analytes in human urine.

For *in vitro* diagnostic use only.

INTENDED USE

The Urinalysis Reagent Strips (Urine) are firm plastic strips onto which several separate reagent areas are affixed. The test is for the qualitative and semi-quantitative detection of one or more of the following analytes in urine: Ascorbic acid, Glucose, Bilirubin, Ketone (Acetoacetic acid), Specific Gravity, Blood, pH, Protein, Urobilinogen, Nitrite and Leukocytes.

SUMMARY

Urine undergoes many changes during states of disease or body dysfunction before blood composition is altered to a significant extent. Urinalysis is a useful procedure as an indicator of health or disease, and as such, is a part of routine health screening. The Urinalysis Reagent Strips (Urine) can be used in general evaluation of health, and aids in the diagnosis and monitoring of metabolic or systemic diseases that affect kidney function, endocrine disorders and diseases or disorders of the urinary tract.^{1,2}

PRINCIPLE AND EXPECTED VALUES

Ascorbic acid: This test involves decolorization of Tillmann's reagent. The presence of ascorbic acid causes the color of the test field to change from blue-green to orange. Patients with adequate diet may excrete 2-10 mg/dL daily. After ingesting large amounts of ascorbic acid, levels can be around 200 mg/dL.

Glucose: This test is based on the enzymatic reaction that occurs between glucose oxidase, peroxidase and chromogen. Glucose is first oxidized to produce gluconic acid and hydrogen peroxide in the presence of glucose oxidase. The hydrogen peroxide reacts with potassium iodide chromogen in the presence of peroxidase. The extent to which the chromogen is oxidized determines the color which is produced, ranging from green to brown. Glucose should not be detected in normal urine. Small amounts of glucose may be excreted by the kidney.³ Glucose concentrations as low as 100 mg/dL may be considered abnormal if results are consistent.

Bilirubin: This test is based on azo-coupling reaction of bilirubin with diazotized dichloroaniline in a strongly acidic medium. Varying bilirubin levels will produce a pinkish-tan color proportional to its concentration in urine. In normal urine, no bilirubin is detectable by even the most sensitive methods. Even trace amounts of bilirubin require further investigation. Atypical results (colors different from the negative or positive color blocks shown on the color chart) may indicate that bilirubin-derived bile pigments are present in the urine specimen, and are possibly masking the bilirubin reaction.

Ketone: This test is based on ketones reacting with nitroprusside and acetoacetic acid to produce a color change ranging from light pink for negative results to a darker pink or purple color for positive results. Ketones are normally not present in urine. Detectable ketone levels may occur in urine during physiological stress conditions such as fasting, pregnancy and frequent strenuous exercise.⁴⁻⁶ In starvation diets, or in other abnormal carbohydrate metabolism situations, ketones appear in the urine in excessively high concentration before serum ketones are elevated.⁷

Specific Gravity: This test is based on the apparent pKa change of certain pretreated polyelectrolytes in relation to ionic concentration. In the presence of an indicator, colors range from deep blue-green in urine of low ionic concentration to green and yellow-green in urine of increasing ionic concentration. Randomly collected urine may vary in specific gravity from 1.003-1.035.⁸ Twenty-four hour urine from healthy adults with normal diets and fluid intake will have a specific gravity of 1.016-1.022.⁹ In cases of severe renal damage, the specific gravity is fixed at 1.010, the value of the glomerular filtrate.

Blood: This test is based on the peroxidase-like activity of hemoglobin which catalyzes the reaction of diisopropylbenzene dihydroperoxide and 3,3',5,5'-tetramethylbenzidine. The resulting color ranges from orange to dark blue. Any green spots or green color development on the reagent area within 60 seconds is significant and the urine specimen should be examined further. Blood is often, but not invariably, found in the urine of menstruating females. The significance of a trace reading varies among patients and clinical judgment is required in these specimens.

pH: This test is based on a double indicator system which gives a broad range of colors covering the entire urinary pH range. Colors range from orange to yellow and green to blue. The expected range for normal urine specimens from newborns is pH 5-7.⁹ The expected range for other normal urine specimens is pH 4.5-8, with an average result of pH 6.⁹

Protein: This reaction is based on the phenomenon known as the "protein error" of pH indicators where an indicator that is highly buffered will change color in the presence of proteins (anions) as the indicator releases hydrogen ions to the protein. At a constant pH, the development of any green color is due to the presence of protein. Colors range from yellow to yellow-green for negative results and green to green-blue for positive results. 1-14 mg/dL of protein may be excreted by a normal kidney.¹⁰ A color matching any block greater than trace indicates significant proteinuria. Clinical judgment is required to evaluate the significance of trace results.

Urobilinogen: This test is based on a modified Ehrlich reaction between p-diethylaminobenzaldehyde and urobilinogen in strongly acidic medium to produce a pink color. Urobilinogen is one of the major compounds produced in heme synthesis and is a normal substance in urine. The expected range for normal urine with this test is 0.2-1.0 mg/dL (3.5-17 µmol/L).⁸ A result of 2.0 mg/dL (35 µmol/L) may be of clinical significance, and the patient specimen should be further evaluated.

Nitrite: This test depends upon the conversion of nitrate to nitrite by the action of Gram negative bacteria in the urine. In an acidic medium, nitrite in the urine reacts with p-arsanilic acid to form a diazonium compound. The diazonium compound in turn couples with 1 N-(1-naphthyl) ethylenediamine to produce a pink color. Nitrite is not detectable in normal urine.⁹ The nitrite area will be positive in some cases of infection, depending on how long the urine specimens were retained in the bladder prior to collection. Retrieval of positive cases with the nitrite test ranges from as low as 40% in cases where little bladder incubation occurred, to as high as approximately 80% in cases where bladder incubation took place for at least 4 hours.

Leukocytes: This test reveals the presence of granulocyte esterases. The esterases cleave a derivatized pyrazole amino acid ester to liberate derivatized hydroxy pyrazole. This pyrazole then reacts with a diazonium salt to produce a beige-pink to purple color. Normal urine specimens generally yield negative results. Trace results may be of questionable clinical significance. When trace results occur, it is recommended to retest using a fresh specimen from the same patient. Repeated trace and positive results are of clinical significance.

REAGENTS AND PERFORMANCE CHARACTERISTICS

Based on the dry weight at the time of impregnation, the concentrations given may vary within manufacturing tolerances. The following table below indicates read times and performance characteristics for each parameter.

Reagent	Read Time	Composition	Description
Ascorbic Acid (ASC)	30 seconds	2,6-dichlorophenolindophenol; buffer and non-reactive ingredients	Detects ascorbic acid as low as 5-10 mg/dL (0.28-0.56 mmol/L).
Glucose (GLU)	30 seconds	glucose oxidase; peroxidase; potassium iodide; buffer; non-reactive ingredients	Detects glucose as low as 50-100 mg/dL (2.5-5 mmol/L).
Bilirubin (BIL)	30 seconds	2, 4-dichloroaniline diazonium salt; buffer and non-reactive ingredients	Detects bilirubin as low as 0.4-1.0 mg/dL (6.8-17 µmol/L).
Ketone (KET)	40 seconds	sodium nitroprusside; buffer	Detects acetoacetic acid as low as 2.5-5 mg/dL (0.25-0.5 mmol/L).
Specific Gravity (SG)	45 seconds	bromthymol blue indicator; buffer and non-reactive ingredients; poly (methyl vinyl ether/maleic anhydride); sodium hydroxide	Determines urine specific gravity between 1.000 and 1.030. Results correlate with values obtained by refractive index method within ± 0.005.
Blood (BLO)	60 seconds	3,3',5,5'-tetramethylbenzidine (TMB); diisopropylbenzene dihydroperoxide; buffer and non-reactive ingredients	Detects free hemoglobin as low as 0.018-0.060 mg/dL or 5-10 Ery/µL in urine specimens with ascorbic acid content of < 50 mg/dL.
pH	60 seconds	methyl red sodium salt; bromthymol blue; non-reactive ingredients	Permits the quantitative differentiation of pH values within the range of 5-9.
Protein (PRO)	60 seconds	tetrabromophenol blue; buffer and non-reactive ingredients	Detects albumin as low as 7.5-15 mg/dL (0.075-0.15 g/L).
Urobilinogen (URO)	60 seconds	p-diethylaminobenzaldehyde; buffer and non-reactive ingredients	Detects urobilinogen as low as 0.2-1.0 mg/dL (3.5-17 µmol/L).
Nitrite (NIT)	60 seconds	p-arsanilic acid; N-(1-naphthyl) ethylenediamine; non-reactive ingredients	Detects sodium nitrite as low as 0.05-0.1 mg/dL in urine with a low specific gravity and less than 30 mg/dL ascorbic acid.
Leukocytes (LEU)	120 seconds	derivatized pyrrole amino acid ester; diazonium salt; buffer; non-reactive ingredients	Detects leukocytes as low as 9-15 white blood cells Leu/µL in clinical urine.

The performance characteristics of the Urinalysis Reagent Strips (Urine) have been determined in both laboratory and clinical tests. Parameters of importance to the user are sensitivity, specificity, accuracy and precision. Generally, this test has been developed to be specific for the parameters to be measured with the exceptions of the interferences listed. Please refer to the Limitations section in this package insert.

Interpretation of visual results is dependent on several factors: the variability of color perception, the presence or absence of inhibitory factors, and the lighting conditions when the strip is read. Each color block on the chart corresponds to a range of analyte concentrations.

PRECAUTIONS

- For *in vitro* diagnostic use only. Do not use after the expiration date.
- The strip should remain in the closed canister until use.
- Do not touch the reagent areas of the strip.
- Discard any discolored strips that may have deteriorated.
- All specimens should be considered potentially hazardous and handled in the same manner as an infectious agent.
- The used strip should be discarded according to local regulations after testing.

STORAGE AND STABILITY

Store as packaged in the closed canister either at room temperature or refrigerated (2-30°C). Keep out of direct sunlight. The strip is stable through the expiration date printed on the canister label. Do not remove the desiccant. Remove only enough strips for immediate use. Replace cap immediately and tightly. **DO NOT FREEZE.** Do not use beyond the expiration date.

Note: Once the canister has been opened, the remaining strips are stable for up to 3 months. Stability may be reduced in high humidity conditions.

SPECIMEN COLLECTION AND PREPARATION

A urine specimen must be collected in a clean and dry container and tested as soon as possible. Do not centrifuge. The use of urine preservatives is not recommended. If testing cannot be done within an hour after voiding, refrigerate the specimen immediately and let it return to room temperature before testing.

Prolonged storage of unpreserved urine at room temperature may result in microbial proliferation with resultant changes in pH. A shift to alkaline pH may cause false positive results with the protein test area. Urine containing glucose may decrease in pH as organisms metabolize the glucose.

Contamination of the urine specimen with skin cleansers containing chlorhexidine may affect protein (and to a lesser extent, specific gravity and bilirubin) test results.

MATERIALS

Materials Provided

- Strips

- Package insert

Materials Required But Not Provided

- Specimen collection container

- Timer

DIRECTIONS FOR USE

Allow the strip, urine specimen, and/or controls to reach room temperature (15-30°C) prior to testing.

- Remove the strip from the closed canister and use it as soon as possible. Immediately close the canister tightly after removing the required number of strip(s). Completely immerse the reagent areas of the strip in fresh, well-mixed urine and immediately remove the strip to avoid dissolving the reagents. See illustration 1 below.
- While removing the strip from the urine, run the edge of the strip against the rim of the urine container to remove excess urine. Hold the strip in a horizontal position and bring the edge of the strip into contact with an absorbent material (e.g. a paper towel) to avoid mixing chemicals from adjacent reagent areas and/or soiling hands with urine. See illustration 2 below.
- Compare the reagent areas to the corresponding color blocks on the canister label at the specified times. Hold the strip close to the color blocks and match carefully. See illustration 3 below.

Note: Results may be read up to 2 minutes after the specified times.

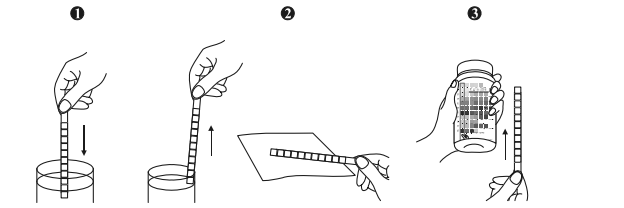

INTERPRETATION OF RESULTS

Results are obtained by direct comparison of the color blocks printed on the canister label. The color blocks represent nominal values; actual values will vary close to the nominal values. In the event of unexpected or questionable results, the following steps are recommended: confirm that the strips have been tested within the expiration date printed on the canister label, compare results with known positive and negative controls and repeat the test using a new strip. If the problem persists, discontinue using the strip immediately and contact your local distributor.

QUALITY CONTROL

For best results, performance of reagent strips should be confirmed by testing known positive and negative specimens/controls whenever a new test is performed, or whenever a new canister is first opened. Each laboratory should establish its own goals for adequate standards of performance.

LIMITATIONS

Note: The Urinalysis Reagent Strips (Urine) may be affected by substances that cause abnormal urine color such as drugs containing azo dyes (e.g. Pyridium®. Azo Gantrisin®, Azo Gantanol®), nitrofurantoin (Microdantin®, Furadantin®), and riboflavin.⁸ The color development on the test pad may be masked or a color reaction may be produced that could be interpreted as false results.

Ascorbic acid: No interference is known.

Glucose: The reagent area does not react with lactose, galactose, fructose or other metabolic substances, nor with reducing metabolites of drugs (e.g. salicylates and nalidixic acid). Sensitivity may be decreased in specimens with high specific gravity (>1.025) and with ascorbic acid concentrations of ≥ 25 mg/dL. High ketone levels ≥ 100 mg/dL may cause false negative results for specimens containing a small amount of glucose (50-100 mg/dL).

Bilirubin: Bilirubin is absent in normal urine, so any positive result, including a trace positive, indicates an underlying pathological condition and requires further investigation. Reactions may occur with urine containing large doses of chlorpromazine or rifampin that might be mistaken for positive bilirubin.⁹ The presence of bilirubin-derived bile pigments may mask the bilirubin reaction. This phenomenon is characterized by color development on the test patch that does not correlate with the colors on the color chart. Large concentrations of ascorbic acid may decrease sensitivity.

Ketone: The test does not react with acetone or β-hydroxybutyrate.⁸ Urine specimens of high pigment, and other substances containing sulfindryl groups may occasionally give reactions up to and including trace (±).

Specific Gravity: Ketoacidosis or protein higher than 300 mg/dL may cause elevated results. Results are not affected by non-ionic urine components such as glucose. If the urine has a pH of 7 or greater, add 0.005 to the specific gravity reading indicated on the color chart.

Blood: A uniform blue color indicates the presence of myoglobin, hemoglobin or hemolyzed erythrocytes.⁸ Scattered or compacted blue spots indicate intact erythrocytes. To enhance accuracy, separate color scales are provided for hemoglobin and for erythrocytes. Positive results with this test are often seen with urine from menstruating females. It has been reported that urine of high pH reduces sensitivity, while moderate to

high concentration of ascorbic acid may inhibit color formation. Microbial peroxidase, associated with urinary tract infection, may cause a false positive reaction. The test is slightly more sensitive to free hemoglobin and myoglobin than to intact erythrocytes.

pH: If the procedure is not followed and excess urine remains on the strip, a phenomenon known as "runover" may occur, in which the acid buffer from the protein reagent will run onto the pH area, causing the pH result to appear artificially low. pH readings are not affected by variations in urinary buffer concentration.

Protein: Any green color indicates the presence of protein in the urine. This test is highly sensitive for albumin, and less sensitive to hemoglobin, globulin and mucoprotein.⁸ A negative result does not rule out the presence of these other proteins. False positive results may be obtained with highly buffered or alkaline urine. Contamination of urine specimens with quaternary ammonium compounds or skin cleansers containing chlorhexidine may produce false positive results.⁸ The urine specimens with high specific gravity may give false negative results.

Urobilinogen: All results lower than 1 mg/dL urobilinogen should be interpreted as normal. A negative result does not at any time preclude the absence of urobilinogen. The reagent area may react with interfering substances known to react with Ehrlich's reagent, such as p-aminosalicylic acid and sulfonamides.⁹ False negative results may be obtained if formalin is present. The test cannot be used to detect porphobilinogen.

Nitrite: The test is specific for nitrite and will not react with any other substance normally excreted in urine. Any degree of uniform pink to red color should be interpreted as a positive result, suggesting the presence of nitrite. Color intensity is not proportional to the number of bacteria present in the urine specimen. Pink spots or pink edges should not be interpreted as a positive result. Comparing the reacted reagent area on a white background may aid in the detection of low nitrite levels, which might otherwise be missed. Ascorbic acid above 30 mg/dL may cause false negatives in urine containing less than 0.05 mg/dL nitrite ions. The sensitivity of this test is reduced for urine specimens with highly buffered alkaline urine or with high specific gravity. A negative result does not at any time preclude the possibility of bacteruria. Negative results may occur in urinary tract infections from organisms that do not contain reductase to convert nitrate to nitrite; when urine has not been retained in the bladder for a sufficient length of time (at least 4 hours) for reduction of nitrate to nitrite to occur; when receiving antibiotic therapy or when dietary nitrate is absent.

Leukocytes: The result should be read between 60-120 seconds to allow for complete color development. The intensity of the color that develops is proportional to the number of leukocytes present in the urine specimen. High specific gravity or elevated glucose concentrations (≥ 2,000 mg/dL) may cause test results to be artificially low. The presence of cephalixin, cephalothin, or high concentrations of oxalic acid may also cause test results to be artificially low. Tetracycline may cause decreased reactivity, and high levels of the drug may cause a false negative reaction. High urinary protein may diminish the intensity of the reaction color. This test will not react with erythrocytes or bacteria common in urine.⁸

BIBLIOGRAPHY

- Free AH, Free HM. *Urinalysis, Critical Discipline of Clinical Science*. CRC Crit. Rev. Clin. Lab. Sci. 3(4): 481-531, 1972.
- Yoder J, Adams EC, Free, AH. *Simultaneous Screening for Urinary Occult Blood, Protein, Glucose, and pH*. Amer. J. Med Tech. 31:285, 1965.
- Shchersten B, Fritz H. *Subnormal Levels of Glucose in Urine*. JAMA 201:129-132, 1967.
- McGarry JD, Lilly. Lecture, 1978: New Perspectives in the Regulation of Ketogenesis. Diabetes 28: 517-523 May, 1978.
- Williamson DH. *Physiological Ketoses, or Why Ketone Bodies?* Postgrad. Med. J. (June Suppl.): 372-375, 1971.
- Paterson P, et al. *Maternal and Fetal Ketone Concentrations in Plasma and Urine*. Lancet: 862-865; April 22, 1967.
- Fraser J, et al. *Studies with a Simplified Nitroprusside Test for Ketone Bodies in Urine, Serum, Plasma and Milk*. Clin. Chem. Acta II: 372-378, 1965.
- Henry JB, et al. Clinical Diagnosis and Management by Laboratory Methods, 20th Ed. Philadelphia. Saunders. 371-372, 375, 379, 382, 385, 2001.
- Tietz NW. Clinical Guide to Laboratory Tests. W.B. Saunders Company. 1976.
- Burtis CA, Ashwood ER. Tietz Textbook of Clinical Chemistry 2nd Ed. 2205, 1994.

Index of Symbols			
	Consult instructions for use		Tests per kit
	For <i>in vitro</i> diagnostic use only		Use by
	Store between 2-30°C		Lot Number
	Authorized Representative		Catalog #

**ACON Laboratories, Inc.**
10125 Mesa Rim Road,
San Diego, CA 92121, USA

**MDSS GmbH**
Schiffgraben 41
30175 Hannover, Germany



浙江东方基因生物制品股份有限公司
Zhejiang Orient Gene Biotech Co.,LTD

STATEMENT

We, Zhejiang Orient Gene Biotech Co., Ltd , having a registered office at 3787#, East Yangguang Avenue, Dipu Street Anji 313300, Huzhou, Zhejiang, China assign SRL SANMEDICO having a registered office at A. Corobceanu street 7A, apt. 9, Chişinău MD-2012, Moldova, as exclusive authorized representative for Orient Gene Brand product in correspondence with the conditions of directive 98/79/EEC in Moldova only. The detailed product list is in the Annex 1 in the following pages.

We declare that the company mentioned above is authorized to register, notify, renew or modify the registration of medical devices on the territory of the Republic of Moldova.

This Statement letter will be valid from Mar.10th,2025to Mar.09th, 2027.

Zhejiang Orient Gene Biotech Co., Ltd

General Manager:

Date:2025/3/10



地址：浙江省湖州市安吉县递铺镇阳光大道东段 3787 号
Add: 3787#, East Yangguang Avenue, Dipu Street Anji 313300, Huzhou, Zhejiang, China
电话 Tel:+86-572-5226111 传真 Fax: +86-572-5226222 邮编 P.C.:313300



浙江东方基因生物制品股份有限公司
Zhejiang Orient Gene Biotech Co.,LTD

Annex 1

Numărul de catalog (referință)*	Denumire generică (denumirea dispozitivului)	Denumire comercială (brand)*	Modelul
GCCOV-702a-H1	TEST RAPID	Orient Gene	Rapid COVID-19 Antigen Oral Fluid Self-Test
GCCOV-702a-H5	TEST RAPID	Orient Gene	Rapid COVID-19 Antigen Oral Fluid Self-Test
GCCOV-702a-H20	TEST RAPID	Orient Gene	Rapid COVID-19 Antigen Oral Fluid Self-Test
GCCOV-502a-H1OGE	TEST RAPID	Orient Gene	Rapid COVID-19 (Antigen) Self-test
GCCOV-502a-H5OGE	TEST RAPID	Orient Gene	Rapid COVID-19 (Antigen) Self-test
GCCOV-502a-H20OGE	TEST RAPID	Orient Gene	Rapid COVID-19 (Antigen) Self-test

GIHSA-102a	TEST RAPID	Orient Gene	One Step Microalbumin Test Cassette
GIHSA-101a	TEST RAPID	Orient Gene	One Step Microalbumin Test Strip (Urine)
GCROA-602a	TEST RAPID	Orient Gene	Rotavirus rapid test cassette (feces)
GCMAL(pf/pv)-402a	TEST RAPID	Orient Gene	Malaria P.f./P.v. Ag Rapid Test Cassette (Whole Blood)
GCROA/ADE-602a	TEST RAPID	Orient Gene	Rotavirus and Adenovirus Combo Rapid Test Cassette (Feces)
GASPE-902a	TEST RAPID	Orient Gene	Male Fertility Rapid Test Cassette (Semen)
GAFSH-101a	TEST RAPID	Orient Gene	One Step Menopause Test Strip (Urine)
GAFSH-102a	TEST RAPID	Orient Gene	One Step Menopause Test Cassette (Urine)
GAIGF1-502a	TEST RAPID	Orient Gene	iGFBP-1 Rapid test Cassette (Swab)

地址：浙江省湖州市安吉县递铺镇阳光大道东段 3787 号

Add: 3787#, East Yangguang Avenue, Dipu Street Anji 313300, Huzhou, Zhejiang, China

电话 Tel:+86-572-5226111 传真 Fax: +86-572-5226222 邮编 P.C.:313300



浙江东方基因生物制品股份有限公司
Zhejiang Orient Gene Biotech Co.,LTD

GAIGF1-501a	TEST RAPID	Orient Gene	iGFBP-1 Rapid Test Strip (Cervical Secretion)
GALH-101a	TEST RAPID	Orient Gene	One Step Ovulation Test Strip (Urine) (25mlU)
GALH-101b	TEST RAPID	Orient Gene	One Step Ovulation Test Strip (Urine) (40mlU)
GALH-102a	TEST RAPID	Orient Gene	One Step Ovulation Test Cassette (Urine) (25mlU)
GALH-102b	TEST RAPID	Orient Gene	One Step Ovulation Test Cassette (Urine) (40mlU)
GCTYP-302a	TEST RAPID	Orient Gene	Typhoid IgG/IgM Rapid Test Cassette (serum/plasma)
GCMAL(pf/pan)-402a	TEST RAPID	Orient Gene	Malaria P.f./Pan Ag Rapid Test Cassette (Whole Blood)
GCDEN-425a	TEST RAPID	Orient Gene	Dengue NS1+IgM/IgG Combo Rapid Test Cassette (Whole blood/serum/plasma)
GCDEN(NS)-402c	TEST RAPID	Orient Gene	Dengue NS1 Antigen Rapid Test Cassette (Whole blood/serum/plasma)
GCDEN(ab)-402c	TEST RAPID	Orient Gene	Dengue IgM/IgG Rapid Test Cassette (Whole blood/serum/plasma)
GCVCH(O1/O9)-602a	TEST RAPID	Orient Gene	V.cholerae O1/O139 Ag Combo Rapid Test Cassette (Feces)
GCMAL(pf)-402a	TEST RAPID	Orient Gene	Malaria Pf Ag Rapid Test Cassette (Whole blood)
GCSAL(ST)-602a	TEST RAPID	Orient Gene	S. typhi Ag Rapid Test Cassette (Serum/plasma/Feces)
GCCHK(IgM)-402a	TEST RAPID	Orient Gene	Chikungunya IgM Rapid Test Cassette (Whole blood/Serum/Plasma)
GCCOV-502a-NN	TEST RAPID	Orient Gene	Coronavirus Ag Rapid Test Cassette (Swab)
GCCOV (Nab)-402b	TEST RAPID	Orient Gene	SARS-CoV-2 Neutralizing Antibody Rapid Test Cassette (Whole blood/Serum/Plasma)
GCCOV-502a-NA	TEST RAPID	Orient Gene	Coronavirus Ag Rapid Tests Cassette (Swab)

地址：浙江省湖州市安吉县递铺镇阳光大道东段 3787 号

Add: 3787#, East Yangguang Avenue, Dipu Street Anji 313300, Huzhou, Zhejiang, China

电话 Tel: +86-572-5226111 传真 Fax: +86-572-5226222 邮编 P.C.: 313300



浙江东方基因生物制品股份有限公司
Zhejiang Orient Gene Biotech Co.,LTD

GCCOV (Ag)-PN10	TEST RAPID	Orient Gene	COVID-19 Antigen Control Kit
GCCOV (Ag)-PN20	TEST RAPID	Orient Gene	COVID-19 Antigen Control Kit
GCFERA-545a	TEST RAPID	Orient Gene	Flu, COVID-19,RSV&Adeno Ag Combo Tests Cassette (Swab)
GCTV-502a	TEST RAPID	Orient Gene	Trichomonas Ag Rapid Test Cassette (Swab)
GCVCH(O1)-602a	TEST RAPID	Orient Gene	V.cholerae O1 Ag Rapid Test Cassette (Feces)
GCCHA-402a	TEST RAPID	Orient Gene	Chagas Ab Rapid Test Cassette (Whole blood/serum/plasma)
GCMAL(pf/pv Ab)-302a	TEST RAPID	Orient Gene	Malaria Pf/Pv Ab Rapid Test Cassette (Serum/plasma)
GCMAL(pf/pv Ab)-402a	TEST RAPID	Orient Gene	Malaria Pf/Pv Ab Rapid Test Cassette (Whole blood/Serum/plasma)
GCMKP-502b	TEST RAPID	Orient Gene	Monkeypox Ag Rapid Test Cassette (Swab)
GCCOV(Del)-T502a	TEST RAPID	Orient Gene	SARS-CoV-2 Delta-series Mutant Strain Ag Rapid Test cassette (Swab)
GCCOV-PN10	TEST RAPID	Orient Gene	COVID-19 IgG/IgM Control kit
GCCOV-PN20	TEST RAPID	Orient Gene	COVID-19 IgG/IgM Control kit
GCFER-T525a	TEST RAPID	Orient Gene	COVID-19/Flu A&B/ RSV Ag Combo Rapid Test Cassette (Swab)
GCCOV(B117)-525a	TEST RAPID	Orient Gene	COVID-19 Ag&B.1.1.7 Mutant Strain Combo Test Cassette (Swab)
GCFERA-T525a	TEST RAPID	Orient Gene	COVID-19/Flu A&B/ RSV/Adeno Ag Combo Rapid Test Cassette (Swab)
GCCOV-702a	TEST RAPID	Orient Gene	COVID-19 Ag Rapid Test Cassette (Oral fluid)
GCFE-T502a	TEST RAPID	Orient Gene	COVID-19/Flu A&B Ag Combo Rapid Test Cassette (Swab)

地址：浙江省湖州市安吉县递铺镇阳光大道东段 3787 号

Add: 3787#, East Yangguang Avenue, Dipu Street Anji 313300, Huzhou, Zhejiang, China

电话 Tel:+86-572-5226111 传真 Fax:+86-572-5226222 邮编 P.C.:313300



浙江东方基因生物制品股份有限公司
Zhejiang Orient Gene Biotech Co.,LTD

GCMKP-402a	TEST RAPID	Orient Gene	Monkeypox IgG/IgM Rapid Test Cassette (Whole blood/serum/plasma)
GCKa1-401a	TEST RAPID	Orient Gene	Leishmania Ab Rapid Test strip (Whole blood/serum/plasma)
GCKa1-T402a	TEST RAPID	Orient Gene	Leishmania IgG/IgM Rapid test cassette (whole blood/serum/plasma)
GCCOV-503a	TEST RAPID	Orient Gene	Smart Rapid COVID-19 Ag Test Device
GCBRU-402a	TEST RAPID	Orient Gene	Brucella Antibody Rapid Test Cassette (Whole blood/serum/plasma)
GCCHA-302a	TEST RAPID	Orient Gene	Chagas Ab Rapid Test Cassette (Serum/plasma)
GCCHK(IgM)-302a	TEST RAPID	Orient Gene	Chikungunya IgM Rapid Test Cassette (Serum/Plasma)
GCCOV-501a	TEST RAPID	Orient Gene	Rapid COVID-19 Antigen Test Strip
GCMON-352a	TEST RAPID	Orient Gene	Mononucleosis IgG/IgM Rapid Test Cassette (Serum/plasma)
GCMON-402a	TEST RAPID	Orient Gene	Mononucleosis Rapid Test Cassette (Whole blood/Serum/plasma)
GCMON-425a	TEST RAPID	Orient Gene	Mononucleosis IgG/IgM Rapid Test Cassette (Whole blood/Serum/plasma)
GCEV71 (IgM)-302a	TEST RAPID	Orient Gene	EV71 IgM Rapid Test Cassette (Serum/plasma)
GCEV71 (IgM)-402a	TEST RAPID	Orient Gene	EV71 IgM Rapid Test Cassette (Whole blood/Serum/plasma)
GENMP22-102a	TEST RAPID	Orient Gene	One Step Nuclear Matrix Protein 22 Test Cassette (Urine)
GEFOB/TF-602a	TEST RAPID	Orient Gene	Fecal Occult Blood and Transferrin Combo Rapid Test Cassette (Feces)
GCHEV-302a	TEST RAPID	Orient Gene	HEV IgM Rapid Test Cassette (Serum/Plasma)
GCMP (IgM)-302a	TEST RAPID	Orient Gene	M.pneumonia IgM Rapid Test Cassette (Serum/plasma)

地址：浙江省湖州市安吉县递铺镇阳光大道东段 3787 号

Add: 3787#, East Yangguang Avenue, Dipu Street Anji 313300, Huzhou, Zhejiang, China

电话 Tel:+86-572-5226111 传真 Fax: +86-572-5226222 邮编 P.C.:313300



浙江东方基因生物制品股份有限公司
Zhejiang Orient Gene Biotech Co.,LTD

FCCOV-502a	TEST RAPID	Orient Gene	SARS-CoV-2 Ag Fluorescence Rapid Test Cassette (Swab)
GCCOV-402Ba	TEST RAPID	Orient Gene	COVID-19 IgG/IgM Rapid test cassette (whole blood/serum/plasma)
GCCOV-402a	TEST RAPID	Orient Gene	COVID-19 IgG/IgM Rapid test cassette (whole blood/serum/plasma)
GCCOV-502a	TEST RAPID	Orient Gene	Coronavirus Ag Rapid Test Cassette (Swab)
GCFC-T503a	TEST RAPID	Orient Gene	Smart Rapid COVID-19 &Flu A/B Ag Test Device
GAHCG-101a	TEST RAPID	Orient Gene	One step pregnancy test strip (urine)
GAHCG-101d	TEST RAPID	Orient Gene	One step pregnancy test strip (urine)
GAHCG-101b	TEST RAPID	Orient Gene	One step pregnancy test strip (urine)
GAHCG-102a	TEST RAPID	Orient Gene	One step pregnancy test cassette (urine)
GAHCG-102d	TEST RAPID	Orient Gene	One step pregnancy test cassette (urine)
GAHCG-102b	TEST RAPID	Orient Gene	One step pregnancy test cassette (urine)

GEFOB-602c	TEST RAPID	Orient Gene	Fecal Occult Blood Rapid Test Cassette (Feces)
GEFOB-602b	TEST RAPID	Orient Gene	Fecal Occult Blood Rapid Test Cassette (Feces)
GEFOB-601c	TEST RAPID	Orient Gene	Fecal Occult Blood Rapid Test Strip (Feces)
GEFOB-601b	TEST RAPID	Orient Gene	Fecal Occult Blood Rapid Test Strip (Feces)
GECEA-402a	TEST RAPID	Orient Gene	Carcinoembryonic Antigen Rapid Test Cassette (Whole blood/serum/plasma)

地址：浙江省湖州市安吉县递铺镇阳光大道东段 3787 号
Add: 3787#, East Yangguang Avenue, Dipu Street Anji 313300, Huzhou, Zhejiang, China
电话 Tel: +86-572-5226111 传真 Fax: +86-572-5226222 邮编 P.C.: 313300



浙江东方基因生物制品股份有限公司
Zhejiang Orient Gene Biotech Co.,LTD

GECEA-401a	TEST RAPID	Orient Gene	Carcinoembryonic Antigen Rapid Test Strip (Whole blood/serum/plasma)
GETF-602a	TEST RAPID	Orient Gene	Transferrin Rapid Test Cassette (Feces)
GETF-601a	TEST RAPID	Orient Gene	Transferrin Rapid Test Strip (Feces)
GEAFP-401a	TEST RAPID	Orient Gene	Alpha-Fetoprotein Rapid Test Strip (Whole blood/serum/plasma)
GEAFP-402a	TEST RAPID	Orient Gene	Alpha-Fetoprotein Rapid Test Cassette (Whole blood/serum/plasma)
GIHSA-101a	TEST RAPID	Orient Gene	One step microalbumin test strip (urine)
GIHSA-102a	TEST RAPID	Orient Gene	One step microalbumin test cassette (urine)
GDCAR-335a	TEST RAPID	Orient Gene	Myoglobin/CK-MB/Troponin I Combo Test Cassette (Serum/plasma)
GDCKM-302a	TEST RAPID	Orient Gene	One step CK-MB Test Cassette (Serum/Plasma)
GDCKM-402a	TEST RAPID	Orient Gene	CK-MB Rapid Test Cassette (Whole blood/serum/plasma)
GDCRP-402a	TEST RAPID	Orient Gene	C-Reactive Protein Semi-Quantitative Rapid Test Cassette (Whole Blood/serum/plasma)
GDTRO-302a	TEST RAPID	Orient Gene	Troponin I Rapid Test Cassette (Serum/Plasma)
GDTRO-402a	TEST RAPID	Orient Gene	Troponin I Rapid Test Cassette (Whole blood/Serum/Plasma) (Except the tender No. ocds-b3wdp1-MD-1722410248839 din 05.09.2024, limited to the quantity 28060 pcs only, as per the tender)
GDTRO-402b	TEST RAPID	Orient Gene	Troponin I Rapid Test Cassette (Whole blood/Serum/Plasma)

地址：浙江省湖州市安吉县递铺镇阳光大道东段 3787 号

Add: 3787#, East Yangguang Avenue, Dipu Street Anji 313300, Huzhou, Zhejiang, China

电话 Tel:+86-572-5226111 传真 Fax: +86-572-5226222 邮编 P.C.:313300



浙江东方基因生物制品股份有限公司

Zhejiang Orient Gene Biotech Co.,LTD

GDMYO-402a	TEST RAPID	Orient Gene	Myoglobin Rapid Test Cassette (Whole blood/serum/plasma)
GDCAR-W435a	TEST RAPID	Orient Gene	Myoglobin/CK-MB/Troponin I Combo Rapid Test Cassette (whole blood/Serum/plasma)
GDPCT-402a	TEST RAPID	Orient Gene	Procalcitonin Rapid Test Cassette (Whole blood/serum/plasma)
GDPCT-T402a	TEST RAPID	Orient Gene	Procalcitonin Semi-Quantitative Rapid Test Cassette (Whole blood/serum/plasma)
GDPCT-T401a	TEST RAPID	Orient Gene	Procalcitonin Semi-Quantitative Rapid Test Strip (Whole blood/serum/plasma)
FDPCT -302a	TEST RAPID	Orient Gene	Procalcitonin Rapid Test Kit (serum/plasma)
GDDDI-402b	TEST RAPID	Orient Gene	D-Dimer Rapid Test Cassette (Whole blood/plasma)
FDCAR-T302a	TEST RAPID	Orient Gene	Troponin I/CK-MB/Myoglobin Fluorescence Combo Test Kit (Serum/plasma)
FDTRO-302a	TEST RAPID	Orient Gene	Troponin I Fluorescence Rapid Test Kit (Serum/plasma)
FDBNP-302a	TEST RAPID	Orient Gene	NT-ProBNP Fluorescence Rapid Test Kit (Serum/plasma)
FDCRP-402a	TEST RAPID	Orient Gene	C-Reactive Protein Rapid Test Kit (Whole blood/serum/plasma)
GDCKM-402a	TEST RAPID	Orient Gene	CK-MB Rapid Test Cassette (whole blood/serum/plasma)
GAHCG-201a	TEST RAPID	Orient Gene	One step pregnancy test strip (Urine/serum)
GAHCG-202a	TEST RAPID	Orient Gene	One step pregnancy test cassette (Urine/serum)
GAHCG-201b	TEST RAPID	Orient Gene	One step pregnancy test strip (Urine/serum)
GAHCG-202b	TEST RAPID	Orient Gene	One step pregnancy test cassette (Urine/serum)
GCHAV(IgM)-302Ba	TEST RAPID	Orient Gene	HAV IgM Rapid Test Cassette (Serum/plasma)
GCHAV-602a	TEST RAPID	Orient Gene	HAV Ag Rapid Test Cassette (Feces)

地址：浙江省湖州市安吉县递铺镇阳光大道东段 3787 号

Add: 3787#, East Yangguang Avenue, Dipu Street Anji 313300, Huzhou, Zhejiang, China

电话 Tel:+86-572-5226111 传真 Fax: +86-572-5226222 邮编 P.C.:313300



浙江东方基因生物制品股份有限公司

Zhejiang Orient Gene Biotech Co.,LTD

GCHAV(IgG/IgM) -302a	TEST RAPID	Orient Gene	HAV IgG/IgM Rapid Test Cassette (Serum/plasma)
GCHSV(IgG)-402a	TEST RAPID	Orient Gene	HSV IgG Rapid Test Cassette (Whole blood/serum/plasma)
GCHSV(IgM)-302a	TEST RAPID	Orient Gene	HSV IgM Rapid test Cassette (serum/plasma)
GCHP-601a	TEST RAPID	Orient Gene	H.pylori Ag Rapid Test Strip (feces)
GCHP-602a	TEST RAPID	Orient Gene	H.pylori Ag Rapid Test Cassette(feces)
GCTB-302a	TEST RAPID	Orient Gene	Tuberculosis IgG/IgM Rapid Test Cassette (serum/plasma)
GCTB-402a	TEST RAPID	Orient Gene	Tuberculosis IgG/IgM Rapid Test Cassette (whole blood/serum/plasma)
GCFLU(A/B)-501a	TEST RAPID	Orient Gene	Influenza A&B Ag Rapid Test Strip (Swab)
GCFLU(A/B)-502a	TEST RAPID	Orient Gene	Influenza A&B Ag Rapid Test Cassette (Swab)
GCFLU(A/B)-502Ca	TEST RAPID	Orient Gene	Influenza A&B Ag Rapid Test Cassette (Swab)
GCFLU(A)-501a	TEST RAPID	Orient Gene	Influenza A Ag Rapid Test Strip (Swab)
GCFLU(A)-502a	TEST RAPID	Orient Gene	Influenza A Ag Rapid Test Cassette (Swab)
GCHP-301a	TEST RAPID	Orient Gene	H.Pylori Ab Rapid Test Strip (serum/plasma)
GCHP-302a	TEST RAPID	Orient Gene	H.pylori Ab Rapid Test Cassette (serum/plasma)
GCHP-401a	TEST RAPID	Orient Gene	H.pylori Ab Rapid Test Strip (Whole blood/serum/plasma)
GCHP-402a	TEST RAPID	Orient Gene	H.pylori Ab Rapid Test Cassette (Whole blood/serum/plasma)
GCCA-502a	TEST RAPID	Orient Gene	Candida albicans Antigen rapid test cassette (swab)
GCGON-502b	TEST RAPID	Orient Gene	Gonorrhea Rapid Test Cassette (Swab)
GCGIA-602a	TEST RAPID	Orient Gene	Giardia lamblia Antigen Rapid tests cassette (feces)

地址：浙江省湖州市安吉县递铺镇阳光大道东段 3787 号

Add: 3787#, East Yangguang Avenue, Dipu Street Anji 313300, Huzhou, Zhejiang, China

电话 Tel:+86-572-5226111 传真 Fax: +86-572-5226222 邮编 P.C.:313300



浙江东方基因生物制品股份有限公司
Zhejiang Orient Gene Biotech Co.,LTD

GCSTR-501a	TEST RAPID	Orient Gene	Strep A Rapid Test Strip (Throat swab)
GCSTR-502a	TEST RAPID	Orient Gene	Strep A Rapid Test Cassette (Throat swab)
GCFC-525a	TEST RAPID	Orient Gene	Rapid COVID-19 + Influenza Antigen Test
GCRSV-502a	TEST RAPID	Orient Gene	RSV Antigen Rapid Test Cassette (swab)
GCADE-502a	TEST RAPID	Orient Gene	Adenovirus antigen rapid test cassette (swab)
GCADE-602a	TEST RAPID	Orient Gene	Adenovirus Rapid test cassette (feces)
GCCD(GDH)-602a	TEST RAPID	Orient Gene	Clostridium difficile Antigen GDH Rapid Test cassette (feces)
GCCD (Toxin A/B)-602a	TEST RAPID	Orient Gene	Clostridium difficile Toxin A&B rapid test cassette (feces)
GCCD-602a	TEST RAPID	Orient Gene	Clostridium difficile GDH & Toxin A/B Rapid Test Cassette (Feces)
GCHSV (IgM)-402a	TEST RAPID	Orient Gene	HSV IgM Rapid test Cassette (whole blood/serum/plasma)
GCHSV(IgG)-302a	TEST RAPID	Orient Gene	HSV IgG Rapid Test Cassette (serum/plasma)
GCSYP-301a	TEST RAPID	Orient Gene	Syphilis Ab Rapid Test Strip (serum/plasma)
GCSYP-302a	TEST RAPID	Orient Gene	Syphilis Ab Rapid Test Cassette (serum/plasma)
GCSYP-401a	TEST RAPID	Orient Gene	Syphilis Ab Rapid test strip (whole blood/serum/plasma)
GCSYP-402a	TEST RAPID	Orient Gene	Syphilis Ab Rapid test cassette (whole blood/serum/plasma)
GBBAR-101a	TEST RAPID	Orient Gene	One Step Barbiturates Test Strip (Urine)
GBBAR-102a	TEST RAPID	Orient Gene	One Step Barbiturates Test Cassette (Urine)
GBAMP-101a	TEST RAPID	Orient Gene	One Step Amphetamine Test Strip (Urine)
GBAMP-102a	TEST RAPID	Orient Gene	One Step Amphetamine Test Cassette (Urine)
GBAMP-105a	TEST RAPID	Orient Gene	One Step Amphetamine Dip Card (Urine)

地址：浙江省湖州市安吉县递铺镇阳光大道东段 3787 号

Add: 3787#, East Yangguang Avenue, Dipu Street Anji 313300, Huzhou, Zhejiang, China

电话 Tel:+86-572-5226111 传真 Fax: +86-572-5226222 邮编 P.C.:313300



浙江东方基因生物制品股份有限公司
Zhejiang Orient Gene Biotech Co.,LTD

GBPPX-101a	TEST RAPID	Orient Gene	One Step Propoxyphene Test Strip (Urine)
GBPPX-102a	TEST RAPID	Orient Gene	One Step Propoxyphene Test Cassette (Urine)
GBDSA-XXXXFX	TEST RAPID	Orient Gene	Oral Fluid Drug test Cube
GBDSA-XXXXEX	TEST RAPID	Orient Gene	Oral Fluid Drug test
GBDSA-XXXXFSI	TEST RAPID	Orient Gene	Oral Fluid Drug test Cube
GBDSA-XXXXCX	TEST RAPID	Orient Gene	Oral Fluid Drug test cylinder
GBOPI-102a	TEST RAPID	Orient Gene	One Step Opiate Test Cassette (Urine)
GBOPI-101a	TEST RAPID	Orient Gene	One Step Opiate Test Strip (Urine)
GBETG-101b	TEST RAPID	Orient Gene	One Step Ethyl Glucoronide Test Strip (urine)
GBETG-102b	TEST RAPID	Orient Gene	One Step Ethyl Glucoronide Test Cassette (urine)
GBMOP-101a	TEST RAPID	Orient Gene	One step Morphine Test strip (urine)
GBMOP-102a	TEST RAPID	Orient Gene	One step Morphine Test Cassette (urine)
GBMOP-105a	TEST RAPID	Orient Gene	One step Morphine Test dip card (urine)
GBTHC-101a	TEST RAPID	Orient Gene	One Step Marijuana Test Strip (Urine)
GBTHC-102a	TEST RAPID	Orient Gene	One Step Marijuana Test Cassette (Urine)
GBTHC-105a	TEST RAPID	Orient Gene	One Step Marijuana Test Dip Card (Urine)
GBMTD-101a	TEST RAPID	Orient Gene	One step Methadone Test strip (urine)
GBMTD-102a	TEST RAPID	Orient Gene	One step Methadone Test cassette (urine)
GBXXX-101	TEST RAPID	Orient Gene	One Step Drugs of Abuse Test Strip (Urine)
GBXXX-102	TEST RAPID	Orient Gene	One Step Drugs of Abuse Test Cassette (Urine)
GBXXX-105	TEST RAPID	Orient Gene	One Step Drugs of Abuse Test Dip Card (Urine)

地址：浙江省湖州市安吉县递铺镇阳光大道东段 3787 号

Add: 3787#, East Yangguang Avenue, Dipu Street Anji 313300, Huzhou, Zhejiang, China

电话 Tel: +86-572-5226111 传真 Fax: +86-572-5226222 邮编 P.C.: 313300



浙江东方基因生物制品股份有限公司

Zhejiang Orient Gene Biotech Co.,LTD

GBDSA-XXXXJSI	TEST RAPID	Orient Gene	Oral fluid drug test cylinder
GBDSA-XXXXJX	TEST RAPID	Orient Gene	Oral fluid drug test cylinder
GBDSA-XXXXKX	TEST RAPID	Orient Gene	Oral fluid drug test cylinder
GBDSA-XXXXMX	TEST RAPID	Orient Gene	Oral fluid drug test device
GBDSA-XXXXA/B/G/H/I	TEST RAPID	Orient Gene	Multi-drug rapid screen test cassette (oral fluid)
GBMTC-101a	TEST RAPID	Orient Gene	One Step Methcathinone Test Strip (Urine)
GBMTC-102a	TEST RAPID	Orient Gene	One Step Methcathinone Test Cassette (Urine)
GBKRA-101a	TEST RAPID	Orient Gene	One step kratom test strip (urine)
GBKRA-102a	TEST RAPID	Orient Gene	One step kratom test cassette (urine)
GBLSD-101a	TEST RAPID	Orient Gene	One Step Lysergic Acid Diethylamide Test Strip (Urine)
GBLSD-102a	TEST RAPID	Orient Gene	One Step Lysergic Acid Diethylamide Test Cassette (Urine)
FBXXX-1102	TEST RAPID	Orient Gene	Hair Multi-drug rapid test kit
GBETG-105a	TEST RAPID	Orient Gene	One step ethyl glucuronide test dip card (urine)
GBPGB-102b	TEST RAPID	Orient Gene	One step pregabalin test cassette (urine)
GBTRA-101a	TEST RAPID	Orient Gene	One step tramadol test strip (urine)
GBTRA-102a	TEST RAPID	Orient Gene	One step tramadol test cassette (urine)
GBOXY-101a	TEST RAPID	Orient Gene	One step oxycodone Test strip (urine)
GBOXY-102a	TEST RAPID	Orient Gene	One step oxycodone Test cassette (urine)
GBMDP-101a	TEST RAPID	Orient Gene	One step 3,4-Methylenedioxypyrovalerone Test strip (urine)

地址：浙江省湖州市安吉县递铺镇阳光大道东段 3787 号

Add: 3787#, East Yangguang Avenue, Dipu Street Anji 313300, Huzhou, Zhejiang, China

电话 Tel:+86-572-5226111 传真 Fax: +86-572-5226222 邮编 P.C.:313300



浙江东方基因生物制品股份有限公司
Zhejiang Orient Gene Biotech Co.,LTD

GBMDP-101a	TEST RAPID	Orient Gene	One step 3,4-Methylenedioxypropylone Test cassette (urine)
GBMQL-102a	TEST RAPID	Orient Gene	One step Methaqualone Test cassette (urine)
GBMQL-101a	TEST RAPID	Orient Gene	One step Methaqualone Test strip (urine)
GBMPD-101a	TEST RAPID	Orient Gene	One step Methylphenidate Test strip (urine)
GBMPD-102a	TEST RAPID	Orient Gene	One step Methylphenidate Test cassette (urine)
GBUR-101a	TEST RAPID	Orient Gene	One step UR-144 test strip (urine)
GBUR-102a	TEST RAPID	Orient Gene	One step UR-144 test cassette (urine)
GBBUP-101a	TEST RAPID	Orient Gene	One step buprenorphine test strip (urine)
GBBUP-102a	TEST RAPID	Orient Gene	One step buprenorphine test cassette (urine)
GBPCP-101a	TEST RAPID	Orient Gene	One step Phencyclidine Test strip (urine)
GBPCP-102a	TEST RAPID	Orient Gene	One step Phencyclidine Test cassette (urine)
GBTCA-101a	TEST RAPID	Orient Gene	One step Tricyclic Antidepressants test strip (urine)
GBTCA-102a	TEST RAPID	Orient Gene	One step Tricyclic Antidepressants test cassette (urine)
GBEDD-101a	TEST RAPID	Orient Gene	One step EDDP test strip (urine)
GBEDD-102a	TEST RAPID	Orient Gene	One step EDDP test cassette (urine)
GBFEN-101b	TEST RAPID	Orient Gene	One step Fentanyl Test strip (urine)
GBFEN-102b	TEST RAPID	Orient Gene	One step Fentanyl Test cassette (urine)
GBALC-101a	TEST RAPID	Orient Gene	Urine Alcohol Test Strip
GBMAM-S102	TEST RAPID	Orient Gene	One step 6-MAM Test cassette (urine)

地址：浙江省湖州市安吉县递铺镇阳光大道东段 3787 号

Add: 3787#, East Yangguang Avenue, Dipu Street Anji 313300, Huzhou, Zhejiang, China

电话 Tel: +86-572-5226111 传真 Fax: +86-572-5226222 邮编 P.C.: 313300



浙江东方基因生物制品股份有限公司
Zhejiang Orient Gene Biotech Co.,LTD

GBMAM-S101	TEST RAPID	Orient Gene	One step 6-MAM Test cassette (urine)
GBHCD-101a	TEST RAPID	Orient Gene	One step Hydrocodone test strip (urine)
GBHCD-102a	TEST RAPID	Orient Gene	One step Hydrocodone test cassette (urine)
GBNFT-101c	TEST RAPID	Orient Gene	One step Norfentanyl test strip (urine)
GBNFT-102c	TEST RAPID	Orient Gene	One step Norfentanyl test cassette (urine)
GBXXX-1102	TEST RAPID	Orient Gene	Hair Multi-Drug Rapid Test Kit (ICA)
GBDSA-XXXXLX	TEST RAPID	Orient Gene	Oral Fluid Drug Test Mini Cube
GBDUA-1X4	TEST RAPID	Orient Gene	One Step Multi-Drug Screen Test Dip Card (urine)
GBDOA-1X5	TEST RAPID	Orient Gene	One Step Multi-Drug Screen Test Cassette (urine)
GBDUA-1X6	TEST RAPID	Orient Gene	One Step Multi-Drug Screen Test Cup (urine)
GBCOT-102a	TEST RAPID	Orient Gene	One step cotinine test cassette (urine)
GBK2-101a	TEST RAPID	Orient Gene	One step K2 Test strip (urine)
GBK2-102a	TEST RAPID	Orient Gene	One step K2 Test cassette (urine)
GBKET-101a	TEST RAPID	Orient Gene	One step Ketamine Test strip (urine)
GBKET-102a	TEST RAPID	Orient Gene	One step Ketamine Test cassette (urine)
GBBZO-101a	TEST RAPID	Orient Gene	One step Benzodiazepines Test Strip (urine)
GBBZO-102a	TEST RAPID	Orient Gene	One step Benzodiazepines Test Cassette (urine)
GBCOC-101a	TEST RAPID	Orient Gene	One step Cocaine Test strip (urine)
GBCOC-102a	TEST RAPID	Orient Gene	One step Cocaine Test cassette (urine)
GBCOC-105a	TEST RAPID	Orient Gene	One step Cocaine Test dip card (urine)
GBMDM-101a	TEST RAPID	Orient Gene	One step ecstasy Test strip (urine)

地址：浙江省湖州市安吉县递铺镇阳光大道东段 3787 号

Add: 3787#, East Yangguang Avenue, Dipu Street Anji 313300, Huzhou, Zhejiang, China

电话 Tel:+86-572-5226111 传真 Fax: +86-572-5226222 邮编 P.C.:313300



浙江东方基因生物制品股份有限公司
Zhejiang Orient Gene Biotech Co.,LTD

GBMDM-102a	TEST RAPID	Orient Gene	One step ecstasy Test cassette (urine)
GBMET-101a	TEST RAPID	Orient Gene	One step Methamphetamine test strip (urine)
GBMET-102a	TEST RAPID	Orient Gene	One step Methamphetamine test cassette (urine)
GBMET-105a	TEST RAPID	Orient Gene	One step Methamphetamine test dip card (urine)
GCTOXI(IgG/IgM)-302a	TEST RAPID	Orient Gene	Toxoplasma gondii test cassette (serum/plasma)
GCTOXI(IgG)-302a	TEST RAPID	Orient Gene	Toxoplasma gondii IgG test cassette (serum/plasma)
GCTOXI(IgM)-302a	TEST RAPID	Orient Gene	Toxoplasma gondii IgM test cassette (serum/plasma)
GCCHL-502a	TEST RAPID	Orient Gene	Chlamydia Trachomatis Antigen test cassette (swab/urine)
GEPSA-402a	TEST RAPID	Orient Gene	Prostate specific antigen test cassette (whole blood/serum/plasma)
GEPSA-401a	TEST RAPID	Orient Gene	Prostate specific antigen test strip (whole blood/serum/plasma)
GEPSA-302a	TEST RAPID	Orient Gene	Prostate specific antigen test cassette (serum/plasma)
GEPSA-301a	TEST RAPID	Orient Gene	Prostate specific antigen test strip (serum/plasma)
GALH-101a-1T	TEST RAPID	Orient Gene	LH Ovulation Test Strip
GALH-101a-5T	TEST RAPID	Orient Gene	LH Ovulation Test Strip
GALH-101a-7T	TEST RAPID	Orient Gene	LH Ovulation Test Strip
GALH-101b-1T	TEST RAPID	Orient Gene	LH Ovulation Test Strip
GALH-101b-5T	TEST RAPID	Orient Gene	LH Ovulation Test Strip
GALH-101b-7T	TEST RAPID	Orient Gene	LH Ovulation Test Strip
GALH-102a-1T	TEST RAPID	Orient Gene	LH Ovulation Test Cassette
GALH-102a-5T	TEST RAPID	Orient Gene	LH Ovulation Test Cassette
GALH-102a-7T	TEST RAPID	Orient Gene	LH Ovulation Test Cassette
GALH-102b-5T	TEST RAPID	Orient Gene	LH Ovulation Test Cassette
GALH-102b-1T	TEST RAPID	Orient Gene	LH Ovulation Test Cassette

地址：浙江省湖州市安吉县递铺镇阳光大道东段 3787 号

Add: 3787#, East Yangguang Avenue, Dipu Street Anji 313300, Huzhou, Zhejiang, China

电话 Tel:+86-572-5226111 传真 Fax: +86-572-5226222 邮编 P.C.:313300



浙江东方基因生物制品股份有限公司
Zhejiang Orient Gene Biotech Co.,LTD

GALH-102b-7T	TEST RAPID	Orient Gene	LH Ovulation Test Cassette
--------------	------------	-------------	----------------------------

VPH-502a	TEST RAPID	Orient Gene	Vaginal pH test cassette (Vaginal secretions)
----------	------------	-------------	---

URS-1T to 14T with various combination	STRIPURI DE URINA	Orient Gene	LEU/NIT/URO/MA/PRO/PH/BLO/S G/ASC/CRE/KET/BIL/GLU/CA
GCHCV-302a	TEST RAPID	Orient Gene	HCV Hepatitis C Virus Rapid Test (serum/plasma) cassette
GCHCV-402a	TEST RAPID	Orient Gene	HCV Hepatitis C Virus Rapid Test (whole blood/serum/plasma) cassette
GCHIV-302a	TEST RAPID	Orient gene	HIV 1/2 Human Immunodeficiency Virus (Serum/Plasma) cassette
GCHIV-402a	TEST RAPID	Orient gene	HIV 1/2 Human Immunodeficiency Virus (Whole blood/serum/plasma)cassette
GCHBsg-302a	TEST RAPID	Orient gene	HBsAg Hepatitis B Surface Antigen Rapid Test (Serum/Plasma)
GCHBsg-402a	TEST RAPID	Orient gene	HBsAg Hepatitis B Surface Antigen Rapid Test(Whole Blood/Serum/Plasma)

The end.



地址：浙江省湖州市安吉县递铺镇阳光大道东段 3787 号
Add: 3787#, East Yangguang Avenue, Dipu Street Anji 313300, Huzhou, Zhejiang, China
电话 Tel:+86-572-5226111 传真 Fax: +86-572-5226222 邮编 P.C.:313300



Certificate

No. Q5 092305 0001 Rev. 02

Holder of Certificate: **Zhejiang Orient Gene Biotech Co., Ltd.**
3787#, East Yangguang Avenue, Dipu Street Anji
313300 Huzhou, Zhejiang
PEOPLE'S REPUBLIC OF CHINA

Certification Mark:



Scope of Certificate: **Design and Development, Production and Distribution of In Vitro Diagnostic Reagent and Instrument for the Detection of Drugs of Abuse, Fertility, Infectious Diseases, Oncology, Biochemistry, Cardiac Diseases, Allergic Disease based on Rapid Test, PCR and Liquid Biochip Method.**

The Certification Body of TÜV SÜD Product Service GmbH certifies that the company mentioned above has established and is maintaining a quality management system, which meets the requirements of the listed standard(s). All applicable requirements of the testing and certification regulation of TÜV SÜD Group have to be complied with. For details and certificate validity see: www.tuvsud.com/ps-cert?q=cert:Q5 092305 0001 Rev. 02

Report No.: SH2398804

Valid from: 2024-03-17

Valid until: 2027-03-16

Date, 2024-03-01

Christoph Dicks
Head of Certification/Notified Body

Certificate

No. Q5 092305 0001 Rev. 02

Applied Standard(s): ISO 13485:2016
(EN ISO 13485:2016/AC:2018, EN ISO 13485:2016/A11:2021)
Medical devices - Quality management systems -
Requirements for regulatory purposes

Facility(ies): **Zhejiang Orient Gene Biotech Co., Ltd.**
3787#, East Yangguang Avenue, Dipu Street Anji, 313300
Huzhou, Zhejiang, PEOPLE'S REPUBLIC OF CHINA

See Scope of Certificate



浙江东方基因生物制品股份有限公司
Zhejiang Orient Gene Biotech Co., LTD



CE-DOC-OG060
Version 1.0

EC Declaration of Conformity

In accordance with Directive 98/79/EC

Legal Manufacturer: *Zhejiang Orient Gene Biotech Co., Ltd*

Legal Manufacturer Address: *3787#, East Yangguang Avenue, Dipu Street,
Anji 313300, Huzhou, Zhejiang, China*

Declares, that the products
Product Name and Model(s)

Fecal Occult Blood Rapid Test Strip (Feces)	GEFOB-601b
Fecal Occult Blood Rapid Test Cassette (Feces)	GEFOB-602b

Classification: *Other*
Conformity assessment route: *Annex III (EC DECLARATION OF CONFORMITY)*

We, the Manufacturer, herewith declare with sole responsibility that our product/s mentioned above meet/s the provisions of the Directive 98/79/EC of the European Parliament and of the Council on In-Vitro Diagnostic Medical Devices.

We hereby explicitly appoint

EC Representative's Name: *Shanghai International Holding Corp. GmbH (Europe)*

EC Representative's Address: *Eiffestrasse 80, 20537 Hamburg, Germany*

to act as our European Authorized Representative as defined in the aforementioned Directive.

I, the undersigned, hereby declare that the medical devices specified above conform with the directive 98/79/EC on in vitro diagnostic medical devices and pertinent essential requirements

Date Signed: November 28, 2017

Name of authorized signatory: *Joyce Pang*
Position held in the company: *Vice-President*

Fecal Occult Blood Rapid Test Cassette (Feces)



INTENDED USE

Fecal Occult Blood Rapid Test Cassette (Feces) is a rapid chromatographic immunoassay for the qualitative detection of human occult blood in feces by professional laboratories or physician's offices. It is useful to detect bleeding caused by a number of gastrointestinal disorders, e.g., diverticulitis, colitis, polyps, and colorectal cancer.

Fecal Occult Blood Rapid Test Cassette (Feces) is recommended for use in 1) routine physical examinations, 2) hospital monitoring for bleeding in patients, and 3) screening for colorectal cancer or gastrointestinal bleeding from any source.

INTRODUCTION

Most of diseases can cause hidden blood in the stool. In the early stages, gastrointestinal problems such as colon cancer, ulcers, polyps, colitis, diverticulitis, and fissures may not show any visible symptoms, only occult blood. Traditional guaiac-based method lacks sensitivity and specificity, and has diet-restriction prior to the testing.

Fecal Occult Blood Rapid Test Cassette (Feces) is a rapid test to qualitatively detect low levels of fecal occult blood in feces. The test uses double antibody-sandwich assay to selectively detect as low as 50 ng/mL of hemoglobin or 6 µg hemoglobin/g feces. In addition, unlike the guaiac assays, the accuracy of the test is not affected by the diet of the patients.

PRINCIPLE

Fecal Occult Blood Rapid Test Cassette (Feces) is a lateral flow chromatographic immunoassay based on the principle of the double antibody-sandwich technique. The membrane is pre-coated with anti-hemoglobin antibodies on the test line region of the device. During testing, the specimen reacts with the colloidal gold coated with anti-hemoglobin antibodies. The mixture migrates upward on the membrane chromatographically by capillary action to react with anti-hemoglobin antibodies on the membrane and generate a colored line. The presence of this colored line in the test region indicates a positive result, while its absence indicates a negative result. To serve as a procedural control, a colored line will always appear in the control line region indicating that proper volume of specimen has been added and membrane wicking has occurred.

MATERIALS PROVIDED

20 Test cassettes
20 Specimen collection tubes with buffer
1 Package insert

MATERIALS REQUIRED BUT NOT PROVIDED

1. Specimen collection containers 2. Clock or timer

STORAGE AND STABILITY

All reagents are ready to use as supplied. Store unused test device unopened at 2°C-30°C. If stored at 2°C-8°C, ensure that the test device is brought to room temperature before opening. The test is not stable out of the expiration date printed on the sealed pouch. Do not freeze the kit or expose the kit over 30°C.

PRECAUTIONS

1. For professional *in vitro* diagnostic use only.
2. This package insert must be read completely before performing the test. Failure to follow the insert gives inaccurate test results.
3. Do not use it if the tube/pouch is damaged or broken.
4. Test is for single use only. Do not re-use under any circumstances.
5. **Do not use specimen with visible blood for the testing.**
6. Handle all specimens as if they contain infectious agents. Observe established standard procedure for proper disposal of specimens.
7. Specimen extraction buffer contains Sodium Azide (0.1%). Avoid contact with skin or eyes. Do not ingest.
8. Wear protective clothing such as laboratory coats, disposable gloves and eye protection when specimens are assayed.
9. Humidity and temperature can adversely affect results.
10. Do not perform the test in a room with strong air flow, i.e. electric fan or strong air conditioning.

PATIENT PREPARATION

1. A specimen should not be collected from a patient with following conditions that may interfere with the test results:

- Menstrual bleeding
 - Bleeding hemorrhoids
 - Constipating bleeding
 - Urinary bleeding.
2. Dietary restrictions are not necessary.
 3. Alcohol and certain medications such as aspirin, indomethacin, phenylbutazone, reserpine, corticosteroids, and nonsteroidal anti-inflammatory drugs may cause gastrointestinal irritation and subsequent bleeding, thus gives positive reactions. On the advice of the physician, such substances should be discontinued at least 48 hours prior to testing.

SPECIMEN COLLECTION AND PREPARATION

Consider any materials of human origin as infectious and handle them using standard biosafety procedures.

1. Collect a random sample of feces in a clean, dry receptacle.
2. Unscrew the top of the collection tube and remove the applicator stick.
3. Randomly pierce the fecal specimen in at least five (5) different sites.
4. Remove excess sample off the shaft and outer grooves. Be sure sample remains on inside grooves.
5. Replace the stick in the tube and tighten securely.
6. Shake the specimen collection bottle so that there is proper homogenisation of feces in buffer solution.

Note: Specimens prepared in the specimen collection tube may be stored at room temperature (15-30°C) for 3 days maximum, at 2-8°C for 7 days maximum or at -20°C for 3 months maximum if not tested within 1 hour after preparation.

TEST PROCEDURE

Allow the test cassette, specimen, and/or controls to reach room temperature (15-30°C) prior to testing.

1. Remove the test cassette from the foil pouch and use it as soon as possible. Best results will be obtained if the assay is performed within one hour.
2. Place the test cassette on a clean, flat surface.
3. Shake the specimen collection tube several times.
4. Hold the specimen collection tube upright and then unscrew and open the upper cap.
5. Squeeze 3 drops (~90 µL) of the sample solution in the sample well of the cassette and start the timer.
6. Wait for the colored line(s) to appear. Read results in 5 minutes. Do not interpret the result after 5 minutes.

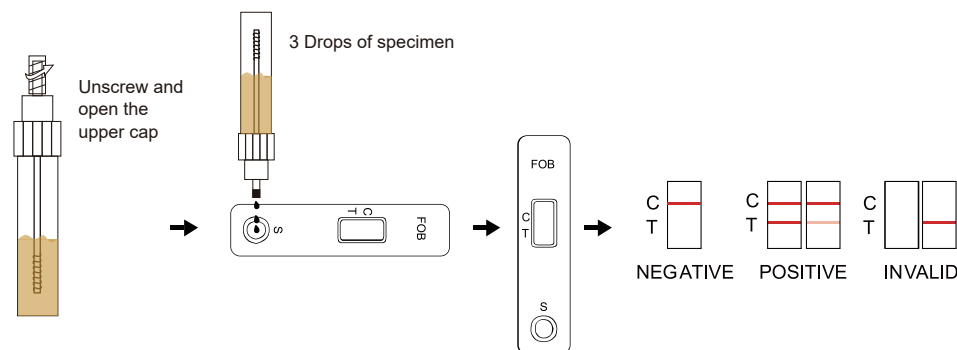

INTERPRETATION OF RESULTS

(Please refer to the illustration above)

Positive: Two lines appear. One colored line should be in the control line region (C) and another apparent colored line should be in the test line region (T).

Negative: One colored line appears in the control line region (C). No line appears in the test line region (T).

Invalid: Control line fails to appear. The test should be repeated using a new cassette. If the problem persists, discontinue using the test kit immediately and contact your local distributor.

NOTE:

1. The intensity of color in the test region (T) may vary depending on the concentration of analytes present in the specimen. Therefore, any shade of color in the test region should be considered positive. Note that this is a qualitative test only, and

Fecal Occult Blood Rapid Test Cassette (Feces)

cannot determine the concentration of analytes in the specimen.

2. Insufficient specimen volume, incorrect operating procedure or expired tests are the most likely reasons for control band failure.

QUALITY CONTROL

An internal procedural control is included in the test. A colored line appearing in the control line region (C) is an internal procedural control. It confirms sufficient specimen volume, adequate membrane wicking and correct procedural technique. Control standards are not supplied with this kit; however it is recommended that positive and negative controls be tested as a good laboratory practice to confirm the test procedure and to verify proper test performance.

LIMITATIONS

1. This test kit is to be used for the qualitative detection of human hemoglobin in fecal samples. A positive result suggests the presence of human hemoglobin in fecal samples. In addition to intestinal bleeding the presence of blood in stools may have other causes such as hemorrhoids, blood in urine etc.
2. Not all colorectal bleedings are due to precancerous or cancerous polyps. The information obtained by this test should be used in conjunction with other clinical findings and testing methods, such as colonoscopy gathered by the physician.
3. Negative results do not exclude bleeding since some polyps and colorectal region cancers can bleed intermittently or not at all. Additionally, blood may not be uniformly distributed in fecal samples. Colorectal polyps at an early stage may not bleed.
4. Urine and excessive dilution of sample with water from toilet bowl may cause erroneous test results. The use of a receptacle is recommended.
5. Feces specimens should not collect during the menstrual period and not three day before or afterwards, at bleeding due to constipation, bleeding haemorrhoids, or at taking rectally administered medication. It could cause false positive results.
6. This test may be less sensitive for detecting upper g.i. Bleeding because blood degrades as it passes through the g.i. Track.
7. The Fecal Occult Blood Rapid Test Cassette (Feces) is to aid indagnosis and is not intended to replace other diagnostic procedures such as G.I. fibroscope, endoscopy, colonoscopy, or X-ray analysis. Test results should not be deemed conclusive with respect to the presence or absence of gastrointestinal bleeding or pathology. A positive result should be followed up with additional diagnostic procedures to determine the exact cause and source for the occult blood in the feces.

PERFORMANCE CHARACTERISTICS

1. Sensitivity: 99.6%

Fecal Occult Blood Rapid Test Cassette (Feces) can detect the levels of human occult blood as low as 50 ng/mL hemoglobin or 6 µg hemoglobin/g feces.

2. Prozone Effect:

It is observed that this FOB test can detect 2 mg/mL hemoglobin.

3. Specificity: 99.9%

Fecal Occult Blood Rapid Test Cassette (Feces) is specific to human hemoglobin. Specimen containing the following substances at the standard concentration was tested on both positive and negative controls and showed no effects on test results at standards concentration.

Substances	Concentrations (Diluted with the extraction buffer)
Beef hemoglobin	2 mg/mL
Chicken hemoglobin	0.5 mg/mL
Pig hemoglobin	0.5 mg/mL
Goat hemoglobin	0.5 mg/mL
Horse hemoglobin	20 mg/mL
Rabbit hemoglobin	0.06 mg/mL

REFERENCES

1. Simon J.B. Occult Blood Screening for Colorectal Carcinoma: A Critical Review, Gastroenterology, Vol. 1985;88:820.
2. Blebea J. and Ncpherson RA. False-Positive Guaiac Testing With Iodine, Arch Pathol Lab Med, 1985;109:437-40.

INDEX OF SYMBOLS

	Consult instructions for use		Tests per kit		Authorized Representative
	For <i>in vitro</i> diagnostic use only		Use by		Do not reuse
	Store between 2~30°C		Lot Number		Catalog#

Zhejiang Orient Gene Biotech Co.,Ltd
Address: 3787#, East Yangguang Avenue, Dipu Street,
Anji 313300, Huzhou, Zhejiang, China
Tel: +86-572-5226111 Fax: +86-572-5226222
Website: www.orientgene.com

Shanghai International Holding Corp. GmbH (Europe)
Add: Eiffestrasse 80, 20537 Hamburg, Germany

GEFOB-602b