

**PRE-INSTALLATION /SITE PREPARATION**  
**IMPORTANT - MUST BE READ BEFORE INSTALLATION!**

The following preparations must be completed before we can install the MACS 700.

- Please plan ahead for the transport of the machine from unloading to indoor transport as this machine weighs 4400 kgs.
- Please use a lift truck with minimum 6 tons capacity. There are mounted rails under the machine for transport by a lift truck.
- Check your elevator for dimensions and weight capacity.
- Move the machine on a flat surface on its wheels. Do not move the machine on its wheels downhill - you will never bring it to a stop manually!
  
- Please refer to the instruction manual section 5.3 (Installation & Commissioning) for more details.
  
- **The dimensions of the machine are:**  
**length 2,800 m x width 1,850 m x height 2,850 m.**
- Floor load is approx. 1000 kgs per sqm.
- Have 2-3 people ready for help and transport. They must wear safety shoes.
  
- Prepare a 3/4" water connection with pressure min 4.5 bar
- Prepare a sewage connection 2" freely drain", so drainage is at floor-level.
- The electric installation must be in accordance with the operating manual (section 3.6 - Connection and consumption data).
- Power supply voltage 3 x 400 V / PEN, + / -10% AC, 50 Hz mains frequency, + / -2%
- Preliminary Fuse 160 A, power supply > = 50 mm<sup>2</sup> Cu, > = 25 mm<sup>2</sup> Cu PEN
  
- The unit should be working exclusively in a closed room. Distance from the walls should be about 0,5 m for easy access for maintenance and repair work.
- See proposed attached layout, ceiling height should not be less than 3.75 m.
- Provide ventilation with minimum 6 air changes per hour.
- Air conditioning is not required if the system is in the basement, otherwise an air conditioner is recommended when installed at ground level or higher (1 or more floors).
- Have metric tools for connection - pipe wrench, water pump pliers, electrician tools for connecting electrical wiring.
  
- Drawings with proposal and sizes needed are below.

# MACS

Machine Autoclave  
Cutting Sterilization

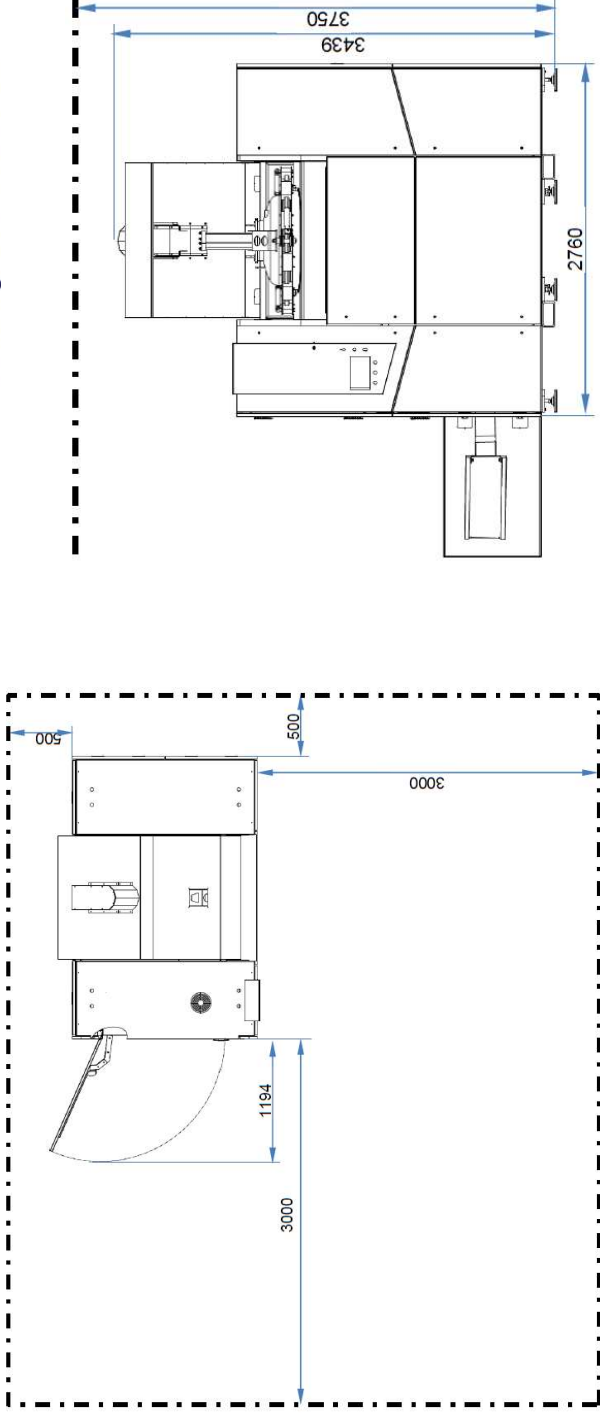

We ask that you please confirm all is done via written reply (e-mail) before departure of the technical engineer. This will avoid the purchaser having to pay any delay expenses such as flight changes, additional traveling days, etc., caused by inadequate preparation. Thank you!

**ERMAFA Environmental Technologies GmbH**  
Reiniggasse 12/13, 1010 Wien  
www.macs-solution.com

**Kontakt**  
T: +43 66488862500  
E: macs@ermafa.at

**Firmeninformationen**  
HG Wien | FN: 487982  
UID: ATU73627514

**Bankverbindung**  
IBAN: AT641500004381022195  
BIC: OBKUAL2L