

# imageRUNNER ADVANCE C3500 III series

## COMPACT COLOUR A3 MULTIFUNCTIONAL WITH POWERFUL END-TO-END DOCUMENT CAPABILITIES



Canon uniFLOW Online  
Outstanding Cloud Duplex/Management Solution



Canon imageRUNNER ADVANCE C3500i  
Outstanding 35 ppm Colour Copier MFP



### MAIN CONFIGURATION OPTIONS

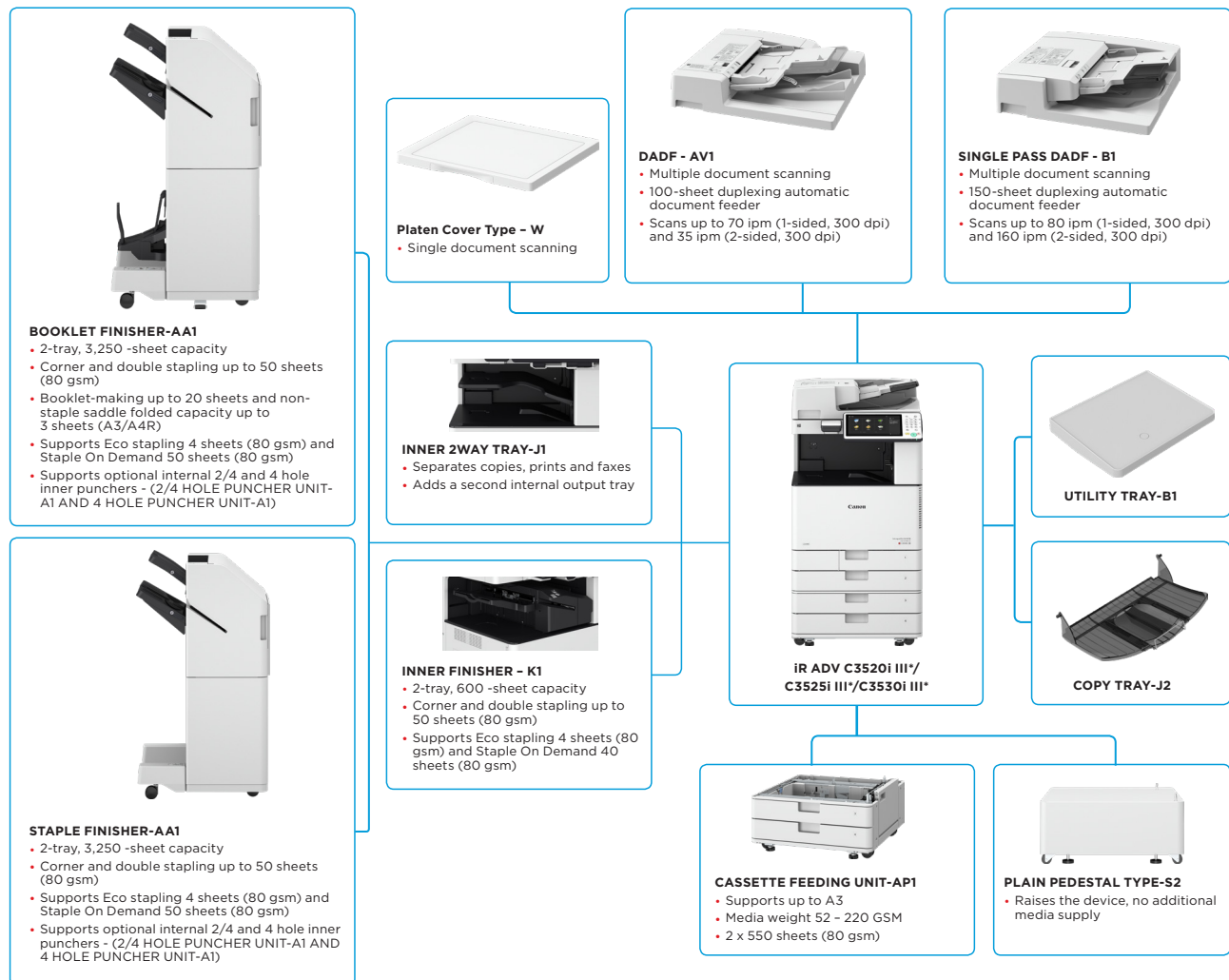

This flat configuration is for illustration purpose only. For a complete list of options and the exact compatibility relationships, please refer to the online product configurator.

III\* indicates that this model has been upgraded to new system software and includes additional security features as standard.

# TECHNICAL SPECIFICATIONS

# imageRUNNER ADVANCE C3500 III series

## MAIN UNIT

<b>Machine type</b>	A3 Colour Laser Multifunctional
<b>Core functions</b>	Print, Copy, Scan, Send, Store and Optional Fax
<b>Processor</b>	Canon Dual Custom Processor (Shared)
<b>Control Panel</b>	25.6 cm (10.1 inch) TFT LCD WSVGA Colour Touch panel
<b>Memory</b>	Standard: 3.0GB RAM
<b>Hard Disk drive</b>	Standard: 250GB, Maximum: 1TB
<b>Interface Connection</b>	<p>NETWORK</p> <p>Standard: 1000Base-T/100Base-TX/10Base-T, Wireless LAN (IEEE 802.11 b/g/n);</p> <p>Optional: NFC, Bluetooth Low Energy</p> <p>OTHERS</p> <p>Standard: USB 2.0 (Host) x1, USB 3.0 (Host) x1, USB 2.0 (Device) x1;</p> <p>Optional: Serial Interface, Copy Control Interface</p>
<b>Paper Supply Capacity (A4, 80gsm)</b>	<p>Standard: 1200 sheets</p> <p>2 x 550-sheet cassettes, 100-sheet multi-purpose tray</p> <p>Maximum: 2,300 sheets (with CASSETTE FEEDING UNIT-AP1)</p>
<b>Paper output capacity (A4, 80gsm)</b>	<p>Standard: 250 sheets</p> <p>Maximum: 3,450 sheets (with External Finisher and copy tray)</p>
<b>Finishing capabilities</b>	<p>Standard: Collate, Group</p> <p>With Inner Finisher : Collate, Group, Offset, Staple, Staple-Free Staple, Staple On Demand</p> <p>With External Finisher : Collate, Group, Offset, Staple, Booklet*1, Hole Punch*2, Staple-Free, Staple On Demand</p> <p>*Requires Booklet Finisher-AA1 only</p> <p>*Requires 2/4 Hole Puncher Unit-A1 or 4 Hole Puncher Unit-A1</p>
<b>Supported media types</b>	<p>Paper Cassettes (1/2): Thin, Plain, Recycled, Thick, Colour, Transparency, Pre-punched, Bond, Envelope</p> <p>Multi-purpose tray: Thin, Plain, Recycled, Thick, Colour, Transparency, Label, Tracing*, Envelope, Coated, Bond, Pre-punched</p> <p>*Some types of tracing paper cannot be used.</p>
<b>Supported media sizes</b>	<p>Paper Cassette 1:</p> <p>Standard size: A4, A5, A5R, A6R*, B5, Envelopes: ISO-C5</p> <p>Custom Size: 105.0 x 148.0 mm to 297.0 x 215.9 mm</p> <p>Paper Cassette 2:</p> <p>Standard size: A3, A4, A4R, A5, A5R, A6R*, B4, B5, B5R, Envelopes: No.10 (COM10), Monarch, DL</p> <p>Custom Size: 105.0 x 148.0 mm to 304.8 x 457.2 mm</p> <p>Multi-purpose tray:</p> <p>Standard size: SRA3, A3, A4, A4R, A5, A5R, A6R*, B4, B5, B5R Envelopes: No.10 (COM10), Monarch, ISO-C5, DL</p> <p>Custom size: 98.4 x 139.7 mm to 320.0 x 457.2 mm</p> <p>Free size: 98.4 x 139.7 mm to 320.0 x 457.2 mm</p> <p>Envelope custom size: 98.0 x 98.0 mm to 320.0 x 457.2 mm</p> <p>* (Simplex only)</p>
<b>Supported media weights</b>	<p>Paper Cassettes (1/2): 52 to 220 gsm</p> <p>Multi-purpose tray: 52 to 300 gsm*</p> <p>*Thick (257 to 300 gsm): Standard format paper size (excl. SRA3), and Custom size/Free size (98.4 x 139.7mm to 304.8 x 457.2 mm) are supported.</p> <p>Coated is supported from 106 to 256 gsm.</p> <p>Duplex: 52 to 220 gsm</p>
<b>Warm-up Time</b>	<p>From Power On: 10 seconds or less*</p> <p>*Time from device power-on, until copy ready (not print reservation)</p> <p>From Sleep Mode: 10 seconds or Less</p> <p>Quick Startup Mode: 4 seconds or less*</p> <p>*Time from device power-on to when key operation can be performed on the touch panel display.</p>
<b>Dimensions ( W x D x H )</b>	<p>Standard with platen cover: 565 x 707 x 777 mm</p> <p>With Single Pass DADF-B1: 565 x 742 x 900 mm</p> <p>With DADF-AV1: 565 x 736 x 880 mm</p>
<b>Installation Space(W x D)</b>	<p>Basic:</p> <p>978 x 1,123 mm (with Single Pass DADF-B1 + right cover open + Multi-purpose tray extension extended + paper cassette open)</p> <p>978 x 1,117 mm (with DADF-AV1 + right cover open + Multi-purpose tray extension extended + Paper cassette open)</p> <p>Fully Configured:</p> <p>1,620 x 1,123 mm (with Single Pass DADF-B1 + Booklet Finisher-AA1/Staple Finisher-AA1 + right cover open + Multi-purpose tray extension extended + paper cassette open)</p> <p>1,620 x 1,117 mm (with DADF-AV1 + Booklet Finisher-AA1/Staple Finisher-AA1 + right cover open + Multi-purpose tray extension extended + paper cassette open)</p>
<b>Weight</b>	<p>Approx. 69 kg including toner (with Platen Cover Type W)</p> <p>Approx. 76 kg including toner (with DADF-AV1)</p> <p>Approx. 81 kg including toner (with SINGLE PASS DADF-B1)</p>

## PRINT SPECIFICATIONS

<b>Print Speed (BW/CL)</b>	<p>iR-ADV C3530i III</p> <p>30 ppm (A4), 15 ppm (A3), 20 ppm (A4R), 30 ppm (A5R/A5/A6R)</p> <p>iR-ADV C3525i III</p> <p>25 ppm (A4), 15 ppm (A3), 20 ppm (A4R), 25 ppm (A5R/A5/A6R)</p> <p>iR-ADV C3520i III</p> <p>20 ppm (A4), 15 ppm (A3), 20 ppm (A4R), 20 ppm (A5R/A5/A6R)</p>
<b>Print Resolution (dpi)</b>	600 × 600, 1200 × 1200
<b>Page description languages</b>	Standard: UFR II, PCL 6, Genuine Adobe PostScript Level 3
<b>Direct Print</b>	Direct printing available from USB memory, Advanced Space, Remote UI and Web Access*
<b>Printing from mobile and cloud</b>	<p>Supported file types: TIFF, JPEG, PDF, EPS, and XPS</p> <p>*Only PDF print from websites is supported</p> <p>AirPrint, Mopria, Google Cloud Print, and Canon PRINT Business, and uniFLOW Online</p> <p>A range of software and MEAP-based solutions are available to provide printing from mobile devices or internet-connected devices and cloud-based services depending on your requirements.</p> <p>Please contact your sales representative for further information</p>
<b>Fonts</b>	<p>PCL fonts: 93 Roman, 10 Bitmap fonts, 2 OCR fonts, Andale Mono WT J/K/S/T*1 (Japanese, Korean, Simplified and Traditional Chinese), Barcode fonts*2</p> <p>PS fonts: 136 Roman</p> <p>*Requires optional PCL International Font Set-A1</p> <p>**Requires optional Barcode Printing Kit-D1</p>
<b>Print Features</b>	Suspend Job Timeout, Profile Settings, Secured Print, Watermark, Header/Footer, Page Layout, Two-sided Printing, Collating, Booklet Printing, Grouping, Mixed Paper Sizes/ Orientations, Offsetting, Front/Back Covers, Toner Reduction, Poster Printing, Forced Hold Printing
<b>Operating System</b>	<p>UFR II: Windows 7 / 8.1 / 10 / Server 2008 / Server 2008 R2 / Server 2012 / Server 2012 R2 / Server 2016, MAC OS X (10.7 or later)</p> <p>PCL: Windows 7 / 8.1 / 10 / Server 2008 / Server 2008 R2 / Server 2012 / Server 2012 R2 / Server 2016</p> <p>PS: Windows 7 / 8.1 / 10 / Server 2008 / Server 2008 R2 / Server 2012 / Server 2012 R2 / Server 2016, MAC OS X (10.7 or later)</p> <p>PPD: MAC OS X (10.7 or later), Windows 7 / 8.1/ 10</p> <p>McAfee Embedded Control Software</p>
<b>COPY SPECIFICATIONS</b>	
<b>Copy Speed (BW/CL)</b>	<p>iR-ADV C3530i III</p> <p>30 ppm (A4), 15 ppm (A3), 20 ppm (A4R), 30 ppm (A5R/A5/A6R)</p> <p>iR-ADV C3525i III</p> <p>25 ppm (A4), 15 ppm (A3), 20 ppm (A4R), 25 ppm (A5R/A5/A6R)</p> <p>iR-ADV C3520i III</p> <p>20 ppm (A4), 15 ppm (A3), 20 ppm (A4R), 20 ppm (A5R/A5/A6R)</p>
<b>First-Copy-Out Time (A4; BW/CL)</b>	Approx. 5.9/8.2 seconds or less
<b>Copy resolution (dpi)</b>	<p>Reading: 600 x 600</p> <p>Printing: Up to 2,400 equivalent × 600</p>
<b>Multiple Copies</b>	Up to 999 copies
<b>Copy Density</b>	Automatic or Manual (9 Levels)
<b>Magnification</b>	25% - 400% (1% Increments)
<b>Preset Reductions</b>	25%, 50%, 70 %
<b>Preset Enlargements</b>	141%, 200%, 400%
<b>Basic Copy Features</b>	Preset R/E Ratios by Area, Paper Setting, Previous Setting, Favourite Setting, Finishing, Two-Sided, Density Adjustment, Original Type Selection, Interrupt Mode, Setting Confirmation/Cancel
<b>Special Copy Features</b>	Book to Two Pages, Two-sided Original, Finishing, Booklet, Job Build, N on 1, Add Cover, Insert Sheets, Different Size Originals, Density Adjustment, Original Type Selection, Transparency Cover Sheets, Page Numbering, Copy Set Numbering, Sharpness, Erase Frame, Secure Watermark, Print Date, Shift, Gutter, Print & Check, Negative/Positive, Repeat Images, Job Done Notice, Mirror Image, Copy ID Card, Skip Blank Pages, Detect Feeder Multi Sheet Feed*, Free Size Original
	*Available with Single-pass Duplexing Automatic Document Feeder (DADF-A1)



# TECHNICAL SPECIFICATIONS

# imageRUNNER ADVANCE C3500 III series

## SCAN SPECIFICATION

Type	Standard: Colour Platen Optional: Platen cover, Single-pass Duplexing Automatic Document Feeder*(DADF-B1) or Duplexing Automatic Document Feeder (DADF-AV1) [2-sided to 2-sided (Automatic with DADF)] *Detect Feeder Multi Sheet Feed is supported.
Document Feeder Paper Capacity (80 gsm)	SINGLE PASS DADF-B1: 150 Sheets DADF-AV1: 100 Sheets
Acceptable Originals and weights	Platen: Sheet, Book, 3-Dimensional Objects (Height: Up to 50 mm, Weight: up to 2kg) Document Feeder media weight: SINGLE PASS DADF-B1: 1-sided scanning: 38 to 157 gsm (BW), 64 to 157 gsm (CL) 2-sided scanning: 50 to 157 gsm (BW), 64 to 157 gsm (CL) DADF-AV1: 1-sided scanning: 38 to 128 gsm (BW), 64 to 128 gsm (CL) 2-sided scanning: 50 to 128 gsm (BW), 64 to 128 gsm (CL)
Supported media sizes	Platen: max. scanning size: 297.0 x 431.8 mm SINGLE PASS DADF-B1: A3, A4, A4R, A5, A5R, B4, B5, B5R, B6R, Custom size: 128.0 x 139.7 mm to 304.8 x 431.8 mm DADF-AV1: A3, A4, A4R, A5, A5R, B4, B5, B5R, B6, Custom size: 139.7 x 128 mm to 297 x 431.8 mm
Scan Speed (ipm: BW/CL, A4)	SINGLE PASS DADF-B1: 1-sided Scanning: 80 /80 (300dpi), 51 /51 (600 dpi) 2-sided Scanning: 160 /160 (300dpi), 51 /51 (600 dpi) DADF-AV1: 1-sided Scanning: 70 /70 (300dpi), 51 /51 (600 dpi) 2-sided Scanning: 35 /35 (300dpi), 25.5 /25.5 (600 dpi)
Scan Resolution (dpi)	600 x 600, 400 x 400, 300 x 300, 200 x 400, 200 x 200, 200 x 100i, 150 x 150, 100 x 100
Pull Scan Specifications	Colour Network ScanGear2. For both TWAIN and WIA Supported OS: Windows 7/8.1/10 Windows Server 2008/Server 2008 R2/Server 2012/Server 2012 R2/Server 2016
Scan Method	Send functionality available on all models Scan to USB Memory Key: Available on all models Scan to Mobile Devices and cloud-based services: A range of solutions is available to provide scanning to mobile devices or cloud-based services depending on your requirements. Please contact your sales representative for further information. TWAIN/WIA Pull scanning available on all models
SEND SPECIFICATIONS	
Destination	E-mail/Internet FAX (SMTP), SMB v3.0, FTP, WebDAV, Mail Box, Super G3 FAX(Optional), IP Fax(Optional)
Address Book	LDAP (2,000)/Local (1,600)/Speed dial (200)
Send resolution (dpi)	600 x 600, 400 x 400, 300 x 300, 200 x 400, 200 x 200, 200 x 100, 150 x 150, 100 x 100
Communication protocol	File: FTP (TCP/IP), SMB v3.0, WebDAV E-mail/I-Fax: SMTP, POP3
File Format	Standard: TIFF, JPEG, PDF (Compact, Searchable, Apply policy, Optimize for Web, PDF A/1-b, Encrypted), XPS (Compact, Searchable), Office Open XML (PowerPoint, Word), PDF/XPS(Device Signature) Optional: PDF (Trace & Smooth), PDF/XPS(User Signature)
Universal Send Features	Original Type Selection, Two-sided Original, Book to Two Pages, Different-size Originals, Density Adjustment, Sharpness, Copy Ratio, Erase Frame, Job Build, Sender's Name (TTI), Delayed Send, Preview, Job Done Notice, File Name, Subject/Message, Reply-to, E-mail Priority, TX Report, Original Content Orientation, Skip Blank Pages, Detect Feeder Multi Sheet Feed* *Available with Single-pass Duplexing Automatic Document Feeder (DADF-A1)
FAX SPECIFICATIONS	
Maximum Number of Connection Lines	2
Modem Speed	Super G3: 33.6 kbps G3: 14.4 kbps
Compression Method	MH, MR, MMR, JBIG
Resolution (dpi)	400 x 400, 200 x 400, 200 x 200, 200 x 100
Sending/Recording Size	A3, A4, A4R, A5*, A5R*, B4, B5*, B5R* <sup>1</sup> *Sent as A4 **Sent as B4
FAX memory	Up to 30,000 pages
Speed dials	Max. 200
Group dials/destinations	Max. 199 dials
Sequential broadcast	Max. 256 addresses
Memory backup	Yes
Fax Features	Original Type Selection, Two-sided Original, Book to Two Pages, Different-size Originals, Density (for Scanning), Sharpness, Copy Ratio, Erase Frame, Job Build, Sender's Name (TTI), Selecting the Telephone Line, Direct Send, Delayed Send, Preview, Job Done Notice, TX Report, Detect Feeder Multi Sheet Feed* *Available with Single-pass Duplexing Automatic Document Feeder (DADF-A1)

## STORE SPECIFICATIONS

Mail Box (Number supported)	100 User Inboxes, 1 Memory RX Inbox, 50 Confidential Fax Inboxes, 30,000 Maximum Pages Stored
Advanced Space	Communication Protocol: SMB or WebDAV Supported Client PC: Windows (Windows7/8.1/10) Concurrent Connections (Max.): SMB: 64, WebDAV: 3 (Active Sessions)
Advanced Space available disc space	Approx. 16GB (Standard HDD) Approx. 480GB (with option 1TB HDD)
Advanced Space Features:	Authentication for Advanced Space Log-in, Sort Function, Printing a PDF File with a Password, imageWARE Secure Audit Manager Support
Memory Media	Standard: USB Memory

## SECURITY SPECIFICATIONS

Authentication	<b>Standard:</b> Universal Login Manager (Device and Function Level Log-in), uniFLOW Online Express*, User Authentication, Department ID Authentication, Access Management System <b>Optional:</b> My Print Anywhere secure print (Requires uniFLOW) *No charge for this solution; however activation is required. <b>Standard:</b> Trusted Platform Module (TPM), Hard Disk Password Lock, Hard Disk Drive Erase, Mail Box Password Protection, Hard Disk Drive Encryption(FIPS140-2 Validated), Common Criteria Certification (DIN ISO 15408) Optional: Hard Disk Drive removal, Data Loss Prevention (Requires uniFLOW)
Data	<b>Standard:</b> IP/Mac Address Filtering, IPSEC, TLS Encrypted Communication, SNMP V3.0, IEEE 802.1X, IPv6, SMTP Authentication, POP Authentication before SMTP, S/MIME
Network	<b>Standard:</b> Secure Print, Adobe LiveCycle® Rights Management ES2.5 Integration, Encrypted PDF, Encrypted Secure Print, Device signature, Secure Watermarks Optional: User signature, Document Scan lock
Document	

## ENVIRONMENTAL SPECIFICATIONS

Operating Environment	Temperature: 10 to 30 °C Humidity: 20 to 80 % RH (Relative Humidity)
Power source	220-240 V (±10 %), 50/60 Hz (±2 Hz), 4.0 Amp
Plug (Main Unit)	CEE 7/7 (230V)
Power consumption	Maximum: Approx. 1,500 W Printing: iR-ADV C3520i III: Approx. 477.4 W <sup>1</sup> iR-ADV C3525i III: Approx. 523.1 W <sup>1</sup> iR-ADV C3530i III: Approx. 533.0 W <sup>1</sup> Standby: Approx. 38.8 W <sup>1</sup> Sleep mode: Approx. 0.8 W <sup>2</sup> Plugin Off: Approx. 0.1W <sup>3</sup> *Reference value: measured one unit **0.8W sleep mode is not available in all circumstances due to certain settings. **Reference value, Quick startup mode OFF
Noise levels (BW/CL)	<b>Sound Power Level (LwAd)</b> Active(BW): iR-ADV C3520i III: 69.1 dB or Less*1, iR-ADV C3525i III: 70.2 dB or Less*1, iR-ADV C3530i III: 71.0 dB or Less*1 Active(CL): iR-ADV C3520i III: 69.1 dB or Less*1, iR-ADV C3525i III: 70.2 dB or Less*1, iR-ADV C3530i III: 71.0 dB or Less*1 Standby: 43 dB*2 <b>Sound Pressure (LpAm)</b> Bystander's position: Active(BW): iR-ADV C3520i III: 47 dB*2, iR-ADV C3525i III/ C3530i III: 48 dB*2 Active(CL): iR-ADV C3520i III/C3525i III: 48dB*2, iR-ADV C3530i III: 49 dB*2 (with Single Pass DADF- B1) iR-ADV C3520i III: 47 dB or Less*2, iR-ADV C3525i III: 48 dB or Less*2, iR-ADV C3530i III: 49 dB or Less*2 (with DADF-AV1) Standby: 10 dB or Less*2 *DE-UZ205 (2017) compliant *Data taken from Blue Angel Standard value) **Reference value: measured only one unit with IS07779, described with IS09296
Standards	Blue Angel

## CONSUMABLES

Toner Cartridges	C-EXV 49 TONER BK/C/M/Y
Toner (Estimated Yield @ 5% Coverage)	C-EXV 49 TONER BK: 36,000 pages C-EXV 49 TONER C/M/Y: 19,000 pages



# TECHNICAL SPECIFICATIONS

# imageRUNNER ADVANCE C3500 III series

## SOFTWARE AND PRINTER MANAGEMENT

### Tracking and reporting

**Universal Login Manager\* (ULM):** Manage your costs easily by using the embedded reporting capability to identify and control costs on a user-based level by device. uniFLOW Online Express: Combining with ULM you can gain further control and highlight expenditures per users/department and pinpoint where costs can be scaled down from a central cloud based location.  
\*Installation, activation & registration required

### Remote management tools

**iW Management Console:** Server-based software for centralised management of a fleet of devices (includes monitoring or consumables, status monitoring and alerts, distribution of address books, configuration settings, firmware and MEAP applications, meter capture and reporting, driver and resource management)  
**eMaintenance:** Compatible with eMaintenance services via embedded RDS (Enables meter capture, automatic consumables management, remote diagnostics and reporting for service providers to offer efficient, fast and proactive maintenance)  
**Content Delivery System:** Allows the Remote distribution of firmware, iR options and MEAP applications; Remote User Interface (RUI) Web based interface to each device that helps to provide remote device management and control

### Scanning software

**Network ScanGear:** TWAIN-compliant scanner driver that enables computers on a network to use the pull scan functionality of the device

## PAPER SUPPLY OPTIONS

### CASSETTE FEEDING UNIT-API

Paper Capacity: 550 sheets x 2 (1,100 sheets) (80 gsm)  
Paper Type: Thin, Plain, Recycled, Thick, Colour, Transparency, Bond, Pre-punched  
Paper Size: A3, A4, A4R, A5, A5R, A6R, B4, B5, B5R, Custom Size: 105.0 x 148.0 mm to 304.8 x 457.2 mm  
Paper Weight: 52 to 220 gsm  
Power Source: From the Main Unit  
Dimensions (W x D x H): 565 x 615 x 248 mm  
Weight: Approx. 16 kg

## OUTPUT OPTIONS

### COPY TRAY-J2

Capacity: 100 sheets (80 gsm)  
Dimensions (W x D x H): 444 x 373 x 176 mm (attached to the main unit, when the extension tray is extended)  
Weight: Approx. 473 g

### INNER 2WAY TRAY-J1

Adds a second internal output tray to give a combined output capacity of 350 sheets (upper tray 100 sheets/ lower tray 250 sheets).

### INNER FINISHER-K1 (Internal)

Number of Trays: 2  
Upper Tray Capacity\*: A4, A5, A5R, B5: 100 sheets, SRA3, A3, A4R, A6R, B4, B5R: 50 sheets  
Lower Tray Capacity\*: A4, A5, A5R, B5: 500 sheets, SRA3, A3, A4R, B4, B5R 250 sheets, A6R: 30 Sheets (64 to 300 gsm) \* with 81.4 gsm paper  
Paper Weight: 52 to 300 gsm  
Staple Position: Corner, Double  
Staple Capacity: (with Lower Tray)  
Corner staple and Double Staple:  
A4/B5: 50 sheets (52 to 90 gsm),  
A3/A4R/B4: 30 sheets (52 to 90 gsm)  
Eco Staple:  
A3/A4/B4/B5: 5 sheets (52 to 64 gsm),  
4 sheets (65 to 81.4 gsm), 3 sheets (81.5 to 105 gsm)  
Staple On Demand: 40 sheets (80 gsm)  
Dimensions (W x D x H): 604 x 525 x 188 mm (unit size: when the extension tray is extended)  
Weight: Approx. 8 kg

### STAPLE FINISHER-AA1 (External)

Number of Trays: 2  
Upper Tray Capacity\*: A4, A5, A5R, A6R, B5: 250 sheets, SRA3, A3, A4R, B4, B5R: 125 sheets  
Lower Tray Capacity\*: A4, A5, A5R, B5: 3,000 sheets, SRA3, A3, A4R, B4, B5R 1,500 sheets, A6R: 250 sheets (52 to 105 gsm), 50 sheets (106 to 300 gsm)  
\*with 81.4 gsm paper  
Paper Weight: Upper Tray 52 to 256 gsm  
Lower Tray 52 to 300 gsm  
Staple Position: Corner, Double  
Staple Capacity: Corner staple and Double Staple:  
A4/B5: 50 sheets (52 to 90 gsm),  
A3, A4R, B4: 30 sheets (52 to 90 gsm)  
Eco Staple:  
A3/A4: 5 sheets (52 to 64 gsm),  
4 sheets (65 to 81.4 gsm), 3 sheets (81.5 to 105 gsm)  
Staple On Demand: 50 sheets (90 gsm)  
Power Source: From the Main Unit  
Dimensions (W x D x H): 637 x 623 x 1,016 mm (attached to the main unit, when the extension tray is extended)  
Weight: Approx. 30 kg

### BOOKLET FINISHER-AA1 (External)

(includes the STAPLE FINISHER-AA1 basic staple specifications)  
Saddle Stitch paper size:  
A3, A4R, B4, Custom Size (195.0 x 270.0 mm to 304.8 x 457.2 mm)  
Saddle Stitch Staple Capacity:  
20 sheets x 10 sets (81.52 to 81.4 gsm) (including 1 cover sheet up to 256 gsm)  
Non Staple Folded Bunch Capacity: up to 3 sheets (52 to 105 gsm)  
Power Source: From the Main Unit  
Dimensions (W x D x H): 637 x 623 x 1,016 mm (attached to the main unit, when the extension tray is extended)  
Weight: Approx. 53 kg

### 2/4 HOLE PUNCHER UNIT-A1

(Requires either the STAPLE FINISHER-AA1 or BOOKLET FINISHER-AA1)  
Two or Four Holes  
Acceptable Punch Paper Weight: 52 to 300 gsm  
Acceptable Punch Paper Size:  
Two holes A3, A4, A4R, A5, B4, B5, B5R, Four holes A3, A4  
Power Source: From the Main Unit

### 4 HOLE PUNCHER UNIT-A1

(Requires either the STAPLE FINISHER-AA1 or BOOKLET FINISHER-AA1)  
Four Holes  
Acceptable Punch Paper Weight: 52 to 300 gsm  
Acceptable Punch Paper Size: Four holes A3, A4, A4R, A5, B4, B5, B5R  
Power Source: From the Main Unit

### STAPLE CARTRIDGE

STAPLE-P1 - For stapling (2 x 5,000 pcs) (for Inner Finisher-K1, Staple Finisher-AA1 and Booklet Finisher-AA1)  
STAPLE CARTRIDGE-Y1 - For saddle stitching (2 x 2,000 pcs) (for Booklet Finisher-AA1)

For a complete list of all Hardware accessories, please refer to our website specifications page or online product configurator.

## Software & Solutions



## Certifications and compatibility



**Canon Ireland**  
3006 Lake Drive  
Citywest, Saggart  
Co. Dublin, Ireland  
Telephone No: 01  
2052400  
Facsimile No: 01 2052525  
canon.ie

**Canon (UK) Ltd**  
Woodhatch  
Reigate  
Surrey RH2 8BF  
Telephone No: 01737  
220000  
Facsimile No: 01737 220022  
canon.co.uk

**Canon Inc.**  
canon.com  
**Canon Europe**  
canon-europe.com  
English edition  
© Canon Europa N.V., 2019