

BS6930

ECG Holter



High accuracy



7 days recording



Max comfort



BS6930

ECG Holter



BS6930 ECG Holter

Slim design and light weight, easily get data of our body Real time waveform display, know every beats without delay Heart rate monitoring with high accuracy, easily control our health condition





12-channel

2 in 1



3-channel



20,000HZ Independent Pacemaker Channel

With pacing pulse detection function, pacemaker sampling rate up to 20,000HZ

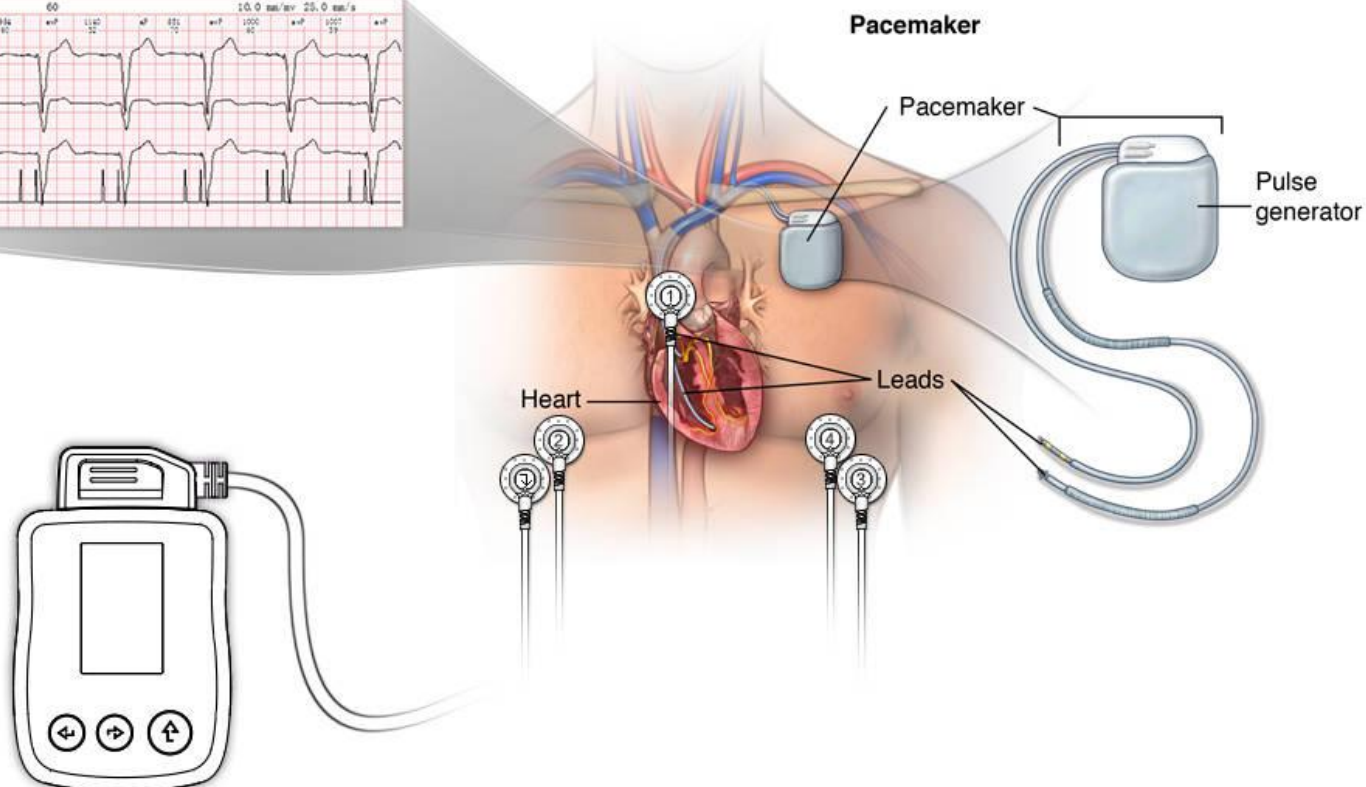

Durable and lasting, lowest power consumption

Up to 7 days recording for 3-ch with only one AAA battery , Up to 48 hours recording for 12-ch with only one AAA battery

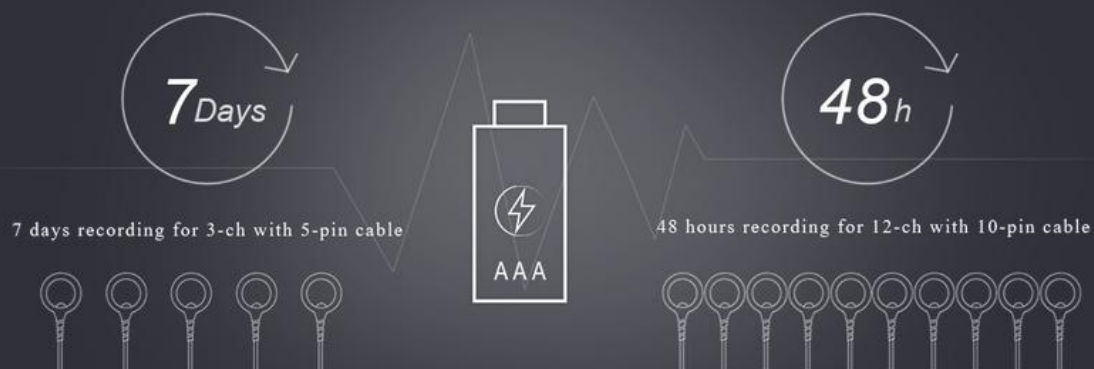

Accessories



BS6930 give the best care for Health

Two ways to transfer data: USB cable or Flash Card Reader Flash memory up to 2G, the largest among similar products



Preparation

1. ECG Holter, Patient Cable, one new AAA battery, 10 disposable ECG electrodes.

2. Instruct Patient about things need attention during recording.

Wearing device

1. Proper preparation of the patient's skin at the typical Electrode Application position. It is suggested to wipe skin with alcohol cotton.



2. Apply the ECG electrodes and attach the patient cable.

3-Ch(5/7Pins) and 12-Ch(10 Pins) Electrodes Placement refer to the pictures below:

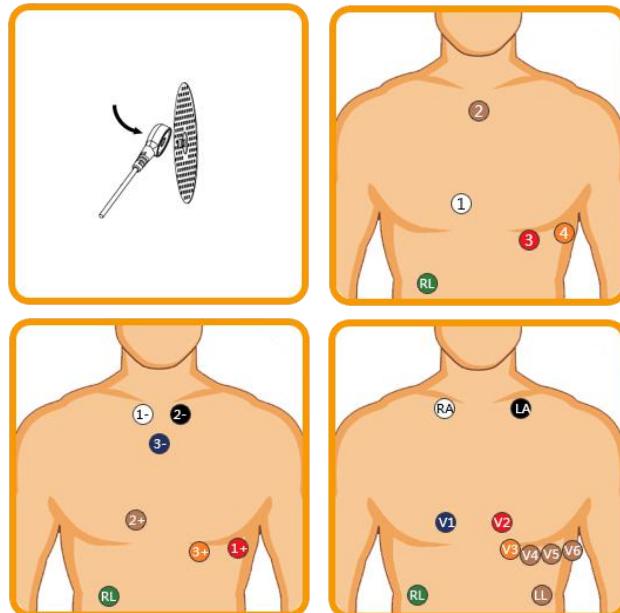

Start Recording

1. Insert battery, SD card and patient cable. Special attention to unlock the SD card, and place the battery in the correct positive and negative direction.

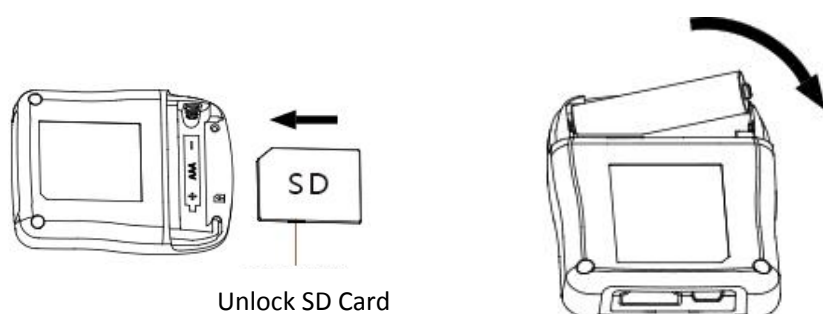

Ensure the patient cable closely inserted to the recorder.



2. Follow the instructions on the screen to start the recorder.

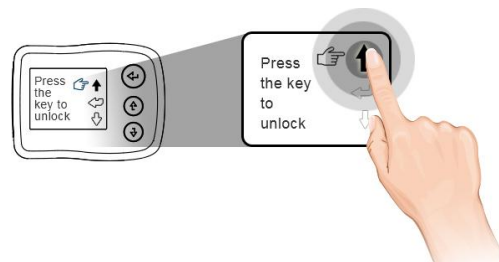

3. Check the waveform of all channels.

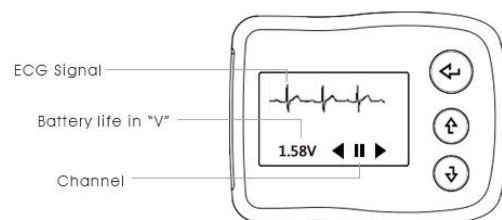

4. different channels by pressing the up or down key.

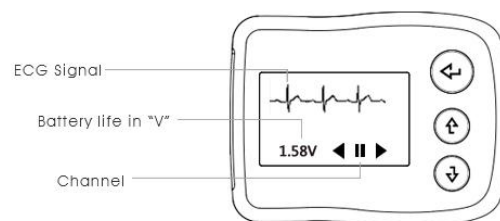

5. Press the "Enter" button to start the recording.

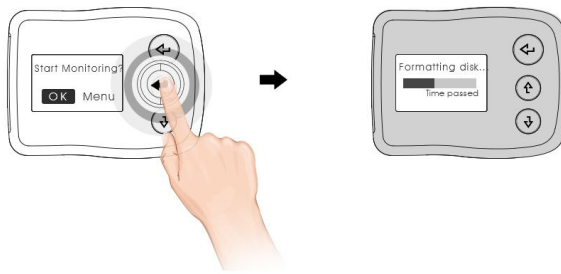

After Format, time will display on the screen, means recording start.

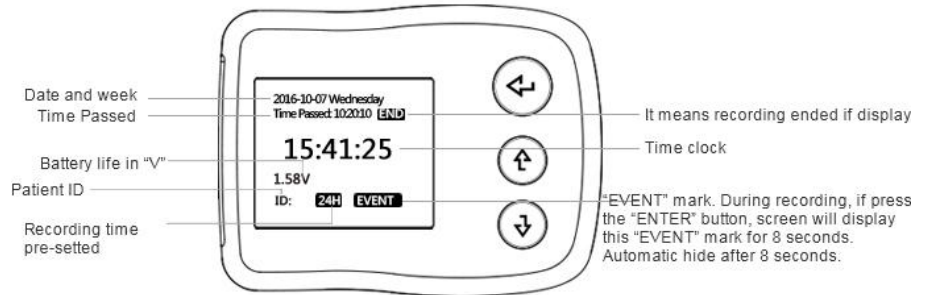

Stop recording

1.The holter will automatically stop recording after 24 hours (pre-set time), and turn off in 30 minutes.

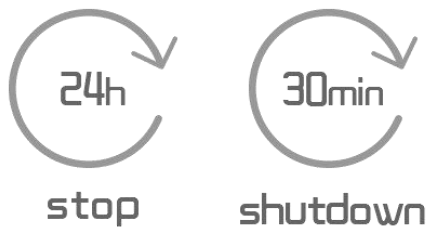

2.If need Early out during recording,press the Enter key and Down key simultaneously,and then follow the instruction on the screen.

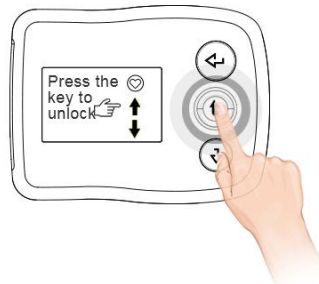

3.Take the ECG electrodes off the patients and place to medical recycling bin; remove and properly dispose the battery according to local laws.



4. Take SD card out from recorder and insert it into card reader for data transfer; or use the USB data cable to connect the recorder with computer directly for data transfer.

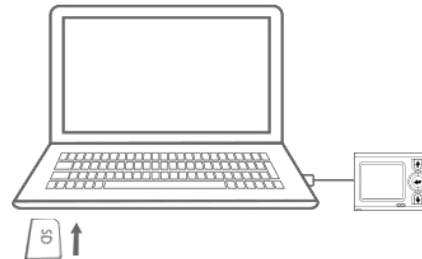

After recording, suggest patients rest in site for 5 minutes before leave.

Remind the patient they can do daily life activities like walking or climbing stairs.



Do not swing limbs, extend chest, play badminton or basketball and other strenuous exercise, can not take a bath.



Away from the computer, hair dryer and other equipment with heavy radiation.



Attention during monitoring

FAQ and Solutions

Q:Low battery.

A:We suggest use new battery for each recording. Old battery may lead to incomplete recording.

Q>Please insert SD card/patient cable.

A:please check whether insert SD card in the recorder, and patient cable closely connected.

Q:"Warning! SD card protection, can not record".

A:Please pull the switch on the SD card from the lock position.

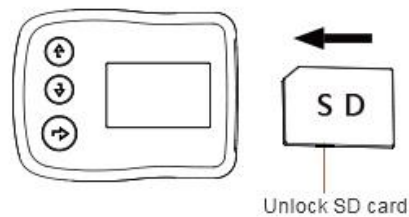

Q:Recording time is less than 24 hours.

A:Please use an official and brand new battery to ensure 24 hours recording.

Q:There is noise and artifacts on the ECG signal.

A:Please check the electrodes placement, skin preparation and patient cable connection.

Q:The recorder displays wrong time.



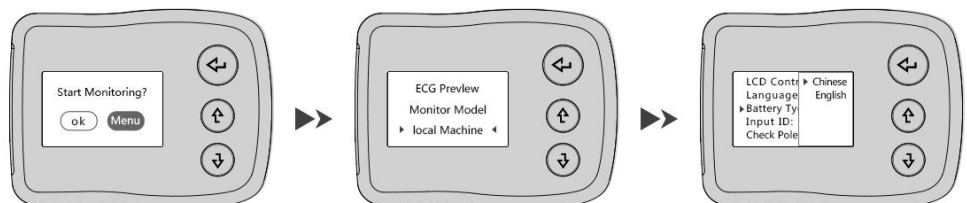

A:Unlock the recorder, set time by following steps below. If time display still wrong, please contact supplier for maintenance.

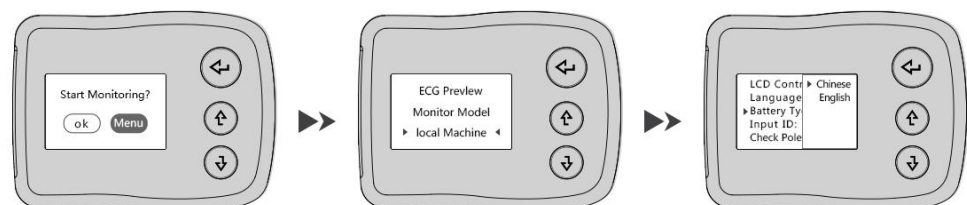

Q:The recorder language is in Chinese.

A:Unlock the recorder, and follow the steps below to change the language.

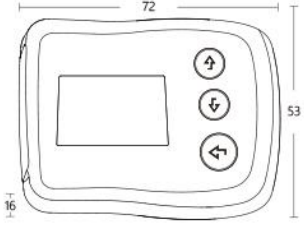

Appearance	  <p>Front</p> <p>Side</p>
Leads	3/12channels
Sampling Rate	128-1024
A/D conversion	8-16bits
Pacemaker	20,000HZ Independent pacemaker sampling rate
Data transfer	USB or SD card reader
LED Display	support
Storage	SD Flash memory512MB - 2GB512MB - 2GB
Size and weight	 <p>Size : 72×53×16 mm Weight : 61g with battery</p>
Battery and life	 <p>1AAA Alkaline battery for24-72hours recording</p>