

# CONTEC Best Selling PM50 ABPM&Spo2 Patient Monitor

NIBP(24-hour ABPM),SPO2,PR,Handheld Patient Monitor

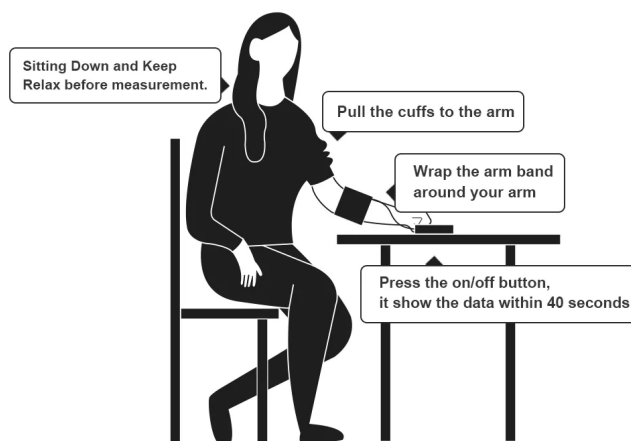

## The Right way For use the Blood Pressure Monitor





PM50 is a multi-functional patient monitor that can monitor BP and SpO<sub>2</sub> at the same time. Realizing long time monitoring of dynamic blood pressure, the device is widely applicable to hospital wards, community clinics and other medical institutions.

### **Features:**

- 1) Compact and portable, easy to use.
- 2) With Integrative SpO<sub>2</sub> Probe.
- 3) Double working modes, monitoring function and 24 hours ambulatory NIBP measurement function can be flexibly set.
- 4) Long time monitoring BP and SpO<sub>2</sub>, displaying value of BP, SpO<sub>2</sub> and PR.
- 5) NIBP and SpO<sub>2</sub> data Record for large capacity.
- 6) With friendly user interface, the user can see list menu and review measurement results.
- 7) The device can display low power information, alarm information, error information and time information richly.
- 8) Parameter alarms function is optional.
- 9) Patient information can be flexibly set.

10)Case management function.PC software can achieve data review, analysis measurement results, seeing trend, printing reports and other functions.

11)Data can be transmitted between device and computer, such as upload patient information, download measurement data.

12)English and Chinese menu.

### **Function of master device software:**

1) Set patient information through PC software.

2) Up to 1000 patients cases can be edited and supervised.

3) The time segment of dealing with the patient's NIBP data is 48 hours.

4) Connect the device by USB interface.

5) Can upload patient information data collection project and download collection data.

6) Can display scoop-shape trend graph,filling-type trend graph, histogram, pie chart, correlation line graph.

7) Can edit every piece of data, and add annotation to it.

8) Can edit basic information,doctor's advice information, NIBP and SpO2 status instruction, current medicine-taken information, etc.

9) Support print preview,print the report.

10) 2.4" TFT colour LCD

11) Power: DC 3V (Two "AA",1.5V Alkali Battery)

12) Product safety type:Type BF application part (Internally powered,defibrillator protected)

### **Accessories(standard)**

1.cuff for adult

2.Integrative SpO2 Probe

3.USB data line

4.Disk (PC software)

5.Pouch

6.User manual

## Optional -Pediatric and neonatal size cuff and Spo2 probe



## FAQ

1.Q: Where is your factory located?

A: Our factory is based in beauty seaside city, Qinhuangdao, China

2.Q:What does your company manufacture and what are your company's main products ?

A : Contec Medical Systems Co., Ltd. focuses on research, manufacture and distribution of medical devices, it was founded in 1996 as a high-tech company. CONTEC covers an area of 125 acres and building area of over 100000 square meter, which is one of the largest bases for R & D and production of medical devices in China.

3.Q: What are your company's advantages?

A: Contec's core competence is it integrates the capacity of Design, R&D, Tooling Design, SMT, Production and Packaging without outsourcing. The integration of various capacities secures the production efficiency and the product quality, reduces the cost and enhances the market competitiveness.

We also have full certificate like CE/ISO and FDA etc., and we are a listed company in China meaning we have good quality assurance.

4.Q: Do you support free sample shipping?

A: Yes, we support for certain small products, but need you to provide us your detailed company information that would support us the application of free sample. Or you could choose to buy the sample in a discount price.

5.Q: Do you support OEM/ODM?

A: Yes, we support all kinds of OEM/ODM and private label, you could choose your own design with our current products for fast market promotion.

6.Q: What is your warranty?

A: Our warranty is 18 months for machines and 6 months for accessories.

7.Q: Can I get good discount when I place order?

You could check our sales rep for discount.

For more information, pls click "contact us" above or "ask us" in the right corner. We will respond as soon as we can.