

TDS No.099
Electronic superimposed pulse ignitor type:
ZX

Reference		Superimposed pulse ignitor
Type		ZX
Ref.No	-	78.02.400.0
Art.No.	-	91078400
High pressure sodium lamps	W	70 (only with 3kV - 5kV) - 400
Metal halide lamps	W	35 - 400
Rated voltage	V	220-240 AC, 50-60 Hz
Main voltage	V	198-264 AC
Ignition voltage	kV	3.0 - 5.0
Max. continuous current of the lamp	A	4.50
Loading capacitance	pF	20 - 100
Pulse number per cycle	No.	≥6
Pulse position	°e	60-90 / 240-270
Switch-on / Switch- off voltage	V	U _{ON} < 198 / U _{OFF} > 170V
Maximum case temperature t _c	°C	105
Temperature range	°C g	-30 / +70
Weight	mm	110
Dimensions		75x34x30
Screw terminals (encapsulated in polyurethane resin)	mm ²	1.0 ÷ 2.5

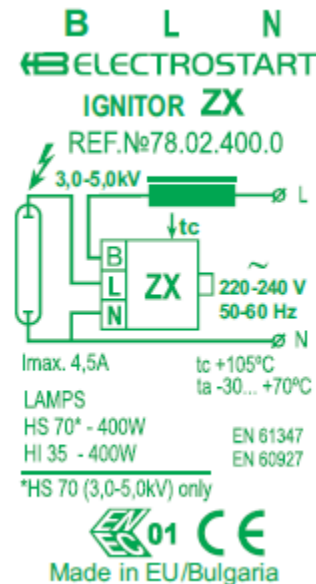
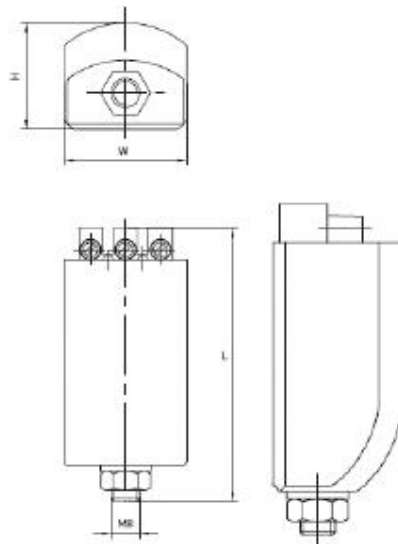

Insulating self-extinguishing casing with fastening shank M-8

In accordance with IEC 61347-2-1, IEC 60927, IEC 60662, IEC 61167