

All materials supplied are in compliance with the requirements of the List of Prohibited Substances

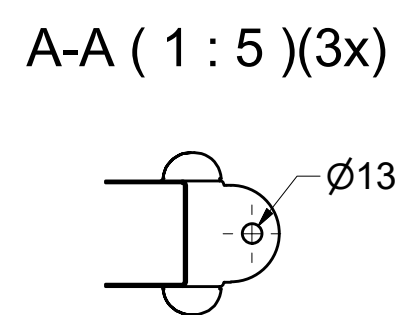
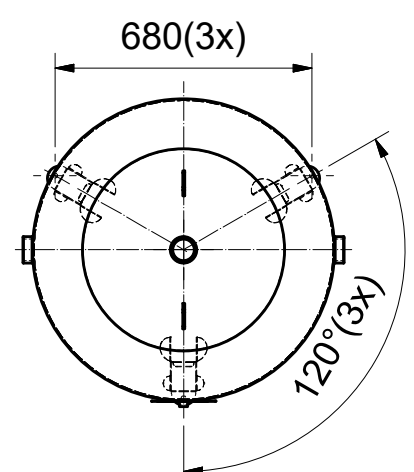
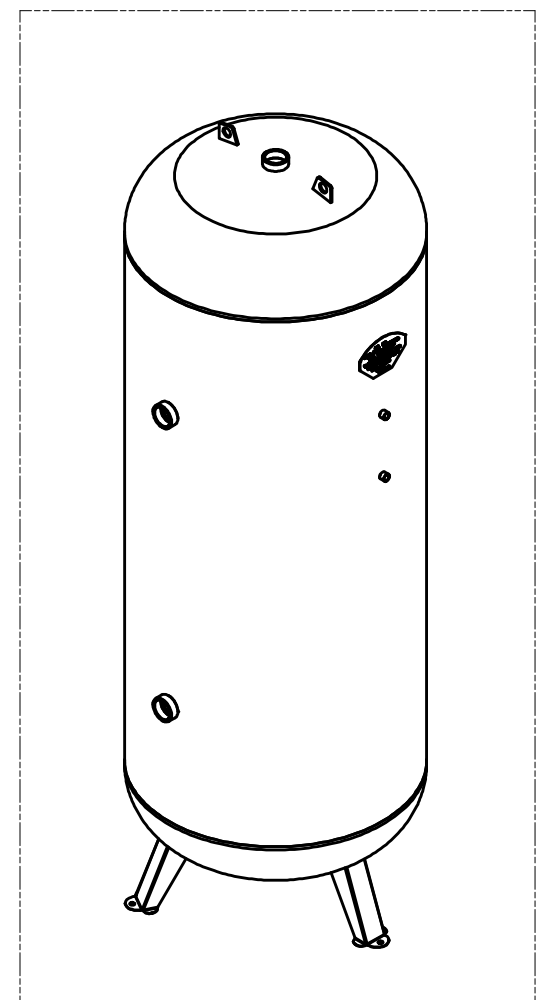
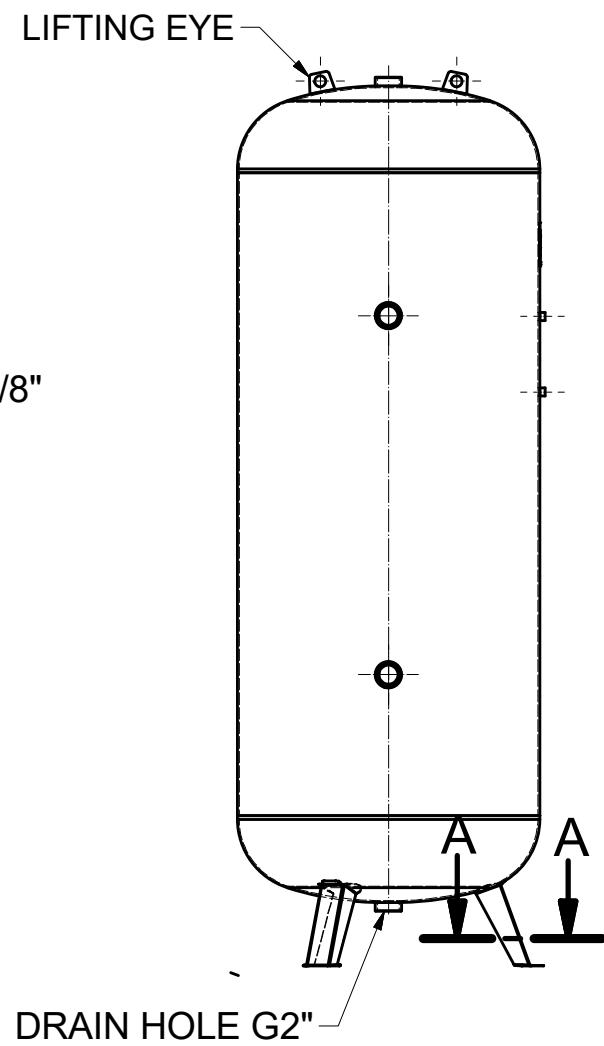
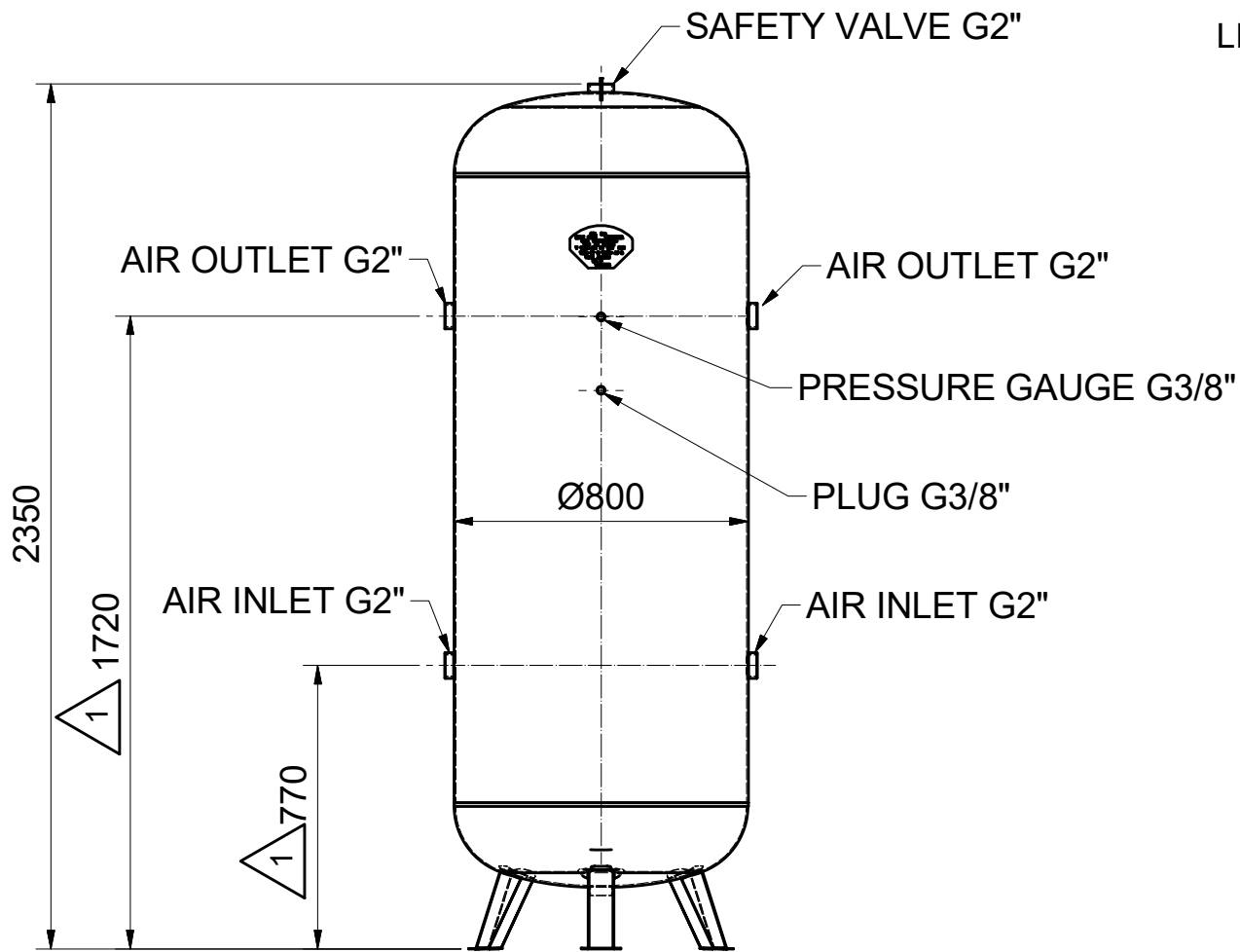

**Note A :**  
 - Dim. 770 was 778.  
 - Dim. 1720 was 1718.  
 - 1629009511 replaced by 8101021809.  
 - 1629009516 replaced by 8101021833.

Type Name	Product Nr	Pressure	Vessel Set
LV1000	8101021809	12 bar	8101024100
LV1000	8101021833	16 bar	8101024142

Tolerances, if not indicated, according to:				ATLAS COPCO STANDARD CLASS			
Name		PRESSURE VESSEL DIMENSION DRWG L1000		Confidentiality Class		acc. to 1102 K	
Material		Not Applicable		Internal			
Treatment		Not Applicable		INV			
	Scale	1 : 20	Family	Compare		Drawing Owner	Transferred from
	Drawn by	INEvak	Blank nr.	Replaces		API	
STATUS	Drawing format	Blank wt	kg	Fini wt.	230.463 kg	Designation	Sheet 1 / 1
Approved Internal		Des checked.	Prod checked.	Approved.	Date	19/11/2015	

01	See Note 'A'	13-10-2017	INEextvip	1629009511	
Ed	Position	Date	Intr./Appd.	Parent 3D model	Ed . Version 3D

**9820920039**

**CONFIDENTIAL:**  
This document is property of Atlas Copco AB and shall not without our permission be altered, copied, used for manufacturing or communicated to any other person or company.